



ON TARGET
Conversion Set

AIR-GRAPHICS
CS-19



Juno HT.1

1:72
Scale

Airbus H135

AIR-GRAPHIC MODELS 

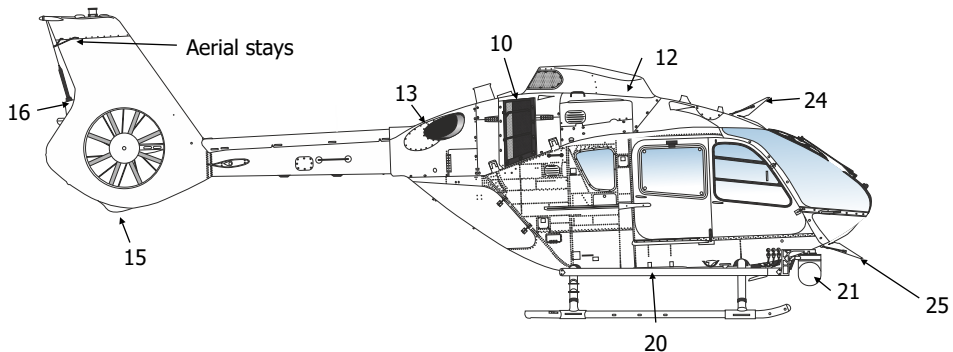
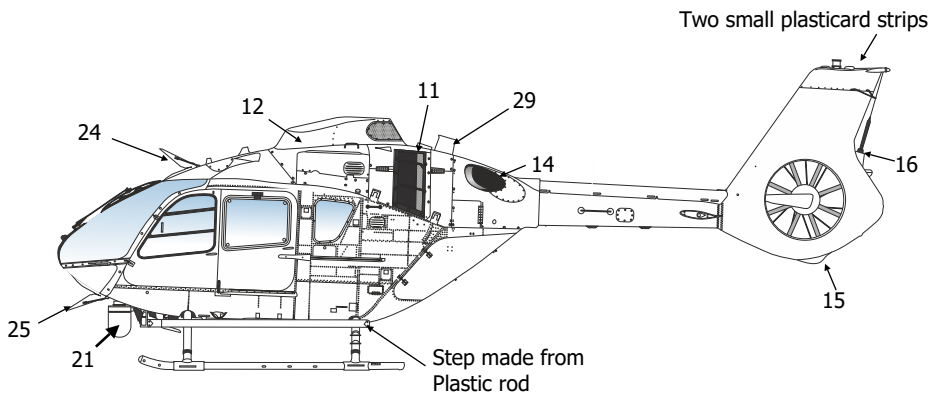

Airbus H135 Juno HT.1

Drg No: CS-019 -01

Drawn: Gary Madgwick

© Copyright Gary Madgwick
Air-Graphic Models 2022

1/72 Scale @ A5

12/08/2021

1

Cabin Assembly

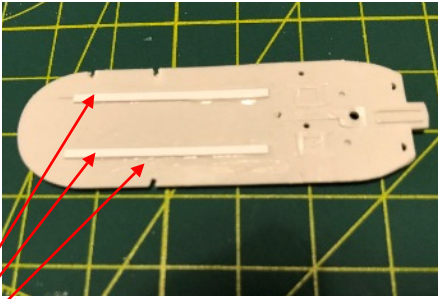

Kit floor with seat risers sanded off.
Two thin plasticard strips which were
Sanded right down to almost nothing.
*Note, 2 small plasticard strips with
hes in on end.

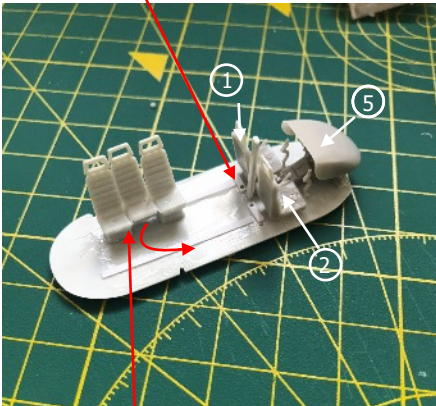
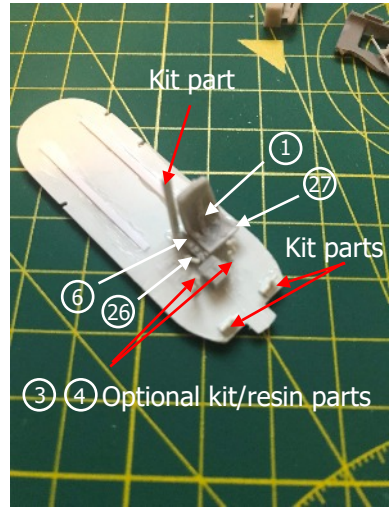

Kit parts.
Note, see photos on next page
for correct layout of two seats
and the rear bulkhead
arrangement.

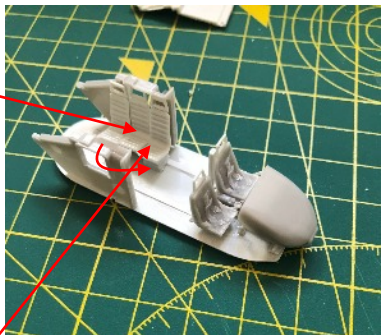
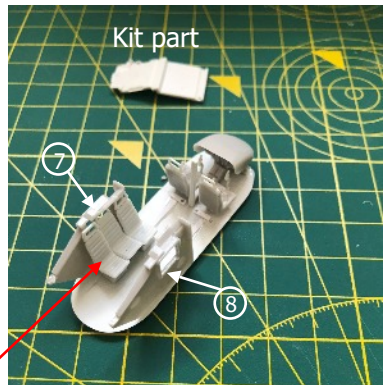

Only two seats, turned through 90 degree
as per picture

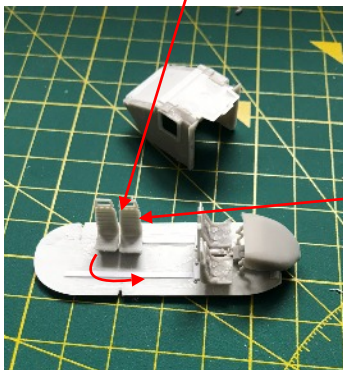

Cockpit Continued



Above: Rear seats, note cabin colour and seat colours. Also note rear cabin bulkhead behind seats



Above: Front cabin seats are black with light grey cushions. Note* two bars behind seats which will need to be made From sprue, wire or plastic rod. These fit into the strip behind The front seats.



Above: View forward from the rear cabin seats showing fixing of the grab bars.



Above: Rear seats and cabin bulkhead



Cockpit tub fitted into fuselage half's. Note fuselage Modifications to take New intake ducts for The RAF aircraft. Also The rear air grills parts 10 and 11 have been Fitted. Note plasticard Backing to help locate These and secure.



3

Fuselage Modifications



Part 9 cabin roof
Instrument panel
position

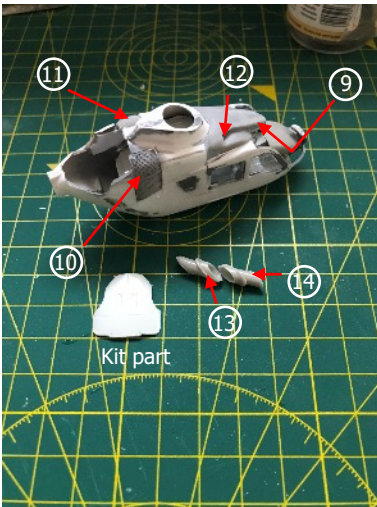

4

Tail detailing



Tail as per kit parts
Apart from part 15
Tail boom skid.



Above right & below left: Completed fuselage and tail during clean up process.



Note, tail planes do not have the vertical
Planes. Remove these

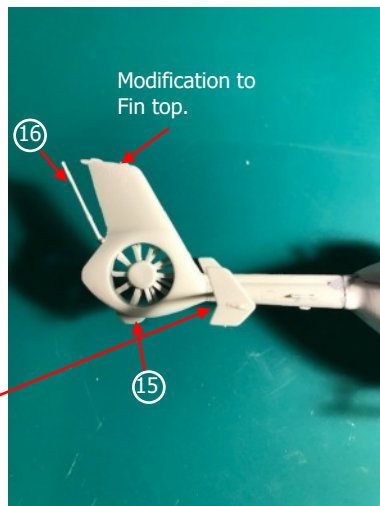

5

Final Detailing

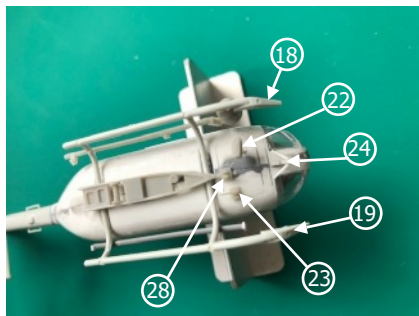
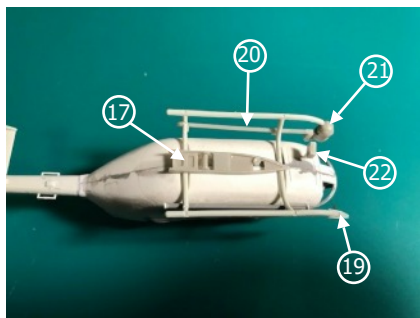
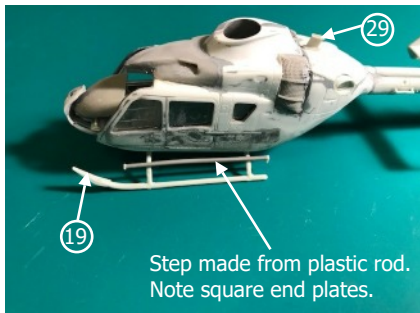

Note, tail planes should not be fitted.

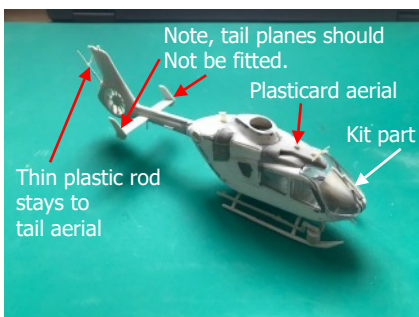

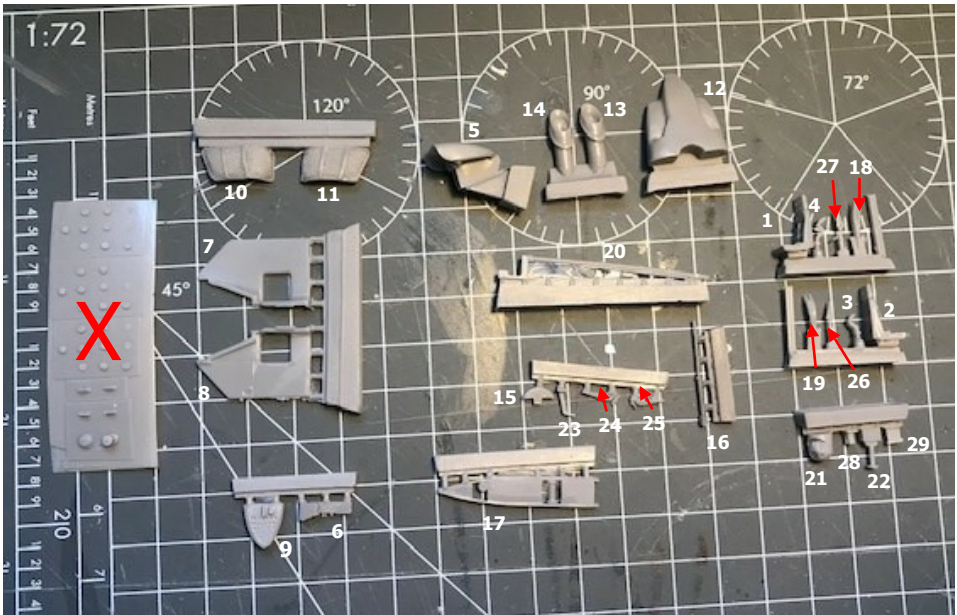

INSTRUCTIONS

- Remove any flash by gently sanding off, or cutting with a scalpel and then lightly sanding.
- Only use Super-glue or a two-part epoxy glue to fix parts.
- Gluing is easier if mating surfaces are slightly sanded to roughen the resin before gluing. Also clean off any dust before gluing.
- Before painting, thoroughly wash all parts in warm water with detergent.
- We recommend the application of a base coat in a light colour to show any blemishes prior to final painting.

WARNING & SAFETY!

- These parts are moulded in polyurethane resin. Please take care when sanding and cleaning up the resin by wearing a dust mask or other protective breathing device to avoid inhalation of the dust particles.
- Wash hands, resin parts and the work surface after sanding resin.
- When using Super-glue or two-part epoxy glue, please take precautions to avoid contact with skin and eyes.
- It is also advisable to wear a mask to avoid breathing in any fumes from the glue or work in a ventilated room.
- The use of barrier creams on hands or wearing disposable gloves, and working in a well ventilated area, is strongly recommended.
- Not suitable for children under 14 years of age.

Thank you for purchasing this Air-Graphics product which forms part of a range of accessories, conversion sets, decals & kits all to 1/72 Scale.

Air-Graphics: 24 Fyfield Close, Wantage, Oxfordshire, OX12 8HN, UK.
E: gary.madgwick@air-graphics.co.uk

