

NOTE:

1. Pressure Test All Suction Lines Upon Installation @ 10-15 PSI max.
2. Keep pressure on Suction Lines for the entire DURATION of construction.
3. Pressure should NOT drop more than 2 PSI.
4. Watch for problems when excavating driveways.
5. If reclaim tanks are located more than 60 feet away from reclaim unit, then increase suction line to 3" sch 80 P.V.C.
6. Placement of suction lines is critical
7. Do NOT put screens on the suction lines
8. ANY QUESTIONS CONTACT SONNYS

CAR WASH RECLAIM SYSTEM STANDARD RECLAIM 3 TANK

(SEE RECLAIM SHEET FOR DETAIL)

NOT FOR CONSTRUCTION UNTIL APPROVED BELOW.

APPROVED BY.

DATE _____

NOTE:

1. ALL UNDERGROUND TANKS AND PIPING BY CONTRACTOR
2. PIPE LOCATIONS SHOULD BE USED FOR ANY TANK
3. ALL INTERNAL TANK PLUMBING TO BE 6" sch 40 PVC UNLESS NOTED OTHERWISE
4. ALL TANK BOTTOMS SHOULD BE LEVEL
5. THIS DRAWING IS TO SHOW TANK HOLDING CAPACITY AND PIPING RELATIONSHIPS ONLY. THEY ARE NOT INTENDED TO ADDRESS TANK STRUCTURE ENGINEERING.

DISCLAIMER
ALTHOUGH BUILDING CODES HAVE BEEN CONSIDERED IN DEVELOPING THIS DRAWING, VERIFICATION OF SITE SPECIFIC CONDITIONS AND COMPLIANCE WITH FEDERAL, STATE AND LOCAL BUILDING CODES IS THE EXCLUSIVE RESPONSIBILITY OF THE CUSTOMER AND/OR ARCHITECT AND ENGINEER. THESE DRAWINGS REFLECT REQUIREMENTS FOR SONNET'S FURNISHED EQUIPMENT ONLY UNLESS OTHERWISE NOTED. PLEASE REFER TO OTHER MANUFACTURERS, IF ANY, FOR THEIR EQUIPMENT REQUIREMENTS.

CONFIDENTIAL WARNING: THIS SHEET CONTAINS AND CONSTITUTES CONFIDENTIAL INFORMATION, IMAGES AND TRADE SECRETS OF SONNYP'S ENTERPRISES INC. ANY UNAUTHORIZED USE OR DISCLOSURE OF ANY OR PORTION THEREOF, IS STRICTLY PROHIBITED. THIS WORK IS THE EXCLUSIVE PROPERTY OF SONNYP'S ENTERPRISES, INC. ALL RIGHTS RESERVED.

21060-D1-Frank Brooks Mckin.

SCALE: N.T.S.

LOCATION: -TX-

Sheet	Rev.
4.3	—+—

4.3

+

RECLAIM TANK SYSTEM; GC



<http://www.SonnysDirect.com>

DATE:	01.25.21
REVISION DATE:	05.27.21
CREATED BY:	LV
REVISED BY:	ADC
CHECKED BY:	Luis V

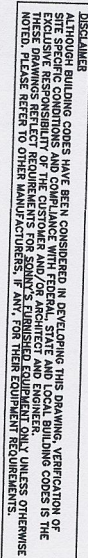
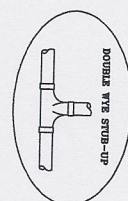

NOT FOR CONSTRUCTION UNTIL APPROVED BELOW

APPROVED BY. _____ DATE _____

© 2021 SONNY'S ENTERPRISES, INC. 5605 Hiatus Road, Tamarac, FL. 33321 USA. TEL.800-327-8723

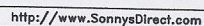

DATE:	01.25.21
REVISION DATE:	05.27.21
CREATED BY:	LV
REVISED BY:	ADC
CHECKED BY:	Luis V.

NO!

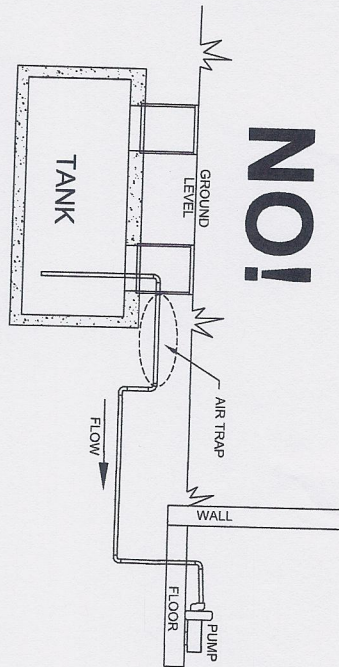

BELOW GROUND TANKS

ALL suction lines must NEVER slope down and then back up again (Air Trap).

NO!

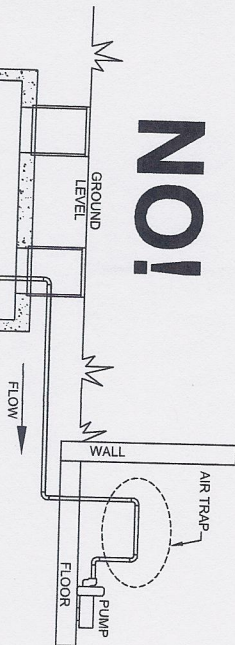

BELOW GROUND TANKS

ALL suction lines must NEVER slope up and then back down again (Air Trap).
ANY QUESTIONS CONTACT SONNY'S

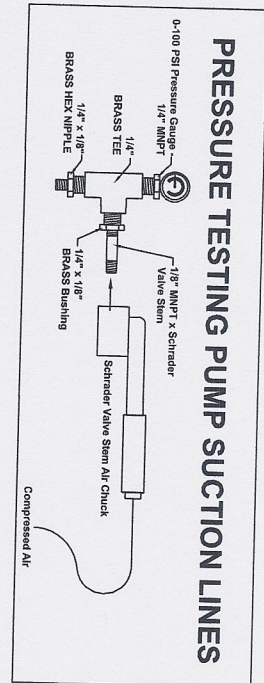

PRESSURE TESTING PUMP SUCTION LINES

0-100 PSI Pressure Gauge
1/4" MNPT
BRASS TEE
1/4" x 1/8" BRASS HEX NIPPLE
1/8" MNPT x Schrader Valve Stem
Schrader Valve Stem Air Chuck
Compressed Air

ERS-100

Underground Stub-Ups & Pipe Connections in Equipment Room by G.C.

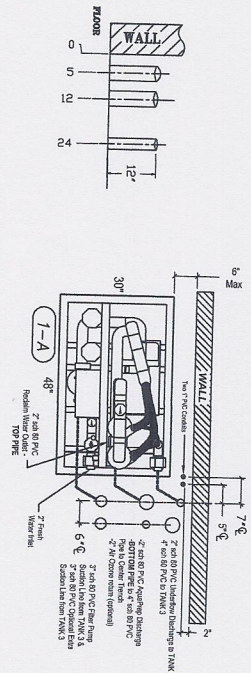

YES!

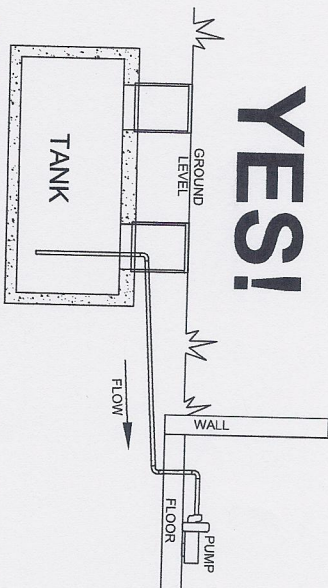

BELOW GROUND TANKS

ALL suction lines require a continuous upward slope to the Equipment Room.

DISCLAIMER

SITE SPECIFIC BUILDING CODES HAVE BEEN CONSIDERED IN DEVELOPING THIS DRAWING. VERIFICATION OF THESE BUILDING CODES FOR COMPLIANCE WITH FEDERAL, STATE AND LOCAL BUILDING CODES IS THE EXCLUSIVE RESPONSIBILITY OF THE USER. SONNY'S ENTERPRISES, INC. AND ENGINEER, ARCHITECT, AND ENGINEER, THESE DRAWINGS REFLECT REQUIREMENTS FOR SONNY'S ENTERPRISES, INC. AND ENGINEER, ARCHITECT, AND ENGINEER. THESE DRAWINGS ARE NOT TO BE USED FOR ANY OTHER PURPOSES WITHOUT THE WRITTEN CONSENT OF SONNY'S ENTERPRISES, INC. FOR THEN EQUIPMENT REQUIREMENTS.

CONFIDENTIAL WARNING: THIS SHEET CONTAINS AND CONSTITUTES CONFIDENTIAL INFORMATION, TRADE SECRETS AND PROPRIETARY INFORMATION OF SONNY'S ENTERPRISES, INC. ANY UNAUTHORIZED USE OR DISCLOSURE OF THIS INFORMATION IS STRICTLY PROHIBITED. THIS WORK IS THE EXCLUSIVE PROPERTY OF SONNY'S ENTERPRISES, INC. ALL RIGHTS RESERVED.

21060-D1-Frank Brooks McKin.

SCALE: N.T.S.

LOCATION: -TX-

Sheet 4.4
Rev. --

RECLAIM SYSTEM; GC



<http://www.SonnysDirect.com>

DATE:	01.25.21
REVISION DATE:	05.27.21
CREATED BY:	LV
REVISED BY:	ADC
CHECKED BY:	Luis V.