

# FOR SALE

## COMMERCIAL BUILDING WITH YARD PLUS COVERED STORAGE



1743 N. COUNTRY CLUB DR.  
MESA, AZ 85201

### PROPERTY FEATURES

- ±5,121 SF Commercial Building
- ±44,431 SF Total Land Size
- Bonus Covered Storage ±2,790 SF
- Excellent Frontage
- LC Zoning, City of Mesa
- Redevelopment Opportunity
- High Traffic Area
- Flexible Building Use
- Minutes to Loop 202 Freeway
- Monument / Building Signage



**UPLAND GROUP** INC.  
COMMERCIAL REAL ESTATE SERVICES

9180 S KYRENE RD, STE 115 | TEMPE, AZ 85284 | 480.820.9229 | WWW.UPLANDGROUP.COM

# 1743 N COUNTRY CLUB DR MESA, AZ 85201

## BUILDING/YARD FOR SALE

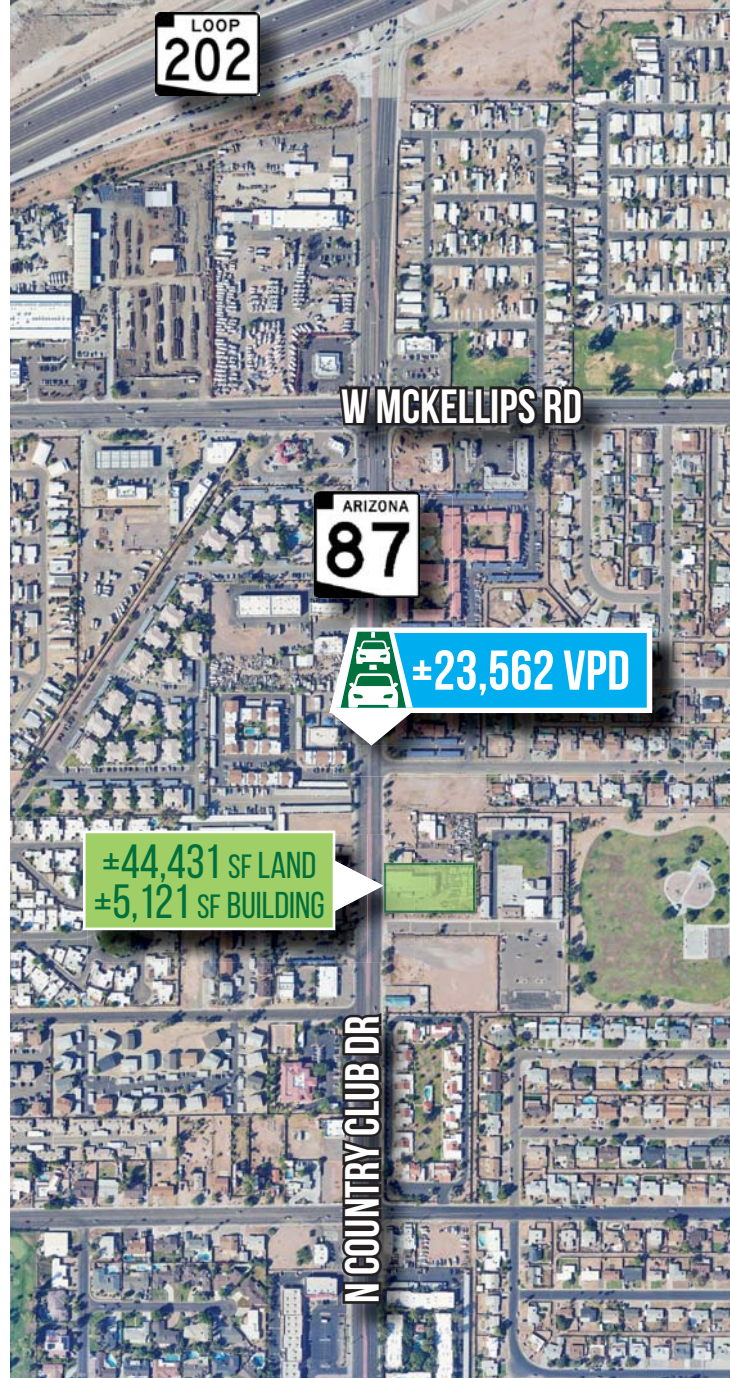
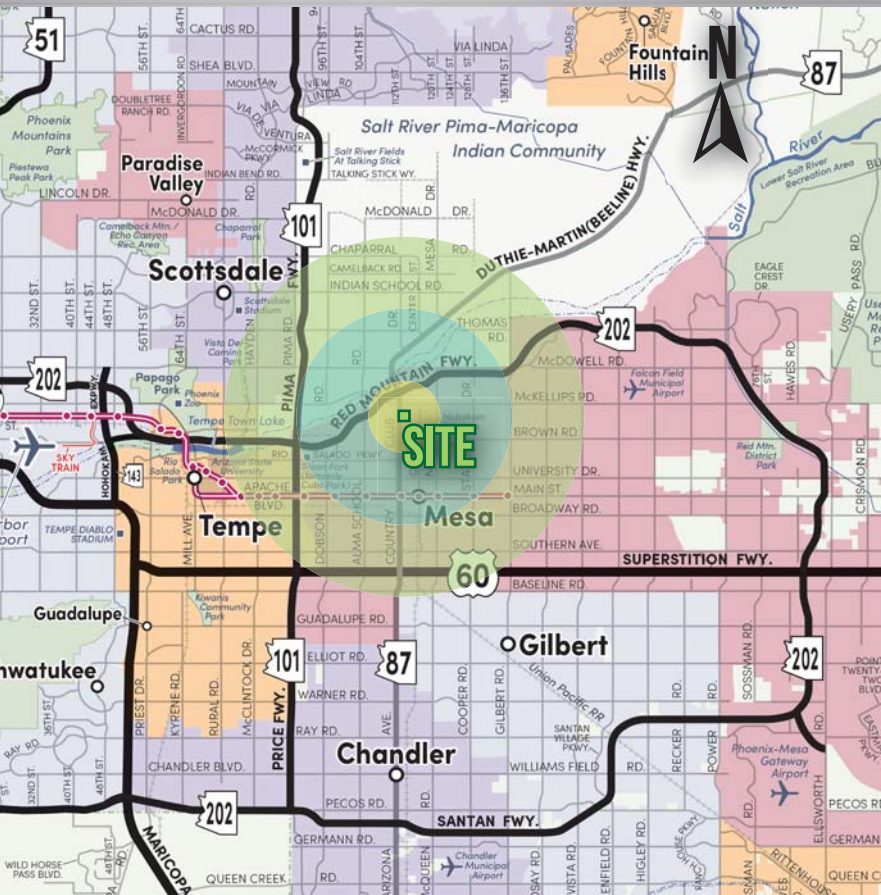

### DEMOGRAPHICS

	1-MILE	3-MILES	5-MILES
Total Population	16,100	90,651	285,823
Total Households	6,277	33,850	112,414
Median Household Income	\$57,244	\$55,920	\$59,400
Median Home Value	\$302,894	\$324,948	\$333,047

**BILL DOUGLASS**

480.420.2306

BILLD@UPLANDGROUP.COM

**CIARA CLINE**

480.420.2308

CIARAC@UPLANDGROUP.COM



**UPLAND GROUP** INC.

COMMERCIAL REAL ESTATE SERVICES

9180 S KYRENE RD, STE 115 | TEMPE, AZ 85284

480.820.9229 | WWW.UPLANDGROUP.COM