

FOR SALE

MULTI-TENANT COMMERCIAL BUILDING



1704 N. COUNTRY CLUB DR.
MESA, AZ 85201



PROPERTY FEATURES

- ±4,902 SF Multi-Tenant Building
- ±15,638 SF Total Land Size
- 3-Tenant Property with Rental Income Opportunity or Owner/User
- Side Yard and Back Yard
- Excellent Frontage
- Newly Painted
- Corner Lot
- High Traffic Area
- Minutes to Loop 202 Freeway



UPLAND GROUP INC.
COMMERCIAL REAL ESTATE SERVICES

9180 S KYRENE RD, STE 115 | TEMPE, AZ 85284 | 480.820.9229 | WWW.UPLANDGROUP.COM

1704 N COUNTRY CLUB DR MESA, AZ 85201

MULTI-TENANT BUILDING FOR SALE

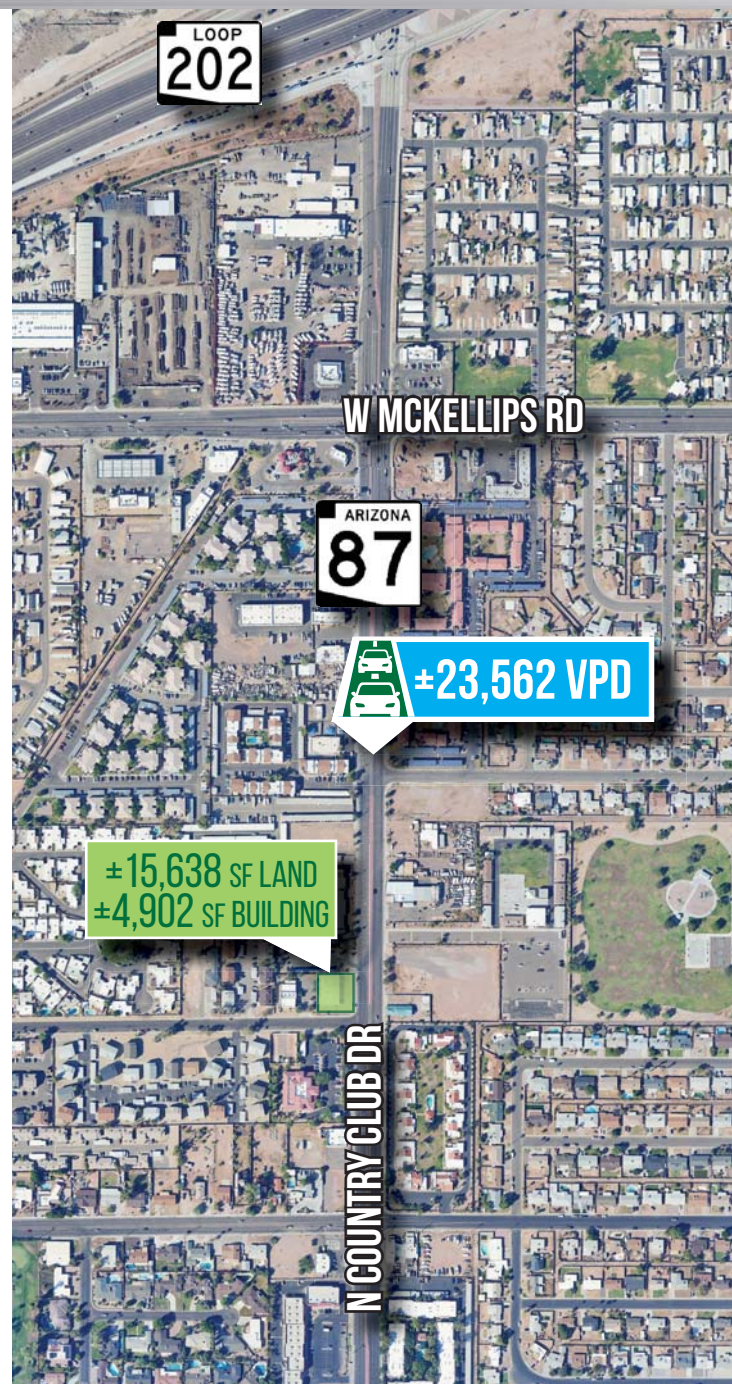
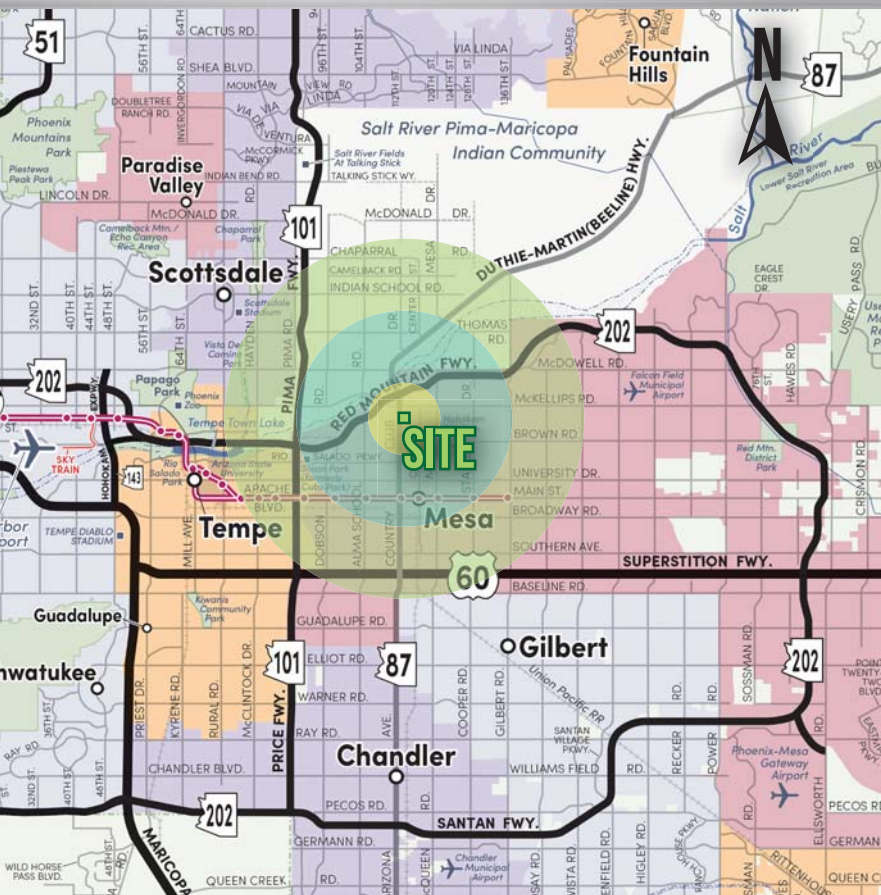

DEMOGRAPHICS

	1-MILE	3-MILES	5-MILES
Total Population	16,100	90,651	285,823
Total Households	6,277	33,850	112,414
Median Household Income	\$57,244	\$55,920	\$59,400
Median Home Value	\$302,894	\$324,948	\$333,047

BILL DOUGLASS

480.420.2306

BILLD@UPLANDGROUP.COM

JAKE SCHMITT

480.420.2321

JAKES@UPLANDGROUP.COM



UPLAND GROUP INC.

COMMERCIAL REAL ESTATE SERVICES

9180 S KYRENE RD, STE 115 | TEMPE, AZ 85284

480.820.9229 | WWW.UPLANDGROUP.COM

ALL INFORMATION FURNISHED REGARDING PROPERTY FOR SALE, RENTAL OR FINANCING IS FROM SOURCES DEEMED RELIABLE, BUT NO WARRANTY OR REPRESENTATION IS MADE TO THE ACCURACY THEREOF AND SAME IS SUBMITTED SUBJECT TO ERRORS, OMISSIONS, CHANGE OF PRICE, RENTAL OR OTHER CONDITIONS PRIOR TO SALE, LEASE OR FINANCING OR WITHDRAWAL WITHOUT NOTICE. NO LIABILITY OF ANY KIND IS TO BE IMPOSED ON THE BROKER HEREIN.