



ADDENDUM

Date Issued:	Feb 17, 2023
Project:	Intermountain Healthcare LDS Hospital, Fluoro Room 2 Remodel 8 th Ave., C Street Salt Lake City, UT 84143
Addendum Number:	1

The Contractors submitting proposals on the above-captioned project shall be governed by the following addendum, changes and explanations to the drawings and specifications and shall submit their bids in accordance therewith.

Item Number	General Items Description
1	Per Robert Smith (Intermountain Health), the conduit run between the Fluoro Room 2 and the panel that serves it, is 2". Add Alternate #2 would have upsized this conduit run if undersized but 2" is adequate for the new circuitry. As such, delete any references to Add Alternate #2. New circuitry for electrical disconnect shall remain as part of base bid. See electrical drawings.
2	Sheet A112, add keynote 02.66.
3	Sheet A113, revise keynote 01.59.
4	Specification Section 01 23 00, delete Add Alternate #2.

Attachments:

A112, A113, Specification Section "01 23 00 Alternates"

SECTION 01 23 00 – ALTERNATES

PART 1 - GENERAL

1.1 SUMMARY

- A. Section identifies each Alternate by number and describes basic changes to be incorporated into Work, only when that Alternate is made a part of Work by specific provisions in Construction Contract.
- B. Section includes only nontechnical descriptions of Alternates.
- C. Refer to specific Sections of Specifications and Drawings for technical description of Alternates.
- D. Coordinate related Work, and modify surrounding Work as required to properly integrate Work under each Alternate and to provide complete construction required by Contract Documents.

1.2 DESCRIPTION

A. Work includes:

- 1. Indicate Alternate prices on Bid Form.
- 2. Alternates will be selected after bids are evaluated.
- 3. Selected Alternates will be made a part of Contract and final Contract Amount will be adjusted accordingly.

1.3 ALTERNATES

- A. **Alternate No. 1:** Base bid for this alternate includes all remodel work described in the Construction Documents. Add Alternate #1 includes the install of an owner provided cabinet and countertop, lavatory and plumbing fixtures. Make plumbing connections to existing plumbing supply and drain and patch existing flooring (floor patching as part of base bid).

- ~~B. **Alternate No. 2:** Base bid for this alternate includes all remodel work described in the Construction Documents. Add Alternate #2 includes the demo of existing conduit run to electrical closet and include new conduit to accommodate new circuitry (circuitry included in base bid).~~

PART 2 – PRODUCTS (Not Used)

PART 3 – EXECUTION (Not Used)

END OF SECTION

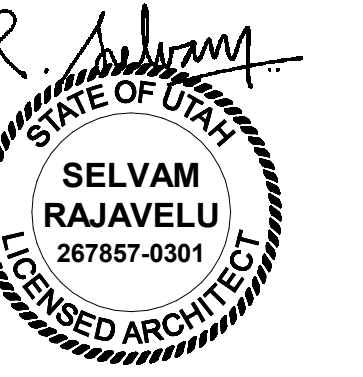

- KEYED NOTES**
- 02.03 WALL AND FLOOR FINISHES FLOORING, WALL BASE, WALL COVERING, WALL PROTECTION SHEETS, WAINSCOT, CORNER GUARDS, ACOUSTICAL PANELS, ETC.), EXISTING TO REMAIN. PROTECT FINISHES FROM DAMAGE DURING CONSTRUCTION. IF DAMAGED AS A RESULT OF CONSTRUCTION OR CONSTRUCTION RELATED ACTIVITIES, REPAIR OR REPLACE FINISH TO MATCH ADJACENT FINISHES.
 - 02.05 DOOR AND FRAME, EXISTING TO REMAIN. PROTECT DOOR AND FRAME FROM DAMAGE DURING CONSTRUCTION. IF DAMAGED AS A RESULT OF CONSTRUCTION OR CONSTRUCTION RELATED ACTIVITIES, REPAIR OR REPLACE.
 - 02.20 EXISTING DOOR TO REMAIN CLOSED AND LOCKED OUTSIDE OF CONSTRUCTION HOURS. COORDINATE AND NOTIFY BUILDING SECURITY OF SCHEDULED CONSTRUCTION HOURS.
 - 02.56 ALL ABOVE CEILING WORK REQUIRED TO INSTALL THROUGH BOLTS FOR NEW X-RAY UNIT MOUNTING PLATE IN THIS AREA TO BE PERFORMED STARTING NOT EARLIER THAN FRIDAY 4:00PM AND NOT LATER THAN 11:59PM SUNDAY. COORDINATE EXACT DATES WITH OWNER.
 - 02.57 IN PREPARATION FOR THE WORK BY THE CONTRACTOR REQUIRED TO INSTALL THROUGH BOLTS FOR X-RAY UNIT MOUNTING PLATE ABOVE THE OWNER SHALL REMOVE THE EXISTING CEILING TILES AND INSTALL NEW CEILING TILES AT THE EXISTING CEILING GRID SIMULTANEOUSLY WITH THE WORK BEING PERFORMED BY THE CONTRACTOR IN THIS AREA. THE CONTRACTOR SHALL COORDINATE WITH THE OWNER THE EXTENTS OF THE CEILING AREA REQUIRED TO PERFORM THE ABOVE CEILING WORK. REMOVE EXISTING CEILING GRID AS REQUIRED AFTER THE ABOVE CEILING WORK IS COMPLETE. AS PART OF PRIOR COORDINATION BY THE CONTRACTOR WITH THE OWNER, THE OWNER WILL PROVIDE SUFFICIENT NUMBER OF NEW CEILING TILES FOR THE CONTRACTOR TO REPLACE ONCE THE WORK ABOVE CEILING IS COMPLETE AND ANY NECESSARY REPAIRS ARE MADE TO THE CEILING GRID.
 - 02.58 REMOVE AND REINSTALL ANY DUCTS, MECHANICAL PIPING, FIRE SPRINKLER LINES, AND CONDUIT ABOVE CEILING AS REQUIRED TO INSTALL THROUGH BOLTS FOR NEW X-RAY UNIT MOUNTING. COORDINATE ANY SHUTDOWNS WITH OWNER IN ACCORDANCE WITH OWNER'S GENERAL CONDITIONS.
 - 02.59 EXISTING DOORS TO REMAIN CLOSED DURING CONSTRUCTION. COVER DOORS OR OPENING WITH PLASTIC SHEET AND SEAL CONTINUOUSLY AROUND EDGES TO WALLS WITH TAPE.
 - 02.60 TIGHTLY SEAL EXISTING TRANSFER AND SUPPLY AIR GRILLES WITH PLASTIC. SEAL TIGHTLY AROUND EDGES CONTINUOUSLY WITH ADHESIVE TAPE.
 - 02.66 WHERE FIREPROOFING IS REMOVED OR DAMAGED AS A RESULT OF THROUGH BOLT INSTALLATION, PATCH AND REPAIR FIREPROOFING AS REQUIRED.
 - 02.67 PROVIDE VACUUM MACHINE WITH DOUBLE HEPA FILTER FILTRATION SYSTEM TO MAINTAIN NEGATIVE PRESSURE IN THE CONSTRUCTION ZONE. DURING CONSTRUCTION PHASE, MOUNT TEMPORARY PRESSURE MONITORS (WITH ALARM CAPABILITIES) ON THE WALL TO MAINTAIN REQUIRED NEGATIVE PRESSURE 24 HOURS A DAY AND 7 DAYS IN THE WEEK. CONTRACTOR SHALL PROVIDE CONTINUOUS AIR FLOW MONITORING TO ENSURE THE DIFFERENTIAL PRESSURE OF -.01 IN.H2O IS MAINTAINED BETWEEN CONFINEMENT AREAS AND CORRIDORS (-.02 IS PREFERRED).
 - 02.68 EXHAUST FILTERED AIR HERE TO CORRIDOR OR TO EXTERIOR.
 - 02.85 DUST PARTITION (FROM FLOOR TO CEILING) WITH DOORS AS REQUIRED TO ACCESS CONSTRUCTION ZONE. LOCATE AND ALIGN PARTITION WITH CEILING GRID (AND/OR GYPSUM BOARD CEILING WHERE OCCURS) ABOVE AS MUCH AS POSSIBLE FOR A TIGHT SEAL. IF THERE IS A CONFLICT, WHERE PARTITION ABUTS CEILING, MOVE ITEMS MOUNTED ON CEILING SUCH AS EXIT SIGN, FIRE/SMOKE ALARM, LIGHT FIXTURE, DIFFUSER, RETURN AIR GRILLE, SENSOR, ETC. TEMPORARILY AWAY FROM THE LOCATION. PROVIDE ANTE ROOM AS INDICATED. MAINTAIN NEGATIVE PRESSURE IN THE CONSTRUCTION ZONE WITH REQUIRED PORTABLE VACUUM MACHINE (OR EXHAUST FANS), WITH HEPA FILTERS, TEMPORARY FLEXIBLE HOSE TYPE DUCTS TO EXHAUST FILTERED AIR AS INDICATED. DUST PARTITION SHALL BE FIRE RATED, POLYCARBONATE, TRANSLUCENT, PLASTIC PANELS WITH METAL FRAMES ON ALL SIDES. INSTALL PARTITION PER MANUFACTURER'S RECOMMENDATIONS. PARTITION MANUFACTURER SHALL BE "EDGE-GUARD" OR EQUIVALENT. MOVE ACCESS DOOR TO THE CONSTRUCTION ZONE AS REQUIRED DURING THE CONSTRUCTION PHASE. SEE "ICRA" (INFECTION CONTROL RISK ASSESSMENT) REQUIREMENTS AND ICRA WORK PERMIT FORM IN THE PROJECT MANUAL FOR ADDITIONAL REQUIREMENTS.
 - 02.86 TIGHTLY SEAL WITH ADHESIVE TAPE BETWEEN DOOR AND DOOR FRAME AND DOOR AND FLOOR BELOW. THIS SEAL SHALL BE AIR TIGHT TO MAINTAIN THE NEGATIVE PRESSURE IN THE CONSTRUCTION ZONE.

GENERAL NOTES

A. SEE SHEET G003 AND G005 FOR SYMBOLS, GENERAL NOTES AND LEGEND.

Intermountain Healthcare
LDS Hospital
Fluoro Room 2 Remodel

8th Ave., C Street
Salt Lake City, UT 84143

NJRA Project # 22246.00
Bid Set Jan 30, 2023
1 Addendum 01 Feb. 17, 2023

Floor Plan
Lower Level

A112

2/15/2023 3:11:10 PM

1 Floor Plan Lower Level
SCALE: 1/4" = 1'-0"

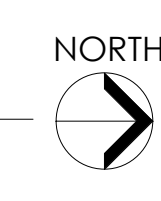

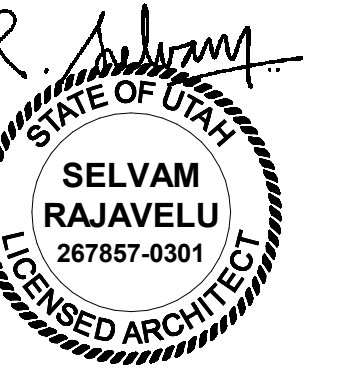

KEYED NOTES

- 01.59 AS PART OF THE BASE BID INCLUDE NEW CIRCUITRY FOR THE NEW ELECTRICAL DISCONNECT, ~~AS PART OF ADD ALTERNATE #2 DEMO EXISTING CONDUIT RUN TO ELECTRICAL CLOSET AND INCLUDE NEW CONDUIT TO~~ ~~ADDITIONAL NEW CIRCUITRY (CIRCUITRY INCLUDED IN BASE BID)~~ ~~CONDUIT REPLACEMENT MUST BE PERFORMED USING CONTAINMENT CART PROVIDED BY OWNER AND IN ACCORDANCE WITH OWNER'S INFECTION CONTROL GUIDELINES. CONDUIT REPLACEMENT AS PART OF ADD ALTERNATE #2 MUST BE PERFORMED ON WEEKENDS. COORDINATE AND SCHEDULE WEEKEND WORK HOURS WITH OWNER'S FACILITY MANAGER. SEE ELECTRICAL DRAWINGS.~~
- 05.18 X-RAY UNIT MOUNTING PLATE, O.F.C.I. SEE VENDOR (G.E.) DRAWINGS FOR INSTALLATION REQUIREMENTS. SEE 11/A553A-12/A553A FOR THROUGH BOLT ATTACHMENT DETAIL. IF ANCHOR OCCURS AT STRUCTURE BELOW CHIP OUT CONCRETE SUFFICIENT ENOUGH TO WELD ANCHOR DIRECTLY TO STRUCTURE. PATCH RESULTANT HOLE WITH HIGH PRESSURE GROUT.
- 06.18 ADD ALT. #1: CABINET AND COUNTERTOP WITH SINK, O.F.C.I.
- 09.20 FLOOR COVERING, O.F.C.I. PATCH FLOOR COVERING AT SINK. COVE BASE AT SINK TO MATCH EXISTING.
- 09.21 FLOOR COVERINGS, O.F.C.I. PATCH FLOOR COVERING AS REQUIRED. COVE BASE AT WALLS TO MATCH EXISTING AS REQUIRED.
- 22.19 ADD ALT. #1: LAVATORY (SINK), O.F.C.I. CONNECT LAVATORY TO EXISTING PLUMBING SUPPLY AND DRAIN.
- 26.24 X-RAY UNIT TRANSFORMER OR GENERATOR, O.F.C.I. CONTRACTOR TO MAKE FINAL ELECTRICAL CONNECTIONS. COORDINATE WITH OWNER AND OWNER'S EQUIPMENT VENDOR (G.E.) SEE VENDOR (G.E.) DRAWINGS FOR FINAL CONNECTION DETAILS. SEE ELECTRICAL DRAWINGS.

GENERAL NOTES

A. SEE SHEET G003 AND G005 FOR SYMBOLS, GENERAL NOTES AND LEGEND.

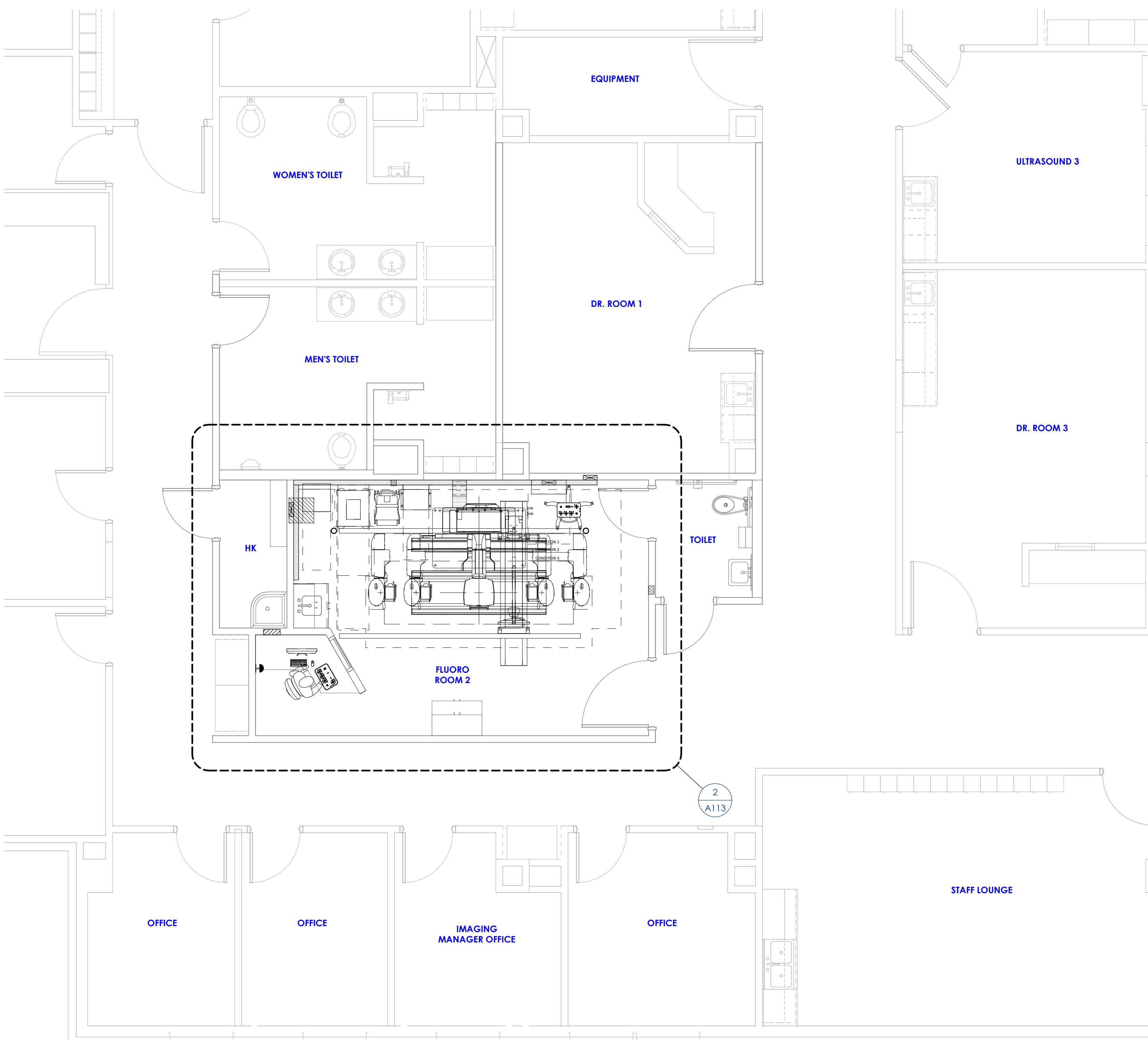

1 Floor Plan Level 1
SCALE: 1/4" = 1'-0"

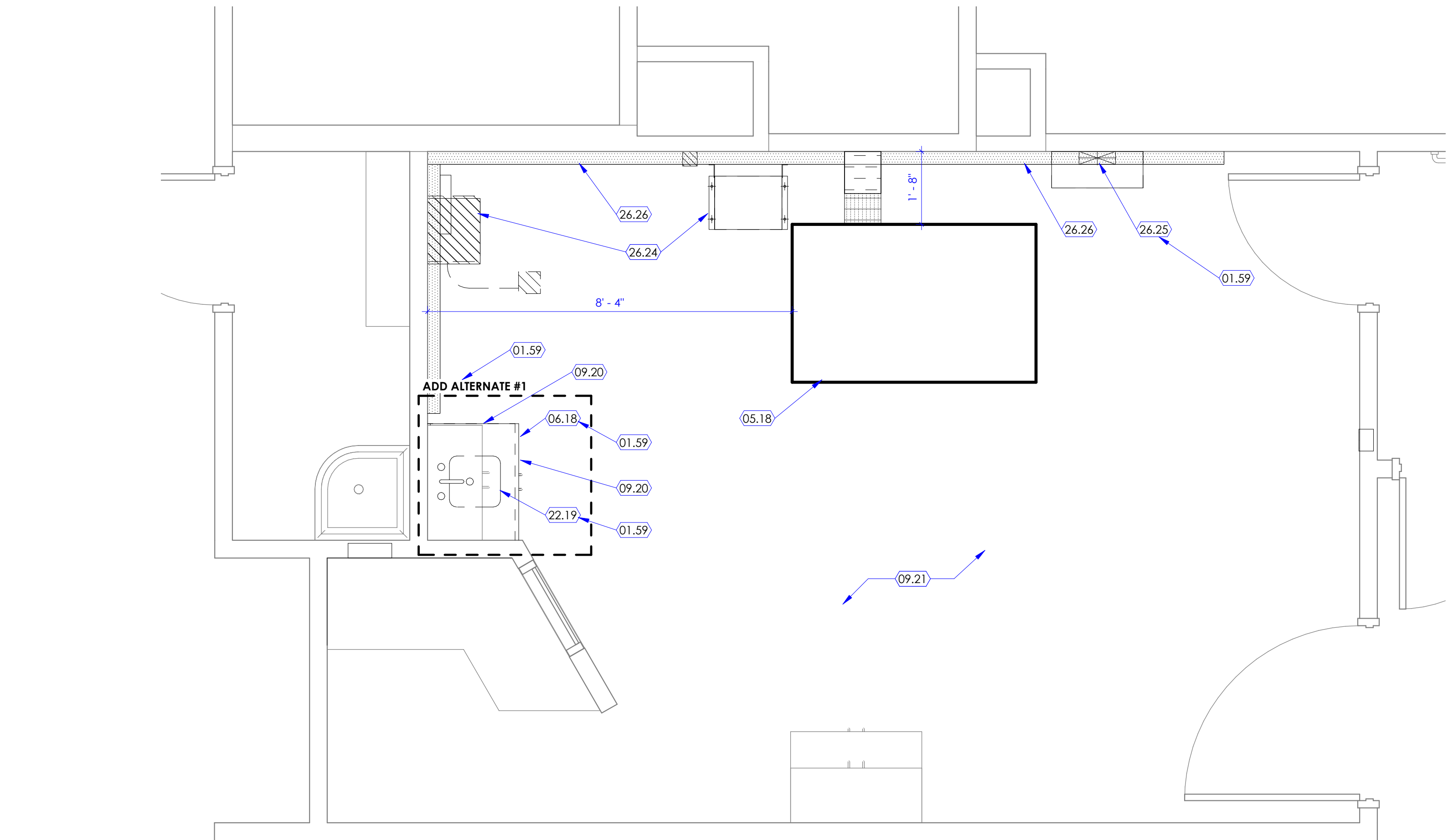
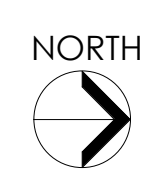

2 Fluoro Room 2
SCALE: 1/2" = 1'-0"

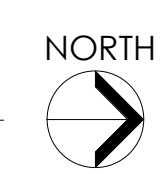

Intermountain Healthcare
LDS Hospital
Fluoro Room 2 Remodel

8th Ave., C Street
Salt Lake City, UT 84143

NJRA Project # 22246.00
Bid Set Jan 30, 2023
1 Addendum 01 Feb. 17, 2023

Floor Plan Level 1

A113

2/15/2023 4:06:16 PM