



## ADDENDUM 02

DATE 09.13.22  
PROJECT NO. 2141  
PROJECT LOGAN FAMILYSEARCH CENTER REMODEL  
FROM STUDIO 333 ARCHITECTS

COMPANY NAME	ADDRESS	PHONE	EMAIL
PAINTER BUILDING	12153 S. 4065 W. RIVERTON, UT 84095 125 W. 2500 N.	801.446.8054	matt@painterconstruction.com
RAYMOND CONSTRUCTION	LOGAN, UT 84341 1601 N. 750 W.	435.752.2911	doug@raymondconst.com
SAUNDERS CONSTRUCTION	OGDEN, UT 84404 PO BOX 1458	801.782.7830	saunderscoinc@yahoo.com sbradley@wadman.com
WADMAN CONSTRUCTION	OGDEN, UT 84402	801.621.4185	bmartin@wadman.com

*This Addendum forms a part of the Contract Documents and modifies the original Bidding Documents dated 08.16.22 as noted below. Acknowledge receipt of this Addendum in the space provided on the Bid Form. Failure to do so may subject the Bidder to disqualification.*

*This Addendum consists of 1 page and the attached Drawing Sheets E0.3, E4.31, E5.31, E5.32, E5.33, E6.31 and E1.31.*

**A. Bid Date Change:**

1. The bid due date has been changed to Thursday, September 15, 2022, at 3:00 PM. You should already have received a Conslog Invitation for this revised date.

**B. Changes to drawings:**

1. Sheets E0.3, E4.31, E5.31, E5.32, E5.33, and E6.31:
  - a. Add these sheets, describing the data design, to the drawing set.
2. Sheet E6.11:
  - a. The Blackjack track system is an approved alternate to the Axis Stencilflex system.
3. Sheet E1.31:
  - a. Add this sheet, which adds data jacks throughout the facility, to the drawing set. Ignore the clouded symbols--all work on this sheet is new.

End of Addendum

### EQUIPMENT/CABLE LIST

THE ITEMS INDICATED BELOW SHALL NOT BE CONSTRUED AS A "BILL OF MATERIALS". THIS LIST IDENTIFIES ITEMS OF SIGNIFICANCE USED DURING THE DESIGN OF THE CABLING INSTALLATION. WHERE THE ITEMS INDICATED ARE ONE PORTION OF AN ASSEMBLY, THE ENTIRE ASSEMBLY SHALL BE PROVIDED UNLESS SPECIFIED OTHERWISE. PROVIDE ALL MISCELLANEOUS HARDWARE AND SUPPORTS WHICH MAY NOT BE LISTED HERE. FOR A COMPLETE INSTALLATION, COMPARE CATALOG NUMBERS WITH DESCRIPTIONS AND NOTIFY ENGINEER OF DISCREPANCIES PRIOR TO BID. IF CATALOG NUMBERS DO NOT MATCH DESCRIPTIONS, THE DESCRIPTIONS TAKE PRECEDENCE. PROVIDE COMPLETE SUBMITTAL FOR APPROVAL PRIOR TO PURCHASING ANY EQUIPMENT OR CABLE. REFER TO SPECIFICATIONS FOR ADDITIONAL REQUIREMENTS.

SYMBOL	ITEM DESCRIPTION	ACCEPTABLE TYPES
	STATION CABLE, DATA - CATEGORY 6 PLENUM, BLUE, DATA	PANDUIT, COMMSCOPE, BELDEN
	STATION CABLE, DATA - CATEGORY 6A PLENUM, WIRELESS, DATA	PANDUIT, COMMSCOPE, BELDEN
F	DATA OUTLET, FURNITURE FACEPLATE, BLACK, 3 POSITION	PANDUIT, COMMSCOPE, BELDEN
▼	CATEGORY 6 JACK - DATA, WHITE	PANDUIT, COMMSCOPE, BELDEN
	BLANK INSERT - DATA, BLACK	PANDUIT, COMMSCOPE, BELDEN
2	DATA OUTLET, SINGLE GANG FACEPLATE, WHITE, 2 POSITION (A=ABOVE COUNTER)	PANDUIT, COMMSCOPE, BELDEN
2	CATEGORY 6 JACK - DATA, WHITE	PANDUIT, COMMSCOPE, BELDEN
4	DATA OUTLET, SINGLE GANG FACEPLATE, WHITE, 4 POSITION	PANDUIT, COMMSCOPE, BELDEN
4	CATEGORY 6 JACK - DATA, GREEN	PANDUIT, COMMSCOPE, BELDEN
(C)	DATA OUTLET, RJ-45 PRE-TERMINATED PLUG OR FIELD TERM RJ45	PANDUIT, COMMSCOPE, BELDEN
[SPP1]	STATION PATCH PANEL, 48-PORT, BLACK, 1RU	PANDUIT, COMMSCOPE, BELDEN
	CATEGORY 6 JACK - DATA, BLACK	PANDUIT, COMMSCOPE, BELDEN
	CATEGORY 6A JACK - WIRELESS, BLUE	PANDUIT, COMMSCOPE, BELDEN
[HWM]	HORIZONTAL WIRE MANAGER, BLACK, 1RU, FRONT ONLY	PANDUIT NMF1
[ ]	WALL MOUNT CABINET, LOCKABLE, 18RU, BLACK	MIDDLE ATLANTIC CWR-18-22SD
[ ]	CABLE RUNWAY, 12", BLACK W/ ALL REQUIRED MOUNTING ACCESSORIES	CHATSWORTH OR APPROVED EQUAL
	WALL ANGLE KIT, 12", BLACK	CHATSWORTH OR APPROVED EQUAL
	JUNCTION SPLICE KIT, BLACK	CHATSWORTH OR APPROVED EQUAL
	CORNER CLAMP KIT, BLACK	CHATSWORTH OR APPROVED EQUAL
	CABLE RUNWAY MOUNTING BRACKET	CHATSWORTH OR APPROVED EQUAL
	END CLOSING KIT, CABLE RUNWAY, BLACK	CHATSWORTH OR APPROVED EQUAL
[ ]	PLYWOOD BACKBOARD, 4x8', GRADE A, FIRE-TREATED & PAINTED	CHATSWORTH OR APPROVED EQUAL
[ ]	TELECOMMUNICATIONS MAIN GROUNDING BUS BAR	

NOTE: ALL RACKS, LADDER, PATCH PANELS AND ACCESSORIES SHALL BE BLACK IN COLOR.

### GENERAL PROJECT NOTES

- UNLESS OTHERWISE NOTED, INSTALL ALL CABLE INSIDE RACEWAY SYSTEMS. WHERE RACEWAY SYSTEMS HAVE NOT BEEN PROVIDED OR SPECIFIED, INSTALL CABLE THROUGH THE SPECIFIED "CADDY" CLIPS AT THE MINIMUM INTERVALS IDENTIFIED IN THE SPECIFICATIONS. SUPPORT "CADDY" CLIPS DIRECTLY FROM THE BUILDING STRUCTURE, NOT FROM OTHER BUILDING SYSTEM SUPPORT WIRES OR CABLE.
- PROVIDE APPROPRIATELY RATED CABLE FOR ALL INSTALLATIONS. I.E. PLENUM IN PLENUM RATED SPACES OUTDOOR RATED CABLE MUST BE USED FOR OUTDOOR INSTALLATIONS.
- LABEL ALL CABLE INSTALLED UNDER THIS CONTRACT REGARDLESS OF LENGTH, ACCORDING TO WRITTEN SPECIFICATION.
- THE EQUIPMENT LABELING IDENTIFIED ON DETAILS IN THESE DRAWINGS ARE EXAMPLES ONLY OF THE ACTUAL LABELING WHICH IS REQUIRED AS PART OF THIS CONTRACT. PRIOR TO FABRICATION, SUBMIT THE NOMENCLATURE FOR ALL LABELS TO THE OWNER FOR REVIEW. THIS REQUIREMENT INCLUDES BUT IS NOT LIMITED TO ALL CABLE LABELING, AND ALL EQUIPMENT LABELING.
- GROUND ALL EQUIPMENT RACKS LADDER RACK, AND EQUIPMENT INSTALLED UNDER THIS CONTRACT IN COMPLIANCE WITH THE CONTRACT DOCUMENTS AND WRITTEN SPECIFICATION.
- PROVIDE THE QUANTITY OF PATCH PANELS REQUIRED +20% FOR THE TOTAL VOICE AND DATA OUTLETS SHOWN ON FLOOR PLANS FOR THE PARTICULAR LEVEL.
- COORDINATE WITH OWNER I.T. PERSONNEL ON RACK PATCH PANEL DENSITY PRIOR TO ANY CABLE TERMINATION.
- CABLES SHALL BE COILED IN IN-WALL OR SURFACE MOUNT BOXES IF ADEQUATE SPACE IS PRESENT TO HOUSE CABLE COIL WITHOUT EXCEEDING MANUFACTURER'S BEND RADIUS. NO MORE THAN 12" OF UTP SLACK SHALL BE STORED IN IN-WALL BOX, MODULAR FURNITURE RACEWAY, OR INSULATED WALLS.
- EACH HORIZONTAL CABLE SHALL HAVE 10 FEET OF SERVICE LOOP NEATLY COILED AND SECURED WITH VELCRO AT THE MD/FIDF LOCATIONS. IT SHALL BE SUPPORTED BY LADDER RACK OR APPROPRIATE CABLE SUPPORTS.
- MANUFACTURER COMPONENTS CANNOT BE INTERCHANGED (I.E., IF A PANDUIT SOLUTION IS INSTALLED, ALL PRODUCTS MUST BE PANDUIT).

### OUTLET COLOR SCHEDULE

COLOR	TYPE
WHITE/BLACK	DATA
BLUE	WIRELESS

### COPPER PATCH CORD SCHEDULE (CATEGORY 6 CABLES W/ RJ-45 CONNECTORS)

LENGTH (FEET)	COLOR	QUANTITY	UNIT COST (EACH)
7'	BLACK	1 PER CABLE	-
10'	BLACK	10	-
15'	BLACK	10	-

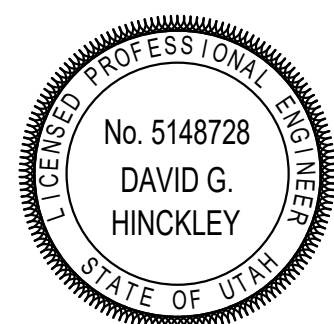

NO.	DATE	DESCRIPTION
02	09.13.22	ADD 02

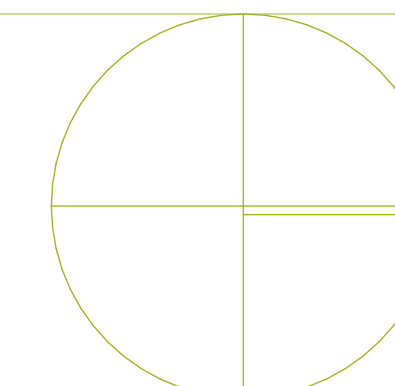

GENERAL SHEET NC

- EXISTING FIRE ALARM PANEL IS A NOTIFIER FIREWARDEN-100. PROVIDE ALL PARTS AND PROGRAMMING NECESSARY TO MAKE NEW DEVICES SHOWN OPERATIONAL ON EXISTING SYSTEM.

SHEET KEYNOTES

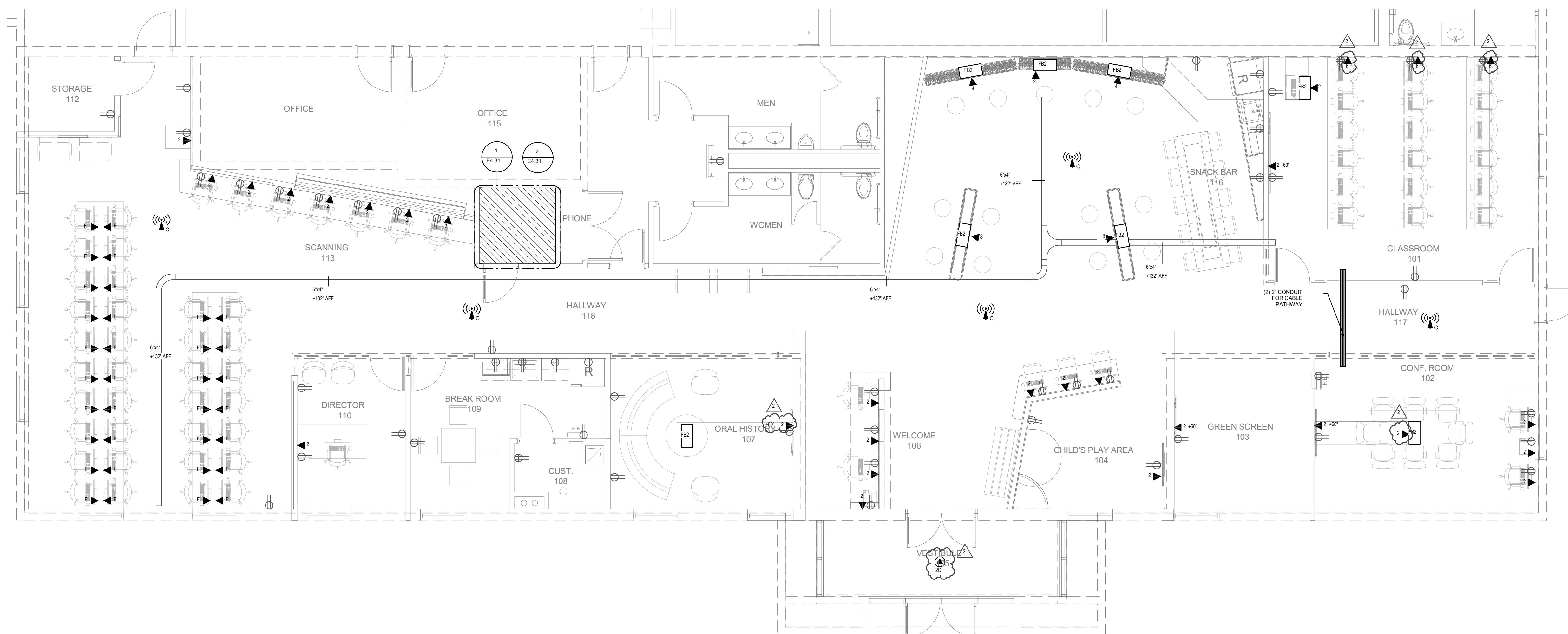

1 1ST LEVEL TELECOM PLAN  
SCALE: 3/16" = 1'-0"

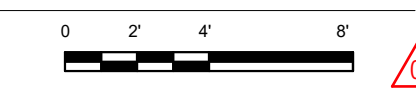

**STUDIO 333 ARCHITECTS**  
333 24TH STREET  
OGDEN, UT 84401  
801.394.3033

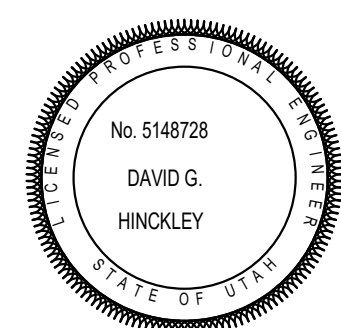

**LOGAN FAMILYSEARCH CENTER REMODEL**  
165 EAST 2200 NORTH, LOGAN, UTAH



324 S. State St., Suite 400  
Salt Lake City, UT 84111  
801-576-7077  
801-528-5151  
fax: 801-528-5155  
www.spectrum-engineers.com

NO.	DATE	DESCRIPTION
02	09.13.22	ADD 02

PERMIT SET  
DATE: 08.26.22  
PROJECT NUMBER: 2141  
PROPERTY NUMBER: 594-2217

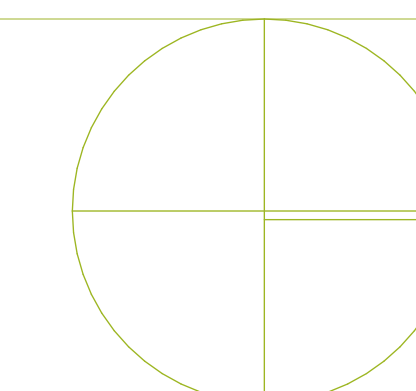



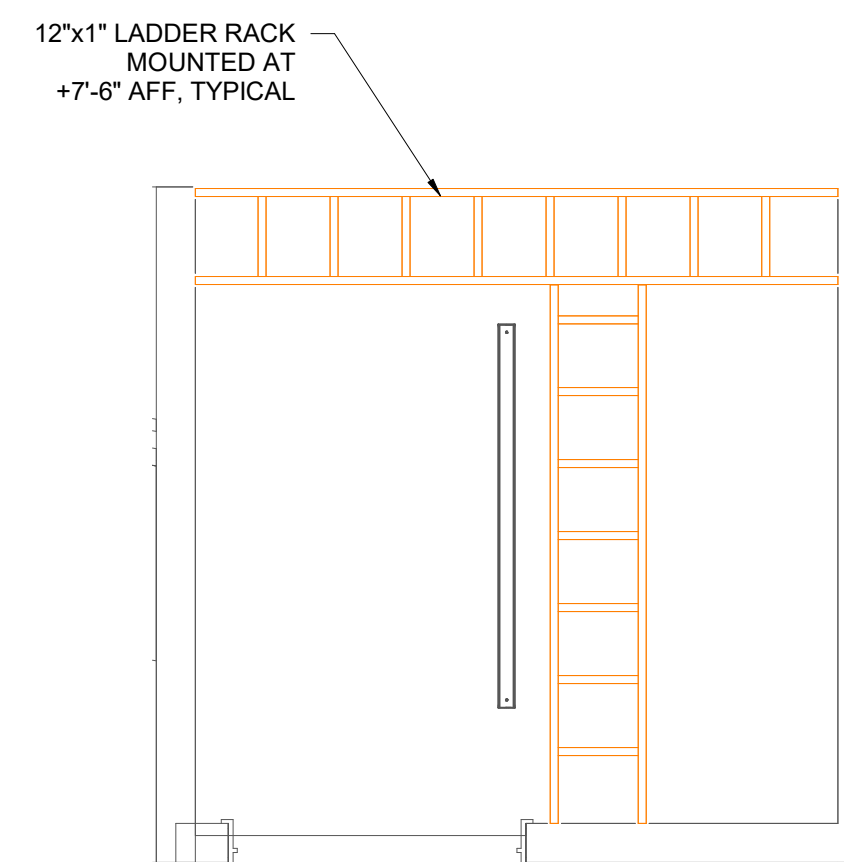

2 ENLARGED LEVEL 1 DATA 114  
LADDER RACK PLAN  
SCALE: 1/2" = 1'-0"

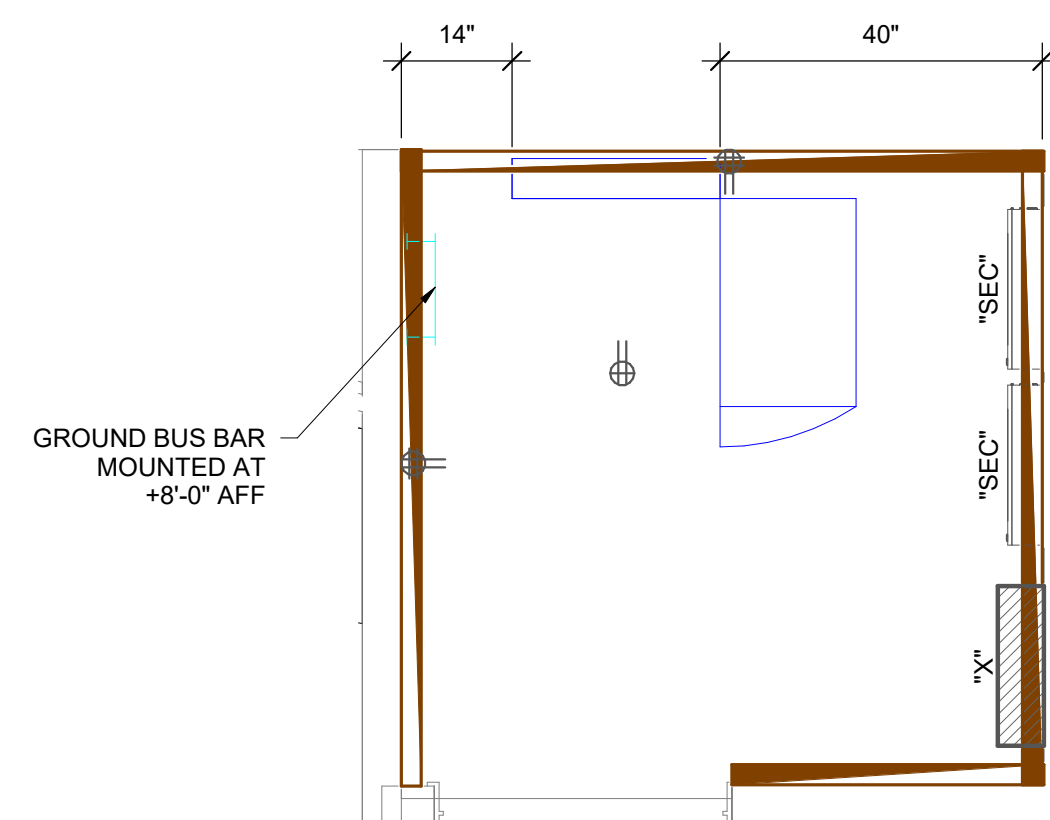

1 ENLARGED LEVEL 1 DATA 114  
EQUIPMENT RACK PLAN  
SCALE: 1/2" = 1'-0"

NO.	DATE	DESCRIPTION
02	09.13.22	ADD 02

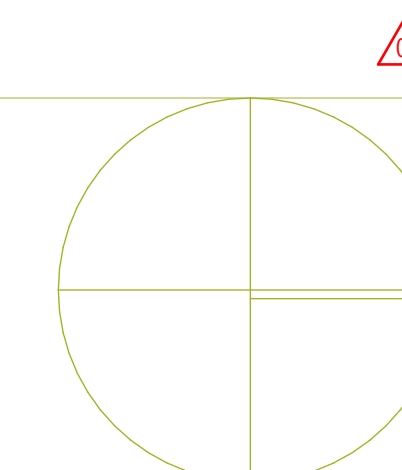

DATA DEVICE DROP SCHEDULE - DATA 114				
DATA DEVICE TYPE	DETAIL LOCATION	COMM ROOM LOCATION	TOTAL BY FLOOR	Num of Drops
1ST LEVEL				
CEILING WIRELESS ACCESS POINT (2-DROP)		DATA 114	5	10
FLOOR DATA (2-DROP)	SEE DETAIL 2/ E5.32	DATA 114	2	0
FLOOR DATA (4-DROP)	SEE DETAIL 3/E5.32	DATA 114	4	0
FURNITURE DATA (1-DROP)	SEE DETAIL 1/E5.32	DATA 114	34	34
WALL DROP (2-DROP)	SEE DETAIL 2/ E5.32	DATA 114	23	46
<b>Grand total</b>			<b>68</b>	<b>90</b>

WALL DATA CABINET"

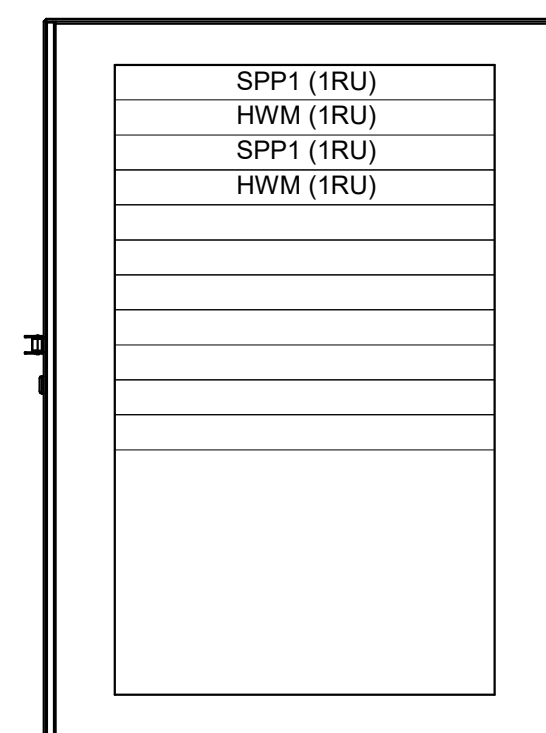

DATA WALL MOUNT CABINET, 18RU

NOTE:  
COORDINATE FINAL RACK ELEVATIONS WITH LDS CHURCH IT STAFF.

1 TELECOM RACK ELEVATION, LEVEL 1 DATA 114  
SCALE: 1/8" = 1'-0"

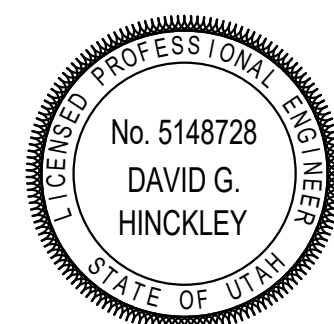

NO.	DATE	DESCRIPTION
02	09.13.22	ADD 02

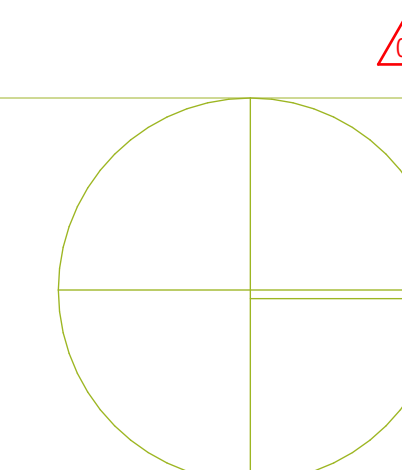

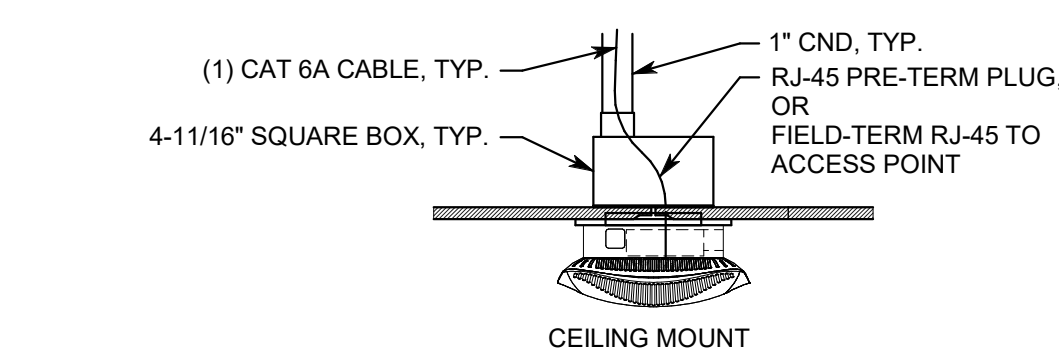

7 TYPICAL WIRELESS ACCESS POINT CEILING MOUNT DETAIL  
SCALE: NTS

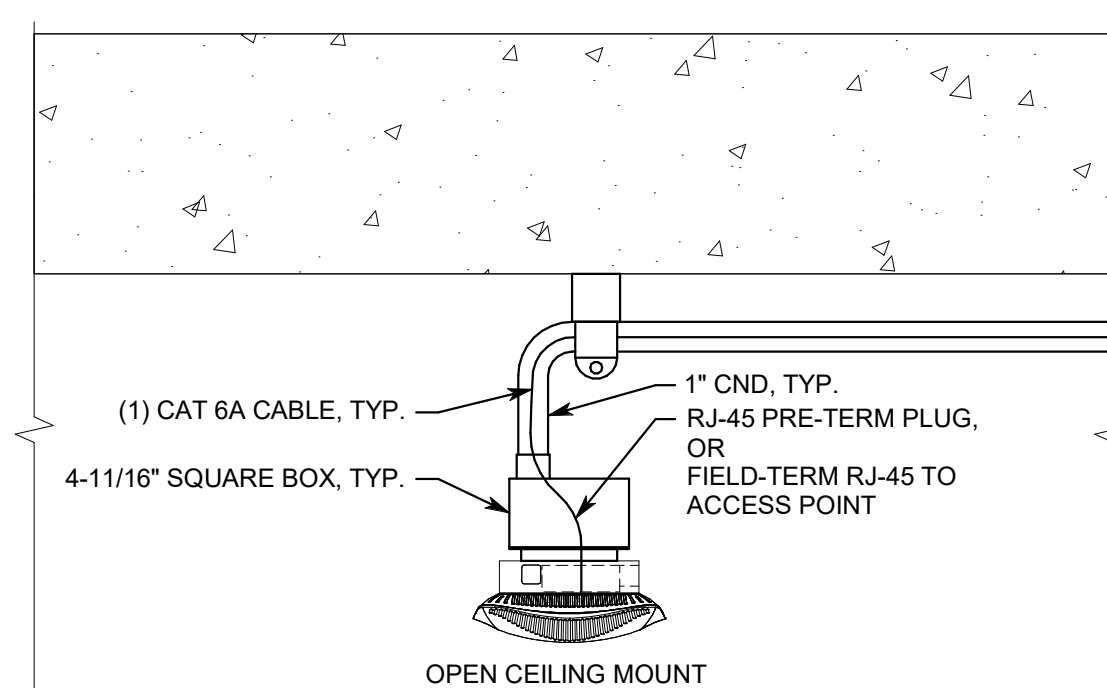

6 TYPICAL WIRELESS ACCESS POINT OPEN CEILING DETAIL  
SCALE: NTS

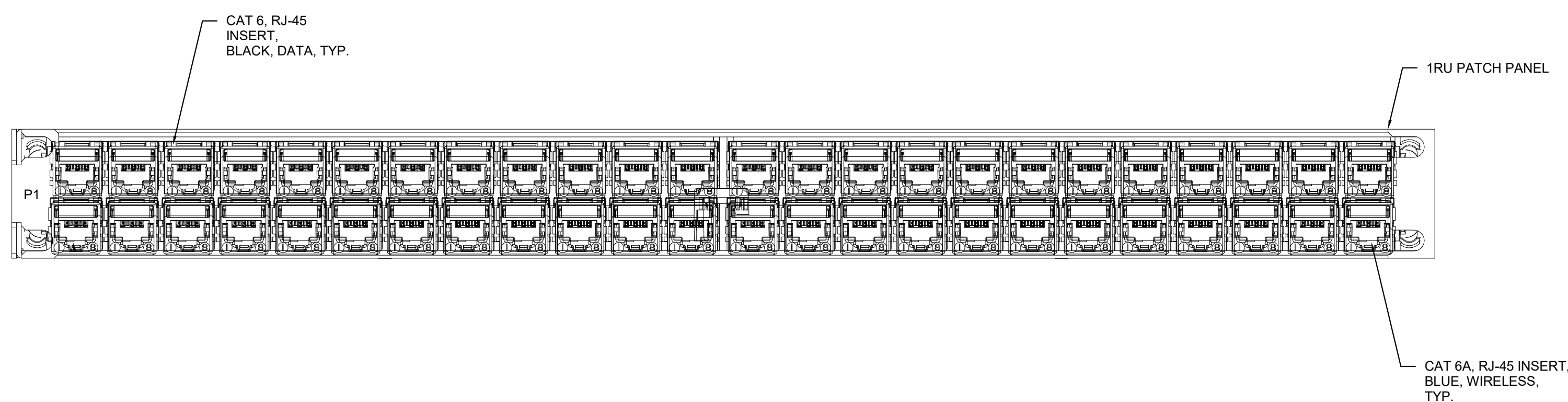

5 STATION PATCH PANEL DETAIL, SPP1  
SCALE: NTS

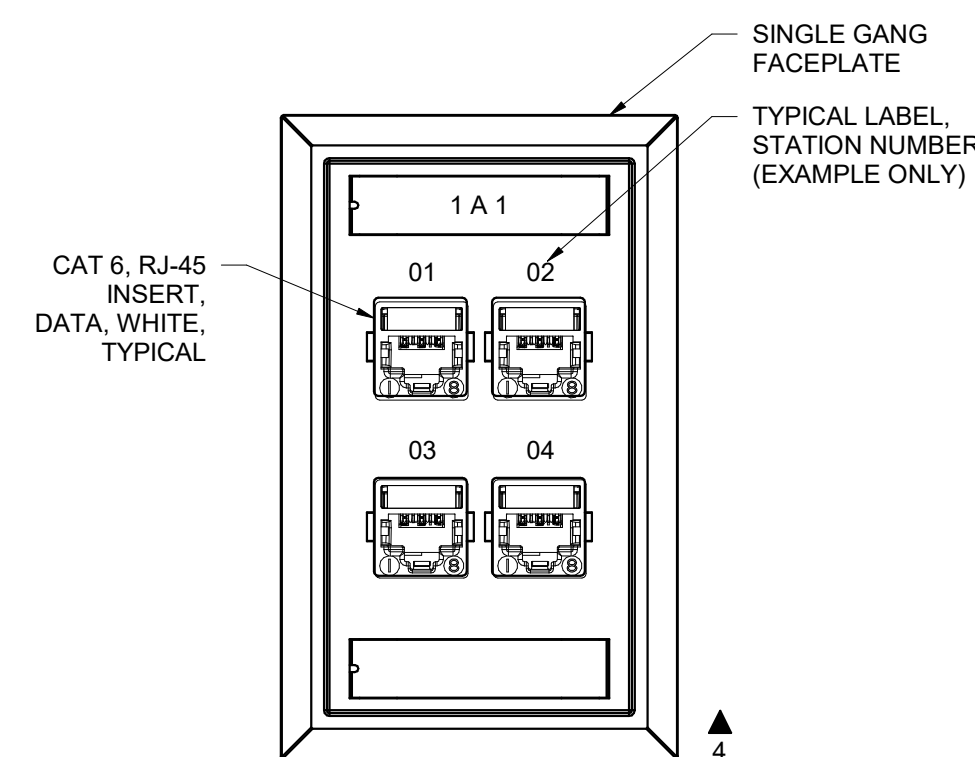

3 TYPICAL 4-DROP WALL DATA DETAIL  
SCALE: NTS

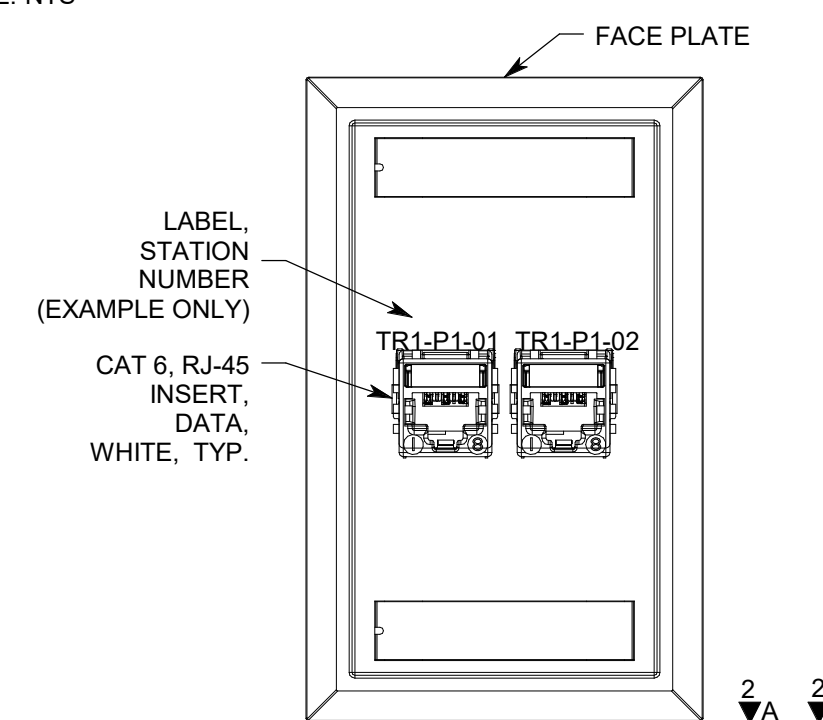

2 TYPICAL 2-DROP WALL DATA OUTLET DETAIL  
SCALE: NTS

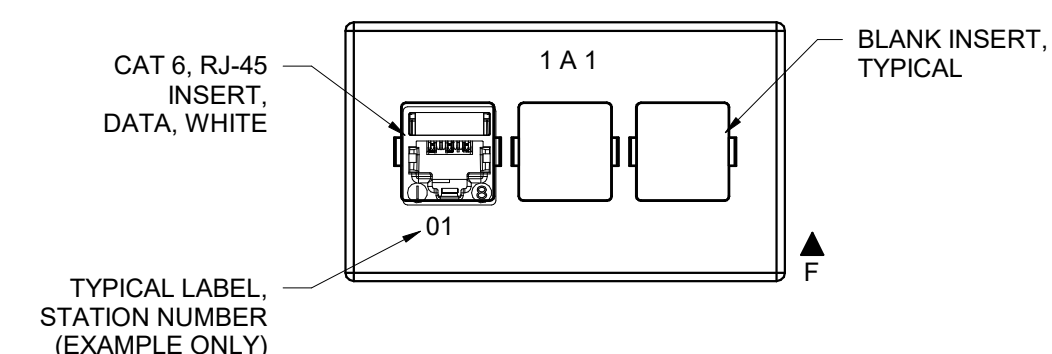

1 TYPICAL 1-DROP FURNITURE DATA DETAIL  
SCALE: NTS

NO.	DATE	DESCRIPTION
02	09.13.22	ADD 02

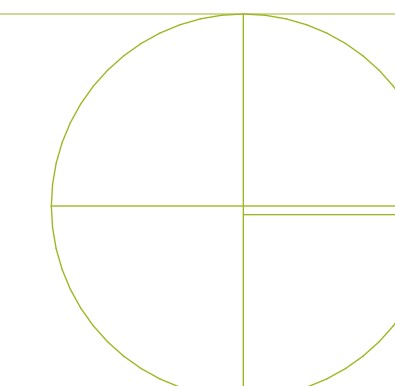



**GENERAL NOTES:**

1. ALL LOW VOLTAGE COMMUNICATIONS CONDUIT SHALL BE GROUNDED TO BASKET TRAY OR TELECOMMUNICATIONS GROUNDING BUS BAR.
2. "TMGB" SHOULD BE 1/4"x4"x24".
3. "TGB" SHOULD BE 1/4"x2"x24".
4. EMT CONDUIT GROUNDING CLAMP SHOULD BE ELECTROLYTIC CAST BRONZE (PANDUIT PART NUMBER GPL-X-X-X, OR EQUAL).
5. RIGID CONDUIT GROUND CLAMP SHOULD BE PART NUMBER O-Z/GEDNEY BLG-XXXX, OR HBLG-XXXX, OR EQUAL.
6. GROUNDING LUGS SHOULD BE TWO-HOLE LONG BARREL LUGS (PANDUIT PART NUMBER LCC6, OR EQUAL).

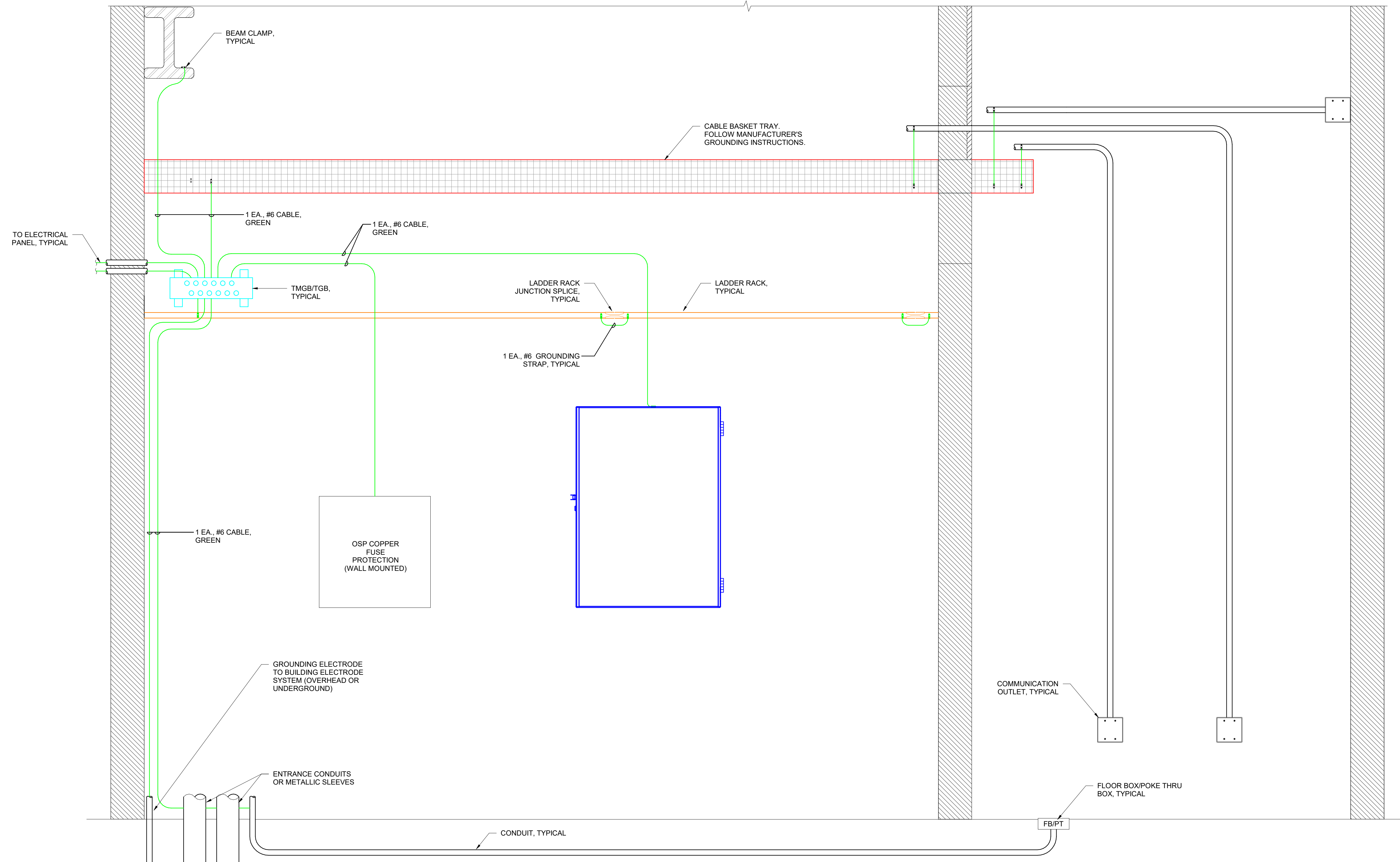

**1** TYPICAL TELECOM EQUIPMENT RACK GROUNDING DETAIL  
SCALE: 1/8" = 1'-0"

STUDIO 333 ARCHITECTS  
333 24TH STREET  
OGDEN, UT 84401  
801.394.3033



LOGAN FAMILYSEARCH CENTER REMODEL  
165 EAST 2200 NORTH, LOGAN, UTAH



324 S. State St., Suite 400  
Salt Lake City, UT 84111  
800-678-7077  
801-328-5151  
fax: 801-328-5155  
www.spectrum-engineers.com

NO.	DATE	DESCRIPTION
02	09.13.22	ADD 02

PERMIT SET  
DATE: 08.26.22  
PROJECT NUMBER: 2141  
PROPERTY NUMBER: 594-2217

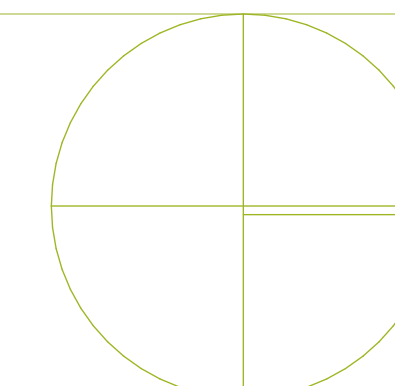

TELECOM EQUIPMENT  
RACK GROUNDING DETAIL

E5.33

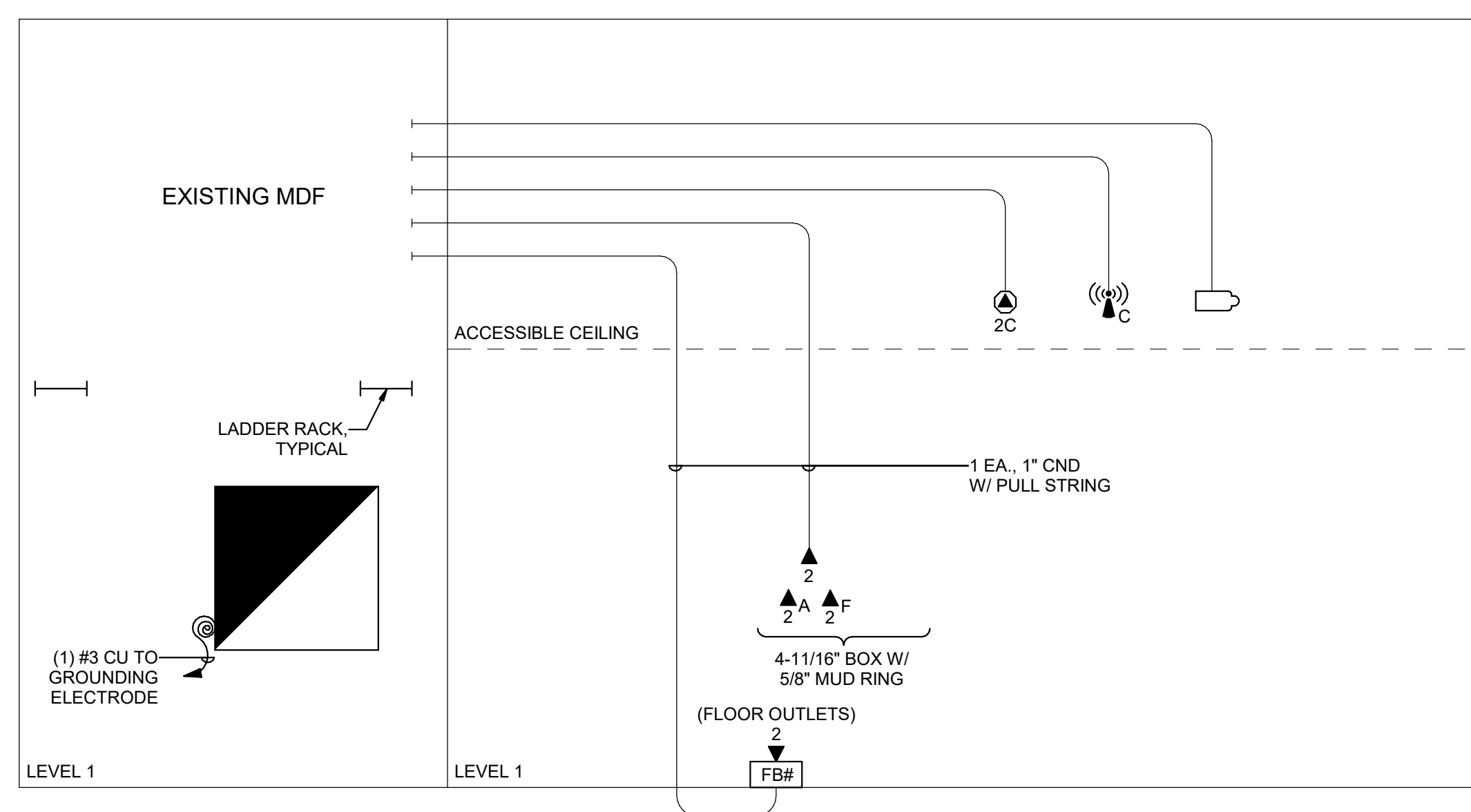
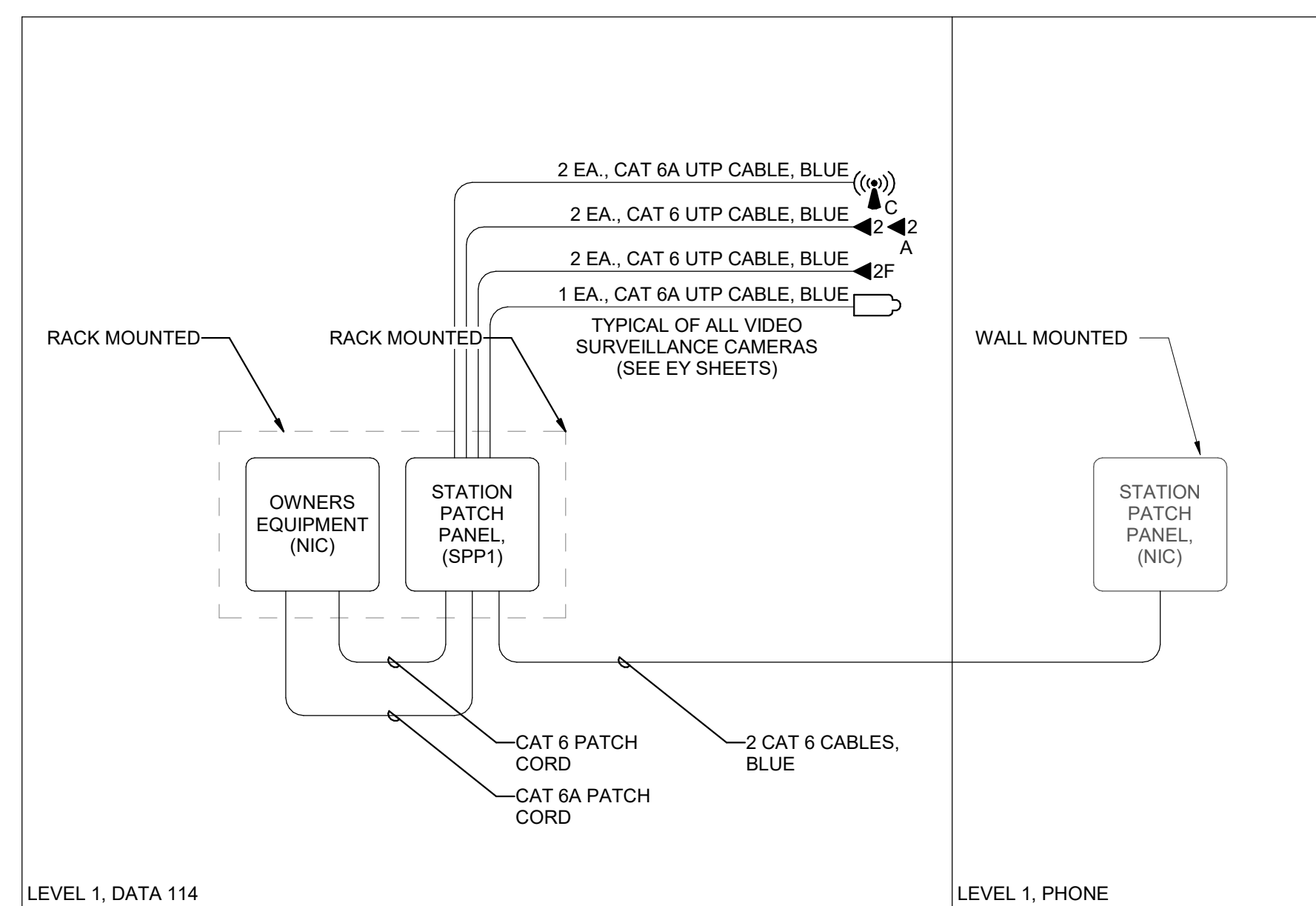

2 TELECOM CABLE RISER DIAGRAM  
 SCALE: 1/8" = 1'-0"

1 TELECOM CONDUIT RISER DIAGRAM  
 SCALE: NTS

NO.	DATE	DESCRIPTION
02	09.13.22	ADD 02

