



Reliant Inserter Feeder (Inserter Series)

Overview

The Reliant Inserter Feeder is designed for swing-arm inserters. It combines flexible performance with superior feeding capabilities to precisely separate, singulate, and present many types of mail inserts to the gripper jaw of swing arm inserters at speeds up to 14,000 per hour. Job setups and changeovers are easily and quickly accomplished via tool-less adjust features. A large capacity hopper is designed to be loaded from the front or rear of the machine maximizing operator efficiency. The brushless and clutch free motor provides long, dependable performance and the feeder is backed by a two-year limited warranty.

Also, the feeder can run continuously on inkjet and tabber bases by simply repositioning the sensor out of the product path.

Standard Features

- Long-lasting natural gum rubber feed belts
- Independent side guide positioning
- Self-adjusting discharge hold down
- Patented product separator
- High-performance photo sensor with tool-less adjust
- Suction cup mounting to the rear inserter table
- Material control springs to keep products in position at the jaw
- Small product insert plate

Applications (ask us about your application)

- 6x9 Swing-arm Inserters Tabbers
- Inkjet Systems Laminators

Products (ask us about your products)

- Sheet Paper C-Folds Z-Folds
- Manuals Business Cards Payment Booklets
- Cardstock Envelopes Plastic Cards
- Post Cards Brochures and more...

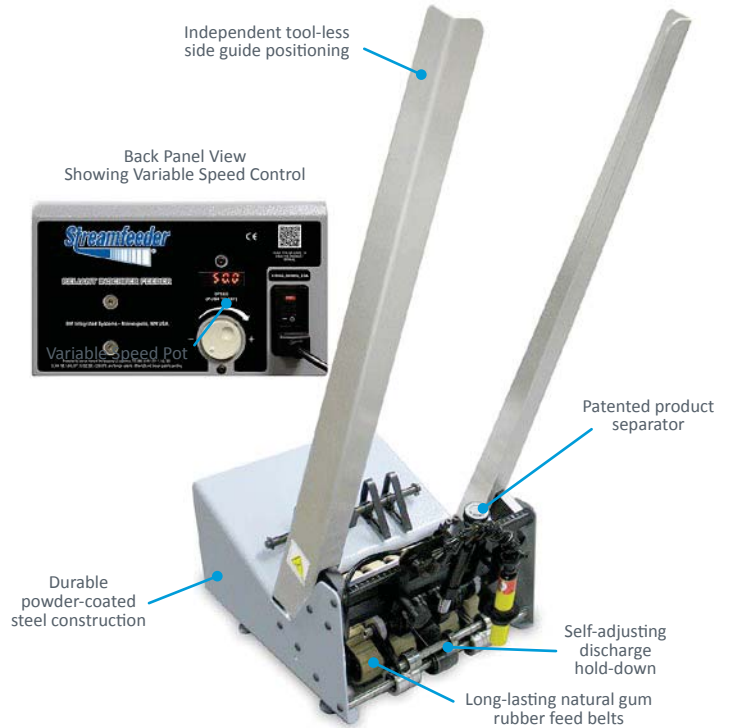

Specifications

Maximum Product Size	9.25 W x 6 L in (235 x 152 mm)
Minimum Product Size	2.125 W x 2.25 L in (54 x 57 mm)
Min/Max Product Thickness	.003 - .250 in (.076 - 6.35 mm)
Belt Speed	1330 in/min (33.78 m/min)
Utilities	115 or 230vac, 60/50Hz, 2.5A
Weight	Only 19 lbs. (8.62 kg)
Warranty	Two year limited

[Other sizes and thickness capabilities available. Contact us for your application.](#)

Footprint drawing available at:
www.streamfeeder.com/footprints.html
or scan the QR Code



AUTOMATED EQUIPMENT SERVICE, INC.

MAIL PROCESSING SYSTEMS

(845) 452-2100 (518) 459-4545

(914) 478-2100 (607) 733-2108

info@AESMailPro.com