



RESTAURANT EQUIPMENT HAWAII



CABINET CONSTRUCTION

HEAVY-DUTY BLACK COATED STEEL EXTERIOR WITH A 304 TYPE STAINLESS STEEL INTERIOR FEATURES COVED CORNERS FOR EASY CLEAN-UP. SELF-CLOSING, SOLID DOORS COME STANDARD WITH LOCKS TO PROTECT CONTENTS INSIDE. DURABLE, 1 1/2" THICK STAINLESS STEEL TOP FOR PREP AND DRINK SERVICE.

FOAMED-IN-PLACE CFC- AND HCFC-FREE POLYURETHANE INSULATION ENHANCES THE STRUCTURAL STRENGTH OF THE CABINET AND HELPS INCREASE ENERGY EFFICIENCY.

REFRIGERATION SYSTEM

ENVIRONMENTALLY SAFE R290 REFRIGERANT. SIDE-MOUNTED CONDENSING UNIT POSITIONED FOR EASY MAINTENANCE.

SHELVING

6 EPOXY-COATED STEEL SHELVES INCLUDED. EACH ACCOMMODATES UP TO 90 LB.

MODEL FEATURES

PREPROGRAMMED DIGITAL CONTROLLER FEATURES AUTO-DEFROST FUNCTION. LED LIGHTING ENSURES OPTIMAL PRODUCT VISIBILITY. ACCOMMODATES THREE 1/2 SIZE KEGS. NARROW DEPTH DESIGN MAKES THIS UNIT IDEAL FOR TIGHT BAR SPACES

SPECIAL FEATURES

- ECO-FRIENDLY R290 HYDROCARBON REFRIGERANT
- SLEEK, BLACK COATED STEEL EXTERIOR WITH SOLID DOORS
- 304 TYPE STAINLESS STEEL INTERIOR WITH COVED CORNERS
- MAINTAINS TEMPERATURES FROM 33-40 F
- 6 EPOXY-COATED STEEL SHELVES ACCOMMODATE UP TO 90 LB. EACH
- ACCOMMODATES UP TO (3) 1/2 KEGS
- FOAMED-IN-PLACE POLYURETHANE INSULATION
- BUILT-IN 1 1/2" STAINLESS STEEL TOP
- 115V; 1/4 HP
- STAINLESS STEEL INTERIOR IS **Food Rated**



WARRANTY
RESIDENTIAL REH ASSUMES NO LIABILITY FOR PARTS OR LABOR COVERAGE FOR COMPONENT FAILURE, FACTORY DEFECT OR ANY OTHER DAMAGES FOR UNITS INSTALLED IN NON-COMMERCIAL FOODSERVICE OR RESIDENTIAL APPLICATIONS.



PARTS & LABOR



COMPRESSOR



RESTAURANT EQUIPMENT HAWAII

QUALITY COMMERCIAL EQUIPMENT FOR
RESTAURANTS & BARS

VISIT OUR ONLINE STORE FOR PRICING & INFORMATION ON
EQUIPMENT, FOOD TRUCKS & OUR COMMISARY KITCHEN

808-845-5052

TECHNICAL DATA

DIMENSIONS

EXTERIOR DIMENSIONS	72 ³ / ₄ "W x 24 ⁷ / ₁₆ "D x 35 ⁵ / ₈ "H
INTERIOR DIMENSIONS	60 ¹ / ₈ "W x 18 ¹ / ₂ "D x 30 ¹ / ₂ "H
NET VOLUME	21.6 CU. FT.
NET WEIGHT	331 LB.
GROSS WEIGHT	374 LB.
PRODUCT CAPACITY	(3) 1/2 KEGS

COOLING

TEMPERATURE RANGE	33°F-40°F
REFRIGERANT	R290
MAX. AMBIENT TEMPERATURE	90°F
DEFROSTING	AUTOMATIC
TEMPERATURE CONTROLLER	DIGITAL
HORSEPOWER	1/4

CONSTRUCTION

EXTERIOR MATERIAL	BLACK COATED STEEL
INTERIOR MATERIAL	TYPE 304 STAINLESS STEEL
COUNTERTOP TYPE	TYPE 304 STAINLESS STEEL
SHELF SIZE	(4) 19" x 18 ¹ / ₄ " + (2) 20 ¹ / ₂ " x 18 ¹ / ₈ "
SHELF MATERIAL	EPOXY-COATED STEEL
SHELF LOAD CAPACITY	90 LB.

ELECTRICAL

VOLTAGE	115
AMPS	3.96
HZ	60
PHASE	1
PLUG TYPE	NEMA 5-15P
ELECTRICAL CORD LENGTH	106"

PLAN VIEW

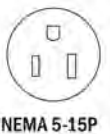
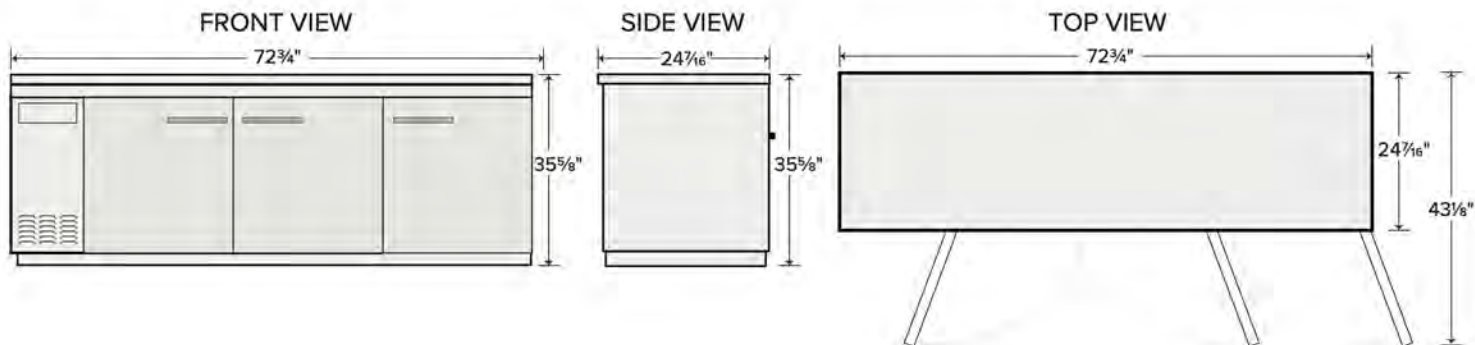

NEMA 5-15P