

hup!

The better way to build

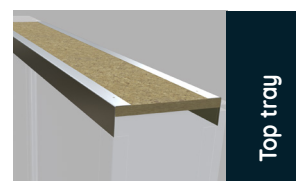

Top tray

Provides secure fixing and rapid connection with the Glass & Hybrid roofs.

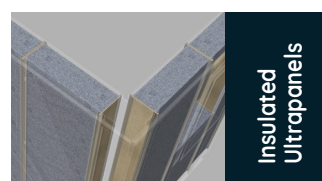

Insulated Ultrapanel

BBA approved technology with an energy efficient U-value of 0.17 that exceeds Building Regulations.



Aperture panel

Provides a strong and secure base for fixing to windows and doors.



Aperture shelf

Neatly lines the apertures for windows and doors.



Render board

Calcium silicate, A fire-rated, waterproof and BBA approved.

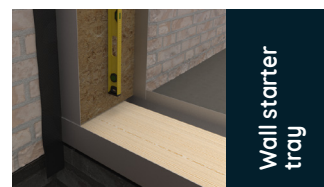

Wall starter tray

Creates a strong abutment connection to the host property.

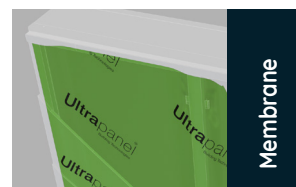

Membrane

BBA approved and breathable, this ensures hup! is watertight quickly to speed up the build process.



Membrane clips

Clip the membrane in place prior to the battens to ensure the building is watertight quickly.

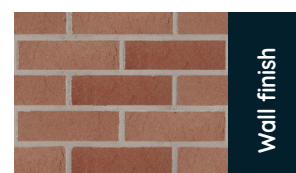

Wall finish

hup! is compatible with any wall finish e.g. render, brick mesh, or cedar providing the ultimate design flexibility.

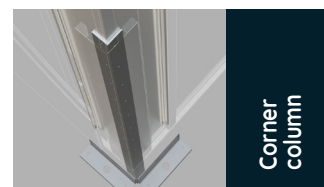

Corner column

Provides stability and structure at the corner to prevent lateral movement.

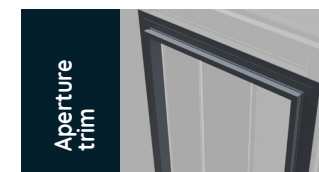

Aperture trim

Provides a neat and easy finish at windows and doors.



Timber battens

Cut to size, these provide ventilation behind wall finishes to ensure the hup! will stand the test of time.



Ultrapanel clips

Form a super strong i-beam structure that is almost twice as strong as a brick wall.



Ventilation trim

Prevents debris build-up and provides continuous ventilation.



Base tray

Provides a secure fix to the foundations. Cut to size like every component, to avoid any mess on site.



Watch the Information Video Here

hup! walls are designed to be used with any Ultraframe roofing system.



hup![®]

The better way to build

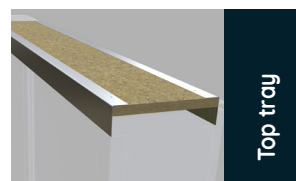

Top tray

Provides secure fixing and rapid connection with the Glass & Hybrid roofs.

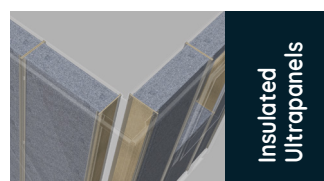

Insulated Ultrapanel

BBA approved technology with an energy efficient U-value of 0.17 that exceeds Building Regulations.

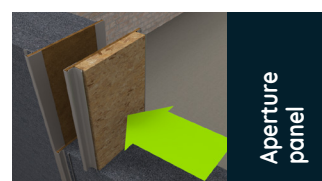

Aperture panel

Provides a strong and secure base for fixing to windows and doors.



Aperture shelf

Neatly lines the apertures for windows and doors.



Render board

Calcium silicate, A fire-rated, waterproof and BBA approved.

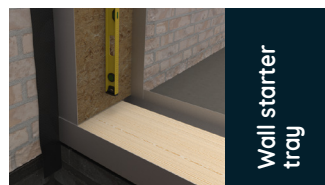

Wall starter tray

Creates a strong abutment connection to the host property.

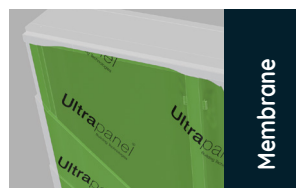

Membrane

BBA approved and breathable, this ensures hup! is watertight quickly to speed up the build process.



Membrane clips

Clip the membrane in place prior to the battens to ensure the building is watertight quickly.

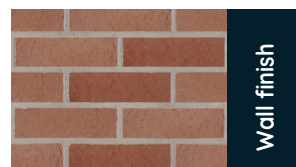

Wall finish

hup! is compatible with any wall finish e.g. render, brick mesh, or cedar providing the ultimate design flexibility.

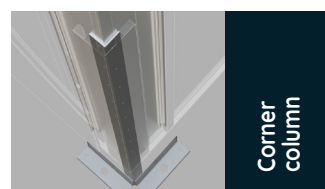

Corner column

Provides stability and structure at the corner to prevent lateral movement.

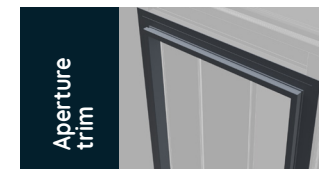

Aperture trim

Provides a neat and easy finish at windows and doors.

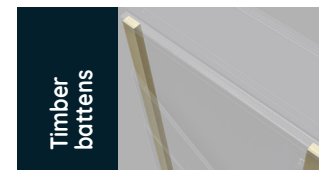

Timber battens

Cut to size, these provide ventilation behind wall finishes to ensure the hup! will stand the test of time.

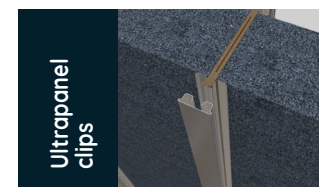

Ultrapanel clips

Form a super strong i-beam structure that is almost twice as strong as a brick wall.



Ventilation trim

Prevents debris build-up and provides continuous ventilation.



Base tray

Provides a secure fix to the foundations. Cut to size like every component, to avoid any mess on site.



Watch the Information Video Here

ADD LOGO HERE

hup! walls are designed to be used with any Ultraframe roofing system.

