

NOTE: Roof Panels need 3/4" per foot min. of drop to warrant against leaks

Drawings are drawn from outside looking in.

- Room Type:
- 2" Non Ins Screen Room
 - 2" Non Ins w Storm Windows
 - 2" Non Ins Eze-Breeze
 - 2" Ins Encl
 - 2" Ins Screen
 - 2" Ins Eze-Breeze
 - 4" Ins Encl

- Ins Wall Color:
- White
 - Tan

- Non Ins Wall Color:
- White
 - Tan
 - Clay
 - Bronze
 - Brown

- Door Types:
- Patio Slider 5 or 6
 - Full View Entry
 - Full Veiw Screen/Storm
 - PGT Cabana
 - PGT Ins

- Windows:
- Horizontal Sliders
 - Double Hung
 - Storm Hor Slider
 - Storm Triple Track
 - EzeBreeze
 - Sky Lights (On Ins Tops Only)

- Mount:
- On OverHang
 - Under OH
 - No OH

- Mount:
- On OverHang
 - Under OH
 - No OH

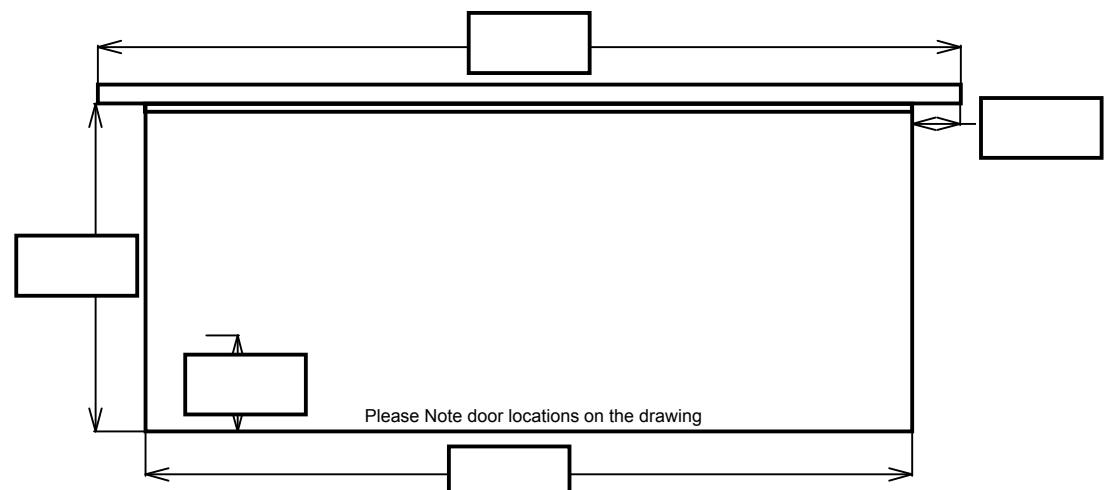

Front Elevation
SCALE 1/4" 1'-0"

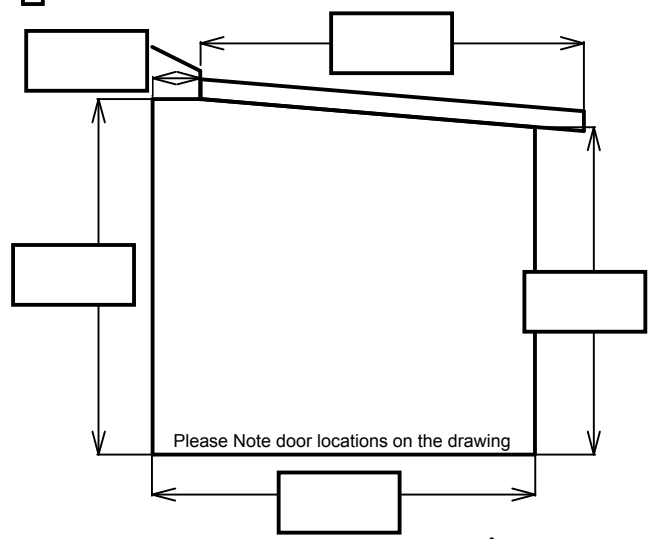

Left Elevation
SCALE 1/4" 1'-0"

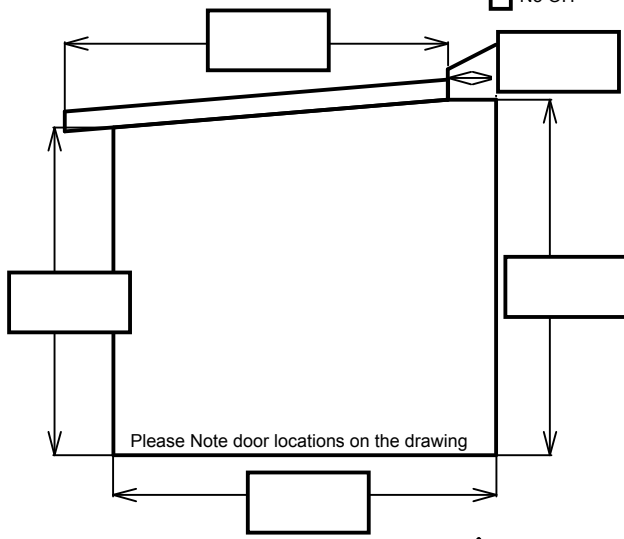

Right Elevation
SCALE 1/4" 1'-0"

- Patio Cover:
- R/F .024 W-Pan
 - R/F .032 Wpan
 - R/F .032 Flat Pan
 - 3" Ins
 - 4" Ins
- Roll Form NOT recommended over enclosures except screen rooms due to condensation

- R/F Color:
- White Pans
 - Tan Pans → .024 W Not Available
 - White Fascia
 - Tan Fascia
 - Clay Fascia
 - Bronze Fascia
 - Brown Fascia

- Ins Top Color:
- White Panels
 - Tan Panel
 - White Fascia
 - Tan Fascia

- Foundation Type:
- Deck
 - 4" Concrete Slab
 - Monolithic
 - Other _____

NOTES and EXTRAS:

PATTON ALUMINUM PRODUCTS INC.
www.pattonaluminum.com
937.845.9404 Fax 937.845.9424

ATTN:

Patton Aluminum assumes contractor/Distributor has pulled all necessary Permits and follows all Building Code compliances. Patton does NOT warrant Structural Damage due to poor foundations decks or any attachment failures or sufficiency of any recommendations for a particular application. It is the responsibility of the dealer/installer to ensure that the proper amount of material is specified.

Customer:

Date:

PO #:

Job Name:

Address: