

The Unity Hall

Co-Working Membership



A Center for Arts, Education and Job Training

The Baltimore Unity Hall is designed to break down barriers that have traditionally divided the community and to help build a healthy, safe neighborhood for all. The Unity Hall is a newly renovated 30,000 square foot building which provides modern office space for community-based organizations, artist studios, and co-working spaces with shared tenant amenities. There are gallery spaces and an auditorium available for rent at reduced rates for tenants. A state-of-the-art commercial kitchen and event space make up the lower level, while office space, the gallery, and auditorium are on the first floor. The second-floor hosts additional office spaces, the co-working spaces, and the suite of artist studios.

The co-working spaces offer a spacious workspace with floor-to-ceiling windows, a spacious kitchen and lounge space, and the opportunity to come along with other professionals from the surrounding community.

The Unity Hall
1505 Eutaw Place, Baltimore, MD 21217
<https://baltimoreunityhall.org/artist-and-co-working>

The Unity Hall

Co-working Office Membership

- ❖ The Co-working Area includes 6 Divided Workstations and private areas for phone calls, available on a first-come, first-served basis
- ❖ Monthly Membership Fee of \$125
- ❖ Flexible Membership Terms with a One Month Minimum Membership Option
- ❖ All utilities (Heating/Cooling, Water/Sewer, High-Speed Wired and Shared Building Wi-Fi Internet Access) are included with in the Membership Fee
- ❖ Membership includes access to a Shared Kitchen, Lounge Area, and Wellness Rooms
- ❖ Co-working Members are provided 4 hours/month of complimentary Conference Room access, additional access is available at a discounted rate of \$25/hr.
- ❖ Members are also eligible for Discounted Rental Rates to reserve the Exhibition/Gallery Rooms and Auditorium.
- ❖ Common Area Cleaning Services Provided by Landlord on a Regular Basis
- ❖ An on-site Mailbox and Package Locker are Available for a \$40/month fee
- ❖ Regular Hours of Operation for the Building - 8 am to 6 pm Monday through Friday
 - Late-night access through 11 pm is an additional \$75/month
- ❖ ADA accessible building with elevator
- ❖ On-Site Center Director co-ordinates scheduling for programs, exhibits, and events, and the reservations for the conference room, gallery spaces and auditorium.

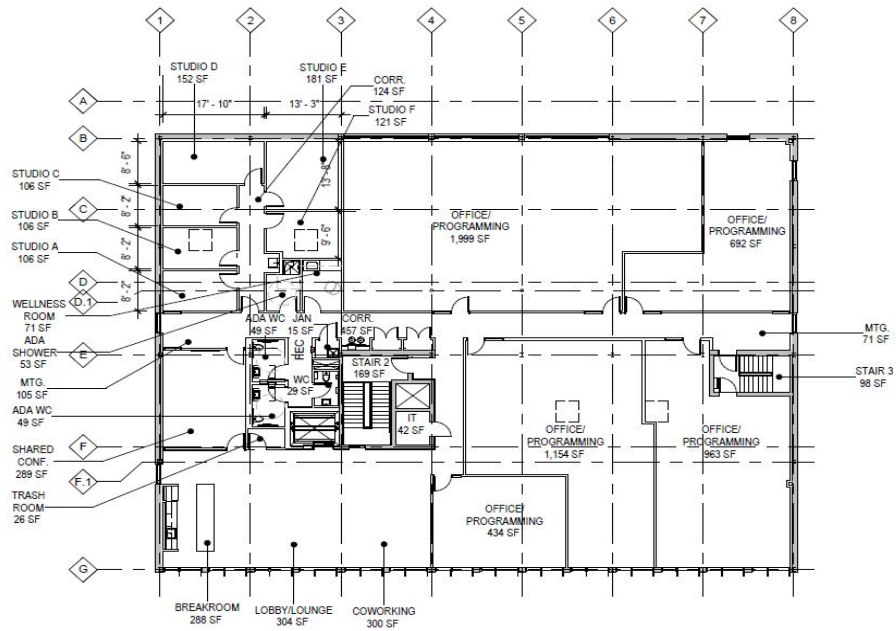

The Unity Hall
 1505 Eutaw Place, Baltimore, MD 21217
<https://baltimoreunityhall.org/artist-and-co-working>