

RIVER

PLEASANT

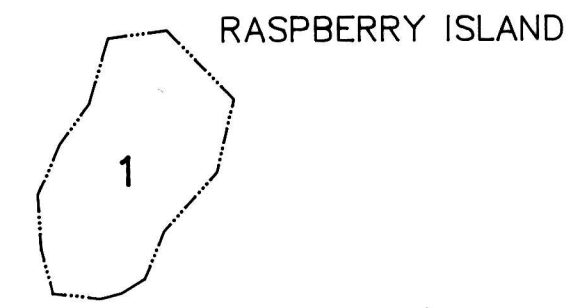

RASPBERRY ISLAND

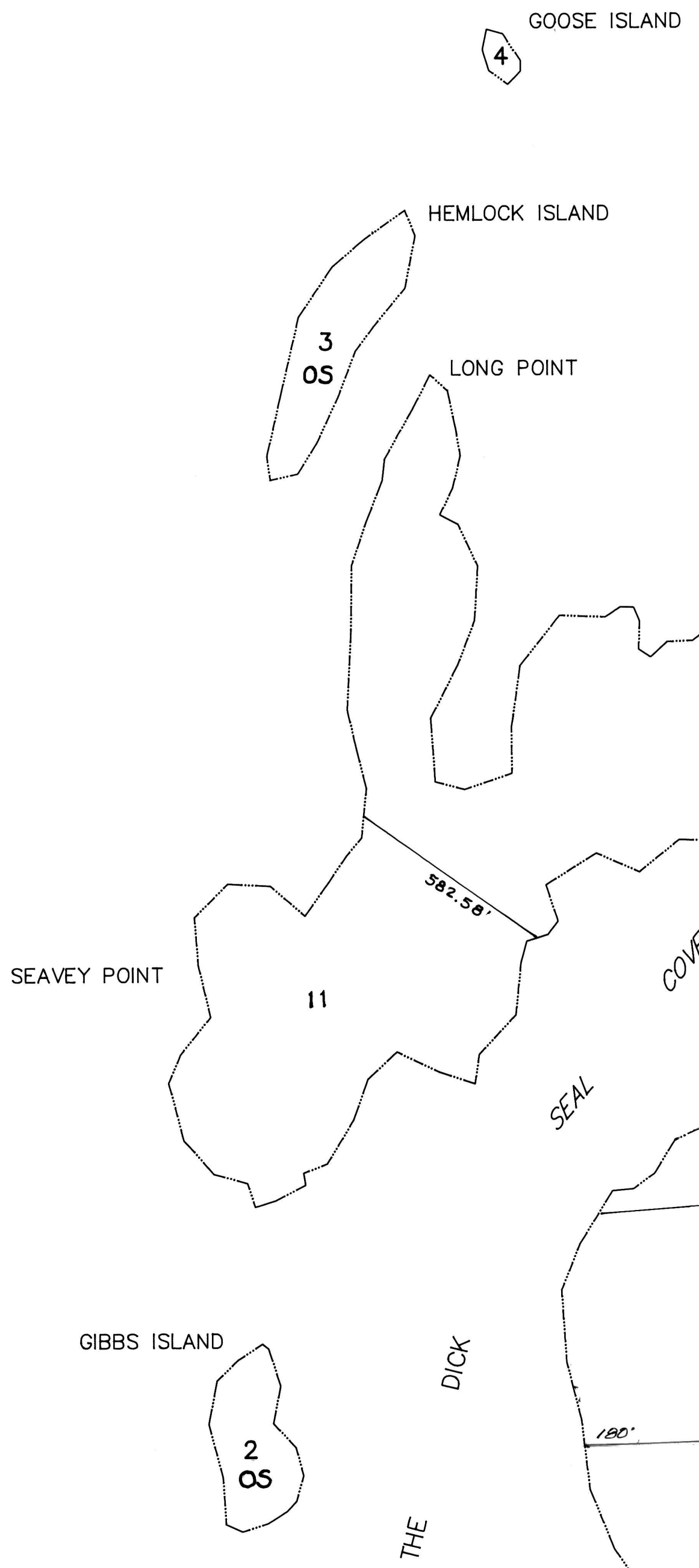

SEAVEY POINT

GIBBS ISLAND

GOOSE ISLAND

HEMLOCK ISLAND

LONG POINT

SEAL COVE

THREE BROOKS COVE

THE DICK

LONG COVE

M 13

M 17

M 19

M 20

LEGEND: PARCEL NUMBER.....12
ADJACENT MAP.....M5
MATCH LINE.....
LOT & RANGE.....L10R2

PREPARED BY: AERIAL SURVEY & PHOTO, INC.
NORRIDGEWOCK, MAINE

NOTE: FOR ASSESSMENT PURPOSES ONLY, NOT TO BE USED FOR CONVEYANCES

PROPERTY MAP
TOWN OF ADDISON
WASHINGTON COUNTY, MAINE

200 0 400 800 1200 1600 FEET

SCALE: 1"=400' APRIL 1, 1992