

PLEASANT BAY

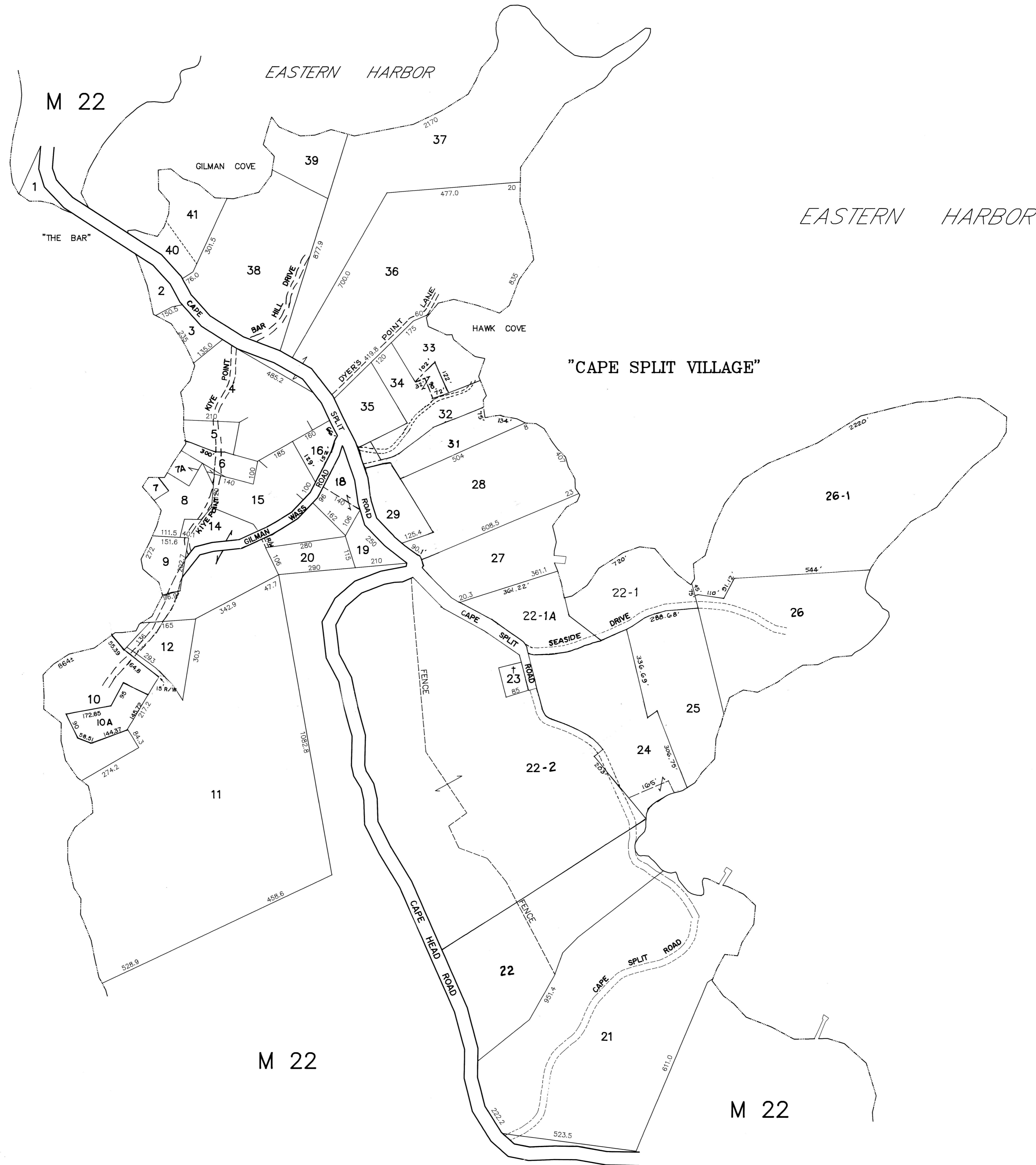

PREPARED BY: AERIAL SURVEY & PHOTO, INC.
NORRIDGEWOCK, MAINE

NOTE: FOR ASSESSMENT PURPOSES ONLY, NOT TO BE USED FOR CONVEYANCES

LEGEND: PARCEL NUMBER.....12
ADJACENT MAP.....M5

PROPERTY MAP
TOWN OF ADDISON
WASHINGTON COUNTY, MAINE

100 0 200 400 600 800 FEET

SCALE: 1"=200'

APRIL 1, 1992