

### Notice of Complete Application

The County of Brant has received an application for a zoning amendment, in accordance with the Planning Act (R.S.O. 1990, C. P. 13) on **January 7, 2022** and has deemed the application complete on **January 7, 2022**

File Number: **ZBA1-22-KD**

Location: **282A Highway # 5**

Applicant: **CSG Limited Partnership**

Agent: **WEBB Planning Consultants**

#### Purposed and Effect of Proposed Zoning Amendment:

An application has been received to rezone the subject lands from **Agriculture** to **M2 Light Industrial** to facilitate the proposed warehouse use.

#### Notice Intent and Additional Information:

This notice is intended to make you aware of the proposed application and to invite your comments. The proposed Zoning Amendment is now being circulated to County Departments and Public Agencies for technical review. Once this has been completed, a report summarizing the proposal and the comments received will be prepared by the Planner and presented at a public meeting with a recommendation to Council. Notice of Public Meeting will be given to those who received this Notice and those requesting such Notice.

**Additional information regarding the proposed Zoning Amendment is available to the public for inspection in person, telephone and e-mail at the following:**

Planning Department Office: 66 Grand River Street N. Paris, On. N3L 2M2 between 8:30a.m. - 4:30pm.

Planner telephone: 519.44BRANT x **3018**

Planner e-mail: [kayla.deleye@brant.ca](mailto:kayla.deleye@brant.ca)

Accessible formats and communications supports are available upon request, please notify the Planner in advance of the hearing.

If a person or public body does not make oral submissions at a public meeting or make written submissions to the County of Brant before the By-law is passed, the person or public body is not entitled to appeal the decision of the County of Brant to the Ontario Land Tribunal. If a person or public body does not make oral submissions at a public meeting, or make written submissions to the County of Brant before the By-law is passed, the person or public body may not be added as a party to the hearing of an appeal before the Ontario Land Tribunal unless, in the opinion of the Tribunal, there are reasonable grounds to do so. If you wish to be notified of the decision of the County of Brant in respect to the proposed zoning By-law amendment, you must make a written request to the County Deputy Clerk, c/o the County of Brant at 31 Mechanic Street., Suite 207, Paris, Ontario N3L 1K1 or by email at [clerks@brant.ca](mailto:clerks@brant.ca). **Written submissions will become part of the public record.**



### **Development Charge Freeze**

Pursuant to Section 26.1 and Section 26.2 of the *Development Charges Act*, as amended (DCA), the total amount of development charge for a development that is proceeding either through a Site Plan Control approval process or a Zoning By-Law Amendment approval process, is to be determined under the County of Brant's Development Charge By-Law on the date when the County has confirmed that a **complete application** has been accepted. If two years has elapsed since the approval of the relevant application to when the first building permit is issued, the amount of the development charge is that amount as on the date of the issuance of the building permit. Should a development be subject to both site plan and re-zoning applications, the latter date shall be used to determine the Development Charge. If neither of these applications apply, the Development Charge shall be the amount as set on the date the building permit is issued.

### **Interest on Frozen Development Charges**

The interest rate for Development Charges frozen at the date of completed Site Plan application or Zoning By-Law amendment application, prior to building permit issuance, shall be Bank of Canada Prime + 2% annually. Bank of Canada Prime will be determined on the first business day of the month.

Please refer to the County of Brant's Development Charges Interest Rate Policy at the following link: <https://www.brant.ca/en/resident-services/Development-Charges-Bylaw.aspx>





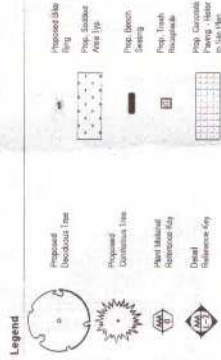

**Proposed Plant Material List**

QTY	UNIT	DESCRIPTION	PRICE	TOTAL
RECOMMENDED TREES				
1	EA	Small Deciduous Tree (10-15')	\$150	\$150
2	EA	Small Deciduous Tree (15-20')	\$250	\$500
3	EA	Small Deciduous Tree (20-25')	\$350	\$1,050
4	EA	Small Deciduous Tree (25-30')	\$450	\$1,800
5	EA	Small Deciduous Tree (30-35')	\$550	\$2,750
6	EA	Small Deciduous Tree (35-40')	\$650	\$3,900
7	EA	Small Deciduous Tree (40-45')	\$750	\$5,250
8	EA	Small Deciduous Tree (45-50')	\$850	\$6,800
9	EA	Small Deciduous Tree (50-55')	\$950	\$8,550
10	EA	Small Deciduous Tree (55-60')	\$1,050	\$10,500
11	EA	Small Deciduous Tree (60-65')	\$1,150	\$12,650
12	EA	Small Deciduous Tree (65-70')	\$1,250	\$15,000
13	EA	Small Deciduous Tree (70-75')	\$1,350	\$17,550
14	EA	Small Deciduous Tree (75-80')	\$1,450	\$20,300
15	EA	Small Deciduous Tree (80-85')	\$1,550	\$23,250
16	EA	Small Deciduous Tree (85-90')	\$1,650	\$26,400
17	EA	Small Deciduous Tree (90-95')	\$1,750	\$29,750
18	EA	Small Deciduous Tree (95-100')	\$1,850	\$33,300
19	EA	Small Deciduous Tree (100-105')	\$1,950	\$37,050
20	EA	Small Deciduous Tree (105-110')	\$2,050	\$40,900
21	EA	Small Deciduous Tree (110-115')	\$2,150	\$44,850
22	EA	Small Deciduous Tree (115-120')	\$2,250	\$48,900
23	EA	Small Deciduous Tree (120-125')	\$2,350	\$53,050
24	EA	Small Deciduous Tree (125-130')	\$2,450	\$57,300
25	EA	Small Deciduous Tree (130-135')	\$2,550	\$61,650
26	EA	Small Deciduous Tree (135-140')	\$2,650	\$66,100
27	EA	Small Deciduous Tree (140-145')	\$2,750	\$70,650
28	EA	Small Deciduous Tree (145-150')	\$2,850	\$75,300
29	EA	Small Deciduous Tree (150-155')	\$2,950	\$80,050
30	EA	Small Deciduous Tree (155-160')	\$3,050	\$84,900
31	EA	Small Deciduous Tree (160-165')	\$3,150	\$89,850
32	EA	Small Deciduous Tree (165-170')	\$3,250	\$94,900
33	EA	Small Deciduous Tree (170-175')	\$3,350	\$100,050
34	EA	Small Deciduous Tree (175-180')	\$3,450	\$105,300
35	EA	Small Deciduous Tree (180-185')	\$3,550	\$110,650
36	EA	Small Deciduous Tree (185-190')	\$3,650	\$116,100
37	EA	Small Deciduous Tree (190-195')	\$3,750	\$121,650
38	EA	Small Deciduous Tree (195-200')	\$3,850	\$127,300
39	EA	Small Deciduous Tree (200-205')	\$3,950	\$133,050
40	EA	Small Deciduous Tree (205-210')	\$4,050	\$138,900
41	EA	Small Deciduous Tree (210-215')	\$4,150	\$144,850
42	EA	Small Deciduous Tree (215-220')	\$4,250	\$150,900
43	EA	Small Deciduous Tree (220-225')	\$4,350	\$157,050
44	EA	Small Deciduous Tree (225-230')	\$4,450	\$163,300
45	EA	Small Deciduous Tree (230-235')	\$4,550	\$169,650
46	EA	Small Deciduous Tree (235-240')	\$4,650	\$176,100
47	EA	Small Deciduous Tree (240-245')	\$4,750	\$182,650
48	EA	Small Deciduous Tree (245-250')	\$4,850	\$189,300
49	EA	Small Deciduous Tree (250-255')	\$4,950	\$196,050
50	EA	Small Deciduous Tree (255-260')	\$5,050	\$202,900
51	EA	Small Deciduous Tree (260-265')	\$5,150	\$209,850
52	EA	Small Deciduous Tree (265-270')	\$5,250	\$216,900
53	EA	Small Deciduous Tree (270-275')	\$5,350	\$224,050
54	EA	Small Deciduous Tree (275-280')	\$5,450	\$231,300
55	EA	Small Deciduous Tree (280-285')	\$5,550	\$238,650
56	EA	Small Deciduous Tree (285-290')	\$5,650	\$246,100
57	EA	Small Deciduous Tree (290-295')	\$5,750	\$253,650
58	EA	Small Deciduous Tree (295-300')	\$5,850	\$261,300
59	EA	Small Deciduous Tree (300-305')	\$5,950	\$269,050
60	EA	Small Deciduous Tree (305-310')	\$6,050	\$276,900
61	EA	Small Deciduous Tree (310-315')	\$6,150	\$284,850
62	EA	Small Deciduous Tree (315-320')	\$6,250	\$292,900
63	EA	Small Deciduous Tree (320-325')	\$6,350	\$301,050
64	EA	Small Deciduous Tree (325-330')	\$6,450	\$309,300
65	EA	Small Deciduous Tree (330-335')	\$6,550	\$317,650
66	EA	Small Deciduous Tree (335-340')	\$6,650	\$326,100
67	EA	Small Deciduous Tree (340-345')	\$6,750	\$334,650
68	EA	Small Deciduous Tree (345-350')	\$6,850	\$343,300
69	EA	Small Deciduous Tree (350-355')	\$6,950	\$352,050
70	EA	Small Deciduous Tree (355-360')	\$7,050	\$360,900
71	EA	Small Deciduous Tree (360-365')	\$7,150	\$369,850
72	EA	Small Deciduous Tree (365-370')	\$7,250	\$378,900
73	EA	Small Deciduous Tree (370-375')	\$7,350	\$388,050
74	EA	Small Deciduous Tree (375-380')	\$7,450	\$397,300
75	EA	Small Deciduous Tree (380-385')	\$7,550	\$406,650
76	EA	Small Deciduous Tree (385-390')	\$7,650	\$416,100
77	EA	Small Deciduous Tree (390-395')	\$7,750	\$425,650
78	EA	Small Deciduous Tree (395-400')	\$7,850	\$435,300
79	EA	Small Deciduous Tree (400-405')	\$7,950	\$445,050
80	EA	Small Deciduous Tree (405-410')	\$8,050	\$454,900
81	EA	Small Deciduous Tree (410-415')	\$8,150	\$464,850
82	EA	Small Deciduous Tree (415-420')	\$8,250	\$474,900
83	EA	Small Deciduous Tree (420-425')	\$8,350	\$485,050
84	EA	Small Deciduous Tree (425-430')	\$8,450	\$495,300
85	EA	Small Deciduous Tree (430-435')	\$8,550	\$505,650
86	EA	Small Deciduous Tree (435-440')	\$8,650	\$516,100
87	EA	Small Deciduous Tree (440-445')	\$8,750	\$526,650
88	EA	Small Deciduous Tree (445-450')	\$8,850	\$537,300
89	EA	Small Deciduous Tree (450-455')	\$8,950	\$548,050
90	EA	Small Deciduous Tree (455-460')	\$9,050	\$558,900
91	EA	Small Deciduous Tree (460-465')	\$9,150	\$569,850
92	EA	Small Deciduous Tree (465-470')	\$9,250	\$580,900
93	EA	Small Deciduous Tree (470-475')	\$9,350	\$592,050
94	EA	Small Deciduous Tree (475-480')	\$9,450	\$603,300
95	EA	Small Deciduous Tree (480-485')	\$9,550	\$614,650
96	EA	Small Deciduous Tree (485-490')	\$9,650	\$626,100
97	EA	Small Deciduous Tree (490-495')	\$9,750	\$637,650
98	EA	Small Deciduous Tree (495-500')	\$9,850	\$649,300
99	EA	Small Deciduous Tree (500-505')	\$9,950	\$661,050
100	EA	Small Deciduous Tree (505-510')	\$10,050	\$672,900
101	EA	Small Deciduous Tree (510-515')	\$10,150	\$684,850
102	EA	Small Deciduous Tree (515-520')	\$10,250	\$696,900
103	EA	Small Deciduous Tree (520-525')	\$10,350	\$709,050
104	EA	Small Deciduous Tree (525-530')	\$10,450	\$721,300
105	EA	Small Deciduous Tree (530-535')	\$10,550	\$733,650
106	EA	Small Deciduous Tree (535-540')	\$10,650	\$746,100
107	EA	Small Deciduous Tree (540-545')	\$10,750	\$758,650
108	EA	Small Deciduous Tree (545-550')	\$10,850	\$771,300
109	EA	Small Deciduous Tree (550-555')	\$10,950	\$784,050
110	EA	Small Deciduous Tree (555-560')	\$11,050	\$796,900
111	EA	Small Deciduous Tree (560-565')	\$11,150	\$809,850
112	EA	Small Deciduous Tree (565-570')	\$11,250	\$822,900
113	EA	Small Deciduous Tree (570-575')	\$11,350	\$836,050
114	EA	Small Deciduous Tree (575-580')	\$11,450	\$849,300
115	EA	Small Deciduous Tree (580-585')	\$11,550	\$862,650
116	EA	Small Deciduous Tree (585-590')	\$11,650	\$876,100
117	EA	Small Deciduous Tree (590-595')	\$11,750	\$889,650
118	EA	Small Deciduous Tree (595-600')	\$11,850	\$903,300
119	EA	Small Deciduous Tree (600-605')	\$11,950	\$917,050
120	EA	Small Deciduous Tree (605-610')	\$12,050	\$930,900
121	EA	Small Deciduous Tree (610-615')	\$12,150	\$944,850
122	EA	Small Deciduous Tree (615-620')	\$12,250	\$958,900
123	EA	Small Deciduous Tree (620-625')	\$12,350	\$973,050
124	EA	Small Deciduous Tree (625-630')	\$12,450	\$987,300
125	EA	Small Deciduous Tree (630-635')	\$12,550	\$1,001,650
126	EA	Small Deciduous Tree (635-640')	\$12,650	\$1,016,100
127	EA	Small Deciduous Tree (640-645')	\$12,750	\$1,030,650
128	EA	Small Deciduous Tree (645-650')	\$12,850	\$1,045,300
129	EA	Small Deciduous Tree (650-655')	\$12,950	\$1,060,050
130	EA	Small Deciduous Tree (655-660')	\$13,050	\$1,074,900
131	EA	Small Deciduous Tree (660-665')	\$13,150	\$1,089,850
132	EA	Small Deciduous Tree (665-670')	\$13,250	\$1,104,900
133	EA	Small Deciduous Tree (670-675')	\$13,350	\$1,120,050
134	EA	Small Deciduous Tree (675-680')	\$13,450	\$1,135,300
135	EA	Small Deciduous Tree (680-685')	\$13,550	\$1,150,650
136	EA	Small Deciduous Tree (685-690')	\$13,650	\$1,166,100
137	EA	Small Deciduous Tree (690-695')	\$13,750	\$1,181,650
138	EA	Small Deciduous Tree (695-700')	\$13,850	\$1,197,300
139	EA	Small Deciduous Tree (700-705')	\$13,950	\$1,213,050
140	EA	Small Deciduous Tree (705-710')	\$14,050	\$1,228,900
141	EA	Small Deciduous Tree (710-715')	\$14,150	\$1,244,850
142	EA	Small Deciduous Tree (715-720')	\$14,250	\$1,260,900
143	EA	Small Deciduous Tree (720-725')	\$14,350	\$1,277,050
144	EA	Small Deciduous Tree (725-730')	\$14,450	\$1,293,300
145	EA	Small Deciduous Tree (730-735')	\$14,550	\$1,309,650
146	EA	Small Deciduous Tree (735-740')	\$14,650	\$1,326,100
147	EA	Small Deciduous Tree (740-745')	\$14,750	\$1,342,650
148	EA	Small Deciduous Tree (745-750')	\$14,850	\$1,359,300
149	EA	Small Deciduous Tree (750-755')	\$14,950	\$1,376,050
150	EA	Small Deciduous Tree (755-760')	\$15,050	\$1,392,900
151	EA	Small Deciduous Tree (760-765')	\$15,150	\$1,409,850
152	EA	Small Deciduous Tree (765-770')	\$15,250	\$1,426,900
153	EA	Small Deciduous Tree (770-775')	\$15,350	\$1,444,050
154	EA	Small Deciduous Tree (775-780')	\$15,450	\$1,461,300
155	EA	Small Deciduous Tree (780-785')	\$15,550	\$1,478,650
156	EA	Small Deciduous Tree (785-790')	\$15,650	\$1,496,100
157	EA	Small Deciduous Tree (790-795')	\$15,750	\$1,513,650
158	EA	Small Deciduous Tree (795-800')	\$15,850	\$1,531,300
159	EA	Small Deciduous Tree (800-805')	\$15,950	\$1,549,050
160	EA	Small Deciduous Tree (805-810')	\$16,050	\$1,566,900
161	EA	Small Deciduous Tree (810-815')	\$16,150	\$1,584,850
162	EA	Small Deciduous Tree (815-820')	\$16,250	\$1,602,900
163	EA	Small Deciduous Tree (820-825')	\$16,350	\$1,621,050
164	EA	Small Deciduous Tree (825-830')	\$16,450	\$1,639,300
165	EA	Small Deciduous Tree (830-835')	\$16,550	\$1,657,650
166	EA	Small Deciduous Tree (835-840')	\$16,650	\$1,676,100
167	EA	Small Deciduous Tree (840-845')	\$16,750	\$1,694,650
168	EA	Small Deciduous Tree (845-850')	\$16,850	\$1,713,300
169	EA	Small Deciduous Tree (850-855')	\$16,950	\$1,732,050
170	EA	Small Deciduous Tree (855-860')	\$17,050	\$1,750,900
171	EA	Small Deciduous Tree (860-865')	\$17,150	\$1,769,850
172	EA	Small Deciduous Tree (865-870')	\$17,250	\$1,788,900
173	EA	Small Deciduous Tree (870-875')	\$17,350	\$1,808,050
174	EA	Small Deciduous Tree (875-880')	\$17,450	\$1,827,300
175	EA	Small Deciduous Tree (880-885')	\$17,550	\$1,846,650
176	EA	Small Deciduous Tree (885-890')	\$17,650	\$1,866,100
177	EA	Small Deciduous Tree (890-895')	\$17,750	\$1,885,650
178	EA	Small Deciduous Tree (895-900')	\$17,850	\$1,905,300
179	EA	Small Deciduous Tree (900-905')	\$17,950	\$1,925,050
180	EA	Small Deciduous Tree (905-910')	\$18,050	\$1,944,900
181	EA	Small Deciduous Tree (910-915')	\$18,150	\$1,964,850
182	EA	Small Deciduous Tree (915-920')	\$18,250	\$1,984,900
183	EA	Small Deciduous Tree (920-925')	\$18,350	\$2,005,050
184	EA	Small Deciduous Tree (925-930')	\$18,450	\$2,025,300
185	EA	Small Deciduous Tree (930-935')	\$18,550	\$2,045,650
186	EA	Small Deciduous Tree (935-940')	\$18,650	\$2,066,100
187	EA	Small Deciduous Tree (940-945')	\$18,750	\$2,086,650
188	EA	Small Deciduous Tree (945-950')	\$18,850	\$2,107,300
189	EA	Small Deciduous Tree (950-955')	\$18,950	\$2,128,050
190	EA	Small Deciduous Tree (955-960')	\$19,050	\$2,148,900
191	EA	Small Deciduous Tree (960-965')	\$19,150	\$2,169,850
192	EA	Small Deciduous Tree (965-970')	\$19,250	\$2,190,900
193	EA	Small Deciduous Tree (970-975')	\$19,350	\$2,212,050
194	EA	Small Deciduous Tree (975-980')	\$19,450	\$2,233,300
195	EA	Small Deciduous Tree (980-985')	\$19,550	\$2,254,650
196	EA	Small Deciduous Tree (985-990')	\$19,650	\$2,276,100
197	EA	Small Deciduous Tree (990-995')	\$19,750	\$2,297,650
198	EA	Small Deciduous Tree (995-1000')	\$19,850	\$2,319,300
199	EA	Small Deciduous Tree (1000-1005')	\$19,950	\$2,341,050
200	EA	Small Deciduous Tree (1005-1010')	\$20,050	\$2,362,900
201	EA	Small Deciduous Tree (1010-1015')	\$20,150	\$2,384,850
202	EA	Small Deciduous Tree (1015-1020')	\$20,250	\$2,406,900
203	EA	Small Deciduous Tree (1020-1025')	\$20,350	\$2,429,050
204	EA	Small Deciduous Tree (1025-1030')	\$20,450	\$2,451,300
205	EA	Small Deciduous Tree (1030-1035')	\$20,550	\$2,473,650
206	EA	Small Deciduous Tree (1035-1040')	\$20,650	\$2,496,100
207	EA	Small Deciduous Tree (1040-1045')	\$20,750	\$2,518,650
208	EA	Small Deciduous Tree (1045-1050')	\$20,850	\$2,541,300
209</				



282A HWY # 5

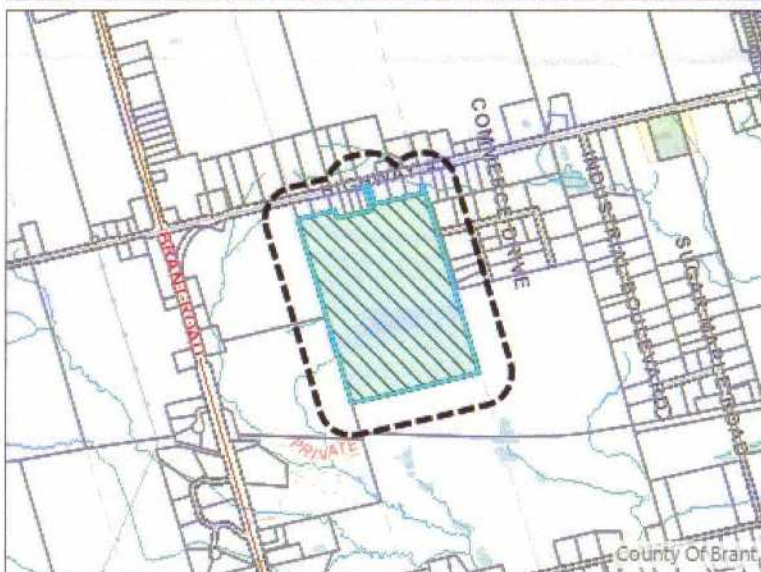

### Legend



Subject Lands



125m Offset for Circulation

This map is for illustrative purposes only. Information contained thereon is not a substitute for professional review or a site survey and is subject to change without notice. Any interpretations of conclusions drawn from this map are the sole responsibility of the user. Orthoimagery was flown in 2017.