

PRESTIGE 500

S U M M A R Y

- > SPECIFICATIONS
- > NEW-MODEL YEAR 2014
- > PRESENTATION
- > TECHNICAL EQUIPMENT
- > ELECTRONIC PACKAGES
- > DIMENSIONS
- > ANCHORING & MOORING KIT
- > ENGINE SPECIFICATIONS
- > GENERAL INFORMATIONS



PRESTIGE
— LUXURY MOTOR YACHTS —

PRINCIPAL CHARACTERISTICS

Overall length	15,20 m / 49'1"
Hull length	14,92 m / 48'1"
Beam	4,5 m / 14'9"
Draft	1,05 m / 3'5"
Air draft	5,23 m / 17'2"

Aft. V deadrise.....	17°
Light displacement	14 100 kg / 30 080 Lbs
Full load displacement	19 862 kg / 43788 Lbs

Berths.....	6
Cabins	3

Fuel tank capacity	2 x 650 l / 2 x 172 US gal
--------------------------	----------------------------

CE category	B-12 / C-14
-------------------	-------------

Architect.....	J&J Design
Concept & Design	JP Concepts
.....	Garroni Design
.....	Prestige Engineering

CAPACITIES

Fuel tank capacity	2 x 650 l / 2 x 172 US gal
Water capacity	2 x 318 l / 2 x 84 US gal
Hot water heater	60 L / 16 US gal
Holding tank capacity	120 L / 32 US gal

ENGINE SPECS. - PERFORMANCES

Engine power.....	Volvo IPS 600 / 2 x 435 Hp
Fuel tank capacity	2 x 650 l / 2 x 172 US gal
Max. speed**	29 N
Cruising speed**	24 N
Fuel consumption at 29 N	170 L / 45 US gal
Fuel consumption at 24 N	130 L / 34 US gal
Range at 29 N.....	230 MN
Range at 24 N.....	250 MN

EQUIPMENT

Platform dimensions	441 x 111 cm / 14'5" x 3'
Optional platform load capacity	300 kg / 660 Lbs
Air conditioning MED*	53 000 BTU ⁽¹⁾
Air conditioning TROPICALE*	69 000 BTU ⁽¹⁾
Generator*	11 Kw - 230 V / 13,5 Kw - 115 V
Hydraulic gangway dimension	270 cm / 8'9"
Hydraulic gangway load capacity	250 kg / 551 Lbs
Electric windlass power	2 000 W

HEADROOM

Headroom:	
Saloon	200 cm / 6'6"
Galley	210 cm / 6'9"
Forward cabin	195 cm / 6'4"
Aft cabin	195 cm / 6'4"
3 rd cabin	195 cm / 6'4"

* *Optional equipment*

** *Speed at half-load, clean hull without antifouling*

⁽¹⁾ : *with skipper cabin*

NEW-MODEL YEAR 2014

- New Brighter Gel Coat
- Continuous forward hull glass
- Search light placed on flybridge sfridoent
- Induction cooktop (repcela the vitroceramic option)
- Squared sink instead of round sink
- New bed heads & Valences
- Premium mattress in master cabin with Diamond Luxe cover

NEW OPTIONS

- Hydraulic plateform 300 kg
- Chocks kit for tender
- Gangway for hydraulic plateform
- 700 W Inverter in Preference trim level
- 2500 W Inverter (upgrade from Preference trim level)

HYDRAULIC PLATFORM 300 KG + STATIC TRIM TAB

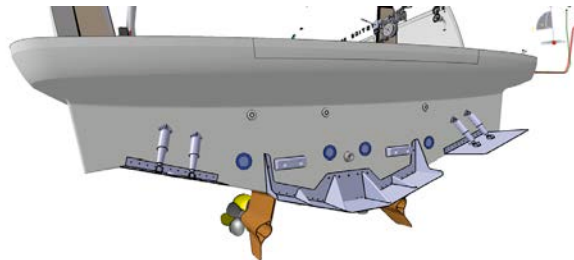

The static trim tab is mounted with the hydraulic platform for optimum planning and to reach 27 knots.

TENDER CHOCKS KIT FOR OPTIONAL PLATFORM

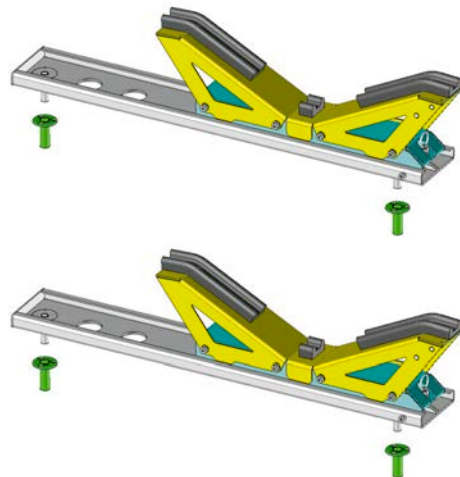
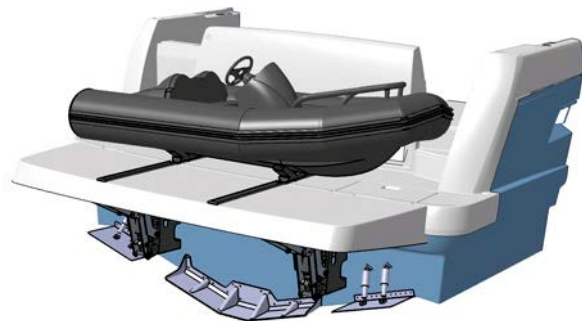



NEW SIGNATURE PRESTIGE

The concept for the new signature PRESTIGE is based on two key principles: perfect harmony in design and the assurance of power and safety.

OPTIMAL COMFORT

The deck plan is designed to facilitate life onboard, with wide sidedecks, a forward sundeck sheltered by a sun awning, and the spacious cockpit opening onto the aft swim platform and hydraulic gangway.

Located near the galley and sheltered by the large flybridge, the spacious cockpit features a direct access to the generous aft cabin, flooded with natural light and boasting its own private head and shower compartment.



CONCEPT

An XXL flybridge

The flybridge of the PRESTIGE 500 is a point of pride, generously sized for a 50-foot motor yacht.

Accessed by an open staircase, the extra-large flybridge features all the luxury of a large motor yacht: a spacious forward sundeck, a helm station with seating for two, a galley and a large table.



Interior space reinvented

The Garroni Design team revolutionizes life onboard with a design concept to fully benefit from life at sea.

The PRESTIGE 500 offers a living space entirely on one level. In seamless communication with the cockpit and the saloon, a spacious galley is ideally situated for easy access to the interior and the exterior. No longer separated from the living area, the open galley is discretely integrated and centrally located, a detail that chefs will appreciate!

The luxurious owner's suite, with private access and an adjoining head and shower compartment, is located mid-ship, where space is maximized and natural light floods in through large windows in the hull.



CONCEPT (continued)

The perfect combination: a prestige hull and volvo ips

A forerunner in the field of POD propulsion, PRESTIGE has already accumulated more experience than the competition and has designed a special hull for superior performance with the new propulsion system. A finely tapered, V-shaped, planing hull and an engine placed slightly forward for optimum weight distribution contribute to the PRESTIGE reputation for building all-weather hulls, renowned for their seakeeping ability and outstanding performance.

Linked to the POD propulsion, the joystick control makes handling a pleasure, whether at port or at sea.



INTERIOR : Design: 3 cabins / 2 head compartments

Spacious and bright skipper's cabin, head compartment with separate shower

Owner's suite with sea view

Third cabin bunk beds can be converted into double berth

Guest cabin with sea view, double berth converts into two single berths



Private access to owner's suite

Head compartment for guest cabin and daytime use

Spacious owner's head compartment with separate shower

INTERIOR

Large wardrobe,
lockers under seats.

Long hull windows, close to 2m².

Private access to
owner's suite

Available in Alpi fair oak

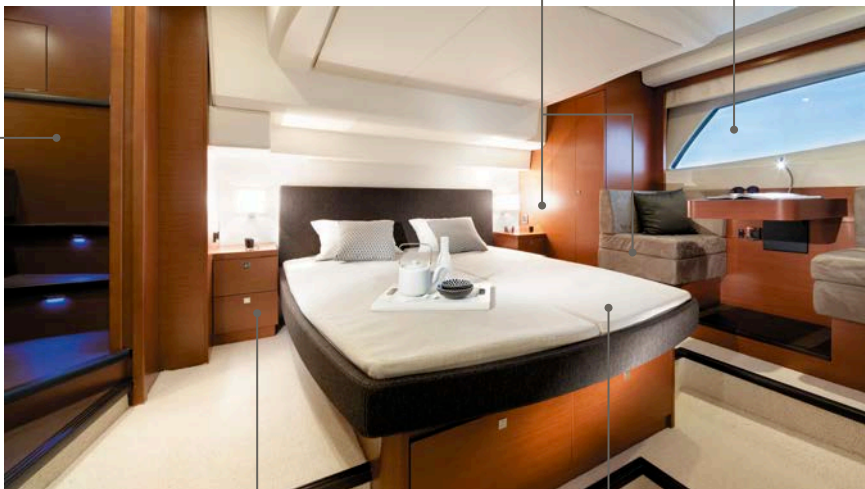

Plenty of storage
under & around the bed.

Bed king size 160 x 200 cm

Headroom all around the bed
(180/196 cm)

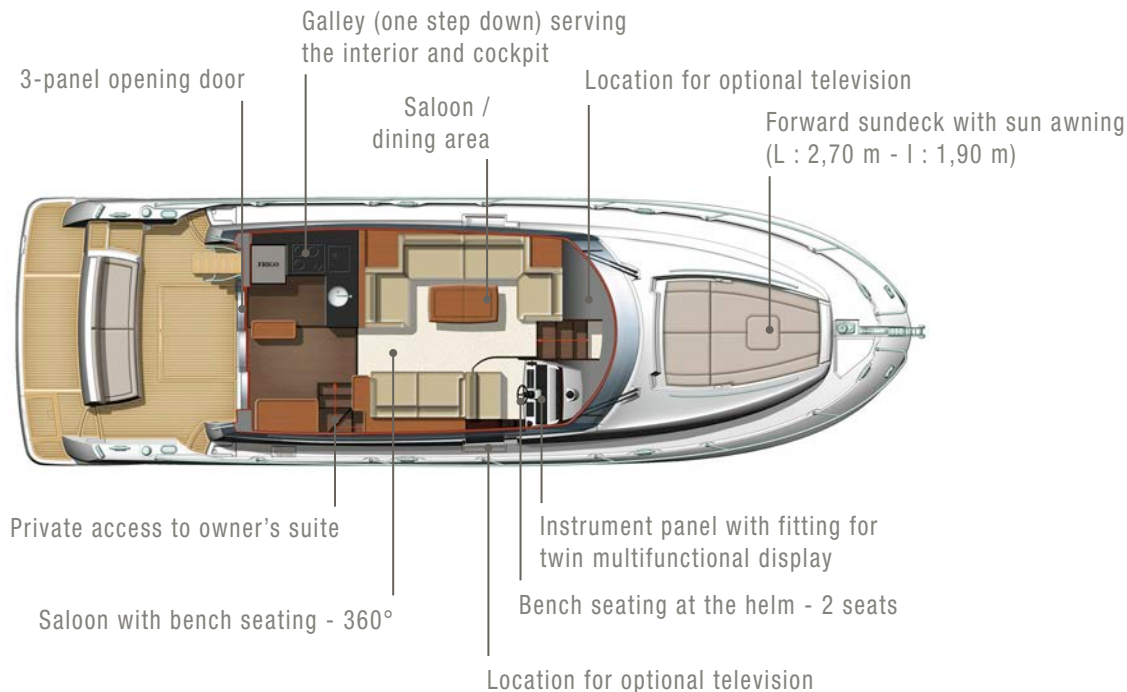



Flybridge galley
(sink, grill, fridge, lockers)



Bench seating
for two at
the helm

Large, comfortable
dining area



Radar arch

Safe, easy movement
onboard

Large and safe forward sundeck
2,70 m x 1,60 m



*: with skipper cabin

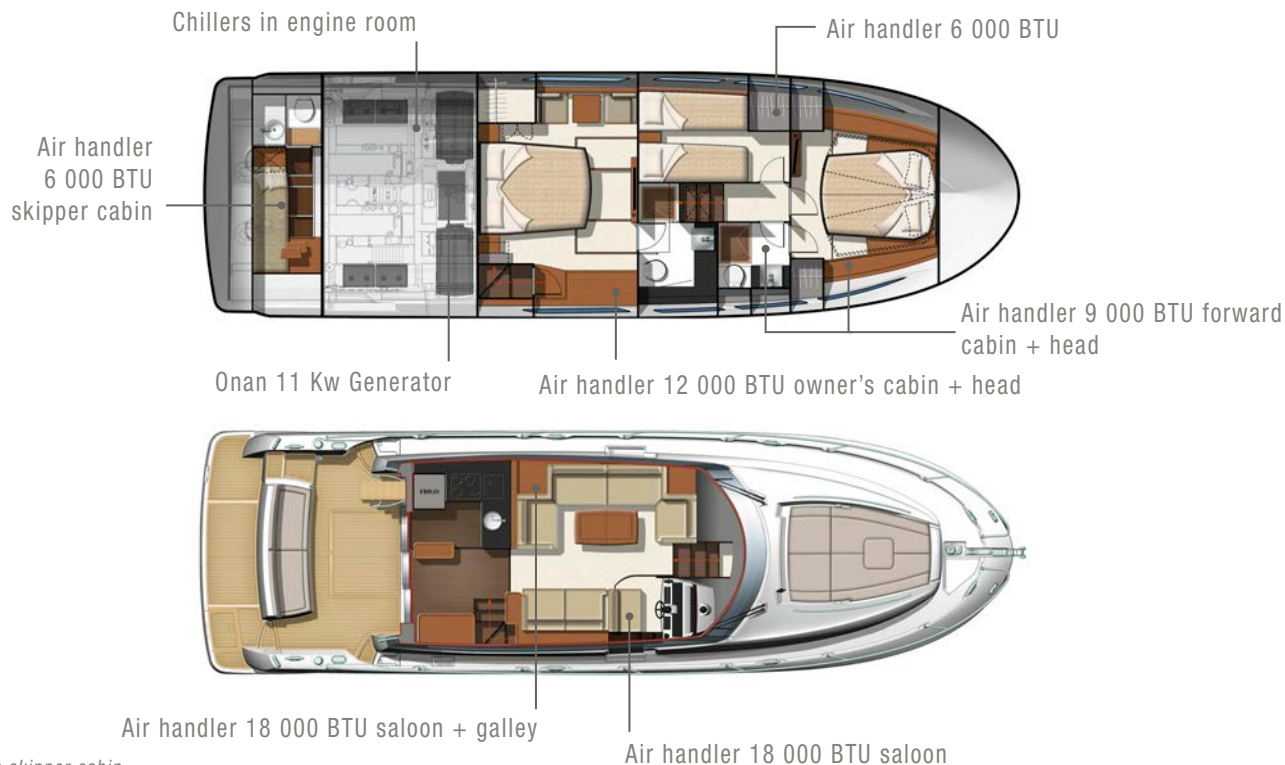

*: with skipper cabin

> DIMENSIONS

- A** L: 360 cm / 11'8"
- B** L: 165 cm / 5'4"
- C** L: 111 cm / 3'6"
- D** L: 340 cm / 11'1"
- E** L: 441 cm / 14'5"
- F** L: 165 cm / 5'4"
- G** L: 270 cm / 8'9"

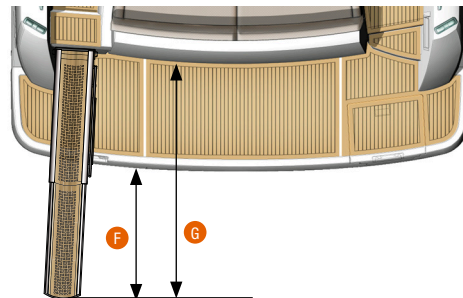
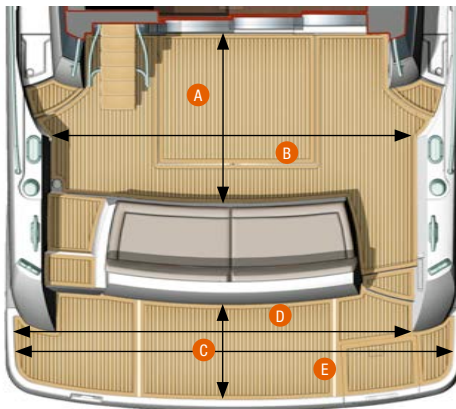

Max. load on gangway:
250 kg / 551 Lbs



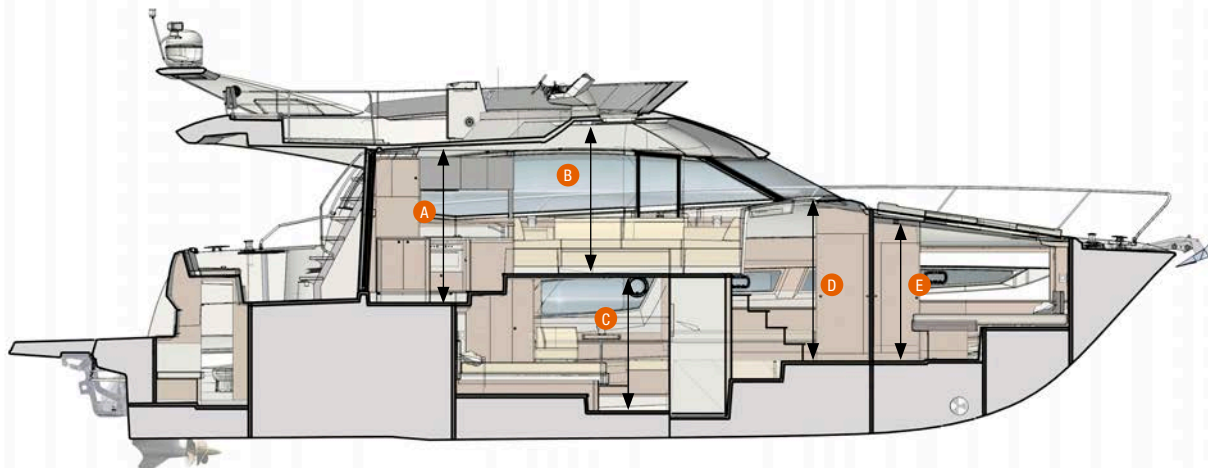

- A** Galley : 210 cm / 6'6"
- B** Saloon : 200 cm / 6'9"
- C** Master cabin : 195 cm / 6'4"
- D** 3rd cabin : 195 cm / 6'4"
- E** VIP Cabin : 195 cm / 6'4"

TRANSPORT:
BATEAU FINI FLY NON ACCASTILLE

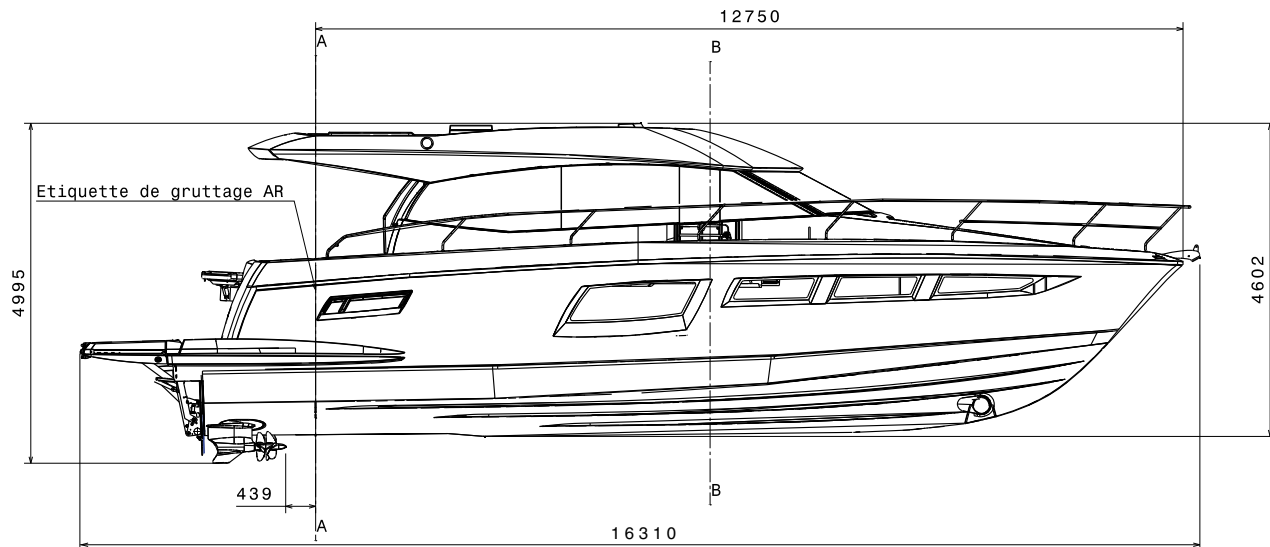

Packing list

Overall lenght	Overall width	Overall height	Height on craddle	Weight (kg)	Volume on craddle (m ³)
15,20 m	4,51 m	5,00 m	5,15 m	13 000	353,04

Pulpits, propellers, rollbar, fl y table, fl y galley, handrails, windscreen, rudder and control panel disassembled



THE UNIQUE BENEFITS OF VOLVO PENTA IPS:

- 40% longer cruising range
- 20% higher top speed
- 30% reduced fuel consumption
- 30% less CO₂ emissions
- 50% lower perceived noise level
- Joystick docking

Compared with inboard shafts at cruising speed, approximate figures. 30% reduction in fuel consumption gives around 40% longer cruising range.

Volvo Penta IPS has been developed as the most environmentally sound inboard propulsion system. For Volvo Penta, green is more than a color. It's a commitment.

FROM A REVOLUTION TO A PROVEN SUCCESS

Praised by boat owners, the press and boat builders, Volvo Penta IPS has revolutionized the boating industry. Superior to inboard shafts in every vital aspect – handling, onboard comfort and performance.



INCREASED CONTROL AND SAFETY

– FOR **EASIER BOATING**

Volvo Penta IPS is available with a range of features that can be tailored to your personal needs. Designed to make life at sea easier, they let you concentrate on the fun of boating and enjoy your days at sea with precise control and increased safety.

JOYSTICK FOR EASY DOCKING

The skipper's best friend that makes docking easy, even fun. Forget complicated shift, throttle and steering wheel combinations in close-quarter maneuvering – simply move the joystick in the direction you want the boat to move, and the boat reacts to your intentions: sideways, diagonally, forwards, backwards or rotate.

DOCK FROM THE AFT DECK

You can make docking even easier with additional joysticks. Place them wherever you have the best possible view for maneuvering. Up to four joysticks can be installed.



VOLVO PENTA IPS JOYSTICK

- Easy and logical one-hand maneuvering
- Move in any direction
- No time limit
- Massive maneuvering power
- No bow or stern thrusters needed
- Up to four joysticks can be installed

