



ANNUAL VISIT TO BNSF
2018



PORTCORPUS CHRISTI®



Vision is to be
The Energy Port
of the Americas





Port Corpus Christi 2017 Stats

- The #1 US Crude Oil Export Port
- 4th Largest Port in the US (by total tonnage)
- USD \$150B in annual economic output
- USD \$100M goods value movement per day
- Greater than \$100M annual port revenues





Investment Highlights

- Air attainment status
- Deep-water ship channel
- Available land suitable for industrial development
- Proximity to major energy production areas including Permian Basin & Eagle Ford Shale formation



Port Corpus Christi Tonnage by Commodity

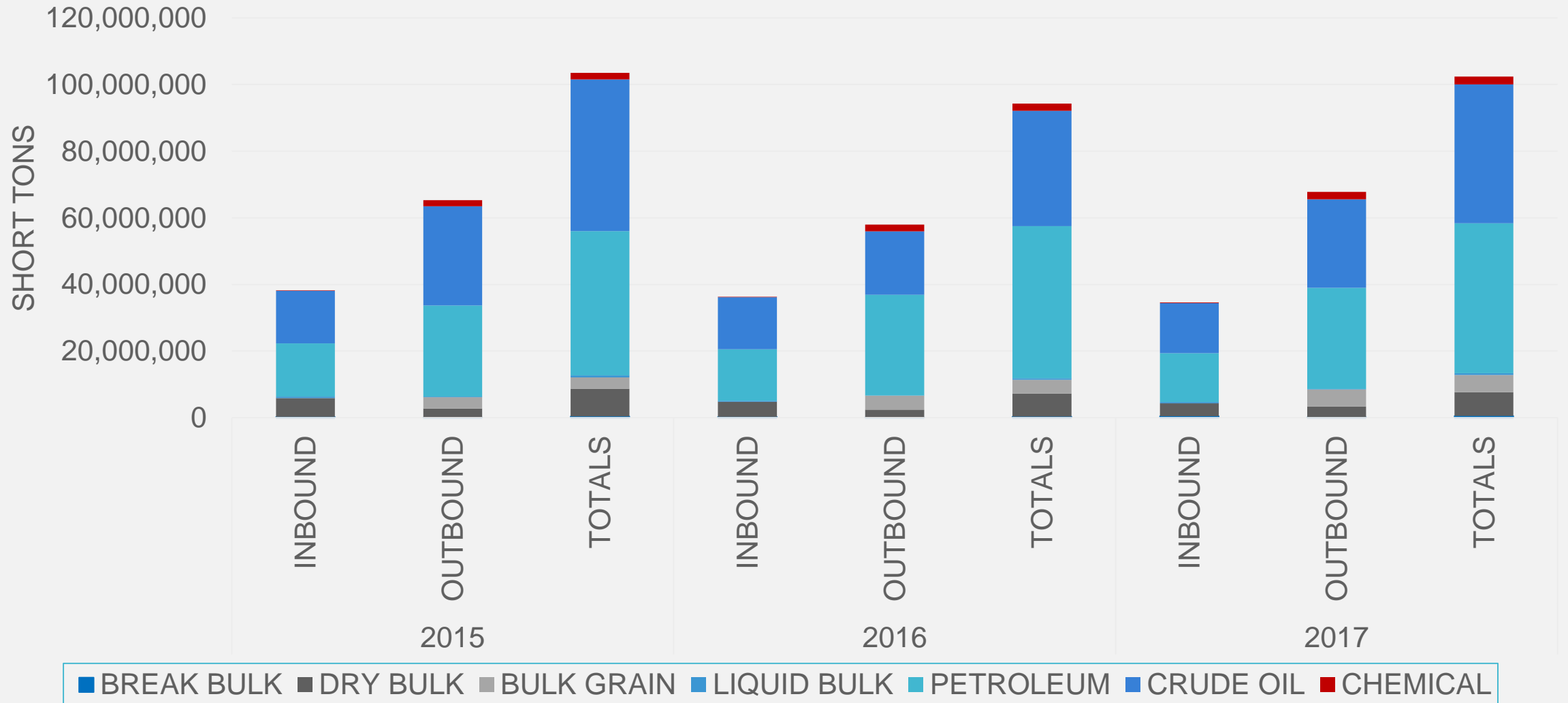

Economic Output

- \$50 Billion in regional investment
- 80,000 related jobs
- 1 million induced jobs nationally
- \$5 billion in personal income
- Over \$15 billion in economic output for Texas
- Over \$350 million in state & local taxes

REVENUE GROWTH BY ENERGY SECTOR

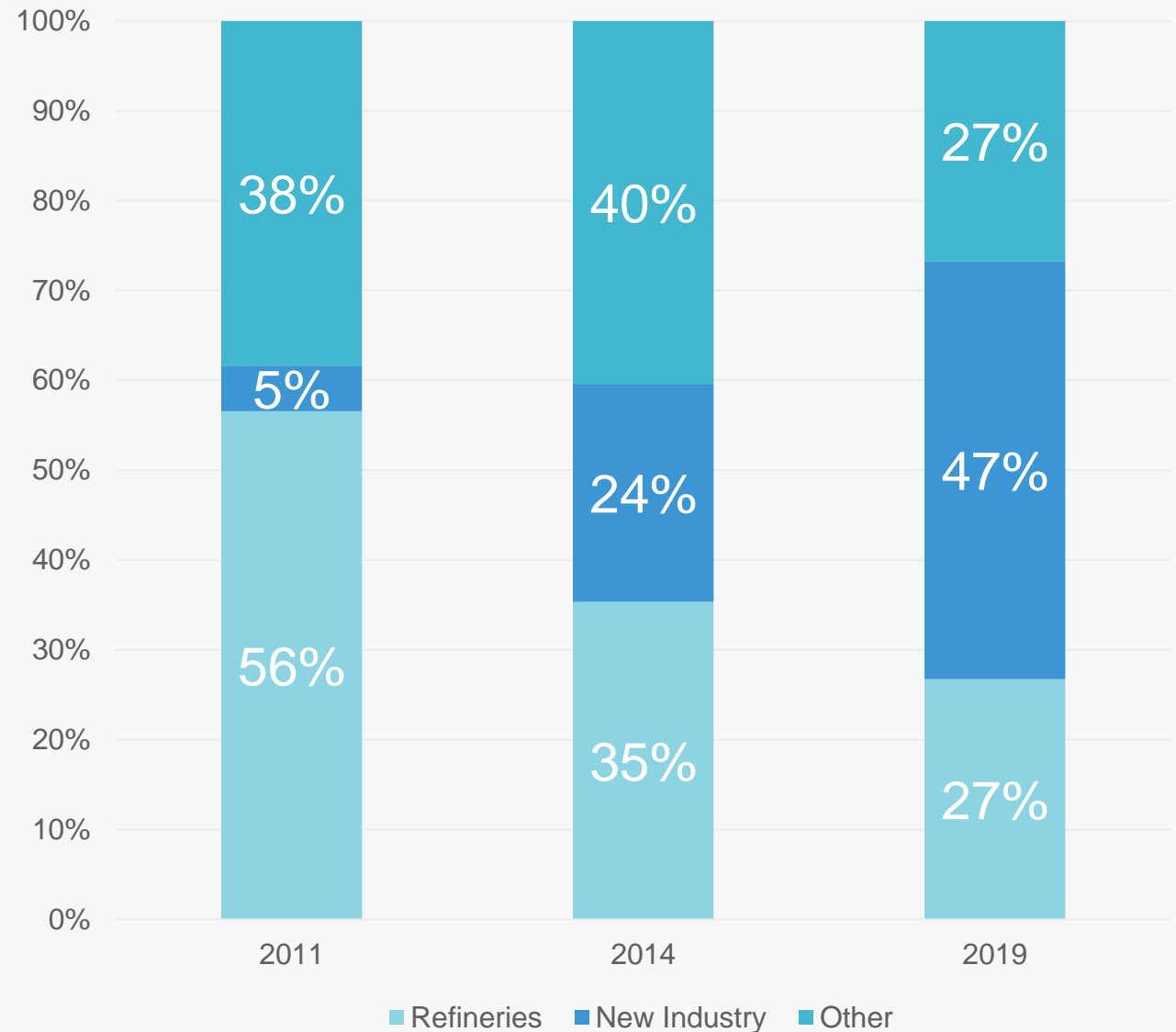

PORT CORPUS CHRISTI

\$50 BILLION INDUSTRIAL INVESTMENTS

\$10 BILLION FOREIGN DIRECT INVESTMENTS



Corpus Christi Polymers (PET/PTA Resin)



INDORAMA
VENTURES

 **alpek**

 遠東新世紀
FAR EASTERN NEW CENTURY



South Texas Cement / GCCM

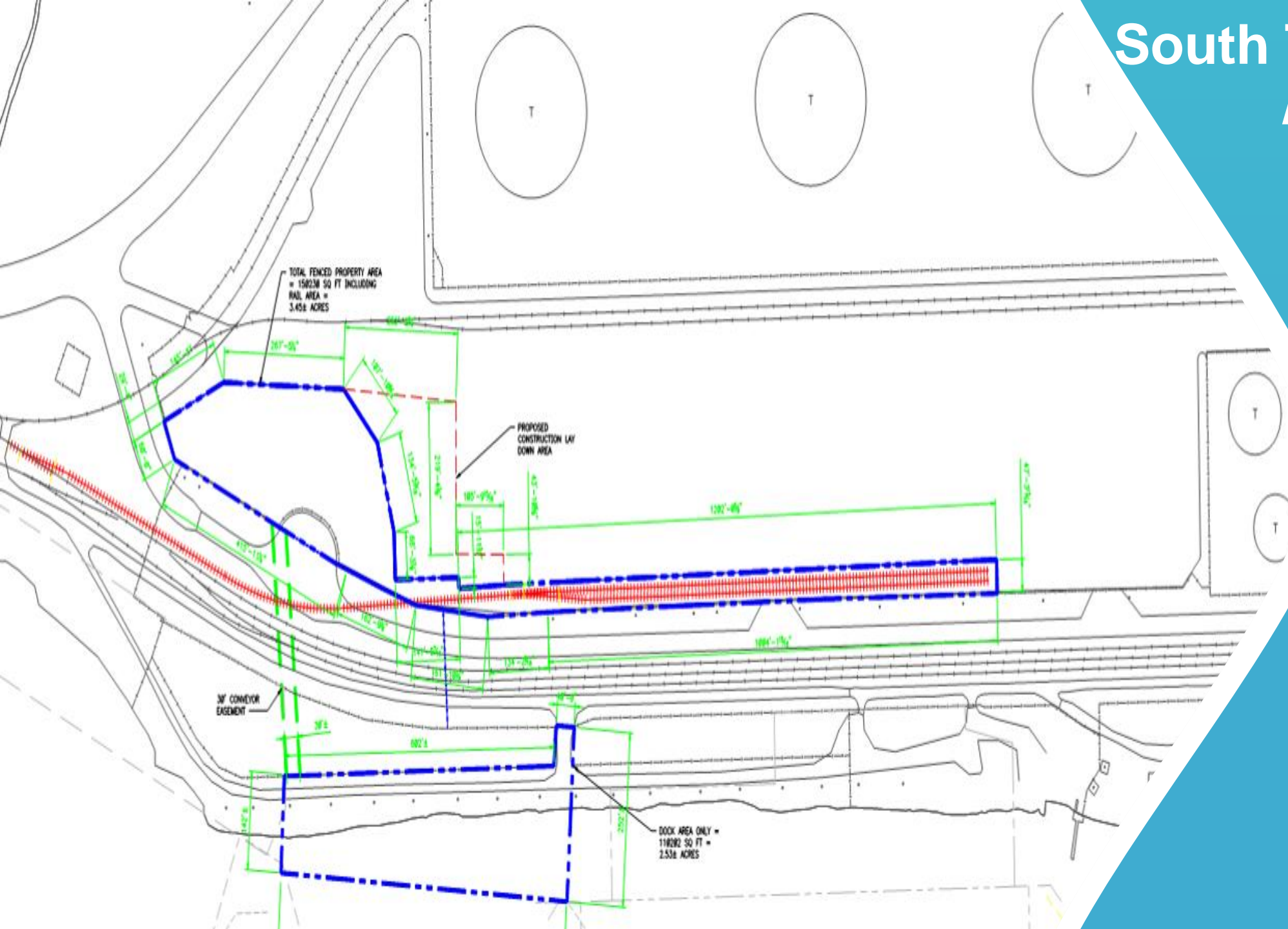

New rail infrastructure for unit train transportation of imported cement to markets in South Texas





Howard Energy Project Maverick Terminal

- Railcar loading infrastructure for unit train transportation of refined petroleum products to Mexico



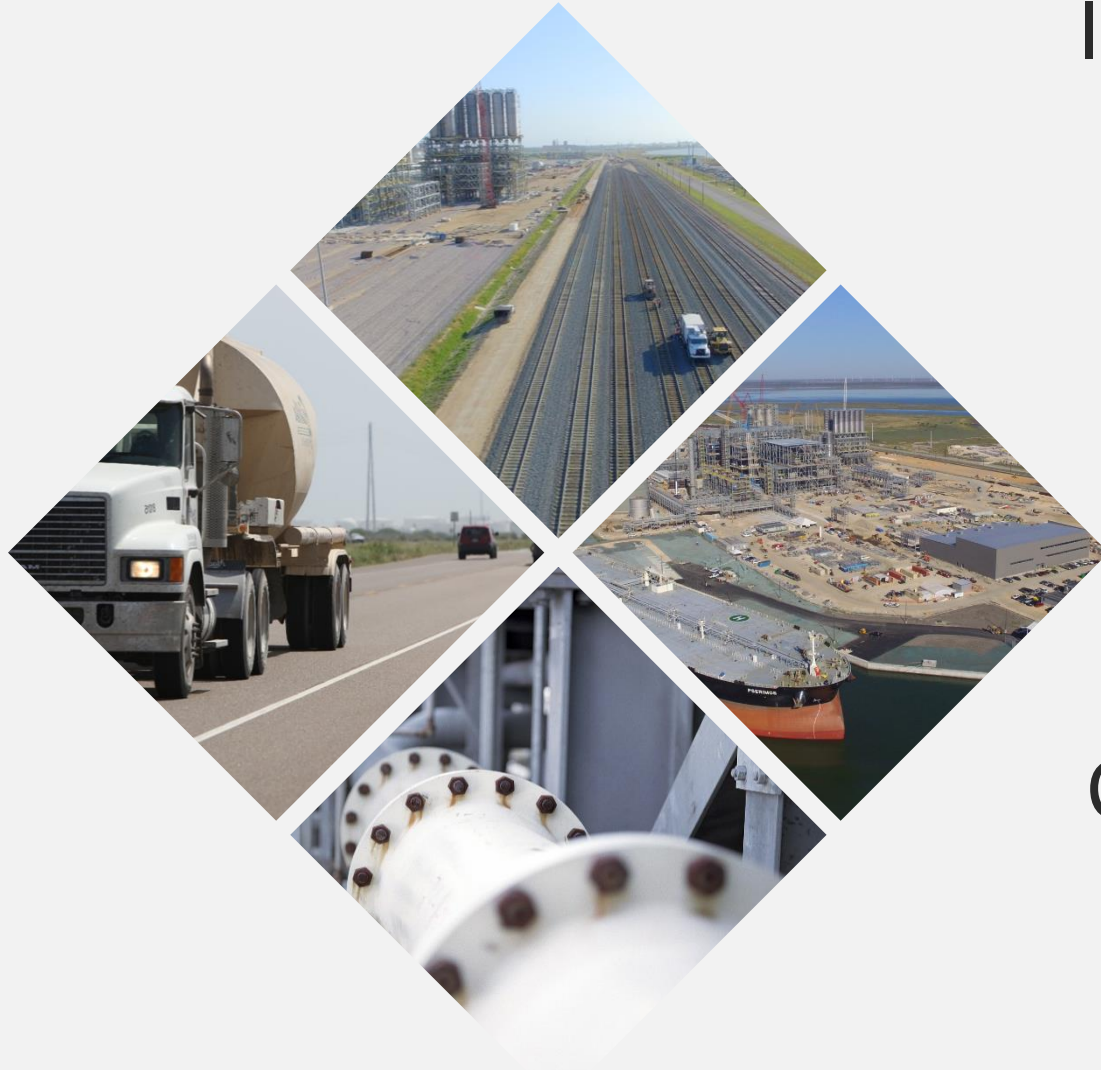

Intermodal Connectivity Imperative

- Intracoastal Waterway Barge Access (M-69)
- Expanding Highway System (I-37 & I-69)
- 36 Miles of Ship Channel (-47' → -54')
- 60 Miles of Railroad Tracks (BNSF, UP & KCS)
- Pipelines, Terminals and Storage Tanks
- New Large Ship Docks

Cargo Types

- Liquid Bulk
- Dry Bulk
- Breakbulk



Annual Rail Car Counts by Rail Company

“Car data prior to 1997 restated to current operators as best estimates available”

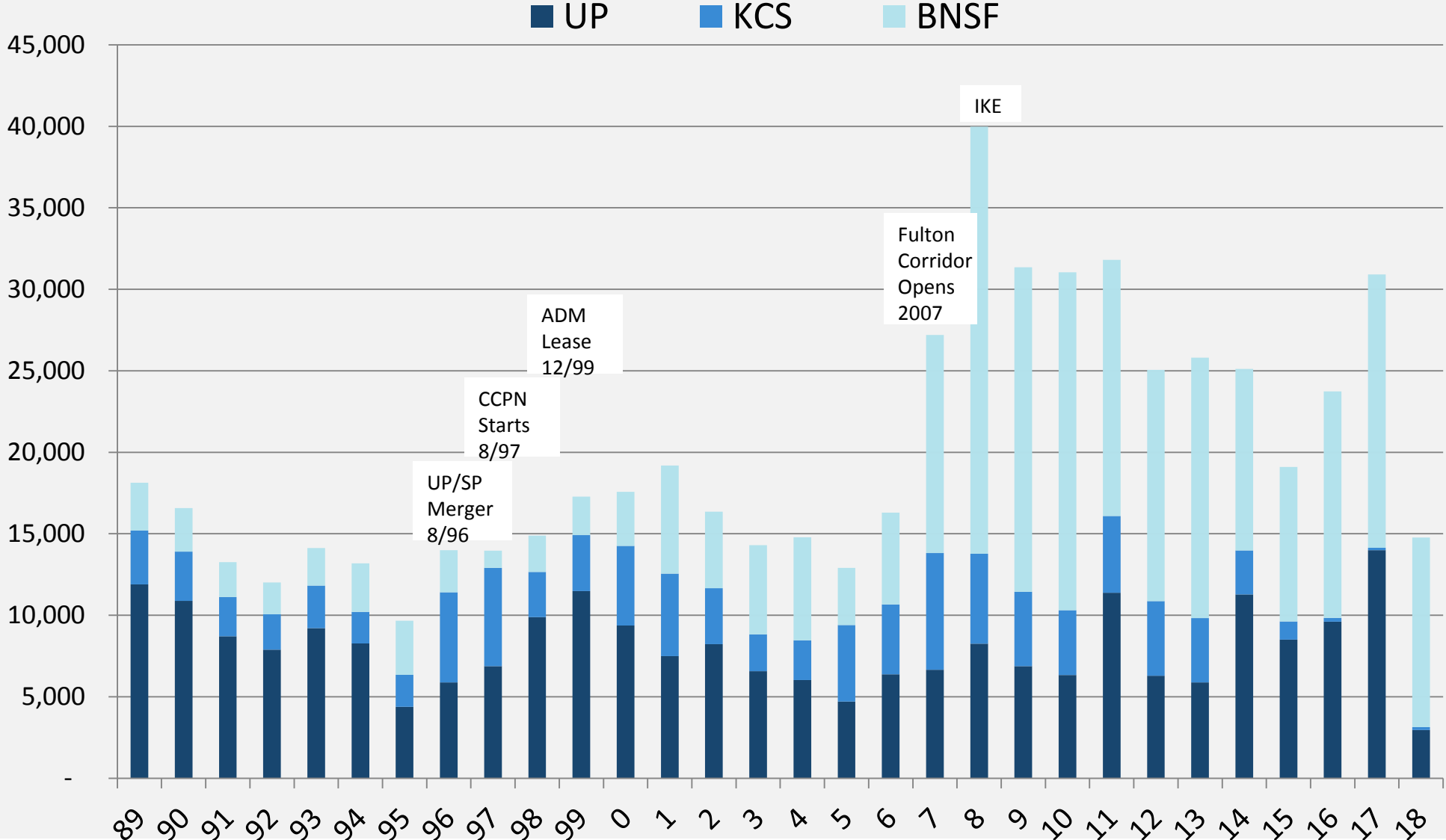

Percentage of Market Share by Rail Company

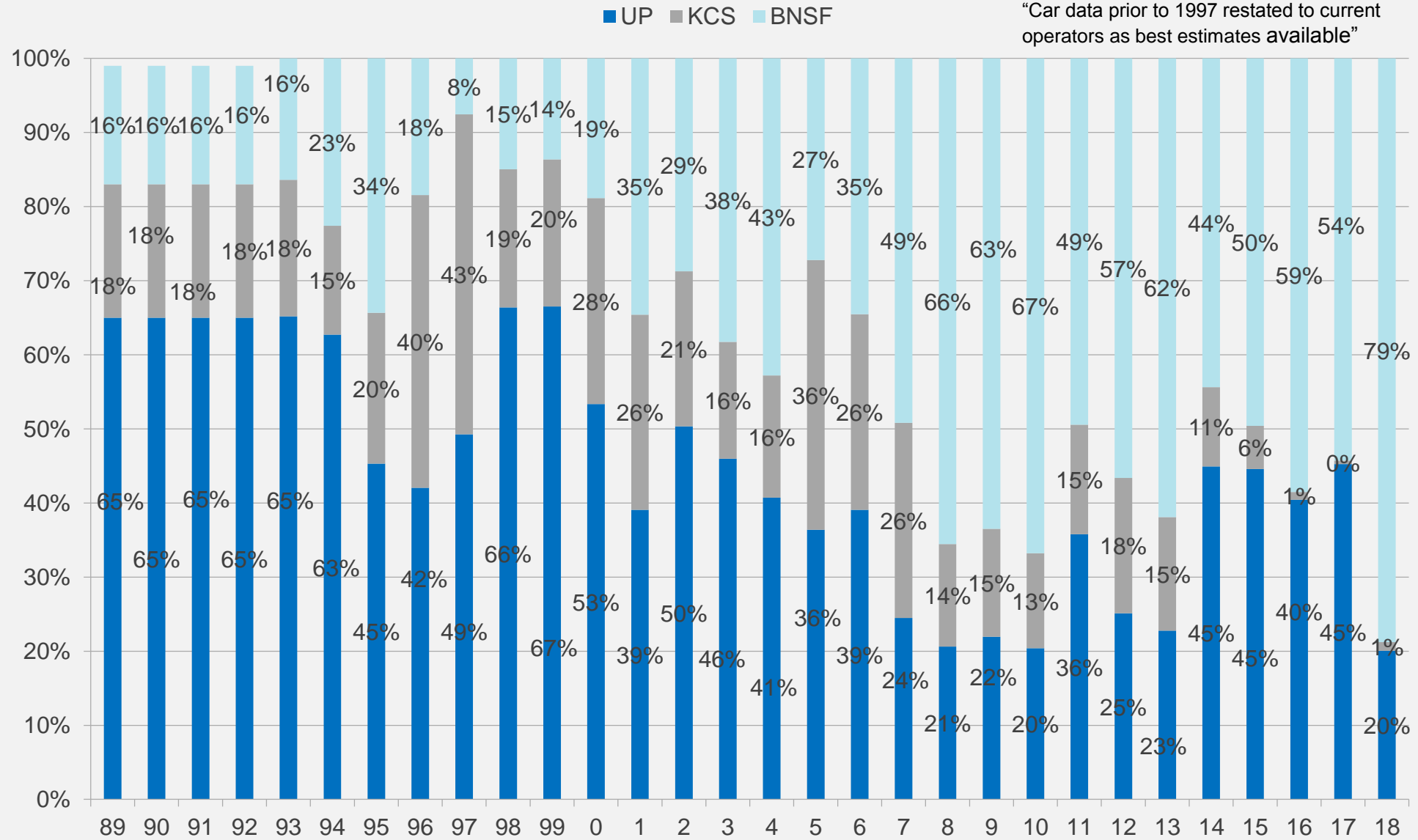

Year-to-Date Carloads (April)

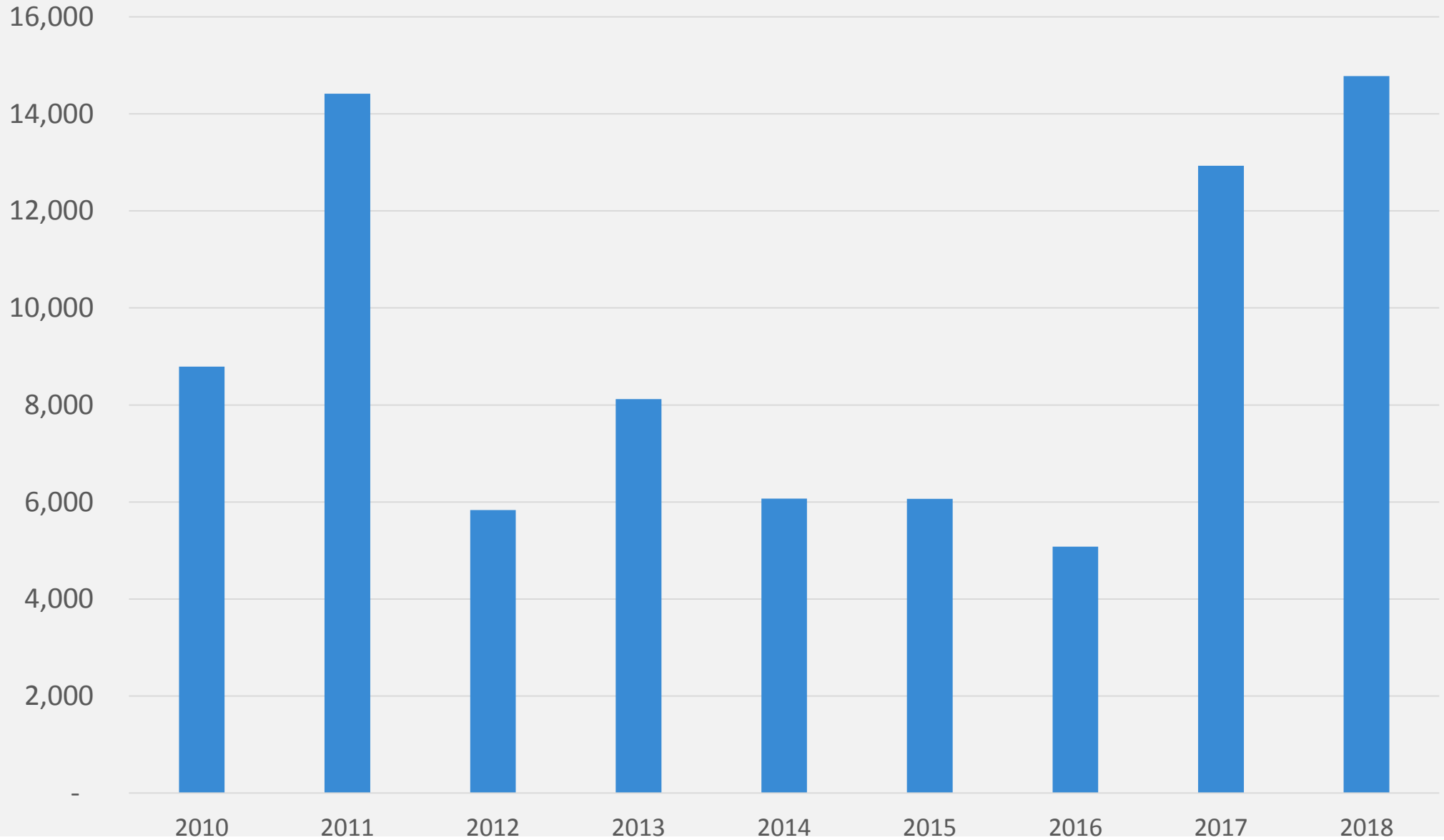

America's Wind Energy Gateway

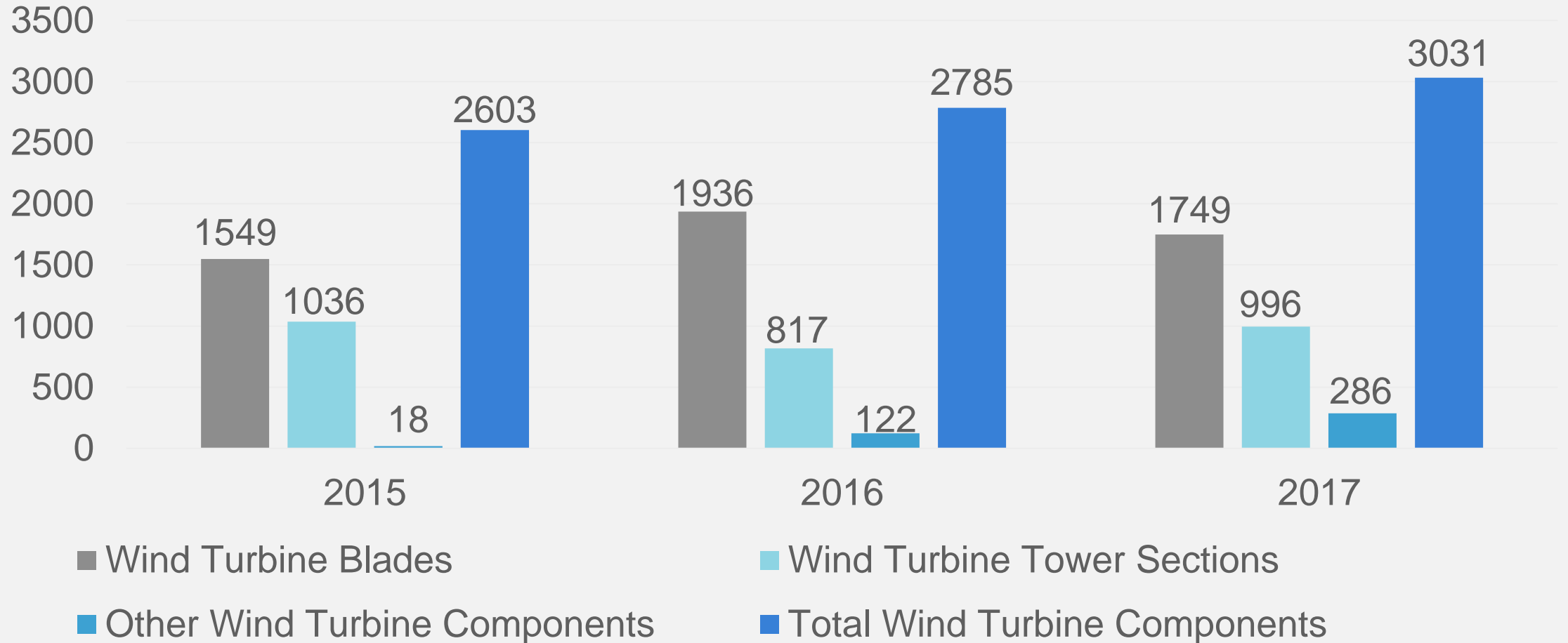

PORT CORPUS CHRISTI

BREAKBULK CAPABILITIES



01
HEAVY LIFT
CAPABILITIES:
KIEWIT OFFSHORE



02
PROJECT CARGO:
RO-RO DOCKS & HEAVY-
HAUL ROAD
CORRIDORS



03
STRATEGIC MILITARY
PORT: AL SPEIGHT
MILITARY YARD WITH
RAILROAD TRACKS

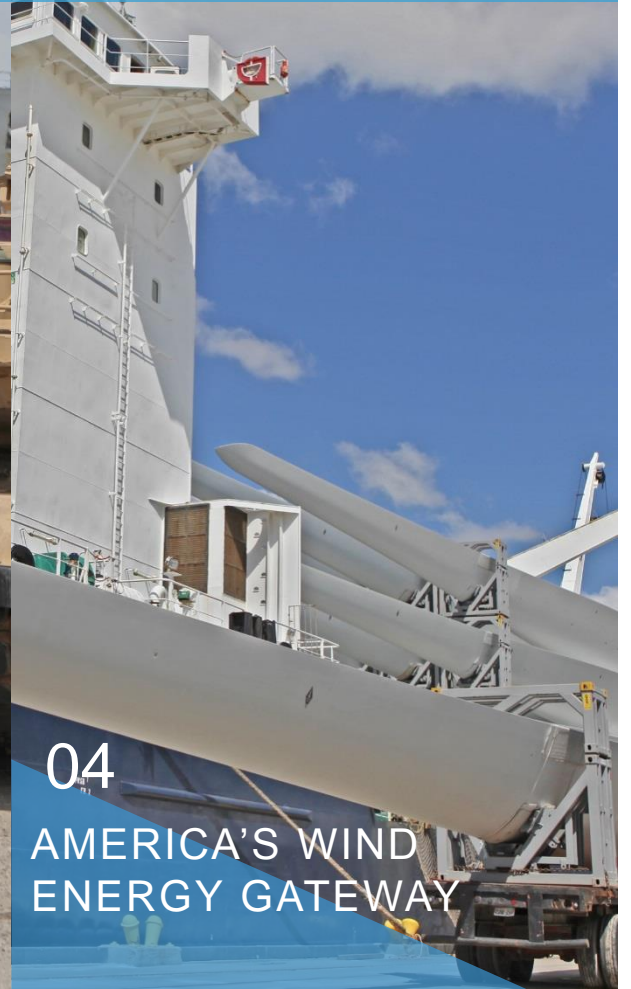

04
AMERICA'S WIND
ENERGY GATEWAY

PORT CORPUS CHRISTI

GLOBAL ENERGY HUB



01

ETHANE CRACKERS:
LYONDELL BASELL
OXYCHEM/MEXICHEM
EXXONMOBIL/SABIC



02

LNG EXPORT:
CHENIERE
STABILIS



03

REFINERY HUB:
VALERO
FLINT HILLS
CITGO

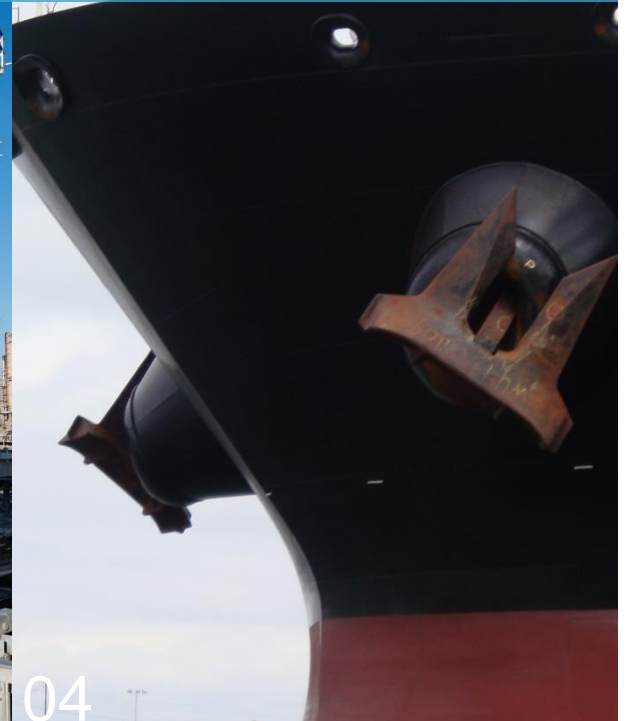

04

CRUDE OIL EXPORT:
BUCKEYE/TRAFIGURA
OXY, NUSTAR, PLAINS,
MAGELLAN, CCI, PIN OAK,
KOCH

Port Corpus Christi Crude Oil Outbound

Exports 2016-2018.04
(Barrels Per Day)

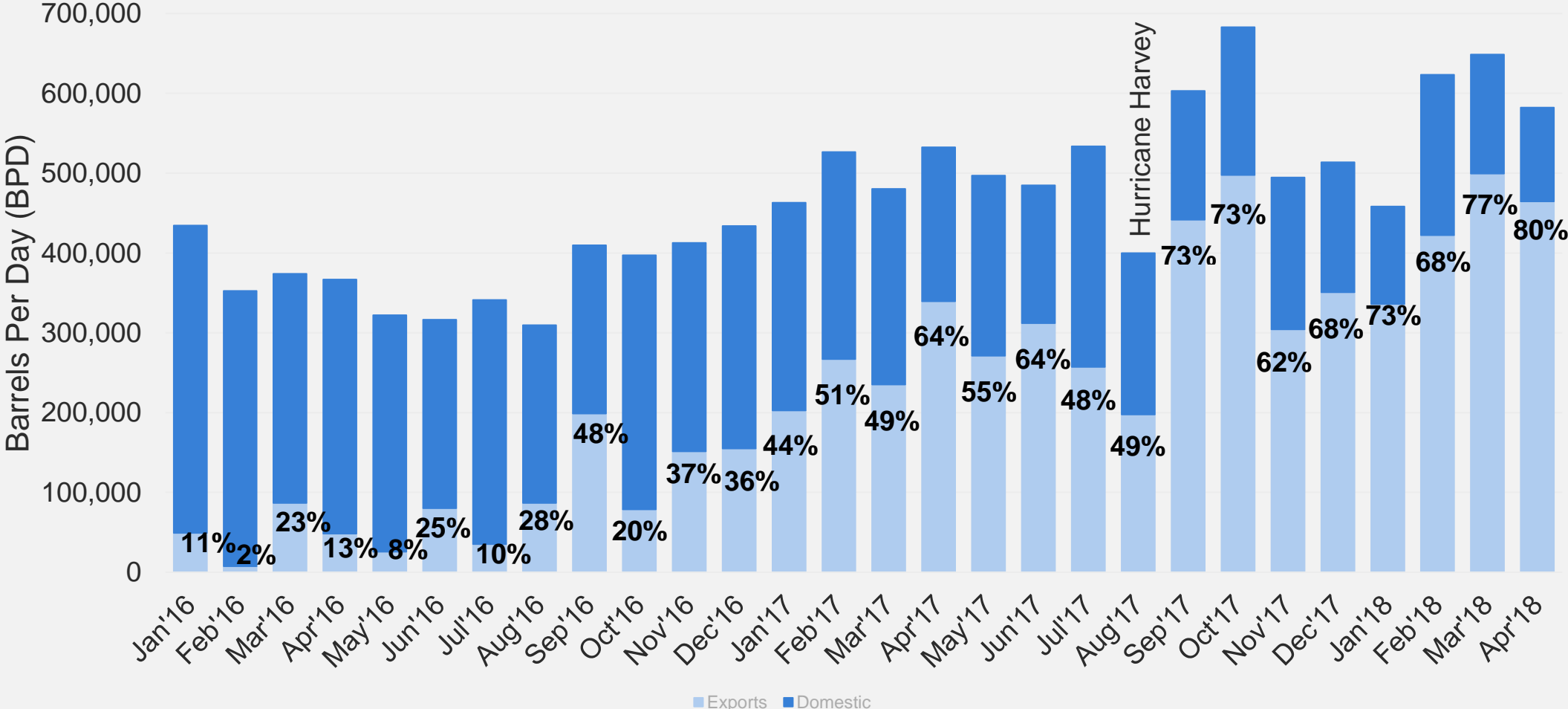

Permian Crude Oil Pipelines

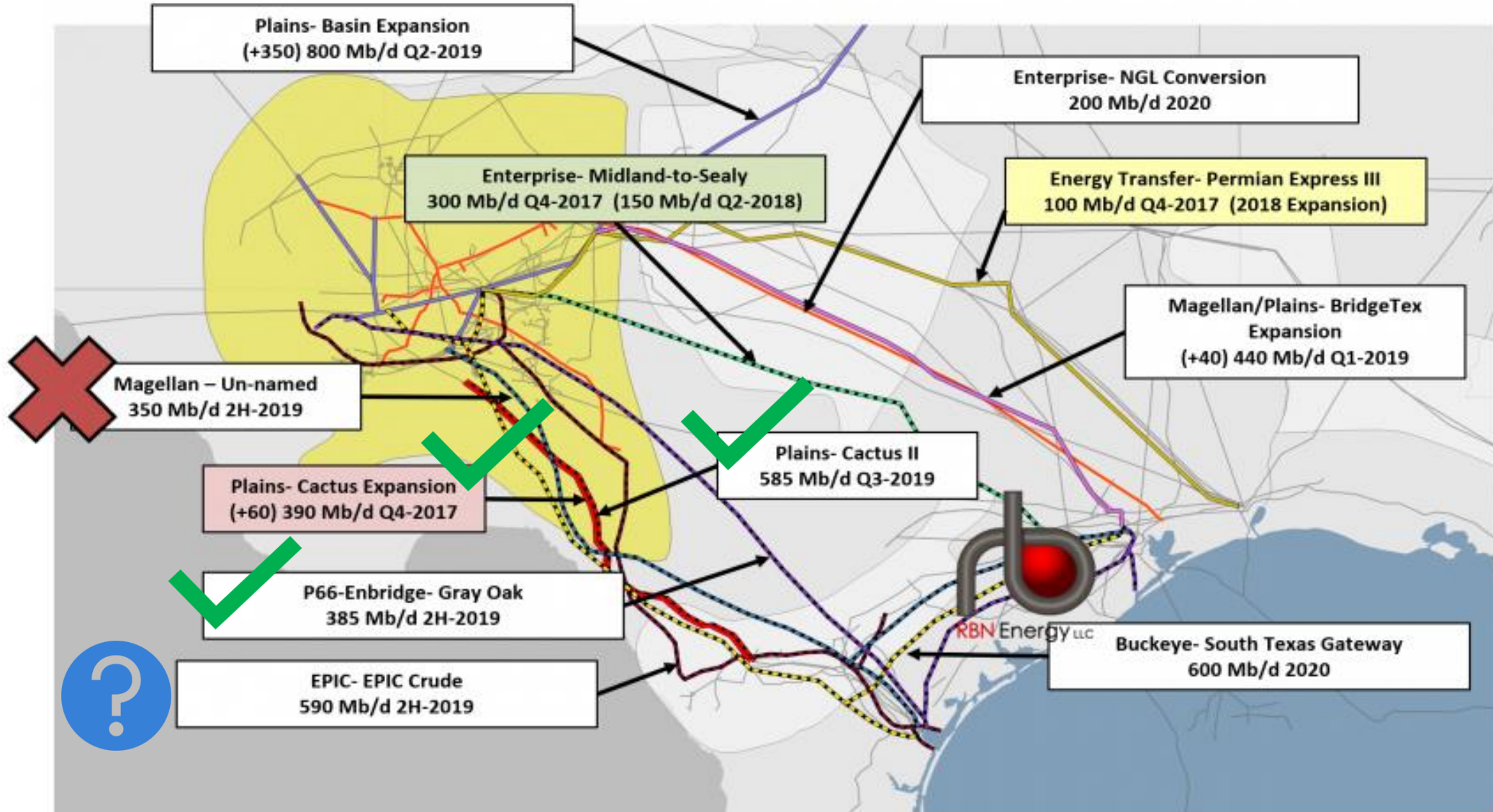

Channel Improvement Project

-54 FT MLLW
(Authorized)

156'

156'

200 FT
Barge Shelf

200 FT
Barge Shelf

400 FT
(Existing)

530 FT
(Proposed)



Channel Improvement Project – Funding & Specs





New Harbor Bridge

\$900 Million Project

\$85 Million Port Investment

- Longest US cable-stayed bridge
- 100 year life span
- 205' air draft clearance
- Hillcrest Washington-Coles Voluntary Acquisition & Relocation Program





Impact

Across Texas & Beyond

- Approximately \$40 billion annually in additional goods value exports
- Help reduce the nation's trade deficit
- Shipping cost savings estimated \$100 million
- Help US energy security



Harbor Island – VLCC Crude Oil Export Terminal

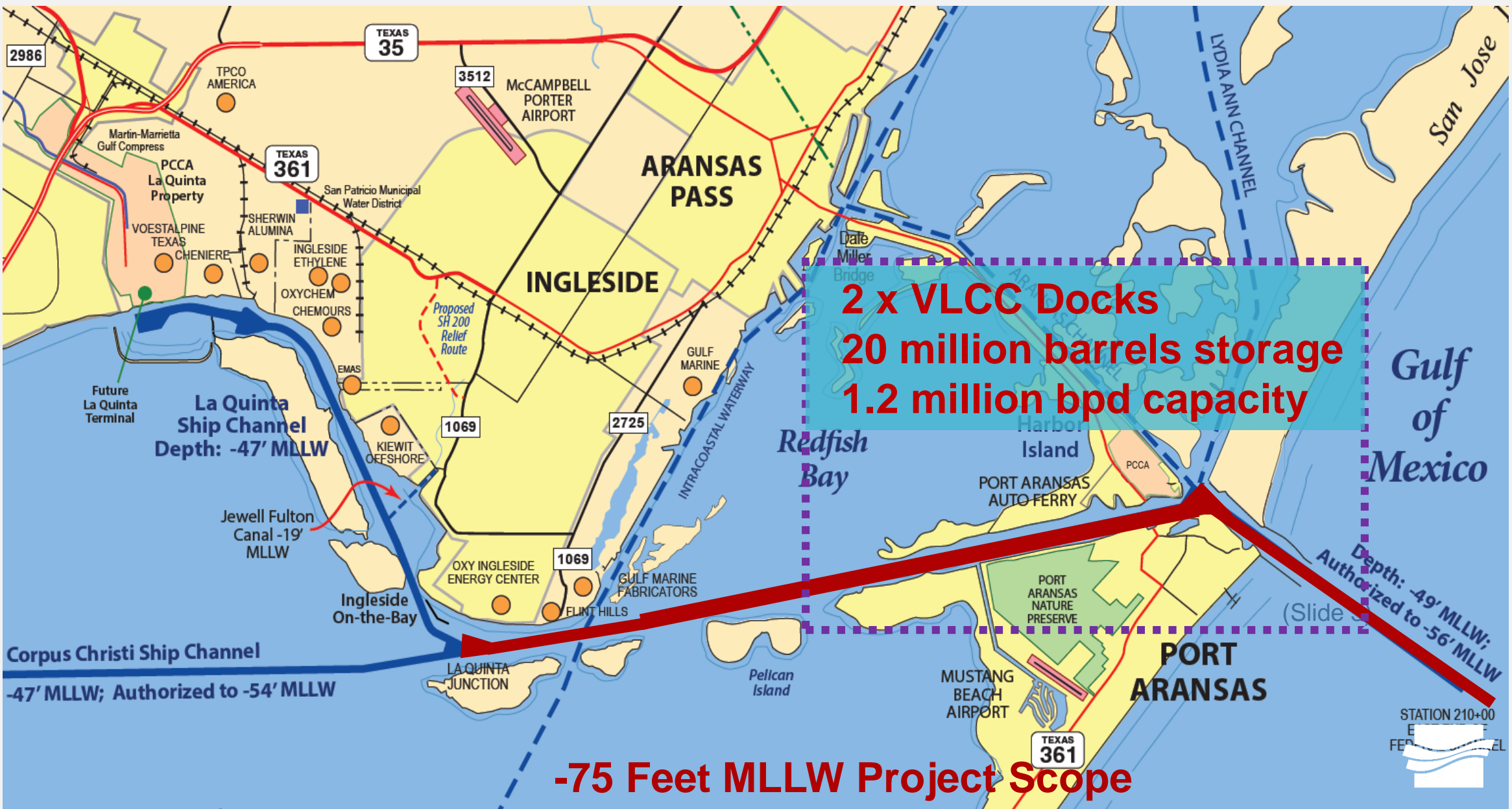

-75 Feet MLLW Project Scope



Railroad Improvement Projects

- Double rail road tracks from Nueces River Rail Yard to Bulk Terminal Loop Tracks
- GCCM / South Texas Cement – infrastructure for unit train transportation of imported cement to markets in South Texas
- Howard Energy / Maverick Terminal for loading unit trains with refined petroleum products for export to Mexico
- Project for expansion of Rincon West Yard up to 40 acres and railroad tracks for loading unit trains
- Potential project for adding double rail road tracks from Bulk Terminal to ADM grain terminal
- Potential project for adding railroad tracks at Permian Yard



Northside Permian Rail Extension & Yard

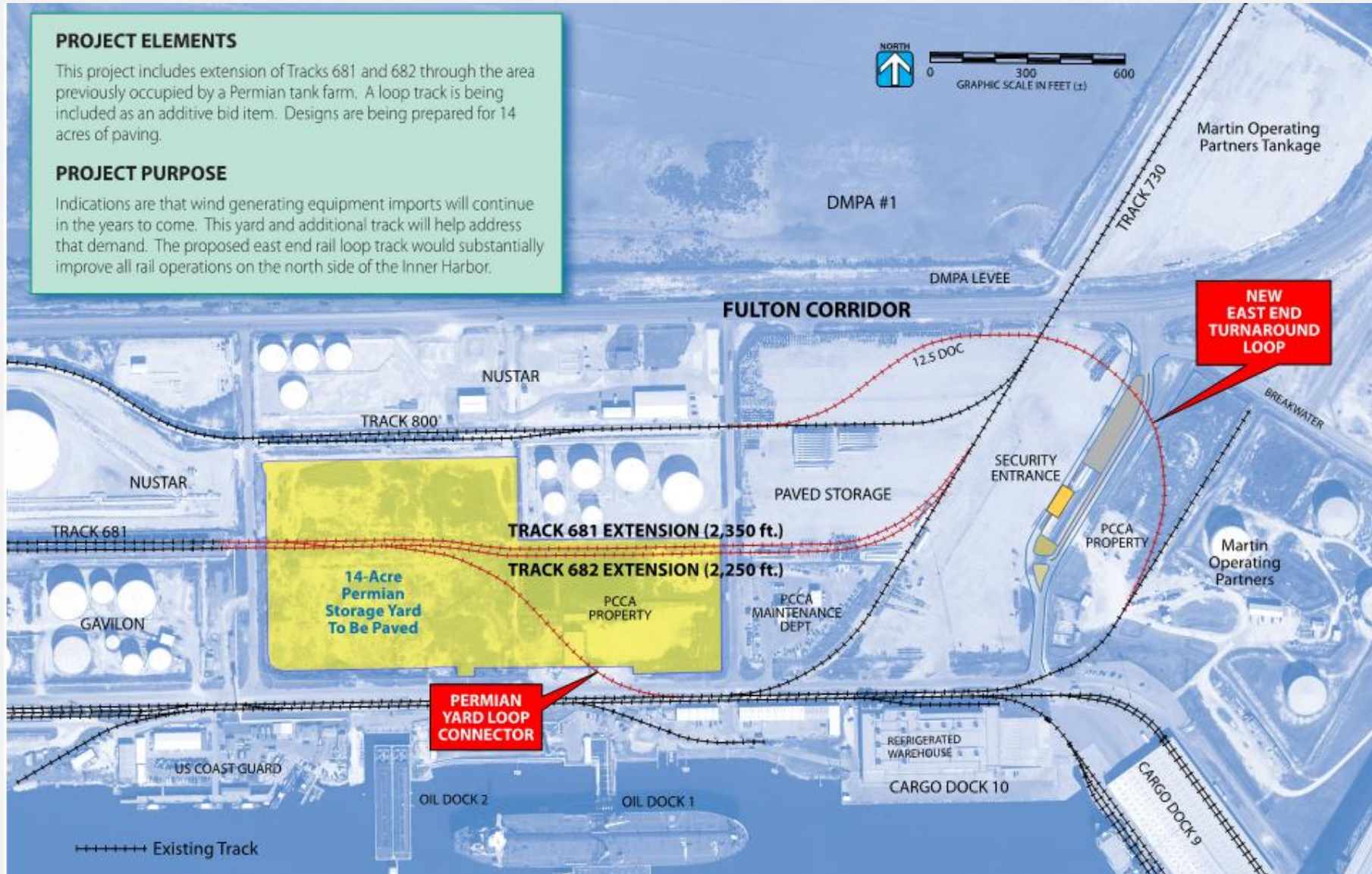



New 25-Acre Rincon West Yard

- Open storage for breakbulk cargo such as steel pipe, wind turbine components, etc.
- Potential expansion of Rincon West Yard to 40 Acres
- Potential rail development



Nueces River Rail Yard to Bulk Terminal Track

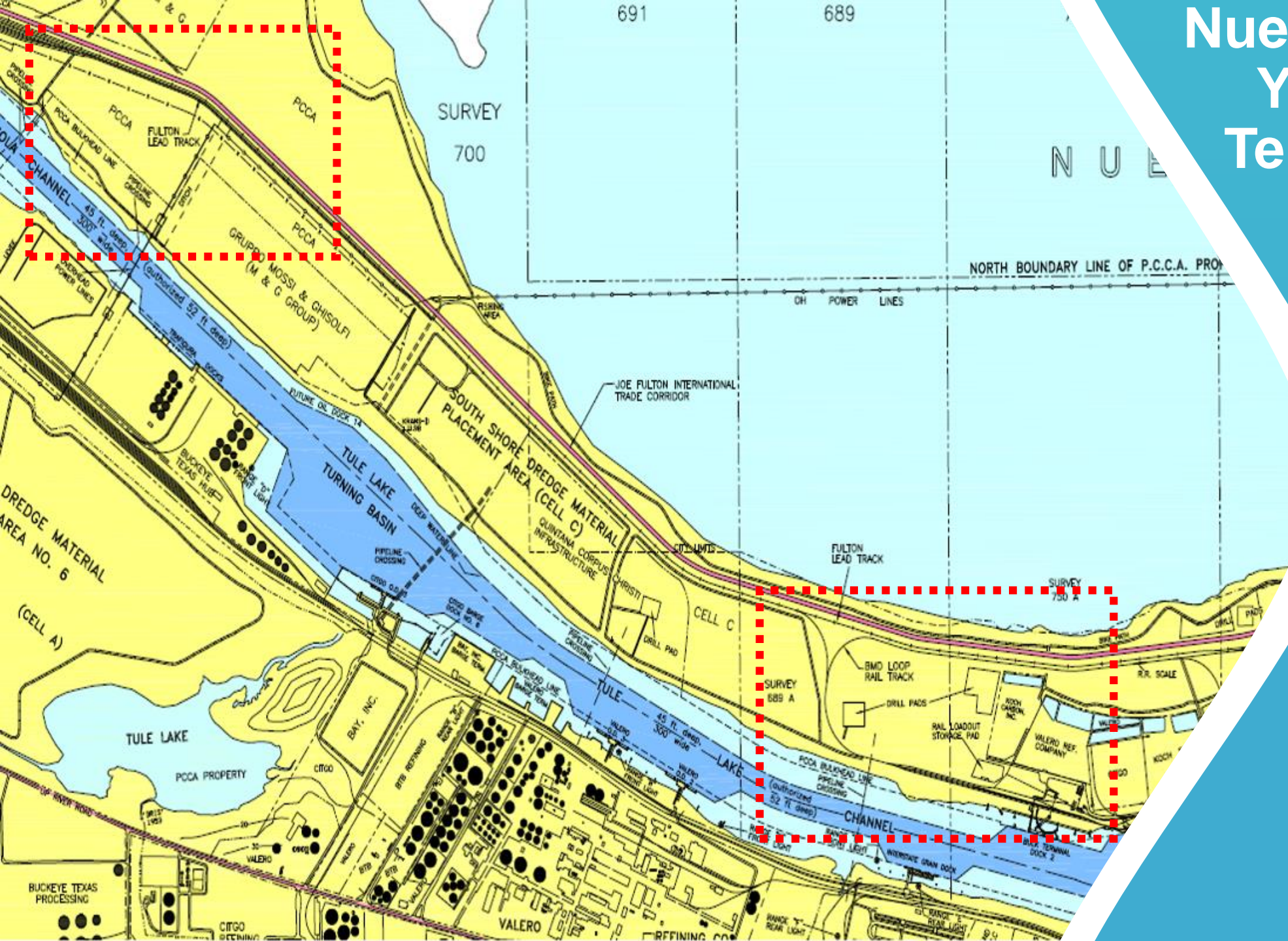

PORT CORPUS CHRISTI

PILLARS OF SUCCESS



Job Creation &
Economic Growth



Sustainability &
Environmental
Stewardship

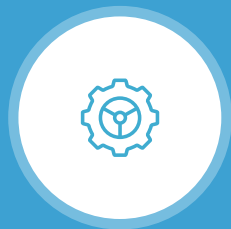

Educational &
Workforce
Development

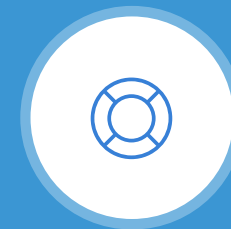

Safety & Corporate
Social
Responsibility

What Port Corpus Christi expects from companies it does business with. What they promise and what they deliver.



Environmental Policy

5 Key Precepts



- **AIR QUALITY** in attainment of national air quality standards
- **WATER QUALITY** that maintains or improves the health of coastal bend ecosystems
- **SOILS & SEDIMENT** protective of human health and the environment
- **WILDLIFE HABITAT** development, improvements, and replacement when modification to existing habitat is necessary
- **ENVIRONMENTAL SUSTAINABILITY** in the development of port facilities and in ongoing port operations





Texas Environmental Excellence Award

- ISO 14001: 2015 Environmental Management System
- The first Port in Texas to obtain Green Marine certification
- Policy which incorporates the evaluation of Environmental impacts
- Recycling over 1,000,000 pounds of materials
- Reduction in electrical and water consumption
- Conversion to 100% renewable energy sources in 2017
- Tenant Audit Program
- Requirement for Stevedores to have an EMS to be licensed for the Port
- Voluntary air monitoring program at the Bulk Terminal





Hurricane Harvey & Emergency Operations:

- Preparedness
- Resiliency & response
- Recovery & business continuity





THANK YOU
QUESTIONS?



PORTCORPUS CHRISTI®



Ship Channel Distances

FROM	TO	Nautical Miles
Station 210+00 In Gulf of Mexico	Port Aransas Inner Basin	3.9
	La Quinta Junction	12.5
	Harbor Bridge	22.1
	Bulk Terminal	25.5
	West End - Inner Harbor	29.4
	West End - La Quinta Channel	18.4
La Quinta Junction	La Quinta Terminal	5.3
	End of La Quinta Channel	5.9
	Harbor Bridge	9.6
Harbor Bridge	Bulk Terminal	3.4
	West End - Inner Harbor	7.5

- PORT AUTHORITY FACILITIES
- INDUSTRIAL OPERATIONS



Depth: -49' MLLW;
Authorized to -56' MLLW

STATION 210+00
EAST END OF
FEDERAL CHANNEL