

MIA PEARL SHOW – March 13, 2021
Hosted by Pearl High School and Pearl Band Auxiliary
GROUP AND SPECTATOR DETAILS

Host Contact:

Matt Rowan

Director of Bands, Pearl High School

mrowan@pearlk12.com

1. Unit Arrival / Parking

Groups should enter the first parking lot adjacent to the school for parking/warm up. There will be parking attendants to help with parking. Please follow their instructions. (See enclosed maps)

2. Unit Warm Up

For this show all warm ups will occur outside per the MIA. In the event of inclement weather, indoor warm ups will be provided. All units should warm up in the parking lot and not impede group parking. Please follow instructions from our traffic attendants. Units should make their way around the building for entry through our roll up door. Several turns will need to be negotiated inside the building as you make your way to the gym. (See enclosed Flow Map)

3. Spectator Parking

Spectators will park in our large student parking lot that is on the interstate side of the school. (See Map)

4. Spectator Admission

Admission is \$10.00. Tickets may be purchased in advance online using the link that follows. The paypal receipt and name of purchasing individual will need to be presented to pick up armbands at the admission table. ***ALL ONLINE TICKET PURCHASES AND WILL CALL REQUESTS MUST BE COMPLETED BY THURSDAY, MARCH 11.***

Up to 250 spectators will be allowed per session/class.

Any remaining tickets will be sold in person on a first come, first served basis on the day of the show.

Spectators will only need a ticket for 1 session. If you wish to view another session please complete the Will Call link to request entry for additional sessions. Viewing additional sessions should be limited to spectators with multiple students participating in separate groups. Anyone wishing to view multiple sessions will need to pick up additional armbands at the will call table.

The gym will be cleared following each session for cleaning. Masks will be required of

spectators as we are still under the K-12 governmental mask mandate.

ALL ONLINE TICKET PURCHASES AND WILL CALL REQUESTS MUST BE COMPLETED BY THURSDAY, MARCH 11.

ONLINE TICKET PURCHASE – PEARL MIA SHOW

<http://www.pearlpirateband.org/miapearl.htm>

WILL CALL – MULTIPLE SESSION VIEWING REQUEST

<https://docs.google.com/forms/d/e/1FAIpQLSdMhHzPBs31q1TY9OXvqK0AdARaqdQnu2Dn9mSZ1sB4EqkNzA/viewform>

5. Concessions

Concessions will be available on a limited basis.

6. Group Meal Deals

The Pearl Band Auxiliary is happy to provide meals for your group with prior notice. We will offer the choice of Hamburger, Hot Dog, or Chic-Fil-A meal deals. All Meal Deals are \$7.00 each.

Please complete the form linked below by no later than WEDNESDAY, March 10

MEAL DEAL LINK – MIA PEARL SHOW

https://docs.google.com/forms/d/e/1FAIpQLScSLY2SWF9ltRiZr7xgxBW-gfahp_9YYeFl240oNSLVBdb2Ww/viewform

WINTERBLAST PEARL MIA SHOW MAP
2021

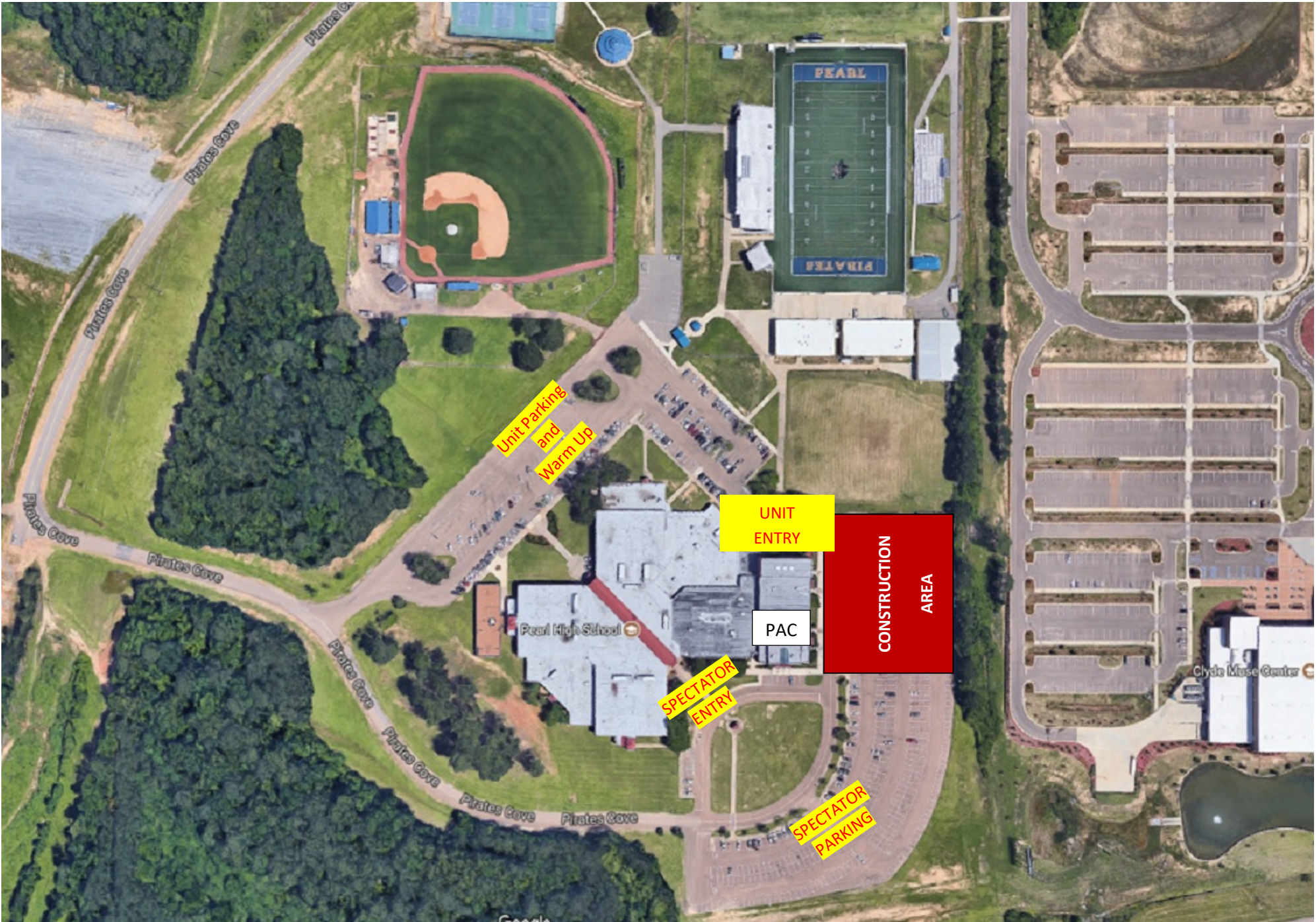

UNIT PARKING WARM UP

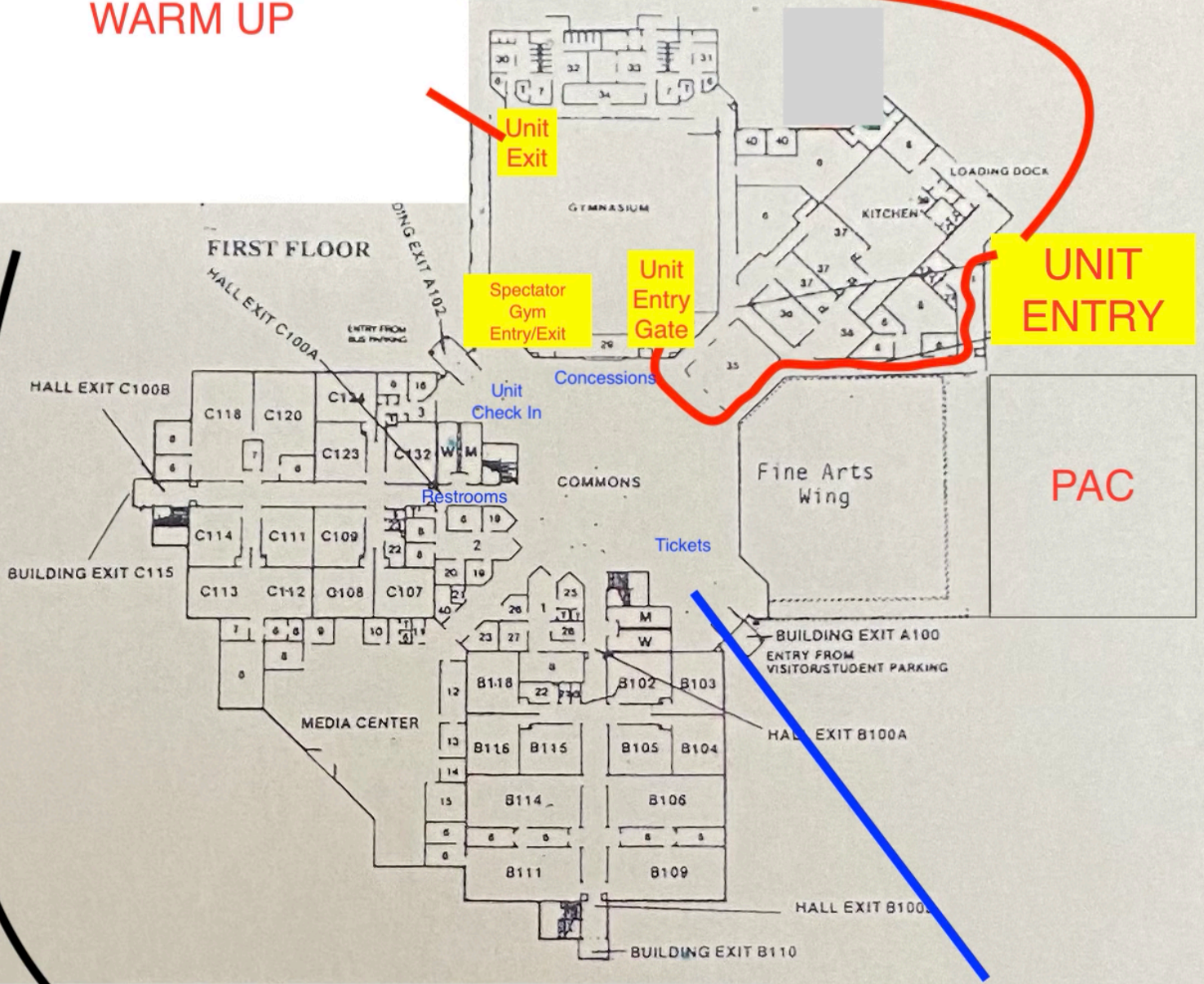

**UNIT
ENTRY**

PAC

**SPECTATOR
PARKING**

**PEARL HS
MIA
FLOW MAP
2021**