

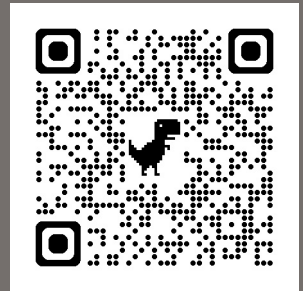

2025 CATALOG

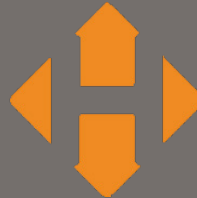

WWW.BETTERBRIX.COM



FAB-FORM
Sustainable Foundations



**HULK
SYSTEMS**



BETTER BRiX DISTRIBUTION
ICF MATERIALS, ACCESSORIES, CONSTRUCTION AND SUPPORT
SINCE 2015



ELEMENT ICF.....3

-ICF Accessories.....4

-ICF Electrical Boxes & Hot Knives5

-ICF Pool Kits.....6



HEAT SHEET.....7

RIGID EPS GRAPHITE INSULATION



HALO SUBTERRA-EXTERRA- INTERRA.....8



RIGID GRAPHITE EPS.....9



FORTRUSS SUSPENDED CONCRETE..... 10



HUG HYDRONICS..... 11



Sustainable Foundations

FORMS AND BRACING..... 12



ICF ALIGNMENT..... 13



**HULK
SYSTEMS**

..... 14



..... 17

SERVICES 23-26

ORDER FORMS27

BETTER

BRIX

DISTRIBUTION

ELEMENTICF[®]

LOGIX BRANDS

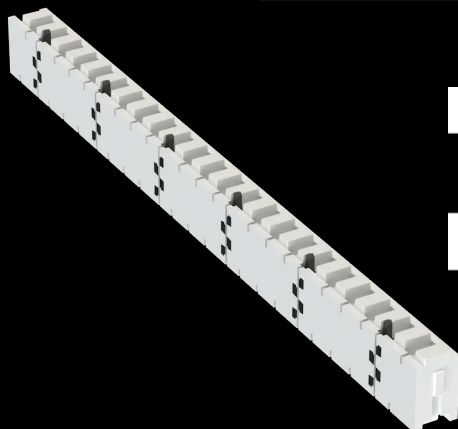
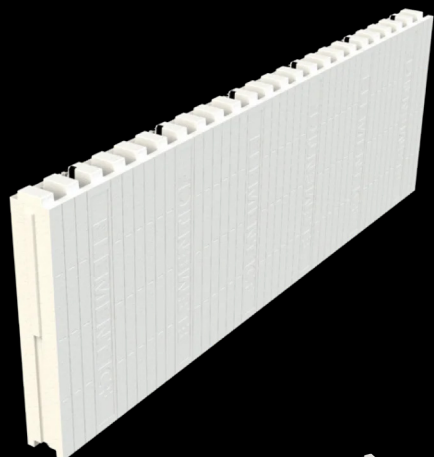
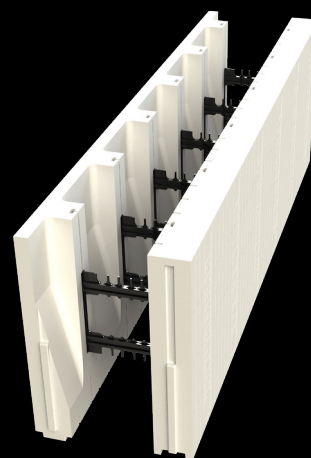
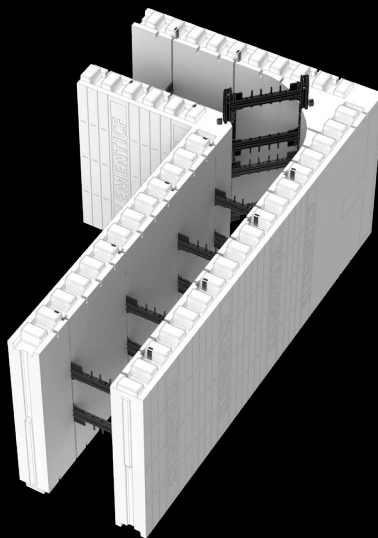
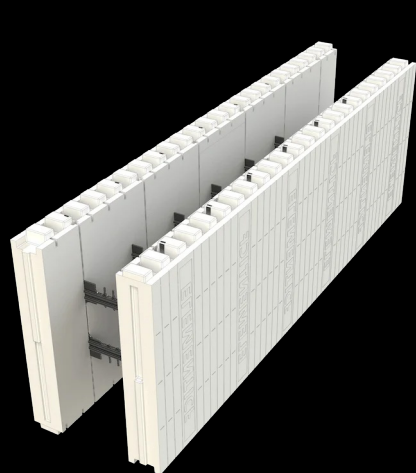

A PRODUCT BY

LOGIX[®]
BRANDS

Want To Build A High-Performance
Foundation, Home or Building?

ELEMENTICF[®]
LOGIX BRANDS

Keep it Simple.[™]

LEARN MORE

WWW.BETTERBRIX.COM
INFO@BETTERBRIX.COM
[509-305-1068](tel:509-305-1068)



ADFOAM PRO
 POLYURETHANE
 INSULATING FOAM & ICF
 ADHESIVES CLEANER AND
 APPLICATOR GUN

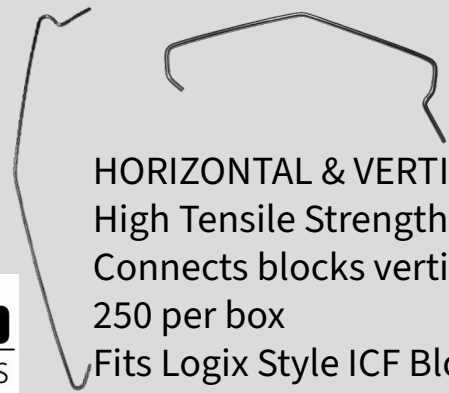

HORIZONTAL & VERTICAL HOOKS
 High Tensile Strength
 Connects blocks vertically
 250 per box
 Fits Logix Style ICF Blocks
 & ELEMENT ICF as needed



36" Heavy Duty Zip Ties
 175lb UV Black 50 ct bags

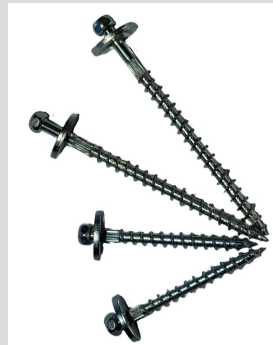

ICF SCREWS

#10 x 2" 500 /BOX
 #10 x 3" 400 /BOX

The screw features a loose washer design and is available in a 2" and 3" option. Each screw is hardened and galvanized for better strength. They have a coarse thread which works well with the plastic web of an ICF block.

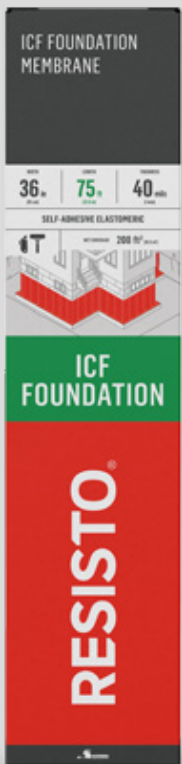

ICF FOUNDATION MEMBRANE

Self-adhesive membrane dedicated to the waterproofing of insulated concrete form (ICF) foundations. It is composed of 1 mm thick SBS modified bitumen and a trilaminate woven polyethylene. The underface is composed of a silicone release film. This membrane is primarily designed to waterproof insulated concrete form (ICF) foundations.

H2O PRIMER

This product is a polymer emulsion-based primer designed to improve the adhesion of self-adhesive waterproofing membranes on most substrates. It is particularly recommended when the use of solvent-based primer is not advised.



SINGLE GANG ICF BOX

DOUBLE GANG ICF BOX



TRIPLE GANG ICF BOX

**ICF HOT KNIFE- CORDLESS
or CORDED**





ICF POOL KITS

RECTANGULAR

12-24ft wide X 24-40ft long

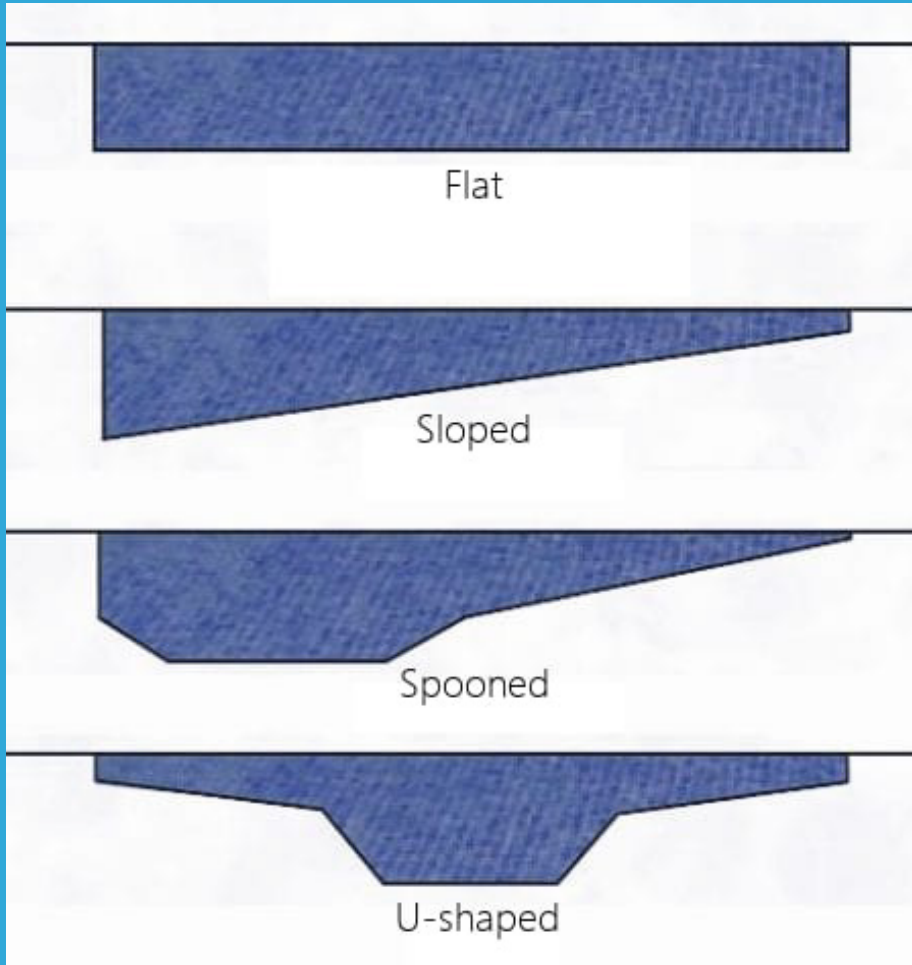

FLAT FLOOR
3' TO 5' deep

SLOPED FLOOR
3' to 9' deep

SPOONED
SHALLOW TO DEEP

SPORT FLOOR
3'- 6'- 3'

ELEMENT ICF by Logix Brands is an ideal choice when building swimming pools. Element ICF “6 Steps in 1” ICF offers EFFICIENCY builds that are typically faster than other methods. Plus, ELEMENT ICF blocks are easy to handle, Experts calculate that up to 80% of a pool’s heat is lost through its sides and bottom due to the fact that the ground conducts heat far more efficiently than air does. A durable ELEMENT ICF pool lowers your energy bills for years to come and can even extend your swimming season in northern climates.

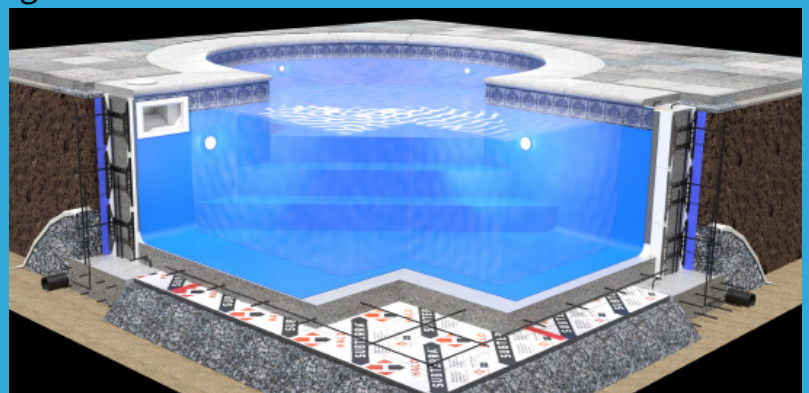



HEAT-SHEET®

BETTER
BRIx
DISTRIBUTION

A PRODUCT BY
LOGIX
BRANDS

*Heat-Sheet®
R4 - R16.1
Perfectly Designed for
Under-Slab,
Slab-On-Grade and
Retrofit Applications*

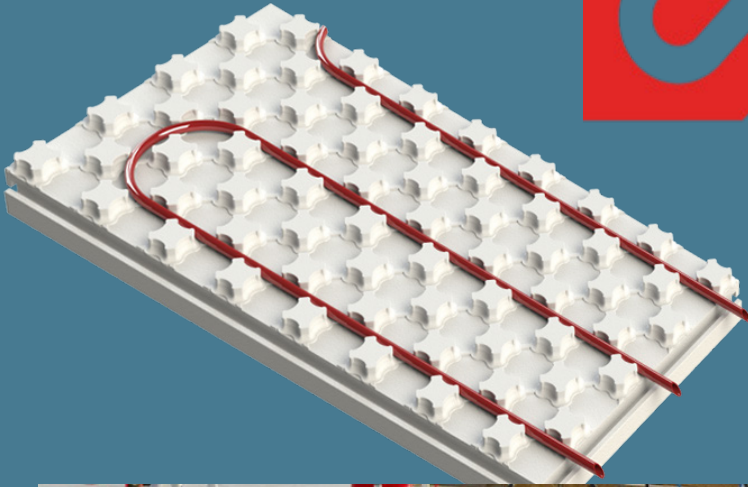
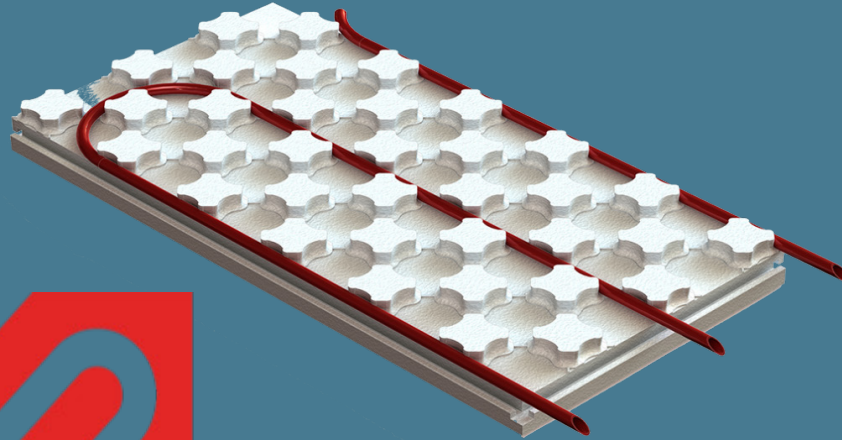

*Heat-Sheet® Heavy
R8 - R20
Perfectly Designed For
Snow-Melt,
Garage and Commercial
Heated Floors*



**WHY CHOOSE RADIANT
FLOOR HEATING?**

WWW.BETTERBRIX.COM

INFO@BETTERBRIX.COM

509-305-1068



A PRODUCT BY
LOGIX
BRANDS

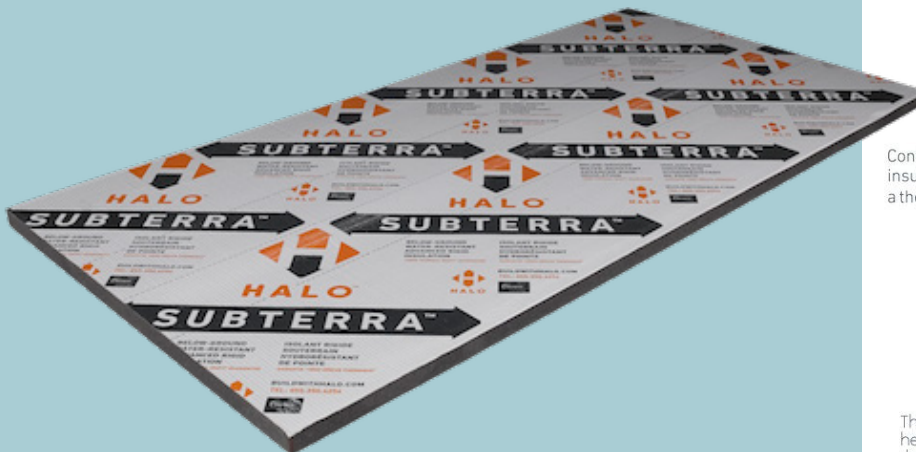
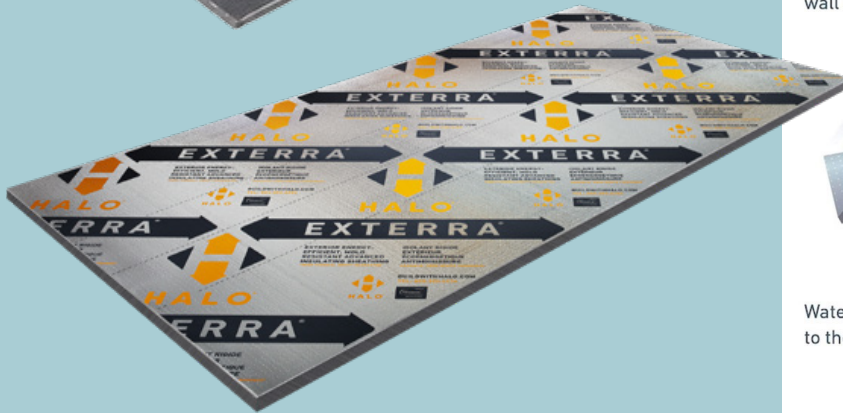
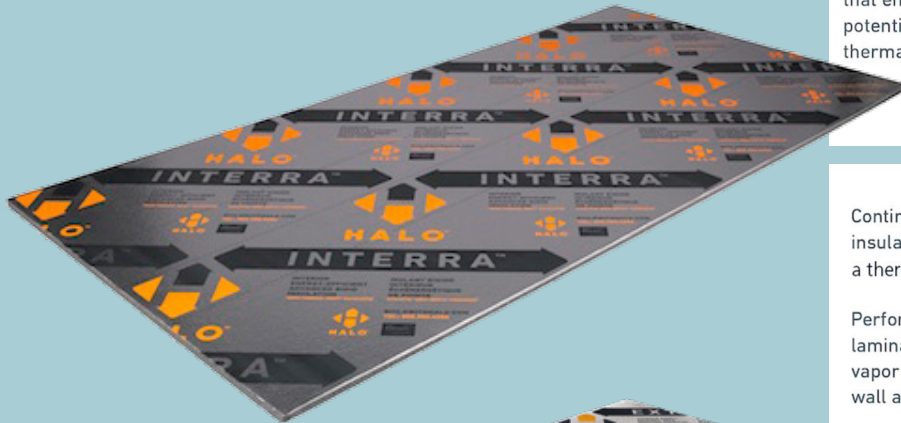

Continuous GPS
insulation creates
a thermal break

Reflective laminate
partially reflects
heat back to
the interior

Reflective
laminate provides
continuous
vapor barrier

Strapping
creates air gap
that enables
potential gain in
thermal performance.

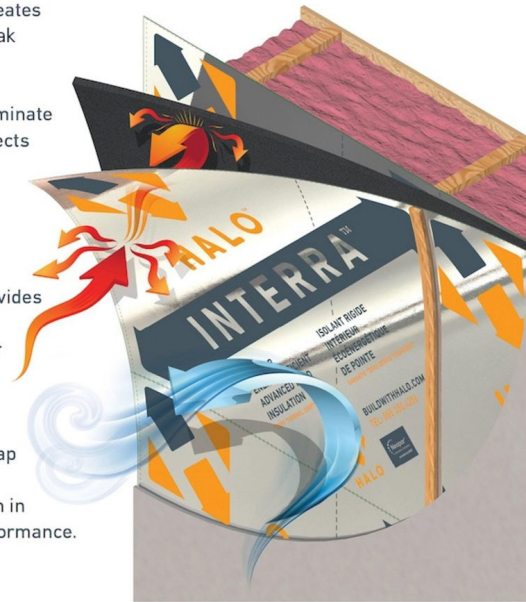

Continuous GPS
insulation creates
a thermal break

Perforated
laminate allows
vapor to escape
wall assembly

Water & air kept
to the exterior

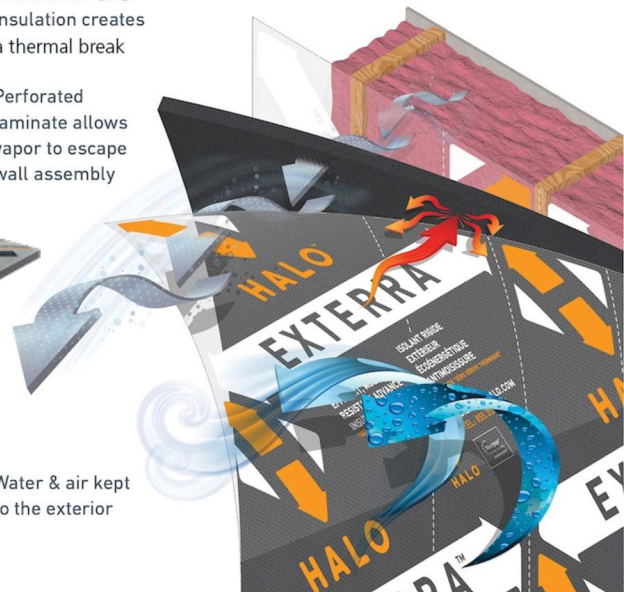

Foundation Wall

Protects waterproofing

Continuous GPS
insulation creates
a thermal break

Thick polypropylene film
helps drain water from
the foundation wall.

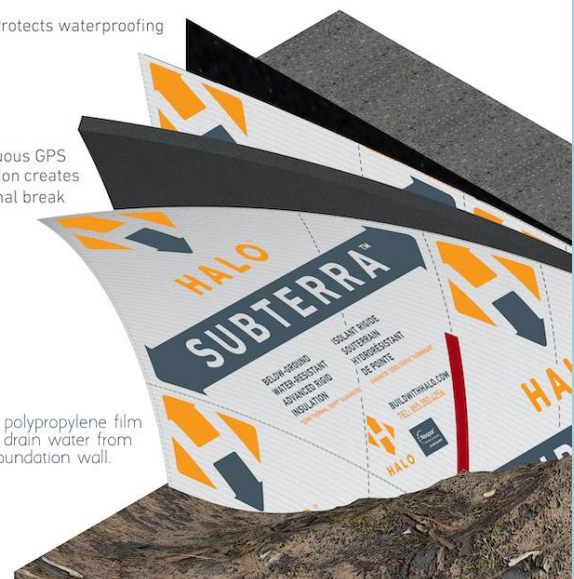

A PRODUCT BY

LOGIX[®]
BRANDS

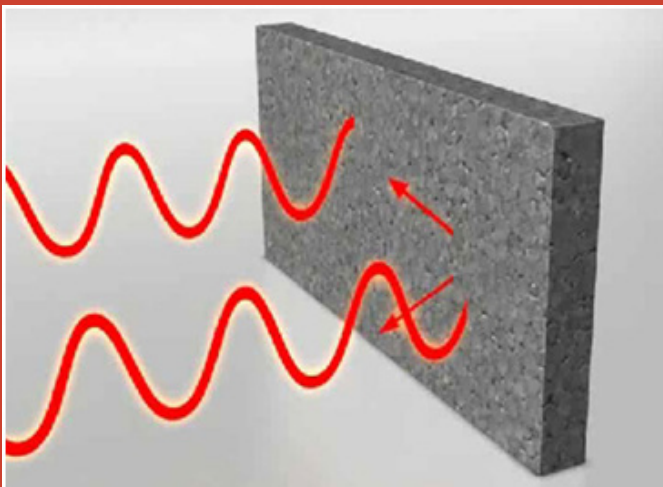
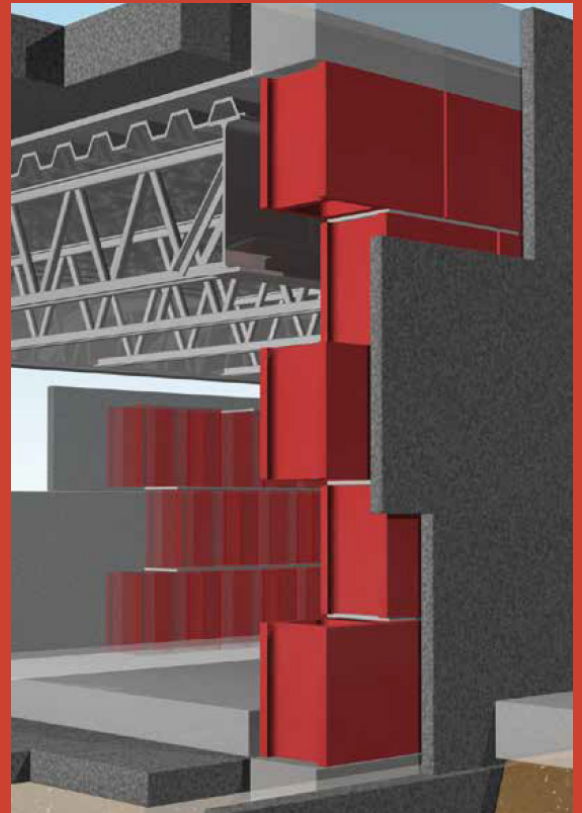

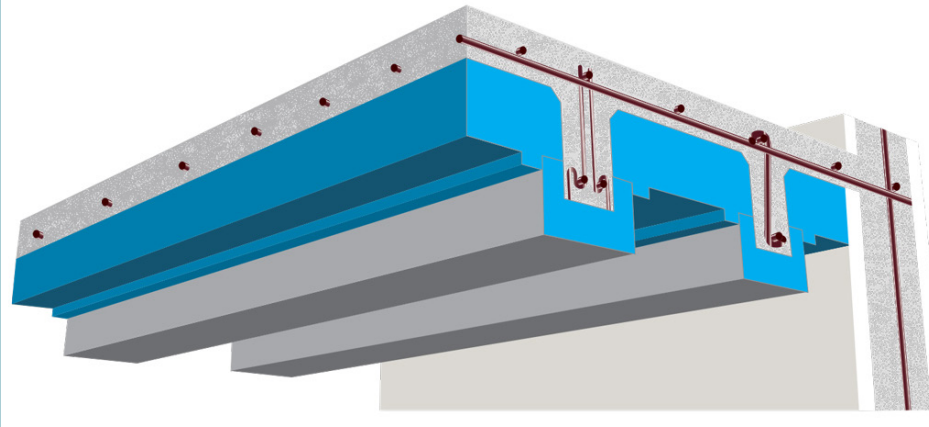

SUSPENDED STRUCTURAL SLABS



Insulated Suspended
Structural Slab

RESIDENTIAL &
COMMERCIAL

- Floor
- Deck
- Roof
- Green Roof

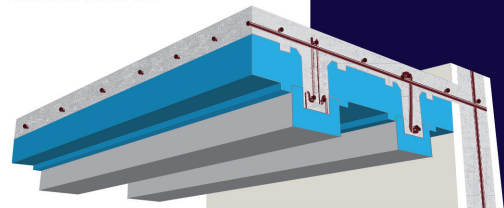

Learn **More** >>

BETTER
BRIX
DISTRIBUTION

Authorized Dealer

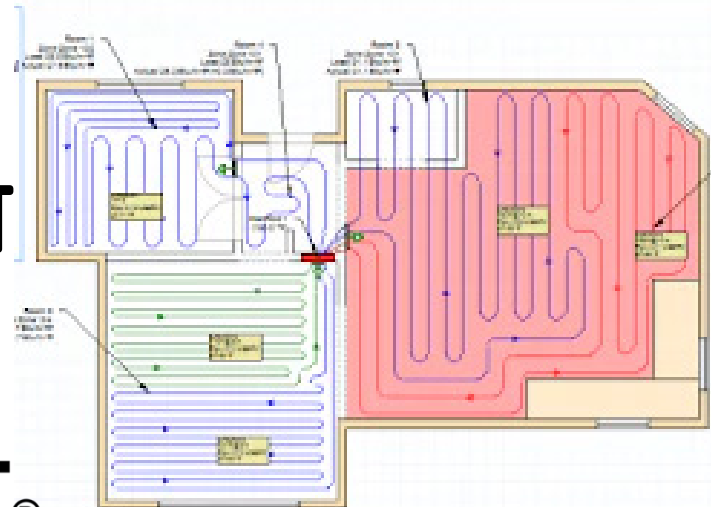
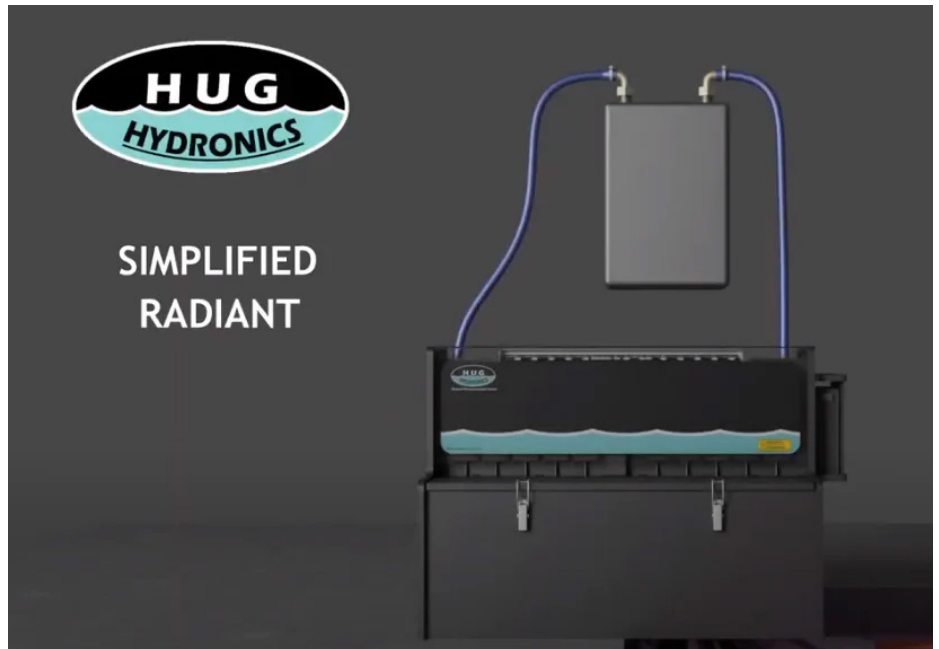

**HYDRONIC IN FLOOR HEAT
SYSTEM FOR USE WITH:**



HEAT-SHEET®

FAB-FORM

Sustainable Foundations

ZONT™ BRACING



The Zont system is the most cost effective and efficient bracing solution for your ICF walls.

Zont water bracket locks the 2x4 walers and strongbacks against your ICF wall to flatten the wall vertically and horizontally. The patented polycarbonate cam is twisted to quickly lock the lumber in place.

Lightweight Zuckle wall aligners rapidly adjust with an electric drill to ensure the top of your wall is perfectly aligned with your stringline.

Lightweight ZAT folding walkway brackets provide over 24" of waist high width to build and adjust the top of your wall.

ZONT

Polycarbonate cam for locking lumber
Zinc plated for long life

Strong 10 gauge steel
Strengthening rib

ZUCKLE

Stake hole
Acme thread for durability
9/16" socket end
Zinc plated for long life
5 gauge steel for high strength

ZAT

Zinc plated for long life
Angled post provides 24" of hip level space
Folds flat for easy storage
Lightweight 7.4 lbs.
Strong 10 gauge steel

www.FAB-FORM.com
(888)303-3278

YouTube Facebook Instagram

FASTFOOT®

Green from the ground up





www.fastfoot.com
(888)303-3278

Giraffe's Turnbuckle ICF bracing system was developed in the early 2000's, and is now an industry icon, available across North America & the World. Every major ICF manufacturer strongly recommends turnbuckle bracing, and some even sell ICF Bracing Systems at a cost that hopefully encourages ICF Contractors to use it systematically.

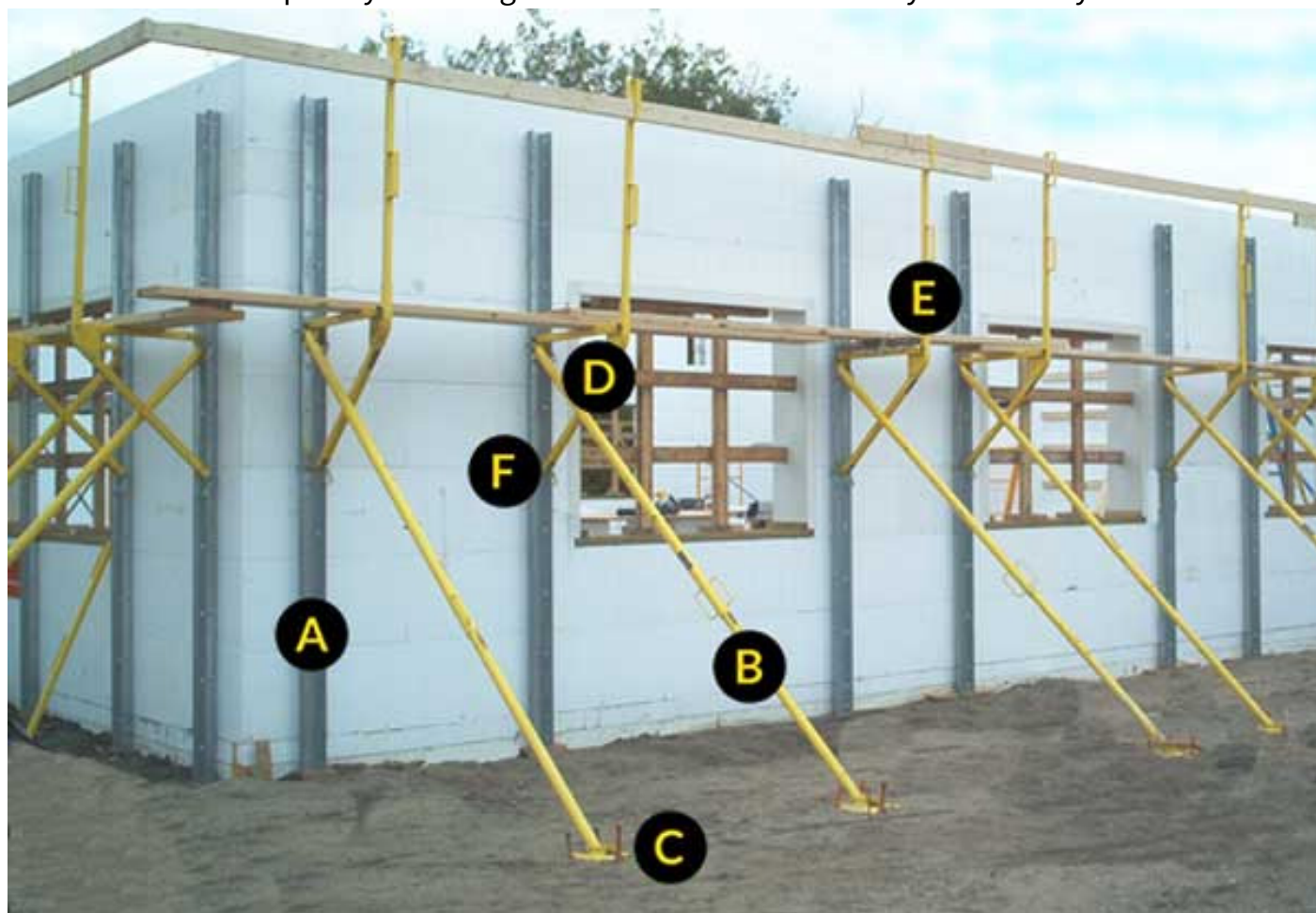

The Giraffe ICF bracing system includes a straightback (A), adjustable leg with internal screw (B), stamped footplate (C), platform bracket (D), safety rail (E) and self-locking gravity pins (F).

The Standard 8', 10' or 12' Giraffe ICF Bracing and Wall Alignment System comes with:

- 1 – 8', 10' or 12' stackable straight back
- 1 – Removable straight back foot plate
- 1 – Adjustable diagonal brace with double connector foot plate
- 1 – Foldable platform bracket
- 1 – Guard rail post
- 2 – 18" steel anchor stakes (may not be suitable for all soils)
- 2 – Self-locking gravity pins

MULTIPLE SOLUTION OFFERINGS FOR **WATERPROOFING**



The Hulk Systems product line offers next evolution solutions. Our entire lineup has been designed to protect EPS and XPS foam surfaces from water and fire as well as traditional structural substrates such as concrete, wood and metal.



LOW SLOPE XPS ROOF SYSTEMS (1 HOUR+ BURN COATING)

- Waterproofing for Foam, Concrete, SBS, and Spudded Tar & Gravel
- Single Layer Application on Majority of Substrates
- Cold Applied with a 1 Hour Burn Rating, Class "A" Fire Resistant Coating
- Friendlier to Apply than Polyurea for Users and Equipment
- Better Abrasion Resistance and Flexibility than Polyurea
- Primer for Bitumen and Aliphatic Topcoat for Color Retention Available

ICF POOL LINING SYSTEM

- Cementitious Composite Base with Marine Epoxy Top-coating
- Simplified 3 Step Application Process VS Competitive Systems
- High Build to Remove ICF Wall Profile
- Long lasting Waterproof Pool Liner
- Tested for Pressure Resistance and Freeze/Thaws
- Good for Pool Walls & Floors

COMPOSITE WATERPROOFING SYSTEMS (CLASS "A" F.R.)

- Available in Acrylic, STPE, and Cementitious Options
- Color Options of Grey, Black, White and Green
- Monolithic / Seamless
- Strengthens and Helps Stabilize Substrate
- Waterproof & Class "A" Fire Resistance
- Easily Applied

STUCCO / EIFS SYSTEM (NON-COMBUSTIBLE MATERIAL)

- Cementitious Composite Base and Aggregate Infused Topcoat
- Simplified 3 Step Application Process VS Competitive Systems
- High Build to Remove Wall Profile Including ICF Blocks
- Waterproof & Class "A" Fire Resistance
- Textured & Tinted for Stucco Look
- Easily Applied with Hopper

WASHABLE SYSTEM (NON-COMBUSTIBLE & 1+ HOUR BURN COATING)

- Transforms Drywall, Foam, Precast, Wood into Washable Surfaces
- Endures Multiple Daily Wash Cycles at High PSI
- Monolithic / Seamless
- Strengthens and Helps Stabilize Substrate
- Custom Tinting Available
- Offers the Highest in Fire Resistant Finish Options

BETTER
BRiX
DISTRIBUTION

☎ Office Phone **509-203-6073**
☎ Cell Phone **509-305-1068** Email
✉ **INFO@BETTERBRIX.COM** for details
📍 1500 Mapleway Rd Yakima WA 98908



FLOORING & POOL STANDARD COLOURS



**HULK
SYSTEMS**

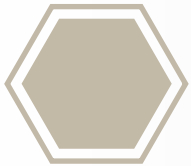

Tropic Beige

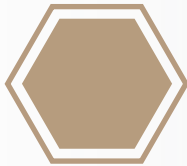

Tan



Ivory Beige

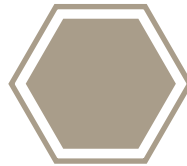

Stone Beige



Dorian Grey



Moonlight Grey



Oyster Grey

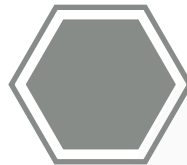

Platinum Grey



Slate Grey



Charcoal Grey



Gun Metal Grey



Silver Grey



Safety Green



Safety Yellow

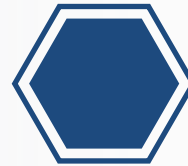

Royal Blue

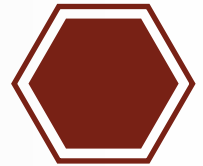

Tile Red



Signal Red



Orange



White



Black



Ocean Blue

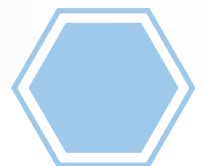

Sky Blue



Ice Blue



Pebble Grey

Hulk System offers a number of standard epoxy-based colours. We can also develop a customized colour to suit your needs, providing a minimum order and adequate lead time. Contact us for qualifying information. This chart is intended as a reference guide only. Printer colour representations may vary slightly from the actual colours. Standard colours may not apply to all Hulk System products.

BETTER
BRiX
DISTRIBUTION



Office Phone **509-203-6073**

Cell Phone **509-305-1068**



Email **INFO@BETTERBRIX.COM** for details



1500 Mapleway Rd Yakima WA



HULK SYSTEMS

ICF BLOCK SYSTEM

Fully protect your ICF with a single seamless system in 3 easy steps, rather than requiring layer upon layer of primers, membranes, peel n' stick, drainage wrap, and protective board products. From the footing up, the monolithic Hulk ICF Block Systems leaves no seams, or joints where water can get behind the system.

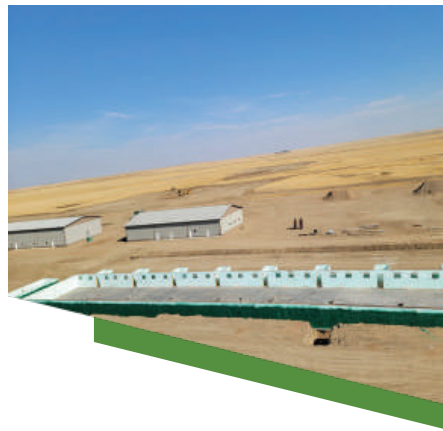

REINFORCE YOUR FOAM

The problem with traditional peel n' stick membrane products, is you can puncture them all extremely easily, and they are significantly compromised during back-filling. So much so, that the damaged lengths can create chambers that hold trapped water rather than protect against it. Hulk not only adds an incredible amount of impact and abrasion resistance to your ICF, but it also creates an ultra-durable shell of protection that keeps water out of your block and away from your concrete.

BETTER
BRIX
DISTRIBUTION



Office Phone **509-203-6073**

Cell Phone **509-305-1068**



Email **INFO@BETTERBRIX.COM** for details



1500 Mapleway Rd Yakima WA 98908



PREMIUM REINFORCEMENT

The #1 Solution for Concrete Reinforcement



Fiberglass Rebar

A Stronger, Lighter, Greener and More Durable Reinforcing Alternative to Steel

Manufactured by MST Rebar Inc.



Specs



MST-BAR® Grade III GFRP

PREMIUM REINFORCEMENT

IMPERIAL		#2	#3	#4	#5	#6	#7	#8	#9	#10	#11
METRIC		6	10	13	16	20	22	25	29	32	36
Minimum Tensile Load	kN	33	74	132	202	285	390	507	650	819	1000
	lbf	7419	16636	29675	45411	64070	87675	112180	146126	184118	224810
Cross Sectional Area	mm ²	32	71	132	201	285	387	491	645	819	1007
Weight	kg/m	0.12	0.22	0.35	0.5	0.7	0.9	1.22	1.4	1.72	2.15

Guaranteed Tensile Strength

>1000 MPa
>145 Ksi

Young's Modulus, E

>60GPa
>8702KSI

Ultimate Strain, ε_{fu}

>1.7%

Transverse Shear Strength, τ

>220 MPa
31.9 ksi

Bond Strength to Concrete

20 MPa Minimum
2900 Psi Minimum

Strength of Bend (Straight Portion)

>900 MPa

Strength of Bend (Bend Portion with Minimum Radius Bend : 4x Diameter of Bar)

>600 MPa

Young's Modulus, E (Bend Bar)

50 GPa

Glass Transition Temperature, T_g*

125C°

Products

STRAIGHT BAR

- Structural and non-structural rebar
- Available in custom lengths (4ft - 60ft)
- Diameters in stock: 10mm - 25mm
- Custom diameters up to 55mm



BENT BAR

- Structural bent rebar
- Custom shapes for any project

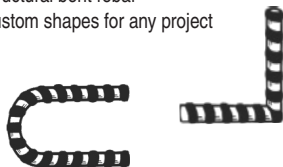

EMAIL SALES@MSTBAR.COM FOR A QUOTE

Applications

MST-BAR™ is suitable anywhere that steel rebar is used. It is especially beneficial to use in coastal areas, near high voltage currents and near magnetic fields. For example:

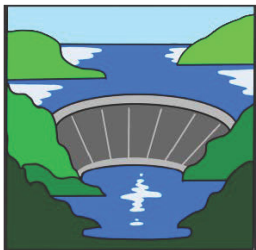

DAMS

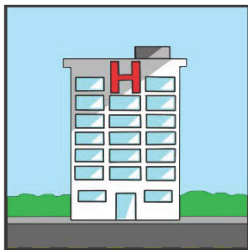

BUILDINGS



ROADS AND BRIDGES

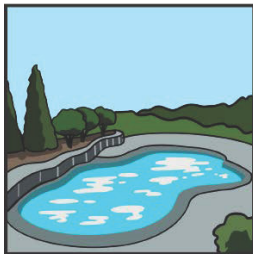

POOLS AND PATIOS



PIERS

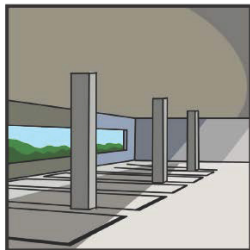

PARKING GARAGES

IMPERIAL		#2	#3	#4	#5	#6	#7	#8	#9	#10	#11
METRIC		6	10	13	16	20	22	25	29	32	36
Minimum Tensile Load	kN	33	74	132	202	285	390	507	650	819	1000
	lbf	7419	16636	29675	45411	64070	87675	112180	146126	184118	224810
Cross Sectional Area	mm ²	32	71	132	201	285	387	491	645	819	1007
Weight	kg/m	0.12	0.22	0.35	0.5	0.7	0.9	1.22	1.4	1.72	2.15

Guaranteed Tensile Strength	>1000 MPa >145 Ksi
Young's Modulus , E	>60GPa >8702KSI
Ultimate Strain , ε _{fu}	>1.7%
Transverse Shear Strength , τ	>220 MPa 31.9 ksi
Bond Strength to Concrete	20 MPa Minimum 2900 Psi Minimum

Strength of Bend (Straight Portion)	>900 MPa
Strength of Bend (Bend Portion with Minimum Radius Bend : 4x Diameter of Bar)	>600 MPa
Young's Modulus , E (Bend Bar)	50 GPa
Glass Transition Temperature, T _g °	125C°

The #1 Solution to Concrete Reinforcement

sales@mstbar.com

www.mstbar.com

416-740-0344

MST-BAR® Manufactured by MST Rebar Inc.

Compliance

USA:

- ACI 440.11-22
- ASTM D7957/D7957M-17
- AASHTO LRFD for GFRP-18
- ICC-ES AC454
- ICC-ES AC521
- Section 932-3 of Florida DOT Canada:
- CAN/CSA S807-19
- CAN/CSA S806-12 (R2017)
- CAN/CSA S6-19
- MTO- 9.65.90
- SIMTReC Design Manual No. 3 (Version 2)
- SIMTRec Design Manual No. 5



ON SITE TRAINING/CONSULTING/JOB SUPPORT
BY APPOINTMENT
& SCHEDULED IN ADVANCE
(FEE BASE ON TRAVEL DISTANCE,
TIME ON JOB, AND JOB FUNCTION)

INSTALLATION OF ICF PRODUCTS/SERVICES
PLACEMENT OF REBAR & CONCRETE
PUMPING OF CONCRETE:
CONTACT FOR APPROVED CONTRACTOR LIST





**TRADITIONAL
DESIGNS INC.**

RON PELSON & BRAD KESSINGER

Office: (509) 452-7604

402 W. Chestnut Ave. Yakima, WA 98942

www.Traditionaldesignsinc.com

*CUSTOM ICF DESIGN:
plans, engineering, permitting
& enegry forms*

FULL ICF INSTALLATION:
FOOTINGS, STEMWALL, WALLS, REBAR,
CONCRETE & ALIGNMENT



WWW.BETTERBRIX.COM INFO@BETTERBRIX.COM 509-305-1068



THE WEST COAST 1250 WITH BASEMENT DESIGN



ELEMENTICF®
LOGIX BRANDS

FEATURES:

2 Storeys , 4 Bedrooms, 4 Bathrooms,
Kitchen, Living Room (Including Basement)

INTERIOR LIVING SPACE:

Main Floor - 914 sq ft

Second Floor - 385 sq ft

Basement - 864 sq ft

APPROXIMATE EXTERIOR DIMENSIONS:

39' W x 31' D



ROOM SCHEDULE:

Name	Level	Area	Perimeter
Bathroom 3	Basement	23' - 9 13/16"	34.58 SF
Bedroom 4	Basement	43' - 1 7/32"	92.43 SF
Foyer	Basement	110' - 9 5/32"	165.87 SF
Home Gym	Basement	69' - 6 15/16"	247.89 SF
Laundry	Basement	41' - 4 5/32"	99.05 SF
Living Room 2	Basement	56' - 3 17/32"	194.11 SF
Office Nook	Basement	22' - 6 5/8"	31.77 SF
Bathroom 1	Main Floor	29' - 4 27/32"	50.34 SF
Bedroom 1	Main Floor	39' - 9 13/32"	98.90 SF
Bedroom 2	Main Floor	39' - 8 3/8"	98.47 SF
Foyer	Main Floor	85' - 8 7/8"	183.75 SF
Kitchen	Main Floor	47' - 11 7/16"	134.12 SF
Living Space	Main Floor	69' - 7 7/16"	248.36 SF
Bathroom 2	Upper Level	33' - 2 3/32"	62.53 SF
Primary Bdrm	Upper Level	99' - 4 19/32"	300.12 SF

Copyright of Logix Brands Ltd. All Rights Reserved.

https://elementicf.com/wp-content/uploads/2024/04/ELE_Small-Homes-Catalogue_040324_web.pdf



Small Home Designs
These attractive small home designs are crafted to provide families with strong, disaster-resilient homes that are comfortable, energy-efficient and affordable.



THE HEARTLAND 1250

DESIGN



ELEMENTICF[®]
LOGIX BRANDS

FEATURES:

3 Bedroom, 2 Bathroom, Kitchen, Living Room

INTERIOR LIVING SPACE:

1,161 sq ft

APPROXIMATE EXTERIOR DIMENSIONS:

32' W x 46' D



ROOM SCHEDULE:

Name	Level	Area	Perimeter
Bedroom 3	First Floor	138 SF	46' - 7 1/4"
Closet. 3	First Floor	18 SF	23' - 3 1/8"
Primary Suite	First Floor	163 SF	50' - 5 5/8"
Utility	First Floor	36 SF	23' - 11 3/4"
Primary Bath	First Floor	59 SF	38' - 2 5/8"
WIC	First Floor	26 SF	23' - 0 3/4"
W.C.	First Floor	14 SF	15' - 10 1/8"
Shower	First Floor	13 SF	14' - 5"
P.	First Floor	24 SF	19' - 4 5/8"
Primary Hall	First Floor	22 SF	20' - 11 1/8"
Hall	First Floor	20 SF	17' - 11 1/2"
Hall Bath	First Floor	48 SF	29' - 3 1/2"
Bedroom 2	First Floor	139 SF	68' - 3 7/8"
Closet. 2	First Floor	11 SF	14' - 11"
Kitchen	First Floor	176 SF	59' - 9 3/8"
Living Room	First Floor	206 SF	57' - 7"
Hall	First Floor	106 SF	67' - 8 3/8"

Copyright of Logix Brands Ltd. All Rights Reserved.

https://elementicf.com/wp-content/uploads/2024/04/ELE_Small-Homes-Catalogue_040324_web.pdf



Small Home Designs

These attractive small home designs are crafted to provide families with strong, disaster-resilient homes that are comfortable, energy-efficient and affordable.

WWW.BETTERBRIX.COM

INFO@BETTERBRIX.COM

509-305-1068



To request estimates please send:

- PDF of Full Plans & Elevations
 - Project Specifications
 - Building Jurisdiction
 - Estimated start/completion
 - Any relevent questions/answers
 - Project Location
 - Project Owner First & Last Name
 - Contractor Info (if other than owner)
 - Phone & Email of Primary Contact
- to the email below.

Thank you!