



2025
CATALOG
INFO@BETTERBRIX.COM



ELEMENTICF[®] **CHROME**
LOGIX BRANDS



FAB-FORM
Sustainable Foundations



A WBI PRODUCT
THERMALBOARD[™]
ECONOMICAL SUSTAINABLE PANELS



BETTER BRiX DISTRIBUTION
ICF MATERIALS, ACCESSORIES, CONSTRUCTION AND SUPPORT
SINCE 2015



ELEMENT ICF.....3

-ICF Accessories.....4

-ICF Electrical Boxes.....5

-ICF Pool Kits.....6



HEAT SHEET.....7

RIGID EPS GRAPHITE INSUATION



LAMINATED SUBTERRA-EXTERRA- INTERRA.....8

CHROME RIGID NON LAMINATED.....9



FORTRUSS SUSPENDED CONCRETE..... 10



HUG HYDRONICS..... 11



FORMS AND BRACING..... 12



ICF ALIGNMENT..... 13



MONO POUR ICF FORMS..... 14



RADIANT FLOOR PANELS..... 18

SERVICES 19-22

ORDER FORMS 23+

BETTER

BRIX

DISTRIBUTION

ELEMENTICF[®]

LOGIX BRANDS



A PRODUCT BY

LOGIX[®]
BRANDS

Want To Build A High-Performance
Foundation, Home or Building?

ELEMENTICF[®]
LOGIX BRANDS

Keep it Simple.[™]

WWW.BETTERBRIX.COM
INFO@BETTERBRIX.COM
509-305-1068

LEARN MORE



ADFOAM PRO
POLYURETHANE
INSULATING FOAM & ICF
ADHESIVES CLEANER AND
APPLICATOR GUN

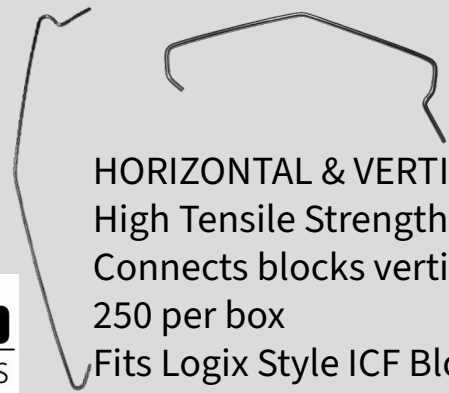

HORIZONTAL & VERTICAL HOOKS
High Tensile Strength
Connects blocks vertically
250 per box
Fits Logix Style ICF Blocks
& ELEMENT ICF as needed



36" Heavy Duty Zip Ties
175lb UV Black 50 ct bags

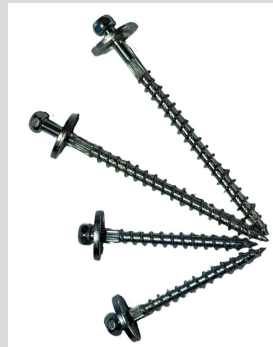

ICF SCREWS

#10 x 2" 500 /BOX
#10 x 3" 400 /BOX

The screw features a loose washer design and is available in a 2" and 3" option. Each screw is hardened and galvanized for better strength. They have a coarse thread which works well with the plastic web of an ICF block.

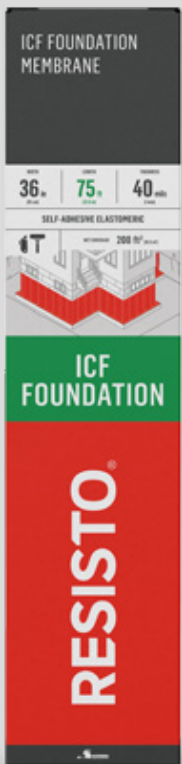

ICF FOUNDATION MEMBRANE

Self-adhesive membrane dedicated to the waterproofing of insulated concrete form (ICF) foundations. It is composed of 1 mm thick SBS modified bitumen and a trilaminate woven polyethylene. The underface is composed of a silicone release film. This membrane is primarily designed to waterproof insulated concrete form (ICF) foundations.

H2O PRIMER

This product is a polymer emulsion-based primer designed to improve the adhesion of self-adhesive waterproofing membranes on most substrates. It is particularly recommended when the use of solvent-based primer is not advised.



RESIDENTIAL & COMMERCIAL

<https://youtu.be/6awEQ-0NeZl>

SINGLE GANG ICF BOX



DOUBLE GANG ICF BOX



TRIPLE GANG ICF BOX



ICF-1-RL PVC SINGLE GANG ICF BOX CSAus NMD CABLE INEXO

ICF-2-RL PVC DOUBLE GANG ICF BOX CSAus NMD CABLE INEXO

ICF-3-RL PVC TRIPLE GANG ICF BOX CSAus NMD CABLE INEXO

ICF-1-CLU PVC SINGLE GANG ICF BOX CSAus MC/NMD CABLE INEXO

ICF-2-CLU PVC DOUBLE GANG ICF BOX CSAus MC/NMD CABLE INEXO

ICF-3-CLU PVC TRIPLE GANG ICF BOX CSAus MC/NMD CABLE INEXO

LVD-RLX ICF BOX LOW VOLTAGE DIVIDER RESIDENTIAL INEXO



ICF POOL KITS

RECTANGULAR

12-24ft wide X 24-40ft long

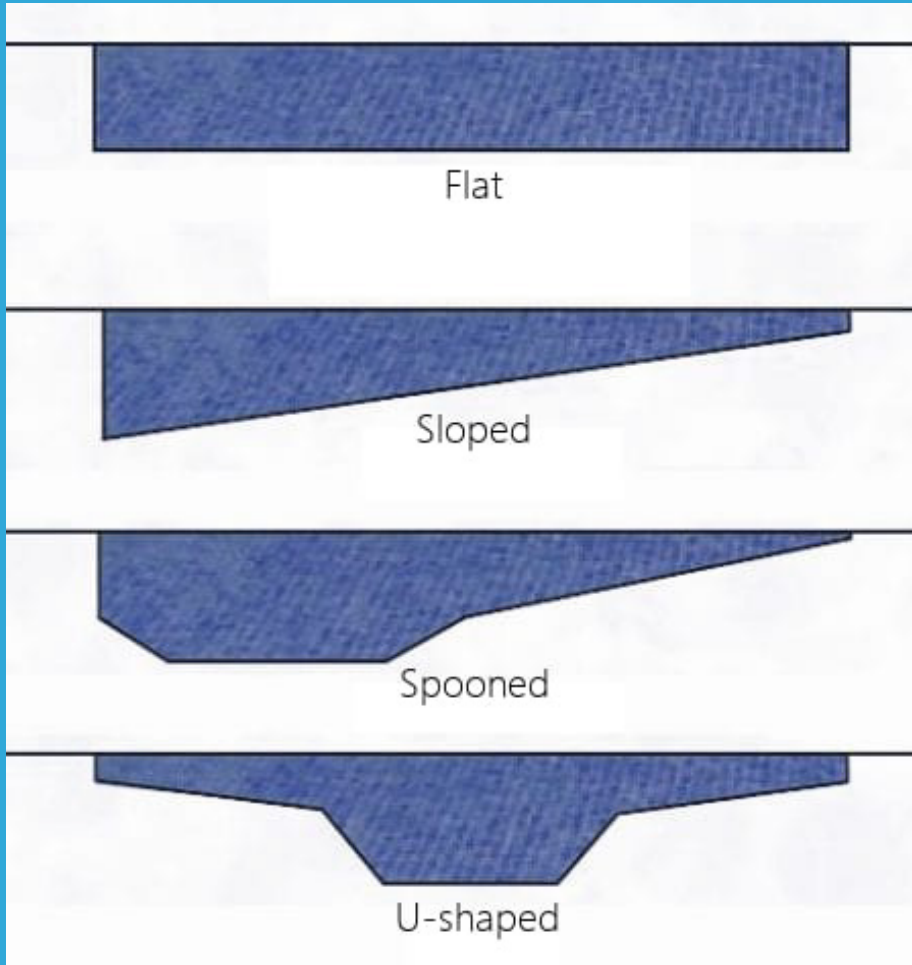

FLAT FLOOR
3' TO 5' deep

SLOPED FLOOR
3' to 9' deep

SPOONED
SHALLOW TO DEEP

SPORT FLOOR
3'- 6'- 3'

ELEMENT ICF by Logix Brands is an ideal choice when building swimming pools. Element ICF “6 Steps in 1” ICF offers EFFICIENCY builds that are typically faster than other methods. Plus, ELEMENT ICF blocks are easy to handle, Experts calculate that up to 80% of a pool’s heat is lost through its sides and bottom due to the fact that the ground conducts heat far more efficiently than air does. A durable ELEMENT ICF pool lowers your energy bills for years to come and can even extend your swimming season in northern climates.

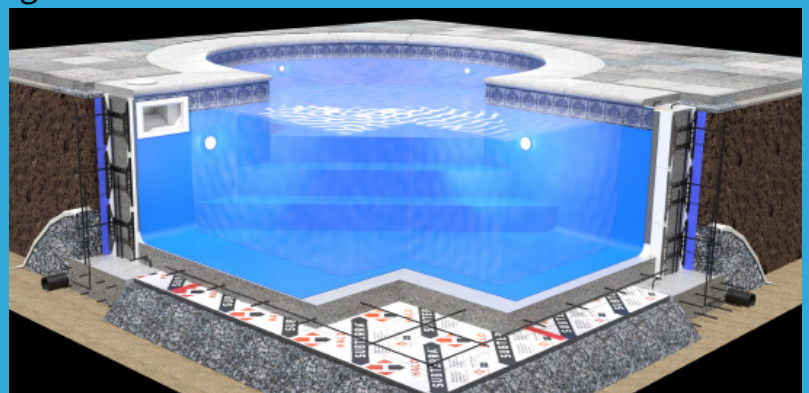



HEAT-SHEET®

BETTER
BRIX
DISTRIBUTION

A PRODUCT BY
LOGIX
BRANDS

*Heat-Sheet®
R4 - R16.1
Perfectly Designed for
Under-Slab,
Slab-On-Grade and
Retrofit Applications*

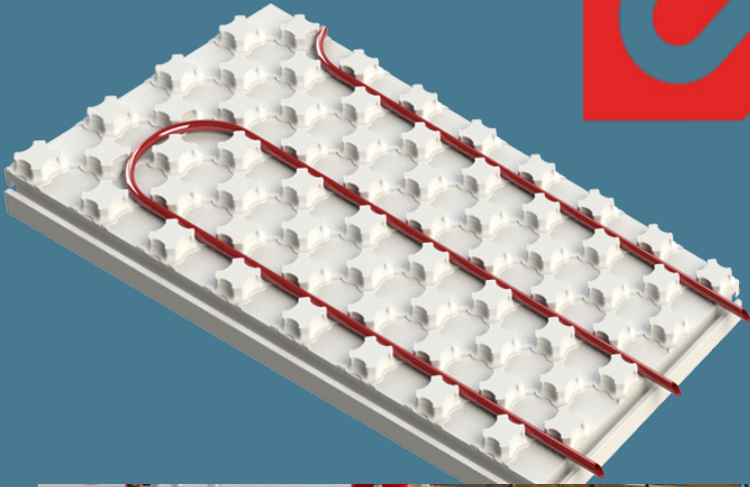
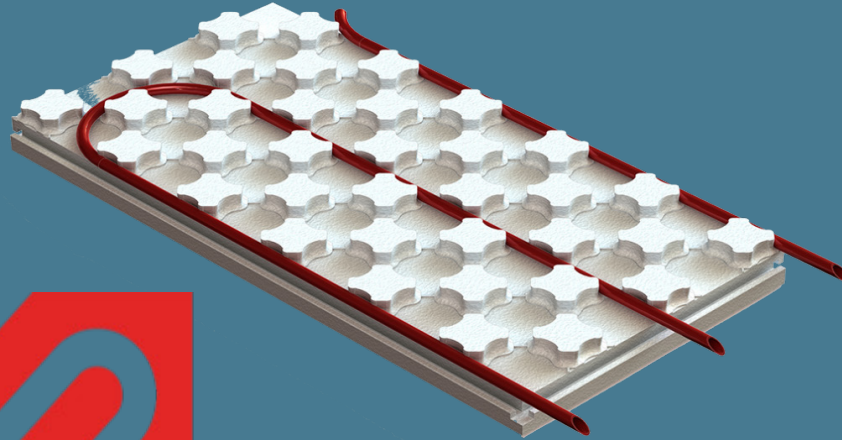

*Heat-Sheet® Heavy
R8 - R20
Perfectly Designed For
Snow-Melt,
Garage and Commercial
Heated Floors*



**WHY CHOOSE RADIANT
FLOOR HEATING?**

WWW.BETTERBRIX.COM

INFO@BETTERBRIX.COM

509-305-1068



A PRODUCT BY
LOGIX
BRANDS

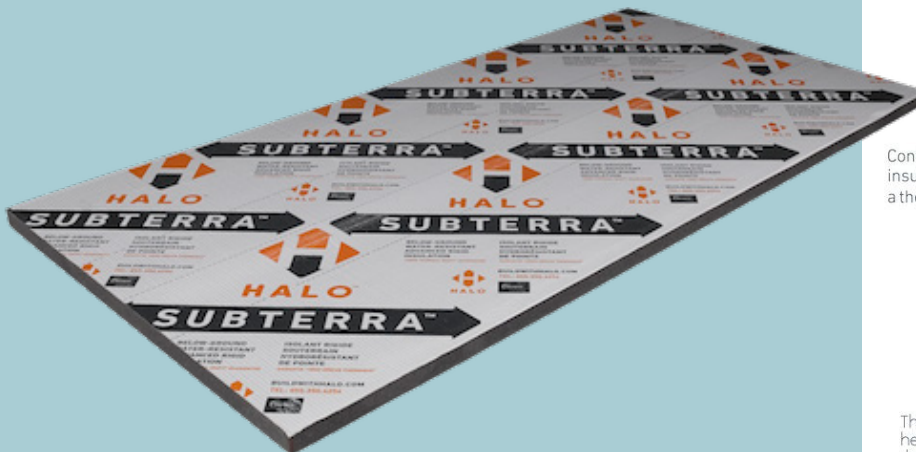
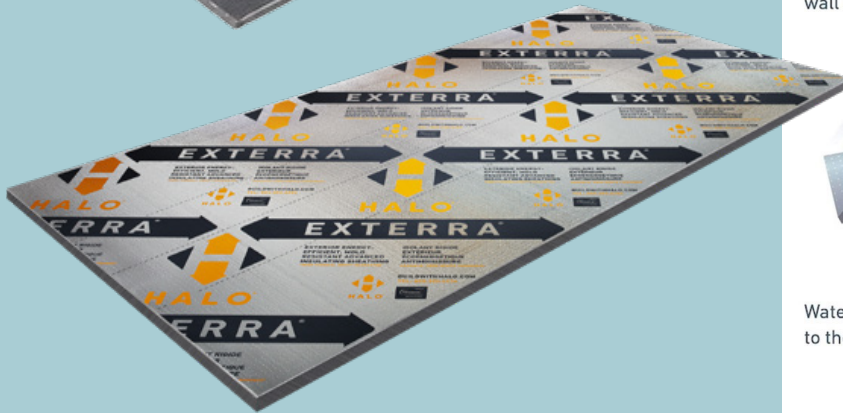
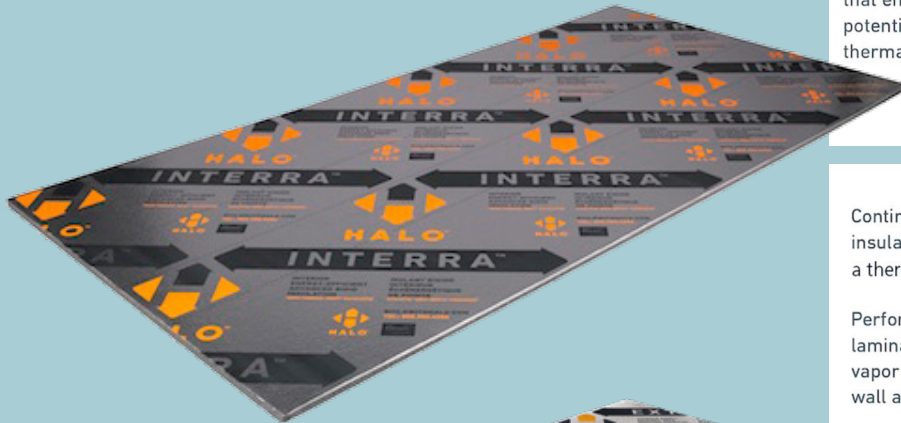

Continuous GPS
insulation creates
a thermal break

Reflective laminate
partially reflects
heat back to
the interior

Reflective
laminate provides
continuous
vapor barrier

Strapping
creates air gap
that enables
potential gain in
thermal performance.

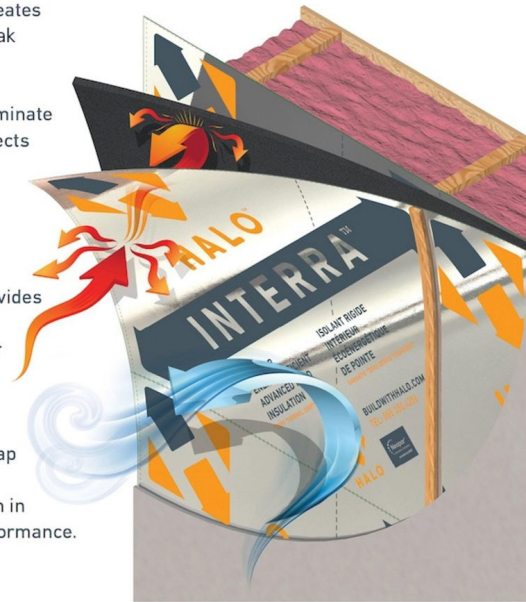

Continuous GPS
insulation creates
a thermal break

Perforated
laminate allows
vapor to escape
wall assembly

Water & air kept
to the exterior

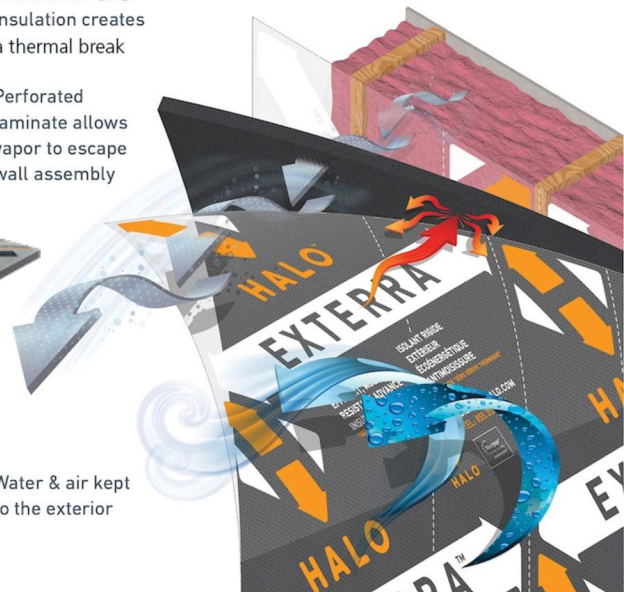

Foundation Wall

Protects waterproofing

Continuous GPS
insulation creates
a thermal break

Thick polypropylene film
helps drain water from
the foundation wall.

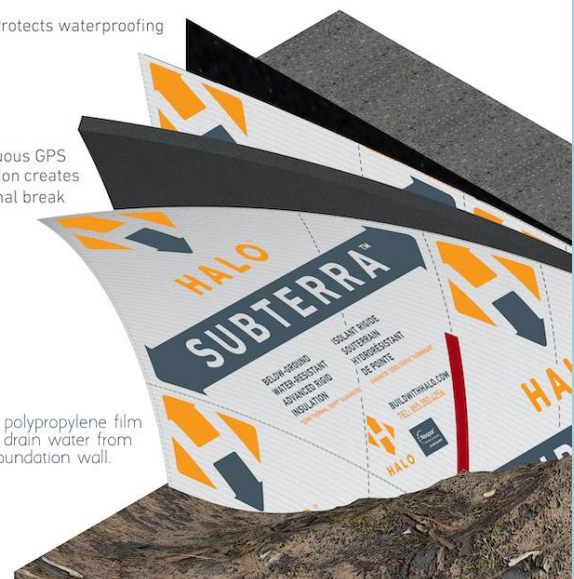

A PRODUCT BY

LOGIX[®]
BRANDS

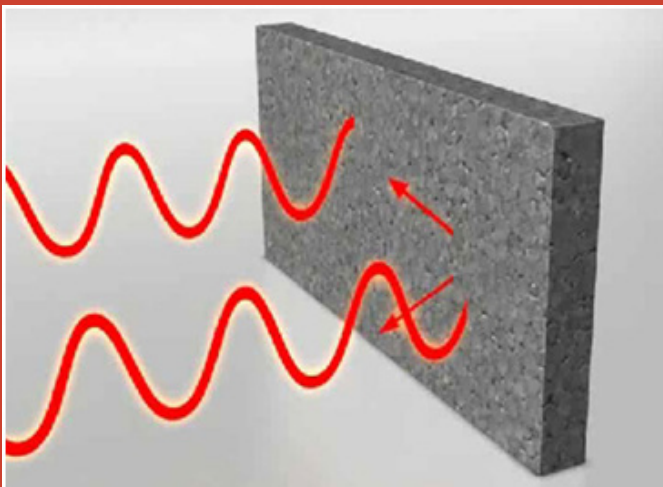
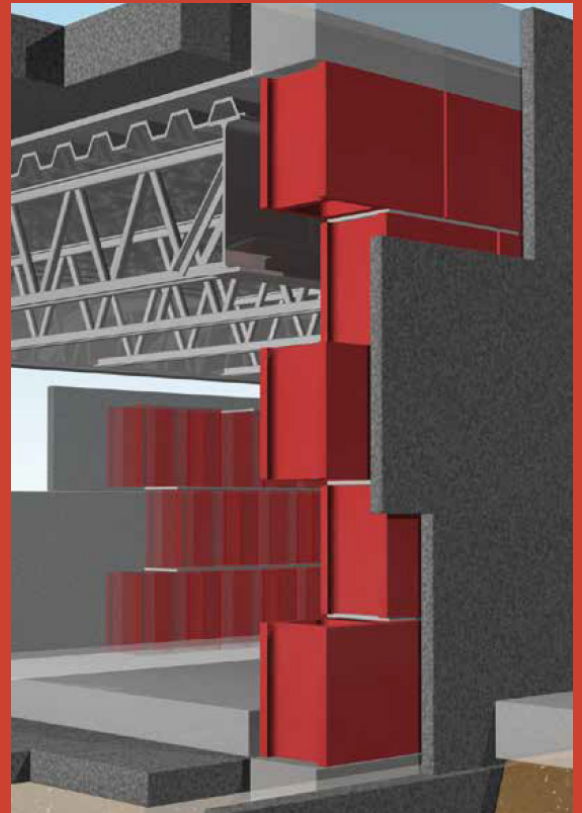

BETTER
BRiX
DISTRIBUTION

Fortruss
PERFORMANCE FORMING WITH EPS

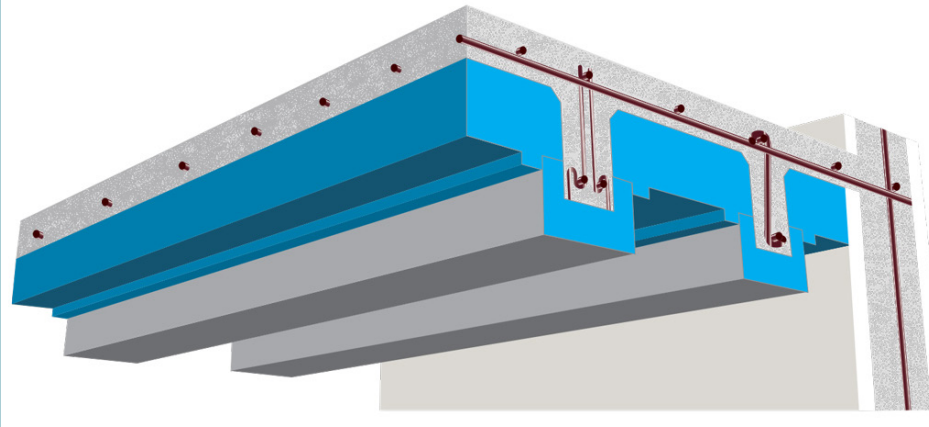

A PRODUCT BY
LOGIX[®]
BRANDS



SUSPENDED STRUCTURAL SLABS



Insulated Suspended
Structural Slab

RESIDENTIAL &
COMMERCIAL

- Floor
- Deck
- Roof
- Green Roof

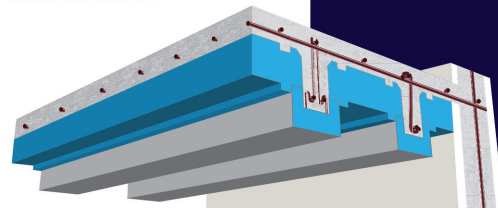

Fortruss
PERFORMANCE FORMING WITH EPS

Learn **More** >>

Authorized Dealer

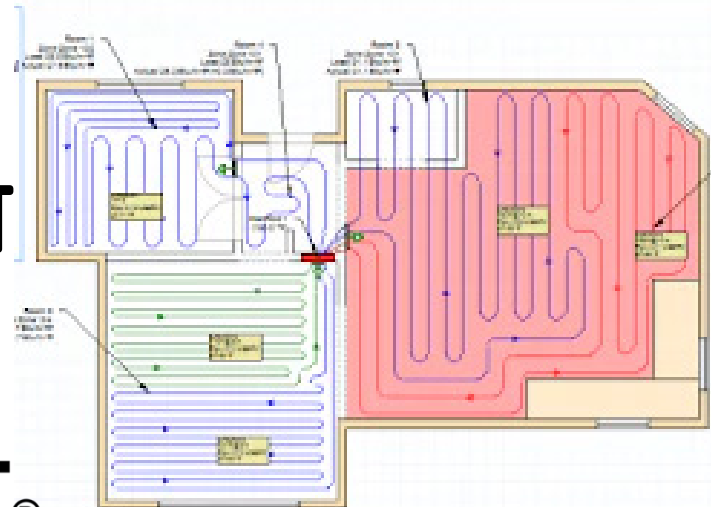
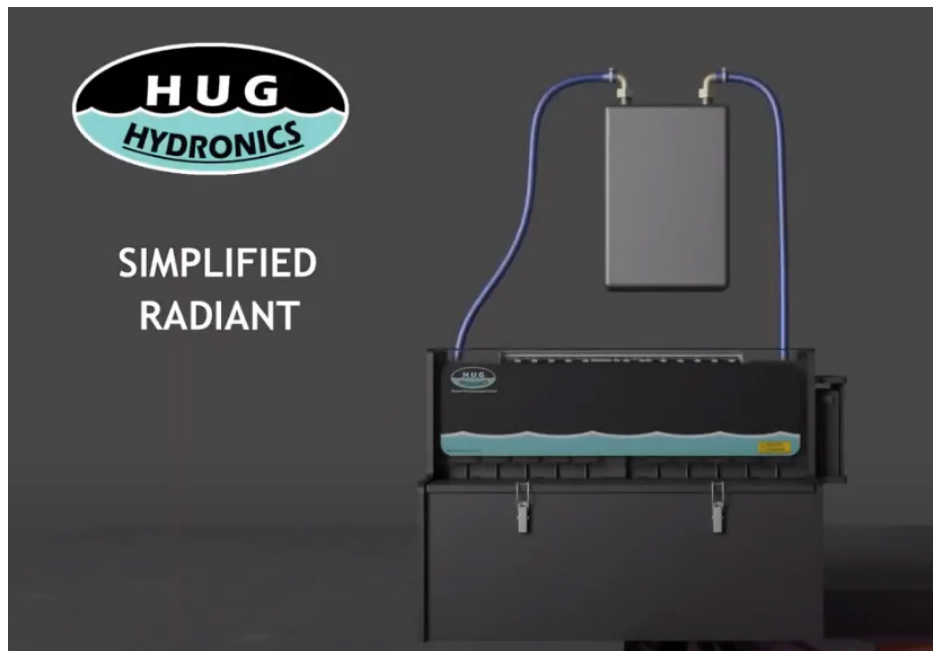

**HYDRONIC IN FLOOR HEAT
SYSTEM FOR USE WITH:**



HEAT-SHEET®

FAB-FORM

Sustainable Foundations

ZONT™ BRACING



The Zont system is the most cost effective and efficient bracing solution for your ICF walls.

Zont water bracket locks the 2x4 walers and strongbacks against your ICF wall to flatten the wall vertically and horizontally. The patented polycarbonate cam is twisted to quickly lock the lumber in place.

Lightweight Zuckle wall aligners rapidly adjust with an electric drill to ensure the top of your wall is perfectly aligned with your stringline.

Lightweight ZAT folding walkway brackets provide over 24" of waist high width to build and adjust the top of your wall.

ZONT

Polycarbonate cam for locking lumber
Zinc plated for long life

Strong 10 gauge steel
Strengthening rib

ZUCKLE

Stake hole
Acme thread for durability
9/16" socket end
Zinc plated for long life
5 gauge steel for high strength

ZAT

Zinc plated for long life
Angled post provides 24" of hip level space
Folds flat for easy storage
Lightweight 7.4 lbs.
Strong 10 gauge steel

www.FAB-FORM.com
(888)303-3278

YouTube Facebook Instagram

FASTFOOT®

Green from the ground up





www.fastfoot.com
(888)303-3278

Giraffe's Turnbuckle ICF bracing system was developed in the early 2000's, and is now an industry icon, available across North America & the World. Every major ICF manufacturer strongly recommends turnbuckle bracing, and some even sell ICF Bracing Systems at a cost that hopefully encourages ICF Contractors to use it systematically.

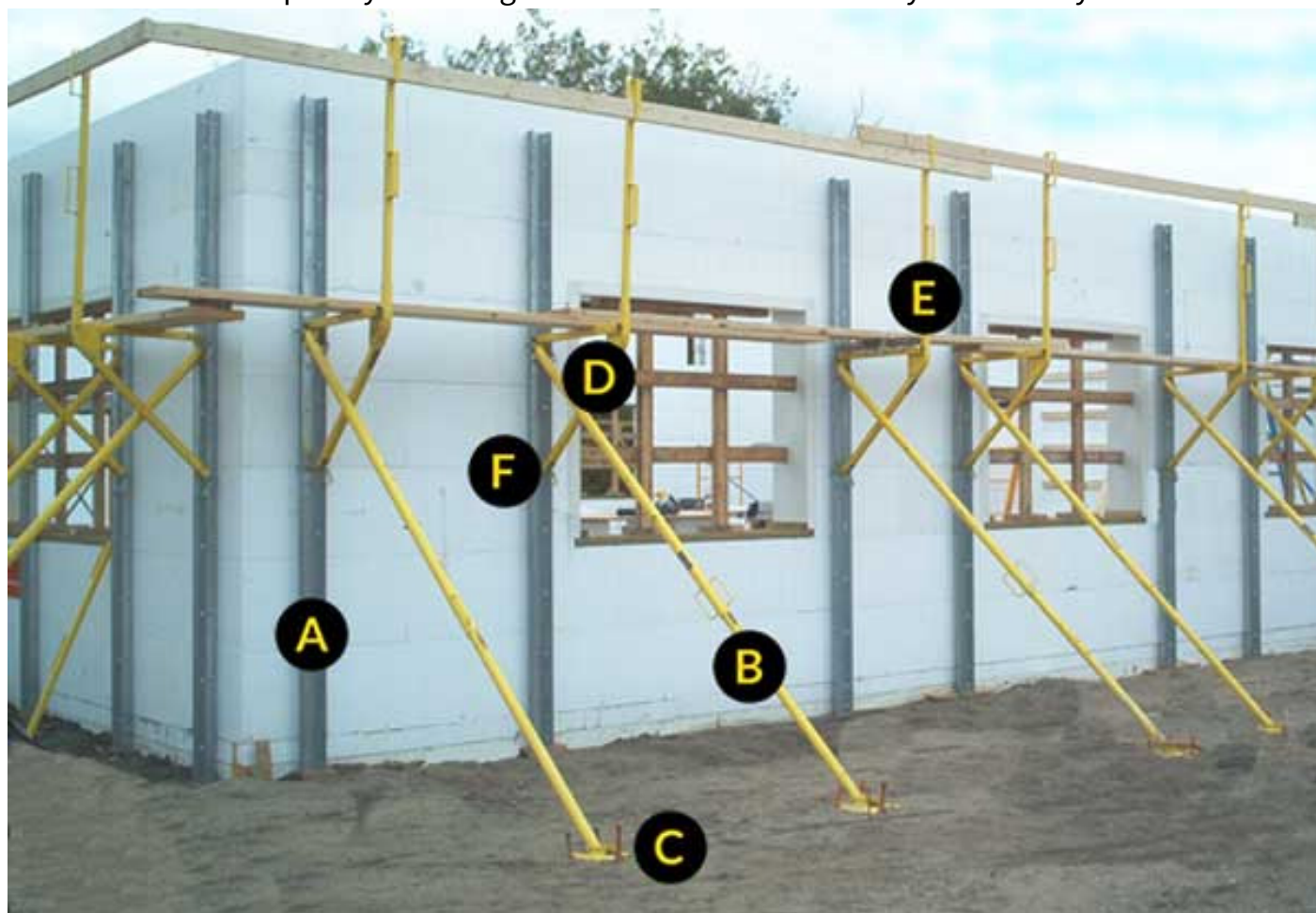

The Giraffe ICF bracing system includes a straightback (A), adjustable leg with internal screw (B), stamped footplate (C), platform bracket (D), safety rail (E) and self-locking gravity pins (F).

The Standard 8', 10' or 12' Giraffe ICF Bracing and Wall Alignment System comes with:

- 1 – 8', 10' or 12' stackable straight back
- 1 – Removable straight back foot plate
- 1 – Adjustable diagonal brace with double connector foot plate
- 1 – Foldable platform bracket
- 1 – Guard rail post
- 2 – 18" steel anchor stakes (may not be suitable for all soils)
- 2 – Self-locking gravity pins



***FOUNDATIONS
MADE EASY***



***INFO@MONOSLABEZFORM.COM - 208-558-5200
WWW.MONOSLABEZFORM.COM***

Form Sizes

Adjustable

PROVIDES NECESSARY R-VALUE TO MEET ENERGY CODE ACROSS THE COUNTRY. THIS FORM PROVIDES OVER 51" OF FROST PROTECTION.

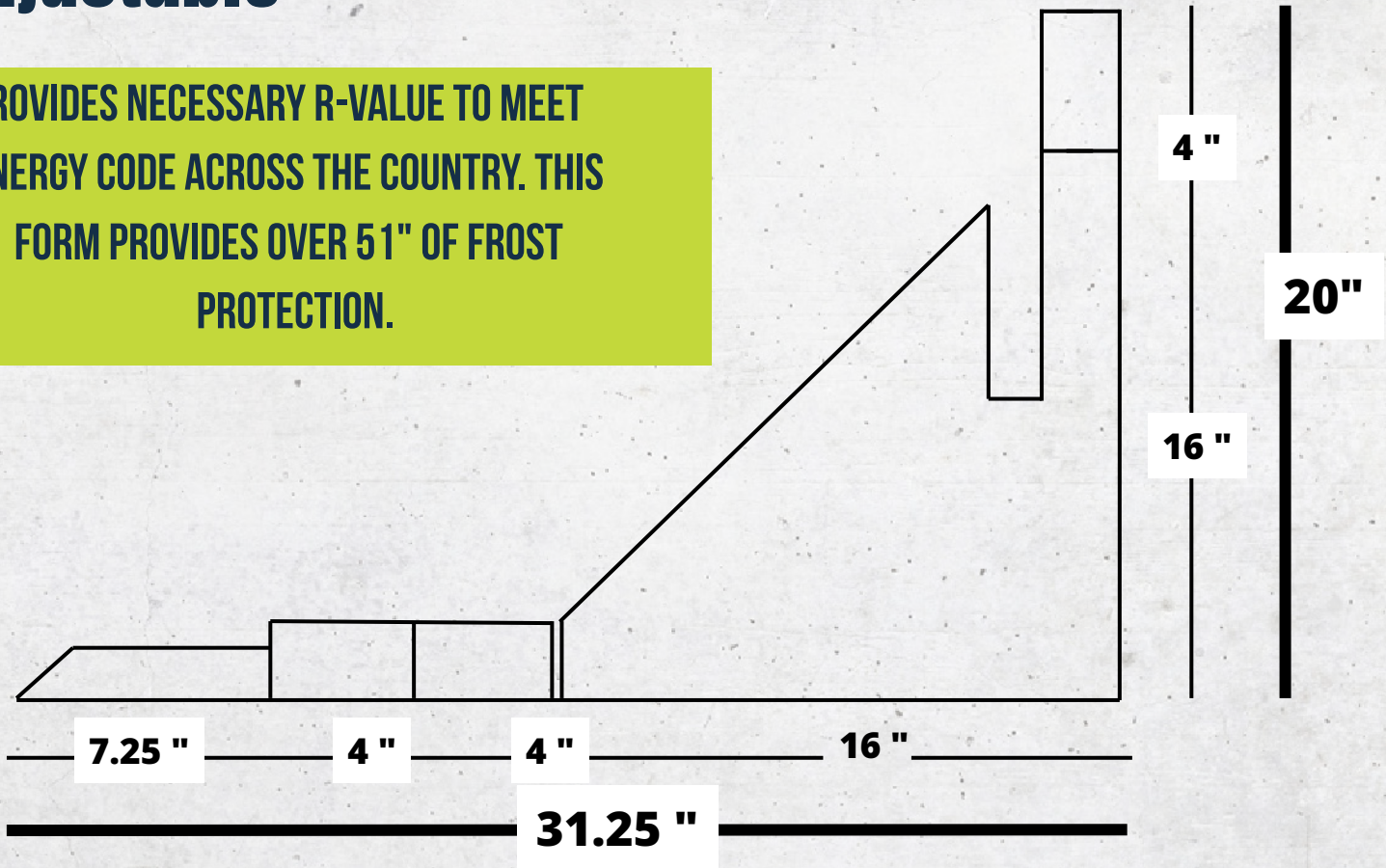

Commercial

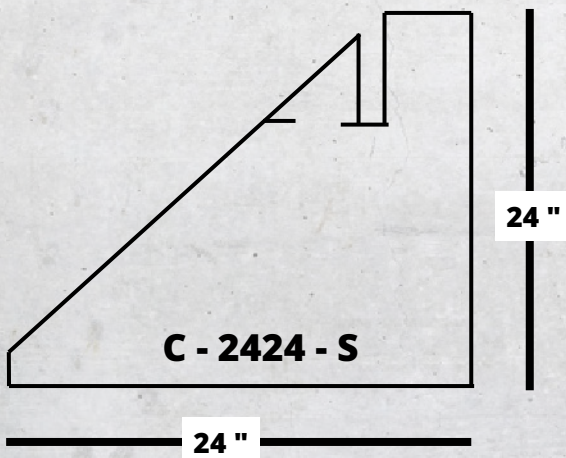

USED FOR STEEL BUILDINGS, LARGE COMMERCIAL PROJECTS, AND ANYWHERE A THICKER FOOTING IS REQUIRED FOR STRUCTURAL LOADS.

Accessories

LVLUP Level Up Extension Bracket

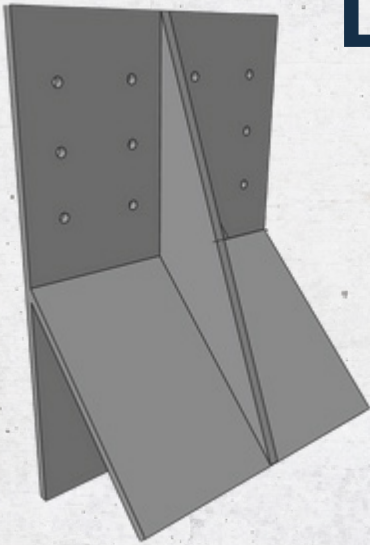

LEVEL UP EXTENSION BRACKET — TO BE USED IN CONJUNCTION WITH MONO SLAB® EZ FORM ADJUSTABLE FORM OR COMMERCIAL FORM TO SIMPLIFY THE LEVELING PROCESS.

*EXTENSION BRACKET (54 PER BOX)

Interior Forms

Interior 14x18

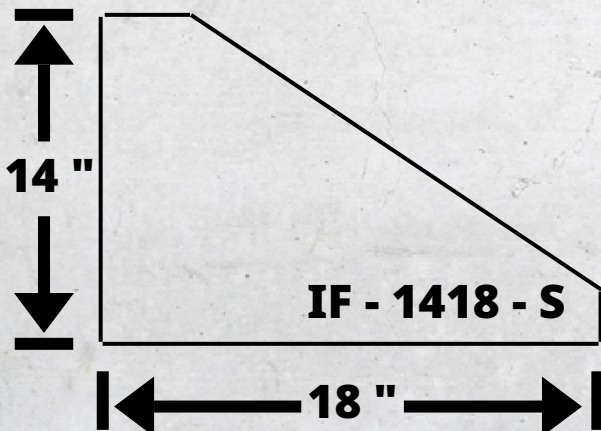

HELPS CONTROL CONCRETE USAGE AND ALSO SUPPORTS SUB-SLAB INSULATION/RADIANT FLOOR HEATING TUBES. ** PRICE ON REQUEST

You've asked, we've delivered!

- CODE COMPLIANT PROTECTIVE FLASHING DESIGNED SPECIFICALLY FOR MONO SLAB® EZ FORM
- PROVIDES ADDED PROTECTION FROM WALL TO BOTTOM PLATE, AND TOP OF MONO SLAB® EZ FORM FOR A CONTINUOUS MOISTURE BARRIER

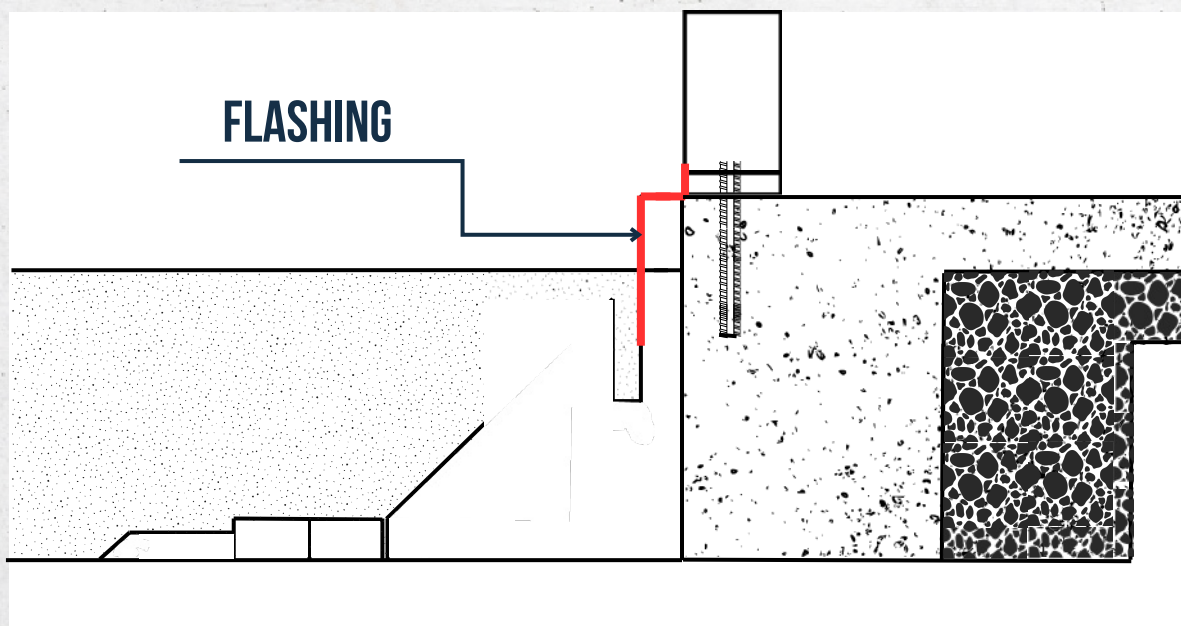

- MONO SLAB® FLASHING IS MADE OF DURABLE PVC
- ROUGH GRAY 10' LENGTHS
- CAN BE USED FOR STEP DOWN, OR STRAIGHT FLASHING

MECHANICAL PROPERTIES

Tensile Strength: 6500 PSI ASTM D-638

Flexural Strength: 11800 PSI ASTM D-790

THERMAL PROPERTIES

Deflection Temperature at 264 PSI: 162°F
ASTM D-648

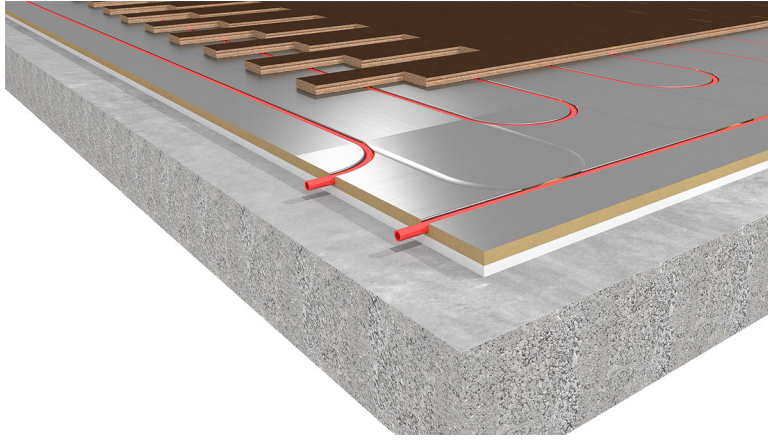

Over New or
Existing Concrete

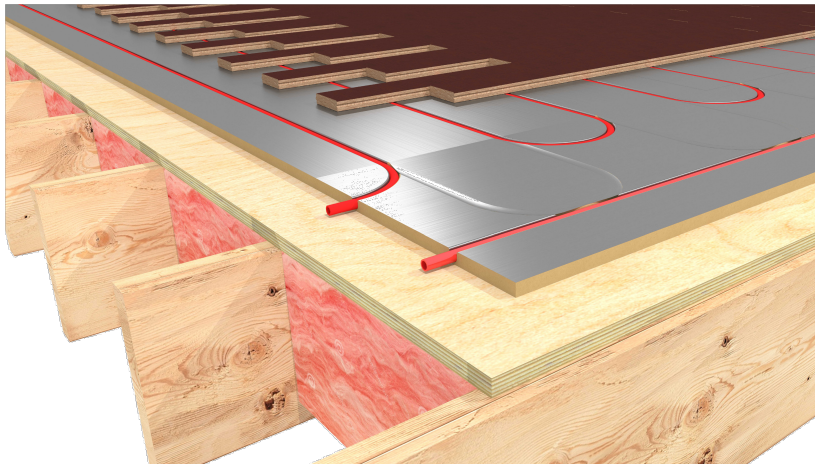

Over Subfloors

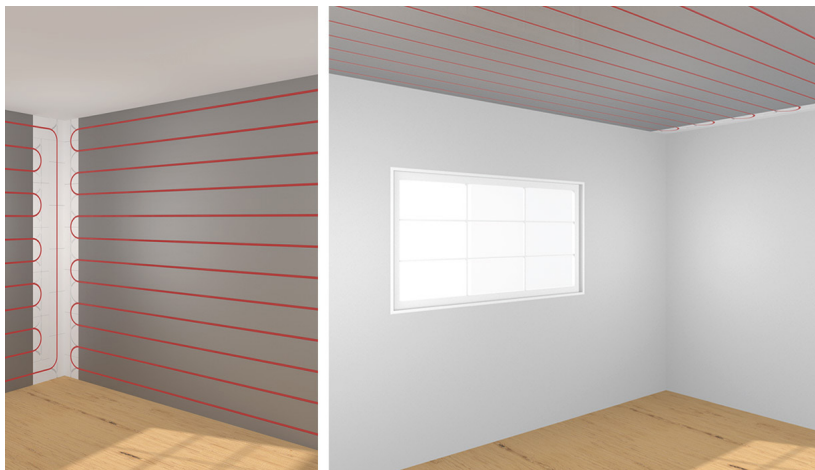

On Walls or
Ceilings

ON SITE TRAINING/CONSULTING/JOB SUPPORT
BY APPOINTMENT
& SCHEDULED IN ADVANCE
(FEE BASE ON TRAVEL DISTANCE,
TIME ON JOB, AND JOB FUNCTION)

INSTALLATION OF ICF PRODUCTS/SERVICES
PLACEMENT OF REBAR & CONCRETE
PUMPING OF CONCRETE:
CONTACT FOR APPROVED CONTRACTOR LIST





**TRADITIONAL
DESIGNS INC.**

RON PELSON & BRAD KESSINGER

Office: (509) 452-7604

402 W. Chestnut Ave. Yakima, WA 98942

www.Traditionaldesignsinc.com

*CUSTOM ICF DESIGN:
plans, engineering, permitting
& energy forms*

**DGE DAVE GOWERS
ENGINEERING**
INSULATED CONCRETE FORMS SPECIALISTS

LOGIX[®]
BRANDS
ENGINEERED INSULATION PRODUCTS
SAVE TIME. GAIN CONTROL.

ELEMENTICF[®]
LOGIX BRANDS
HEAT-SHEET[®]

HALO[®]

CHROME GPS
PROFESSIONAL GRADE GRAPHITE INSULATION

Fortruss
PERFORMANCE FORMING WITH EPS

Mono Slab[®] **EZ** Form LLC

WWW.BETTERBRIX.COM

INFO@BETTERBRIX.COM

509-305-1068



THE WEST COAST 1250 WITH BASEMENT DESIGN



FEATURES:

2 Storeys , 4 Bedrooms, 4 Bathrooms,
Kitchen, Living Room (Including Basement)

INTERIOR LIVING SPACE:

Main Floor - 914 sq ft

Second Floor - 385 sq ft

Basement - 864 sq ft

APPROXIMATE EXTERIOR DIMENSIONS:

39' W x 31' D



ROOM SCHEDULE:

Name	Level	Area	Perimeter
Bathroom 3	Basement	23' - 9 13/16"	34.58 SF
Bedroom 4	Basement	43' - 1 7/32"	92.43 SF
Foyer	Basement	110' - 9 5/32"	165.87 SF
Home Gym	Basement	69' - 6 15/16"	247.89 SF
Laundry	Basement	41' - 4 5/32"	99.05 SF
Living Room 2	Basement	56' - 3 17/32"	194.11 SF
Office Nook	Basement	22' - 6 5/8"	31.77 SF
Bathroom 1	Main Floor	29' - 4 27/32"	50.34 SF
Bedroom 1	Main Floor	39' - 9 13/32"	98.90 SF
Bedroom 2	Main Floor	39' - 8 3/8"	98.47 SF
Foyer	Main Floor	85' - 8 7/8"	183.75 SF
Kitchen	Main Floor	47' - 11 7/16"	134.12 SF
Living Space	Main Floor	69' - 7 7/16"	248.36 SF
Bathroom 2	Upper Level	33' - 2 3/32"	62.53 SF
Primary Bdrm	Upper Level	99' - 4 19/32"	300.12 SF

Copyright of Logix Brands Ltd. All Rights Reserved.

https://elementicf.com/wp-content/uploads/2024/04/ELE_Small-Homes-Catalogue_040324_web.pdf



Small Home Designs
These attractive small home designs are crafted to provide families with strong, disaster-resilient homes that are comfortable, energy-efficient and affordable.



THE HEARTLAND 1250

DESIGN



ELEMENTICF[®]
LOGIX BRANDS

FEATURES:

3 Bedroom, 2 Bathroom, Kitchen, Living Room

INTERIOR LIVING SPACE:

1,161 sq ft

APPROXIMATE EXTERIOR DIMENSIONS:

32' W x 46' D



ROOM SCHEDULE:

Name	Level	Area	Perimeter
Bedroom 3	First Floor	138 SF	46' - 7 1/4"
Closet. 3	First Floor	18 SF	23' - 3 1/8"
Primary Suite	First Floor	163 SF	50' - 5 5/8"
Utility	First Floor	36 SF	23' - 11 3/4"
Primary Bath	First Floor	59 SF	38' - 2 5/8"
WIC	First Floor	26 SF	23' - 0 3/4"
W.C.	First Floor	14 SF	15' - 10 1/8"
Shower	First Floor	13 SF	14' - 5"
P.	First Floor	24 SF	19' - 4 5/8"
Primary Hall	First Floor	22 SF	20' - 11 1/8"
Hall	First Floor	20 SF	17' - 11 1/2"
Hall Bath	First Floor	48 SF	29' - 3 1/2"
Bedroom 2	First Floor	139 SF	68' - 3 7/8"
Closet. 2	First Floor	11 SF	14' - 11"
Kitchen	First Floor	176 SF	59' - 9 3/8"
Living Room	First Floor	206 SF	57' - 7"
Hall	First Floor	106 SF	67' - 8 3/8"

Copyright of Logix Brands Ltd. All Rights Reserved.

https://elementicf.com/wp-content/uploads/2024/04/ELE_Small-Homes-Catalogue_040324_web.pdf



Small Home Designs

These attractive small home designs are crafted to provide families with strong, disaster-resilient homes that are comfortable, energy-efficient and affordable.

WWW.BETTERBRIX.COM

INFO@BETTERBRIX.COM

509-305-1068



To request estimates please send:

- PDF of Full Plans & Elevations
 - Project Specifications
 - Building Jurisdiction
 - Estimated start/completion
 - Any relevent questions/answers
 - Project Location
 - Project Owner First & Last Name
 - Contractor Info (if other than owner)
 - Phone & Email of Primary Contact
- to the email below.

Thank you!