

WATERPROOF GRADE

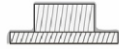

IP54 waterproof

Paint a thin layer of silicon glue on the top of strips to proof dust and water



IP65 waterproof

Drop a thick layer of silicon glue on the top of strip to proof dust and water

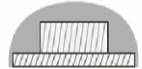

IP 67 waterproof

Put strip into the silicon tube to protect strips from dust and water

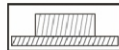

IP68 waterproof

Sill the strip into the silicon tube with silicon glue, totally waterproof

