

EFSM

Electric heavy duty reach truck

- Ergonomically designed passenger compartment
- Need-based customization due to assistance systems
- Sensitive operation by joystick with superimposed operating function
- Reach mast technology allows gain of space
- Genkinger Curve Control, driving speed reduction when driving along a curve



Schematic diagram

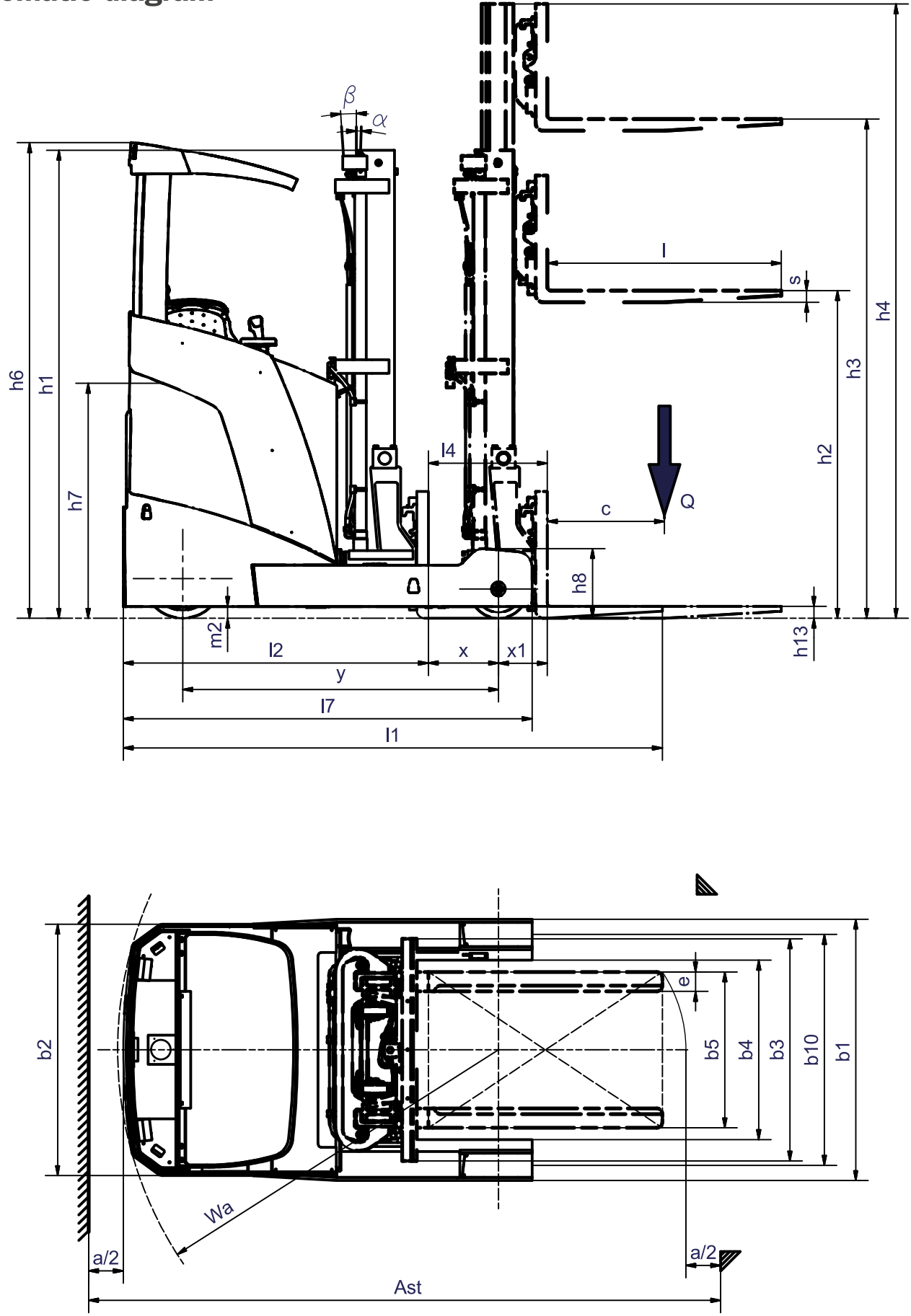

Technical data

according to VDI 2198, As of: 12/2016

Mark	1.1	Manufacturer (Abbreviation)			Genkinger Material Handling		
	1.2	Manufacturer's designation			EFSM	EFSM	
	1.3	Drive			electric	electric	
	1.4	Operator type			cross-seat	cross-seat	
	1.5	Rated capacity/rated load	Q	t	4	4	
	1.6	Load centre distance	c	mm	600	600	
	1.8.1	Load distance	x	mm	355	355	
	1.8.2	Load distance, mast extended	x1	mm	250	250	
	1.9	Wheelbase	y	mm	1620	1620	
Weight	2.1.1	Service weight incl. battery (see 6,5)		kg	5400	5800	
	2.3.1	Axle loading, w.o. load, forks retracted, front/rear		kg	3802 / 1798	3721 / 1879	
	2.3.2	Axle loading, w.o. load, forks forward, front/rear		kg	4037 / 1363	3508 / 2292	
	2.4	Axle loading, forks forward with load at front/rear		kg	1338 / 8262	1260 / 8540	
	2.5	Axle loading, forks retracted with load at front/rear		kg	3212 / 6388	2564 / 7236	
Wheels/ Chassis	3.1	Tyres			Vulkollan	Elastic	
	3.2	Tyre size, front		mm	ø406 x 178	ø457 x 229	
	3.3	Tyre size, rear		mm	ø300 x 120	ø457 x 229	
	3.5	Wheels, number front/rear (x = driven wheels)			1 / 2 (1x)	1 / 2 (1x)	
	3.6	Track width, front		b10	mm	1184	1350
Dimension	4.1	Mast/fork carriage tilt, forward/backward		α/β	°	1 / 4	1 / 4
	4.2	Height of mast, lowered		h1	mm	2400	2400
	4.3	Free lift		h2	mm	1543	1543
	4.4	Lift		h3	mm	4800	4800
	4.5	Height of mast, extended		h4	mm	5577	5577
	4.7	Height of overhead guard (cabin)		h6	mm	2440	2440
	4.8	Stand height		h7	mm	1180	1180
	4.10	Height of load arms		h8	mm	355	500
	4.15	Height, lowered		h13	mm	60	60
	4.19	Overall length		l1	mm	2765	2765
	4.20	Head length		l2	mm	1565	1565
	4.21	Overall width		b1/b2	mm	1340 / 1290	1650 / 1290
	4.22	Fork dimensions		s/e/l	mm	50 / 120 / 1150	50 / 120 / 1150
	4.23	Fork carriage to ISO 2328, class/type A, B			3A	3A	
	4.24	Width of fork carriage		b3	mm	870	870
	4.25	Width over forks		b5	mm	336 - 840	336 - 840
	4.26	Width between load arms		b4	mm	920	920
	4.28	Reach travel		l4	mm	610	670
	4.32	Ground clearance, centre of wheelbase		m2	mm	60	60
	4.32.1	Ground clearance, lowest point			mm	55	55
	4.33	Aisle width for pallets 1000 x 1200 sideways		Ast	mm	2965	2965
	4.34	Aisle width for pallets 800 x 1200 lengthways		Ast	mm	2965	2965
	4.35	Turning radius		Wa	mm	1955	1955
	4.37	Length of chassis		l7	mm	2097	2175
	Work data	5.1.1	Travel speed, laden/unladen		km/h	8 / 12	8 / 12
5.1.2		Travel speed, mast not in basic position, laden/unladen		km/h	6 / 6	6 / 6	
5.2		Lift speed, laden/unladen		m/s	0,28 / 0,35	0,28 / 0,35	
5.3		Lowering speed, laden/unladen		m/s	0,35 / 0,35	0,35 / 0,35	
5.4		Reach speed laden/unladen		m/s	0,12	0,12	
5.7		Gradeability, laden/unladen		%	6 / 9	6 / 9	
5.8		Max. gradeability, laden/unladen		%	9 / 11	9 / 11	
5.9		Acceleration time, laden/unladen		S	5,3 / 4,5	5,3 / 4,5	
5.10		Service brake			-	-	
Electric		6.1	Drive motor rating S2 60 min. AC		kW	7	7
	6.2	Lift motor rating at S3 15% AC		kW	14	14	
	6.3	Battery acc. to DIN 43531/35/36 A, B, C, no			DIN 43531 EN/IEC 60254-2	DIN 43531 EN/IEC 60254-2	
	6.4	Battery voltage/ nominal capacity		V/Ah	48 / 775	48 / 775	
	6.5	Battery weight		kg	1200	1200	
Other	8.1	Type of controller			MOS-FET AC	MOS-FET AC	
	8.2	Operating pressure for attachments		bar	160	160	
	8.3	Oil flow for attachments		l/min	20	20	
	8.4	Noise level acc. to EN 12053 at operator's ear		dB (A)	69	69	

EFSM

The strengths of the Genkinger electric heavy duty reach truck are reflected in power, high performance, modern working conditions and innovative technology. Perfectly suitable for difficult operating conditions and for the single-shift and multi-shift operation.

Advantages:

- The version with elastic tyres allows an universal use of the vehicle, even where driving under different floor conditions is required. Thus, the Genkinger reach truck can be used on smooth floor in the warehouse or also for loading and unloading trucks on rough asphalt.
- Maintenance expenses are reduced by the use of three-phase AC technology. Moreover, the energy consumption is reduced due to energy recuperation when braking. This leads to a higher handling capacity.
- By means of an ergonomically designed operator's position with upholstered and air-suspended comfort driver seat, 80 mm height adjustable foot-rest, driving with foot pedal, well-designed handle on the steering wheel and joystick with superimposed operating function.
- By means of a 4.3" colour display which shows all relevant data and information.
- Genkinger Curve Control – automatic driving speed regulation when driving along a curve.
- The arrangement of the control elements does not only ensure excellent visibility conditions, but also contributes to safety.
- Further safety elements, such as BlueSpot, are offered as optional features.

A wide range of assistance systems and further optional features allow a need-based solution for every individual case.



from 3,0 t to...

Genkinger GmbH

Albstraße 49, D-72525 Münsingen

Telefon: +49 (0) 7381 186-0

Fax: +49 (0) 7381 186-44

www.genkinger.de

info@genkinger.de

Id.-Nr.: GH52602847

We reserve the right to make technical changes.

Power ratings are approximate values without any obligation.

