

EGY-S

Electric four-way pedestrian-controlled high-lift truck

- Four-way wide gauge wheels for lengthwise and crosswise drive
- Driving, lifting and steering drive in three-phase AC technology
- Storage operations at great heights are made easy with pantograph
- Control by means of an ergonomic tiller head with display



EGY-S

The Genkinger electric four-way pedestrian-controlled high-lift truck is perfectly suitable for the handling of long loads in narrow aisles. Therefore, it is an excellent machine for fields of application in the timber industry, the building materials and sanitary trade, the door and window industry and the steel industry.

A newly integrated extending mechanism in the form of a hydraulic pantograph provides for an incomparably large field of vision at any rack height.

In the normal position, the tiller arm is parallel to the driving wheel. This allows a rapid movement.

Due to the use of three-phase AC technology, maintenance expenses are considerably reduced. This makes the Genkinger stacker more cost-effective and more efficient.

Moreover, the integrated servo steering allows uncomplicated manoeuvring in a very confined space and reduces operator fatigue.

Apart from the new design and the compact construction, longstanding quality and robustness made by Genkinger have not been neglected. This saves costs and serves to maintain the value of the machine.

The machine is completely operated by means of a multifunctional tiller arm with a centrally arranged display which shows all relevant data, such as battery condition, maintenance intervals etc., and provides the possibility of programming the driver profile by means of code access. Moreover, the tiller arm allows an exact positioning by the sensitive control of the driving and lifting speed.

Apart from a large number of available standard options, Genkinger four-way stackers can also be adapted to customer-specific requirements and equipped according to individual needs.



Options



Long-load fork-carriage

The fork-carriage can be adjusted individually for transportation of long loads e.g. timber and metal profiles.

It is available in manual and hydraulic execution.



Manual telescopic forks

Through loosening the safety bolt, the forks can be adjusted in length and then locked again.

Hydraulic telescopic forks

The hydraulic forks can be adjusted hydraulically via the multifunctional drawbar head.

Telescoping area from 800 mm to 1200 mm.



Multifunctional display to show

- Load torque detection
- Lift height pre-selection
- Setting of personalized operator profiles
- Personal log in
- Battery discharge indicator
- Operation hours
- Driving direction indicator
- Time

Schematic diagram

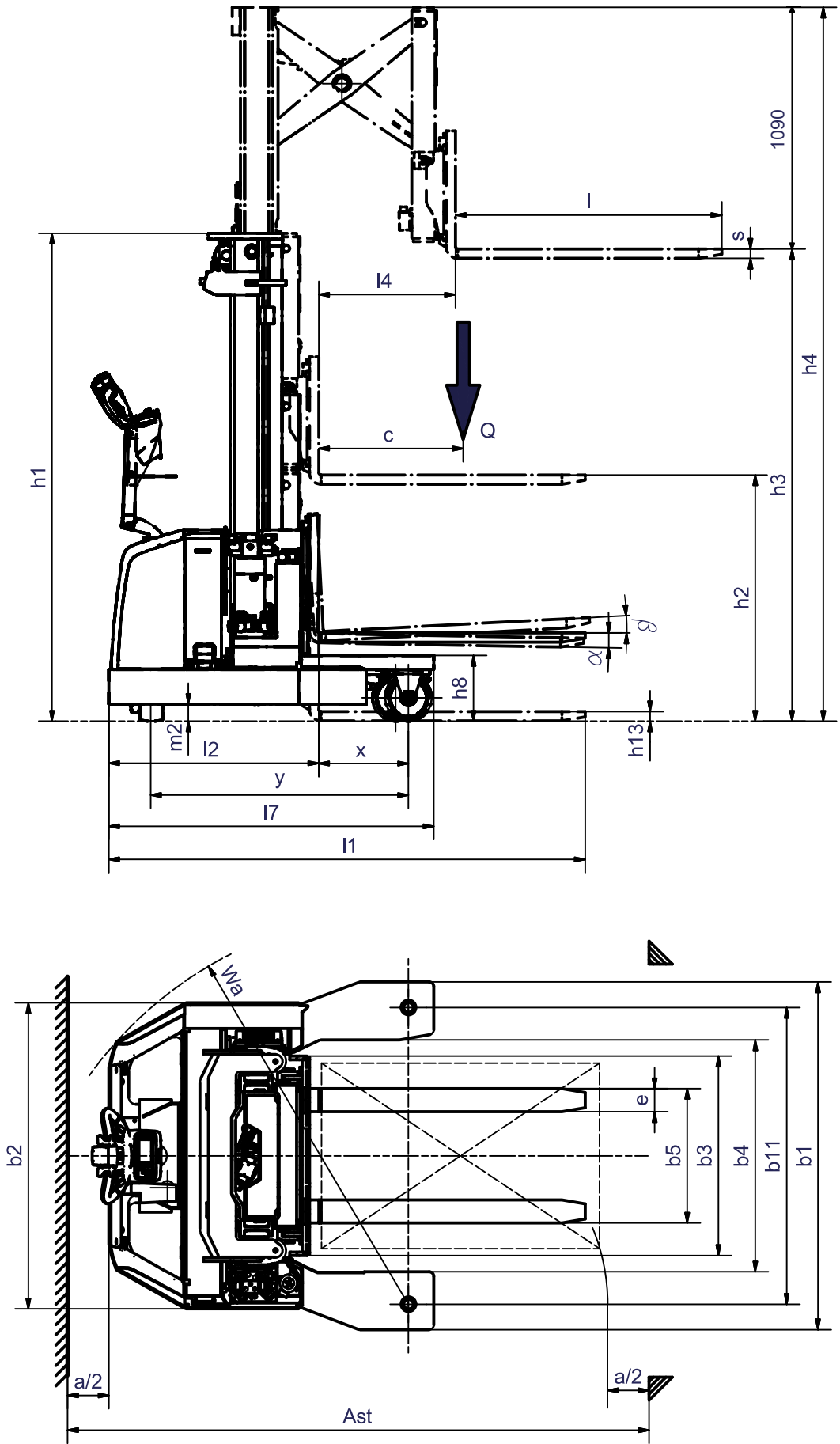

Technical data

according to VDI 2198, As of: 03/2017

Mark	1.1	Manufacturer (Abbreviation)			Genkinger Material Handling	
	1.2	Manufacturer's designation			EGY-S	EGY-S
	1.3	Drive			electric	electric
	1.4	Operator type			walkie	walkie
	1.5	Rated capacity/rated load		Q t	1,8	1,6
	1.6	Load centre distance	c	mm	600	600
	1.8	Load distance	x	mm	360	360
	1.8.1	Load distance, pantograph extended	x1	mm	228	228
	1.9	Wheelbase	y	mm	1105	1105
Wheigt	2.1.1	Service weight incl. battery		kg	2840	2700
	2.3.1	Axle loading, w.o. load, forks retracted, front/rear		kg	916 / 1924	900 / 1800
	2.3.2	Axle loading, w.o. load, forks forward, front/rear		kg	1144 / 1698	967 / 1733
	2.4	Axle loading, forks forward with load at front/rear		kg	4130 / 470	3800 / 500
	2.5	Axle loading, forks retracted with load at front/rear		kg	3225 / 1415	2850 / 1450
Wheels/ Chassis	3.1	Tyres			Vulkollan	Elastic
	3.2	Tyre size, front		mm	ø254 x 95	ø275 x 140
	3.3	Tyre size, rear		mm	ø200 x 50	ø300 x 80
	3.5	Wheels, number front/rear (x = driven wheels)			1x / 4	1x / 4
	3.7	Track width, front	b10	mm	1280	1280
Dimension	4.1	Mast/fork carriage tilt, forward/backward	α/β	°	1 / 3	1 / 3
	4.2	Height of mast, lowered	h1	mm	2110	2110
	4.3	Free lift	h2	mm	1540	1540
	4.4	Lift	h3	mm	4410	4410
	4.5	Height of mast, extended	h4	mm	5500	5500
	4.7	Height of overhead guard (cabin)	h6	mm	none	none
	4.8	Stand height	h7	mm	none	none
	4.10	Height of load arms	h8	mm	283	390
	4.15	Height, lowered	h13	mm	50	50
	4.19	Overall length	l1	mm	2060	2060
	4.20	Head length	l2	mm	910	910
	4.21	overall width	b1/b2	mm	1500 / 1320	1500 / 1320
	4.22	Fork dimensions	s/e/l	mm	40/100/1150	40/100/1150
	4.23	Fork carriage to ISO 2328, class/type A, B			2A	2A
	4.24	Width of fork carriage	b3	mm	860	860
	4.25	Width over forks	b5	mm	336 - 830	336 - 830
	4.26	Width between load arms	b4	mm	1000	1000
	4.28	Reach travel	l4	mm	590	590
	4.32	Ground clearance, centre of wheelbase	m2	mm	73	73
	4.32.1	Ground clearance, lowest point		mm	70	70
Work data	5.1	Travel speed, laden/unladen		km/h	4 / 5	4 / 5
	5.2	Lift speed, laden/unladen		m/s	0,12/ 0,18	0,12 / 0,18
	5.3	Lowering speed, laden/unladen		m/s	0,20 / 0,20	0,20 / 0,20
	5.4	Reach speed, laden/unladen		m/s	0,20	0,20
	5.7	Gradeability, laden/unladen %		%	5 / 8	5 / 8
	5.8	Max. gradeability, laden/unladen %		%	7 / 10	7 / 10
	5.9	Acceleration time, laden/unladen		S	5,3 / 3,5	5,3 / 3,5
	6.1	Drive motor rating S2 60 min. AC		kW	2,6	2,6
	6.2	Lift motor rating at S3 15% AC		kW	4,5	4,5
Electric	6.3	Battery acc. to DIN 43531/35/36 A, B, C, no			DIN 43531 EN/IEC 602542	DIN 43531 EN/IEC 602542
	6.4	Battery voltage/nominal capacity		V/Ah	24 / 270	24 / 270
	6.5	Battery weight		kg	225	225
	8.1	Type of controller				
Other	8.2	Operating pressure for attachments		bar	150	150
	8.3	Oil flow for attachments		l/min	18	18
	8.4	Noise level acc. To EN 12053 at operator's ear		dB (A)	69	69

Mast data EGY-S 18 with PU Vulkollan tyres

As of: 03/2017

			Simplex			Duplex		
Height of mast, lowered	4.2	h1	2092	2352	2692	2112	2362	2712
Free lift	4.3	h2	0	0	0	1018	1268	1618
Lift	4.4	h3	2950	3450	4150	2950	3450	4150
Height of mast, extended	4.5	h4	4070	4570	4715	4090	4590	5290
Height, lowered	4.15	h13	50	50	50	50	50	50
Rated capacity								
Residual capacity in kg								
Lc c= 400 mm			1800	1800	1800	1800	1800	1800
Lc c= 500 mm			1800	1750	1600	1800	1750	1600
Lc c= 600 mm			1700	1600	1450	1700	1600	1450
Lc c= 700 mm			1500	1400	1275	1500	1400	1275
Lc c= 900 mm			1200	1175	1050	1200	1175	1050
Lc c= 1000 mm			1080	1050	950	1080	1050	950

			Triplex			
Standard fork-carriage						
Height of mast, lowered	4.2	h1	1991	2124	2291	2504
Free lift	4.3	h2	897	1030	1197	1410
Lift	4.4	h3	4010	4410	4910	5550
Height of mast, extended	4.5	h4	5110	5510	6010	6650
Height, lowered	4.15	h13	50	50	50	50
Rated capacity						
Residual capacity in kg						
Lc c= 400 mm			1800	1750	1650	1500
Lc c= 500 mm			1650	1550	1450	1350
Lc c= 600 mm			1500	1400	1250	1125
Lc c= 700 mm			1325	1250	1150	1050
Lc c= 900 mm			1100	1050	1000	950
Lc c= 1000 mm			1000	950	900	850

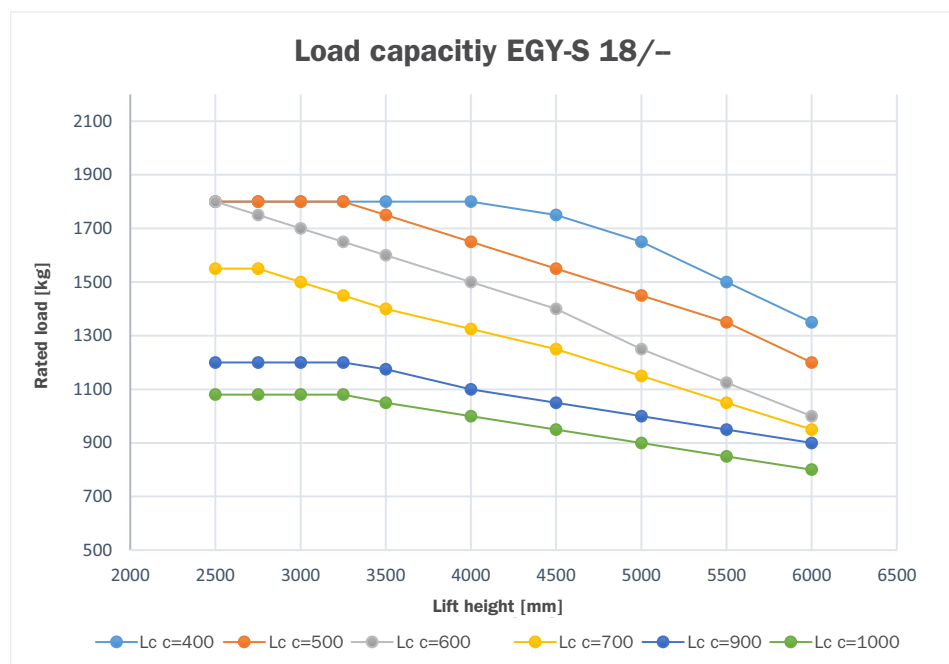

We reserve the right to make technical changes.
Power ratings are approximate values without any obligation.

Application in timber industry



- Ideal positioning in front of racks due to pantograph.



- Easy manoeuvrability in the most confined areas.



- Comfortable lifting of pallets from the floor.

Application in aluminium industry



- The robust pantograph is lifting the long load.



- Four-way chassis for easy switch over from lengthwise to crosswise driving.



- Suitable for indoor and outdoor use.

Genkinger GmbH

Albstraße 49, D-72525 Münsingen

Telefon: +49 (0) 7381 186-0

Fax: +49 (0) 7381 186-44

www.genkinger.de

info@genkinger.de

