



The AceCube Road Tow is a transportable cube style tank range.



Available Sizes

- ✓ AC-RT-950L / 250G
- ✓ AC-RT-2000L / 528G
- ✓ AC-RT-3000L / 792G
- ✓ AC-RT-4500L / 1188G

acecube
Road Tow

DyMac Global Head Office | Kitsmead Lane | Longcross | Chertsey | Surrey UK | KT16 0EF
+44 300 303 3353 | sales@dymacglobal.com | www.dymacglobal.com

Company Reg. 10445307



acecube

Road Tow

Enhanced Design Features

Unique Design Standard

The AceCube Road tow tank comes with stacking corners which double up as lifting lugs allowing lifting when full. The innovative design allows the primary hatch lid to open up to a conveniently positioned component ports & fittings plate which also provides access to an extra large equipment compartment area where various hose reels and electric pump kits can be fitted.

Maintenance & Environment

To ensure the efficient and unencumbered maintenance and inspections the class leading design allows the tank to be removed from the trailer easily and the inner tank can also be removed and disconnected from the outer tank. This flexible design ensures a minimal amount of downtime and thus increases long term ROI.

Dispensing & Accessibility

The AceCube Road tow tank range comes equipped with a spacious equipment chamber which engages a bespoke universal bracket system that can support retractable hose reels, along with a variety of electric pump dispensing kits and rotary hand pumps devices.

Transportable & Portable

The AceCube Road tow IBC Bunded Fuel Storage tanks range from 450L/118G to 3000L/792G. They are UN31A/Y certified guaranteeing them for safe and secure transportation under ADR regulations. The AC-RT-450L/118G to AC-RT-3000L/792G can be transported on all major road ways in Europe, USA and Canada only.



Truly Versatile

Take a look inside

Multiple Down Pipes for Multiple Generator Connections, Internal Baffle Plates for sloshing protection whilst towing when full, Extra Large Bunded equipment compartment for housing Engine Driven or Electric Pumps and Dispensing Equipment, completely Removable Inner Tank for maintenance.

By direction Forklift Pockets. Stacking Brackets double up as lifting lugs providing ease of manoeuvrability.



Superior Features



Can accommodate up to 10M or 40ft retractable hose reel mounted in the bunded equipment compartment.



Multiple ports that can connect up to three pieces of machinery at one time and allow dispensing simultaneously.



Three tier component design, outer top cover lid, Complete inner primary tank and outer tank.

Optional Accessories



Nato Hitch Option



Mud Guard



Spare Wheel

acecube

Road Tow

Model (AC-RT-450L / 118G)

The AceCube Road Tow AC-RT-450L/118G is designed for the safe and secure transporting and storage of various industrial lubricants and hazardous liquids worldwide.



Specifications

	Metric	US	Imperial
Capacity	450 Litres	118 Gallons	99 Gallons
Length	1466 mm	57 11/16"	57 11/16"
Width	1066 mm	41 15/16"	41 15/16"
Height	853 mm	33 9/16"	33 9/16"
Outer Tank Thickness	3 mm	1/16"	1/16"
Inner Tank Thickness	4 mm	2/16"	2/16"
Weight, Tare	393 kg	866 lbs, 7oz	866 lbs, 7oz
Weight, Laden	814 kg	1794 lbs, 9oz	1794 lbs, 9oz
Safe Fuel Fill Level	428 Litres	113 Gallons	94 Gallons

Approvals and Certifications

UK & Europe

- ✓ Trade Mark Certificate Europe
- ✓ Trade Mark Certificate UK
- ✓ (IBC) Intermediate Bulk Containment
- ✓ UN 31 A/Y
- ✓ Adhering to ADR regulations
- ✓ Lifting when Full Certified
- ✓ PPG2 & PPG26
- ✓ Vibration Tested
- ✓ UL142
- ✓ ULCS601-14
- ✓ Patent no: GB2502198

USA & Canada

- ✓ (IBC) Intermediate Bulk Containment
- ✓ TSSA B1390 ON – 2006 (Optional)
- ✓ UN 31 A/Y
- ✓ DOT USA
- ✓ DOT Canada
- ✓ Lifting when Full Certified
- ✓ Vibration Tested
- ✓ UL142
- ✓ ULCS601-14
- ✓ Patent no: GB2502198

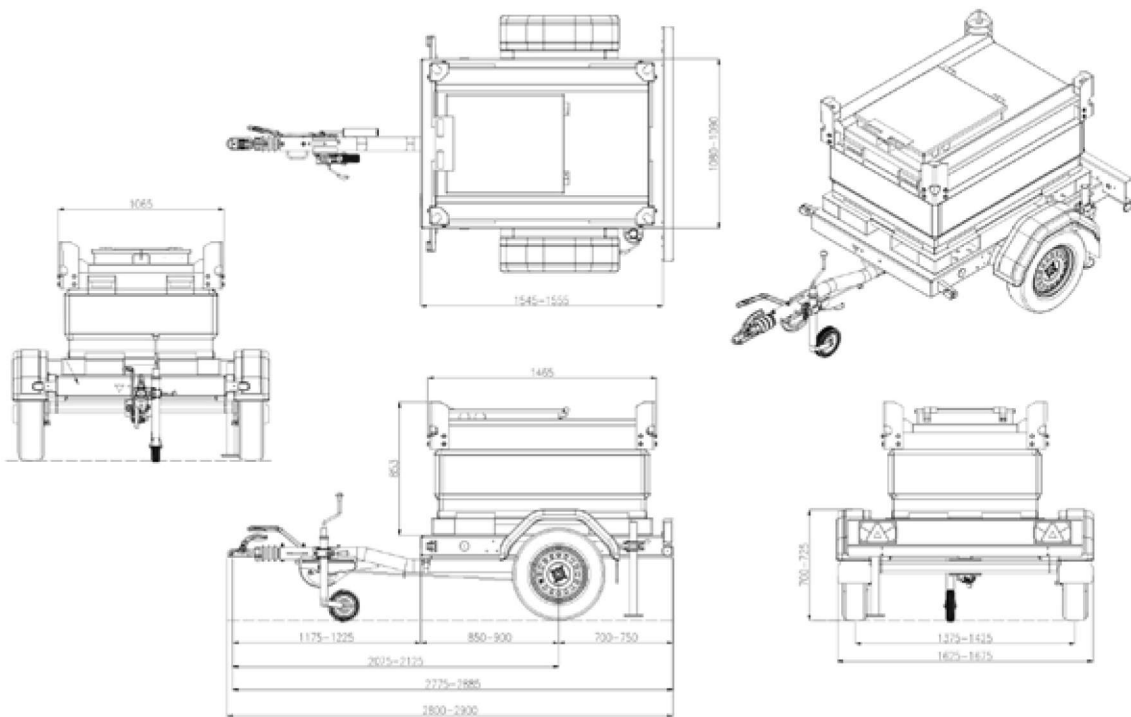

The range has an extra large equipment compartment area that can house a variety of accessories.



DISPENSING NOZZLE VARIATIONS



HOSES WITH ISO QUICK RELEASE COUPLERS

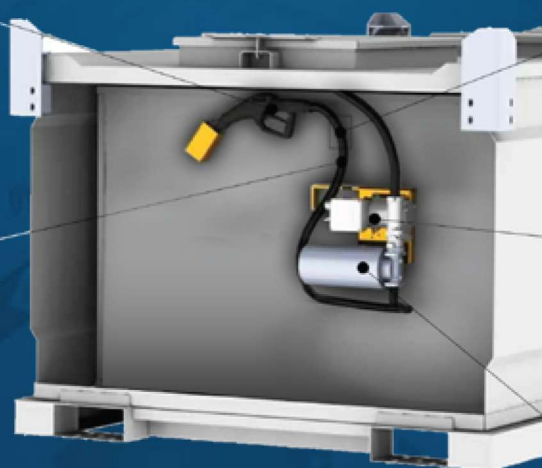

DIGITAL FLOW METERS



ENGINE DRIVEN OR ELECTRIC PUMPS



IN LINE PARTIAL SEPARATION FILTERS

acecube

Road Tow

Model (AC-RT-950L / 250G)

The AceCube Road Tow AC-RT-950L/250G is designed for the safe and secure transporting and storage of various industrial lubricants and hazardous liquids worldwide.



Specifications

	Metric	US	Imperial
Capacity	950 Litres	250 Gallons	209 Gallons
Length	1643 mm	64 11/16"	64 11/16"
Width	1099 mm	43 4/16"	43 4/16"
Height	1296 mm	51"	51"
Outer Tank Thickness	3 mm	1/16"	1/16"
Inner Tank Thickness	4 mm	2/16"	2/16"
Weight, Tare	606 kg	1336 lbs, 0oz	1336 lbs, 0oz
Weight, Laden	1518 kg	3346 lbs, 10oz	3346 lbs, 10oz
Safe Fuel Fill Level	903 Litres	239 Gallons	199 Gallons

Approvals and Certifications

UK & Europe

- ✓ Trade Mark Certificate Europe
- ✓ Trade Mark Certificate UK
- ✓ (IBC) Intermediate Bulk Containment
- ✓ UN 31 A/Y
- ✓ Adhering to ADR regulations
- ✓ Lifting when Full Certified
- ✓ PPG2 & PPG26
- ✓ Vibration Tested
- ✓ UL142
- ✓ ULCS601-14
- ✓ Patent no: GB2502198

USA & Canada

- ✓ (IBC) Intermediate Bulk Containment
- ✓ TSSA B1390 ON – 2006 (Optional)
- ✓ UN 31 A/Y
- ✓ DOT USA
- ✓ DOT Canada
- ✓ Lifting when Full Certified
- ✓ Vibration Tested
- ✓ UL142
- ✓ ULCS601-14
- ✓ Patent no: GB2502198

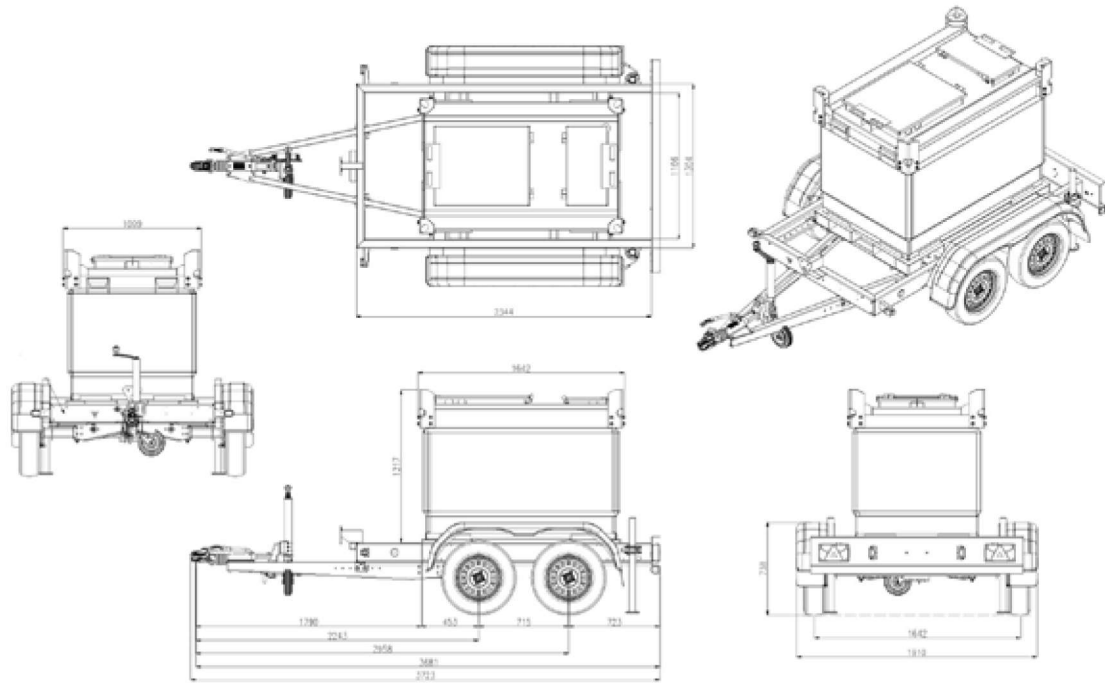

The range has an extra large equipment compartment area that can house a variety of accessories.



DISPENSING NOZZLE VARIATIONS



HOSES WITH ISO QUICK RELEASE COUPLERS



UP TO 10M OR 32FT RETRACTABLE HOSE REELS



DIGITAL FLOW METERS



ENGINE DRIVEN OR ELECTRIC PUMPS



IN LINE PARTIAL SEPARATION FILTERS

acecube

Road Tow

Model (AC-RT-2000L / 528G)

The AceCube Road Tow AC-RT-2000L/528G is designed for the safe and secure transporting and storage of various industrial lubricants and hazardous liquids worldwide.



Specifications

	Metric	US	Imperial
Capacity	2000 Litres	528 Gallons	440 Gallons
Length	2613 mm	102 13/16"	102 13/16"
Width	1179 mm	46 6/16"	46 6/16"
Height	1296 mm	51"	51"
Outer Tank Thickness	3 mm	1/16"	1/16"
Inner Tank Thickness	4 mm	2/16"	2/16"
Weight, Tare	916 kg	2019 lbs, 7oz	2019 lbs, 7oz
Weight, Laden	2796 kg	6164 lbs, 2oz	6164 lbs, 2oz
Safe Fuel Fill Level	1900 Litres	502 Gallons	418 Gallons

Approvals and Certifications

UK & Europe

- ✓ Trade Mark Certificate Europe
- ✓ Trade Mark Certificate UK
- ✓ (IBC) Intermediate Bulk Containment
- ✓ UN 31 A/Y
- ✓ Adhering to ADR regulations
- ✓ Lifting when Full Certified
- ✓ PPG2 & PPG26
- ✓ Vibration Tested
- ✓ UL142
- ✓ ULCS601-14
- ✓ Patent no: GB2502198

USA & Canada

- ✓ (IBC) Intermediate Bulk Containment
- ✓ TSSA B1390 ON – 2006 (Optional)
- ✓ UN 31 A/Y
- ✓ DOT USA
- ✓ DOT Canada
- ✓ Lifting when Full Certified
- ✓ Vibration Tested
- ✓ UL142
- ✓ ULCS601-14
- ✓ Patent no: GB2502198

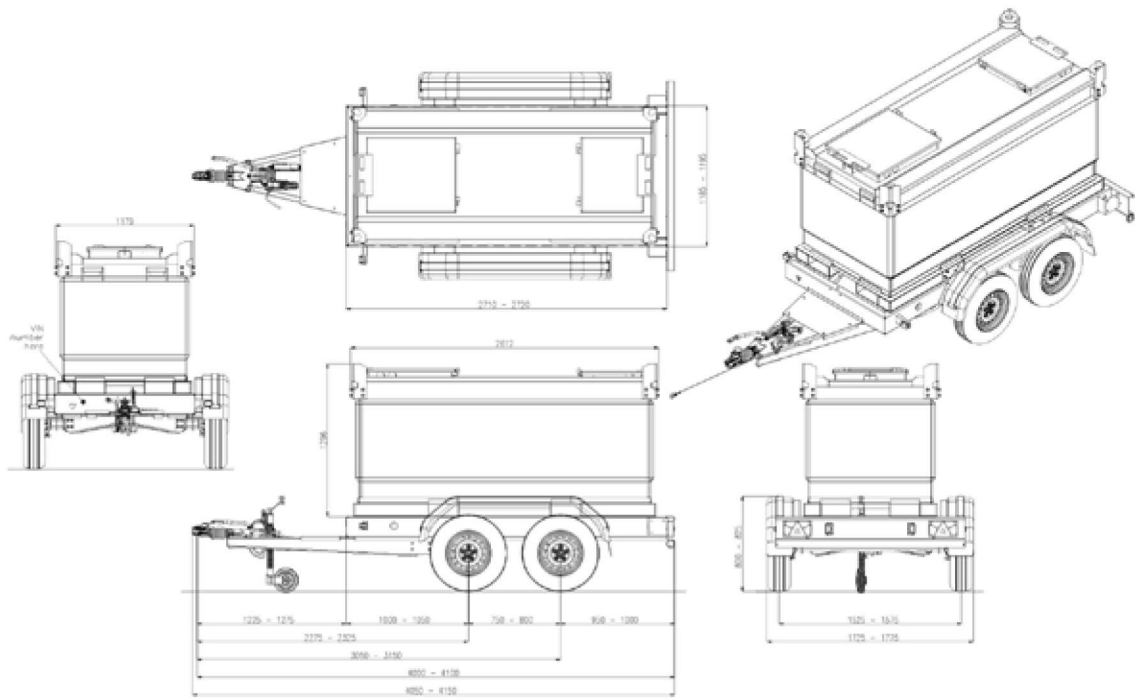

The range has an extra large equipment compartment area that can house a variety of accessories.



DISPENSING NOZZLE VARIATIONS



HOSES WITH ISO QUICK RELEASE COUPLERS



UP TO 10M OR 32FT RETRACTABLE HOSE REELS



DIGITAL FLOW METERS



ENGINE DRIVEN OR ELECTRIC PUMPS



IN LINE PARTIAL SEPARATION FILTERS

acecube

Road Tow

Model (AC-RT-3000L / 792G)

The AceCube Road Tow AC-RT-3000L/792G is designed for the safe and secure transporting and storage of various industrial lubricants and hazardous liquids worldwide.



Specifications

	Metric	US	Imperial
Capacity	3000 Litres	792 Gallons	660 Gallons
Length	2613 mm	102 13/16"	102 13/16"
Width	1685 mm	66 5/16"	66 5/16"
Height	1296 mm	51"	51"
Outer Tank Thickness	3 mm	1/16"	1/16"
Inner Tank Thickness	4 mm	2/16"	2/16"
Weight, Tare	1125 kg	2480 lbs, 3oz	2480 lbs, 3oz
Weight, Laden	3955 kg	8719 lbs, 5oz	8719 lbs, 5oz
Safe Fuel Fill Level	2850 Litres	753 Gallons	627 Gallons

Approvals and Certifications

UK & Europe

- ✓ Trade Mark Certificate Europe
- ✓ Trade Mark Certificate UK
- ✓ (IBC) Intermediate Bulk Containment
- ✓ UN 31 A/Y
- ✓ Adhering to ADR regulations
- ✓ Lifting when Full Certified
- ✓ PPG2 & PPG26
- ✓ Vibration Tested
- ✓ UL142
- ✓ ULCS601-14
- ✓ Patent no: GB2502198

USA & Canada

- ✓ (IBC) Intermediate Bulk Containment
- ✓ TSSA B1390 ON – 2006 (Optional)
- ✓ UN 31 A/Y
- ✓ DOT USA
- ✓ DOT Canada
- ✓ Lifting when Full Certified
- ✓ Vibration Tested
- ✓ UL142
- ✓ ULCS601-14
- ✓ Patent no: GB2502198

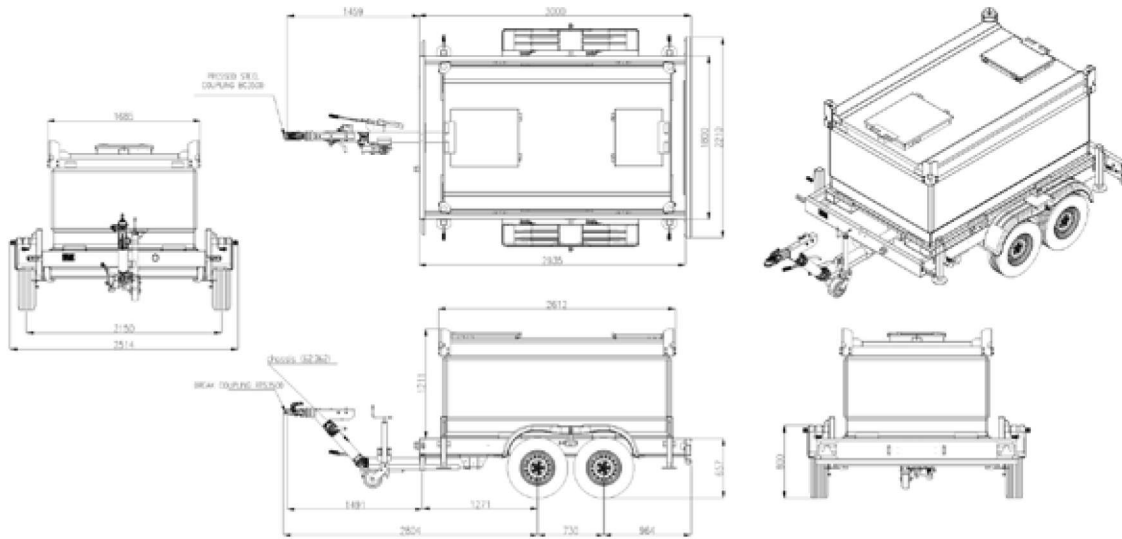

The range has an extra large equipment compartment area that can house a variety of accessories.



DISPENSING NOZZLE VARIATIONS



HOSES WITH ISO QUICK RELEASE COUPLERS



UP TO 10M OR 32FT RETRACTABLE HOSE REELS

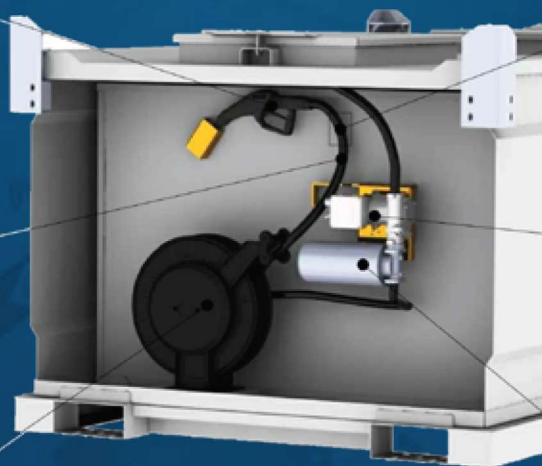

DIGITAL FLOW METERS



ENGINE DRIVEN OR ELECTRIC PUMPS



IN LINE PARTIAL SEPARATION FILTERS



Fuelling Your Progress

DyMac Global Head Office
E: sales@dymacglobal.com
T: +44 300 303 3353
Kitsmead Lane
Longcross, Chertsey
Surrey KT16 0EF
United Kingdom

DyMac Global India
E: india@dymacglobal.com
T: +91 8243556957
Pam Arcade
3rd floor, Kottara
Ashok Nagar
Mangalore - 575006
India

DyMac Canada
E: canada@dymacglobal.com
T: +1 905 564 3654
Mississauga
Toronto
Canada

DyMac Europe / Ireland
E: europe@dymacglobal.com
T: +353 1 442 0516
Unit 3B, Canal Bank
Hume Avenue
Park West Ind EST
Dublin
Ireland

www.dymacglobal.com