

**PROPOSED SUITE PLAN**  
SCALE : 3/16" = 1'-0"

**PROJECT NOTES :**

1. ALL SUITE CONSTRUCTION IS EXISTING UNLESS OTHERWISE INDICATED.
2. ALL NOTES AND DIMENSIONS ARE TYP. FOR SUBSEQUENT CONDITIONS UNLESS OTHERWISE INDICATED.
3. VERIFY ALL CONDITIONS IN FIELD PRIOR TO BEGINNING ANY WORK.
4. PROVIDE A DEDUCTIVE ALTERNATE FOR A CLIENT PROVIDED CAB & SINK.

**OCCUPANCY CALCULATIONS**

OFFICE AREA BUSINESS USE  
630 S.F. GROSS @ 1 PERSON/150 S.F. = 5 PEOPLE  
STORAGE WAREHOUSE USE  
1,134 S.F. GROSS @ 1 PERSON/300 S.F. = 3 PEOPLE  
TOTAL NEW OCCUPANT LOAD = 8 PEOPLE

**PLAN LEGEND**

- CONC. TILT-UP WALL
- PANEL POINT
- EXISTING 1 HR. F.R. WALL
- NEW PARTITION WALL
- NEW PARTITION WALL TO THE DECK
- 2A10BC FIRE EXTINGUISHER
- COLUMN/SUITE GRID DESIGNATION
- DOOR DESIGNATION
- WINDOW DESIGNATION
- SECTION DETAIL
- SHEET LOCATION

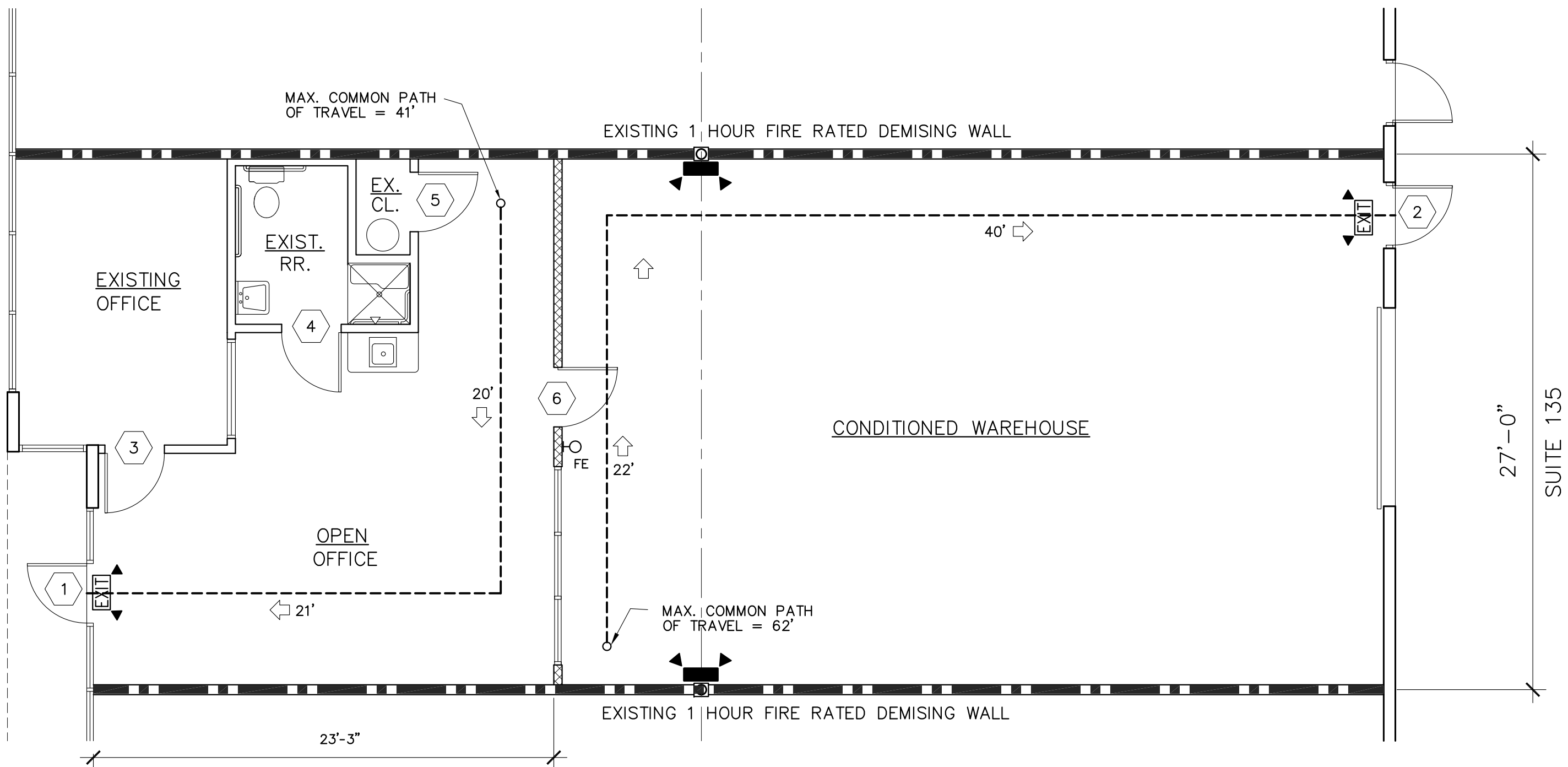

**LIFE SAFETY PLAN**  
SCALE : 3/16" = 1'-0"

DOOR SCHEDULE												
MARK	NO.	SIZE	THICK	CORE	MAT'L	TYPE	FRAME	THRES.	HARDW.	CLOS.	KICK	REMARKS
1	1	3'-0"X 7'-0"	1 3/4"	GL.	ALUM.	STOREFRONT	ALUM.	ALUM.	THUMBTURN	YES	—	EXISTING STOREFRONT DOOR
2	1	3'-0"X 6'-8"	1 3/4"	HOL.	ALUM.	FLUSH	ALUM.	ALUM.	THUMBTURN	YES	—	EXISTING REAR DOOR
3	1	3'-0"X 6'-8"	1 3/4"	SOL.	WD	FLUSH	H.M.	—	LOCKSET	—	—	EXISTING OFFICE DOOR
4	1	3'-0"X 6'-8"	1 3/4"	SOL.	WD	FLUSH	H.M.	—	PRIVACY	YES	—	EXISTING DOOR W/ RR SIGNAGE
5	1	3'-0"X 6'-8"	1 3/4"	SOL.	WD	FLUSH	H.M.	—	PASSAGE	—	—	EXISTING CLOSET DOOR
6	1	3'-0"X 6'-8"	1 3/4"	GL.	WD	FRENCH	H.M.	—	LOCKSET	—	—	RELOCATED DOOR

**DOOR NOTES**

1. ALL EXIT DOORS SHALL BE OPERABLE FROM THE INSIDE WITHOUT SPECIAL KNOWLEDGE OR EFFORT OR THE USE OF A KEY AND SHALL FOLLOW ALL APPLICABLE CODES.
2. ALL DOORS SHALL BE EQUIPPED WITH H.C. ACCESSIBLE HARDWARE (LEVER TYPE) UNLESS OTHERWISE INDICATED.

NEW WINDOW SCHEDULE								
MARK	NO.	SIZE	FRAME	FINISH	GLAZING	TYPE	TEMPERED	REMARKS
A	1	10'-0" X 10'-0"	ALUM.	MILL	CLEAR	FIXED	YES	RELOCATED STOREFRONT

**WINDOW NOTE**

1. ALL ARCHITECTURAL GLAZING MATERIALS AND INSTALLATION SHALL COMPLY WITH ALL APPLICABLE CODES AND REGULATIONS OF THE 2023 F.B.C.

ROOM FINISH SCHEDULE													
ROOM DESCRIPTION	FLOOR	BASE	WALLS		CEILING	HEIGHT	WAINS	REMARKS					
	L.V.P.	SEALED CONC.	VINYL	EGG SHELL SATIN PAINT	ACOUS. TILE EXPOSED	8'-0" A.L.F.F. VARIES							
OPEN OFFICE	•	•	•	•	•	•	•						SEE FINISH NOTES
OFFICE	•	•	•	•	•	•	•						
RESTROOM	•	•	•	•	•	•	•						
STORAGE CLOSET	•	•	•	•	•	•	•						
WAREHOUSE	•	•	•	•	•	•	•						

**FINISH NOTES**

1. ALL INTERIOR FINISHES SHALL MEET THE RESTRICTIONS OF THE 2023 F.B.C. & 2023 F.F.P.C.
2. ALL MATERIALS TO BE APPLIED IN ACCORDANCE WITH MANUFACTURER'S SPECIFICATIONS AND REQUIREMENTS. PROVIDE ACTUAL SAMPLES OF ALL FINISHES FOR APPROVAL BY CLIENT PRIOR TO ORDER OR INSTALLATION.
3. ALL PAINTED SURFACES TO RECEIVE A MINIMUM OF ONE PRIMER COAT & TWO FINISH COATS (SHERWIN WILLIAMS OR APPROVED EQUAL). COLOR TO BE SELECTED BY ARCHITECT/INT. DESIGNER & APPROVED BY OWNER.
4. ALL DOORS & FRAMES SHALL BE FINISHED AS PER THE DOOR SCHEDULE. COLOR SHALL MATCH EXISTING.
5. CONTRACTOR SHALL PROVIDE A BUDGET FOR ALL INTERIOR FINISHES.
6. COORDINATE ALL WORK WITH ERIKA DUARTE.

**LIFE SAFETY PLAN LEGEND**

- 2A10BC FIRE EXTINGUISHER
- DOOR DESIGNATION
- EXIT LIGHT W/ BATTERY BACK-UP
- EMERGENCY LIGHT W/ BATTERY BACK-UP
- EXIT/EMERGENCY COMBO LIGHT W/ BATTERY BACK-UP
- PATH OF EGRESS
- EGRESS FLOW
- DOOR ASSEMBLY

**PLAN NOTES**

1. All dimensions are plus or minus and subject to verification of existing dimensions in field by job superintendent.
2. All dimensions shown are finish dimensions and all walls are nominally 5" thick unless otherwise indicated.
3. All storefronts, exterior walls & doors, etc. are existing unless otherwise indicated.
4. All exit doors shall be operable from the inside without special knowledge or effort or the use of a key and shall meet all applicable codes.
5. Coordinate finish and hardware schedule with project manager.
6. Verify exact location of all switches, electrical, telecommunication and phone outlets with project manager.

**LIFE SAFETY DATA**

**OFFICE/BUSINESS AREA**

OCCUPANT LOAD FACTOR 5 PEOPLE  
REQUIRED MEANS OF EGRESS WIDTH 36"  
PROVIDED MEANS OF EGRESS WIDTH 36"  
NUMBER OF EXITS REQUIRED 1  
NUMBER OF EXITS PROVIDED 1  
COMMON TRAVEL PATH ALLOWED 100'  
MAX. COMMON PATH OF TRAVEL 41'

**WAREHOUSE AREA**

OCCUPANT LOAD FACTOR 3 PEOPLE  
REQUIRED MEANS OF EGRESS WIDTH 36"  
PROVIDED MEANS OF EGRESS WIDTH 36"  
NUMBER OF EXITS REQUIRED 1  
NUMBER OF EXITS PROVIDED 1  
COMMON TRAVEL PATH ALLOWED 100'  
MAX. COMMON PATH OF TRAVEL 62'