



CRUCIBLE

The AI Architecture to Automate
& Replace Enterprise Strategy

The Consulting Industry Sells Compromise. We Engineer Synthesis.

THE OLD WAY: THE CONSULTING MODEL



Legacy firms like McKinsey and Accenture optimize for **trade-offs**. Their solutions are fundamentally limited by human cognition, resulting in slow, expensive compromises.

“Whereas conventional engineering often settled for compromises or trade-offs, TRIZ provided a toolkit to resolve these contradictions... This shift from compromise-based optimization to contradiction-elimination was the fundamental philosophical contribution...”

THE NEW WAY: THE CRUCIBLE MODEL

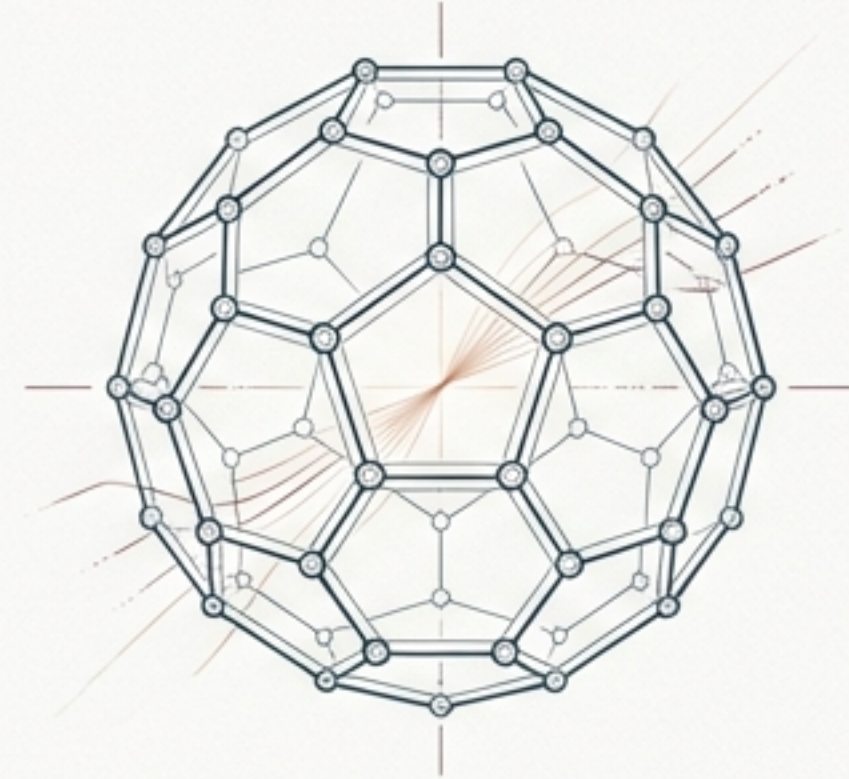

Our AI system systematically models and eliminates contradictions to achieve **synthesis**. It finds the non-obvious solution where you get speed *and* reliability, strength *and* low mass. This is exponential, scalable, and unlocks true invention.

A System for Structured, Adversarial Invention

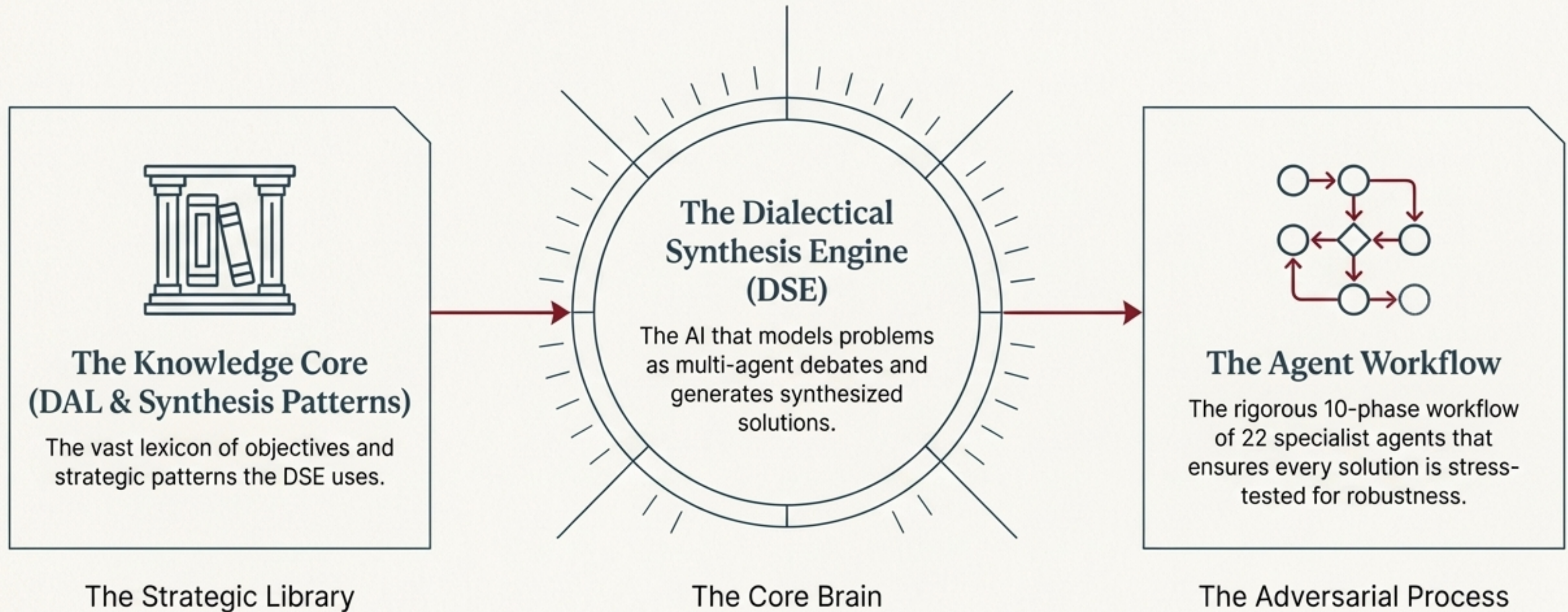

The DSE Models Conflict Across a Dialectic-Antinomy Continuum

Systemic Dialectic (Macro View)

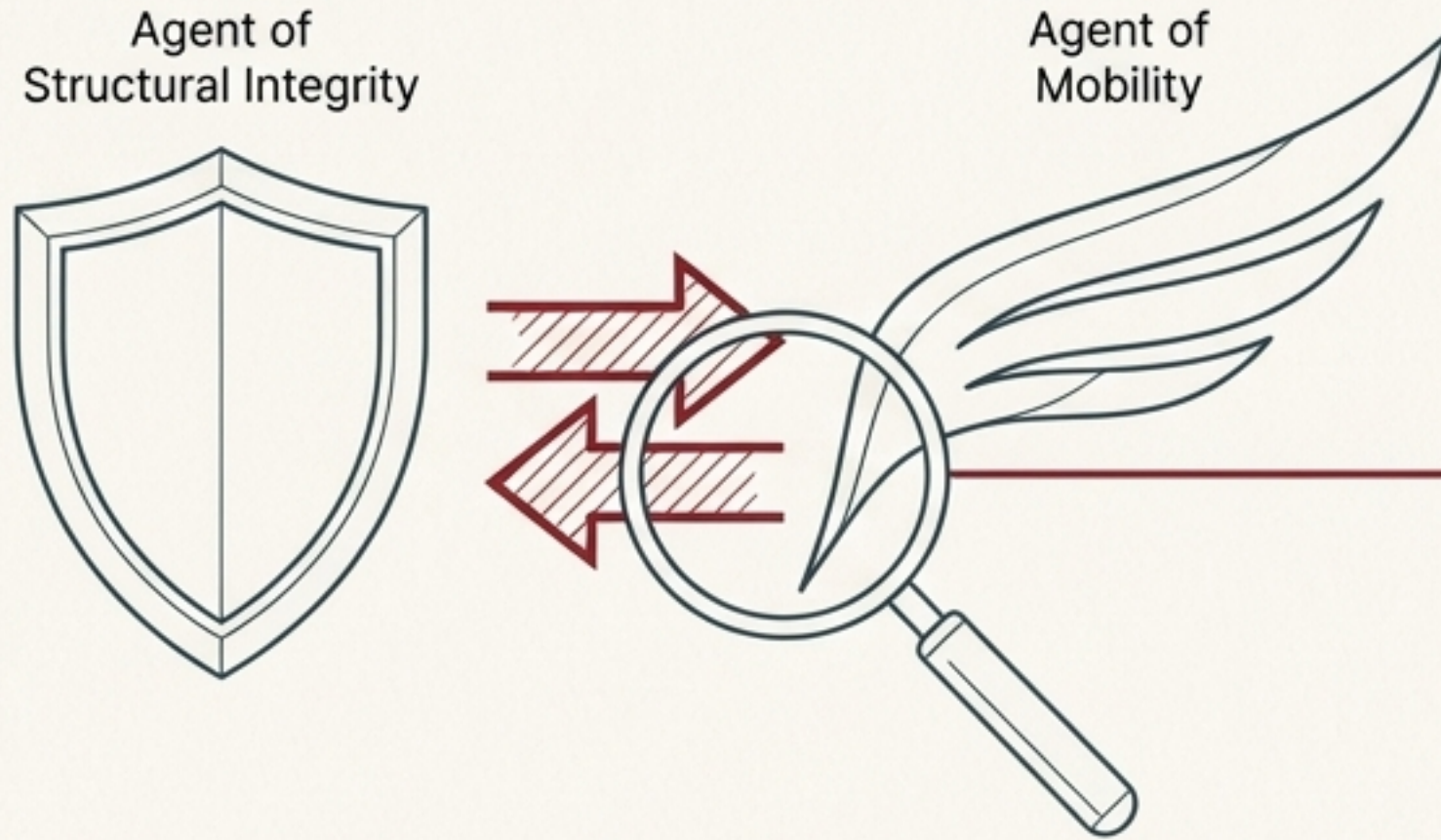

Models high-level tensions **between** competing agents.
This is an externalized conflict.
Example: 'Agent of Structural Integrity' vs. 'Agent of Mobility'.

Agentic Antinomy (Micro View)

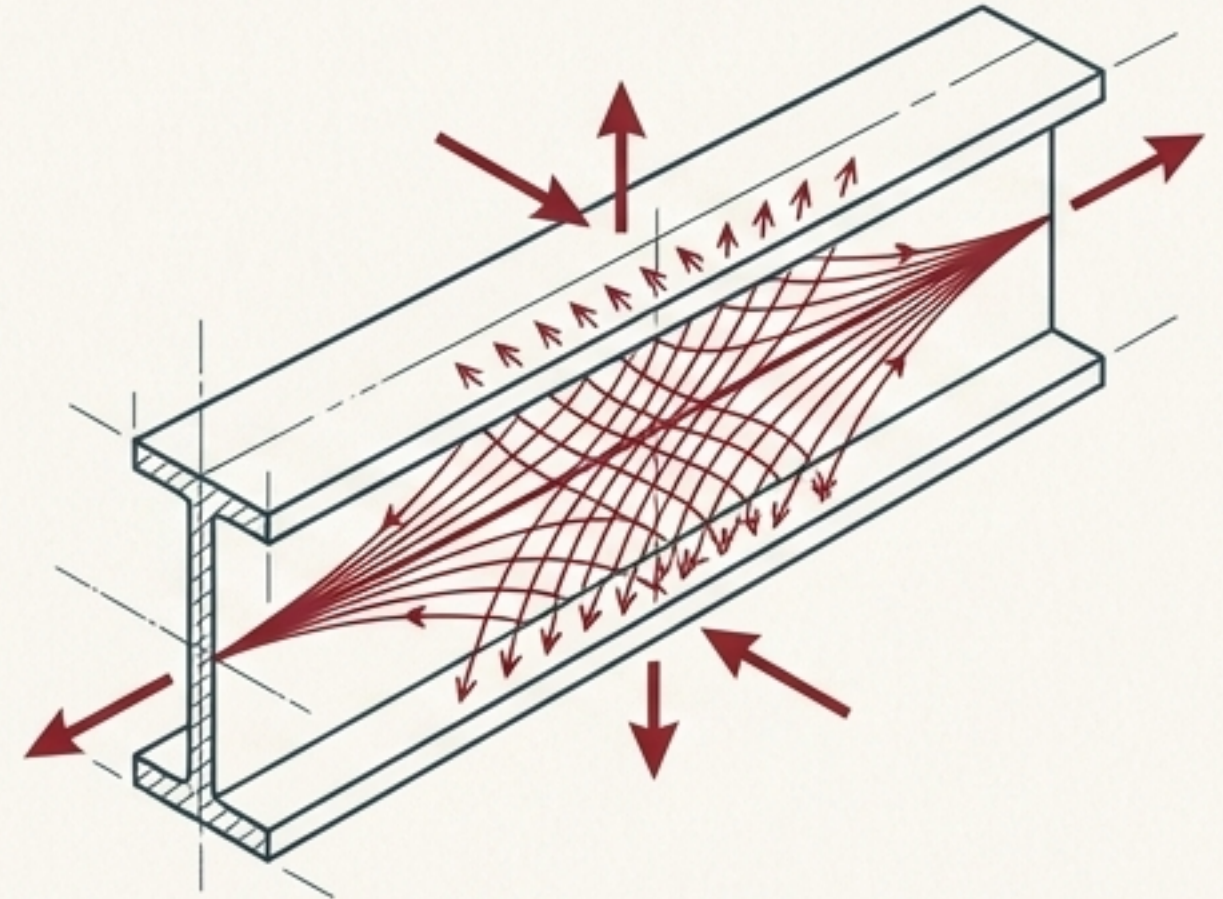

Models internalized contradictions **within** a single component.
Example: A material must embody both 'Rigid' to resist wear
and 'Pliant' to absorb energy.

The AI's Power: The DSE fluidly "zooms" between these views, collapsing a Dialectic into its core Antinomy or expanding an Antinomy to understand its systemic impact. This dynamic abstraction modulation is key to finding the most fertile point for a breakthrough.

An Exponentially Expanded Language for Modern Innovation

Classical TRIZ (c. 1946)

39

Static Engineering
Parameters

40

Inventive Principles

Designed for mechanical,
electrical, chemical problems.

CRUCIBLE (AI-Native)

61

Dynamic Agentic Lexicon (DAL): 61 agentic objectives, expanding beyond the physical to cover cognitive, ethical, and informational domains ('Cognitive Load', 'Ethical Alignment').

45

Synthesis Patterns: 45 patterns, including the 40 classical principles plus 5 emergent, AI-era patterns.



Cognitive
Substitution



Sensory
Augmentation



Platformization



Superpositional
Function



Ethical
Framing

The Bottom Line: A nearly **3x increase** in the creative reach of the original system, purpose-built for today's complex challenges.

Four Synthesis Protocols to Resolve 'Impossible' Contradictions

Where classical TRIZ used simple separation principles, CRUCIBLE's DSE deploys four advanced Synthesis Protocols to resolve **Agentic Antinomies**—where a component must embody two opposing states.



1. Temporal Modulation

Separate in time (e.g., A traffic light is both 'Go' and 'Stop' at different times).



2. Spatial Differentiation

Separate in space (e.g., A knife has a 'sharp edge' and a 'strong spine').



3. Conditional State Switching

Change based on conditions (e.g., Smart armor is 'pliant' until impact, then becomes 'rigid').



4. Emergent Property Synthesis

Separate by scale (e.g., Rigid chain links create a 'flexible' chain).

Rigor Through a 10-Phase Adversarial Workflow

CRUCIBLE operates as a 10-phase process, with each phase owned by a pair of specialized AI agents: a **Protagonist** advancing a thesis and an **Antagonist** stress-testing it.

This structured adversarial process, orchestrated by the **Nexus** agent, ensures every solution is rigorously pressure-tested for clarity, novelty, and resilience before completion. A minimum of two adversarial iterations are required per phase.

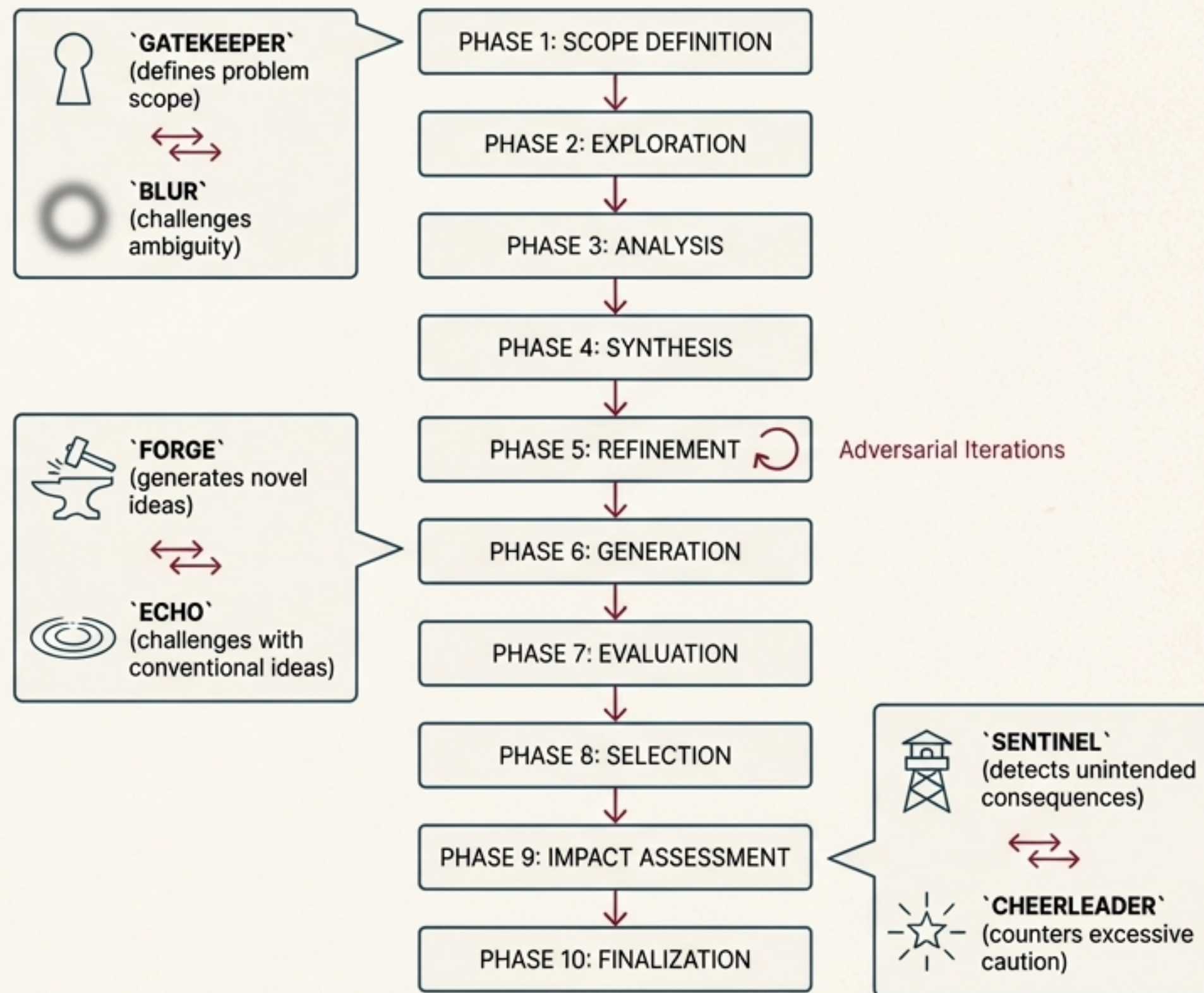

Case Study: Ultra-Fast EV Charging Without Grid Upgrades

The Dialectic: `Agent of Driver Time` vs. `Agent of Grid Stability`.

The Antinomy: The battery must be `Rapidly Energized` (high C-rate) yet `Gently Preserved` (low thermal stress).

The CRUCIBLE Synthesis Pathway: "Buffered Boost"

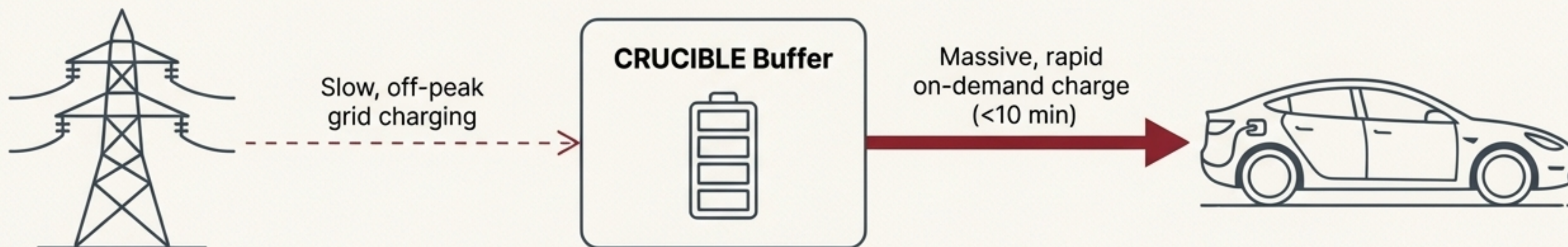

Protocols Applied: Spatial Differentiation & Temporal Modulation.

Patterns Applied: Intermediary (24), Nesting (7), Feedback (23).

Solution: The DSE generates a solution using an on-site DC battery buffer. This buffer charges slowly from the grid during off-peak hours (solving the Grid Stability problem) and then delivers a massive, **rapid charge** to the vehicle on-demand (solving the Driver Time problem).

Case Study: Generative Design Beyond Human Bias

The Primary Dialectic: Agent of Minimal Mass vs. Agent of Structural Integrity.

The Root Cause Dialectic: Agent of Optimal Performance vs. Agent of Human Design Bias.

Human-Designed Equivalent

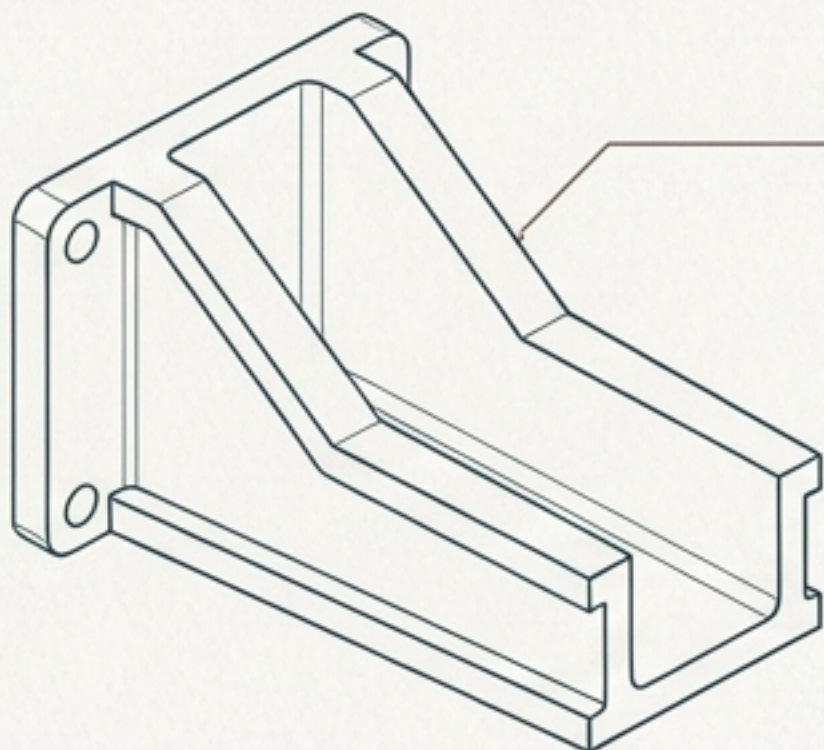

**45%
LIGHTER**

**20%
STRONGER**

CRUCIBLE Generative Design

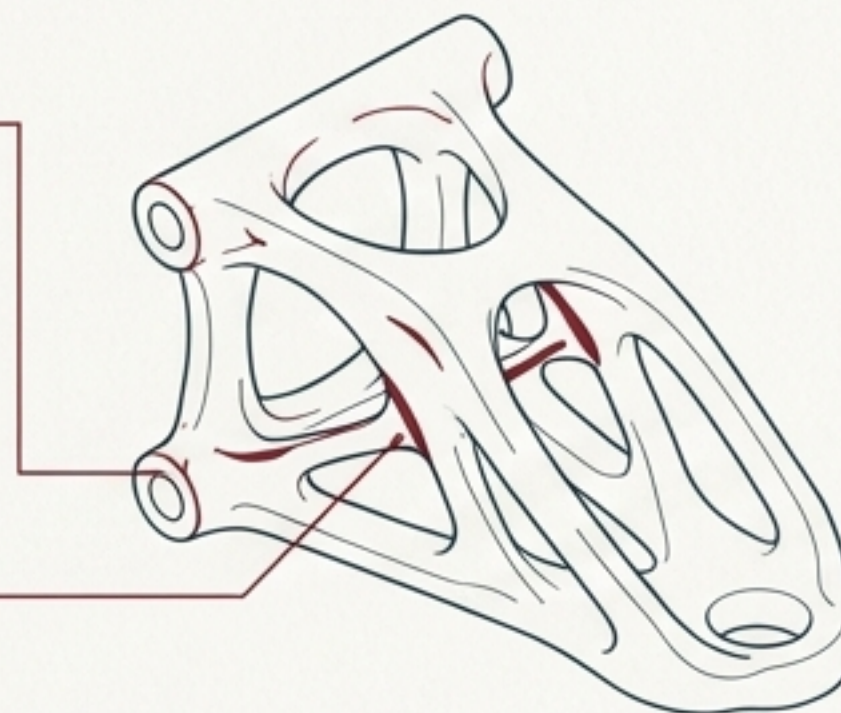

The CRUCIBLE Synthesis Pathway:

Pattern Applied: Cognitive Substitution (41).

Core Move: The DSE identified human design bias (favoring familiar geometries) as the core bottleneck and replaced the human design loop with a generative design algorithm.

Result: A novel, organic bracket optimized for additive manufacturing that is 45% lighter and 20% stronger than the best human-designed equivalent.

An Exponential Solution Space: The Unfair Advantage

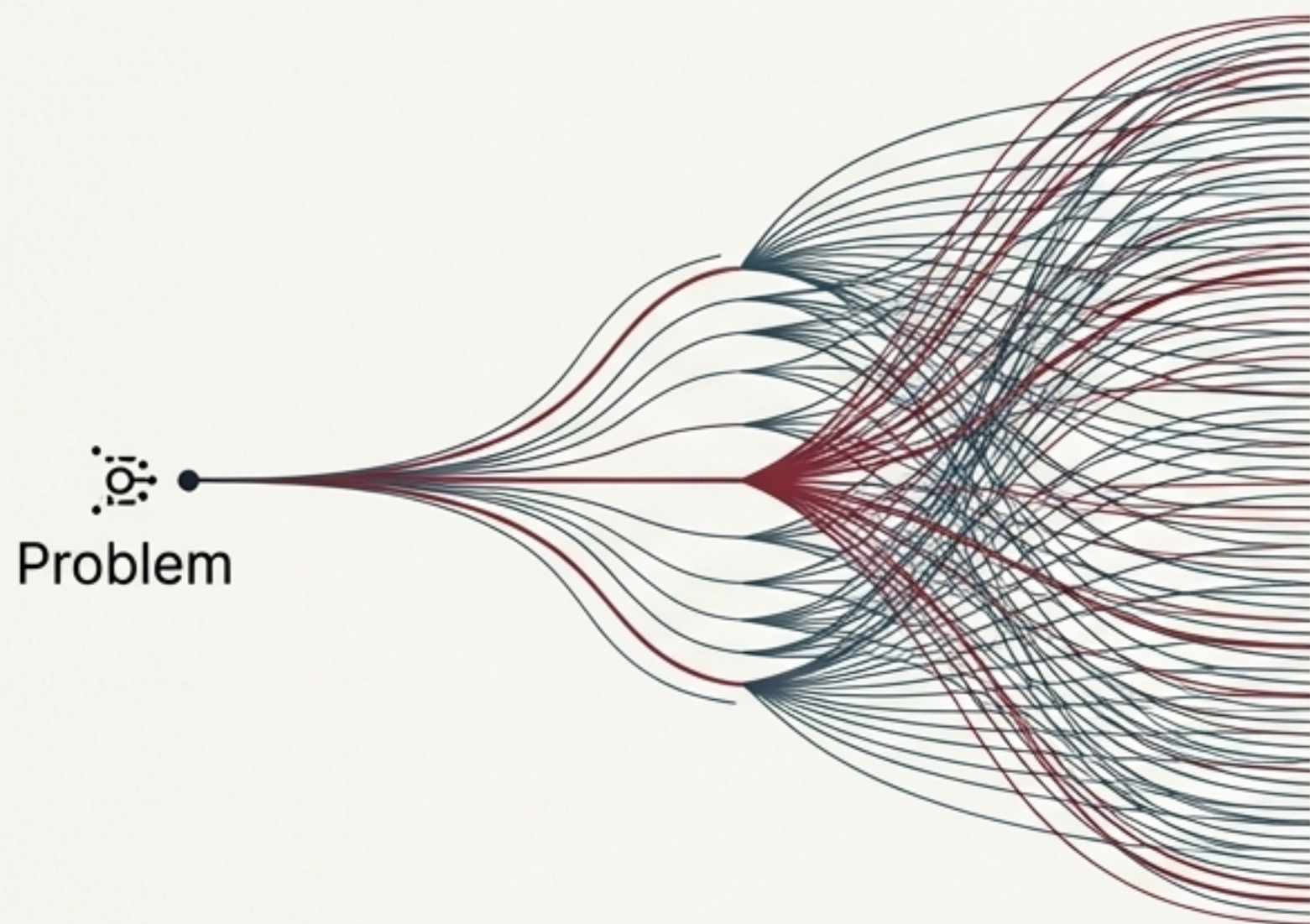

5,300,000,000+
Potential Synthesis Routes

CRUCIBLE is not a static matrix; it is a generative system for systematic invention. With 61 objectives (DAL), 45 Synthesis Patterns, and 4 Synthesis Protocols, the DSE can generate a vast and complex solution space. A conservative estimate for a simple 3-step synthesis pathway reveals over **5.3 Billion** potential routes.

From Billable Hours to an Automated Consulting Stack

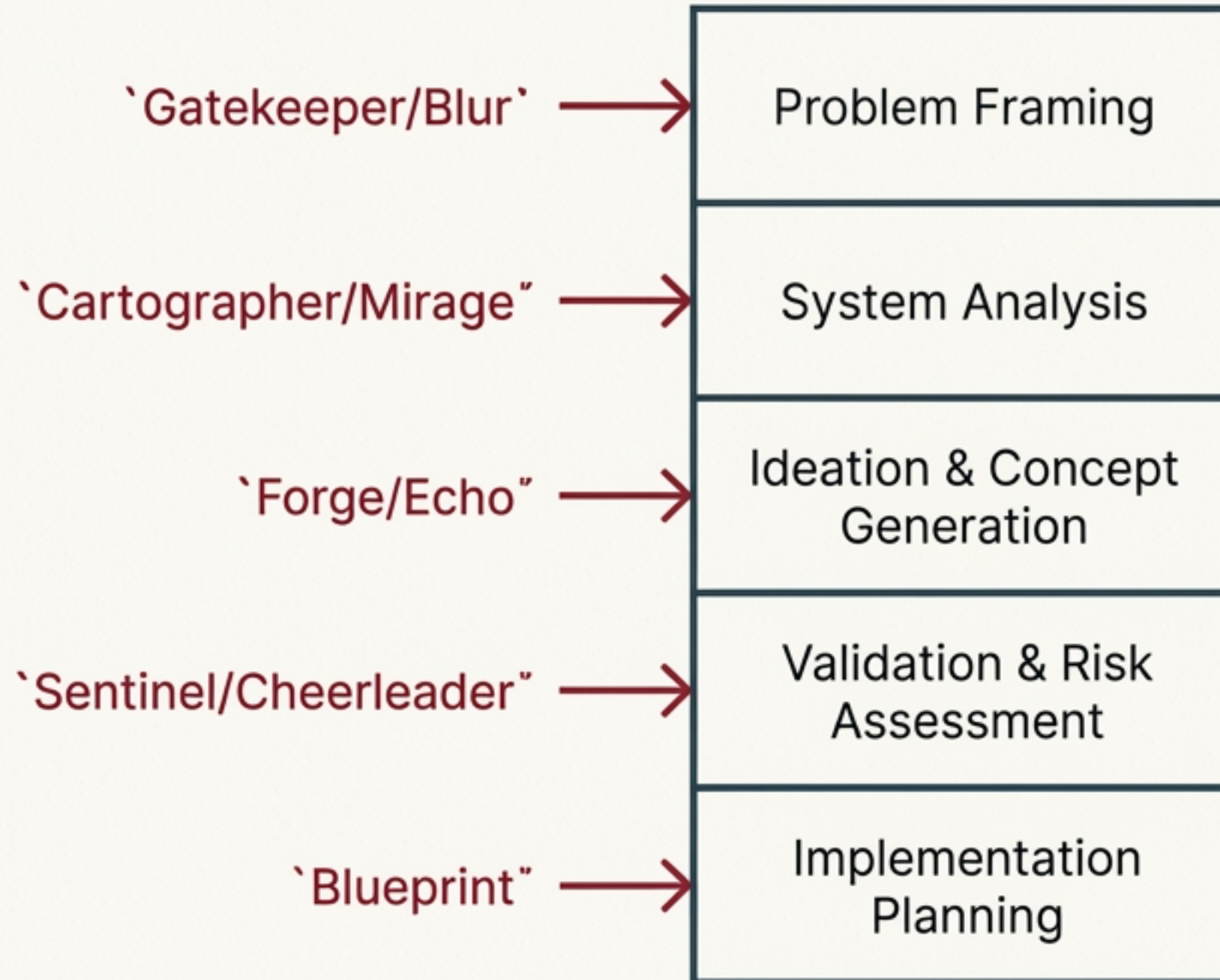

The New Paradigm for Strategy & Innovation

| Feature | Legacy Consulting | CRUCIBLE Platform |
|------------------|---------------------------|-------------------------------------|
| Scalability | Linear (Hire more humans) | Exponential (Cloud compute) |
| Speed | 3-6 Months | 3-6 Hours |
| Solution Quality | Compromise & Optimization | Synthesis & Invention |
| Rigor | Subjective & Bias-prone | Systematic & Adversarial |
| Cost Model | High (Billable Hours) | Low (SaaS Subscription) |

We Are Not a Better Tool for Consultants. We Are Their Replacement.

The Market: The global Management Consulting market is a multi-trillion dollar industry built on an inefficient, pre-AI labor model.

The Product: CRUCIBLE is a scalable SaaS platform that delivers elite-tier strategy and innovation as a service, automating the entire consulting value chain.

The Vision: To become the default operating system for any organization solving its most complex challenges, capturing the value currently locked in the billable hours of legacy firms.

Let's Build the Future of Problem-Solving.

Tom Brazil

tom.brazil@agentovation.com

www.agentovation.com

Request a live demo. We will solve one of your portfolio's toughest challenges.

