

ROHO® Dry FLOATATION® cushion inflation and adjustment guide

permobil

The QUADTRO SELECT has four compartments of air cells. When the ISOFLO® Memory Control is open, the air flows freely between the compartments. When the ISOFLO is closed, the air is “locked” within each compartment. The inflation level of each compartment can be separately adjusted. This allows you to correct or accommodate side-to-side and/or anterior-posterior asymmetries of the pelvis and upper legs. **NOTE: Before adjusting the cushion for an asymmetry, you MUST adjust the air inflation level to the proper cushion inflation setting as outlined below.**

QUADTRO SELECT setup

Inflate and adjust the ROHO QUADTRO SELECT cushion for a new individual.

1. Place the Quadtro Select cushion in the wheelchair with the air cells facing up and the non-skid surface of the cover facing down.
2. Before inflating, you must open the ISOFLO Memory Control so that all of the air cells will inflate. Push the ISOFLO green knob toward the unlocked position.
3. Slide the rubber nozzle of the hand pump over the inflation valve. Pinch the nozzle, turn to open the inflation valve, and overinflate the air cells.
4. Remove the hand pump.

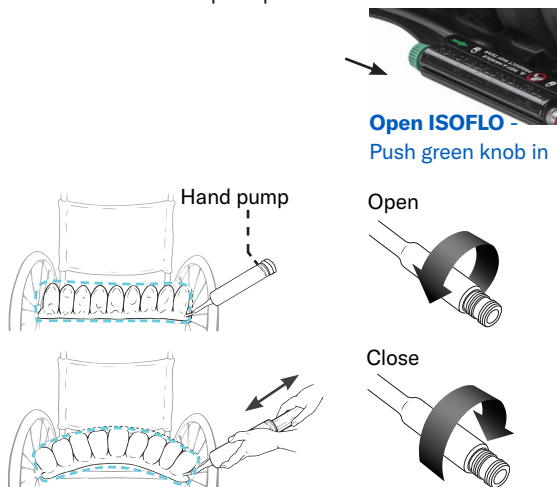

QUADTRO SELECT adjustment

Check the inflation level daily by performing a *hand check*.

After overinflating the cushion, perform a *hand check* to adjust to the *proper cushion inflation setting*:

1. The individual should sit in the chair in their usual position. The cushion should be centered beneath the individual.

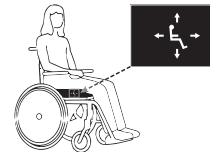

2. Perform a hand check:
 - a. Slide your hand between the cushion and the individual. Lift the leg slightly and feel for the lowest bony prominence, and then lower the leg to a sitting position.

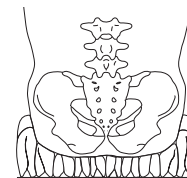

- b. Open the valve to remove air, keeping your hand beneath the individual's lowest bony prominence.

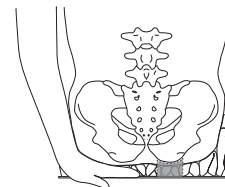

- c. Release air until you can slightly move your fingertips. Close the valve.

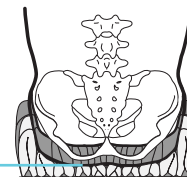

1/2" - 1"
Proper cushion inflation setting
1/2" - 1" (1.5 cm - 2.5 cm)

Hand check results

Re-adjust the inflation level only as needed (typically every 3-4 months).

- If you can slightly move your fingertips: the cushion is at the Proper Cushion Inflation Setting (1/2" - 1" air between the lowest bony prominence and the seat surface) and no further adjustment is needed.
- If you can easily move your fingertips: there is too much air between the lowest bony part prominence and the seat surface. Open the inflation valve and slowly release air until you can barely move your fingertips, then close the valve.
- If you cannot move your fingertips at all: there is too little/no air between the lowest bony prominence and the seat surface. Open the inflation valve and slowly add air until you can slightly move your fingertips, then close the valve.

See reverse side for instructions on how to adjust QUADTRO SELECT for postural asymmetries.