

Kustomworx LLC,

503 -502 -2443

1250 NW Perimeter Way - Troutdale, Oregon 97060

scott@kustomworxLLC.com

Order form / build sheet for the 1911 Double Stack Series.

After an order is placed any Changes or Request must be made in writing via email **NO TEXT CHANGES ALLOWED.**

Please completely Fill out and return the build sheet to
scott@kustomworxllc.com

I can no longer take orders placed over the phone or by Text

Base Price is \$3,400.00 Vulcan or Defender

The base price includes the following finishes, brushed finish, satin finish or Black Nitride finish. Prices for PVD/DLC Finishes vary based on what gets coated, In General a complete gun would run between \$350 & \$500 for one color. & \$500.00 to \$600 for two colors. The Minimum charge is 275.00 per color. These prices are set by the coating facility.

Polished Finishes are \$150.00 for Frame, \$200 for Slide, \$350 for a complete gun.

The Polished finish may have some very minor scratches; we sand to 1000 Grit and then Polish.

_____ 5 Inch Vulcan with Full Length Dust Cover (standard)

_____ 4 ¼ Inch Defender Standard Length Dust Cover _____ Full Length Dust cover _____

Customer Information: This is Required Information (We must be able to read any handwriting)

First _____ Middle _____ Last _____

Address _____ City _____ State _____ Zip _____

Phone # _____ Email _____

Available PVD Colors: More colors will be added as they become available.

Alpha T - Gold Alpha TS – Copper Alpha Slate - Silver Gray

Alpha GR - Titanium Rose Gold

Customer Comments

Kustomworx LLC,

503 -502 -2443

1250 NW Perimeter Way - Troutdale, Oregon 97060

scott@kustomworxLLC.com

Please Choose one of the following.

HANDGUN RANGE BAG OPTIONS:

_____ BLACK
_____ FDE
_____ ACU CAMO

TEE SHIRT

_____ Men's
_____ Women's

_____ Small
_____ Medium
_____ Large
_____ X Large
_____ XX Large
_____ XXX Large

Each Firearm Includes the Following Items.

1. Handgun Range Bag - GPS Double Pistol case Range Bag
2. 3 ATLAS 18 round capacity Magazines or 3 MBX 18 Round Magazines.
3. Lock – ATF Required item.
4. TEK 1911 Cleaning Mat.
5. Tee Shirt.
6. Custom ID Tag.

Please choose a caliber

Additional charge for Ported or Threaded Barrels.

Caliber

Ported \$250.00

Threaded \$150.00

_____ 9MM
_____ 38 Super
_____ 45 ACP

_____ Ported
_____ Ported
_____ Ported

_____ Threaded Barrel
_____ Threaded Barrel
_____ Threaded Barrel

Porting Options

_____ **V10 porting**

_____ **Inline Porting**

Choose the type of finish you would like on the barrel.

_____ Polished _____ BLK DLC Custom PVD Color _____

If you have chosen a threaded barrel option, please indicate what thread size you want or provide us the Make and Model of your suppressor. Most common thread sizes are:

_____ 1/2 inch X 28

_____ 5/8 X 24

Special request _____

Please choose below to indicate what finish you would like to have on your firearm, you can mix and match finishes to personalize your firearm.

Frame

☐ Black Nitride 4 week delay
☐ Black DLC
☐ Polished
☐ Brushed
☐ Satin
☐ Custom PVD

Slide

☐ Black Nitride 4 week delay
☐ Black DLC
☐ Polished
☐ Brushed
☐ Satin
☐ Custom PVD

IF Choosing Custom PVD Colors, please indicate which PVD coating _____

Please choose a Slide Option

If you are choosing an Optics Cut slide there are 3 different footprints to choose from and we have verified the fit of the following.

1. RMR Footprint - Used on Holosun, Swamp fox, Bushnell, Trijicon and a few others. We recommend Holosun or the Trijicon for the RMR footprint. **If you plan to use the Trijicon SRO please let us know before delivery, the Trijicon SRO uses a different rear fixed sight that mounts behind the glass.**
2. Delta Point Pro. Only fits the Leupold Delta Point Pro.
3. Aimpoint Acro

☐ Standard Slide with adjustable Rear Site. Choose your front site option.

☐ Fiber Optic Front ☐ Tritium ☐ Gold Bead **ADD \$100.00**

☐ RMR Optics Cut Slide with co Witness Rear site choose your choice of front site option.

☐ Fiber Optic Front ☐ Tritium ☐ Gold Bead

☐ Delta Point Pro Optics Cut Slide with NO FIXED SIGHTS.

☐ RMR Optics Cut Slide with NO Fixed Sights

☐ Aimpoint ACRO Optics Cut Slide with NO FIXED SIGHTS

Kustomworx LLC,

503 -502 -2443

1250 NW Perimeter Way - Troutdale, Oregon 97060

scott@kustomworxLLC.com

Grip Finish – CHOOSE ONLY ONE

_____ Custom Cerakote Inlay - Grip with choice of color in grip section then sand and polish around Trigger Guard and sanded areas.

Cerakote Color Name: _____ Cerakote ID Number _____

Custom Grip Additional Cost \$250.00

Colors can be seen on the Cerakote website. <https://www.cerakote.com/shop/cerakote-coating>

IF YOU CHOOSE A CUSTOM CERAKOTE INLAY YOU CAN NOT CHOOSE ANOTHER OPTION BELOW.

Aluminum Grips Can NOT be PVD/DLC coated

_____ Anodized Black – Main Spring Housing/mag flare to be coated to match as close as possible.

_____ Polished and then Cerakote Clear coated – Retains the High Polish finish. Add \$50.00

_____ Satin Finish with Cerakote Clear Coat – Retains the Satin Look. Add \$50.00

_____ Anodized Color – Gold – Red – Purple – Pink – Yellow – Green – Blue – Gray.

Main Spring Housing

_____ One Piece Mag Flare Mainspring Housing.

_____ Legacy Mag Flare with Seperate Main spring Housing

Please choose finish

_____ Polished _____ Satin _____ Brushed Finish _____ BLK DLC Custom PVD Color _____

Grip/Trigger Guard Selection

Comfortable

- _____ Diamond Pattern Rounded Trigger Guard
- _____ Diamond Pattern Squared Trigger Guard
- _____ Diamond Pattern Double Drop Trigger Guard

Semi Aggressive

- _____ Hex Pattern Rounded Trigger Guard
- _____ Hex Pattern Squared Trigger Guard
- _____ Hex Pattern Double Drop Trigger Guard

Aggressive

- _____ Plus + Pattern Rounded Trigger Guard
- _____ Plus + Pattern Squared Trigger Guard
- _____ Plus + Pattern Double Drop Trigger Guard

Kustomworx LLC,

503 -502 -2443

1250 NW Perimeter Way - Troutdale, Oregon 97060

scott@kustomworxLLC.com

Trigger Style, Length and Finish

Our One Piece Triggers are manufactured from solid Stainless or Titanium Material

Stainless Open Shoe design

Titanium Trigger ADD \$65.00

____ Short Open **Small Hands**
____ Medium Open **Average Hands**
____ Long Open **Large Hands**

____ Short Closed **Small Hands**
____ Medium Closed **Average Hands**
____ Long Closed **Large Hands**

____ Polished ____ Satin ____ Brushed Finish ____ BLK DLC Custom PVD Color _____

Hammer Options and styles

Wilson Combat Hammer styles can be seen on the Wilson Combat website

____ Kustomworx Deluxe Hammer, SEAR & Disconnecter with Aggressive serrations on Hammer
 This is a machined and matched set for the best performance.
____ Retro Commander Hammer – Wilson Combat
____ Deluxe Commander Hammer _ Wilson Combat

____ Polished ____ Satin Finish ____ Brushed finish ____ Blk DLC

Custom PVD Color _____

Guide Rod Selection

____ Standard guide rod
____ Toolless guide rod - **Add\$50.00**
____ Polished____ Satin Finish____ Brushed Finish ____BLK DLC Custom PVD Color_____

Magazine Release and style of Release button

____ Standard – Standard length button with drilled and tapped hole.
____ Extended Round Button – **Additional \$35.00**
____ Extended Oversize, Rectangle Shape or Oval Shape, **Additional \$35.00**

____ Polished ____ Brushed ____ SatinFinish ____ Black DLC

Custom PVD Color _____

Kustomworx LLC,

503 -502 -2443

1250 NW Perimeter Way - Troutdale, Oregon 97060

scott@kustomworxLLC.com

Thumb Safety (Choose Style and Finish)

____ Extended – Wilson Combat

____ Wide Extended - Wilson Combat

____ **ATLAS** Shielded single side: **Additional Charge of 120.00**

____ **ATLAS** Ambidextrous any style SEE BELOW: **Additional Charge \$200.00**

Are you a Left Handed or Right Handed Shooter: LH _____ RH _____

Please indicate which style you would like us to install. _____ Or Circle below.

____ Polished

____ Black Nitride

____ Blk DLC

Custom PVD Color _____

Below are the available Atlas Thumb Safeties.

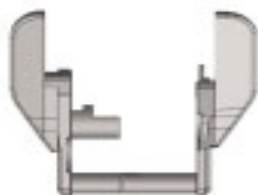

Carry Ambi Thumb Safety



Shielded Single Sided Thumb Safety

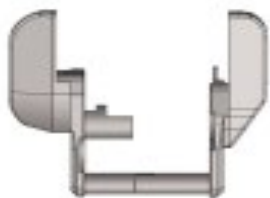

Ambi IDPA Thumb Safety

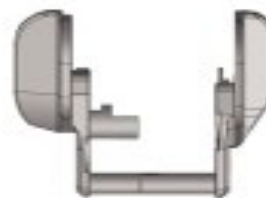

Shielded IDPA Ambi Thumb Safety

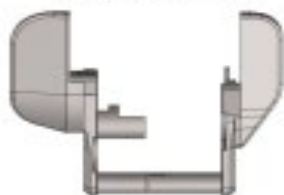

Ambi Thumb Safety

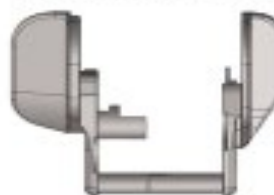

Shielded Ambi Thumb Safety

MBX or Atlas Magazines

Magazine Tubes can be PVD or DLC Coated - Add \$50.00 for prepping magazines. Does not include cost of PVD or DLC Coating.

DLC (Black) _____

PVD Color _____

Kustomworx LLC,

503 -502 -2443

1250 NW Perimeter Way - Troutdale, Oregon 97060

scott@kustomworxLLC.com

Non Functional Grip Safety

____ Polished ____ Satin Finish ____ Brushed Finish ____ BLK DLC
Custom PVD Color_____

Atlas or Wilson Combat Standard Slide Stop

____ Wilson Combat
____ Atlas

____ Polished ____ Satin Finish ____ BLK DLC or Custom PVD Color_____

ATLAS Slide stop/Thumb Rest – Gas Pedal

You can select the ATLAS Slide stop/Thumb Rest at an additional charge of \$120.00

This slide stop / Thumb rest will not allow the slide to lock back when the magazine is empty.



____ Polished ____ Satin Finish ____ Blk DLC or Custom PVD Color _____

Optics

We can supply and Install Holosun & Trigicon Reflex Optical Sights. Please be specific on what model you want. _____ Installed Price \$_____

Do Not fill in this section. We will complete this section and return the build sheet for your final approval. After final approval we will send you an electronic invoice that you can use to pay the deposit from.

Total Build Cost less PVD or DLC Coating. \$_____

Shipping Cost will be determined at time of completion. Two Day Shipping average is \$45.00

For Kustomworx LLC _____ Date_____

Kustomworx LLC,

503 -502 -2443

1250 NW Perimeter Way - Troutdale, Oregon 97060

scott@kustomworxLLC.com

Trigger Setup.

Please indicate the style and trigger release you would like on your firearm.

You must read and sign the statement below regardless of what trigger release you choose.

This firearm is delivered as a custom firearm, the trigger pull/release can be adjusted from 2lbs to 8lbs. A trigger release of 5lbs or less is considered a competition trigger release, competition triggers are insanely light for a reason, you're using it for maximum efficiency under very limited stress in a highly controlled and predictable environment. Combat or duty carry firearm triggers aren't light for a reason. When you need them, you're a ragging mess of nerves and mistakes that hopefully your training can overcome. You and you alone are responsible for determining what type of firearm and what options you require or want.

Print Name _____

Signature _____ Date ____/____/____

Trigger pull (can be from 2.0+) _____ lb.

ALL of the following Contact information below is required information – no exceptions- Incomplete info and the build sheet will not be processed.

FFL Contact information where you would you like the firearm transferred to.

All Transfers of Handguns must be made to an FFL in the state that you reside in.
Handguns Require shipping via 2 day or overnight by regulation.

Name _____

Address _____

City _____ State _____ Zip code _____

Phone Number _____

Contact Name _____

Email _____