

Kustomworx LLC,

503 -502 -2443

1250 NW Perimeter Way - Troutdale, Oregon 97060

scott@kustomworxLLC.com

Order form / build sheet for the 1911 Double Stack Series.

After an order is placed any Changes or Request must be made in writing via email **NO TEXT CHANGES ALLOWED.**

Please completely Fill out and return the build sheet to scott@kustomworxllc.com

I can no longer take orders placed over the phone or by Text

Base Price is \$3,600.00 Vulcan or Defender

The base price includes the following finishes, brushed finish, satin finish or Black Nitride finish. Prices for PVD/DLC Finishes vary based on what gets coated, In General a complete gun would run between \$350 & \$500 for one color. & \$500.00 to \$650 for two colors. The Minimum charge is 275.00 per color. These prices are set by the coating facility.

Polished Finishes are \$150.00 for Frame, \$200 for Slide, \$400 for a complete gun.

The Polished finish may have some very minor scratches; we sand to 1000 Grit and then Polish.

_____ 5 Inch Vulcan with Full Length Dust Cover (standard)

_____ 4 1/4 Inch Defender Standard Length Dust Cover _____ Full Length Dust cover _____

Customer Information: This is Required Information (We must be able to read any handwriting)

First _____ Middle _____ Last _____

Address _____ City _____ State _____ Zip _____

Phone # _____ Email _____

Available PVD Colors: More colors will be added as they become available.

Alpha T - Gold Alpha TS – Copper Alpha Slate - Silver Gray

Alpha GR - Titanium Rose Gold Alpha CR - Chrome Apperance

Customer Comments

Kustomworx LLC,

503 -502 -2443

1250 NW Perimeter Way - Troutdale, Oregon 97060

scott@kustomworxLLC.com

Please Choose one of the following.

HANDGUN RANGE BAG OPTIONS:

_____ BLACK
_____ FDE

TEE SHIRT

_____ Men's
_____ Women's

_____ Small
_____ Medium
_____ Large
_____ X Large
_____ XX Large
_____ XXX Large

Each Firearm Includes the Following Items.

1. Handgun Range Bag - GPS Double Pistol case Range Bag
2. 3 18 round capacity Magazines.
3. Lock – ATF Required item.
4. TEK 1911 Cleaning Mat.
5. Tee Shirt.
6. Custom ID Tag.

Please choose a caliber

Additional charge for Ported or Threaded Barrels.

Caliber

Ported \$250.00

_____ 9MM
_____ 45 ACP

_____ Ported
_____ Ported

_____ Threaded Barrel \$150.00

_____ 1/2 inch X 28 _____ 5/8 X 24

Special request _____

Porting Options

_____ **V10 porting**

_____ **Inline Porting**

Choose the type of finish you would like on the barrel.

_____ Polished _____ BLK DLC Custom PVD Color _____

If you have chosen a threaded barrel option, please indicate what thread size you want or provide us the Make and Model of your suppressor. Most common thread sizes are:

Please choose below to indicate what finish you would like to have on your firearm, you can mix and match finishes to personalize your firearm.

Frame

- Black Nitride 4 week delay
- Black DLC
- Polished
- Brushed
- Satin
- Custom PVD

Slide

- Black Nitride 4 week delay
- Black DLC
- Polished
- Brushed
- Satin
- Custom PVD

IF Choosing Custom PVD Colors, please indicate which PVD coating _____

Please choose a Slide Option

If you are choosing an Optics Cut slide there are 3 different footprints to choose from and we have verified the fit of the following.

1. RMR Footprint - Used on Holosun, Swamp fox, Bushnell, Trijicon and a few others. We recommend Holosun or the Trijicon for the RMR footprint. **If you plan to use the Trijicon SRO please let us know before delivery, the Trijicon SRO uses a different rear fixed sight that mounts behind the glass.**
2. Delta Point Pro. Only fits the Leupold Delta Point Pro.
3. Aimpoint Acro

_____ Standard Slide with adjustable Rear Site. Choose your front site option.

_____ Fiber Optic Front _____ Tritium _____ Gold Bead **ADD \$100.00**

_____ RMR Optics Cut Slide with co Witness Rear site choose your choice of front site option.

_____ Fiber Optic Front _____ Tritium _____ Gold Bead **ADD \$100.00**

_____ Delta Point Pro Optics Cut Slide with NO FIXED SIGHTS.

_____ RMR Optics Cut Slide with NO Fixed Sights

_____ Aimpoint ACRO Optics Cut Slide with NO FIXED SIGHTS

Kustomworx LLC,

503 -502 -2443

1250 NW Perimeter Way - Troutdale, Oregon 97060

scott@kustomworxLLC.com

Grip Finish – CHOOSE ONLY ONE

____ Custom Cerakote Inlay - Grip with choice of color in grip section then sand and polish around Trigger Guard and sanded areas.

Cerakote Color Name: _____ Cerakote ID Number _____

Custom Grip Additional Cost \$250.00

Colors can be seen on the Cerakote website. <https://www.cerakote.com/shop/cerakote-coating>

IF YOU CHOOSE A CUSTOM CERAKOTE INLAY YOU CAN NOT CHOOSE ANOTHER OPTION BELOW.

Aluminum Grips Can NOT be PVD/DLC coated

____ Anodized Black – Main Spring Housing/mag flare to be coated to match as close as possible.

____ Polished and then Cerakote Clear coated – Retains the High Polish finish. **Add \$50.00**

____ Anodized Color – Gold – Red – Purple – Pink – Yellow – Green – Blue – Gray.

Main Spring Housing

_____ One Piece Mag Flare Mainspring Housing.

_____ Legacy Mag Flare with Separate Aluminum Main spring Housing

Please choose finish

____ Polished ____ Satin ____ Brushed Finish ____ BLK DLC Custom PVD Color _____

Grip/Trigger Guard Selection

Comfortable

- ____ Diamond Pattern Rounded Trigger Guard
- ____ Diamond Pattern Squared Trigger Guard
- ____ Diamond Pattern Double Drop Trigger Guard

Semi Aggressive

- ____ Hex Pattern Rounded Trigger Guard
- ____ Hex Pattern Squared Trigger Guard
- ____ Hex Pattern Double Drop Trigger Guard

Aggressive

- ____ Plus + Pattern Rounded Trigger Guard
- ____ Plus + Pattern Squared Trigger Guard
- ____ Plus + Pattern Double Drop Trigger Guard

Kustomworx LLC,

503 -502 -2443

1250 NW Perimeter Way - Troutdale, Oregon 97060

scott@kustomworxLLC.com

Trigger Style, Length and Finish

Our One Piece Triggers are manufactured from solid Stainless or Titanium Material

Stainless Open Shoe design

Titanium Trigger ADD \$65.00

Short Open **Small Hands**
 Medium Open **Average Hands**
 Long Open **Large Hands**

Short Closed **Small Hands**
 Medium Closed **Average Hands**
 Long Closed **Large Hands**

Polished Satin Brushed Finish BLK DLC Custom PVD Color _____

Hammer Options and styles

Wilson Combat Hammer styles can be seen on the Wilson Combat website

Kustomworx Deluxe Hammer, SEAR & Disconnecter with Aggressive serrations on Hammer
This is a machined and matched set for the best performance.
 Retro Commander Hammer – Wilson Combat
 Deluxe Commander Hammer _ Wilson Combat

Polished Satin Finish Brushed finish Blk DLC

Custom PVD Color _____

Guide Rod Selection

Standard guide rod
 Toolless guide rod - **Add\$60.00**
 Polished Satin Finish Brushed Finish BLK DLC Custom PVD Color _____

Magazine Release and style of Release button

Standard – Standard length button with drilled and tapped hole.
 Extended Round Button – **Additional \$40.00**
 Extended Oversize, Rectangle Shape or Oval Shape, **Additional \$40.00**

Polished Brushed SatinFinish Black DLC

Custom PVD Color _____

Kustomworx LLC,

503 -502 -2443

1250 NW Perimeter Way - Troutdale, Oregon 97060

scott@kustomworxLLC.com

Thumb Safety (Choose Style and Finish)

_____ Extended – Wilson Combat

_____ Wide Extended - Wilson Combat

_____ **ATLAS** Shielded single side: **Additional Charge of 130.00**

_____ **ATLAS** Ambidextrous any style SEE BELOW: **Additional Charge \$220.00**

Are you a Left Handed or Right Handed Shooter: LH _____ RH _____

Please indicate which style you would like us to install. _____ Or Circle below.

_____ Polished

_____ Black Nitride

_____ Blk DLC

Custom PVD Color _____

Below are the available Atlas Thumb Safeties.

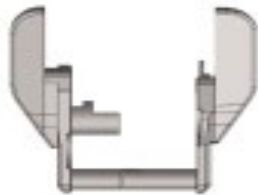

Carry Ambi Thumb Safety



Shielded Single Sided Thumb Safety

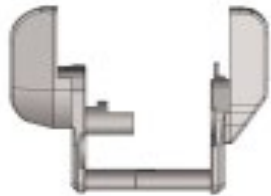

Ambi IDPA Thumb Safety



Shielded IDPA Ambi Thumb Safety

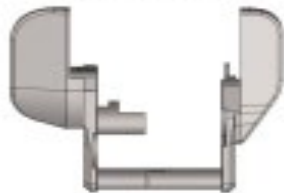

Ambi Thumb Safety

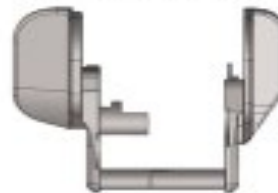

Shielded Ambi Thumb Safety

MBX or Atlas Magazines

Magazine Tubes can be PVD or DLC Coated - Add \$50.00 for prepping magazines. Does not include cost of PVD or DLC Coating.

DLC (Black) _____

PVD Color _____

Kustomworx LLC,

503 -502 -2443

1250 NW Perimeter Way - Troutdale, Oregon 97060

scott@kustomworxLLC.com

Non Functional Grip Safety

___ Polished ___ Satin Finish ___ Brushed Finish ___ BLK DLC
Custom PVD Color_____

Atlas or Wilson Combat Standard Slide Stop

___ Wilson Combat
___ Atlas

___ Polished ___ Satin Finish ___ BLK DLC or Custom PVD Color_____

ATLAS Slide stop/Thumb Rest – Gas Pedal

You can select the ATLAS Slide stop/Thumb Rest at an additional charge of \$140.00
This slide stop / Thumb rest will not allow the slide to lock back when the magazine is empty.
You will still receive the standard slide stop.



___ Polished ___ Satin Finish ___ Blk DLC or Custom PVD Color _____

Optics

We can supply and Install Holosun & Trigon Reflex Optical Sights. Please be specific on what model you want. _____ Installed Price \$_____

Do Not fill in this section. We will complete this section and return the build sheet for your final approval. After final approval we will send you an electronic invoice that you can use to pay the deposit from.

Total Build Cost less PVD or DLC Coating. \$_____

Shipping Cost will be determined at time of completion. Two Day Shipping average is \$45.00

For Kustomworx LLC _____ Date_____

Kustomworx LLC,

503 -502 -2443

1250 NW Perimeter Way - Troutdale, Oregon 97060

scott@kustomworxLLC.com

Trigger Setup.

Please indicate the style and trigger release you would like on your firearm.

You must read and sign the statement below regardless of what trigger release you choose.

This firearm is delivered as a custom firearm, the trigger pull/release can be adjusted from 3lbs to 8lbs. A trigger release of 5lbs or less is considered a competition trigger release, competition triggers are insanely light for a reason, you're using it for maximum efficiency under very limited stress in a highly controlled and predictable environment. Combat or duty carry firearm triggers aren't light for a reason. When you need them, you're a ragging mess of nerves and mistakes that hopefully your training can overcome. You and you alone are responsible for determining what type of firearm and what options you require or want.

Print Name _____

Signature _____ Date ____/____/____

Trigger pull (can be from 3.0+) _____ lb.

ALL of the following Contact information below is required information – no exceptions- Incomplete info and the build sheet will not be processed.

FFL Contact information where you would you like the firearm transferred to.

**All Transfers of Handguns must be made to an FFL in the state that you reside in.
Handguns Require shipping via 2 day or overnight by regulation.**

Name _____

Address _____

City _____ State _____ Zip code _____

Phone Number _____

Contact Name _____

Email _____