



MISSION
PROPERTIES

1111 REGENT ST

Fredericton, NB



TABLE OF CONTENTS

- Location
- Tenants
- Building
- Parking
- Units





DESTINATION LOCATION

- Hospital, Evert Chalmers
- High Schools (x2)
- Priestman Elementary School

- TransCanada Highway
- University of New Brunswick
- Residential Neighbourhood
- Primary shopping strip

Regent Street

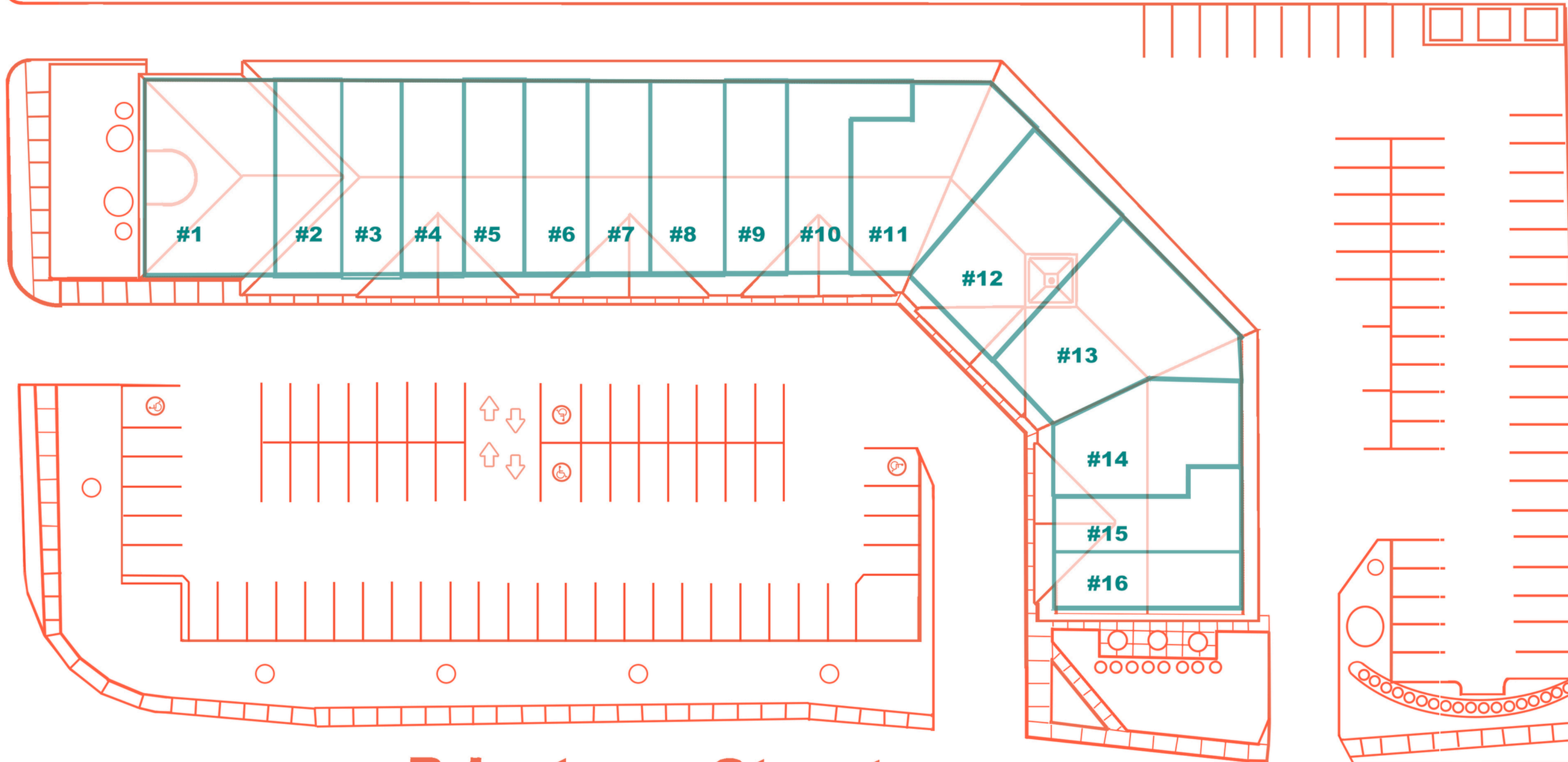

Priestman Street



1111 Regent St.
Fredericton, N.B.
E3B 3Z2

- | | | | |
|----------------|-----------------|--------------------------|-----------------------|
| 1. Scotiabank | 5. First Choice | 9. Edo Japan | 13. Optical Warehouse |
| 2. Pharmasave | 6. M&M Meats | 10. barBurrito | 14. Spice Market |
| 3. Sassy Nails | 7. Yassu | 11. Nobel Grape | 15. MaryBrown Chicken |
| 4. Telus | 8. Pizza Pizza | 12. Great Canadian Bagel | 16. Wayback Burgers |





FELLOW TENANTS

- Always bustling with the lunch hour crowd
- Popular location to run errands and for quick pick-ups

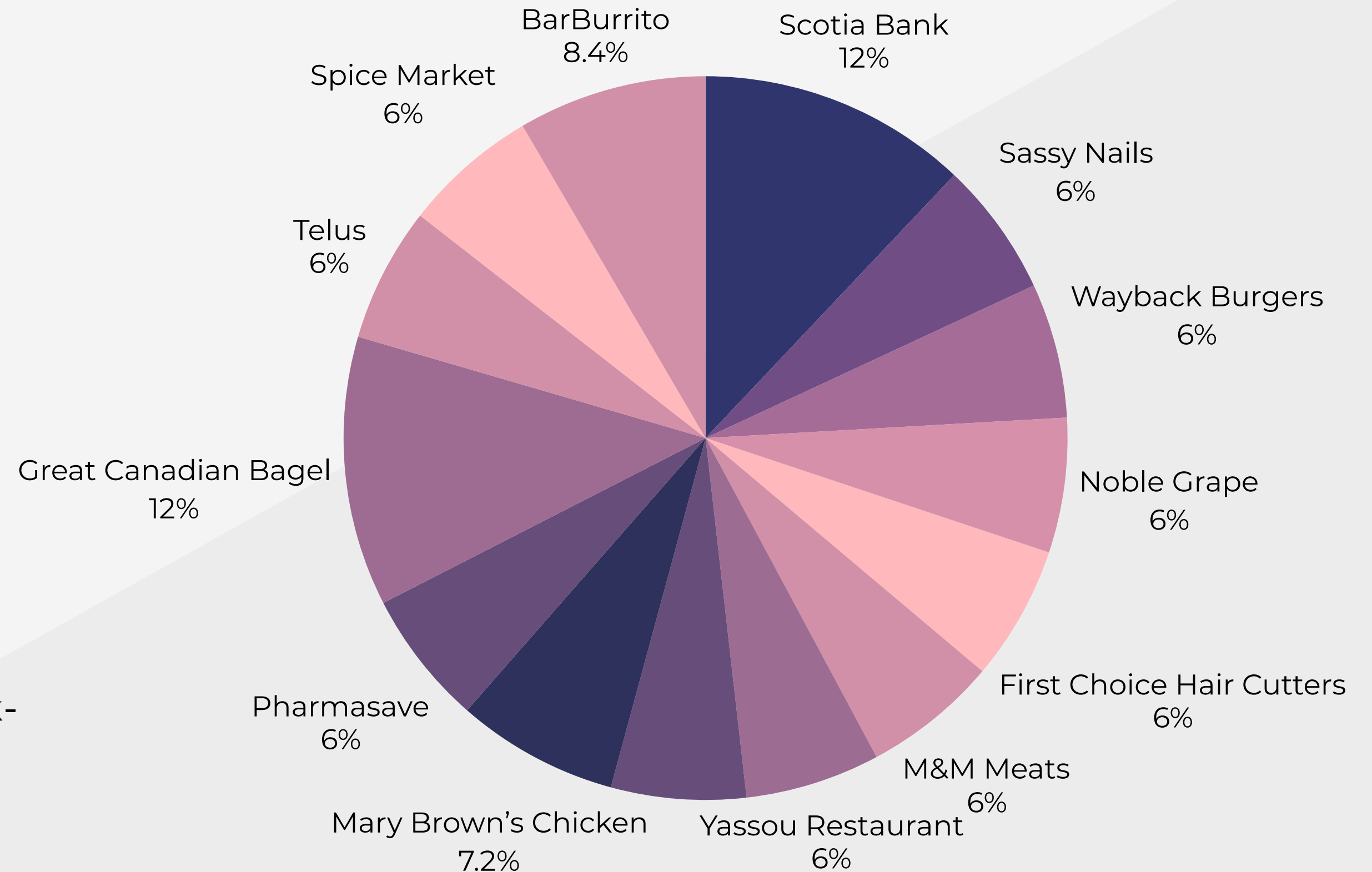

BUILDING



LOCATION

Priestman
&
Regent

RANGE

900 sq ft
-3.5000 sq ft



TOTAL SIZE

25,000 sq ft

Parking

120 Stalls
Front: 67
Back: 53

Average Unit

1,200 sq ft

KEY POINTS



Established Location

Constructed in 1995, locals know and rely on the presence of our services



Local Management

Issues are dealt with quickly thanks to constant contact



Growing Space

Due to popularity an additional 16 parking stalls were added



Managed by:



506-457-7117

arnold@missionproperties.net

www.MissionProperties.net

