

915 N 16th St

Phoenix AZ 85006

Business Complex Includes: Smoke Shop,
Boost Mobile, MetroPCS.

Nearby Business: Local Restaurants, Bar-
ber, Check Cashing Services, Grocery
Store, Convenience Store, Gas Stations
and Auto Parts Store.



Major Cross Streets are E Roosevelt St and N 16th St.

Currently separated into two suites.

Both suites are on one electrical meter.

Front and Rear parking available. Single Story, Ground Level.

Approx. 809 Square Feet (Suite 1)

Approx. 1,970 Square Feet (Suite 2)

Combined Approx. 2,779 Square Feet

Zoned C-1

Tenant Responsible for Electric Utilities & Trash
Application, Credit Check & Background Check

12 Month Lease Minimum

Available to View M-F 8am-4pm

Building 1

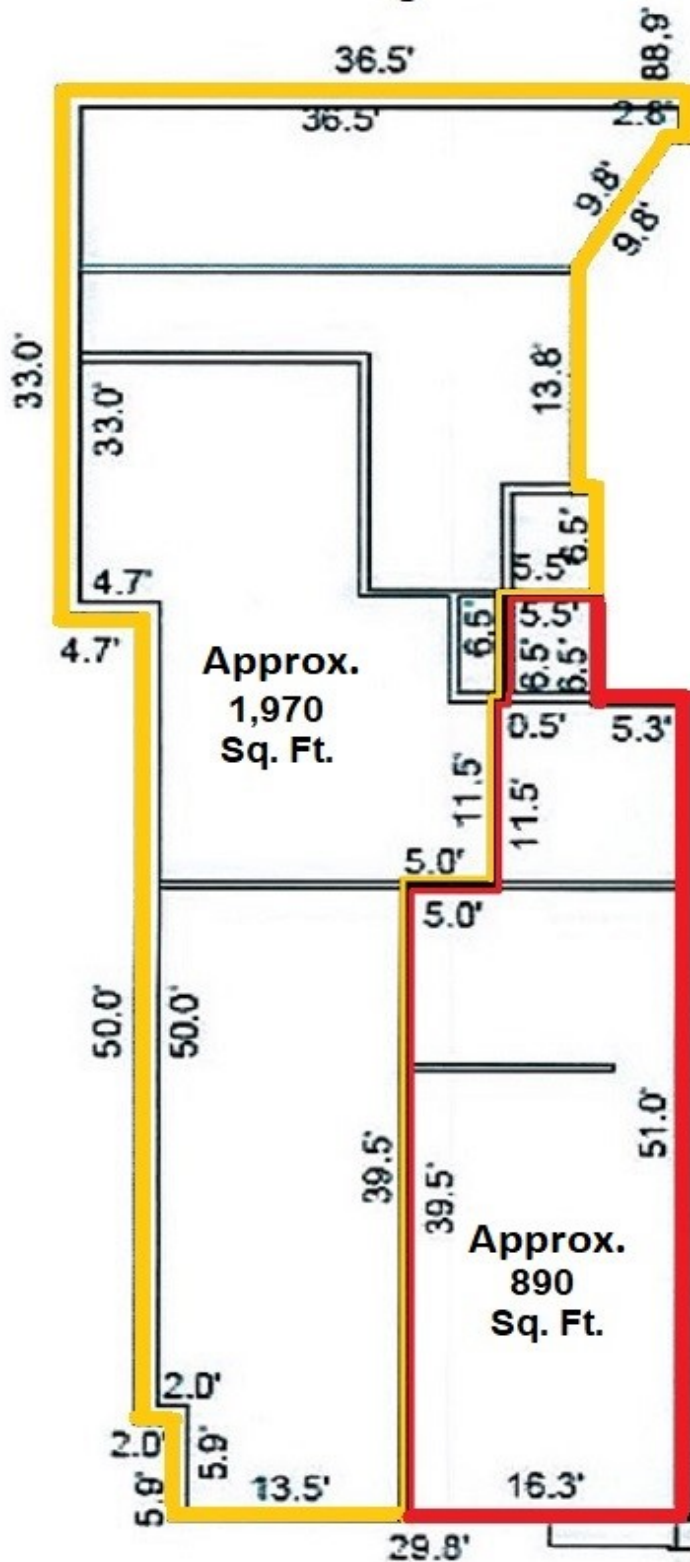

Approx.
1,970
Sq. Ft.

Approx.
890
Sq. Ft.

809 Square Feet (**Suite 1**)
1,970 Square Feet (**Suite 2**)
Combined 2,779 Square Feet
*ALL Square Footage is
Approximate

Unit 915