

Endotracheal Tube Bridle



For Endotracheal tube sizes 7.0-8.0

Instructions for Use

In quick succession:

1. Disconnect ventilator from ETT hub per your facility's standard procedure.
2. Remove the old ETT hub from the endotracheal tube.
3. Insert ETT Bridle into endotracheal tube.
4. Quickly reconnect ventilator circuit to hub of ETT Bridle
5. Loop cable tie through both loops of the bridle and pull it tight.
6. Cut off excess cable tie.

Caution: Tighten firmly by hand only.

Note: Periodically inspect product to ensure proper fitting and placement. To reposition or re-secure, cut and remove existing cable tie and replace with the spare tie from the package

Caution: In the event of incorrect application or excessive force, any hub, including this bridle may disconnect from the endotracheal tube. Keep scissors and the spare cable tie from the package on hand to replace the bridle if needed.

Caution: Incorrect assembly or application of this product may result in adverse effects on patient care.

Caution: Single Patient Use Only - Disposable - Not Sterile - DO NOT REUSE - DO NOT REPROCESS

In Quick Succession:

1. Disconnect from circuit



2. Remove old hub

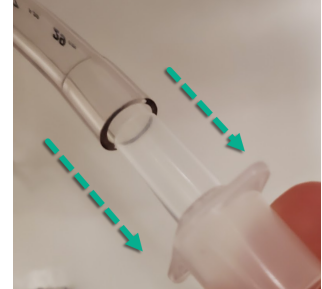

3. Insert Bridle

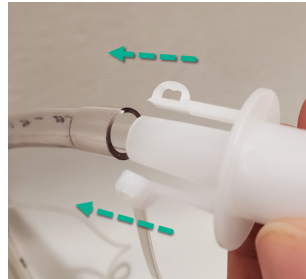

4. Reconnect Circuit



5. Place Cable tie as shown



6. Pull Cable tie tight



7. Cut excess cable tie



Manufactured For:

ETT Secure, LLC
P.O Box 160579 Clearfield, Utah 84016
productsupport@ettsecure.com
www.ettsecure.com