

CabinetCRUNCHER Cabinet Design & Cut List Software

Face Frame Settings *(section not applicable to frameless version)*

Face Frame Extension Above Cabinet Case

- **Cell N15** Enter the amount the face frame will extend above the cabinet case.

SET-UP VALUES		ASSEMBLY & FABRICATION NOTES
BUILT-IN BASE CABINET	2	Face frame extension above cabinet case
NO DADO L & R STILES		
NO DADO TOP/BOT RAILS		
NO FACE FRAME TENONS		
	1/4	Stile overlap (scribe) on left side panel
	1/4	Stile overlap (scribe) on right side panel
	1 1/2	Rail overlap under top panel
	1/4	Rail overlap on top of bottom panel

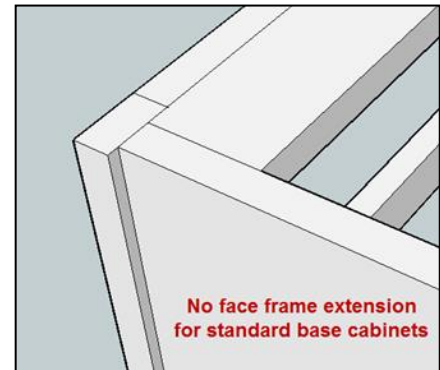
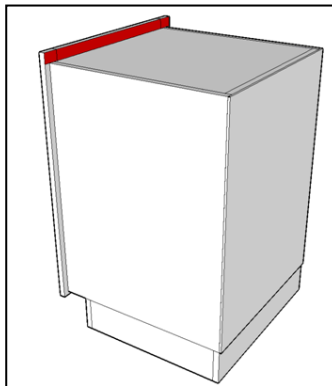
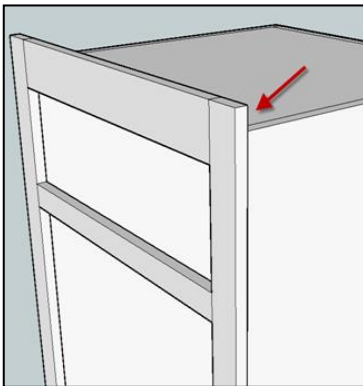

NOTE: This setting is only applicable to "BUILT-IN", "FREE-STANDING" and "WALL" cabinets. If you selected "BASE CABINET", this setting will not have any effect on the cutlist.

EXAMPLE: If you enter 2, the top of the face frame will extend 2 inches above the top of the cabinet case. The width of top rail in Cell E21 is calculated automatically based on your cutlist settings.

Dado Left and Right Stiles

- **Cell L16** This setting enables you to dado the left and right face frame stiles to accommodate the left and right-side panels.

IMPORTANT: This setting applies to the left and right stiles only. Separate settings on the cutlist will enable you to dado the face frame rails.

CabinetCRUNCHER Cabinet Design & Cut List Software

SET-UP VALUES		ASSEMBLY & FABRICATION NOTES
BUILT-IN BASE CABINET	2	Face frame extension above cabinet case
NO DADO L & R STILES		
NO DADO TOP/BOT RAILS		
NO FACE FRAME TENONS		
	1/4	Stile overlap (scribe) on left side panel
	1/4	Stile overlap (scribe) on right side panel
	1 1/2	Rail overlap under top panel
	1/4	Rail overlap on top of bottom panel

Select **DADO LEFT/RIGHT STILES** if a dado will be cut on the back surface of the left and right stiles to accommodate the left and right-side panels.

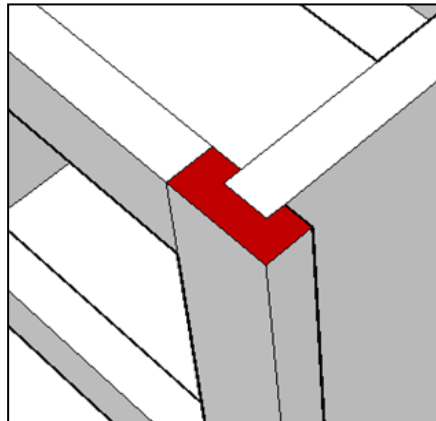
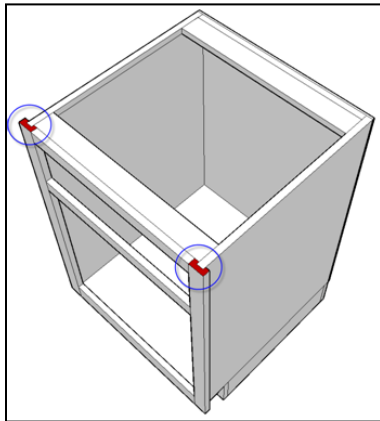

Select **NO DADO L & R STILES** if the front edge of the left and right-side panels will be butted directly to the back surface of the left and right stiles (no dado required).

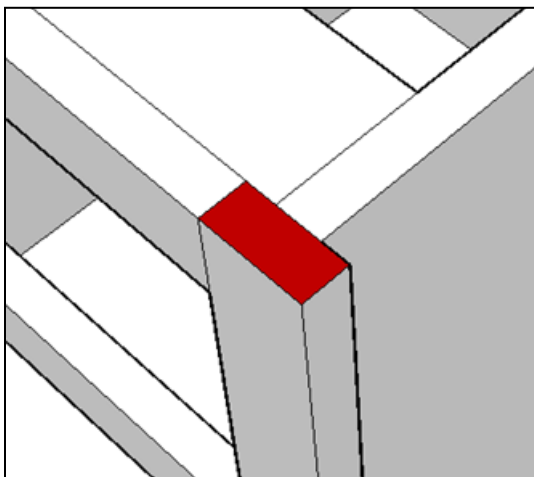

CabinetCRUNCHER Cabinet Design & Cut List Software

Depth of Dado in Left and Right Stiles

Cell N16 Enter the depth of dado that will be cut into the right and left face frame stiles to accept the side panels.

NOTE: If you selected **NO DADO L & R STILES** in the adjacent cell, this setting will not have any effect on the cutlist.

SET-UP VALUES		ASSEMBLY & FABRICATION NOTES
BUILT-IN BASE CABINET	2	Face frame extension above cabinet case
DADO LEFT/RIGHT STILES	1/4	Depth of dado in left & right stiles
NO DADO TOP/BOT RAILS		
NO FACE FRAME TENONS		
	1/4	Stile overlap (scribe) on left side panel
	1/4	Stile overlap (scribe) on right side panel
	1 1/2	Rail overlap under top panel
	1/4	Rail overlap on top of bottom panel

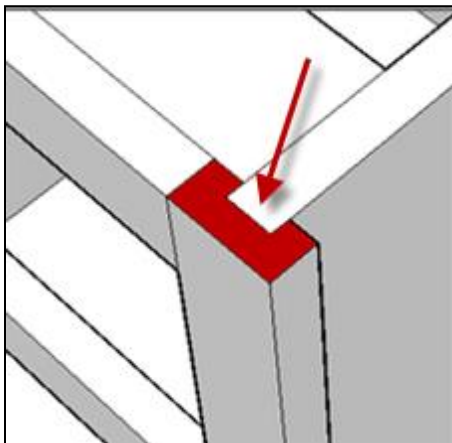

Dado Top and Bottom Rails

- **Cell L17** This setting enables you to dado the top and bottom face frame rails to accommodate the top and bottom panels.

SET-UP VALUES		ASSEMBLY & FABRICATION NOTES
BUILT-IN BASE CABINET	2	Face frame extension above cabinet case
DADO LEFT/RIGHT STILES	1/4	Depth of dado in left & right stiles
NO DADO TOP/BOT RAILS		
NO FACE FRAME TENONS		
	1/4	Stile overlap (scribe) on left side panel
	1/4	Stile overlap (scribe) on right side panel
	1 1/2	Rail overlap under top panel
	1/4	Rail overlap on top of bottom panel

Cabinet**CRUNCHER** Cabinet Design & Cut List Software

NOTE: If the cabinet does not have a top panel then this setting will apply to the bottom rail only.

Select **NO DADO TOP/BOT RAILS** if the front edge of the top panel (if applicable) and bottom panel will be butted directly to the back surface of the top and bottom rails.

Select **DADO TOP/BOT RAILS** if a dado will be cut into the back surface of the top and bottom rails to accommodate the top and bottom panels.

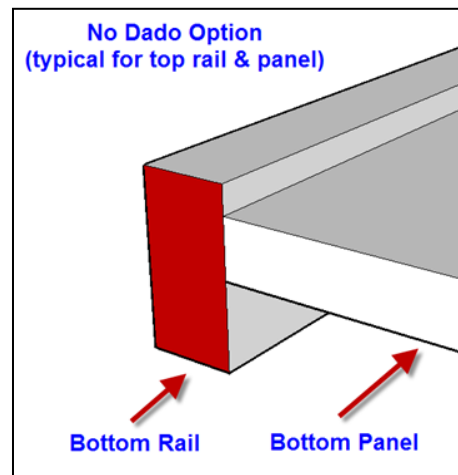
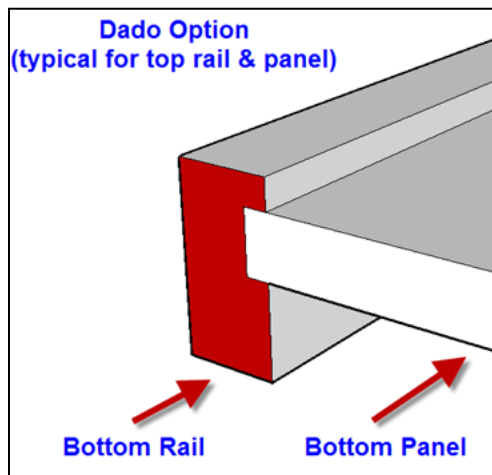

CabinetCRUNCHER Cabinet Design & Cut List Software

Depth of Dado in Top and Bottom Rails

Cell N17 Enter the depth of the dado that will be cut into the top and bottom face frame rails to accept the top and bottom panels.

NOTE: If this cabinet does not have a top panel then this setting will apply to the bottom rail only.

SET-UP VALUES		ASSEMBLY & FABRICATION NOTES
BUILT-IN BASE CABINET	2	Face frame extension above cabinet case
DADO LEFT/RIGHT STILES	1/4	Depth of dado in left & right stiles
DADO TOP/BOTTOM RAILS	1/4	Depth of dado in top and bottom rails
NO FACE FRAME TENONS		
	1/4	Stile overlap (scribe) on left side panel
	1/4	Stile overlap (scribe) on right side panel
	1 1/2	Rail overlap under top panel
	1/4	Rail overlap on top of bottom panel

Face Frame Tenons

- Cell L18** This setting enables you to add additional length to the face frame rails, and center stiles (if applicable to this cabinet configuration) to accommodate tenons or beaded face frame construction.

SET-UP VALUES		ASSEMBLY & FABRICATION NOTES
BUILT-IN BASE CABINET	2	Face frame extension above cabinet case
DADO LEFT/RIGHT STILES	1/4	Depth of dado in left & right stiles
DADO TOP/BOTTOM RAILS	1/4	Depth of dado in top and bottom rails
NO FACE FRAME TENONS		
	1/4	Stile overlap (scribe) on left side panel
	1/4	Stile overlap (scribe) on right side panel
	1 1/2	Rail overlap under top panel
	1/4	Rail overlap on top of bottom panel

Select **NO FACE FRAME TENONS** if the face frame does not require any tenons or additional length adjustment for beaded construction.

Select **FACE FRAME TENONS** if the face frame rails and center stiles (if applicable to the cabinet configuration) will require tenons or additional length for beaded construction.

NOTE: If you selected **NO FACE FRAME TENONS**, this setting will not have any effect on the cutlist.

CabinetCRUNCHER Cabinet Design & Cut List Software

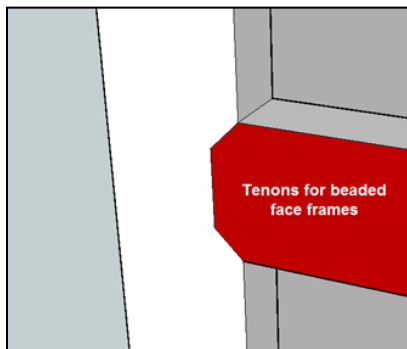
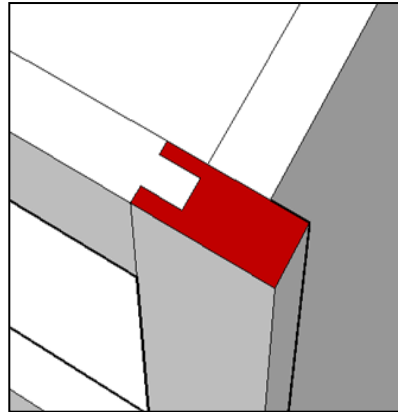
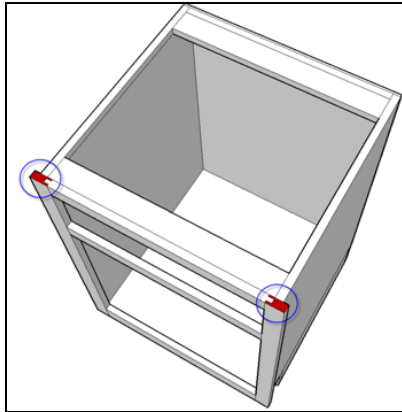

Length of Face Frame Tenons

- **Cell N18** Enter the length of the required tenon.

SET-UP VALUES		ASSEMBLY & FABRICATION NOTES
BUILT-IN BASE CABINET	2	Face frame extension above cabinet case
DADO LEFT/RIGHT STILES	1/4	Depth of dado in left & right stiles
DADO TOP/BOTTOM RAILS	1/4	Depth of dado in top and bottom rails
FACE FRAME TENONS	1/4	Length of rail tenon
	1/4	Stile overlap (scribe) on left side panel
	1/4	Stile overlap (scribe) on right side panel
	1 1/2	Rail overlap under top panel
	1/4	Rail overlap on top of bottom panel

CabinetCRUNCHER Cabinet Design & Cut List Software

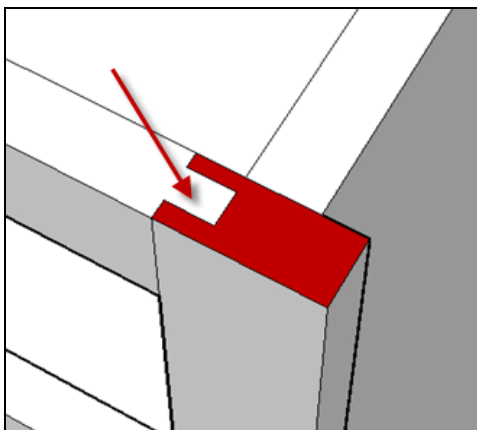

Left Stile Scribe

- **Cell N19** Enter how far the outer edge of the left face frame stile will extend over the outer surface of the left side panel.

SET-UP VALUES		ASSEMBLY & FABRICATION NOTES
BUILT-IN BASE CABINET	2	Face frame extension above cabinet case
DADO LEFT/RIGHT STILES	1/4	Depth of dado in left & right stiles
DADO TOP/BOTTOM RAILS	1/4	Depth of dado in top and bottom rails
FACE FRAME TENONS	1/4	Length of rail tenon
	1/4	Stile overlap (scribe) on left side panel
	1/4	Stile overlap (scribe) on right side panel
	1 1/2	Rail overlap under top panel
	1/4	Rail overlap on top of bottom panel

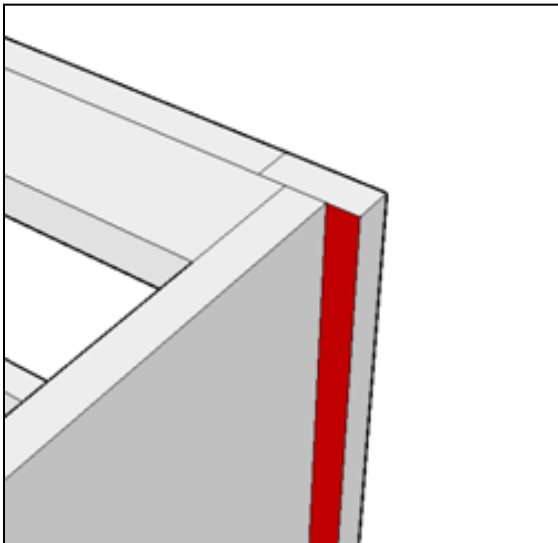
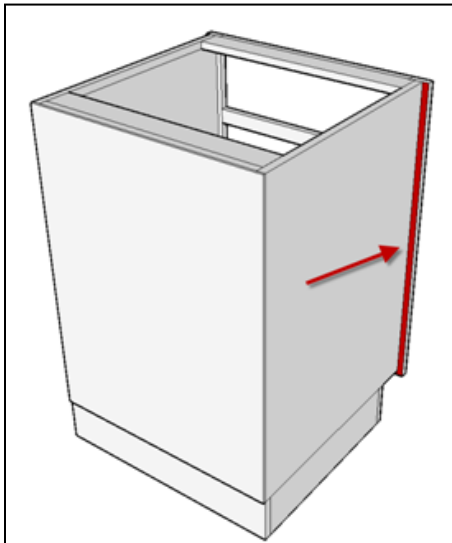

CabinetCRUNCHER Cabinet Design & Cut List Software

Right Stile Scribe

- **Cell N20** Enter how far the outer edge of the right face frame stile will extend over the outer surface of the right side panel.

SET-UP VALUES		ASSEMBLY & FABRICATION NOTES
BUILT-IN BASE CABINET	2	Face frame extension above cabinet case
DADO LEFT/RIGHT STILES	1/4	Depth of dado in left & right stiles
DADO TOP/BOTTOM RAILS	1/4	Depth of dado in top and bottom rails
FACE FRAME TENONS	1/4	Length of rail tenon
	1/4	Stile overlap (scribe) on left side panel
	1/4	Stile overlap (scribe) on right side panel
	1 1/2	Rail overlap under top panel
	1/4	Rail overlap on top of bottom panel

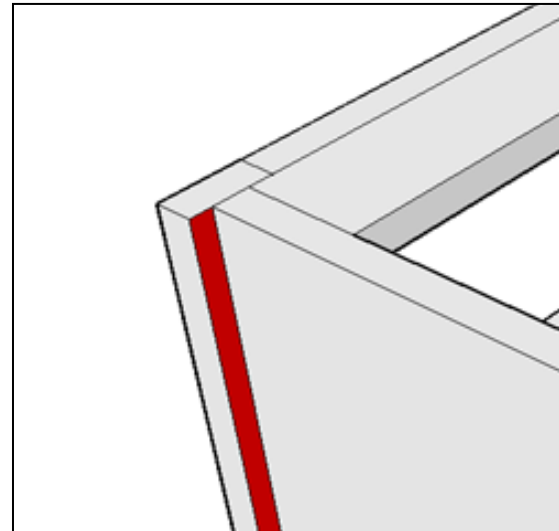
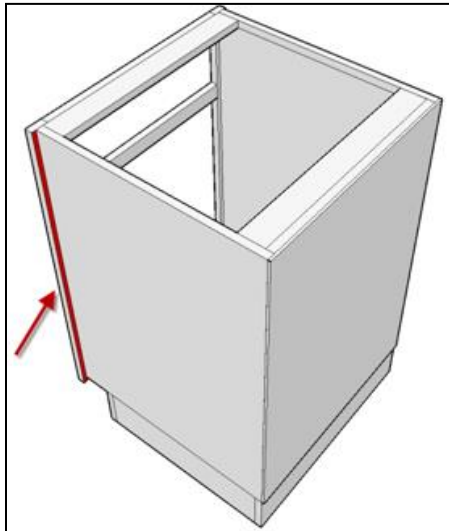

Top Rail

- **Cell N21** For BASE CABINETS, enter the desired width of the top rail.

SET-UP VALUES		ASSEMBLY & FABRICATION NOTES
BASE CABINET		
DADO LEFT/RIGHT STILES	1/4	Depth of dado in left & right stiles
DADO TOP/BOTTOM RAILS	1/4	Depth of dado in bottom rail
FACE FRAME TENONS	1/4	Length of rail tenon
	1/4	Stile overlap (scribe) on left side panel
	1/4	Stile overlap (scribe) on right side panel
	1 1/2	Width of top rail
	1/4	Rail overlap on top of bottom panel

CabinetCRUNCHER Cabinet Design & Cut List Software

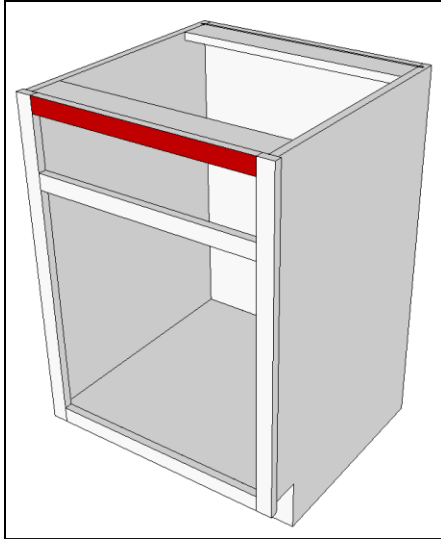

For "BUILT-IN", "FREE-STANDING" and "WALL CABINETS", enter how far the lower edge of the top rail will extend below the lower surface of the top panel. Enter 0 if you want the lower edge of the top rail to be flush with the lower surface of the top panel.

CAUTION: If this cell is ORANGE, check the width of the top rail in Cell E21. You may need to adjust the width of the top rail.

SET-UP VALUES		ASSEMBLY & FABRICATION NOTES
BUILT-IN BASE CABINET	2	Face frame extension above cabinet case
DADO LEFT/RIGHT STILES	1/4	Depth of dado in left & right stiles
DADO TOP/BOTTOM RAILS	1/4	Depth of dado in top and bottom rails
FACE FRAME TENONS	1/4	Length of rail tenon
	1/4	Stile overlap (scribe) on left side panel
	1/4	Stile overlap (scribe) on right side panel
	1 1/2	Rail overlap under top panel
	1/4	Rail overlap on top of bottom panel

CabinetCRUNCHER Cabinet Design & Cut List Software

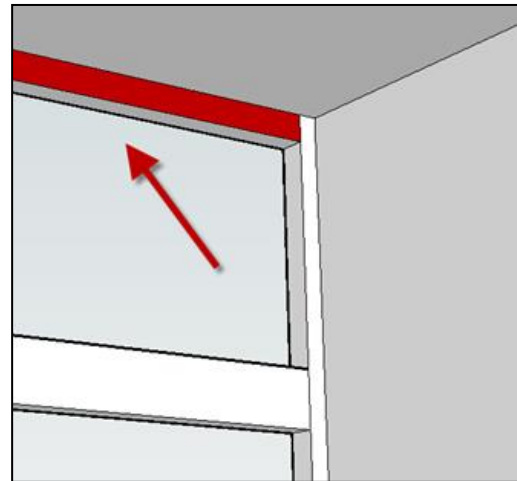
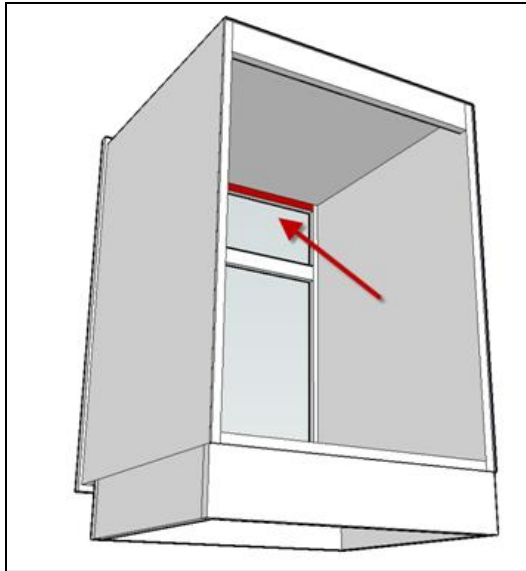

Bottom Rail

Cell N22 Enter how far the top edge of the bottom rail will extend above the upper surface of the bottom panel.

Enter 0 if you want the top edge of the bottom rail to be flush with the upper surface of the bottom panel.

SET-UP VALUES		ASSEMBLY & FABRICATION NOTES
BUILT-IN BASE CABINET	2	Face frame extension above cabinet case
DADO LEFT/RIGHT STILES	1/4	Depth of dado in left & right stiles
DADO TOP/BOTTOM RAILS	1/4	Depth of dado in top and bottom rails
FACE FRAME TENONS	1/4	Length of rail tenon
	1/4	Stile overlap (scribe) on left side panel
	1/4	Stile overlap (scribe) on right side panel
	1 1/2	Rail overlap under top panel
	1/4	Rail overlap on top of bottom panel

Cabinet *CRUNCHER* Cabinet Design & Cut List Software

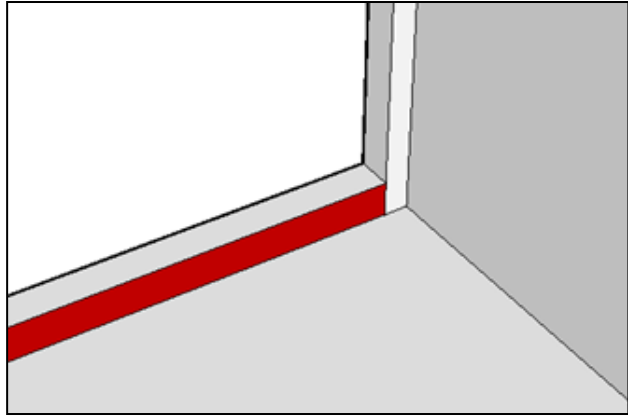
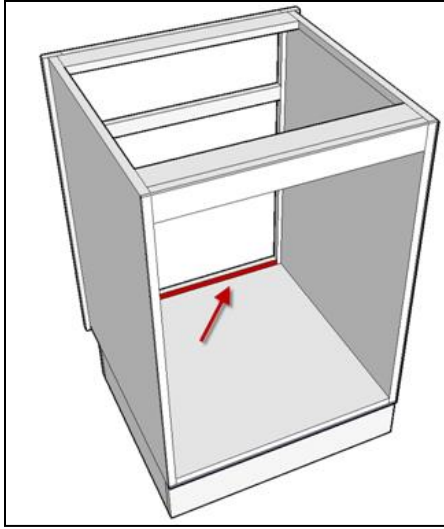

CabinetCRUNCHER Cabinet Design & Cut List Software

Panels

Adjusting the Length of Left and Right Side Panels

- **Cell L30 (Face Frame version only)** NOTE: This setting is applicable only if Cell L34 is set as "BUTTED TO SIDE PANELS", and if Cell L45 is not set to "NO BASE".

PANELS									
Left Side Panel	23 1/2	28	1	3/4	Birch Ply	FLUSH BOTTOM PANEL			
Right Side Panel	23 1/2	28	1	3/4	Birch Ply				
Top Panel	22 1/2	27 1/2	1	3/4	Birch ply	BUTTED TO SIDE PANELS	0		
							1/2		Distance from top of side panels to top panel
Bottom Panel	23 1/2	27 1/2	1	3/4	Birch Ply	BUTTED TO SIDE PANELS			
Back Panel	27 15/16	27 1/2	1	1/4	Birch Ply	DADO SIDE PANELS	1/4		Depth of dado in sides & bottom panel for back panel
						DADO BOTTOM ONLY	3/4		Location of dado from back edge of panels
							1/16		Clearance space within dados for back panel

Select **FULL LENGTH** if you want the bottom edge of the side panels to be flush with the bottom edge of the face frame stiles.

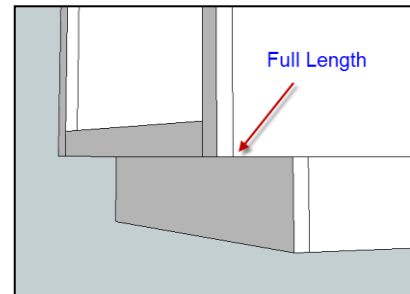
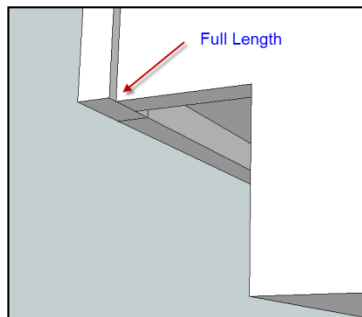
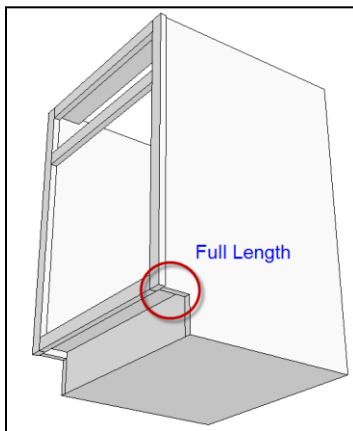

Select **FLUSH BOTTOM PANEL** if you want the bottom edge of the side panels to be flush with the lower surface of the bottom panel.

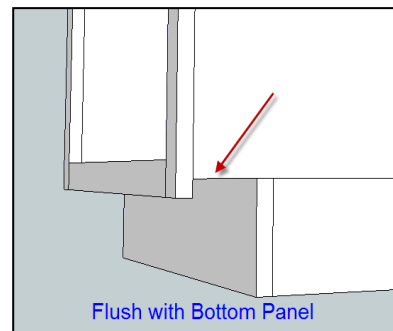
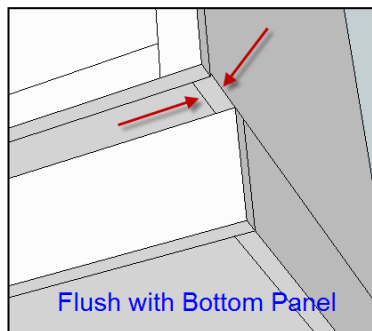
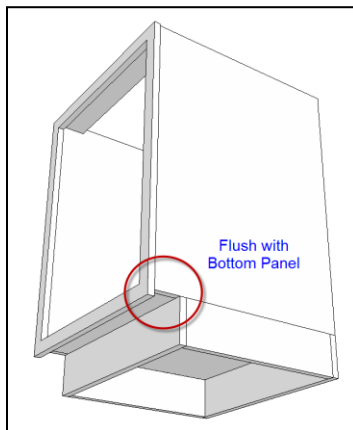

CabinetCRUNCHER Cabinet Design & Cut List Software

Independently Rabbet the Left or Right Side Panels

- **Cell N30 (Cell N20 Frameless)** If this cell is ORANGE, this is a caution advisory for you to verify your setting. If your setting is correct, disregard this caution advisory.

PANELS									
Left Side Panel	23 1/4	28		1	3/4	Birch Ply	FLUSH BOTTOM PANEL	NO	Do not rabbet left side panel
Right Side Panel	23 1/4	28		1	3/4	Birch Ply		NO	Do not rabbet right side panel
Top Panel	22 3/4	27 1/2		1	3/4	Birch ply	BUTTED TO SIDE PANELS	0	
								1/2	Distance from top of side panels to top panel
Bottom Panel	23 1/2	27 1/2		1	3/4	Birch Ply	BUTTED TO SIDE PANELS		
Back Panel	29 1/16	27 1/2		1	1/4	Birch Ply	RABBET SIDE PANELS	1/4	Depth of rabbet in sides & bottom panel for back panel
							RABBET BOTTOM ONLY	3/4	Width of rabbet along back edge of panels
								1/16	Lateral clearance within rabbet for back panel

This setting enables you to independently rabbet the left side panel or leave it un-rabbetted.

This setting only applies if you selected **RABBET SIDE PANEL** for the back panel in Cell L35 (L26 for Frameless).

Enter YES if the left side panel will be rabbetted. In this case the back panel will fit into the rabbet on the left side panel.

Enter NO if the left side panel will not be rabbetted. In this case, the back panel will be flush with the outer surface of the left side panel.

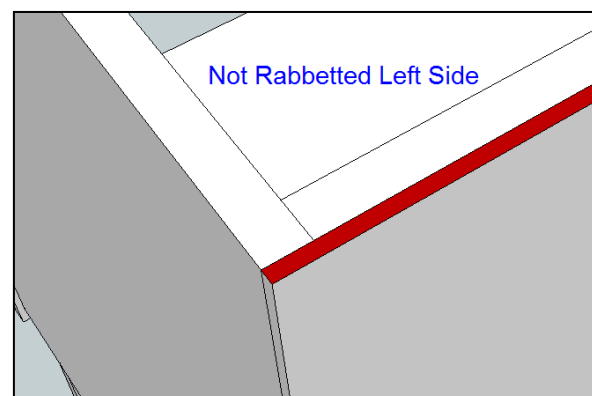
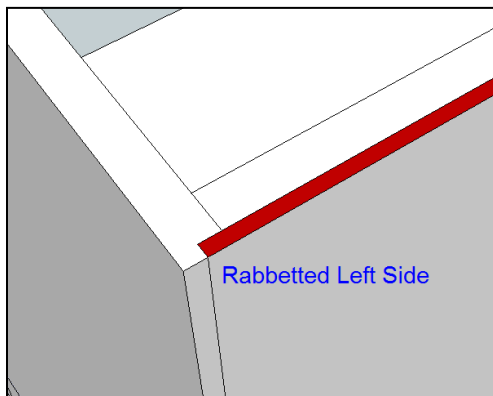
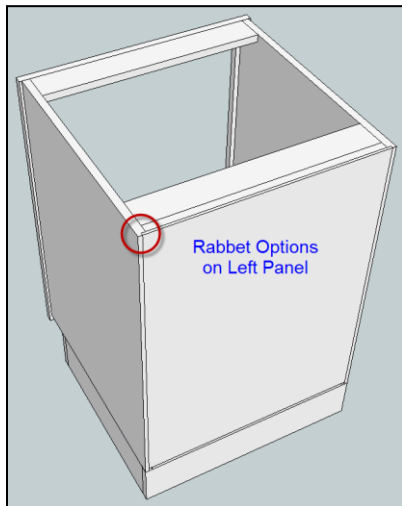

Cabinet**CRUNCHER** Cabinet Design & Cut List Software

- **Cell N31 (Cell N21 Frameless)** If this cell is ORANGE, this is a caution advisory for you to verify your setting. If your setting is correct, disregard this caution advisory.

PANELS									
Left Side Panel	23 1/4	28		1	3/4	Birch Ply	FLUSH BOTTOM PANEL	NO	Do not rabbet left side panel
Right Side Panel	23 1/4	28		1	3/4	Birch Ply		NO	Do not rabbet right side panel
Top Panel	22 3/4	27 1/2		1	3/4	Birch ply	BUTTED TO SIDE PANELS	0	
								1/2	Distance from top of side panels to top panel
Bottom Panel	23 1/2	27 1/2		1	3/4	Birch Ply	BUTTED TO SIDE PANELS		
Back Panel	29 1/16	27 1/2		1	1/4	Birch Ply	RABBET SIDE PANELS	1/4	Depth of rabbet in sides & bottom panel for back panel
							RABBET BOTTOM ONLY	3/4	Width of rabbet along back edge of panels
								1/16	Lateral clearance within rabbet for back panel

This setting enables you to independently rabbet the right side panel or leave it un-rabbetted.

This setting only applies if you selected **RABBET SIDE PANEL** for the back panel in Cell L35 (L26 for Frameless).

Enter YES if the right side panel will be rabbetted. In this case the back panel will fit into the rabbet on the right side panel.

Enter NO if the right side panel will not be rabbetted. In this case, the back panel will be flush with the outer surface of the right side panel.

Top Panel

- **Cell C32 (Cell C22 Frameless)** This is a top panel that is applicable only to "built-in", "free-standing" or "wall" cabinets.

PANELS				
BC30-5	Left Side Panel	23 1/2	28	
BC30-6	Right Side Panel	23 1/2	28	
BC30-7	Top Panel	23 1/2	27 1/2	
BC30-8	Bottom Panel	23 1/2	27 1/2	
BC30-9	Back Panel	27 15/16	26 7/16	

- **Cell L32 (Cell L22 Frameless)** This setting only applies to cabinets with a top panel (EXAMPLE: BUILT-IN BASE CABINETS, FREE-STANDING BASE CABINETS, and WALL CABINETS).

CabinetCRUNCHER Cabinet Design & Cut List Software

PANELS									
Left Side Panel	23 1/2	28		1	3/4	Birch Ply	FLUSH BOTTOM PANEL		
Right Side Panel	23 1/2	28		1	3/4	Birch Ply			
Top Panel	23 1/2	27 1/2		1	3/4	Birch ply	BUTTED TO SIDE PANELS	0	
								1/2	Distance from top of side panels to top panel
Bottom Panel	23 1/2	27 1/2		1	3/4	Birch Ply	BUTTED TO SIDE PANELS		
Back Panel	27 15/16	26 7/16		1	1/4	Birch Ply	DADO SIDE PANELS	1/4	Depth of dado along sides, top & bottom for back panel
							DADO TOP & BOTTOM	3/4	Location of dado from back edge of panels
								1/16	Clearance space within dados for back panel

- **Cell L32 (Cell L22 Frameless)** Select **BUTTED TO SIDE PANELS** if you want the top panel to be butted up against the side panels. Refer to "Set-Up Values" to specify how far the upper surface of the top panel is located from the upper edge of the side panels.

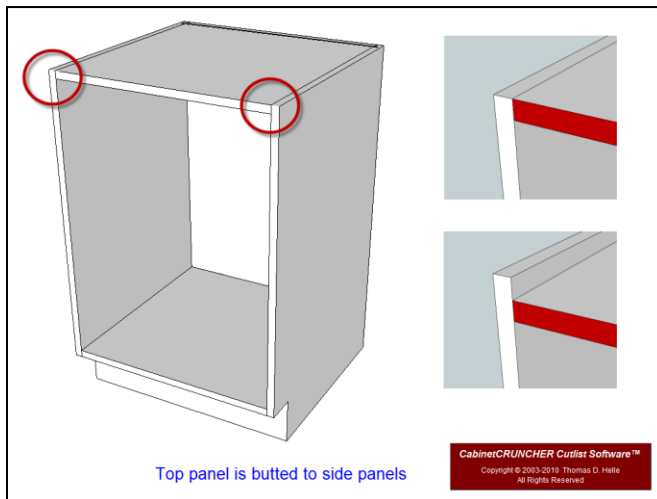

- **Cell L32 (Cell L22 Frameless)** Select **DADO SIDE PANELS** if you want the top panel to fit into dados that are cut into the side panels. Use the "Set-Up Values" to specify the dado depth and to specify how far the dado will be located from the top edge of the side panels.

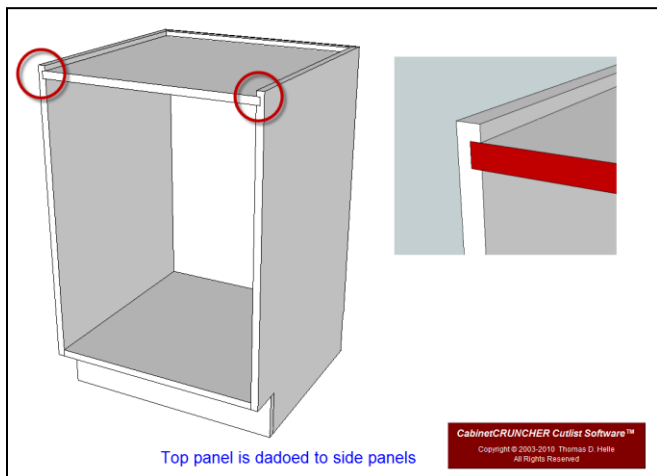

CabinetCRUNCHER Cabinet Design & Cut List Software

- **Cell L32 (Cell L22 Frameless)** Select **RABBET SIDE PANELS** if you want the top panel to fit into a rabbet that is cut along the top edge of the side panels. Use the "Set-Up Values" to specify the rabbet depth.

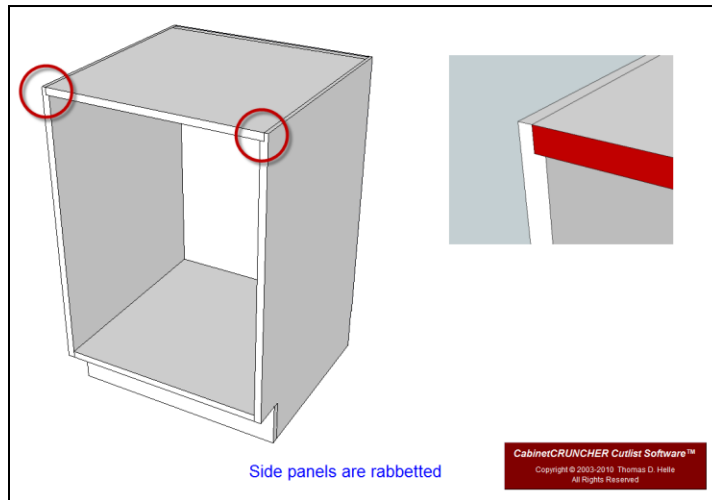

- **Cell L32 (Cell L22 Frameless)** Select **RABBET TOP PANEL** if you want the side panels to fit into a rabbet that is cut along the outboard edges of the top panel. Use the "Set-Up Values" to specify the rabbet depth.

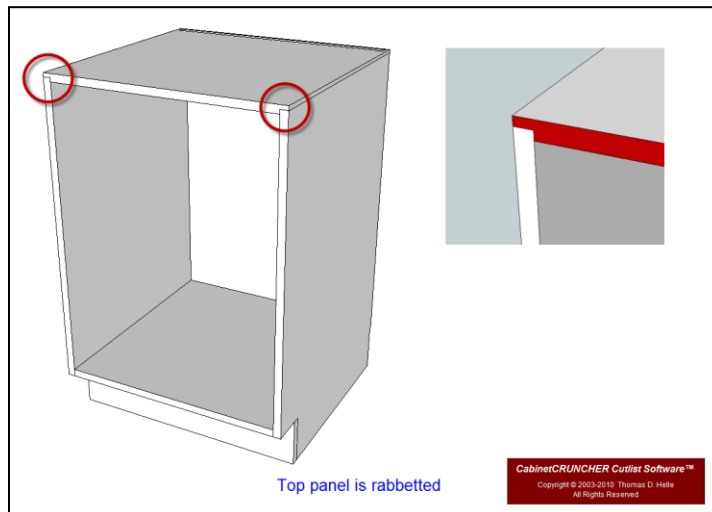

- **Cell L32 (Cell L22 Frameless)** Select **OVERLAP SIDE PANELS** if you want the top panel to extend over the top of the side panels. Use the "Set-Up Values" to specify how far the top panel will extend over the outer surface of the side panels.

CabinetCRUNCHER Cabinet Design & Cut List Software

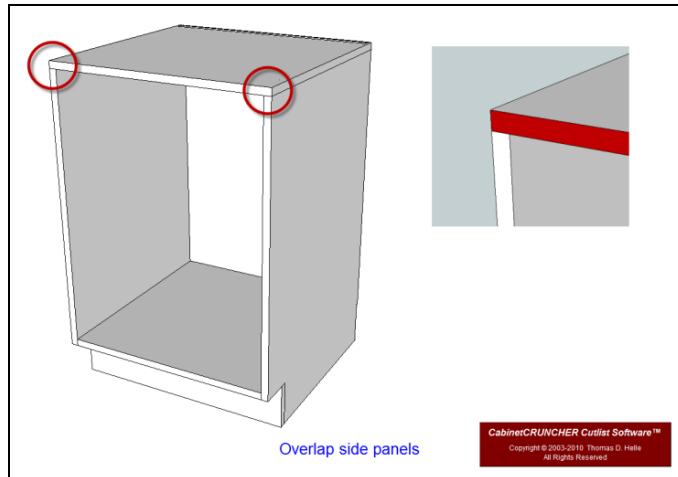

- **Cell L32 (Cell L22 Frameless)** Select **MITER TO SIDE PANELS** if you want the outer edges of the top panel and the upper edges of the side panels mitered 45 degrees.

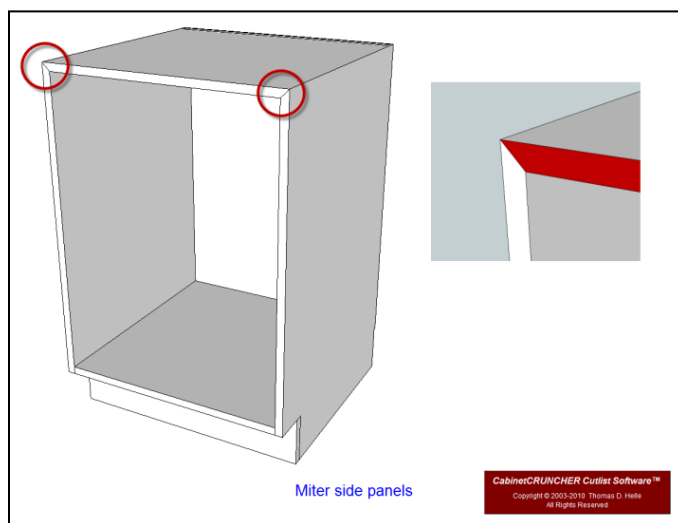

- **Cell N32 (Cell N22 Frameless)** For top panels that fit into dados in the side panels, enter the depth of the dado that will be cut into the side panels.

PANELS									
Left Side Panel	23 1/2	28	1	3/4	Birch Ply	FLUSH BOTTOM PANEL			
Right Side Panel	23 1/2	28	1	3/4	Birch Ply				
Top Panel	23 1/2	28	1	3/4	Birch ply	DADO SIDE PANELS	1/4	1/2	Depth of dado in side panels for top panel
									Location of dado from top edge of side panels
Bottom Panel	23 1/2	27 1/2	1	3/4	Birch Ply	BUTTED TO SIDE PANELS			
Back Panel	27 15/16	26 7/16	1	1/4	Birch Ply	DADO SIDE PANELS	1/4		Depth of dado along sides, top & bottom for back panel
						DADO TOP & BOTTOM	3/4		Location of dado from back edge of panels
							1/16		Clearance space within dados for back panel

For top panels that fit into rabbets in the side panels, enter the depth of the rabbet that will be cut into the side panels.

Cabinet**CRUNCHER** Cabinet Design & Cut List Software

For top panels that **OVERLAP SIDE PANELS**, enter the amount the top panel will extend over the outer surface of the side panel. Enter 0 if the right and left edges of the top panel will be flush with the outer surface of the side panels.

CAUTION: if this cell is orange, verify this setting. If the value is greater than 0, the length of the top panel will extend past the outer surface of the side panels.

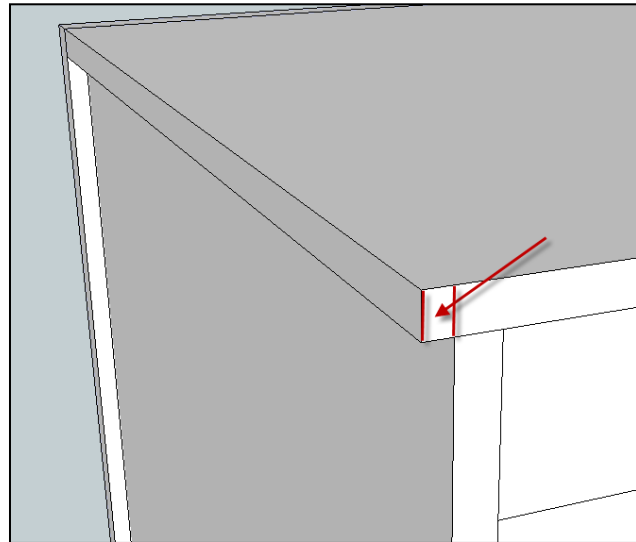
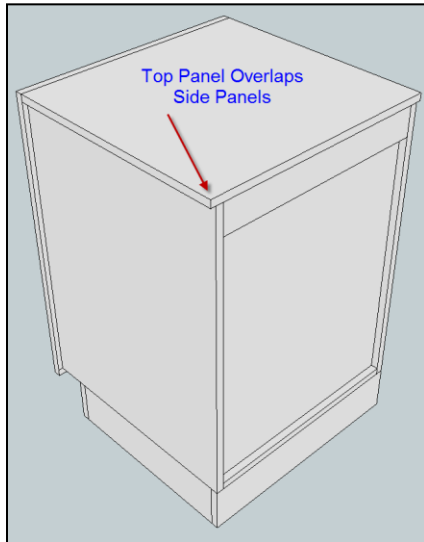

- **Cell N33 (Cell N23 Frameless)** Specify how far the upper surface of the top panel is located from to the top edge of the side panels.

EXAMPLE: Enter .5 if the upper surface of the top panel is located .5 inches from the upper edge of the side panels.

PANELS									
Left Side Panel	23 1/2	28		1	3/4	Birch Ply	FLUSH BOTTOM PANEL		
Right Side Panel	23 1/2	28		1	3/4	Birch Ply			
Top Panel	23 1/2	28		1	3/4	Birch ply	DADO SIDE PANELS	1/4	Depth of dado in side panels for top panel
								1/2	Location of dado from top edge of side panels
Bottom Panel	23 1/2	27 1/2		1	3/4	Birch Ply	BUTTED TO SIDE PANELS		
Back Panel	27 15/16	26 7/16		1	1/4	Birch Ply	DADO SIDE PANELS	1/4	Depth of dado along sides, top & bottom for back panel
							DADO TOP & BOTTOM	3/4	Location of dado from back edge of panels
								1/16	Clearance space within dados for back panel

Enter 0 if you want the upper surface of the top panel to be flush with the upper edge of the side panels.

IMPORTANT: If this cell is RED, this setting must be greater than 0. Reason: Cell L32 (Cell L22 Frameless) is set as "**DADO SIDE PANELS**". If you dado the side panels, the location of the dado from the top edge of the side panels in Cell N33 (Cell N23 Frameless) must be greater than 0.

Cabinet**CRUNCHER** Cabinet Design & Cut List Software

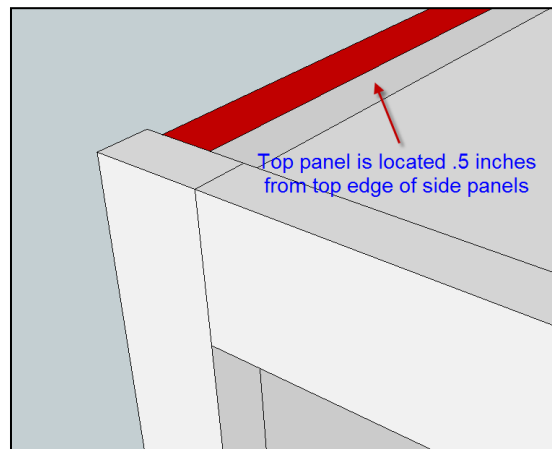
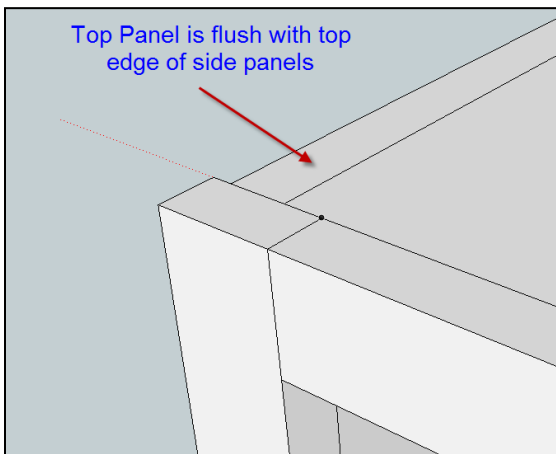
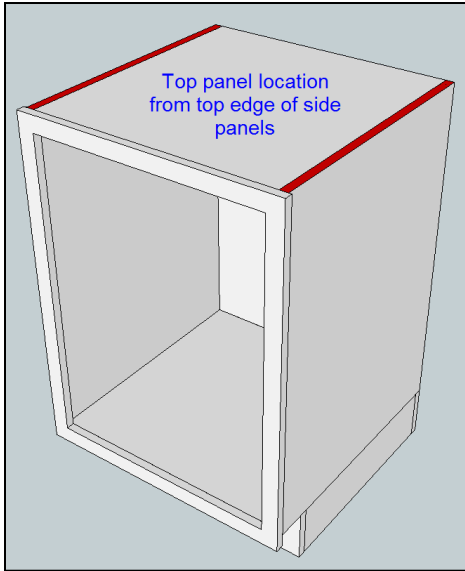

CabinetCRUNCHER Cabinet Design & Cut List Software

Bottom Panel

- **Cell L34 (Cell L24 Frameless)** Select **BUTTED TO SIDE PANELS** if you want the bottom panel to be butted up against the side panels. Refer to "Set-Up Values" to specify the location of the bottom panel from the bottom edge of the side panels.

PANELS									
Left Side Panel	23 1/2	28		1	3/4	Birch Ply	FLUSH BOTTOM PANEL		
Right Side Panel	23 1/2	28		1	3/4	Birch Ply			
Top Panel	23 1/2	28		1	3/4	Birch ply	DADO SIDE PANELS	1/4	Depth of dado in side panels for top panel
								1/2	Location of dado from top edge of side panels
Bottom Panel	23 1/2	27 1/2		1	3/4	Birch Ply	BUTTED TO SIDE PANELS		
Back Panel	27 15/16	26 7/16		1	1/4	Birch Ply	DADO SIDE PANELS	1/4	Depth of dado along sides, top & bottom for back panel
							DADO TOP & BOTTOM	3/4	Location of dado from back edge of panels
								1/16	Clearance space within dados for back panel

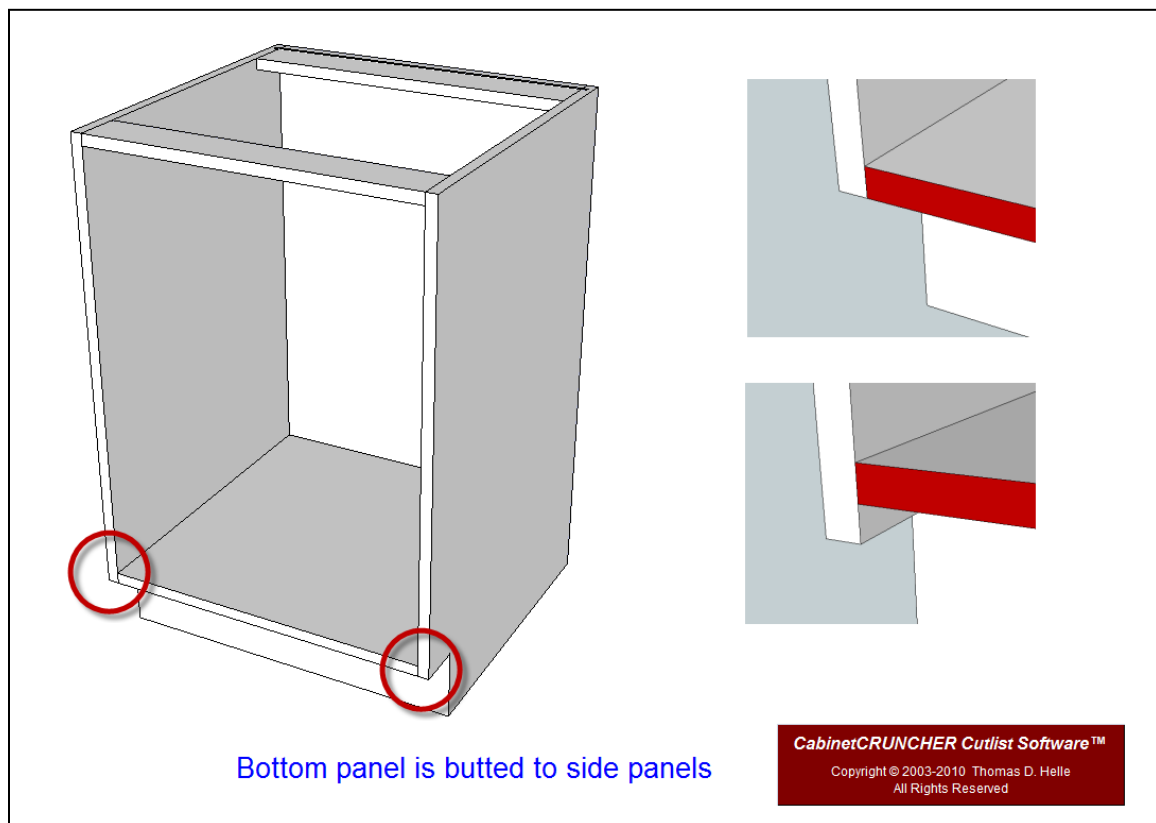

CabinetCRUNCHER Cabinet Design & Cut List Software

- **Cell L34 (Cell L24 Frameless)** Select **DADO SIDE PANELS** if you want the bottom panel to fit into dado's that are cut into the side panels. Use the "Set-Up Values" to specify the dado depth.

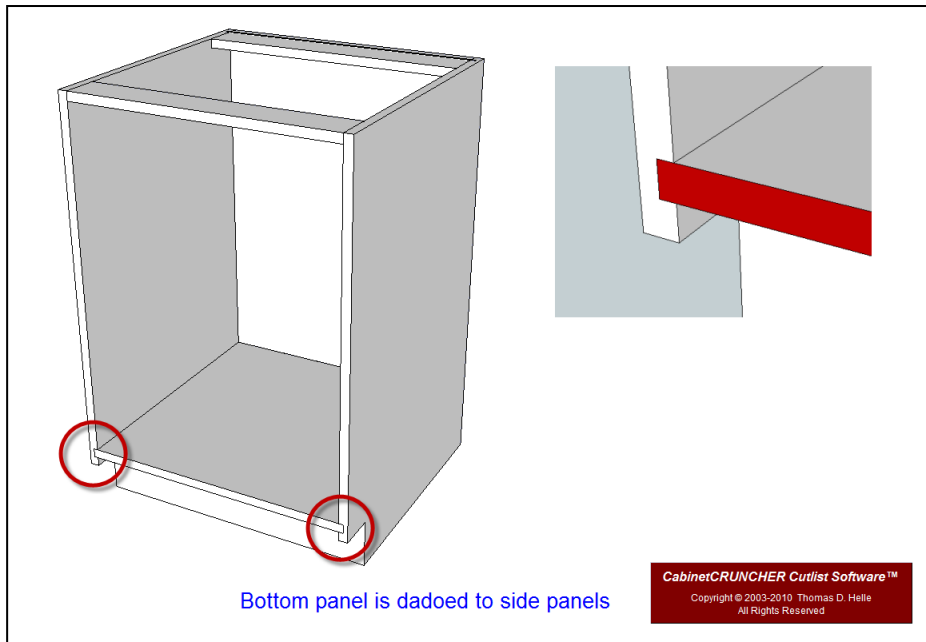

- **Cell L34 (Cell L24 Frameless)** Select **RABBET SIDE PANELS** if you want the bottom panel to fit into a rabbet that is cut along the bottom edge of the side panels. Use the "Set-Up Values" to specify the rabbet width

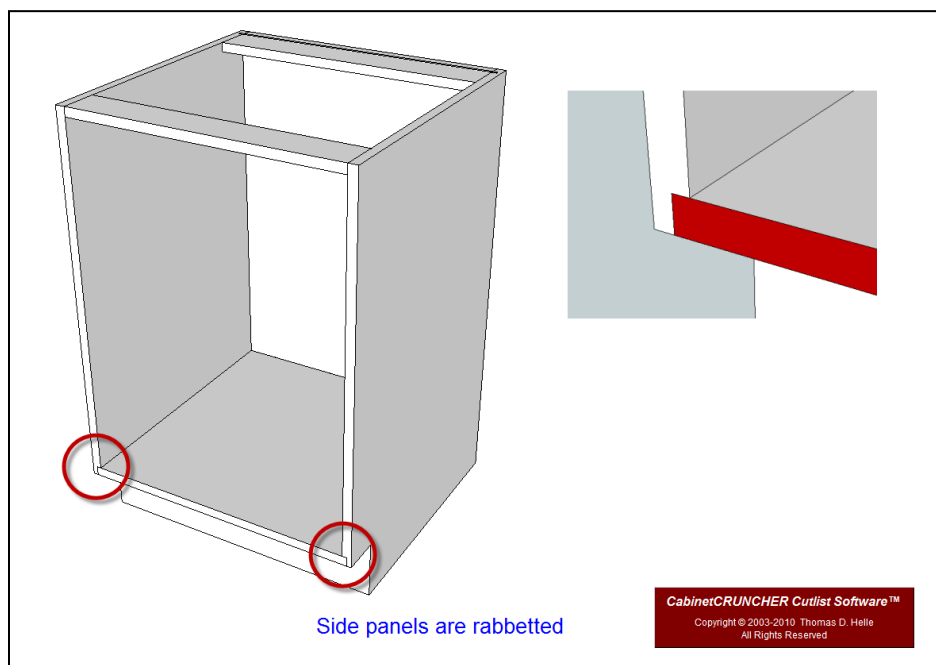

CabinetCRUNCHER Cabinet Design & Cut List Software

- **Cell L34 (Cell L24 Frameless)** Select **RABBIT BOTTOM PANEL** if you want the side panels to fit into a rabbet that is cut along the outboard edges of the bottom panel. Use the "Set-Up Values" to specify the rabbet width.

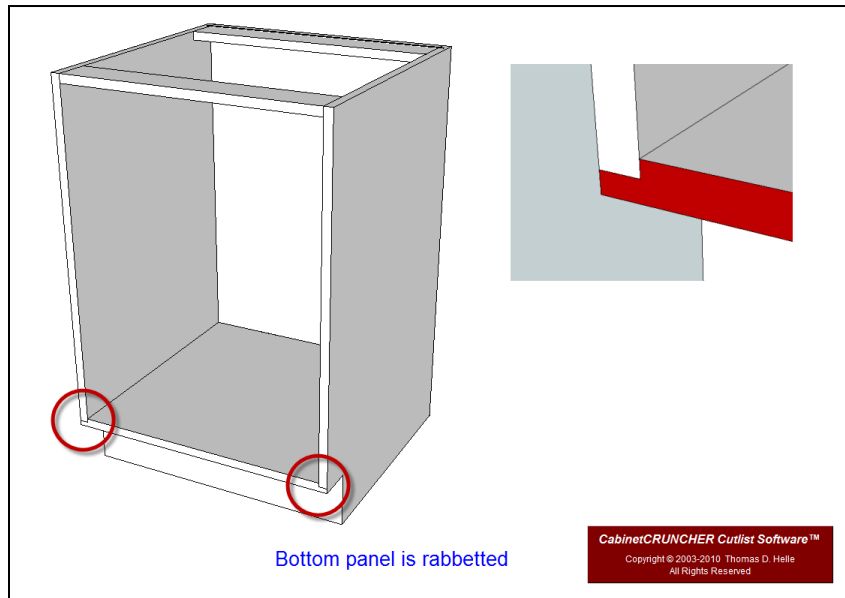

- **Cell L34 (Cell L24 Frameless)** Select **UNDER SIDE PANELS** if you want the bottom panel to overlap the side panels. The bottom panel will fit below the side panels (the length of the bottom panel will be flush with the outer surfaces of the side panels). **NOTE:** For most base cabinets, this setting is not typically used in the industry. If you use this setting, use it in conjunction with the "NO BASE" base setting and set the "Height of Kickspace Under Face Frame" to 0.

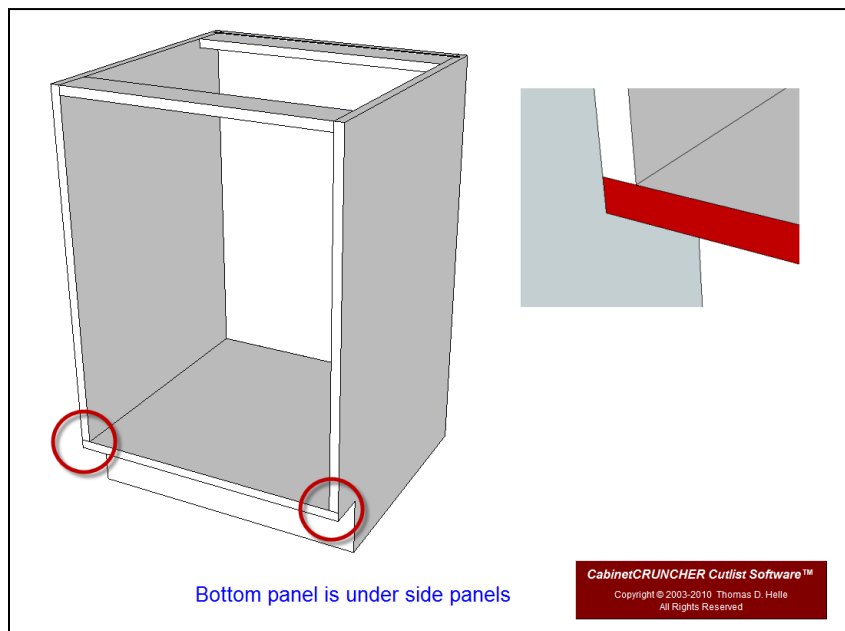

Cabinet**CRUNCHER** Cabinet Design & Cut List Software

- **Cell L34 (Cell L24 Frameless)** Select **MITER TO SIDE PANELS** if you want the outboard edges of the bottom panel and the lower edges of the side panels mitered 45 degrees.

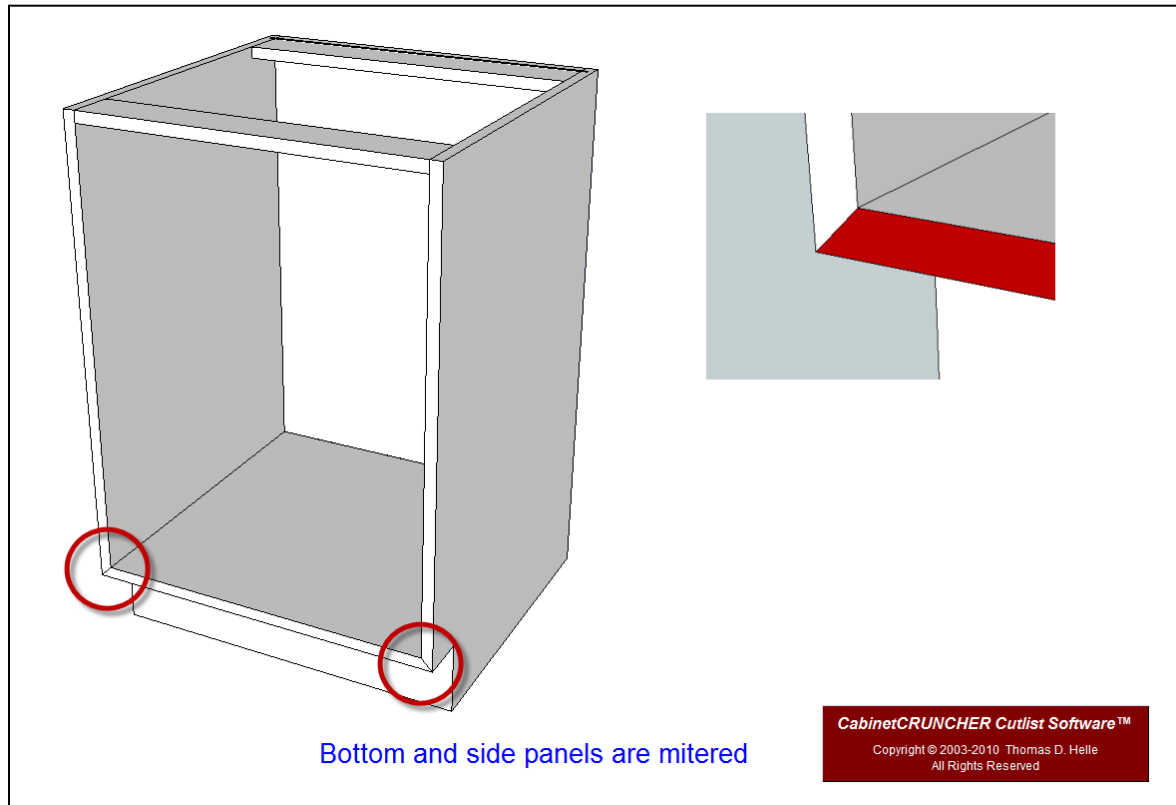

- **Cell N34 (Cell N24 Frameless)** For bottom panels that fit into dados in the side panels, enter the depth of the dado that will be cut into the side panels.

PANELS									
Left Side Panel	23	1/2	28	1	3/4	Birch Ply	FLUSH BOTTOM PANEL		
Right Side Panel	23	1/2	28	1	3/4	Birch Ply			
Top Panel	23	1/2	28	1	3/4	Birch ply	DADO SIDE PANELS	1/4	Depth of dado in side panels for top panel
								1/2	Location of dado from top edge of side panels
Bottom Panel	23	1/2	27 1/2	1	3/4	Birch Ply	BUTTED TO SIDE PANELS		
Back Panel	27 15/16	26	7/16	1	1/4	Birch Ply	DADO SIDE PANELS	1/4	Depth of dado along sides, top & bottom for back panel
							DADO TOP & BOTTOM	3/4	Location of dado from back edge of panels
								1/16	Clearance space within dados for back panel

Cabinet**CRUNCHER** Cabinet Design & Cut List Software

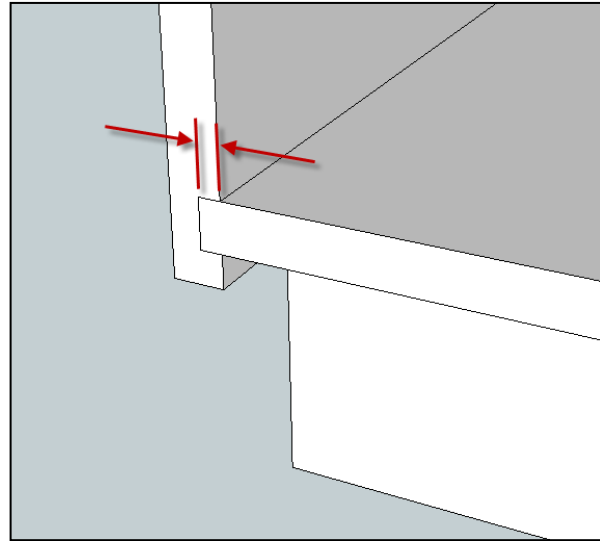
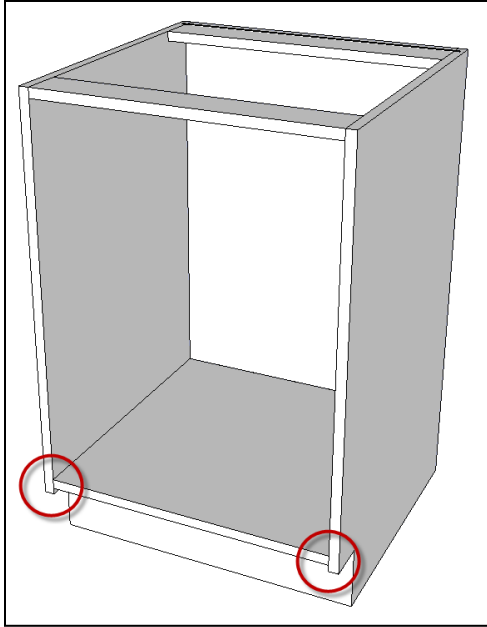

For bottom panels that fit into rabbets in the side panels, enter the depth of the rabbet that will be cut into the side panels.

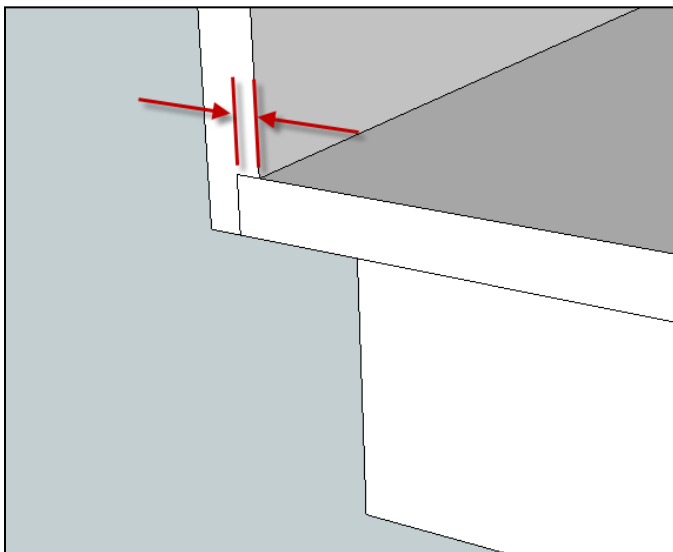

CabinetCRUNCHER Cabinet Design & Cut List Software

Back Panel

- **Cell L35 (Cell L26 Frameless)** Select **BUTTED TO SIDE PANELS** if you want the back panel to be attached directly to the back of the side panels. The width of the back panel will be flush with the outer edge of the side panels.

PANELS									
Left Side Panel	23 1/2	28		1	3/4	Birch Ply	FLUSH BOTTOM PANEL		
Right Side Panel	23 1/2	28		1	3/4	Birch Ply			
Top Panel	23 1/2	28		1	3/4	Birch ply	DADO SIDE PANELS	1/4	Depth of dado in side panels for top panel
								1/2	Location of dado from top edge of side panels
Bottom Panel	23 1/2	27 1/2		1	3/4	Birch Ply	BUTTED TO SIDE PANELS		
Back Panel	27 15/16	26 7/16		1	1/4	Birch Ply	DADO SIDE PANELS	1/4	Depth of dado along sides, top & bottom for back panel
							DADO TOP & BOTTOM	3/4	Location of dado from back edge of panels
								1/16	Clearance space within dados for back panel

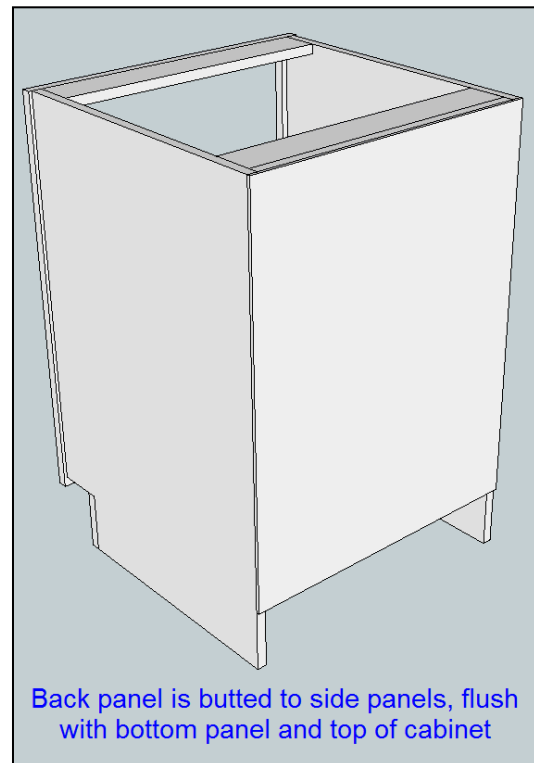
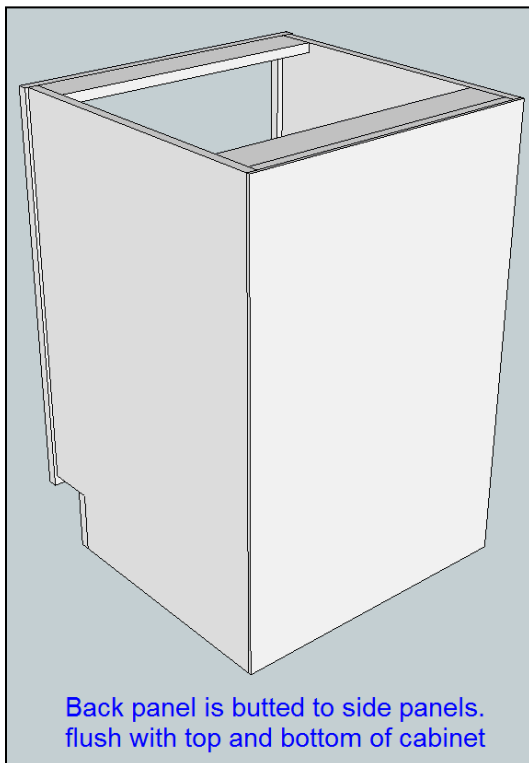

Cabinet**CRUNCHER** Cabinet Design & Cut List Software

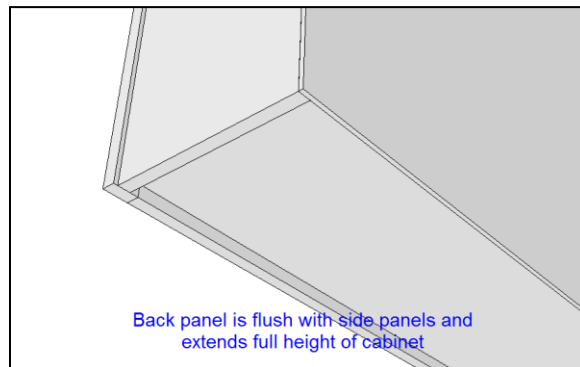
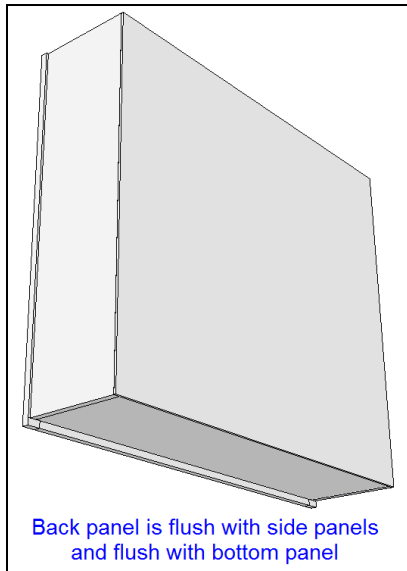

- **Cell L35 (Cell L26 Frameless)** Select **DADO SIDE PANELS** if you want the back panel to fit inside dados that are cut into the side panels. Use the "Set-Up Values" to specify the depth of the dado and the location of the dado from the back edge of the side panels.

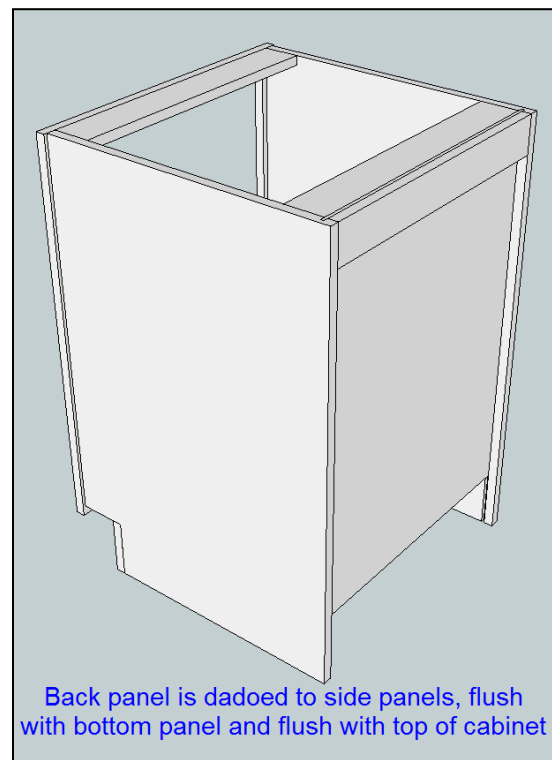
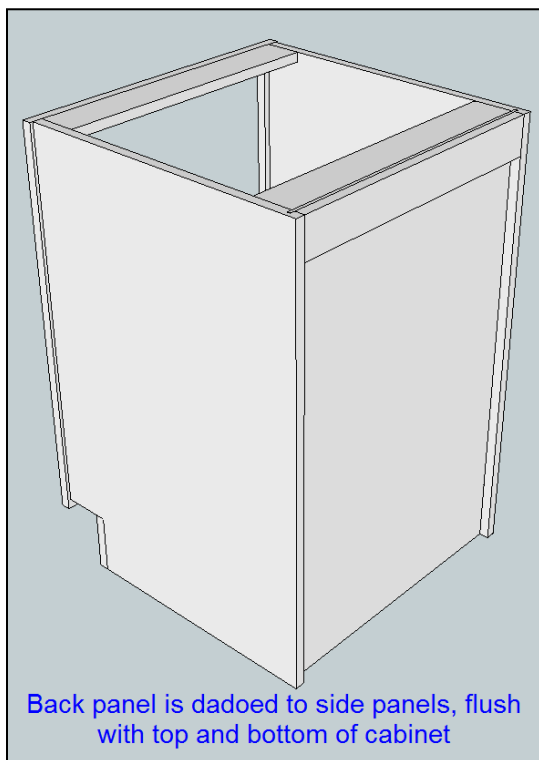

Cabinet *CRUNCHER* Cabinet Design & Cut List Software

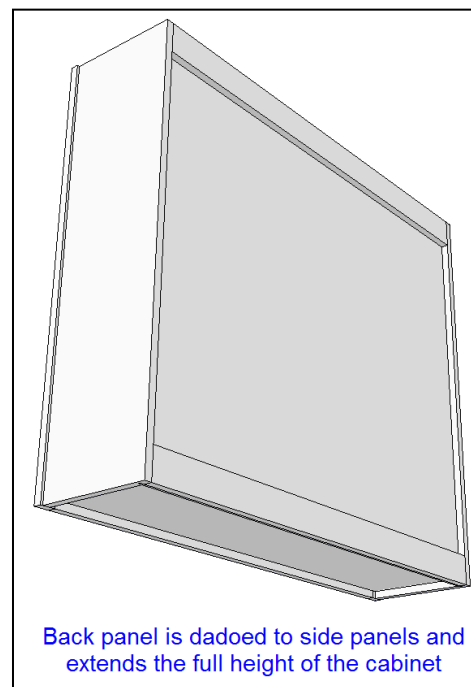
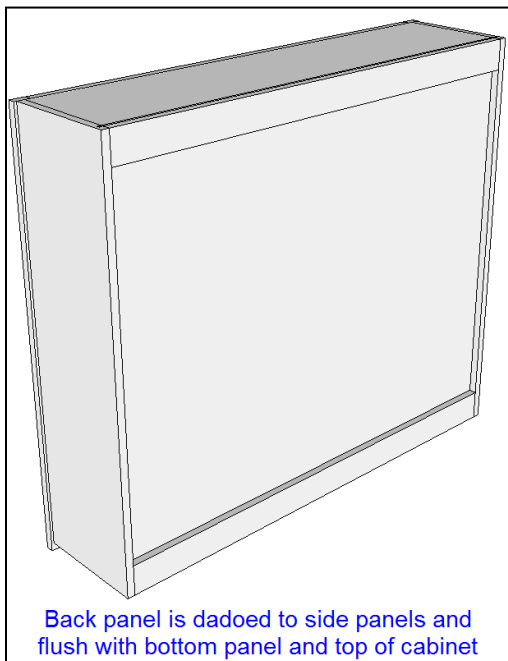
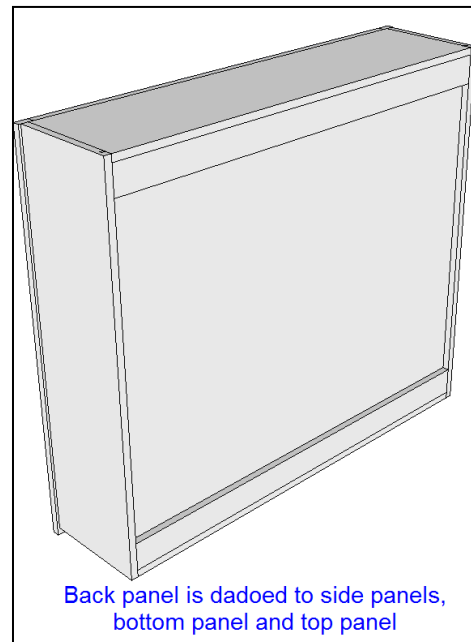
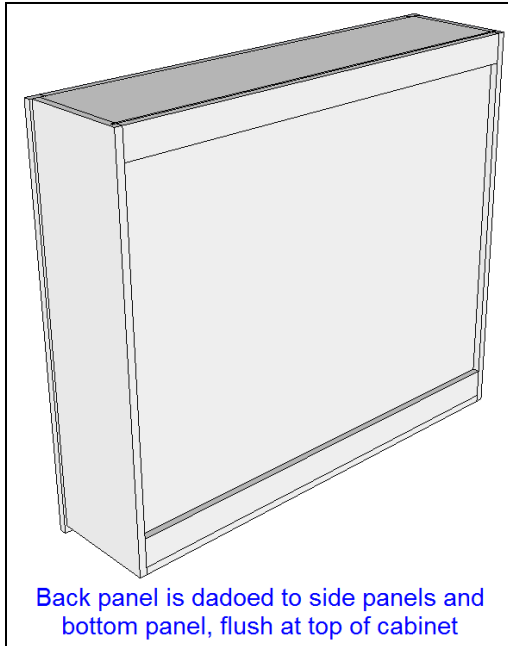

- **Cell L35 (Cell L26 Frameless)** Select **RABBIT SIDE PANELS** if you want the back panel to fit inside rabbets that are cut along the back edge of the side panels. Use the "Set-Up Values" to specify the depth of the rabbet in the side panels.

Cabinet**CRUNCHER** Cabinet Design & Cut List Software

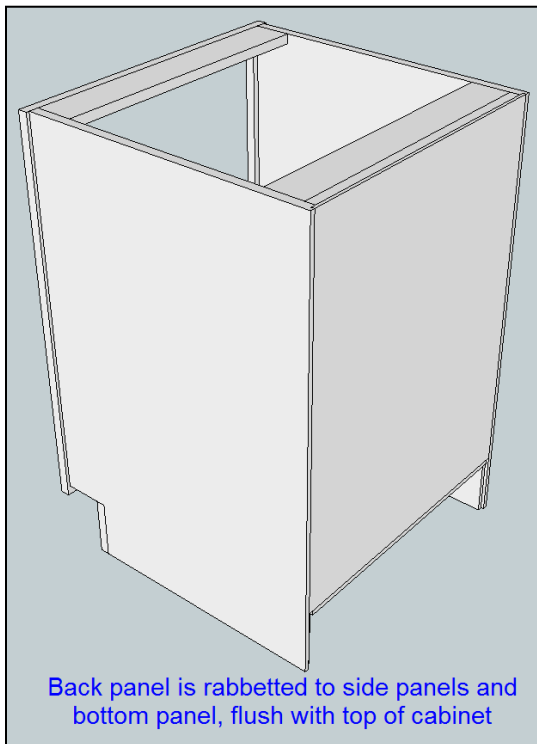
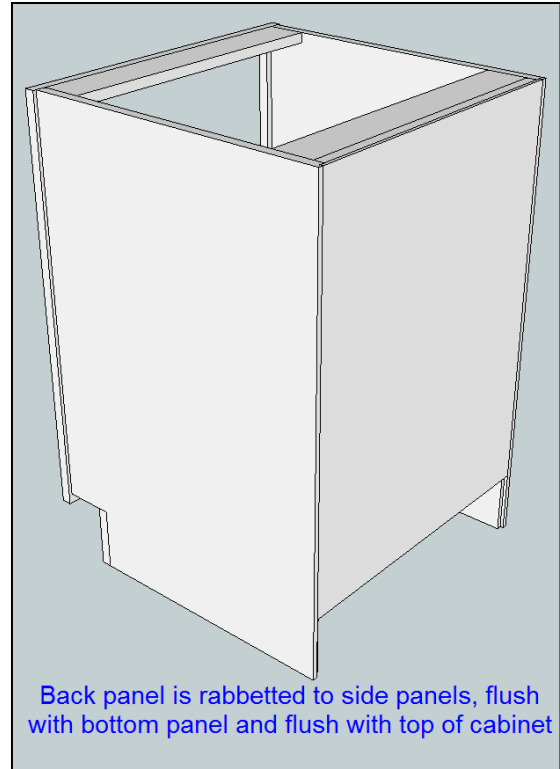
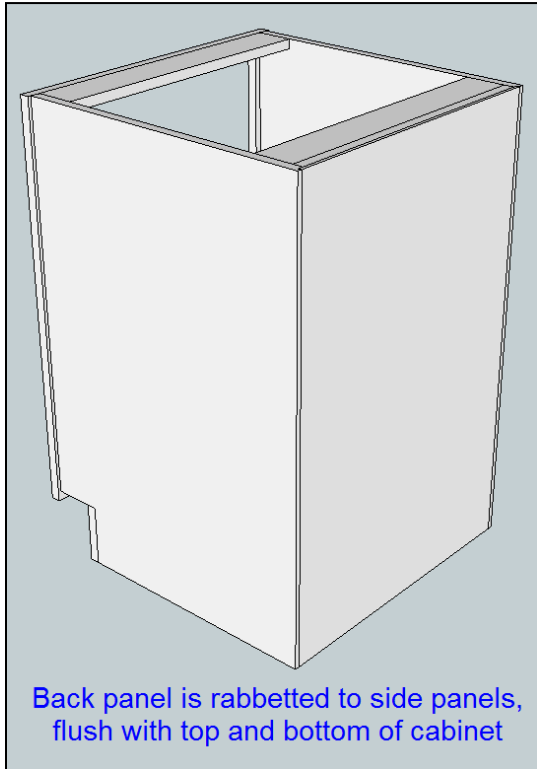

Cabinet *CRUNCHER* Cabinet Design & Cut List Software

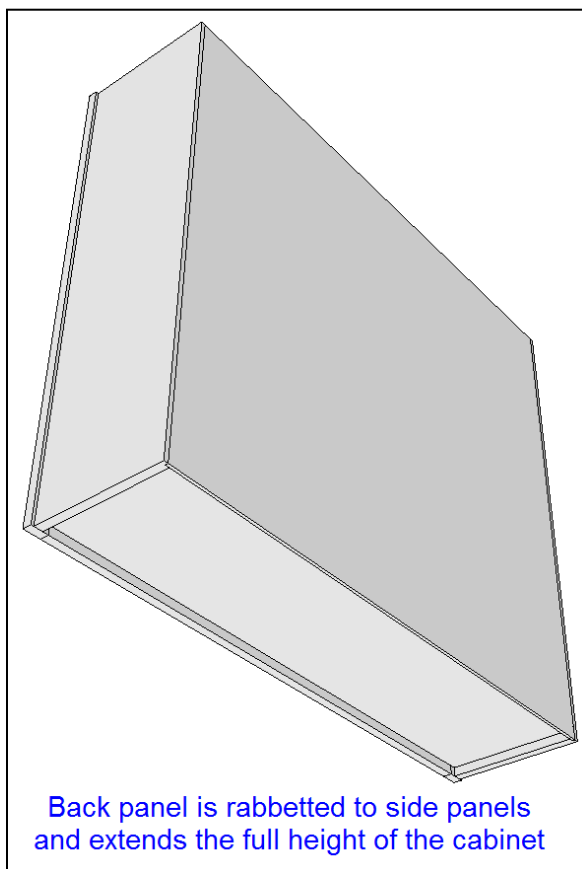
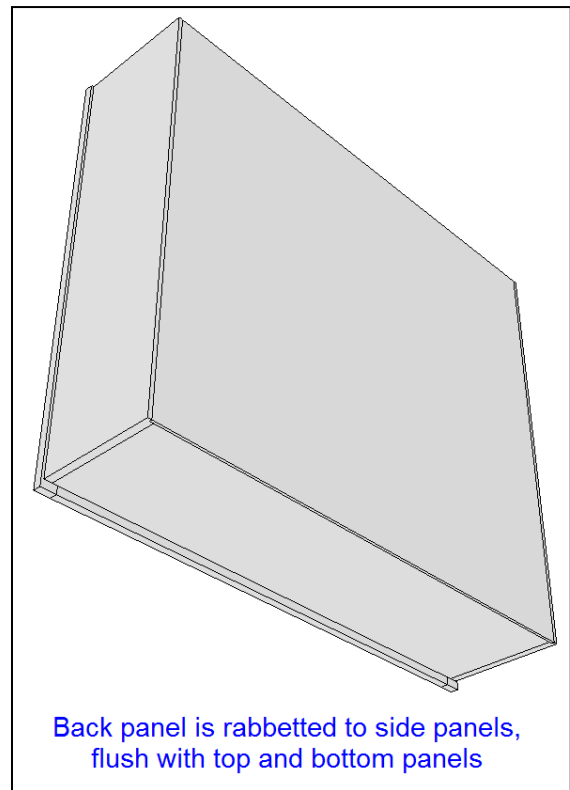
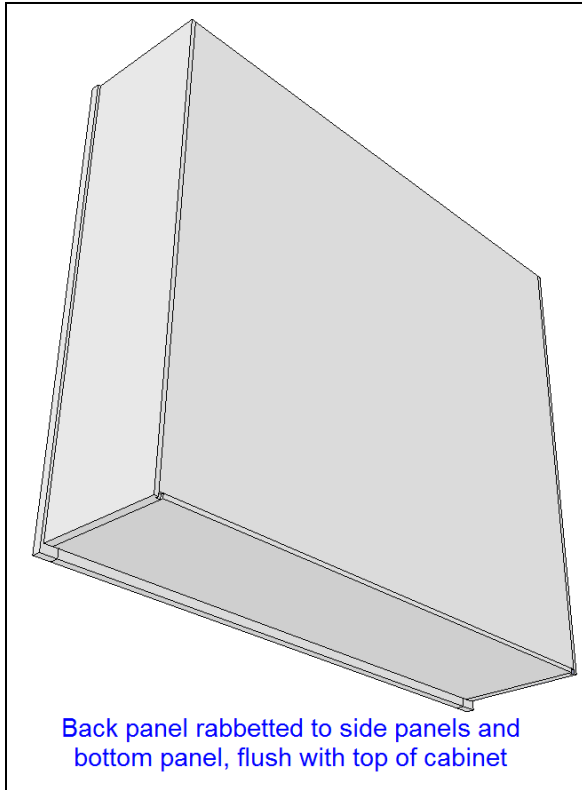

CabinetCRUNCHER Cabinet Design & Cut List Software

- **Cell N35 (Cell N26 Frameless)** Enter the depth of dado or rabbet that will be cut along the back edge of the side panels to accommodate the back panel.

PANELS									
Left Side Panel	23 1/2	28		1	3/4	Birch Ply	FLUSH BOTTOM PANEL		
Right Side Panel	23 1/2	28		1	3/4	Birch Ply			
Top Panel	23 1/2	28		1	3/4	Birch ply	DADO SIDE PANELS	1/4	Depth of dado in side panels for top panel
								1/2	Location of dado from top edge of side panels
Bottom Panel	23 1/2	27 1/2		1	3/4	Birch Ply	BUTTED TO SIDE PANELS		
Back Panel	27 15/16	26 7/16		1	1/4	Birch Ply	DADO SIDE PANELS	1/4	Depth of dado along sides, top & bottom for back panel
							DADO TOP & BOTTOM	3/4	Location of dado from back edge of panels
								1/16	Clearance space within dados for back panel

- **Cell L36 (Cell L27 Frameless)** This setting enables you to adjust the HEIGHT of the back panel.

PANELS									
Left Side Panel	23 1/2	28		1	3/4	Birch Ply	FLUSH BOTTOM PANEL		
Right Side Panel	23 1/2	28		1	3/4	Birch Ply			
Top Panel	23 1/2	28		1	3/4	Birch ply	DADO SIDE PANELS	1/4	Depth of dado in side panels for top panel
								1/2	Location of dado from top edge of side panels
Bottom Panel	23 1/2	27 1/2		1	3/4	Birch Ply	BUTTED TO SIDE PANELS		
Back Panel	27 15/16	26 7/16		1	1/4	Birch Ply	DADO SIDE PANELS	1/4	Depth of dado along sides, top & bottom for back panel
							DADO TOP & BOTTOM	3/4	Location of dado from back edge of panels
								1/16	Clearance space within dados for back panel

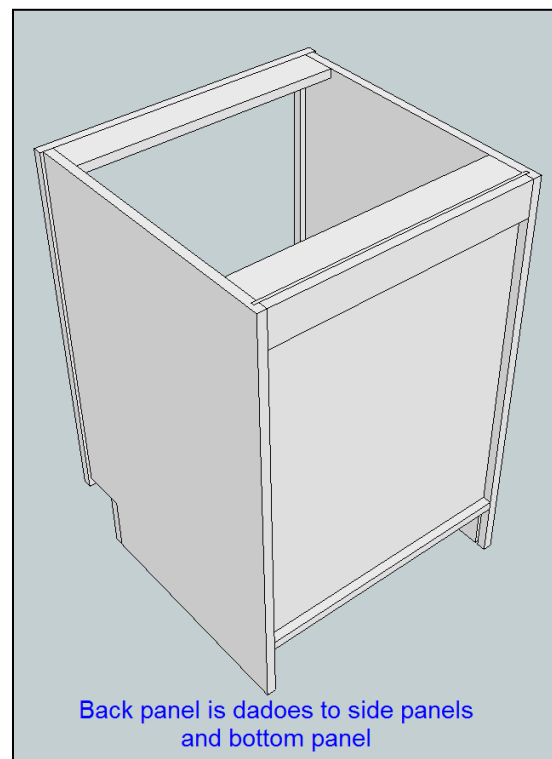
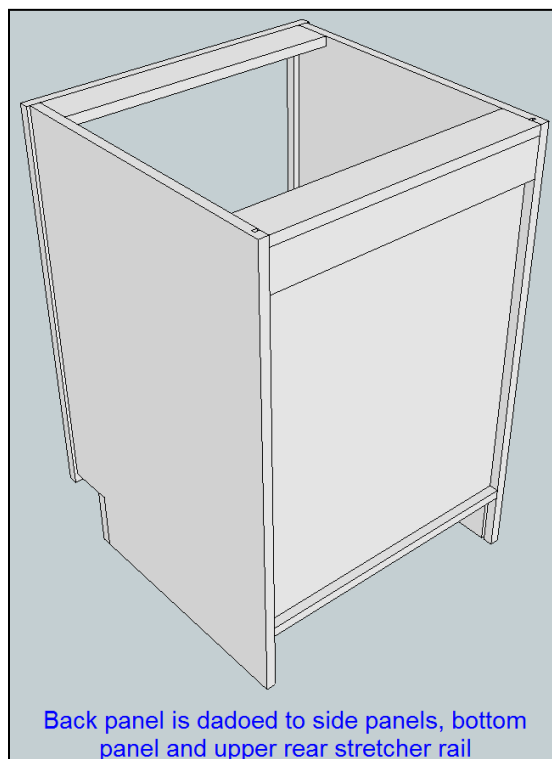

For butted back panels: select **FLUSH BOTTOM PANEL** if you want the back panel to be flush with the top of the cabinet case and flush with the lower surface of the bottom panel.

Cabinet**CRUNCHER** Cabinet Design & Cut List Software

Select **FULL HEIGHT** if you want the back panel to be flush with the top and bottom of the cabinet.

For dadoed back panels: select **DADO TOP & BOTTOM** if you want the back panel to fit into dados that are cut into the upper rear rail or top panel, and the bottom panel. Select **DADO BOTTOM ONLY** if you want the back panel to fit into a dado cut into the bottom panel. The back panel will be flush with the top of the cabinet case. Select **FLUSH BOTTOM PANEL** if you want the back panel to be flush with the top of the cabinet case and flush with the lower surface of the bottom panel. Select **FULL HEIGHT** if you want the back panel to be flush with the top and bottom of the cabinet. Use the "Set-Up Values" to adjust the depth of the dado and the dado's location from the back edge of the side/bottom panels.

For rabbetted back panels: select **RABBIT TOP & BOTTOM** if you want the back panel to fit into rabbets that are cut into the upper rear rail or top panel, and the bottom panel. Select **RABBIT BOTTOM ONLY** if you want the back panel to fit into a rabbet cut along the back edge of the bottom panel. The back panel will be flush with the top of the cabinet case. Select **FLUSH BOTTOM PANEL** if you want the back panel to be flush with the top of the cabinet case and flush with the lower surface of the bottom panel. Select **FULL HEIGHT** if you want the back panel to be flush with top and bottom of the cabinet. Use the "Set-Up Values" to adjust the width of the rabbet.

IMPORTANT: Is this cell is RED, you must change the drop-down selection.

- **Cell N36 (Cell N28 Frameless)** If Cell L35 (Cell L26 Frameless) is set to "DADO SIDE PANELS", enter how far the dado will be located from the back edge of the side panels.

PANELS									
Left Side Panel	23 1/2	28	1	3/4	Birch Ply	FLUSH BOTTOM PANEL			
Right Side Panel	23 1/2	28	1	3/4	Birch Ply				
Top Panel	23 1/2	28	1	3/4	Birch ply	DADO SIDE PANELS	1/4	Depth of dado in side panels for top panel	
							1/2	Location of dado from top edge of side panels	
Bottom Panel	23 1/2	27 1/2	1	3/4	Birch Ply	BUTTED TO SIDE PANELS			
Back Panel	27 15/16	26 7/16	1	1/4	Birch Ply	DADO SIDE PANELS	1/4	Depth of dado along sides, top & bottom for back panel	
						DADO TOP & BOTTOM	3/4	Location of dado from back edge of panels	
							1/16	Clearance space within dados for back panel	

EXAMPLE: If you enter .75, the BACK surface of the back panel will be located .75 from the back edges of the side panels (see below).

Cabinet**CRUNCHER** Cabinet Design & Cut List Software

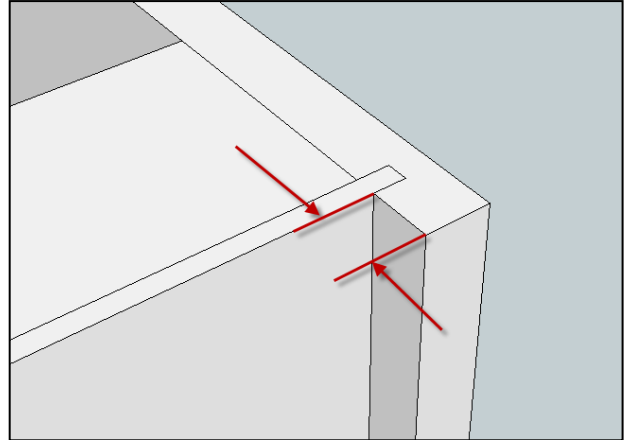
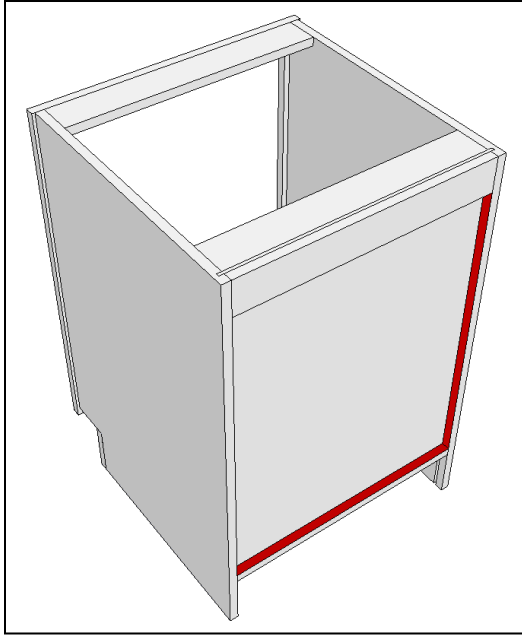

If Cell L35 (Cell L26 Frameless) is set to "RABBET SIDE PANELS", enter the width of the rabbet along the back edge of the side panels (see below).

EXAMPLE: If you enter .75, the FRONT surface of the back panel will be located .75 from the back edges of the side panels. In other words, the width of the rabbet will be .75.

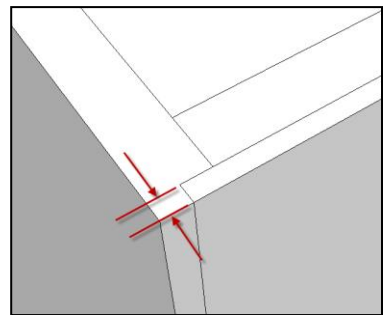
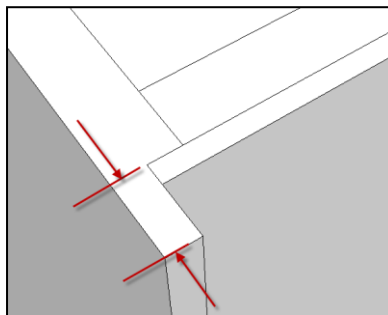
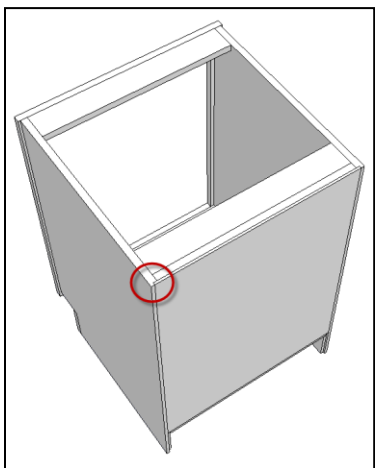

Cell N37 This setting enables you to shrink the back panel so that it will not fit too tight inside the dados or rabbets.

CabinetCRUNCHER Cabinet Design & Cut List Software

EXAMPLE: If the back panel will fit into dados that are cut into the side panels, if you enter 1/16, the width of the back panel will be reduced 1/16. In other words, the back panel will have 1/16 lateral clearance so that it will not fit too tight when installed.

PANELS									
Left Side Panel	23 1/2	28		1	3/4	Birch Ply	FLUSH BOTTOM PANEL		
Right Side Panel	23 1/2	28		1	3/4	Birch Ply			
Top Panel	23 1/2	28		1	3/4	Birch ply	DADO SIDE PANELS	1/4	Depth of dado in side panels for top panel
								1/2	Location of dado from top edge of side panels
Bottom Panel	23 1/2	27 1/2		1	3/4	Birch Ply	BUTTED TO SIDE PANELS		
Back Panel	27 15/16	26 7/16		1	1/4	Birch Ply	DADO SIDE PANELS	1/4	Depth of dado along sides, top & bottom for back panel
							DADO TOP & BOTTOM	3/4	Location of dado from back edge of panels
								1/16	Clearance space within dados for back panel

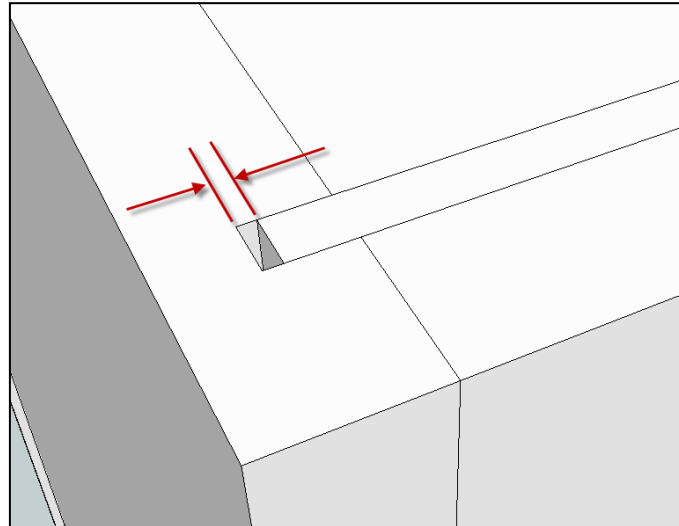
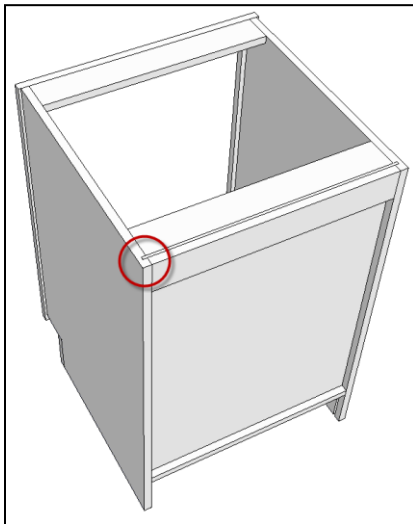

Vertical Partition Panel

- Cell L38 (Cell L29 Frameless)** Select **BUTTED TOP/BOTTOM** if you want the top and/or bottom edges of the center vertical partition panel to butt to the top and/or bottom panel.

Vertical Partition Panel	22 3/8	29 1/2		1	3/4	Birch Ply	DADO TOP/BOTTOM	1/4	Depth of dado in bottom panel for vertical partition panel
Horizontal Partition Panel - Left				0	0		DADO CENTER STILE	1/8	Depth of dado in center stile for vertical partition panel
Horizontal Partition Panel - Right				0	0				

Cabinet **CRUNCHER** Cabinet Design & Cut List Software

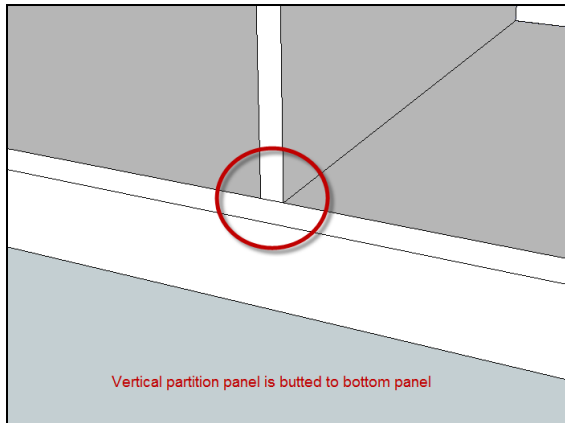

- **Cell L38 (Cell L29 Frameless)** Select **DADO TOP/BOTTOM** if you want the top and/or bottom edges of the center vertical partition panel to fit into dados that are cut into the top and/or bottom panel

NOTE: Top panels are only applicable to "built-in", "free-standing" or "wall" cabinets.

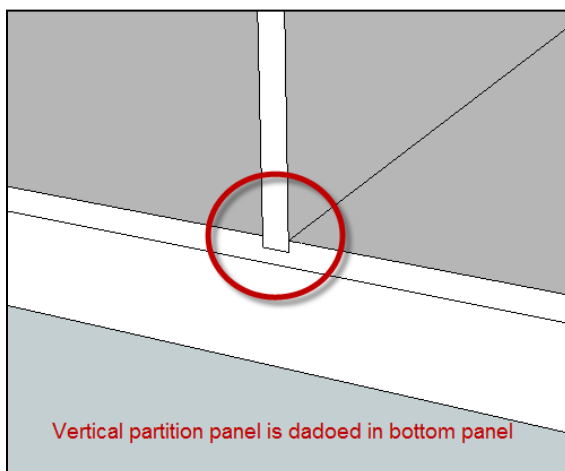

CabinetCRUNCHER Cabinet Design & Cut List Software

- **Cell N38 (Cell N29 Frameless)** Enter the depth of dado that will be cut into the top and/or bottom panel to accommodate the vertical partition panel.

Vertical Partition Panel	22 3/8	29 1/2		1	3/4	Birch Ply	DADO TOP/BOTTOM	1/4	Depth of dado in bottom panel for vertical partition panel
Horizontal Partition Panel - Left			0	0			DADO CENTER STILE	1/8	Depth of dado in center stile for vertical partition panel
Horizontal Partition Panel - Right			0	0					

- **Cell L39 (Face Frame version only)** Select **NO DADO CENTER STILE** if the front edge of the center vertical partition panels will be butted directly to the back surface of the center stiles.

Vertical Partition Panel	22 3/8	29 1/2		1	3/4	Birch Ply	DADO TOP/BOTTOM	1/4	Depth of dado in bottom panel for vertical partition panel
Horizontal Partition Panel - Left			0	0			DADO CENTER STILE	1/8	Depth of dado in center stile for vertical partition panel
Horizontal Partition Panel - Right			0	0					

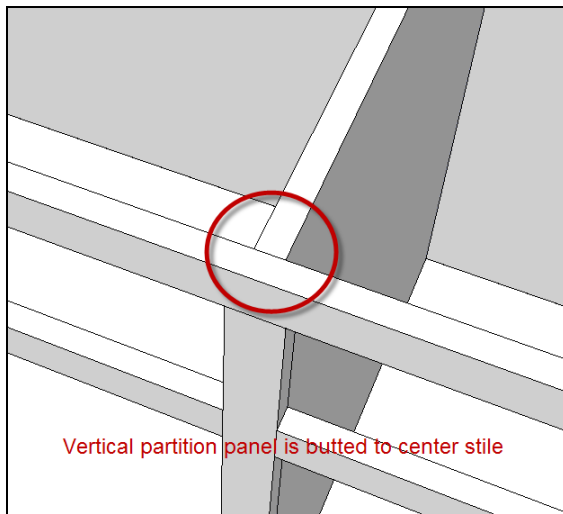

- **Cell L39 (Face Frame version only)** Select **DADO CENTER STILE** if a dado will be cut into the back surface of the center stiles to accommodate the vertical partition panels.

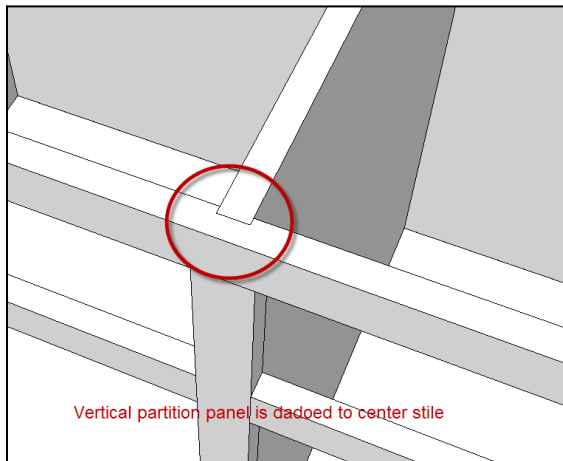

CabinetCRUNCHER Cabinet Design & Cut List Software

- **Cell N39 (Face Frame version only)** Enter the depth of dado that will be cut into the face frame center stile to accept the vertical partition panel.

Ignore this setting if the front edge of the vertical partition panel will be butted to the face frame center stile.

Vertical Partition Panel	22 3/8	29 1/2		1	3/4	Birch Ply	DADO TOP/BOTTOM	1/4	Depth of dado in bottom panel for vertical partition panel
Horizontal Partition Panel - Left				0	0		DADO CENTER STILE	1/8	Depth of dado in center stile for vertical partition panel
Horizontal Partition Panel - Right				0	0				

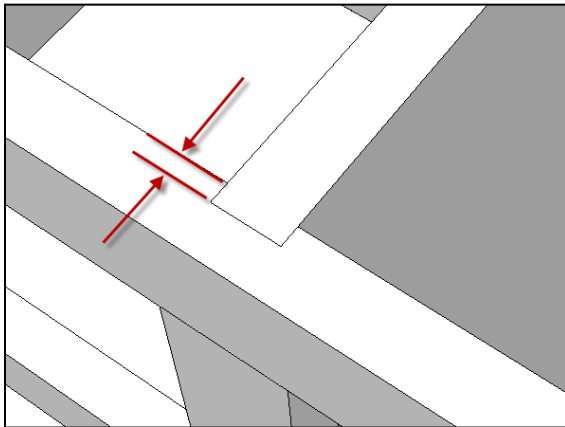

Horizontal Partition Panel

- **Cell L40 (Face Frame version only)** Select **BUTTED TO SIDE PANELS** if you want the horizontal partition panel to be butted to the side panels.

PANELS									
Left Side Panel	23 1/2	28		1	3/4	Birch Ply	FLUSH BOTTOM PANEL		
Right Side Panel	23 1/2	28		1	3/4	Birch Ply			
Top Panel	23 1/2	28		1	3/4	Birch ply	DADO SIDE PANELS	1/4	Depth of dado in side panels for top panel
								1/2	Location of dado from top edge of side panels
Bottom Panel	23 1/2	27 1/2		1	3/4	Birch Ply	BUTTED TO SIDE PANELS		
Back Panel	27 15/16	26 7/16		1	1/4	Birch Ply	DADO SIDE PANELS	1/4	Depth of dado along sides, top & bottom for back panel
							DADO TOP & BOTTOM	3/4	Location of dado from back edge of panels
								1/16	Clearance space within dados for back panel
Horizontal Partition Panel	22 1/4	27 1/2		1	1	3/4	Birch Ply	BUTTED TO SIDE PANELS	
							NO DADO CENTER RAILS		

CabinetCRUNCHER Cabinet Design & Cut List Software

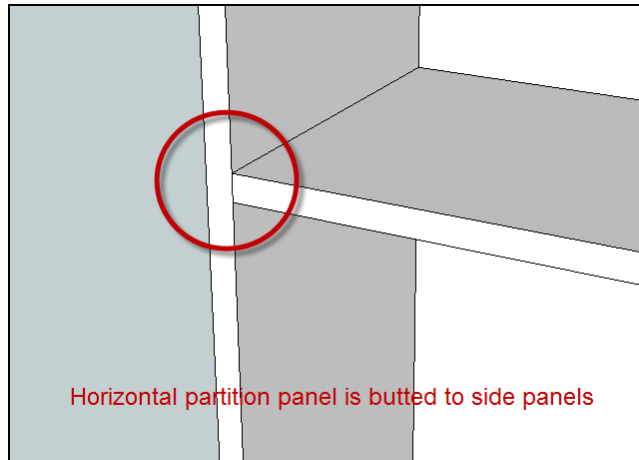

- **Cell L40** Select **DADO SIDE PANELS** if you want the horizontal partition panel to fit into dados that are cut into the side panels. Use the "Set-Up Values" to specify the dado depth.

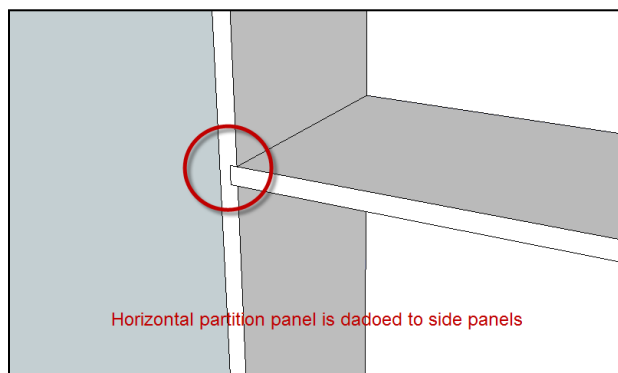

- **Cell N40** If the partition panel will fit into dados that are cut into the side panels, enter the depth of dado.

PANELS									
Left Side Panel	23 1/2	28		1	3/4	Birch Ply	FLUSH BOTTOM PANEL		
Right Side Panel	23 1/2	28		1	3/4	Birch Ply			
Top Panel	23 1/2	28		1	3/4	Birch ply	DADO SIDE PANELS	1/4	Depth of dado in side panels for top panel
								1/2	Location of dado from top edge of side panels
Bottom Panel	23 1/2	27 1/2		1	3/4	Birch Ply	BUTTED TO SIDE PANELS		
Back Panel	27 15/16	26 7/16		1	1/4	Birch Ply	DADO SIDE PANELS	1/4	Depth of dado along sides, top & bottom for back panel
							DADO TOP & BOTTOM	3/4	Location of dado from back edge of panels
								1/16	Clearance space within dados for back panel
Horizontal Partition Panel	22 1/4	28		1	1	3/4	Birch Ply	DADO SIDE PANELS	1/4
							NO DADO CENTER RAILS		Depth of dado in side panels for horizontal partition

CabinetCRUNCHER Cabinet Design & Cut List Software

- **Cell L41 (Face Frame version only)** Select **NO DADO CENTER RAIL** if the front edge of the horizontal partition panels will be butted directly to the back surface of the center rails.

PANELS										
Left Side Panel	23 1/2	28		1	3/4	Birch Ply	FLUSH BOTTOM PANEL			
Right Side Panel	23 1/2	28			3/4	Birch Ply				
Top Panel	23 1/2	28		1	3/4	Birch ply	DADO SIDE PANELS	1/4	Depth of dado in side panels for top panel	
								1/2	Location of dado from top edge of side panels	
Bottom Panel	23 1/2	27 1/2		1	3/4	Birch Ply	BUTTED TO SIDE PANELS			
Back Panel	27 15/16	26 7/16		1	1/4	Birch Ply	DADO SIDE PANELS	1/4	Depth of dado along sides, top & bottom for back panel	
							DADO TOP & BOTTOM	3/4	Location of dado from back edge of panels	
								1/16	Clearance space within dados for back panel	
Horizontal Partition Panel	22 1/4	28		1	1	3/4	Birch Ply	DADO SIDE PANELS NO DADO CENTER RAILS	1/4	Depth of dado in side panels for horizontal partition

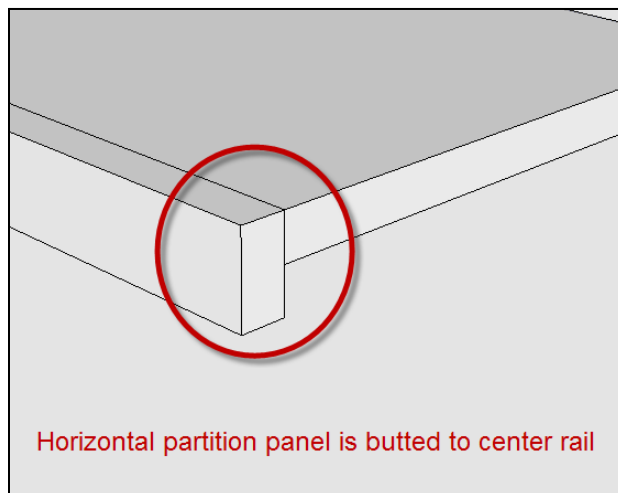

- **Cell L41 (Face Frame version only)** Select **DADO CENTER RAIL** if a dado will be cut into the back surface of the center rails to accommodate the horizontal partition panels.

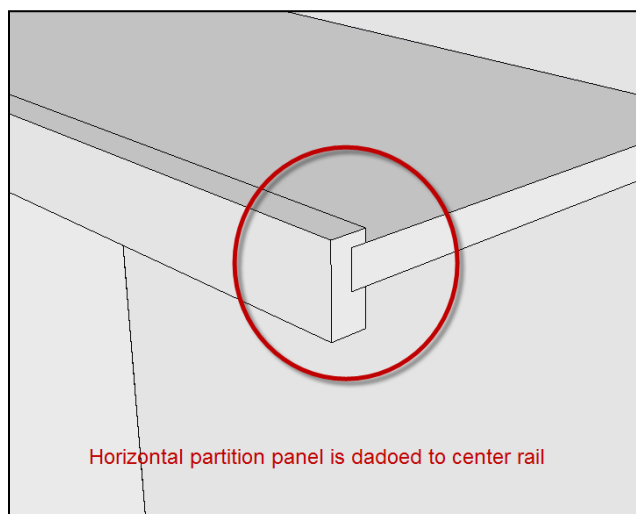

CabinetCRUNCHER Cabinet Design & Cut List Software

- **Cell L41 (Face Frame version only)** Select **SET-BACK** to adjust the finished depth of the horizontal partition panel. Use Cell N41 to enter the amount of desired clearance space between the front face of the panel to the inside surface of face frame.

EXAMPLE: Enter .5 if you want the front edge of the panel to be located .5 from the back surface of the face frame.

PANELS									
Left Side Panel	23 1/2	28			1	3/4	Birch Ply	FLUSH BOTTOM PANEL	
Right Side Panel	23 1/2	28			1	3/4	Birch Ply		
Top Panel	23 1/2	28			1	3/4	Birch ply	DADO SIDE PANELS	1/4
									1/2
Bottom Panel	23 1/2	27 1/2			1	3/4	Birch Ply	BUTTED TO SIDE PANELS	
Back Panel	27 15/16	26 7/16			1	1/4	Birch Ply	DADO SIDE PANELS	1/4
								DADO TOP & BOTTOM	3/4
									1/16
Horizontal Partition Panel	22 1/8	28			1	1	3/4	Birch Ply	DADO SIDE PANELS
								SET-BACK	1/8

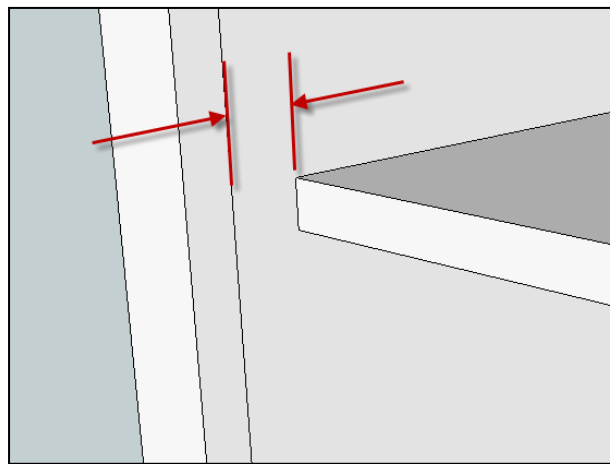
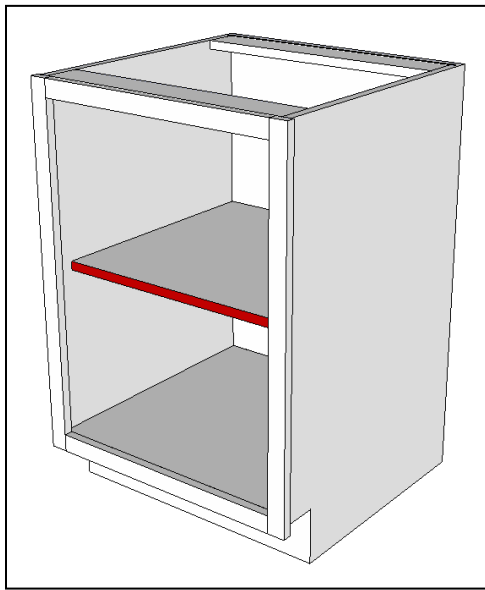

- **Cell N41 (Face Frame version only)** Enter the depth of dado that will be cut into the face frame center rails to accept the horizontal partition panels.

PANELS									
Left Side Panel	23 1/2	28			1	3/4	Birch Ply	FLUSH BOTTOM PANEL	
Right Side Panel	23 1/2	28			1	3/4	Birch Ply		
Top Panel	23 1/2	28			1	3/4	Birch ply	DADO SIDE PANELS	1/4
									1/2
Bottom Panel	23 1/2	27 1/2			1	3/4	Birch Ply	BUTTED TO SIDE PANELS	
Back Panel	27 15/16	26 7/16			1	1/4	Birch Ply	DADO SIDE PANELS	1/4
								DADO TOP & BOTTOM	3/4
									1/16
Horizontal Partition Panel	22 3/8	28			1	1	3/4	Birch Ply	DADO SIDE PANELS
								DADO CENTER RAILS	1/8

CabinetCRUNCHER Cabinet Design & Cut List Software

Cabinet Bases

No Base

- **Cell L45 (Cell L41 Frameless)** Select **NO BASE** if the cabinet does not require a base. This setting is typically used if the cabinet will rest of the side panels, or if you are building any type of cabinet box (EXAMPLE: a "Base Cabinet" box without a base, or a "Wall Cabinet".

BASE										
Base - Front	4 1/2	29		1	3/4	Birch Ply	PEDESTAL BASE	4		Height of kick-space under face frame
Base - Left & Right Sides	4 1/2	18 1/2		2				4		Depth of kick-space in front of cabinet
Base - Rear	4 1/2	29		1				0		Depth of kick-space on left side of cabinet
								0		Depth of kick-space on right side of cabinet

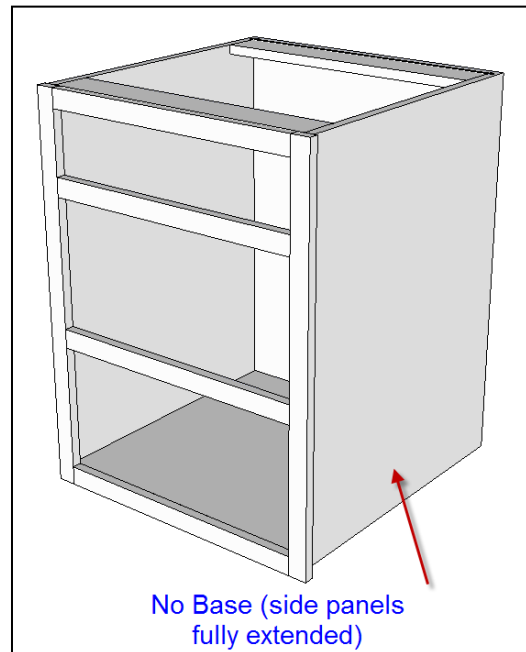
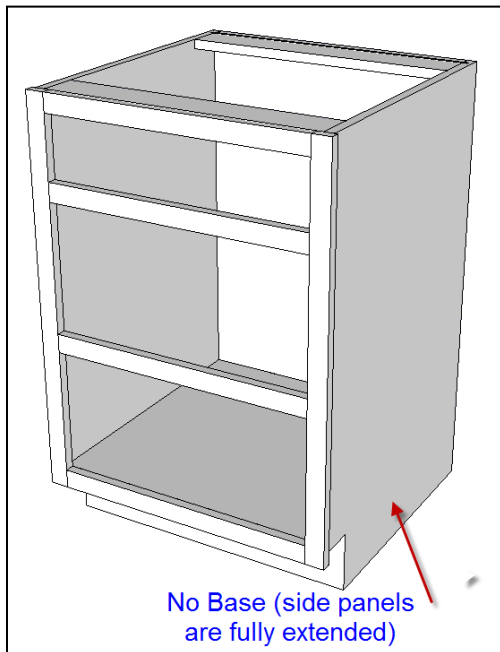

CabinetCRUNCHER Cabinet Design & Cut List Software

Pedestal Base

- **Cell L45 (Cell L41 Frameless)** Select **PEDESTAL BASE** if the cabinet case will rest on a pedestal base unit that will be attached underneath the cabinet.

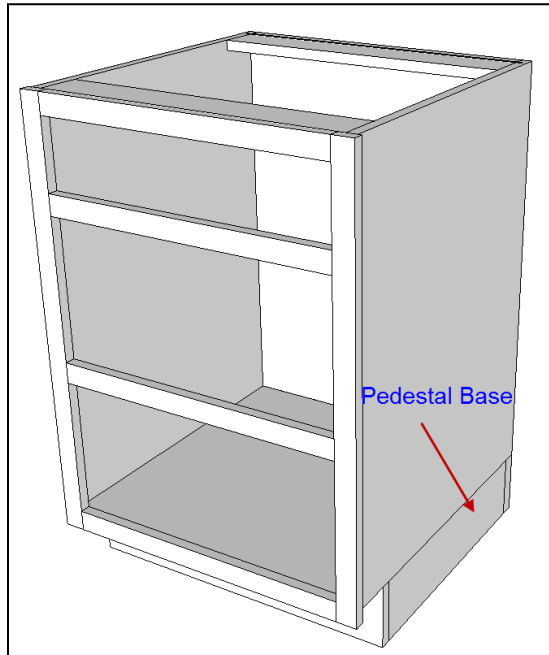

Ladder Base

- **Cell L45 (Cell L41 Frameless)** Select **LADDER BASE** if the cabinet will be installed on a separate custom-built detached "ladder" base unit. (NOTE: a ladder base is a single base unit that is typically built in the field and is designed to accommodate several cabinets).

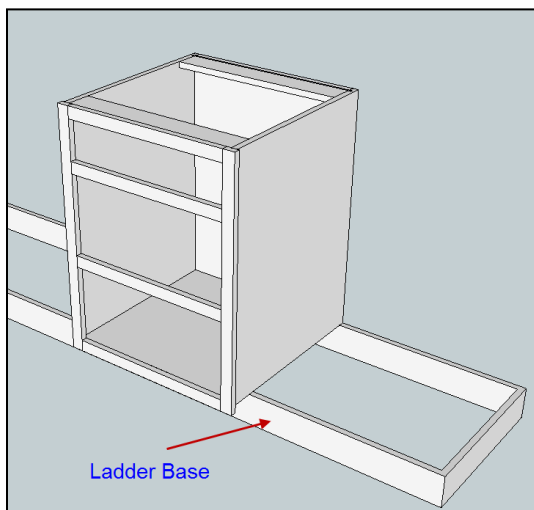

Cabinet**CRUNCHER** Cabinet Design & Cut List Software

- **Cell S44 (Face Frame version only)** If a LADDER BASE is selected, this dimension is measured from the floor to the lower edge of the side panels or the bottom panel (whichever is lower).

BASE							Birch Ply	LADDER BASE	4	Required height of LADDER BASE is: Height of kick-space under face frame	4 1/2
------	--	--	--	--	--	--	-----------	-------------	---	---	-------

If a LEGS OR CASTERS base is selected, this dimension is from the floor to the lower surface of the bottom panel.

Adjustable Legs & Casters

- **Cell L45 (Cell L41 Frameless)** Select **LEGS-CASTERS** if the cabinet will be installed on legs or casters that will be mounted on the lower surface of the bottom panel.

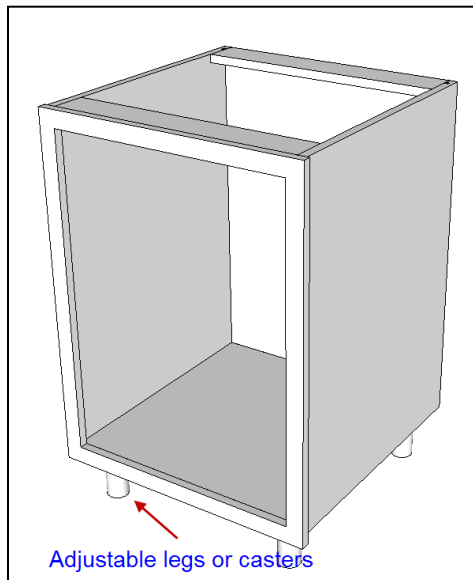

WARNING: if this cell is RED, change this setting to "NO BASE". Reason: Your setting in Cell L14 is "WALL CABINET". Wall cabinets cannot have a base.

CabinetCRUNCHER Cabinet Design & Cut List Software

Adjusting Kickspace

- **Cell N45 (Cell N41 Frameless)** Enter the desired height of the kick-space under the face frame. This is the amount of clearance between the floor where the cabinet is installed to the bottom rail of the face frame.

BASE									
Base - Front	4 1/2	29			1	3/4	Birch Ply	PEDESTAL BASE	4
Base - Left & Right Sides	4 1/2	18 1/2			2				4
Base - Rear	4 1/2	29			1				0
									0

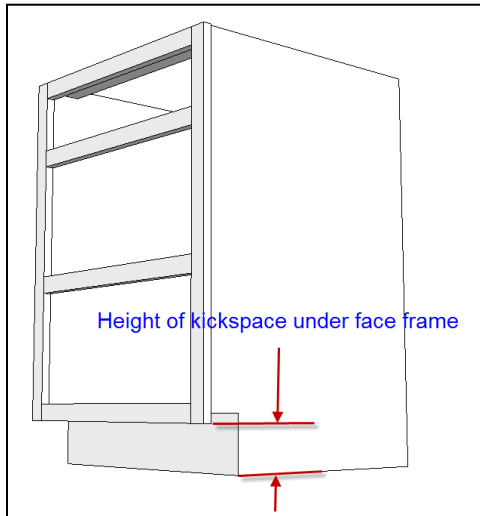

IMPORTANT: (Face Frame version only) If this cell is RED, change this setting to 0, or change the base setting in Cell L45, or change the bottom panel setting in Cell L34. Reason: The bottom panel setting that you selected in Cell L34 cannot be installed if you are using a "NO BASE" setting in Cell L45 and the height of the kickspace in Cell N45 is greater than 0.

CAUTION: (Face Frame version only) If this cell is ORANGE, this setting should be greater than 0. Reason: the base setting that you selected in Cell N45 would typically require a kickspace height setting greater than 0.

- **Cell N46 (Cell N42 Frameless)** Enter the desired depth of the kick-space. This is the distance from the front surface of the face frame to the front face of the pedestal base or kick plate.

BASE									
Base - Front	4 1/2	29			1	3/4	Birch Ply	PEDESTAL BASE	4
Base - Left & Right Sides	4 1/2	18 1/2			2				4
Base - Rear	4 1/2	29			1				0
									0

NOTE: This dimension does not include finish molding.

CabinetCRUNCHER Cabinet Design & Cut List Software

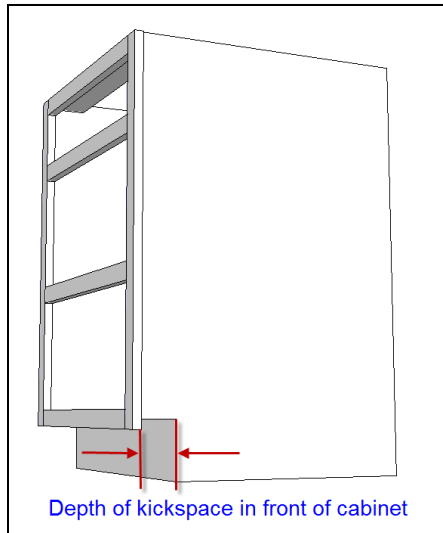

- **Cell N47 (Cell N43 Frameless)** Enter the desired depth of the kick-space on the left side of the cabinet. This is the distance from the outer surface of the left side panel to the pedestal base.

BASE									
Base - Front	4 1/2	29			1	3/4	Birch Ply	PEDESTAL BASE	4
Base - Left & Right Sides	4 1/2	18 1/2			2				4
Base - Rear	4 1/2	29			1				0
									0

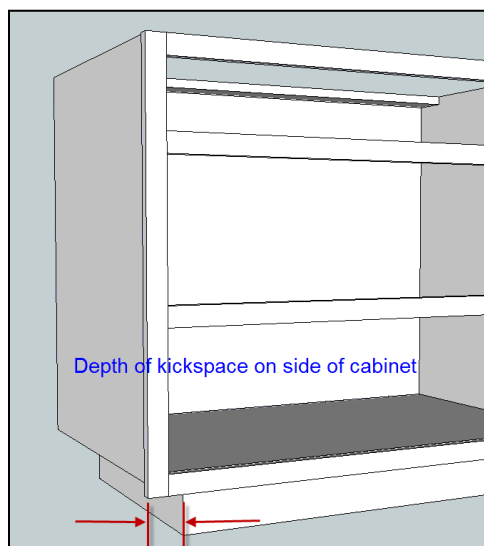

Enter 0 if you want the pedestal base to be flush with the outer surface of the left side panel.

NOTE: This dimension does not include finish molding.

CabinetCRUNCHER Cabinet Design & Cut List Software

- **Cell N48 (Cell N44 Frameless)** Enter the desired depth of the kick-space on the right side of the cabinet. This is the distance from the outer surface of the right side panel to the pedestal base.

BASE											
Base - Front	4 1/2	29		1	3/4	Birch Ply	PEDESTAL BASE	4		Height of kick-space under face frame	
Base - Left & Right Sides	4 1/2	18 1/2		2				4		Depth of kick-space in front of cabinet	
Base - Rear	4 1/2	29		1				0		Depth of kick-space on left side of cabinet	
								0		Depth of kick-space on right side of cabinet	

Enter 0 if you want the pedestal base to be flush with the outer surface of the right side panel.

NOTE: This dimension does not include finish molding.

Shelving

Fixed Shelves

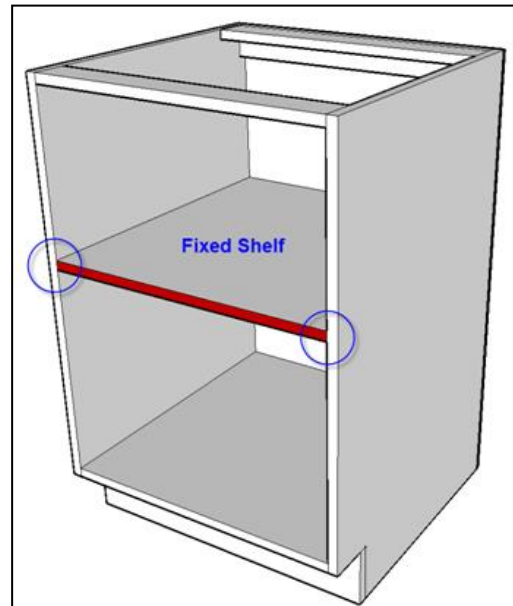
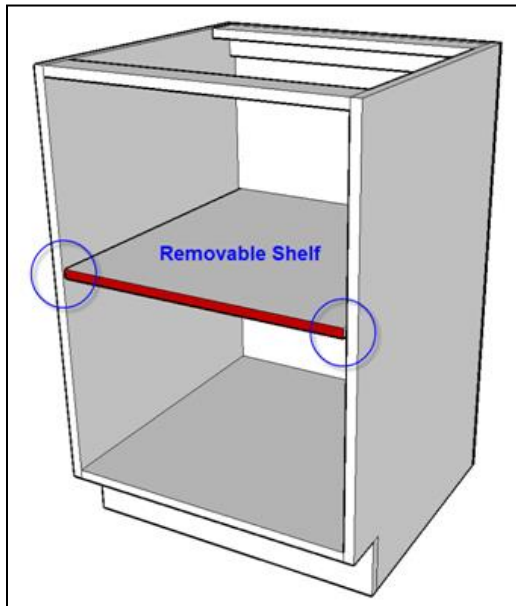

- **Cell L50 (Cell L48 Frameless)** Select **BUTTED TO SIDE PANELS** if you want the shelf to be butted to the side panels.

SHELVES											
Removable Shelf	21	27 3/8		1	1	3/4	Birch Ply	BUTTED TO SIDE PANELS			
									1/8	Lateral clearance for removable shelves	
									1/2	Set-back from face frame for shelves	
									3/4	Thickness of trim material on front edge of shelf	

CabinetCRUNCHER Cabinet Design & Cut List Software

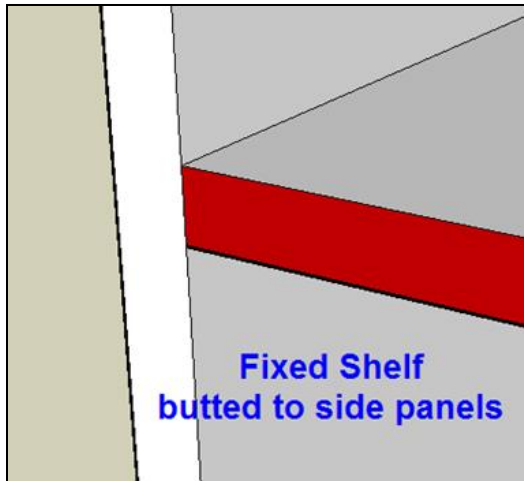

- **Cell L50 (Cell L48 Frameless)** Select **DADO SIDE PANELS** if you want the shelf to fit into dados that are cut into the side panels. Use the "Set-Up Values" to specify the dado depth.

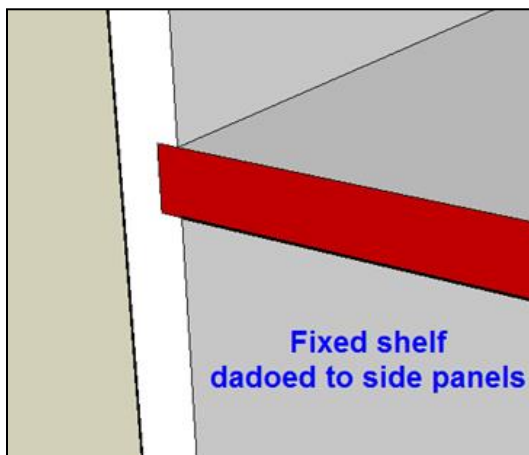

- **Cell N50 (Cell N48 Frameless)** If the shelves will fit into dados that are cut into the side panels, enter the depth of dado.

SHELVES											
Fixed Shelf	21	28	1	1	3/4	Birch Ply	DADO SIDE PANELS	1/4	Depth of dado in side panels for fixed shelves		
								1/2	Set-back from face frame for shelves		
								3/4	Thickness of trim material on front edge of shelf		

Cabinet**CRUNCHER** Cabinet Design & Cut List Software

Removable Shelves

Cell N51 (Cell N49 Frameless) If removable shelves are installed, enter the amount of clearance space for the shelves between the side panels.

EXAMPLE: If you enter .125, the length of the shelf will be .125 shorter than the actual width between the side panels.

SHELVES									
Removable Shelf	21	27 3/8		1	1	3/4	Birch Ply	BUTTED TO SIDE PANELS	
									1/8 Lateral clearance for removable shelves
									1/2 Set-back from face frame for shelves
									3/4 Thickness of trim material on front edge of shelf

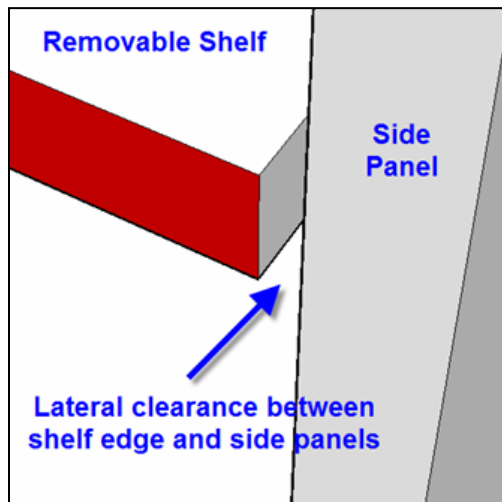

Shelving Set-Back

- **Cell N52 (Cell N50 Frameless)** This setting enables you to adjust the finished depth of the shelf. Enter the amount of desired clearance space between the front face of the finished shelf (with trim material installed) to the inside surface of face frame.

EXAMPLE: Enter .5 if you want the front edge of the finished shelf to be located .5 from the back surface of the face frame.

SHELVES									
Removable Shelf	21	27 3/8	1	1	3/4	Birch Ply	BUTTED TO SIDE PANELS		
								1/8	Lateral clearance for removable shelves
								1/2	Set-back from face frame for shelves
								3/4	Thickness of trim material on front edge of shelf

CabinetCRUNCHER Cabinet Design & Cut List Software

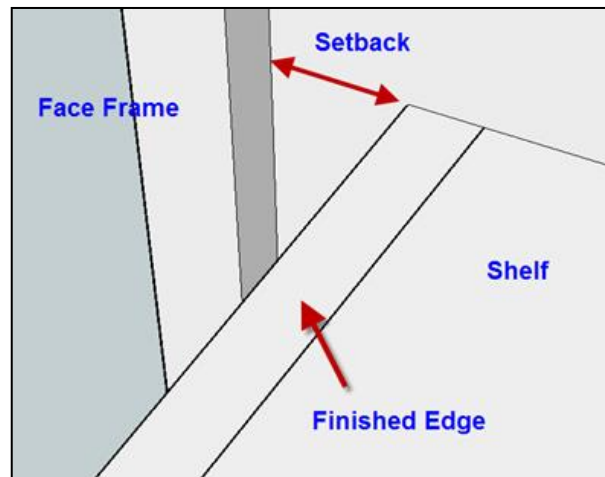
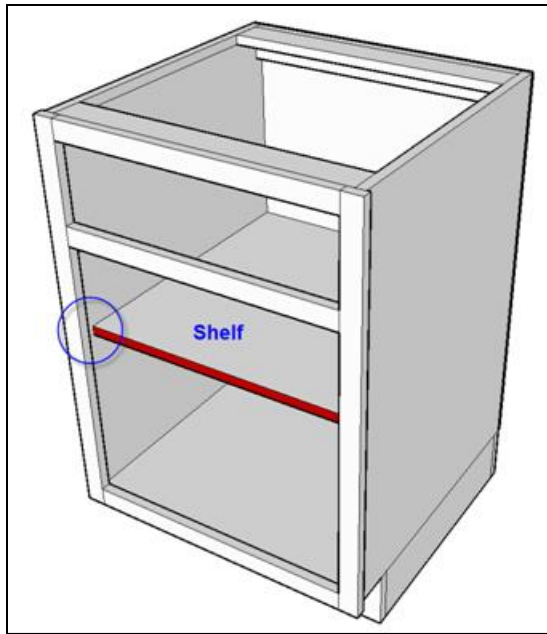

- **Cell N53 (Face Frame version only)** If the shelves require an applied hardwood trim or edge band on the front edge of the panel, enter the thickness of the trim material.

CAUTION: The depth dimension of the shelf panels in Cell E50-E53 is the shelf panel without the trim.

SHELVES									
Removable Shelf	21	27 3/8		1	1	3/4	Birch Ply	BUTTED TO SIDE PANELS	
									1/8
									1/2
									3/4

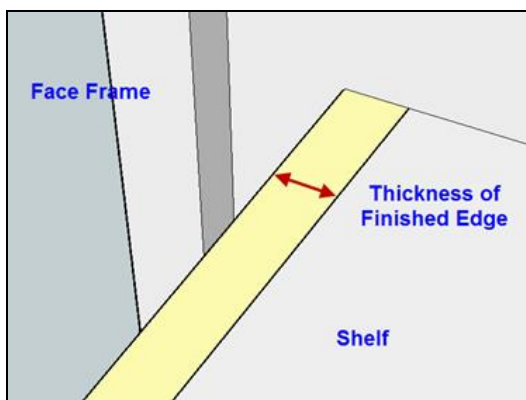

CabinetCRUNCHER Cabinet Design & Cut List Software

Additional Items

Hang Rails

- **Cell L55** Select **INSTALL INSIDE** if the hang rail will be installed inside the cabinet on the front face of the back panel.

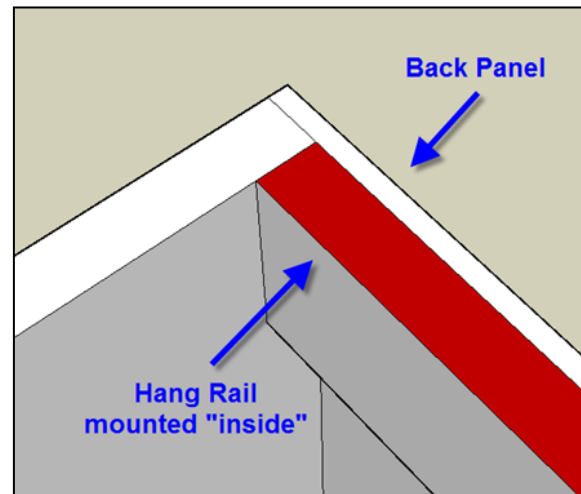
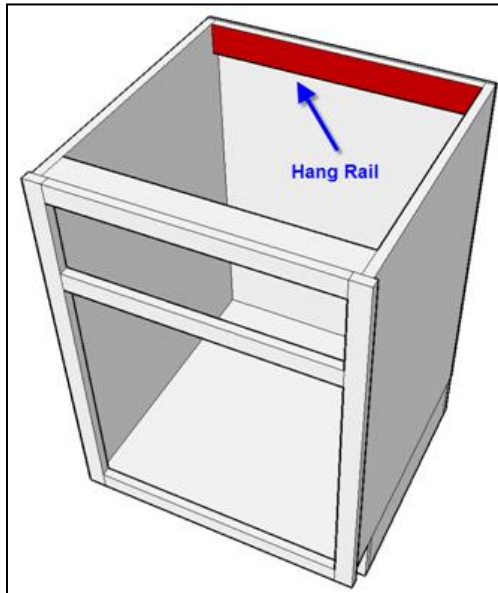

- **Cell L55** Select **INSTALL OUTSIDE** if the hang rail will be installed on the back of the cabinet behind the back panel.

ADDITIONAL ITEMS									
Nailer (Hang Rail)	3	27 1/2		1	1	3/4	Birch Ply	INSTALL OUTSIDE	
Countertop Mounting Cleats	3	27 1/2		2	2	3/4	Birch Ply	LATERAL MOUNT	
Trim Material for Shelves	1 1/2	27 3/8			1	3/4	Cherry		Total lineal feet required is: 2.3
Kickplate					0			FLUSH INSIDE	Ignore this setting - kickplate is not required

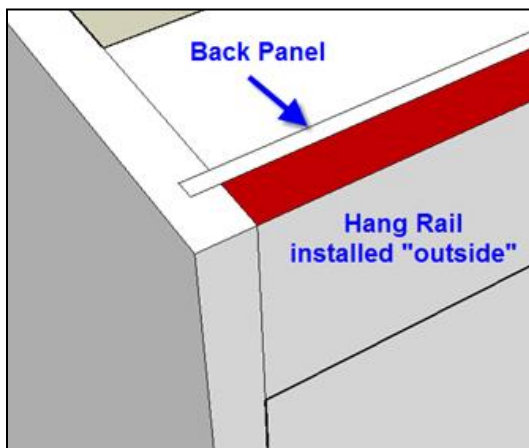

CabinetCRUNCHER Cabinet Design & Cut List Software

Countertop Cleats

- **Cell L56 (Face Frame version only)** This setting enables you to install countertop mounting cleats either laterally (positioned across the width of the cabinet) or fore & aft (positioned from front to back of cabinet).

ADDITIONAL ITEMS									
Nailer (Hang Rail)	3	27 1/2		1	1	3/4	Birch Ply	INSTALL OUTSIDE	
Countertop Mounting Cleats	3	27 1/2		2	2	3/4	Birch Ply	LATERAL MOUNT	
Trim Material for Shelves	1 1/2	27 3/8			1	3/4	Cherry		
Kickplate					0			FLUSH INSIDE	
Total lineal feet required is:									2.3
Ignore this setting - kickplate is not required									

- **Cell L56 (Face Frame version only)** Select **LATERAL MOUNT** if you want the cleat to extend the full width of the inside cabinet opening.

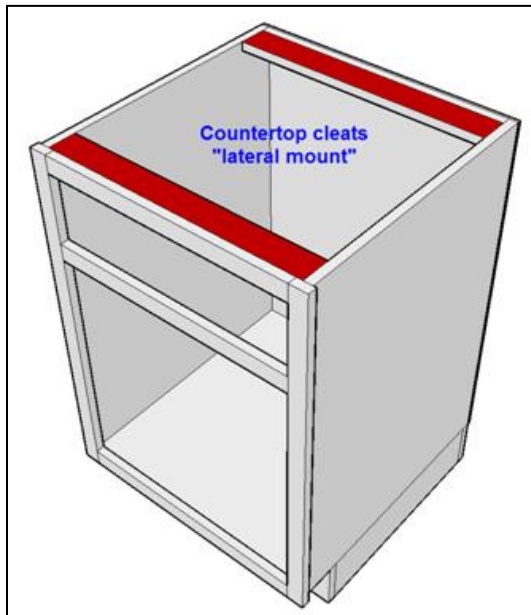

- **Cell L56 (Face Frame version only)** Select **FORE & AFT MOUNT** if you want the cleat to extend from the front to the back of the cabinet. NOTE: if a hang rail is installed along the top back edge of the cabinet, the length of the countertop mounting cleat will be shortened by the thickness of the hang rail. In other words, the hang rail will be installed behind the cleat.

CabinetCRUNCHER Cabinet Design & Cut List Software

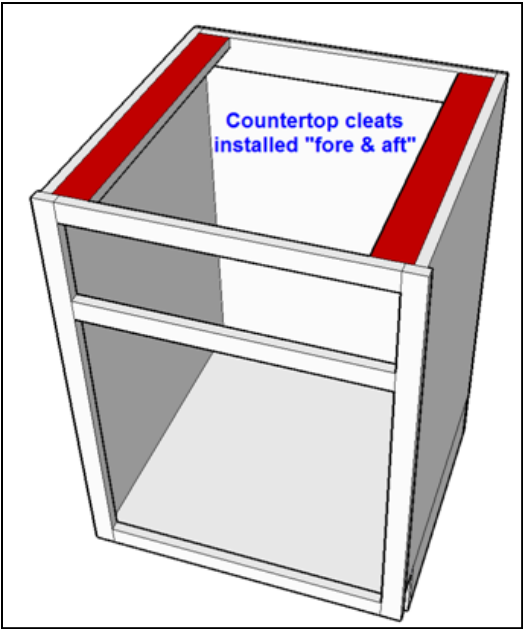

Trim Material for Shelves

- Cell D57 (Cell D47 Frameless)** If fixed or removable shelves are installed, use this line to specify the width of the trim material that will be used on the front edge of the shelves.

ADDITIONAL ITEMS									
Nailer (Hang Rail)	3	27 1/2		1	1	3/4	Birch Ply	INSTALL OUTSIDE	
Countertop Mounting Cleats	3	27 1/2		2	2	3/4	Birch Ply	LATERAL MOUNT	
Trim Material for Shelves	1 1/2	27 3/8			1	3/4	Cherry		Total lineal feet required is: 2.3
Kickplate				0				FLUSH INSIDE	Ignore this setting - kickplate is not required

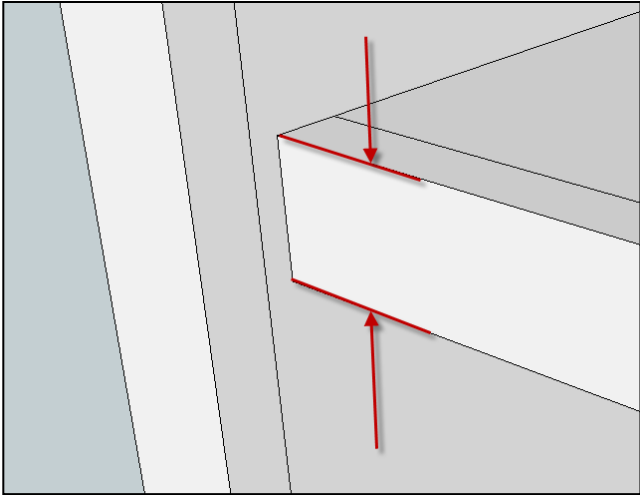
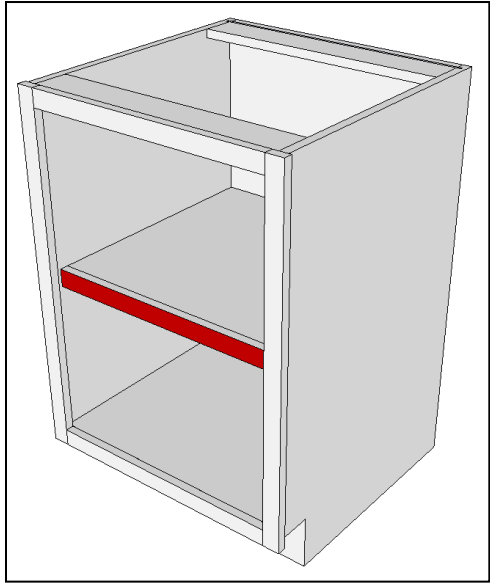

CabinetCRUNCHER Cabinet Design & Cut List Software

Kickplates

- **Cell D58 (Cell D57 Frameless)** This kickplate is only applicable if your base selection in Cell L45 is set to "NO BASE".

ADDITIONAL ITEMS									
Nailer (Hang Rail)	3	27 1/2		1	1	3/4	Birch Ply	INSTALL OUTSIDE	
Countertop Mounting Cleats	3	27 1/2		2	2	3/4	Birch Ply	LATERAL MOUNT	
Trim Material for Shelves	1 1/2	27 3/8			1	3/4	Cherry		Total lineal feet required is: 2.3
Kickplate					0			FLUSH INSIDE	Ignore this setting - kickplate is not required

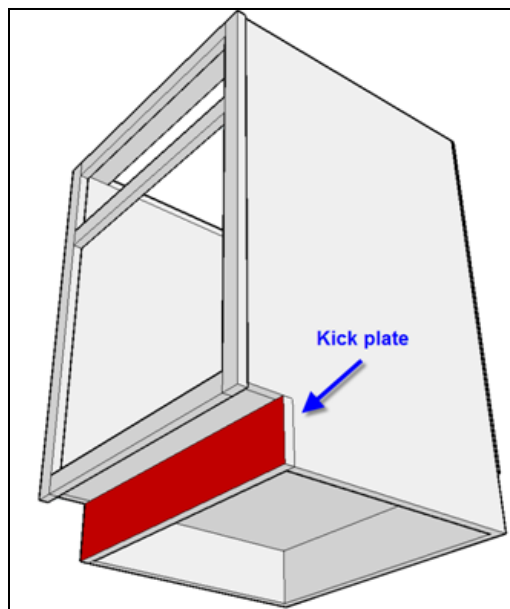

- **Cell E58 (Face Frame version only)** If you selected "FLUSH INSIDE" in Cell L58, this calculation is measured from the bottom of the side panels to the lower surface of the bottom panel.

ADDITIONAL ITEMS									
Nailer (Hang Rail)	3	27 1/2		1	1	3/4	Birch Ply	INSTALL OUTSIDE	
Countertop Mounting Cleats	3	27 1/2		2	2	3/4	Birch Ply	LATERAL MOUNT	
Trim Material for Shelves	1 1/2	27 3/8			1	3/4	Cherry		Total lineal feet required is: 2.3
Kickplate	4 1/2	27 1/2			1	3/4	Birch ply	FLUSH INSIDE	Kickplate is installed inboard of side panels

If you selected "FLUSH OUTSIDE" in Cell L58, this calculation is measured from the bottom of the side panels to the bottom of the face frame.

- **Cell L58 (Face Frame version only)** This setting adjusts the length of the kickplate for cabinets with EXTENDED SIDE PANELS.

CabinetCRUNCHER Cabinet Design & Cut List Software

ADDITIONAL ITEMS									
Nailer (Hang Rail)	3	27 1/2		1	1	3/4	Birch Ply	INSTALL OUTSIDE	
Countertop Mounting Cleats	3	27 1/2		2	2	3/4	Birch Ply	LATERAL MOUNT	
Trim Material for Shelves	1 1/2	27 3/8			1	3/4	Cherry		
Kickplate					0			FLUSH INSIDE	
Total lineal feet required is:									2.3
Ignore this setting - kickplate is not required									

- **Cell L58 (Face Frame version only)** Select **FLUSH OUTSIDE** if you want the kickplate to be flush with the outside surface of the side panels.

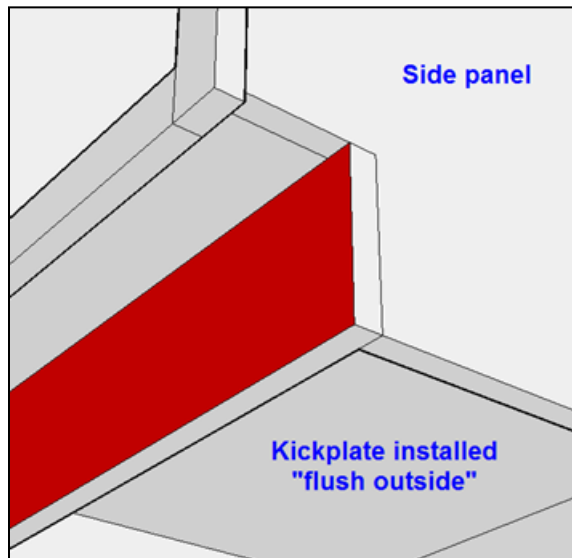

- **Cell L58 (Face Frame version only)** Select **MOUNT INSIDE** if you want the kickplate to span between the side panels.

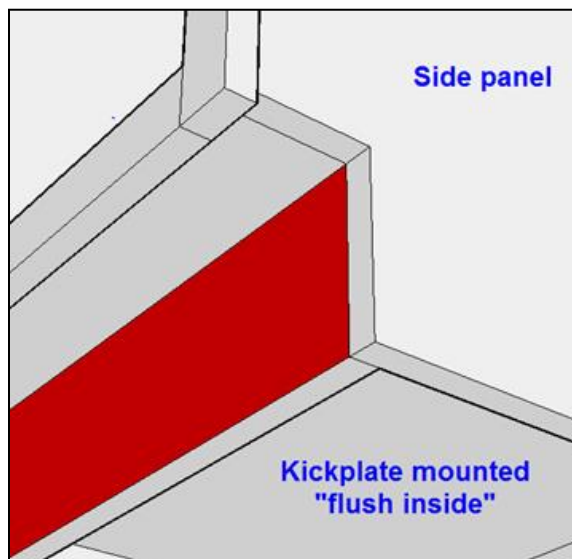

Cabinet**CRUNCHER** Cabinet Design & Cut List Software

Upper Rear Stretcher Rail

Cell D59 (Cell C35 Frameless) This is a rear stretcher rail that spans between the side panels along the upper back edge of the cabinet. It is used only to accommodate "BASE CABINETS" where you have selected the back panel to be "DADOED TOP & BOTTOM" or "RABBETTED TOP & BOTTOM". This rail will be dadoed or rabbetted to accept the back panel.

ADDITIONAL ITEMS											
Nailer (Hang Rail)	3	27 1/2	1	1	3/4	Birch Ply	INSTALL OUTSIDE				
Countertop Mounting Cleats	3	27 1/2	2	2	3/4	Birch Ply	LATERAL MOUNT				
Trim Material for Shelves	1 1/2	27 3/8		1	3/4	Cherry			Total lineal feet required is:	2.3	
Kickplate				0			FLUSH INSIDE		Ignore this setting - kickplate is not required		
Dadoed Upper Rear Rail	3	27 1/2		1	3/4	Birch ply					
				0							

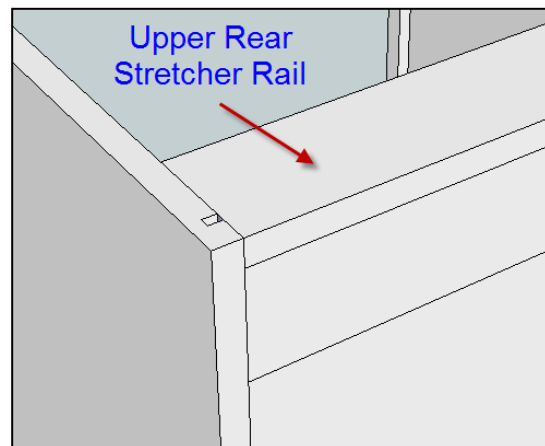
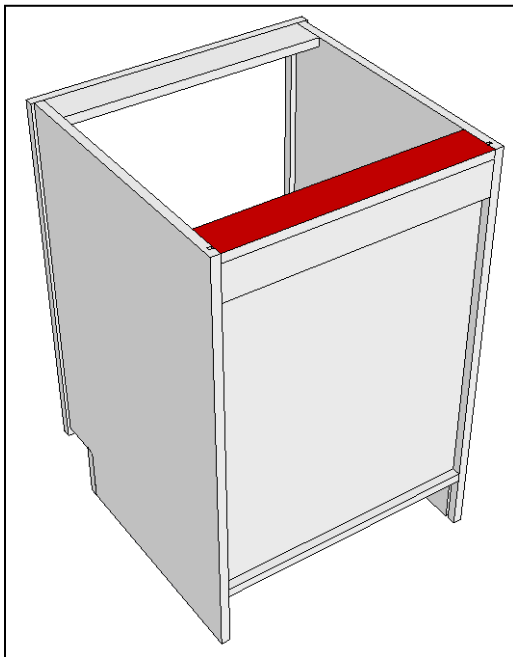

Miscellaneous Items

- **Lines 60-64 (Lines 58-64 Frameless)** Use these lines to add additional miscellaneous components for your cabinet.

[illegible]

CabinetCRUNCHER Cabinet Design & Cut List Software

Adjusting Size of Cabinet Openings

Depth of Cabinet Opening

- **Cell O66** This measurement is the inside depth of the cabinet for drawer box planning purposes. The depth of your drawer boxes must be less than this measurement.

SIZE OF CABINET OPENINGS		DEPTH		23
CABINET LOCATION	REF. NO.	WIDTH	HEIGHT	
Top	1	27	6	
Center	2	27	6	
Bottom	3	27	12 1/2	

SIZE OF CABINET OPENINGS		DEPTH		23
CABINET LOCATION	REF. NO.	WIDTH	HEIGHT	
Top	1	27	6	
Center	2	27	6	
Bottom	3	27	12 1/2	

For face frame cabinets, if you are installing "OVERLAY" doors/drawer fronts, the depth of the cabinet opening is measured from the OUTSIDE surface of the face frame to the inside surface of the back panel.

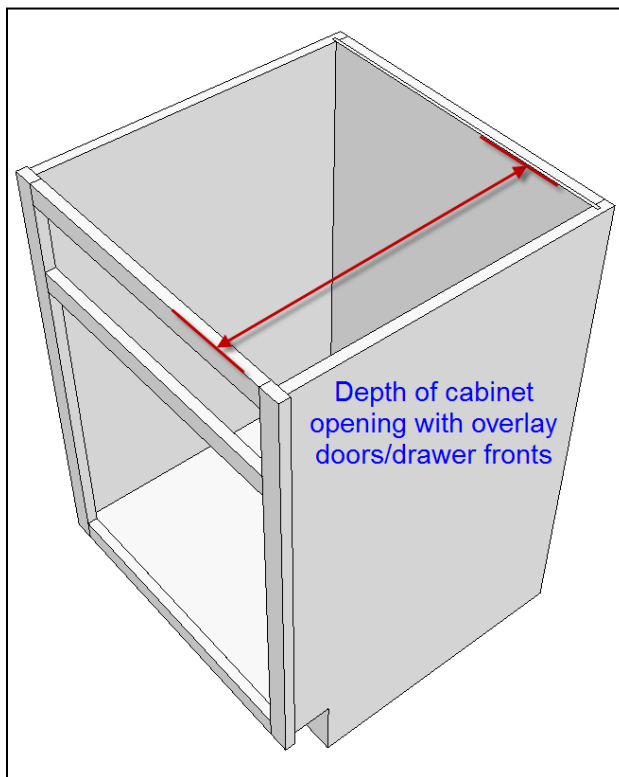

Cabinet**CRUNCHER** Cabinet Design & Cut List Software

For face frame cabinets, if you are installing "INSET" doors/drawer fronts, the depth of the cabinet opening is measured from the INSIDE surface of the face frame to the inside surface of the back panel.

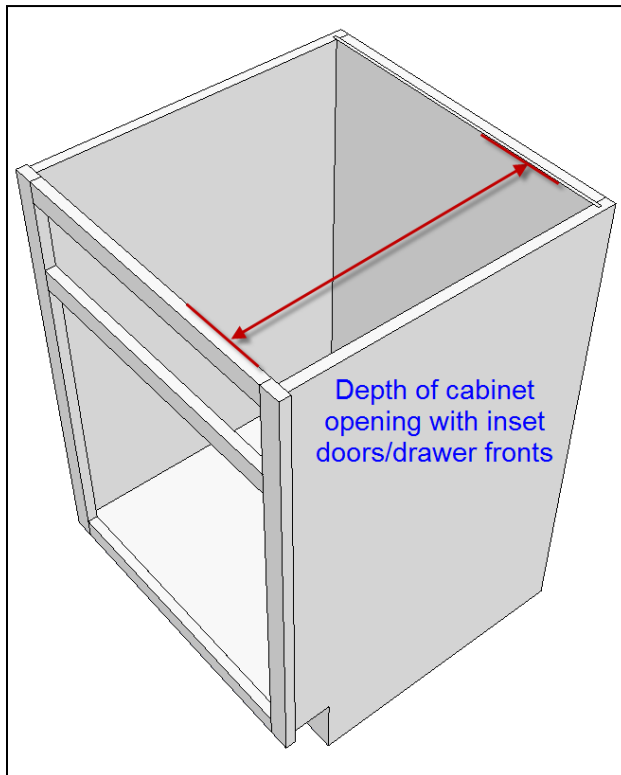

Adjusting Width of Cabinet Openings

Cell N67 Whenever you see a yellow highlighted cell in this column, you can adjust the width of the cabinet opening.

NOTE: If the cells in this column are not highlighted in yellow, the width is calculated automatically based on your cutlist settings.

SIZE OF CABINET OPENINGS		DEPTH	23
CABINET LOCATION	REF. NO.	WIDTH	HEIGHT
Left - Top	1	22	6
Left - Bottom	2	22	20
Right - Top	3	21 1/2	6
Right - Bottom	4	21 1/2	20

CabinetCRUNCHER Cabinet Design & Cut List Software

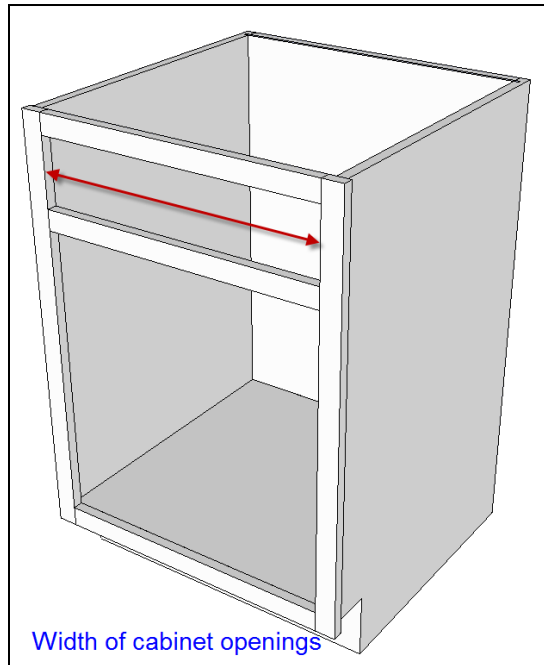

Adjusting Height of Cabinet Openings

Cell O67 Whenever you see a yellow highlighted cell in this column, you can adjust the height of the cabinet opening.

NOTE: If the cells in this column are not highlighted in yellow, the height is calculated automatically based on your cutlist settings.

SIZE OF CABINET OPENINGS		DEPTH	23
CABINET LOCATION	REF. NO.	WIDTH	HEIGHT
Left - Top	1	22	6
Left - Bottom	2	22	20
Right - Top	3	21 1/2	6
Right - Bottom	4	21 1/2	20

CabinetCRUNCHER Cabinet Design & Cut List Software

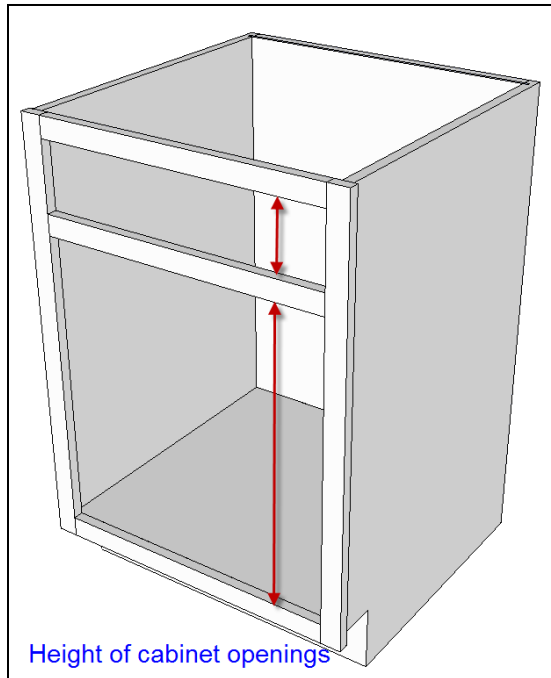

Reference Numbers

- **Cell M67** The "Ref No." provides a location designator for each particular cabinet opening location in Cells K68-K83. The location of all corresponding cabinet doors and drawer boxes will refer to this reference number.

SIZE OF CABINET OPENINGS		DEPTH	23
CABINET LOCATION	REF. NO.	WIDTH	HEIGHT
Top	1	27	6
Center	2	27	6
Bottom	3	27	12 1/2

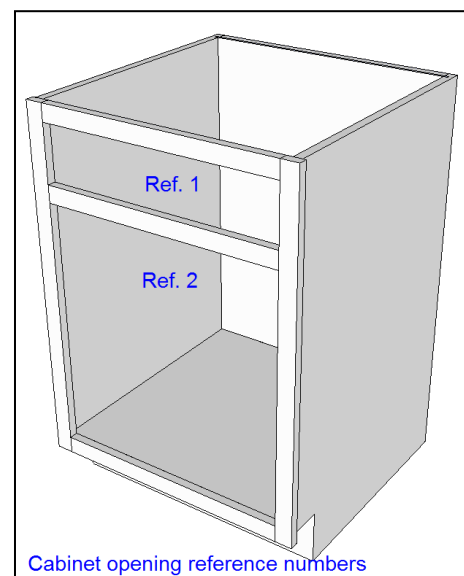

CabinetCRUNCHER Cabinet Design & Cut List Software

Doors, Drawer Fronts & Applied End Panels

- Cell C67** For each of the cabinet openings, use the drop-down menu to choose if the cabinet opening will include a Door, Single Drawer Front, Multiple Drawer Fronts, False Panel or Open Space.

DOORS, DRAWER FRONTS & APPLIED END PANELS						CLEAR
	TYPE OF CABINET OPENING	REF. NO	WIDTH	HEIGHT	QTY	
BC30-17	Drawer Front	1	28 1/2	7 1/4	1	1
BC30-18	Drawer Front	2	28 1/2	7	1	1
BC30-19	Drawer Front	3	28 1/2	13 3/4	1	1

NOTE: If you select "Multiple Drawer Fronts", you will need to manually enter the sizes of the drawer fronts in the section below.

NOTE: An "Open Space" would be a cabinet opening that is intended to be left open without the installation of doors, drawer fronts or false panels.

- Cell E67** The "Ref No." corresponds to the cabinet opening locations identified in Cells M68-M83.

DOORS, DRAWER FRONTS & APPLIED END PANELS						CLEAR
	TYPE OF CABINET OPENING	REF. NO	WIDTH	HEIGHT	QTY	
BC30-17	Drawer Front	1	28 1/2	7 1/4	1	1
BC30-18	Drawer Front	2	28 1/2	7	1	1
BC30-19	Drawer Front	3	28 1/2	13 3/4	1	1

- Cell F67** The width is calculated automatically based on the size of your cabinet opening and your OVERLAY or INSET settings.

DOORS, DRAWER FRONTS & APPLIED END PANELS						CLEAR
	TYPE OF CABINET OPENING	REF. NO	WIDTH	HEIGHT	QTY	
BC30-17	Drawer Front	1	28 1/2	7 1/4	1	1
BC30-18	Drawer Front	2	28 1/2	7	1	1
BC30-19	Drawer Front	3	28 1/2	13 3/4	1	1

CabinetCRUNCHER Cabinet Design & Cut List Software

- **Cell G67** The height is calculated automatically based on the size of your cabinet opening and your OVERLAY or INSET settings.

DOORS, DRAWER FRONTS & APPLIED END PANELS					CLEAR	
	TYPE OF CABINET OPENING	REF. NO	WIDTH	HEIGHT	QTY	
BC30-17	Drawer Front	1	28 1/2	7 1/4	1	1
BC30-18	Drawer Front	2	28 1/2	7	1	1
BC30-19	Drawer Front	3	28 1/2	13 3/4	1	1

- **Cell H67** Use the drop-down list to select the quantity of doors that will be installed in this cabinet opening location. Depending on the width of the cabinet opening, you should select a door quantity 1 or 2.

DOORS, DRAWER FRONTS & APPLIED END PANELS					CLEAR	
	TYPE OF CABINET OPENING	REF. NO	WIDTH	HEIGHT	QTY	
BC30-17	Drawer Front	1	28 1/2	7 1/4	1	1
BC30-18	Drawer Front	2	28 1/2	7	1	1
BC30-19	Drawer Front	3	28 1/2	13 3/4	1	1

If a single drawer front or false panel will be installed at this cabinet opening location, the drop-down quantity will be limited to 1.

If this cabinet opening will be an "open space", the drop-down quantity will be limited to 0.

[illegible]

Overlay on Left stile

- For INSET requirements: ignore this setting.

[illegible]

SET-UP VALUES	
DOORS DRAWER FRONTS	OVERLAY
Left Stile	3/4
Right Stile	3/4
Center Stile/Mullion	1/2
Top Rail	3/4
Bottom Rail	3/4
Center Rail	1/2
Ignore this setting	1/8
Door Gap	1/8
Door Thickness	3/4
APPLIED END PANELS	
Left Width Adjust	0
Left Height Adjust	0
Right Width Adjust	0
Right Height Adjust	0
DRAWER BOXES	
Slide Clearance	1/2

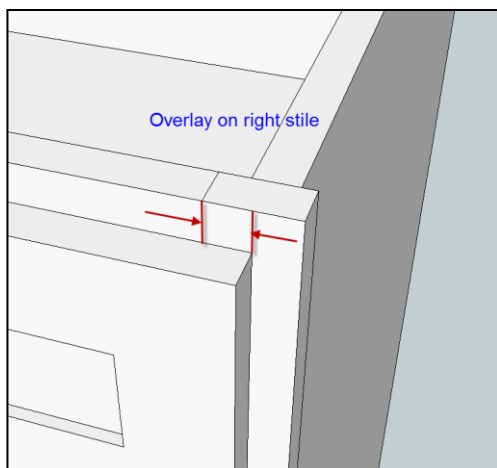

CabinetCRUNCHER Cabinet Design & Cut List Software

- **Cell S70 (Face Frame version only)** For OVERLAY requirements: enter the amount of overlay that is required on the center stiles (NOTE: the center stiles are applicable only on some cabinet configurations).

For INSET requirements: ignore this setting.

SIZE OF CABINET OPENINGS		DEPTH		23
CABINET LOCATION	REF. NO.	WIDTH	HEIGHT	
Left - Top	1	22	6	
Left - Bottom	2	22	20	
Right - Top	3	21 1/2	6	
Right - Bottom	4	21 1/2	20	

SET-UP VALUES	
DOORS	OVERLAY
Left Stile	3/4
Right Stile	3/4
Center Stile/Mullion	1/2
Top Rail	3/4
Bottom Rail	3/4
Center Rail	1/2
Ignore this setting	1/8
Door Gap	1/8
Door Thickness	3/4
APPLIED END PANELS	
Left Width Adjust	0
Left Height Adjust	0
Right Width Adjust	0
Right Height Adjust	0
DRAWER BOXES	
Side Clearance	1/2

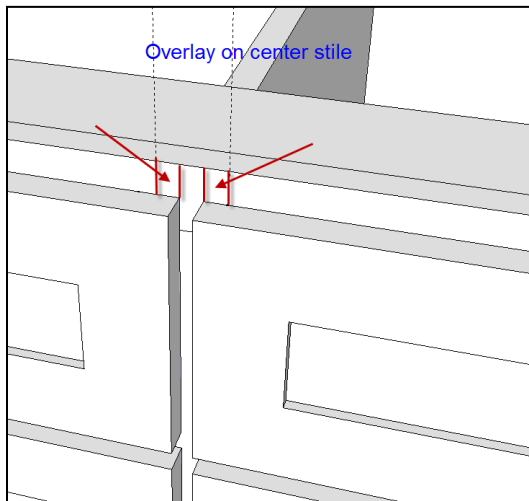

- **Cell S71 (Face Frame version only)** For OVERLAY requirements: enter the amount of overlay that is required on the top rail.

For INSET requirements: ignore this setting.

CabinetCRUNCHER Cabinet Design & Cut List Software

SIZE OF CABINET OPENINGS		DEPTH		23
CABINET LOCATION	REF. NO.	WIDTH	HEIGHT	
Left - Top	1	22	6	
Left - Bottom	2	22	20	
Right - Top	3	21 1/2	6	
Right - Bottom	4	21 1/2	20	

SET-UP VALUES	
DOORS	OVERLAY
DRAWER FRONTS	
Left Stile	3/4
Right Stile	3/4
Center Stile/Mullion	1/2
Top Rail	3/4
Bottom Rail	3/4
Center Rail	1/2
Ignore this setting	1/8
Door Gap	1/8
Door Thickness	3/4
APPLIED END PANELS	
Left Width Adjust	0
Left Height Adjust	0
Right Width Adjust	0
Right Height Adjust	0
DRAWER BOXES	
Side Clearance	1/2

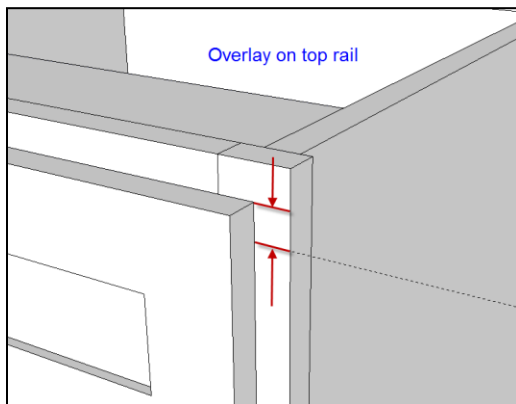

- Cell S72 (Face Frame version only)** For OVERLAY requirements: enter the amount of overlay that is required on the bottom rail.

For INSET requirements: ignore this setting.

SIZE OF CABINET OPENINGS		DEPTH		23
CABINET LOCATION	REF. NO.	WIDTH	HEIGHT	
Left - Top	1	22	6	
Left - Bottom	2	22	20	
Right - Top	3	21 1/2	6	
Right - Bottom	4	21 1/2	20	

SET-UP VALUES	
DOORS	OVERLAY
DRAWER FRONTS	
Left Stile	3/4
Right Stile	3/4
Center Stile/Mullion	1/2
Top Rail	3/4
Bottom Rail	3/4
Center Rail	1/2
Ignore this setting	1/8
Door Gap	1/8
Door Thickness	3/4
APPLIED END PANELS	
Left Width Adjust	0
Left Height Adjust	0
Right Width Adjust	0
Right Height Adjust	0
DRAWER BOXES	
Side Clearance	1/2

CabinetCRUNCHER Cabinet Design & Cut List Software

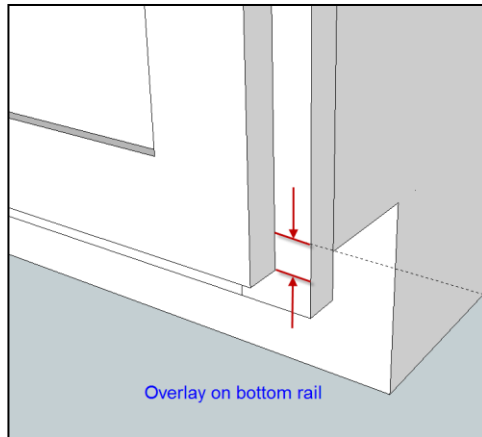

- **Cell S73 (Face Frame version only)** For OVERLAY requirements: enter the amount of overlay that is required on the center rails (NOTE: center rails are applicable only on some cabinet configurations).

For INSET requirements: ignore this setting.

SIZE OF CABINET OPENINGS		DEPTH	23
CABINET LOCATION	REF. NO.	WIDTH	HEIGHT
Left - Top	1	22	6
Left - Bottom	2	22	20
Right - Top	3	21 1/2	6
Right - Bottom	4	21 1/2	20

SET-UP VALUES	
DOORS DRAWER FRONTS	OVERLAY
Left Stile	3/4
Right Stile	3/4
Center Stile/Mullion	1/2
Top Rail	3/4
Bottom Rail	3/4
Center Rail	1/2
Ignore this setting	1/8
Door Gap	1/8
Door Thickness	3/4
APPLIED END PANELS	
Left Width Adjust	0
Left Height Adjust	0
Right Width Adjust	0
Right Height Adjust	0
DRAWER BOXES	
Side Clearance	1/2

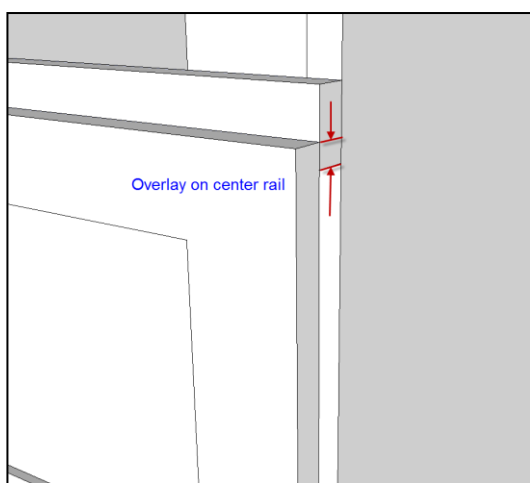

CabinetCRUNCHER Cabinet Design & Cut List Software

Inset Adjustments (Face Frame version only)

- **Cell S74** For INSET requirements: enter the desired amount of inset. The inset will be calculated on all edges of the panel except for the "door gap". You will need to specify the door gap separately.

For OVERLAY requirements: ignore this setting.

SIZE OF CABINET OPENINGS		DEPTH	22 1/4
CABINET LOCATION	REF. NO.	WIDTH	HEIGHT
Left - Top	1	22	6
Left - Bottom	2	22	20
Right - Top	3	21 1/2	6
Right - Bottom	4	21 1/2	20

SET-UP VALUES	
DOORS	INSET
DRAWER FRONTS	
Inset Amount	1/8
Door Gap	1/8
Door Thickness	3/4
APPLIED END PANELS	
Left Width Adjust	0
Left Height Adjust	0
Right Width Adjust	0
Right Height Adjust	0
DRAWER BOXES	
Side Clearance	1/2

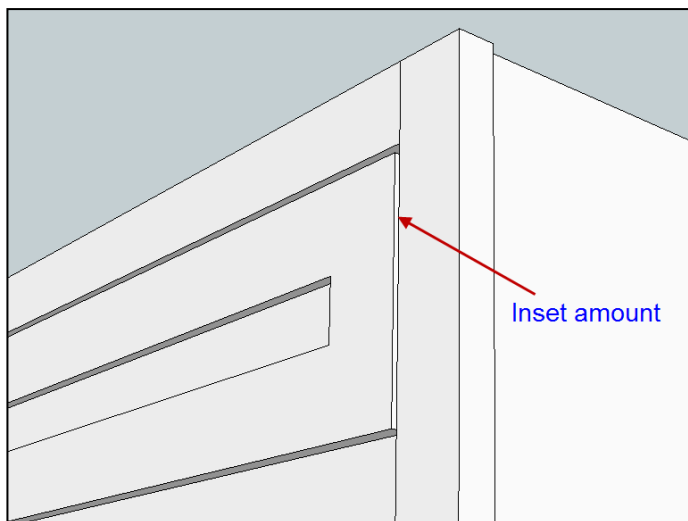

Door Gaps

- **Cell S75** Enter desired gap between mating doors. This setting will only apply if two doors are installed in a single cabinet opening.

CabinetCRUNCHER Cabinet Design & Cut List Software

SIZE OF CABINET OPENINGS		DEPTH		23
CABINET LOCATION	REF. NO.	WIDTH	HEIGHT	
Left - Top	1	22	6	
Left - Bottom	2	22	20	
Right - Top	3	21 1/2	6	
Right - Bottom	4	21 1/2	20	

SET-UP VALUES	
DOORS	OVERLAY
DRAWER FRONTS	
Left Stile	3/4
Right Stile	3/4
Center Stile/Mullion	1/2
Top Rail	3/4
Bottom Rail	3/4
Center Rail	1/2
Ignore this setting	1/8
Door Gap	1/8
Door Thickness	3/4
APPLIED END PANELS	
Left Width Adjust	0
Left Height Adjust	0
Right Width Adjust	0
Right Height Adjust	0
DRAWER BOXES	
Side Clearance	1/2

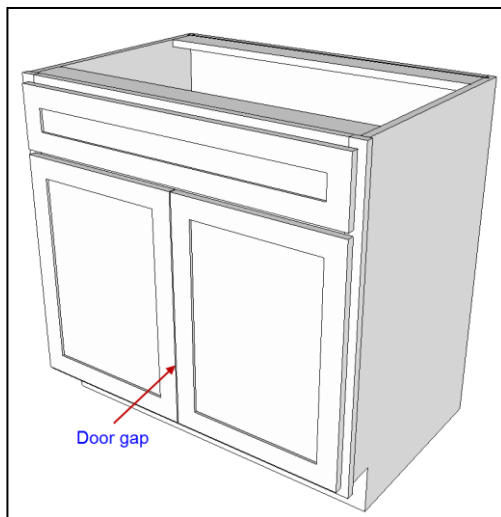

Thickness of Doors/Drawer Fronts

- **Cell S76** Enter the thickness of the cabinet doors/drawer fronts.

SIZE OF CABINET OPENINGS		DEPTH		23
CABINET LOCATION	REF. NO.	WIDTH	HEIGHT	
Left - Top	1	22	6	
Left - Bottom	2	22	20	
Right - Top	3	21 1/2	6	
Right - Bottom	4	21 1/2	20	

SET-UP VALUES	
DOORS	OVERLAY
DRAWER FRONTS	
Left Stile	3/4
Right Stile	3/4
Center Stile/Mullion	1/2
Top Rail	3/4
Bottom Rail	3/4
Center Rail	1/2
Ignore this setting	1/8
Door Gap	1/8
Door Thickness	3/4
APPLIED END PANELS	
Left Width Adjust	0
Left Height Adjust	0
Right Width Adjust	0
Right Height Adjust	0
DRAWER BOXES	
Side Clearance	1/2

Applied End Panels

- [illegible]

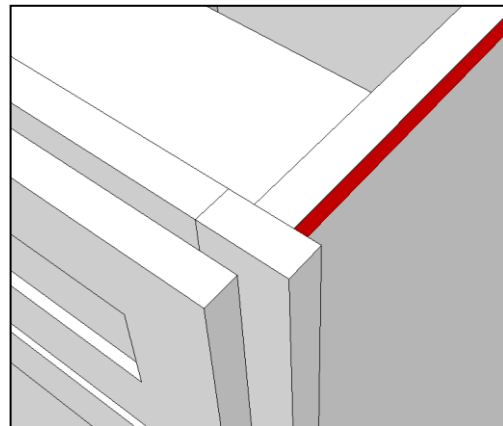
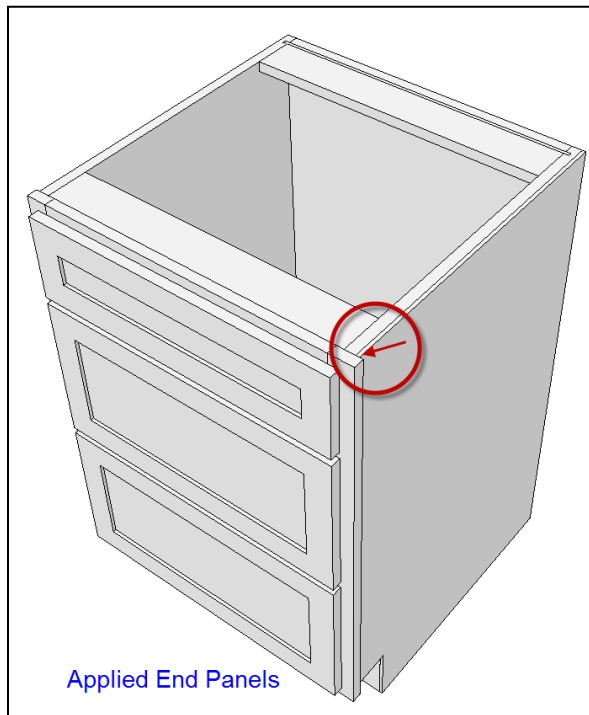

Cabinet**CRUNCHER** Cabinet Design & Cut List Software

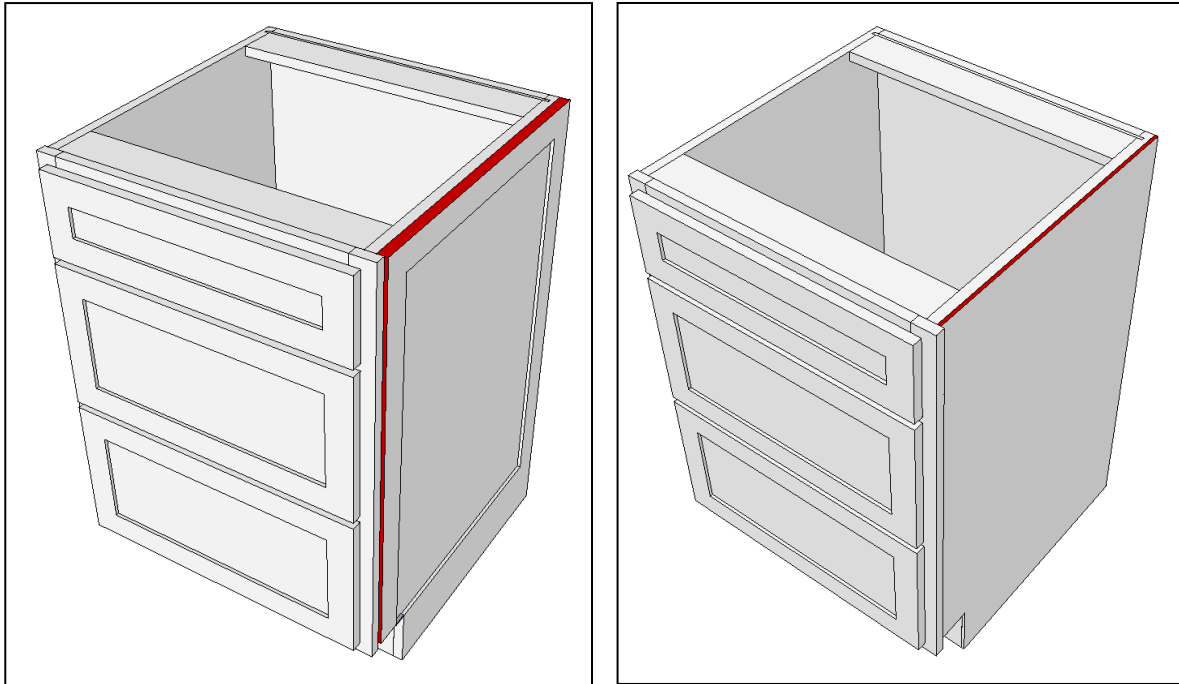

IMPORTANT: The total finished width of the cabinet is typically the width of the face frame however, if you are installing applied end panels (refer to quantities in Cell H91 and H92), and if the thickness of the applied end panels extends beyond the face frame stiles, then the finished width of the cabinet will be measured from the outer surfaces of the applied end panels.

- **Cell H91** Enter 0 if an applied end panel is not required.

[illegible]

- **Cell H91** Enter 1, if an applied end panel is required.

Cabinet**CRUNCHER** Cabinet Design & Cut List Software

IMPORTANT: The total finished width of the cabinet is typically the width of the face frame however, if you are installing applied end panels (refer to Cell H91 and H92), and if the thickness of the applied end panels extends beyond the face frame stiles, then the finished width of the cabinet will be measured from the outer surfaces of the applied end panels.

CAUTION: If this cell is ORANGE, verify your "Applied End Panel" settings in Cell H91 and E91. If these settings are correct, disregard this caution advisory.

- **Cell E92** Enter the thickness of the applied end panel.

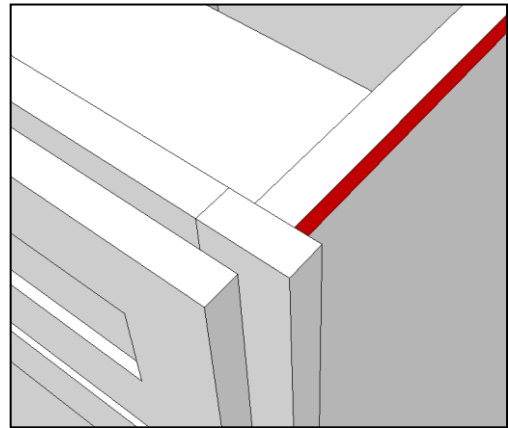
[illegible]

IMPORTANT: The total finished width of the cabinet is typically the width of the face frame however, if you are installing applied end panels (refer to quantities in Cell H91 and H92), and if the thickness of the applied end panels extends beyond the face frame stiles, then the finished width of the cabinet will be measured from the outer surfaces of the applied end panels.

- **Cell H92** Enter 0 if an applied end panel is not required.

Cabinet**CRUNCHER** Cabinet Design & Cut List Software

[illegible]

- **Cell H92** Enter 1, if an applied end panel is required.

IMPORTANT: The total finished width of the cabinet is typically the width of the face frame however, if you are installing applied end panels (refer to Cell H91 and H92), and if the thickness of the applied end panels extends beyond the face frame stiles, then the finished width of the cabinet will be measured from the outer surfaces of the applied end panels.

CAUTION: If this cell is ORANGE, verify your "Applied End Panel" settings in Cell H92 and E92. If these settings are correct, disregard this caution advisory.

Adjust Width of Applied End Panels

- Cell S78** This setting enables you to increase the width of the LEFT applied end panel to accommodate scribes against adjoining walls, or to support a variety of joinery options with the face frame styles.

[illegible]

SET-UP VALUES	
DOORS DRAWER FRONTS	OVERLAY
Left Stile	3/4
Right Stile	3/4
Center Stile/Mullion	1/2
Top Rail	3/4
Bottom Rail	3/4
Center Rail	1/2
Ignore this setting	1/8
Door Gap	1/8
Door Thickness	3/4
APPLIED END PANELS	
Left Width Adjust	0
Left Height Adjust	0
Right Width Adjust	0
Right Height Adjust	0
DRAWER BOXES	
Side Clearance	1/2

Cabinet**CRUNCHER** Cabinet Design & Cut List Software

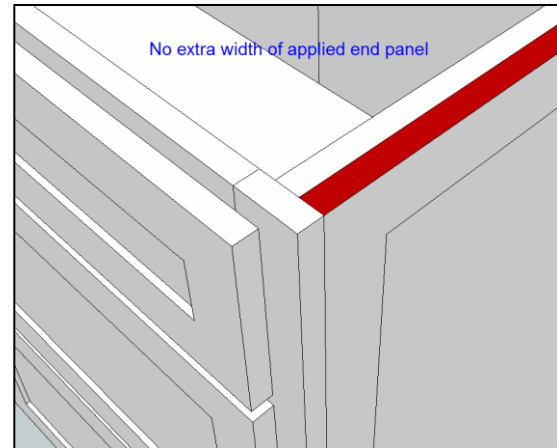
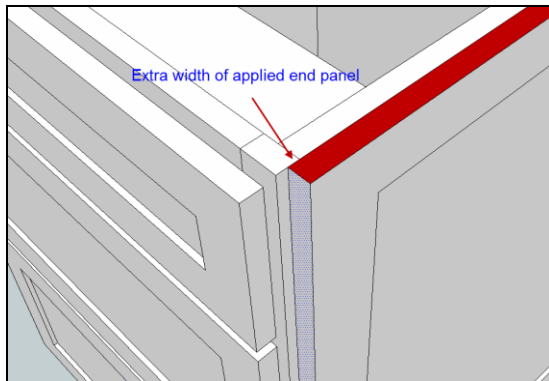

If you enter 0 in this setting, the width of the applied end panel is measured from the back surface of the face frame stile to the back edge of the cabinet. If you enter a dimension that is larger than 0, the width of the applied end panel will increase by the amount entered.

By adjusting this setting in conjunction with the face frame stile scribe settings (refer to Cells N19 and N20), you can create mitered joints, or a variety of revealed edge designs.

EXAMPLE: If you want to miter the front edge of the applied end panel to the face frame stile, and if the thickness of the applied end panel is $\frac{3}{4}$, you would enter $\frac{3}{4}$ in this setting, and also enter $\frac{3}{4}$ for the face frame stile scribe. This will enable you to miter the edge of the applied end panel and the stile at 45 degrees.

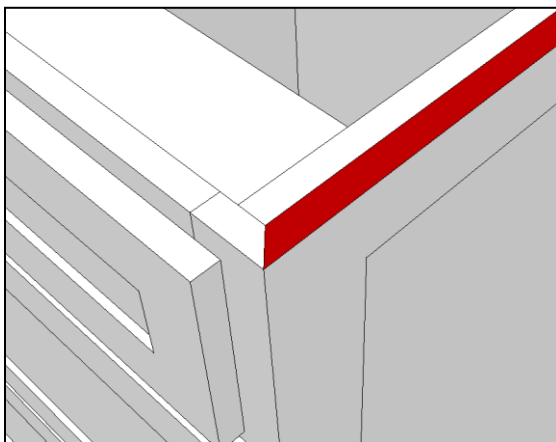

Cabinet**CRUNCHER** Cabinet Design & Cut List Software

Adjust Height of Applied End Panels

- **Cell S79** This setting enables you to increase the height of the LEFT applied end panel relative to the length of the face frame stile.

[illegible]

SET-UP VALUES	
DOORS DRAWER FRONTS	OVERLAY
Left Stile	3/4
Right Stile	3/4
Center Stile/Mullion	1/2
Top Rail	3/4
Bottom Rail	3/4
Center Rail	1/2
Ignore this setting	1/8
Door Gap	1/8
Door Thickness	3/4
APPLIED END PANELS	
Left Width Adjust	0
Left Height Adjust	0
Right Width Adjust	0
Right Height Adjust	0
DRAWER BOXES	
Side Clearance	1/2

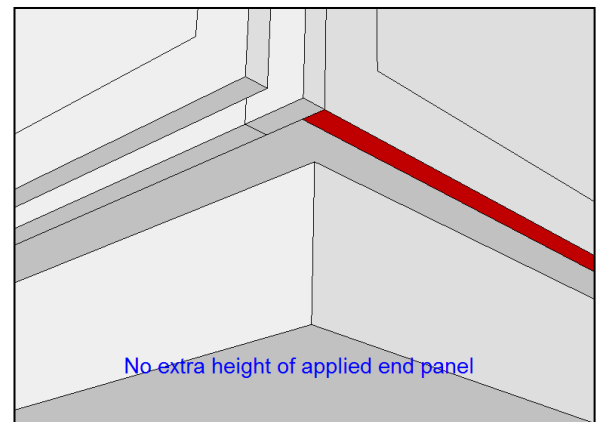
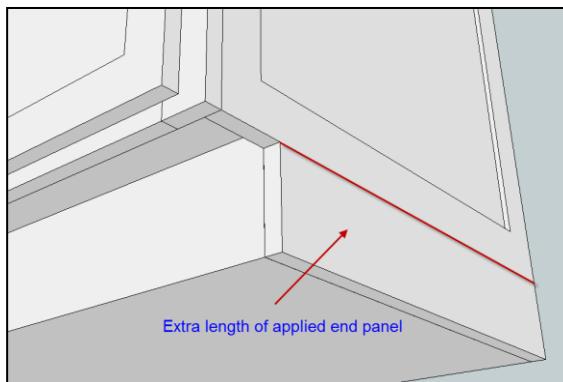

EXAMPLE: If you enter 0, the height of the applied end panel will equal the length of the face frame stile. If you enter a dimension that is larger than 0, the height of the applied end panel will increase by the amount entered. If you enter a negative value, the height of the applied end panel will decrease by the amount entered.

- **Cell S80** This setting enables you to increase the width of the RIGHT applied end panel to accommodate scribes against adjoining walls, or to support a variety of joinery options with the face frame stiles.

Cabinet**CRUNCHER** Cabinet Design & Cut List Software

[illegible]

SET-UP VALUES	
DOORS	
DRAWER FRONTS	OVERLAY
Left Stile	3/4
Right Stile	3/4
Center Stile/Mullion	1/2
Top Rail	3/4
Bottom Rail	3/4
Center Rail	1/2
Ignore this setting	1/8
Door Gap	1/8
Door Thickness	3/4
APPLIED END PANELS	
Left Width Adjust	0
Left Height Adjust	0
Right Width Adjust	0
Right Height Adjust	0
DRAWER BOXES	
Side Clearance	1/2

If you enter 0 in this setting, the width of the applied end panel is measured from the back surface of the face frame stile to the back edge of the cabinet. If you enter a dimension that is larger than 0, the width of the applied end panel will increase by the amount entered.

By adjusting this setting in conjunction with the face frame stile scribe settings (refer to Cells N19 and N20), you can create mitered joints, or a variety of revealed edge designs.

EXAMPLE: If you want to miter the front edge of the applied end panel to the face frame stile, and if the thickness of the applied end panel is 3/4, you would enter 3/4 in this setting, and also enter 3/4 for the face frame stile scribe. This will enable you to miter the edge of the applied end panel and the stile at 45 degrees.

- **Cell S81** This setting enables you to increase the height of the RIGHT applied end panel relative to the length of the face frame stile.

[illegible]

SET-UP VALUES	
DOORS DRAWER FRONTS	OVERLAY
Left Stile	3/4
Right Stile	3/4
Center Stile/Mullion	1/2
Top Rail	3/4
Bottom Rail	3/4
Center Rail	1/2
Ignore this setting	1/8
Door Gap	1/8
Door Thickness	3/4
APPLIED END PANELS	
Left Width Adjust	0
Left Height Adjust	0
Right Width Adjust	0
Right Height Adjust	0
DRAWER BOXES	
Slide Clearance	1/2

EXAMPLE: If you enter 0, the height of the applied end panel will equal the length of the face frame stile. If you enter a dimension that is larger than 0, the height of the applied end panel will increase by the amount entered. If you enter a negative value, the height of the applied end panel will decrease by the amount entered.

CabinetCRUNCHER Cabinet Design & Cut List Software

Drawer Boxes

- **Cell S83** Enter the amount of side clearance that is required for the drawer boxes and/or pullouts. This setting affects the width of the drawer boxes and pullouts in Cells E96-E101.

EXAMPLE: If the width of the cabinet opening is 20 inches, if you enter 1/2 inch, the width of the drawer box will be 19 inches.

SIZE OF CABINET OPENINGS		DEPTH	23
CABINET LOCATION	REF. NO.	WIDTH	HEIGHT
Left - Top	1	22	6
Left - Bottom	2	22	20
Right - Top	3	21 1/2	6
Right - Bottom	4	21 1/2	20

SET-UP VALUES	
DOORS	OVERLAY
Left Stile	3/4
Right Stile	3/4
Center Stile/Mullion	1/2
Top Rail	3/4
Bottom Rail	3/4
Center Rail	1/2
Ignore this setting	1/8
Door Gap	1/8
Door Thickness	3/4
APPLIED END PANELS	
Left Width Adjust	0
Left Height Adjust	0
Right Width Adjust	0
Right Height Adjust	0
DRAWER BOXES	
Side Clearance	1/2

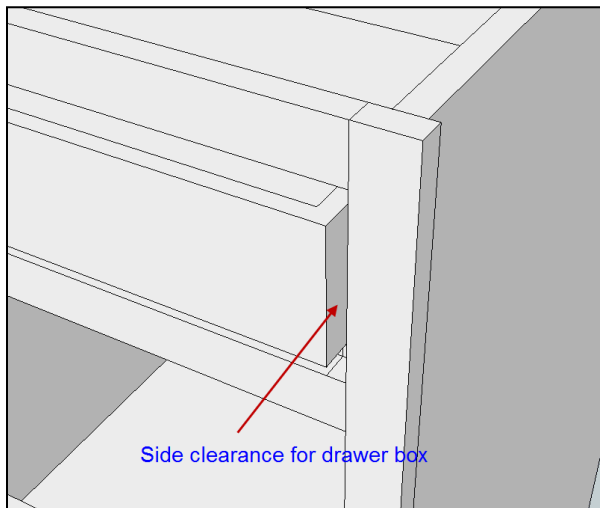

Multiple Drawer Fronts in a Single Cabinet Opening

- Cell C85** If you need to install multiple drawer fronts in a single cabinet opening, use the spaces below to manually list the requirements.

[illegible]

EXAMPLE: If you have a single cabinet opening and you want to install several drawers into this opening, then you will manually list the width, height and quantity of each drawer front.

NOTE: The cutlist will not include center rails between these drawer fronts.

CAUTION: These are manual calculations. Be careful to make sure the width is compatible with the cabinet opening size, and your overlay/inset requirements.

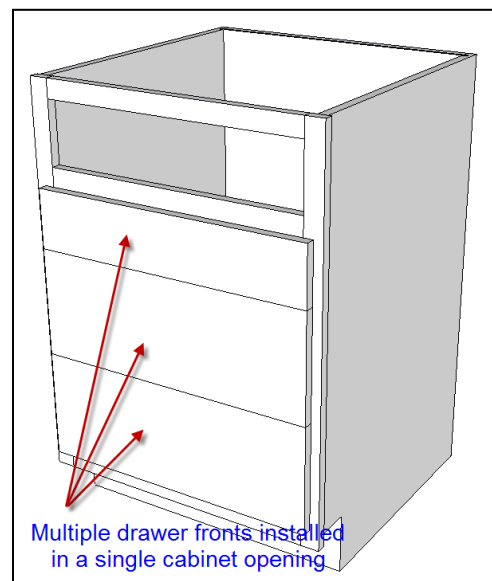
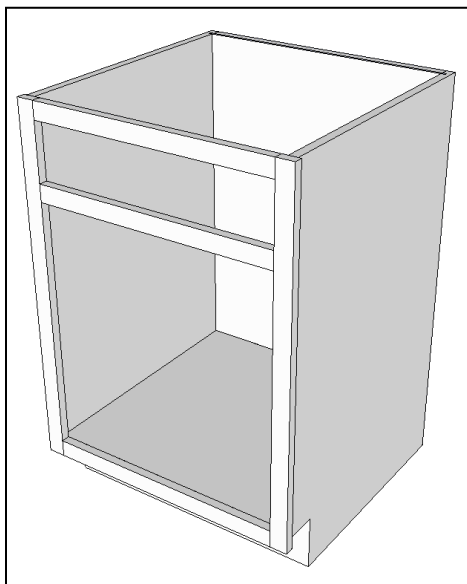

CabinetCRUNCHER Cabinet Design & Cut List Software

- Cell E85 The "Ref No." identifies the cabinet location to install the multiple drawer fronts. Refer to Cells M68-M83 and use the "Ref No." that corresponds to the desired cabinet opening location.

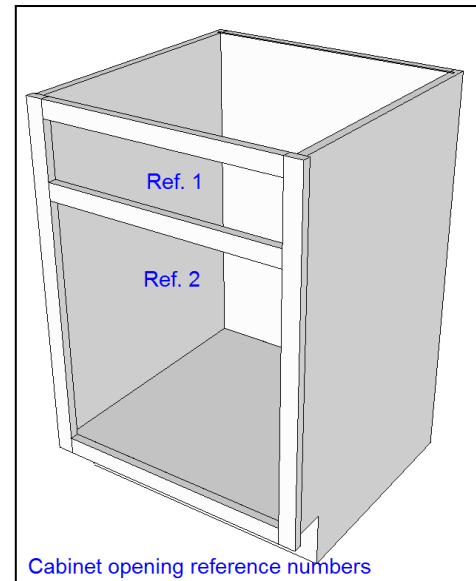
[illegible]

- **Cell F85** If you need to install multiple drawers in a single cabinet opening, enter the width of the drawer fronts.

[illegible]

CAUTION: These are manual calculations. Be careful to make sure the width is compatible with the cabinet opening size, and your overlay/inset requirements.

Cabinet**CRUNCHER** Cabinet Design & Cut List Software

- **Cell G85** If you need to install multiple drawers in a single cabinet opening, enter the height of the drawer fronts.

[illegible]

CAUTION: These are manual calculations. Be careful to make sure the heights and quantities, overlays, and gap spacing between the drawer fronts will fit the cabinet opening.

- Cell H85** If multiple drawer fronts will be installed in a single cabinet opening, enter the quantity of drawer fronts that will be installed.

[illegible]

CAUTION: Make sure that the total quantity and height of the drawer fronts do not exceed the height of the cabinet opening.

CabinetCRUNCHER Cabinet Design & Cut List Software

Drawer Boxes & Roll-Out Trays

- **Cell C95** For each of the cabinet openings, use the drop-down menu to choose either "Drawer Box" or "Roll-Out Tray", or you can enter your own description.

DRAWER BOXES & ROLL-OUT TRAYS							CLEAR
	TYPE	REF. NO	WIDTH	DEPTH	HEIGHT	QTY	
BC30-24	Drawer Box	1	21	22	4	1	1
							0
							0
							0
							0
							0

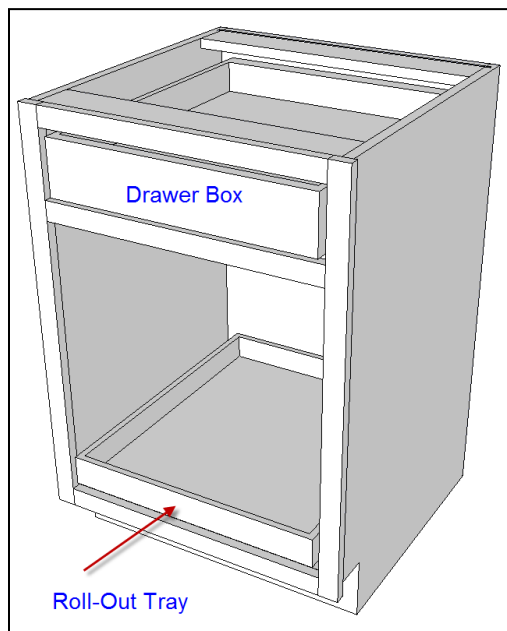

- **Cell D95** The "Ref No." identifies the location to install the drawer boxes/roll-out trays. Refer to Cell M68-M83 and use the "Ref No." that corresponds to the desired cabinet opening location.

DRAWER BOXES & ROLL-OUT TRAYS							CLEAR
	TYPE	REF. NO	WIDTH	DEPTH	HEIGHT	QTY	
BC30-24	Drawer Box	1	21	22	4	1	1
							0
							0
							0
							0
							0

Cabinet**CRUNCHER** Cabinet Design & Cut List Software

- **Cell E95** The width of the drawer boxes/roll-out trays are calculated automatically. The calculation is based on the width of the face frame opening minus the Drawer Box "Side Clearance" setting in Cell S83.

DRAWER BOXES & ROLL-OUT TRAYS							CLEAR
	TYPE	REF. NO	WIDTH	DEPTH	HEIGHT	QTY	
BC30-24	Drawer Box	1	21	22	4	1	1
							0
							0
							0
							0
							0



- **Cell F95** Enter the desired depth of the drawer box or roll-out tray. The depth cannot exceed the maximum depth of the cabinet opening in Cell O66.

DRAWER BOXES & ROLL-OUT TRAYS							CLEAR
	TYPE	REF. NO	WIDTH	DEPTH	HEIGHT	QTY	
BC30-24	Drawer Box	1	21	22	4	1	1
							0
							0
							0
							0
							0



If you are installing "overlay" drawer fronts, the maximum depth of the cabinet opening is measured from the inside surface of the back panel to the OUTSIDE surface of the face frame.

If you are installing "inset" drawer fronts, the maximum depth of the cabinet opening is measured from the inside surface of the back panel to the INSIDE surface of the face frame.

- **Cell G95** Enter the desired height of the drawer boxes or roll-out trays.

DRAWER BOXES & ROLL-OUT TRAYS							CLEAR
	TYPE	REF. NO	WIDTH	DEPTH	HEIGHT	QTY	
BC30-24	Drawer Box	1	21	22	4	1	1
							0
							0
							0
							0
							0



Make sure that the total quantity and height of all drawer boxes and roll-out trays that are installed in a single cabinet opening do not exceed the height of the cabinet opening.

EXAMPLE: If the height of the cabinet opening is 10 inches, and you try to install 2 drawer boxes that are 6 inches high, the boxes will not fit into the cabinet opening.

CabinetCRUNCHER Cabinet Design & Cut List Software

- **Cell H95** Enter the quantity of drawer boxes or roll-out trays that will be installed in the cabinet opening.

DRAWER BOXES & ROLL-OUT TRAYS						CLEAR
	TYPE	REF. NO	WIDTH	DEPTH	HEIGHT	QTY
BC30-24	Drawer Box	1	21	22	4	1
						0
						0
						0
						0
						0

Make sure that the total quantity and height of all drawer boxes and pullouts that are installed in a single cabinet opening does not exceed the height of the cabinet opening.

EXAMPLE: If the height of the cabinet opening is 10 inches, and you try to install 2 drawer boxes that are 6 inches high, the boxes will not fit into the cabinet opening.

List of Materials

CabinetCRUNCHER will automatically calculate the total quantity of all materials used on the cutlist.

- **Cell E104** Board Foot Calculation:

MATERIALS				MASTER LIST		
THICK (WIDTH)	MATERIAL	TYPE	BOARD FEET	SHEETS	LINEAL FEET	COST
3/4	Cherry	Solid	2.6			\$20.53
3/4	Birch Ply	Sheet		1.2		\$75.82
1/4	Birch Ply	Sheet		0.3		\$9.51
OTHER ITEMS/MATERIALS				QTY	UNIT COST	
						\$0.00
						\$0.00
						\$0.00

For any material that is less than 1 inch thick, the board foot calculation automatically rounds the material up to 1 inch thick. For example, if your face frame uses 3/4 thick material, the board foot calculation will round up to 1 inch (equivalent to 4/4 stock).

For any material that is greater than 1 inch thick, the board foot calculation will round that particular material up to the next higher 1/4 thickness. For example, if you are using 1 inch material, the board foot calculation will round up to 1 1/4 (equivalent to 5/4 stock).

- **Cell H104 - Available in Professional Version Only:** The cost for all materials on this cutlist is based on your settings on the Materials Set-Up List.

Cabinet**CRUNCHER** Cabinet Design & Cut List Software

MATERIALS				MASTER LIST		
THICK (WIDTH)	MATERIAL	TYPE	BOARD FEET	SHEETS	LINEAL FEET	COST
3/4	Cherry	Solid	2.6			\$20.53
3/4	Birch Ply	Sheet		1.2		\$75.82
1/4	Birch Ply	Sheet		0.3		\$9.51
OTHER ITEMS/MATERIALS				QTY	UNIT COST	
						\$0.00
						\$0.00
						\$0.00

IMPORTANT: Make sure all materials listed in this section are included on the Master Materials List. If the material and thickness combination, and its associated cost is not included on the Master Materials List, the material cost will not be calculated. To add materials on the Master Materials List, click the "**MASTER LIST**" button.

EXAMPLE: If the cutlist includes 3/4 inch thick Birch plywood, but you did not add the 3/4 inch thick Birch plywood with its price on the Master Materials List, then the cost shown on the cutlist will be \$0.00.

- **Cell B113** If desired, use the space below to manually add additional materials.

MATERIALS				MASTER LIST		
THICK (WIDTH)	MATERIAL	TYPE	BOARD FEET	SHEETS	LINEAL FEET	COST
3/4	Cherry	Solid	2.6			\$20.53
3/4	Birch Ply	Sheet		1.2		\$75.82
1/4	Birch Ply	Sheet		0.3		\$9.51
OTHER ITEMS/MATERIALS				QTY	UNIT COST	
						\$0.00
						\$0.00
						\$0.00

Link to the Master Materials List

- Click "**MASTER LIST**" to go to the "**Master Materials List**". This will enable you to update your material prices, or add additional materials whenever needed.

Cabinet**CRUNCHER** Cabinet Design & Cut List Software

MATERIALS				MASTER LIST		
THICK (WIDTH)	MATERIAL	TYPE	BOARD FEET	SHEETS	LINEAL FEET	COST
3/4	Cherry	Solid	1.5			\$11.91
3/4	Birch Ply	Sheet		0.7		\$46.05
1/4	Birch Ply	Sheet		0.2		\$5.83
OTHER ITEMS/MATERIALS				QTY	UNIT COST	
						\$0.00
						\$0.00
						\$0.00

CabinetCRUNCHER Cabinet Design & Cut List Software

Hardware

- **Cell B119** Use the drop-down list to select hardware items from your MASTER HARDWARE LIST.

HARDWARE	MASTER LIST		CLEAR
ITEM	QTY	TOTAL	COST
Modul 100 Degree Hinge Full Overlay / Self-Closing	4	4	\$9.76
Tandem 562H - Full Ext 22" w/ Locking Device + Blumotion	2	2	\$30.30

IMPORTANT: Make sure all hardware listed in this section are included on the "**Master Hardware List**". If the hardware item and its associated cost is not included on the master list, the hardware cost for that item will not be calculated. To add hardware on the Master Hardware List, click the "**MASTER LIST**" button.

- **Cell F119** Enter the total quantity of hardware items that are required for this cabinet.
- **Cell G119** This is the total quantity based on the quantity selected in Column F multiplied by the quantity of cabinets in Cell K8.

HARDWARE	MASTER LIST		CLEAR
ITEM	QTY	TOTAL	COST
Modul 100 Degree Hinge Full Overlay / Self-Closing	4	4	\$9.76
Tandem 562H - Full Ext 22" w/ Locking Device + Blumotion	2	2	\$30.30

- **Cell H119 - Available in Professional Version Only:** The cost for all hardware items on this cutlist is based on your settings on the Master Hardware List.

HARDWARE	MASTER LIST		CLEAR
ITEM	QTY	TOTAL	COST
Modul 100 Degree Hinge Full Overlay / Self-Closing	4	4	\$9.76
Tandem 562H - Full Ext 22" w/ Locking Device + Blumotion	2	2	\$30.30

IMPORTANT: Make sure all hardware listed in this section are included on the Master Hardware List. If the hardware item and its associated cost is not included on the master list, the hardware cost will not be calculated. To add hardware on the Master Hardware List, click the "**MASTER LIST**" button.

Cabinet**CRUNCHER** Cabinet Design & Cut List Software

EXAMPLE: If the cutlist includes a drawer slide but you did not add the drawer slide and its price on the HARDWARE MASTER LIST, then the cost shown on the cutlist will be \$0.00.

Link to the Master Hardware List

- Click "**MASTER LIST**" to go to the "**Master Hardware List**". This will enable you to update your hardware prices, or add additional hardware items whenever needed.

HARDWARE		MASTER LIST		CLEAR
ITEM		QTY	TOTAL	COST



Clearing (Reset) Your Data

- [illegible]

- [illegible]

- Click the **"CLEAR"** button to remove your selections in the "Hardware" section. This will remove all the data you entered in the YELLOW cells.