

# Kargo King

## Operation and Maintenance

### Manual:

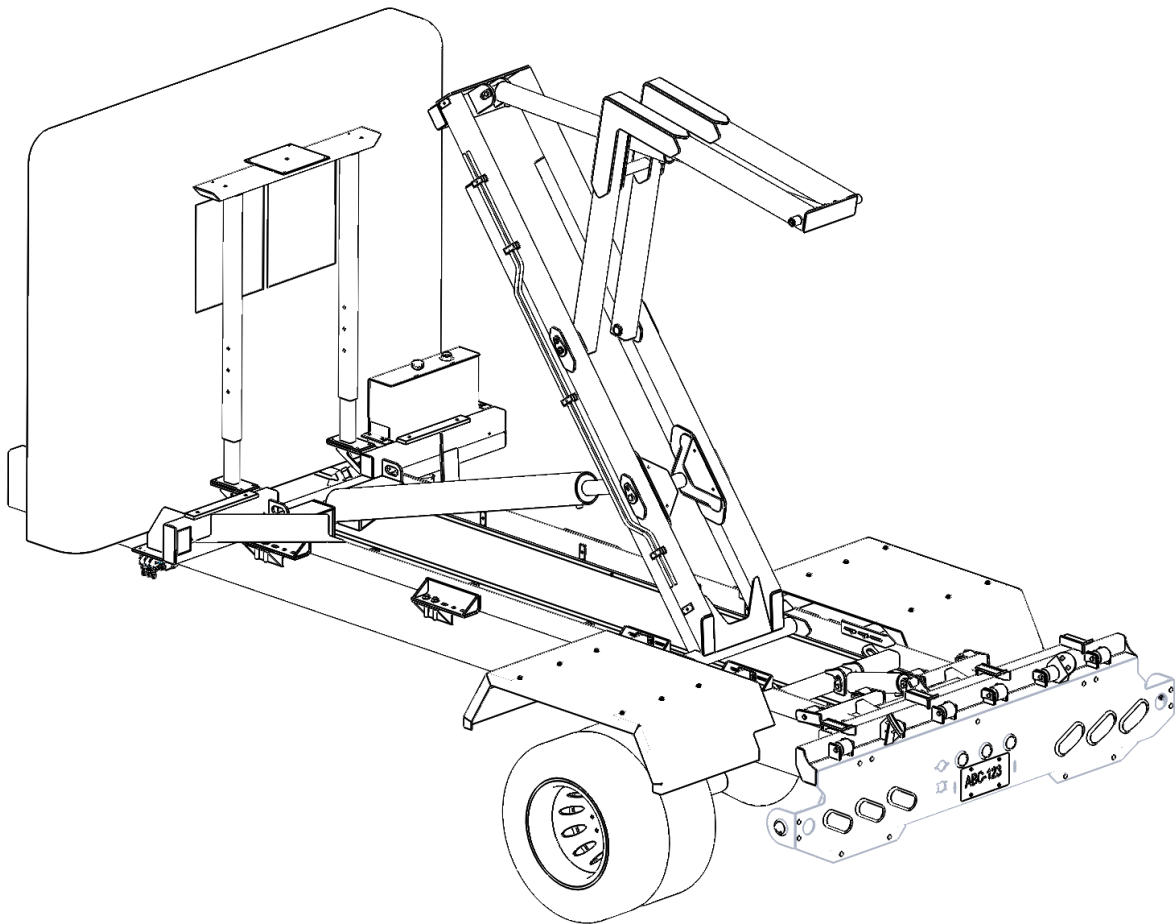

# **SAFETY**

## **PRE-OPERATION**

1. The operator must demonstrate the ability to understand all decals, Operation-Maintenance manual and any other information required for safe operation of the KK system prior to the operation. **FAILURE TO READ THIS MANUAL PRIOR TO THE OPERATION OF THIS EQUIPMENT IS CONSIDERED MIS USE OF THE KK SYSTEM AND MAY RESULT IN DEATH OR SERIOUS INJURY OR MAY CAUSE DAMAGE TO THE PRODUCT.**
2. The Kargo King system must be used with kk detachable bodies that properly fit the hook and rear lock tabs. The detachable body specifications must match the kk system specifications.
3. The KK system and detachable kk bodies should be kept in good working conditions. **DO NOT** use if repairs are needed. It is the user's responsibility to perform periodic inspections and maintenance as required by the maintenance section of this manual.

## **OPERATION**

1. **DO NOT** operate the Kargo King system on uneven ground.
2. Keep away from operating the Kargo King system near overhead power lines and utility poles. Serious injury or death can result from contact with electrical lines.
3. Make sure work area is clear of people and obstacles prior to the loading/unloading operation of the Kargo king system.
4. The operation of loading requires the truck to back up towards the kk detachable body in order to pick it up. Hence, there is a pinch point between the jib arm and the body.
5. Back up alarm is strongly recommended to be installed on the truck chassis.
6. **NEVER** exceed the KK system's loading capacity ratings.
7. Payload capacity of the truck can be reduced if majority of the weight is located close towards the truck cab. **OVERLOADING THE KARGO KING SYSTEM MAY RESULT IN SERIOUS DAMAGE OF THE USER, OTHERS AND EQUIPMENT.**
8. **DO NOT** drive until the KK detachable bodies are properly locked on the system sub frame.
9. **DO NOT** exceed to the ideal Engine RPM when operating the Power Take Off (P.T.O.). Never leave the P.T.O. engaged while driving truck.

1. The Kargo King detachable bodies **MUST** be safely unloaded on the ground and disconnected from the KK system prior to performing any repairs or maintenance to the kk system.
2. **DO NOT** perform any inspection, maintenance or repair on the kk system when in a raised position without first installing certified safety Prop Rods or connecting to an overhead crane to eliminate all possibility of the system accidentally lowering.
3. Avoid contact with high-pressure fluids. Hydraulic Fluids under high pressure can penetrate the skin causing severe injury.
4. User must Relieve pressure before disconnecting hydraulic or other lines. Tighten all connections before reapplying pressure.
5. **NEVER** modify, alter or repair any of the Kargo king system (mechanical, electrical, or hydraulic) without obtaining written Authorization from the Product manufacturer.
6. Tampering with the hydraulic relief system is **PROHIBITED. SUCH ACTION MAY RESULT IN SERIOUS DAMANGE OF SELF, OTHERS, EQUIPMENT OR THE SURROUNDINGS.** Warranty is voided when the seal of hydraulic relief system is broken.
7. It is the responsibility of the owner or user to provide proper maintenance of the safety decals. Replace the safety decals when any fading or damage occurs.

# OPERATION

## 1) Inspect the site of operation



When arriving at the job site, ensure the vehicle is parked on level ground.

## 2) Get Ready (if equipped with light bar- Turn on Emergency lights)



Illuminate Emergency Lighting

3) Initial Preparation:

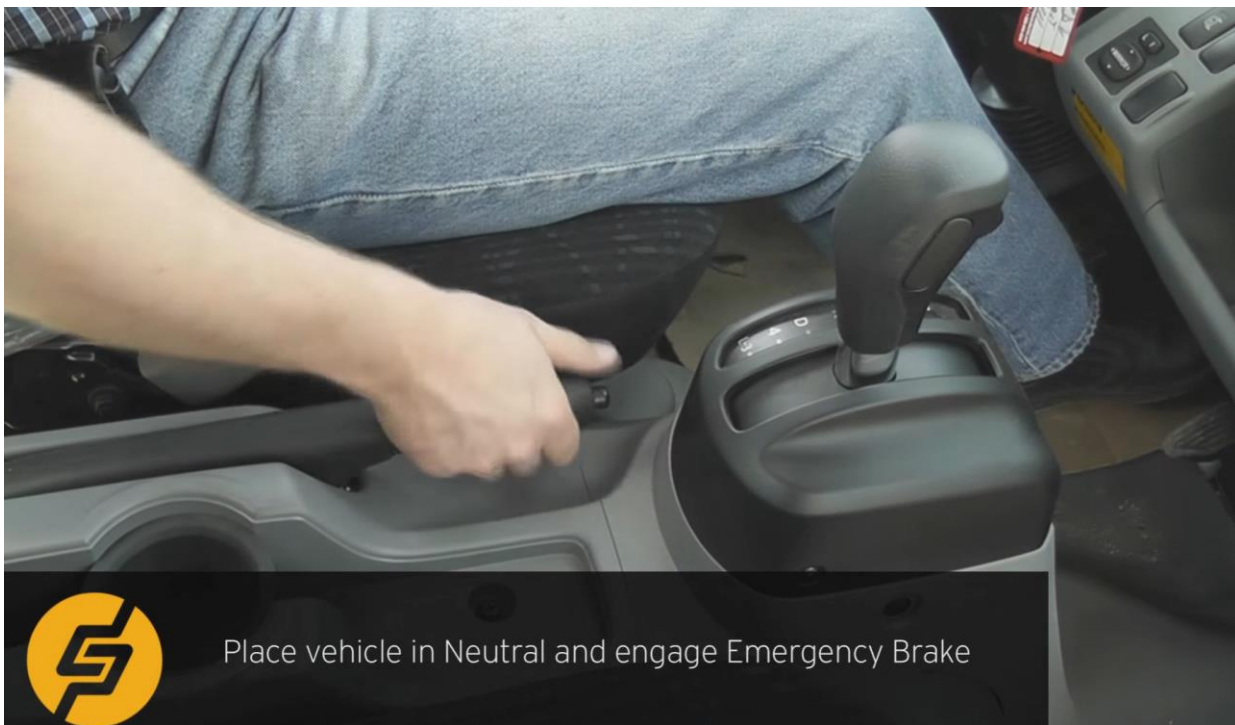

4) Engage PTO :



5) Cruise Control

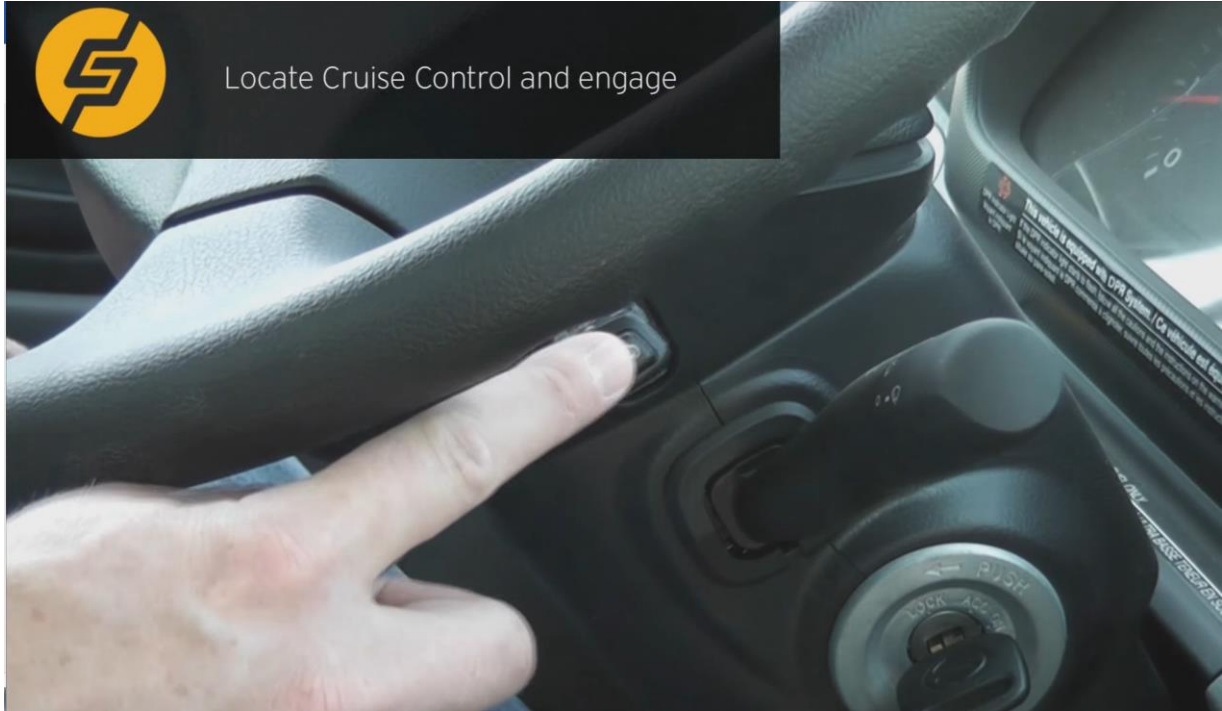

6) Set RPM

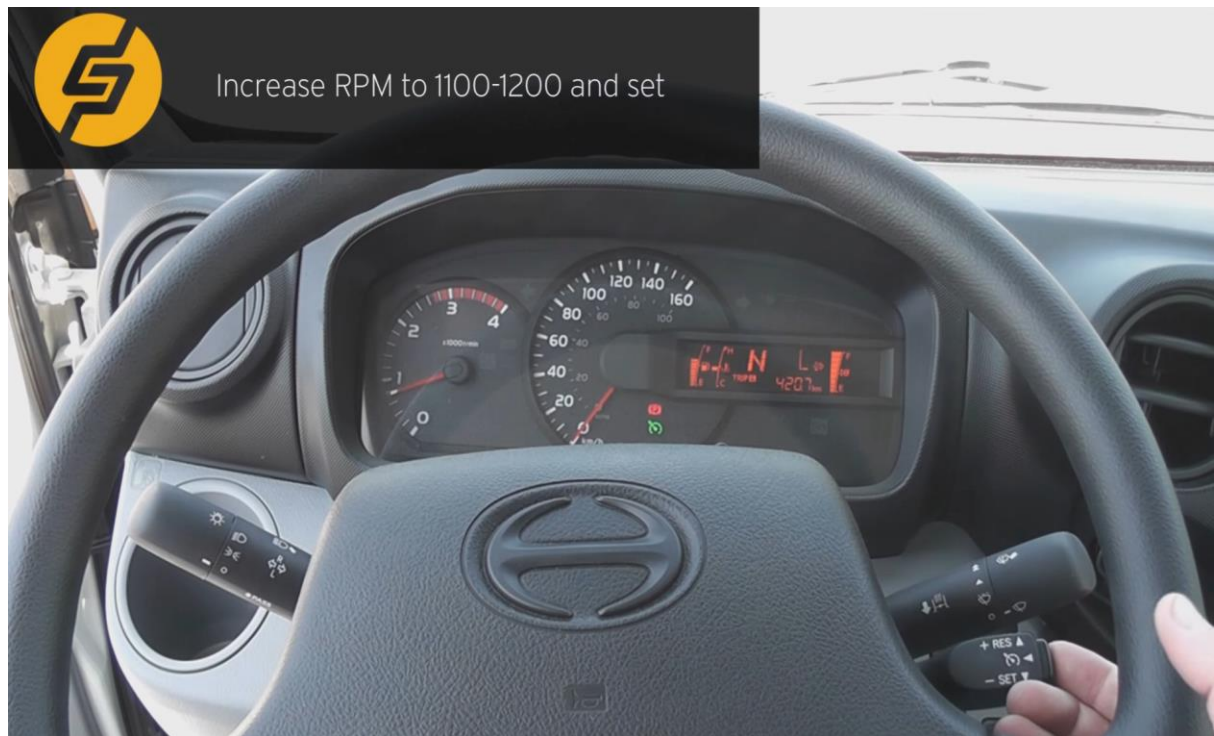

7) Extend the Jib Arm only 2/3<sup>rd</sup> of the Stroke



To clear the back of truck-subframe all the time without retracting Jib Cylinder, extend up to 2/3<sup>rd</sup> only (Do not Go to full extension)



8) Main lift Cylinder



9) If you fully extend "JIB" cylinder at step 7 :



Please note that on the longer system such as 14' and 18' Jib always have to be retracted.

10) Almost Finish

Aware of your surroundings



**This helps to take the pins out from the deck.**

11) Take the Pins out.

Protect your hand from pinch points or sharp edges while removing the pins.

Make sure you put the pins back in deck hook or keep them to secure location for future operation.

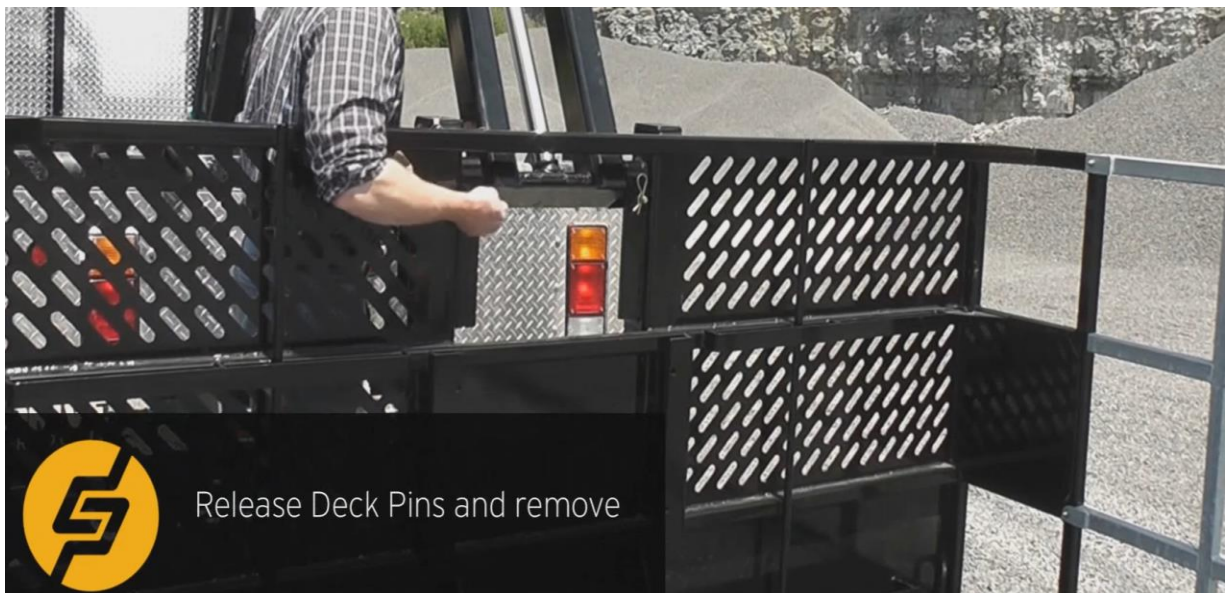

12) Extend the Jib cylinder to un-hook the Jib from Deck



13) Drive Forward

- Retract the system to its original position



14) Reverse this procedure to load the deck back on Chassis

## Operating Procedure for Dock Leveler:

- 1) Extend the Jib first for at least 8 to 10" to Unlock the Subframe Rear tabs

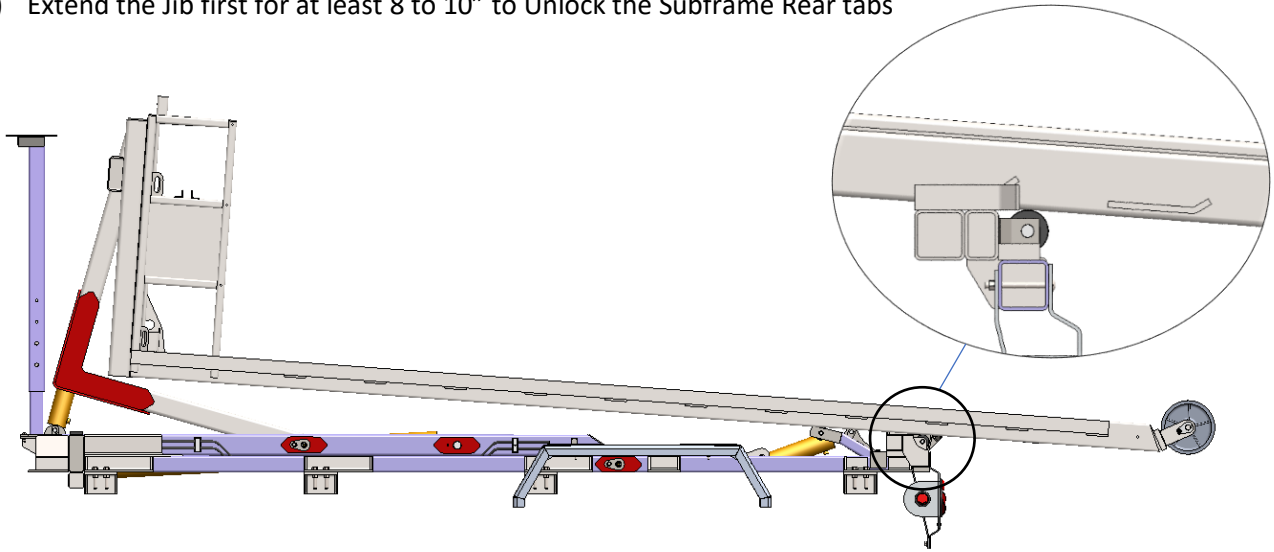

- 2) Operate the Dock Leveler Cylinder to lift the Deck:

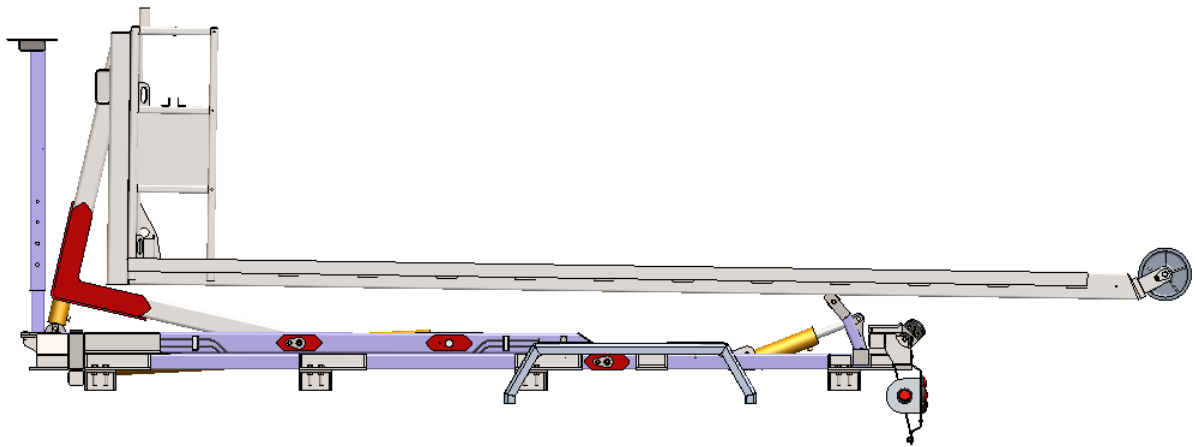

- 3) Reverse this procedure to bring the deck down.

# MAINTENANCE

## GREASE POINT LOCATION:

**GREASE DAILY**

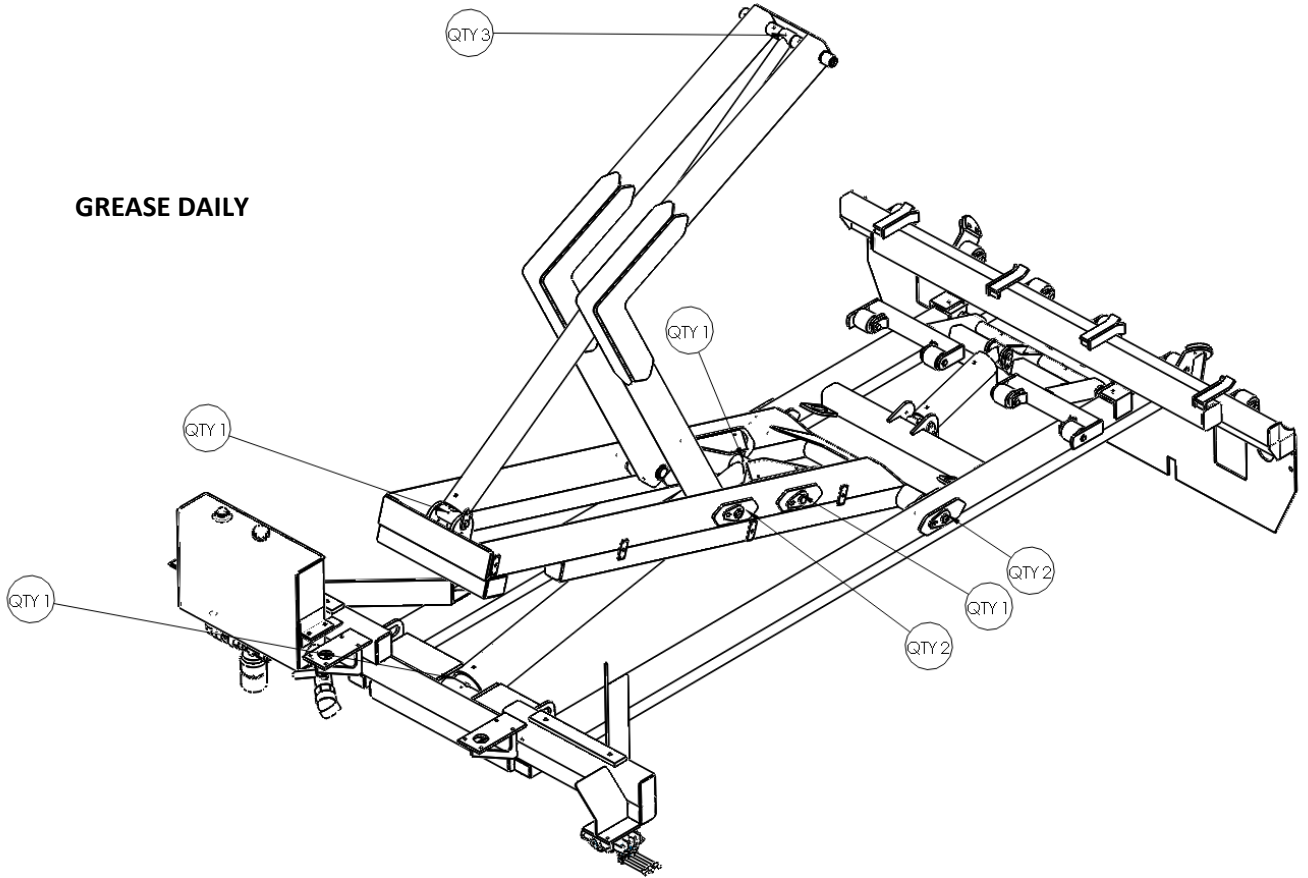

**GREASE WEEKLY  
(IF ORDERED)**

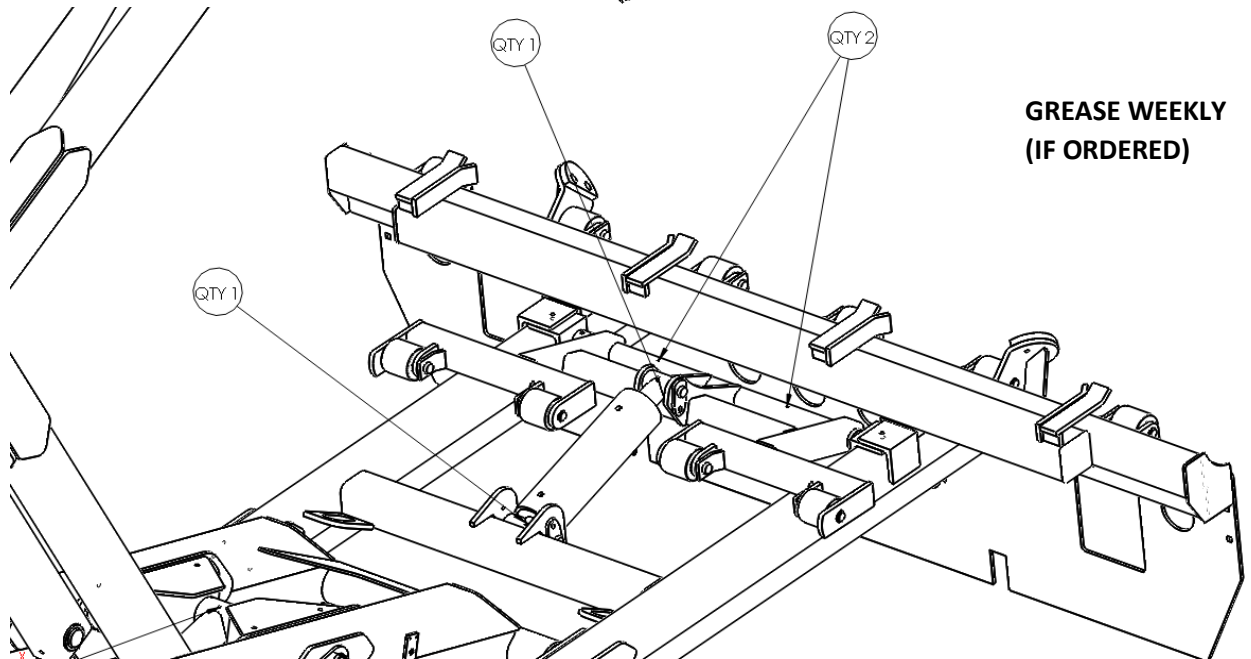



## HYDRAULIC OIL:

It is highly recommended that you change the hydraulic oil every **4 months**.

Recommended Hydraulic oil = **AW32**

## HYDRAULIC FILTER SPECS:

It is highly recommended that you change the hydraulic filter every **4 months**.

Recommended Filter Specs' = **10 micron**



Note: This manual is subjected to change without any notification.

**PROPRIETARY AND CONFIDENTIAL:**

**THE INFORMATION CONTAINED IN THIS DOCUMENT/DRAWING IS THE SOLE PROPERTY OF DRIVE PRODUCTS INC. ANY REPRODUCTION IN PART OR AS A WHOLE WITHOUT THE WRITTEN PERMISSION OF DRIVE PRODUCTS INC IS STRICKLY PROHIBITED.**

Call our Customer service at 1-800-668-6012 for any inquires.

Drive Products  
1665 Shawson Dr  
Mississauga, Ontario  
Canada. L4W 1T7  
<http://www.driveproducts.com/>