

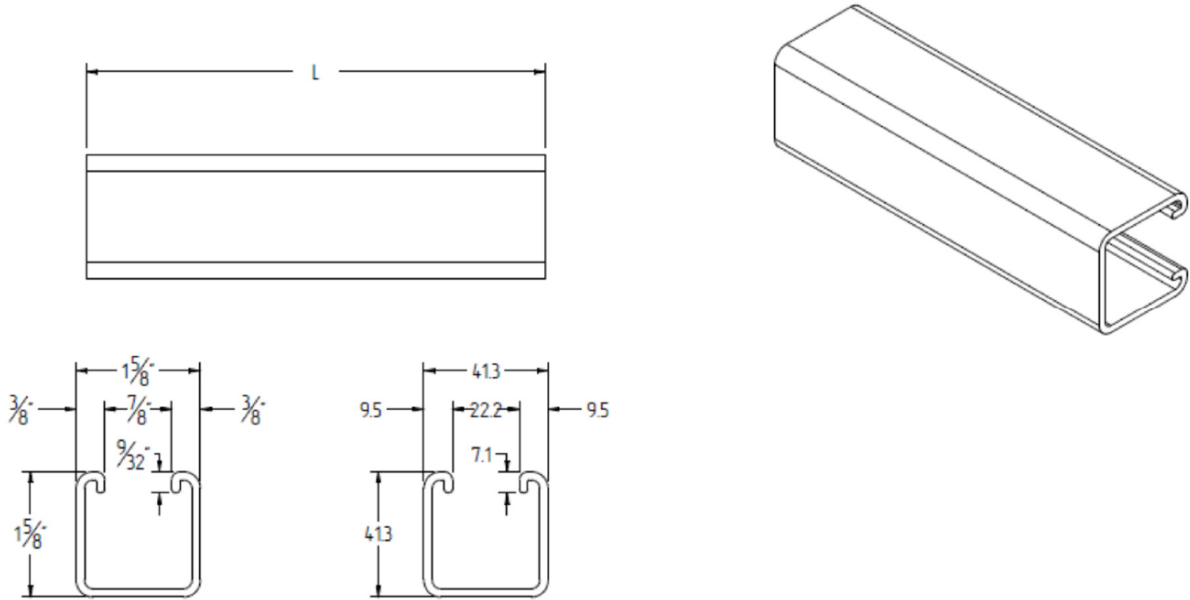

LVM

STRUT

S100 1-5/8" x 1-5/8" (12 ga or 14 ga)



S100 RH 1-5/8" x 1-5/8" (12 ga or 14 ga)

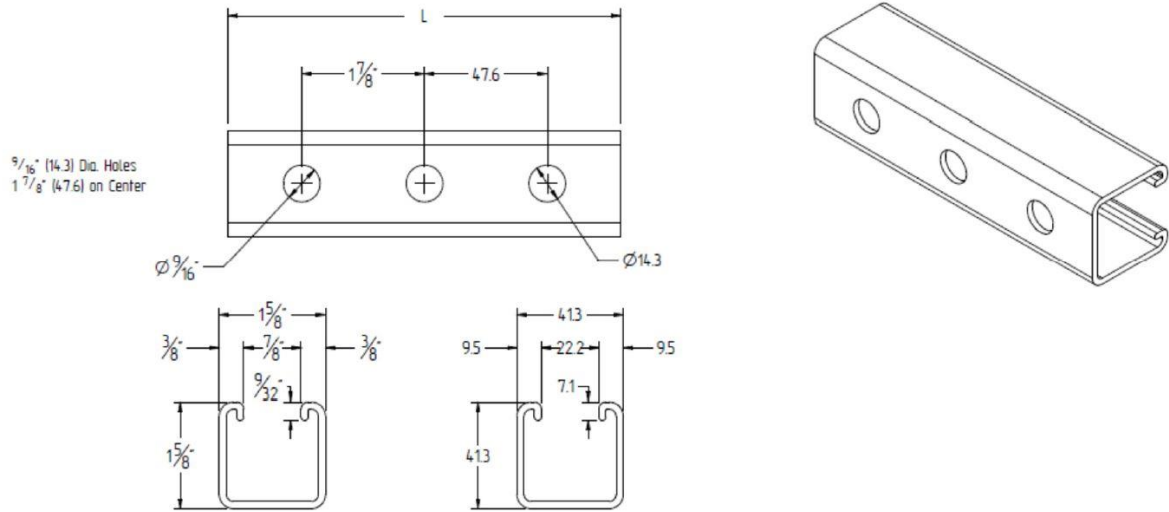

S100 SH 1-5/8" x 1-5/8" (12 ga or 14 ga)

Slots are
1 1/8" (28.6) x 9/16" (14.3)
2" (50.8) on Center

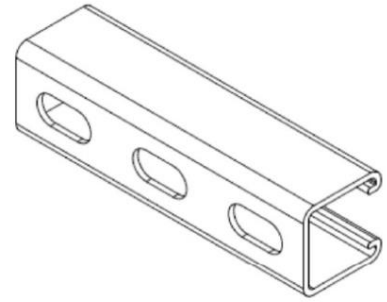
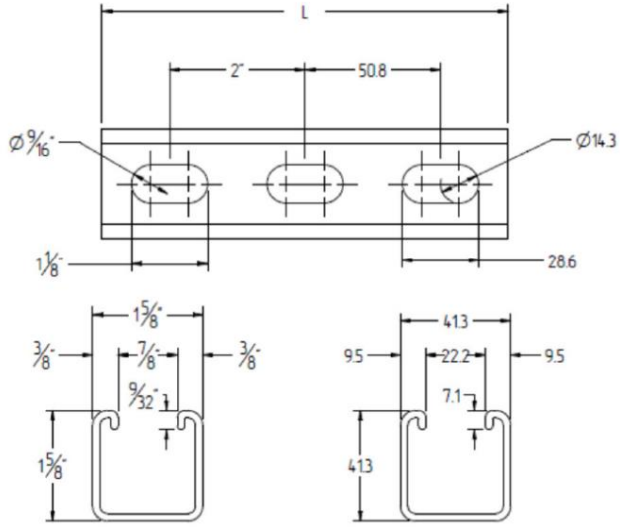

Back-to-Back Strut Options

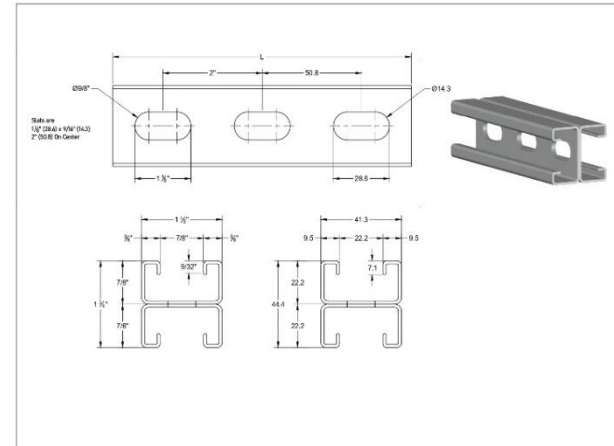
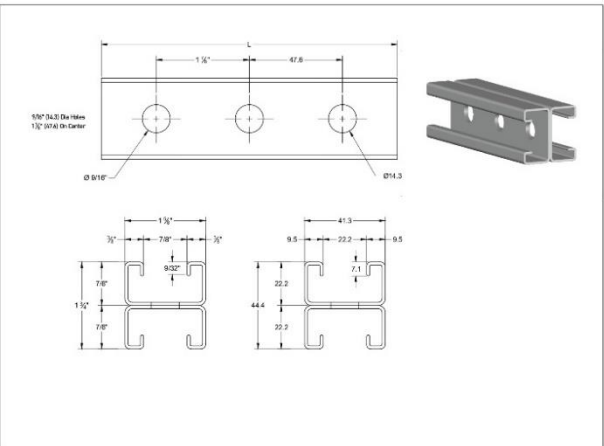
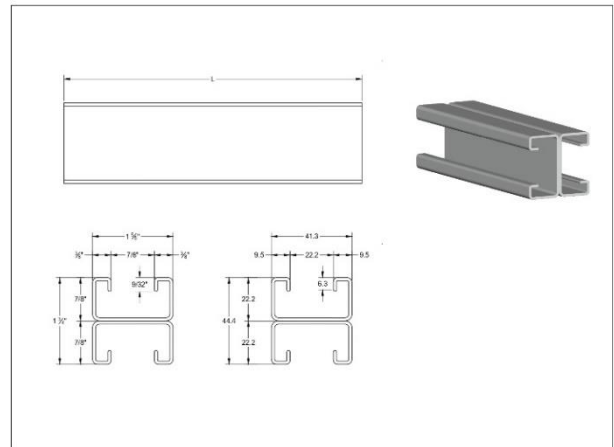
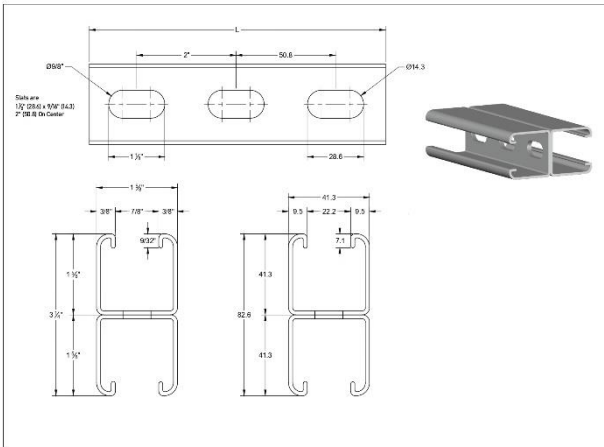
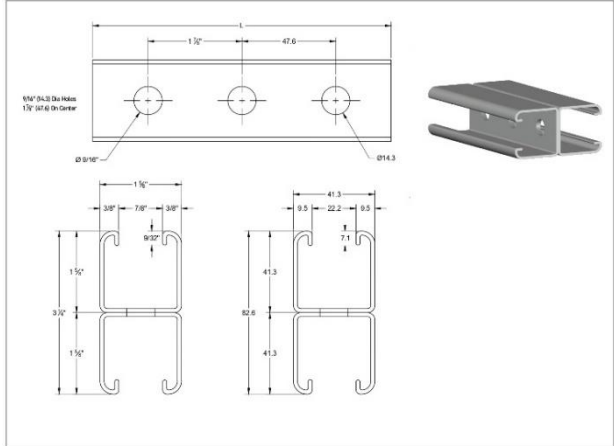
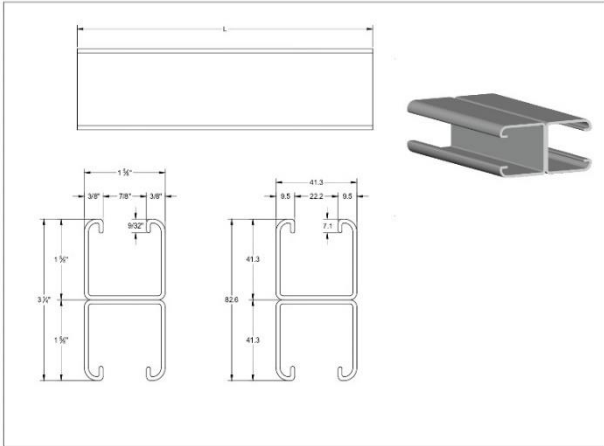

S200 1-5/8" x 7/8" (12 ga or 14 ga)

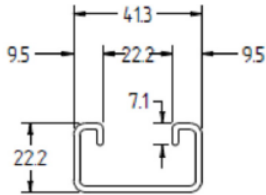
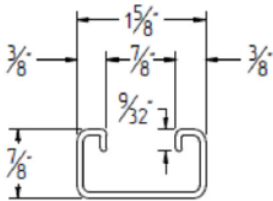
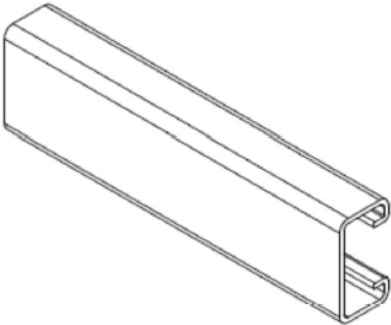
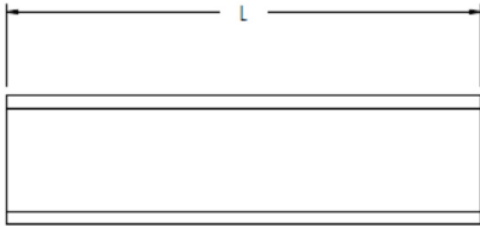

S200 RH 1-5/8" x 7/8" (12 ga or 14 ga)

9/16" (14.3) Dia. Holes
1 7/8" (47.6) on Center

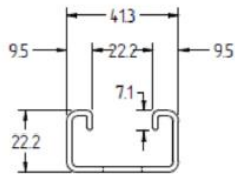
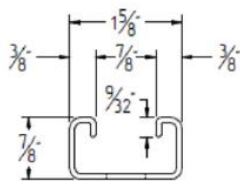
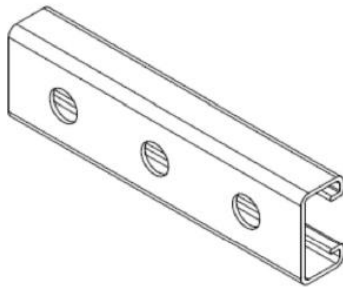
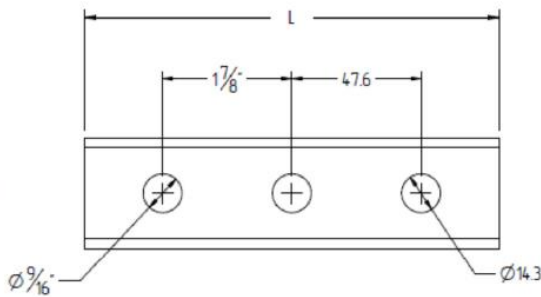

S200 SH 1-5/8" x 7/8" (12 ga or 14 ga)

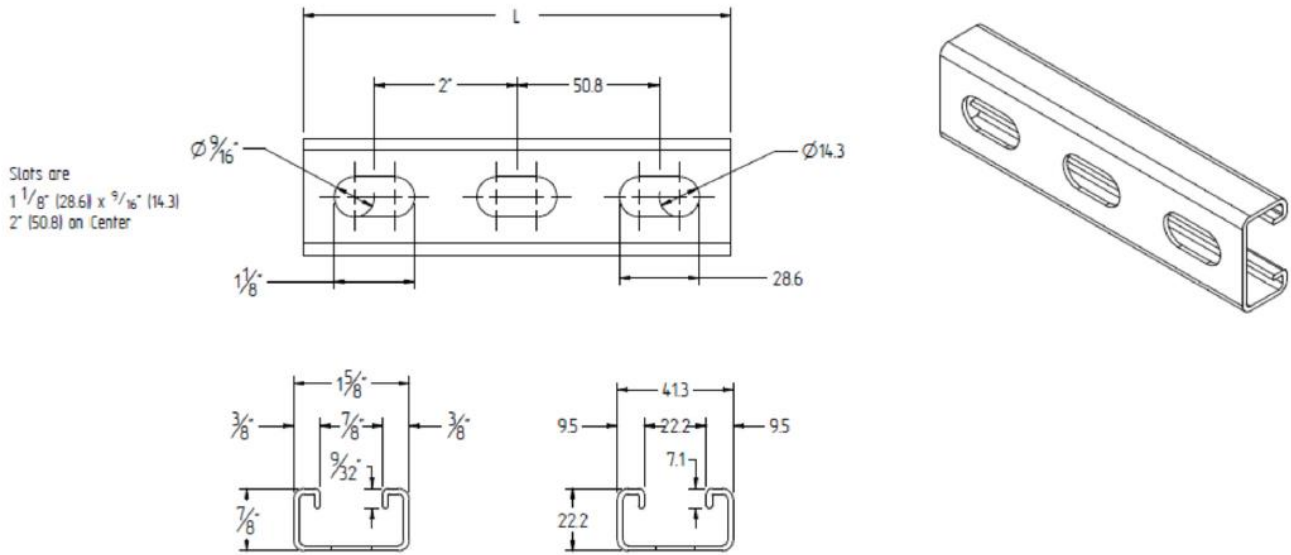

NOTES:

GENERAL:

1. Steel: ASTM A653 Grade 33 or better.
2. 12 gage 0.103" thickness; 14 gage = 0.0689" thickness.
3. Load capacity calculated in accordance with AISI S100-16 w/S1.
4. Warning: Load tables, charts and design criteria are intended as guides only. Selection of proper product, installation intervals, erection and placement are the responsibility of the user.

COLUMN LOADS:

1. Column loads are for allowable axial loads for the unsupported heights listed (including a K value of 1.00).
2. Column loads must be reduced for eccentric loading.
3. Column loads highlighted in **Blue** indicate a column slenderness, KL/r , in excess of 200, and the use of these lengths is not recommended.

BEAM LOADS:

1. Loads listed are distributed uniformly. For loads concentrated at center of span, multiply uniform load by 0.5 and deflection by 0.8.
2. Where deflection is not a factor, use the allowable beam load. When deflection is a factor, use deflection of 1/240 span.
3. Beam deflection loads highlighted in **Yellow** indicate that the deflection load is in excess of the allowable strength.
4. For perforated channels, multiply beam load values as follows:
 - a. 9/16" x 1-1/8" slot at 2" on center (SH) - multiply by 0.84
 - b. 9/16" round holes at 1-7/8" on center (RH) - multiply by 0.89

S100 1-5/8" x 1-5/8" (12 ga)

Section Properties								
Section	Wt. #/ft	Area (in ²)	I _x (in ⁴)	S _x (in ³)	r _x (in)	I _y (in ⁴)	S _y (in ³)	r _y (in)
12ga	1.827	0.537	0.178	0.193	0.574	0.229	0.281	0.652

Beam Span or Column Height (inches)	Maximum Allowable Column Load (Lbs)	Maximum Allowable Uniform Beam Load (Lbs / ft)	Total Allowable Uniform Beam Load (Lbs)	Uniform Load at L/240 Span Deflection (lbs/ft)	Total Uniform Load at L/240 Span Deflection (lbs)
12	10377	3469	3469	11669	11669
18	9202	1398	2096	3457	5186
24	7985	706	1411	1459	2917
30	6870	533	1333	747	1867
36	5910	355	1065	432	1297
42	5102	251	877	272	953
48	4416	185	739	182	729
54	3858	141	634	128	576
60	3430	110	552	93	467
66	3088	88	487	70	386
72	2804	72	433	54	324
84	2355	50	352	34	238
96	2009	37	293	23	182
108	1732	28	248	16	144
120	1506	21	213	12	117
132	1317	17	185	9	96
144	1160	13	161	7	81
156	1027	11	142	5	69
168	889	9	126	4	60
180	774	8	113	3	52
192	681	6	101	3	46
204	603	5	92	2	40
216	538	5	83	2	36
228	483	4	76	2	32
240	436	3	70	1	29

S100 1-5/8" x 1-5/8" (14 ga)

Section Properties								
Section	Wt. #/ft	Area (in ²)	I _x (in ⁴)	S _x (in ³)	r _x (in)	I _y (in ⁴)	S _y (in ³)	r _y (in)
14 ga	1.280	0.376	0.132	0.147	0.593	0.166	0.204	0.663

Beam Span or Column Height (inches)	Maximum Allowable Column Load (Lbs)	Maximum Allowable Uniform Beam Load (Lbs / ft)	Total Allowable Uniform Beam Load (Lbs)	Uniform Load at L/240 Span Deflection (lbs/ft)	Total Uniform Load at L/240 Span Deflection (lbs)
12	7086	2578	2578	8653	8653
18	6297	1030	1545	2564	3846
24	5398	653	1306	1082	2163
30	4503	394	985	554	1385
36	3686	255	766	320	961
42	2978	174	608	202	706
48	2430	122	489	135	541
54	2050	88	397	95	427
60	1773	65	325	69	346
66	1564	49	267	52	286
72	1402	37	221	40	240
84	1164	23	159	25	177
96	997	15	121	17	135
108	871	10	94	12	107
120	772	7.5	75	8.7	87
132	691	5.5	61	6.5	72
144	623	4.1	50	5.0	60
156	564	3.1	40	3.9	51
168	513	2.3	33	3.2	44
180	468	1.7	26	2.6	38
192	429	1.3	20	2.1	34
204	394	0.9	15	1.8	30
216	363	0.6	11	1.5	27
228	335	0.3	7	1.3	24
240	310	0.1	3	1.1	22

S100 1-5/8" x 7/8" (12 ga)

Section Properties								
Section	Wt. #/ft	Area (in ²)	I _x (in ⁴)	S _x (in ³)	r _x (in)	I _y (in ⁴)	S _y (in ³)	r _y (in)
12ga	1.302	0.383	0.035	0.068	0.304	0.139	0.171	0.602

Beam Span or Column Height (inches)	Maximum Allowable Column Load (Lbs)	Maximum Allowable Uniform Beam Load (Lbs / ft)	Total Allowable Uniform Beam Load (Lbs)	Uniform Load at L/240 Span Deflection (lbs/ft)	Total Uniform Load at L/240 Span Deflection (lbs)
12	7792	1235	1235	2294	2294
18	7074	550	824	680	1020
24	6062	289	578	287	574
30	4926	176	439	147	367
36	3822	117	351	85	255
42	2848	100	351	54	187
48	2181	76	304	36	143
54	1723	60	268	25	113
60	1396	46	230	18	92
66	1153	39	216	14	76
72	969	33	196	11	64
84	712	24	165	6.7	47
96	545	18	142	4.5	36
108	431	14	125	3.1	28
120	349	11	111	2.3	23
132	288	9.0	99	1.7	19
144	242	7.4	89	1.3	16
156	206	6.2	81	1.0	14
168	178	5.3	74	0.8	12
180	155	4.5	68	0.7	10
192	136	3.9	63	0.6	9
204	121	3.4	58	0.5	8
216	108	3.0	54	0.4	7
228	97	2.6	50	0.3	6
240	87	2.3	47	0.3	6

S100 1-5/8" x 7/8" (14 ga)

Section Properties								
Section	Wt. #/ft	Area (in ²)	I _x (in ⁴)	S _x (in ³)	r _x (in)	I _y (in ⁴)	S _y (in ³)	r _y (in)
14ga	0.93	0.273	0.028	0.055	0.321	0.103	0.127	0.614

Beam Span or Column Height (inches)	Maximum Allowable Column Load (Lbs)	Maximum Allowable Uniform Beam Load (Lbs / ft)	Total Allowable Uniform Beam Load (Lbs)	Uniform Load at L/240 Span Deflection (lbs/ft)	Total Uniform Load at L/240 Span Deflection (lbs)
12	5304	992	992	1836	1836
18	4713	411	616	544	816
24	4115	209	419	229	459
30	3577	156	389	117	294
36	2926	104	313	68	204
42	2263	74	260	43	150
48	1733	55	221	29	115
54	1369	43	191	20	91
60	1109	34	168	15	73
66	916	27	149	11	61
72	770	22	134	8	51
84	566	16	110	5.4	37
96	433	12	93	3.6	29
108	342	9	80	2.5	23
120	277	7	69	1.8	18
132	229	5.5	61	1.4	15
144	192	4.5	54	1.1	13
156	164	3.7	48	0.8	11
168	141	3.0	43	0.7	9
180	123	2.5	38	0.5	8
192	108	2.1	34	0.4	7
204	96	1.8	31	0.4	6
216	86	1.6	28	0.3	6
228	77	1.3	26	0.3	5
240	69	1.2	23	0.2	5



LVM STRUT