

# Gothic Cathedral

## Ruined Corner 4

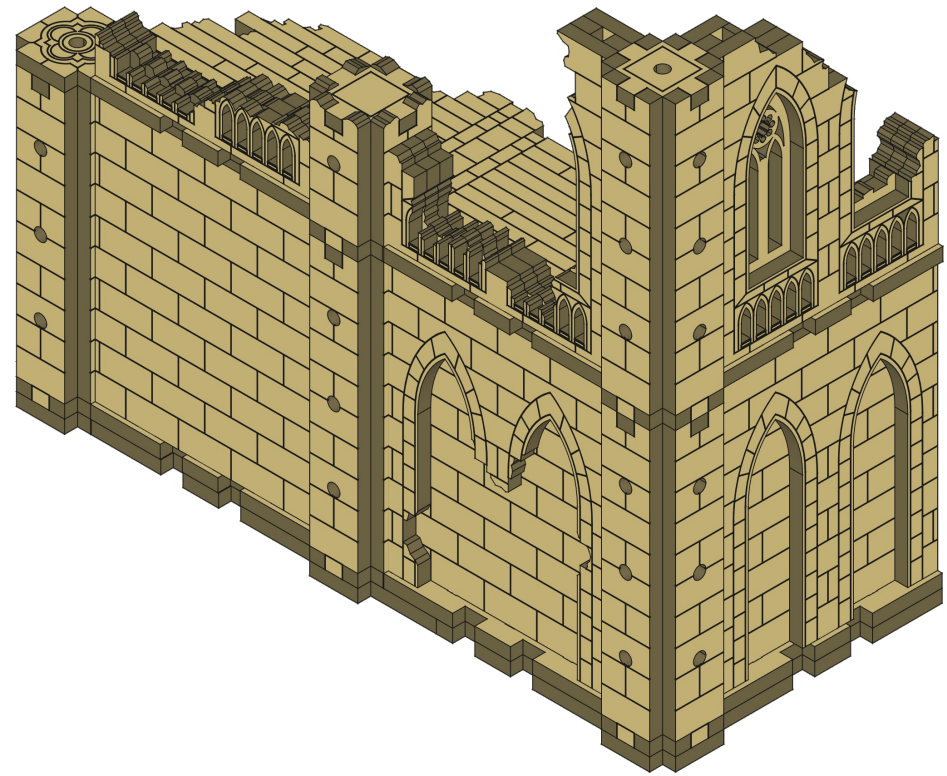
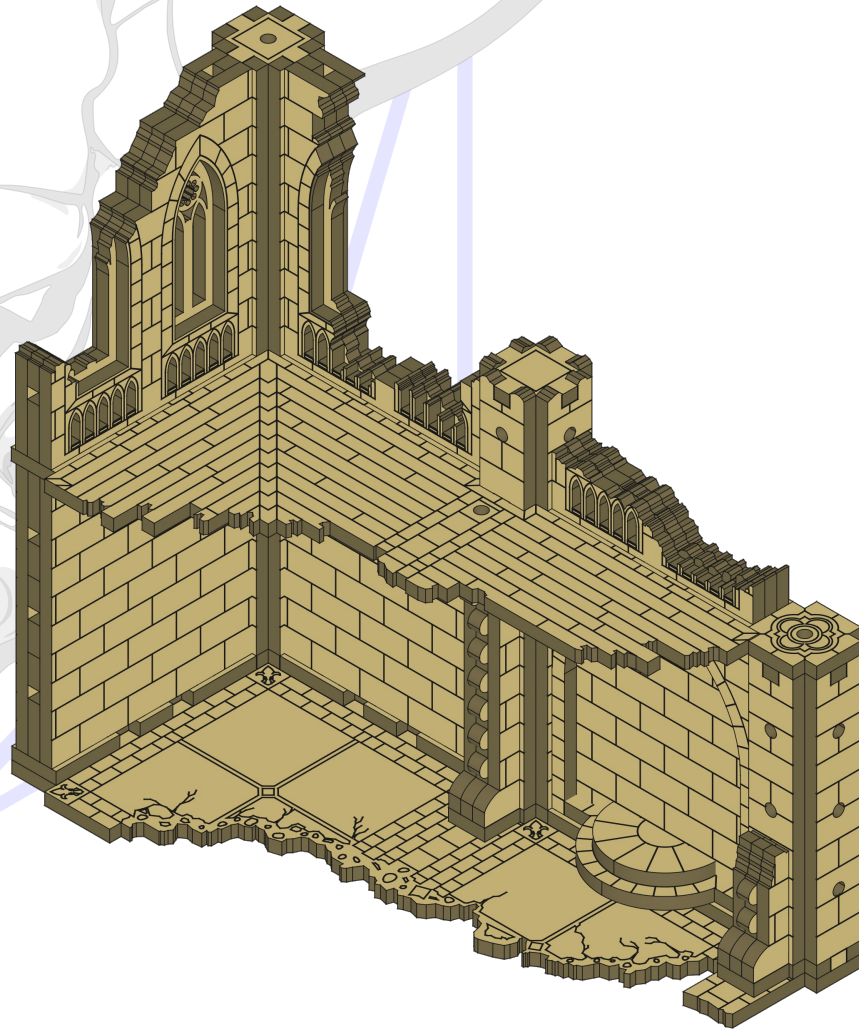

82 Pieces

Requires 127 3mm x 3mm neodymium magnets



# Magnets

## Tips and Tricks for Your Success.

### WHAT IS POLARITY?

Magnets have a north (+) and a south (-) pole. Opposite poles attract each other and like poles repel. You can't easily tell which side is north or south. In these instructions, red is north and blue is south.

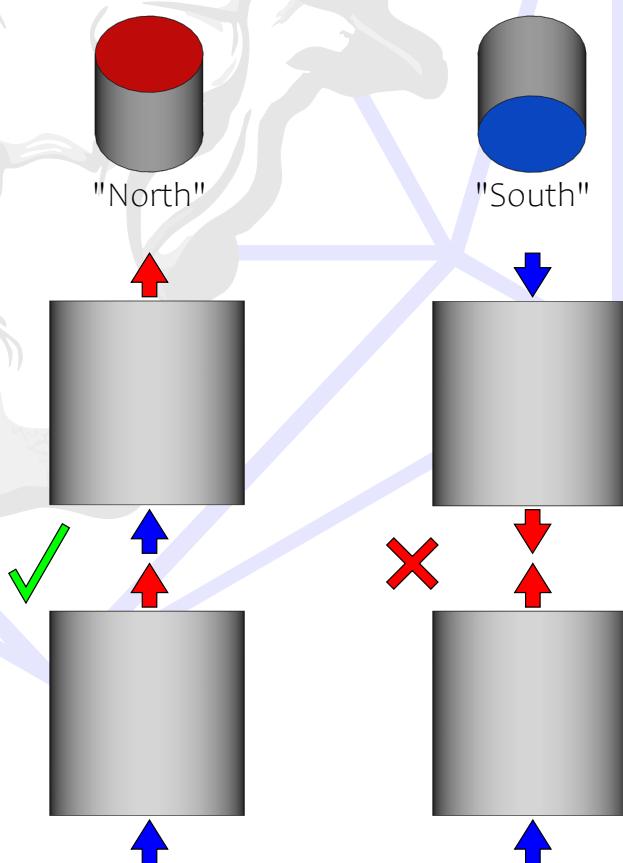

### BE CONSISTENT

Because you won't really know which side is north or south, just pick a direction and stick with it. Make one piece and use that to be your guide for the rest.

Apply magnets in a stack.  
This ensures they are facing the same direction.

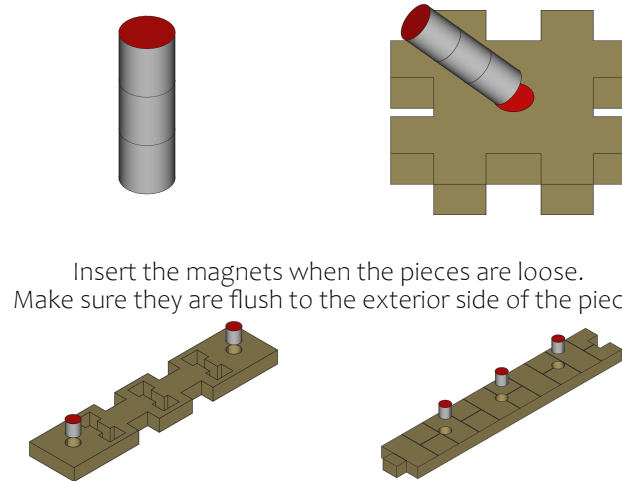

Insert the magnets when the pieces are loose.  
Make sure they are flush to the exterior side of the piece.

Apply CA glue (super glue) to the back of the magnets.  
This will prevent them from falling out or being pulled out.

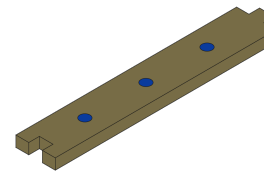

### ALIGNMENT

After assembly is finished, the polarities should look like this.  
Walls connect horizontally to columns.  
Everything stacks vertically.

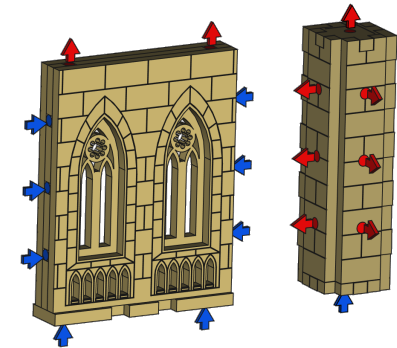

For your convenience, we provide a helper tool in every kit.  
This "BSTOOL" has labels to help with aligning your magnets.  
Use the tool as if it was a column or wall.  
It can also be used to poke pieces out of their sheet or apply glue.

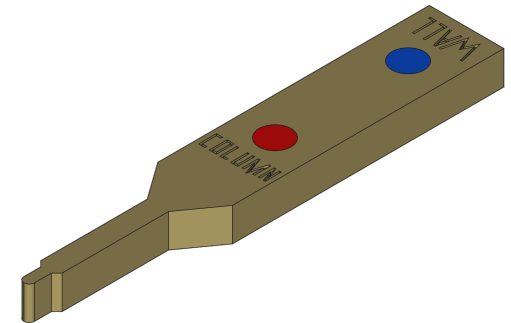

# Gothic Cathedral

## 4-way Column, 1x Tall

Part 1

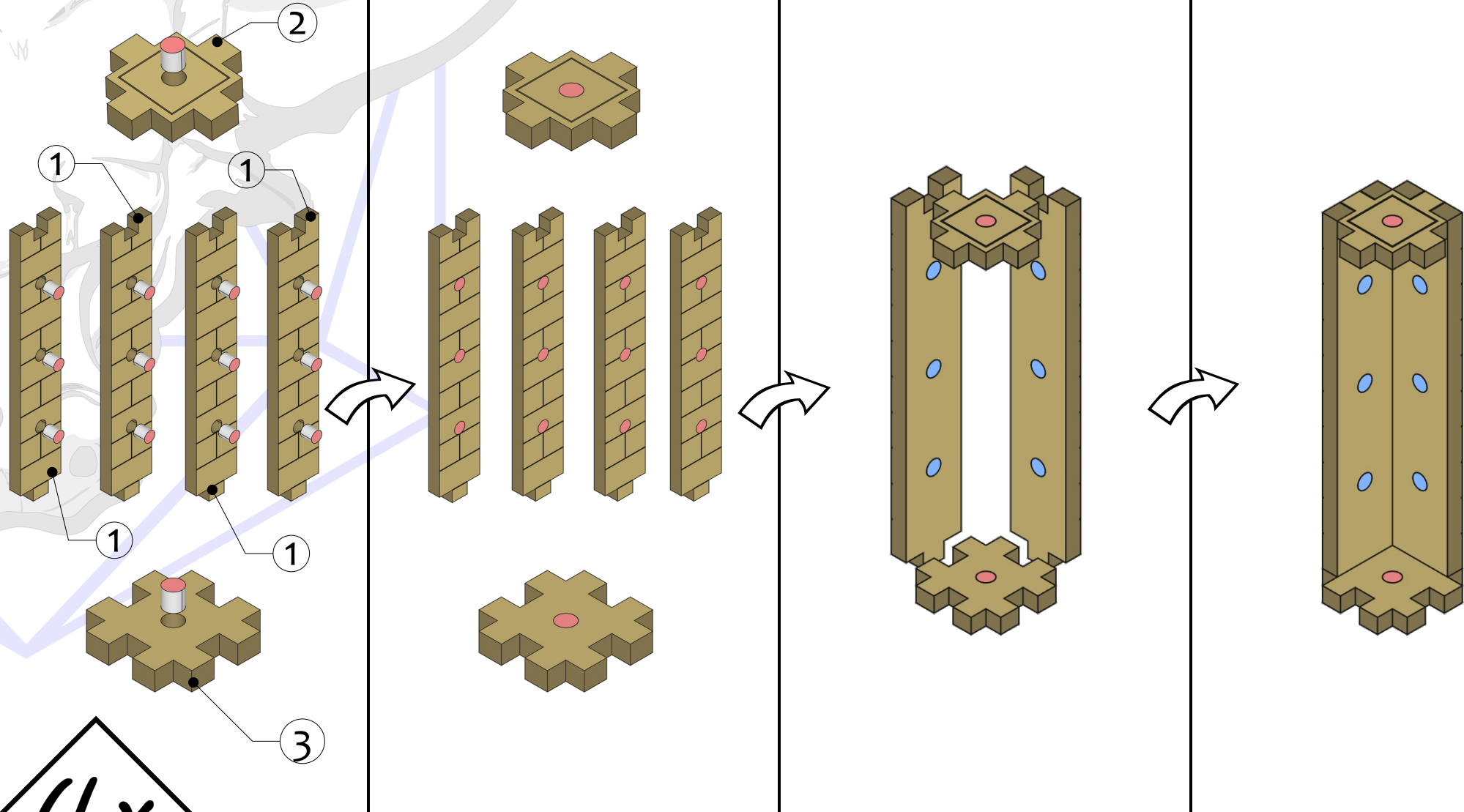

4x



# Gothic Cathedral

## 4-way Column, 1x Tall

Part 2

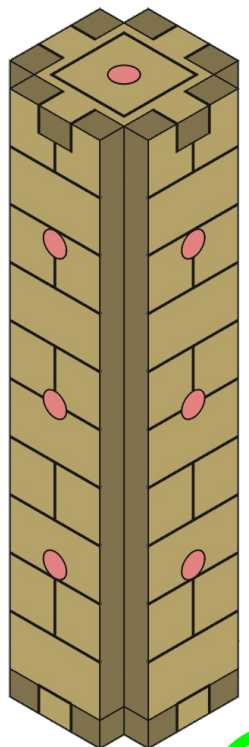
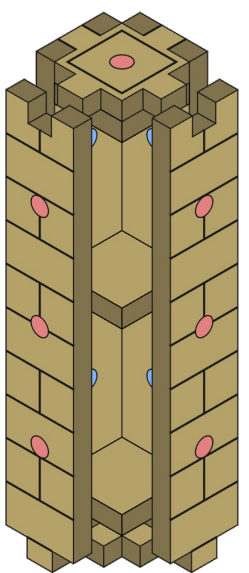
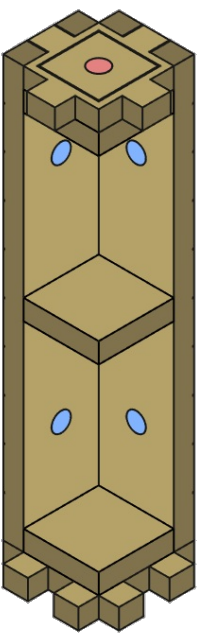
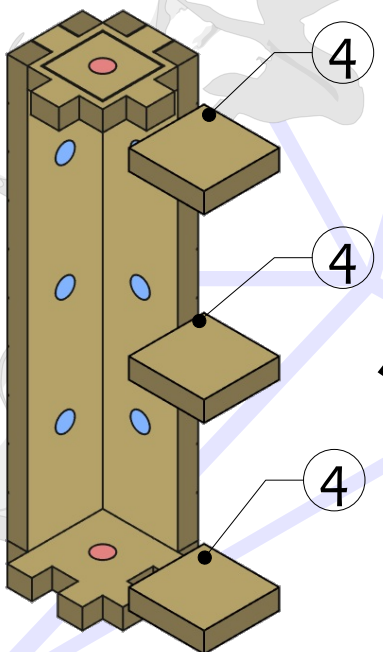

4x





# Gothic Cathedral

## Alcove Wall, 1x Tall

Part 1

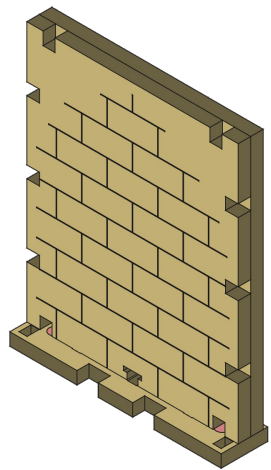
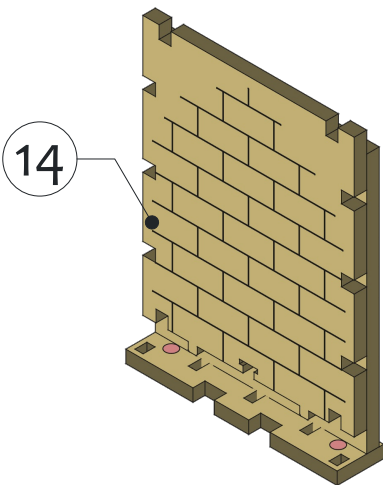
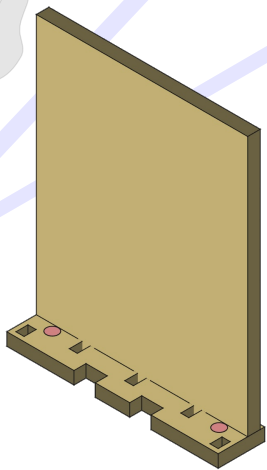
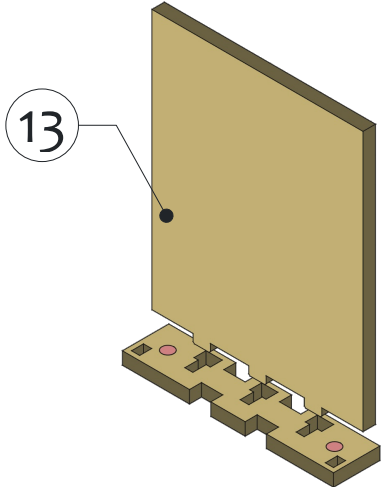
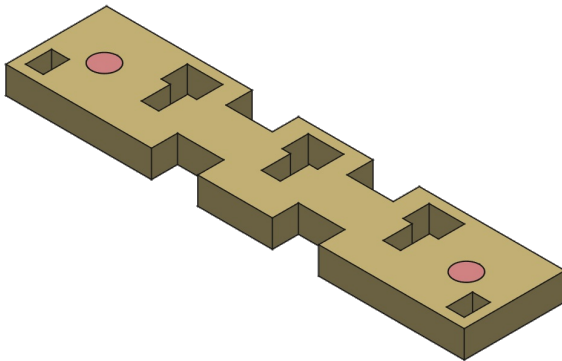
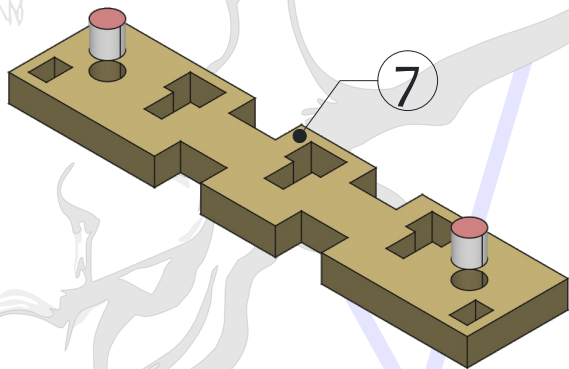

# Gothic Cathedral

## Alcove Wall

Part 2

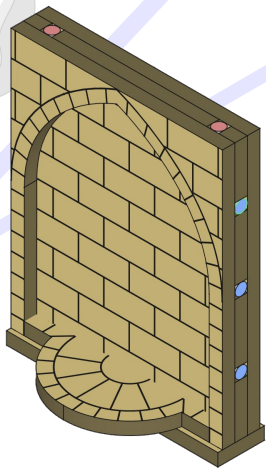
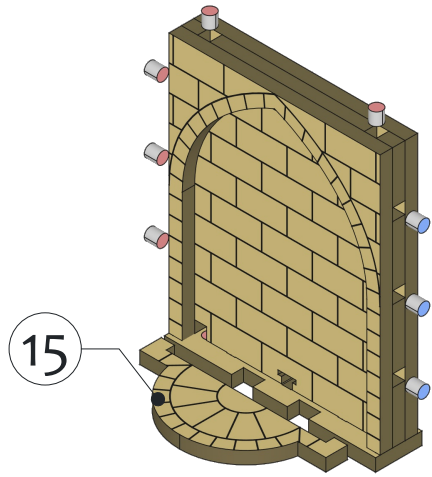
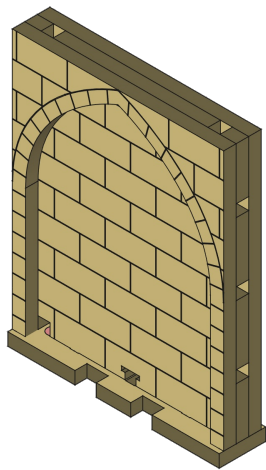
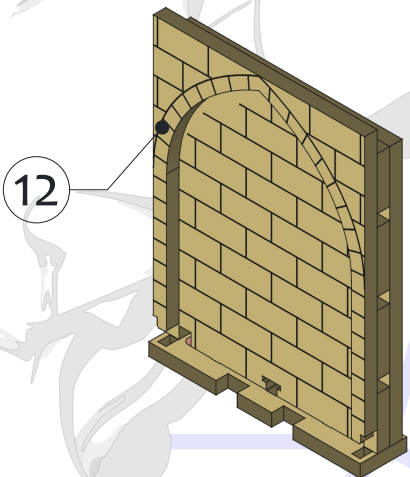

Optional Parts

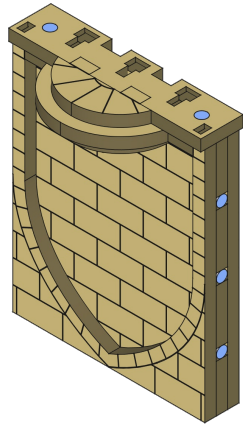
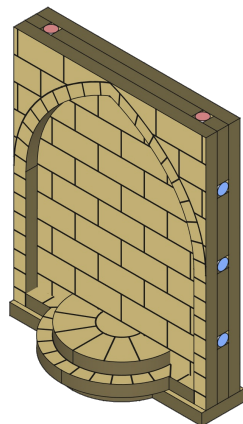
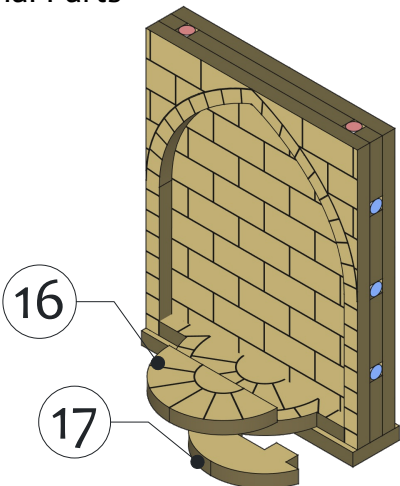

# Gothic Cathedral

## Double Arch Wall, 1x Tall - Ruined 4

Part 1

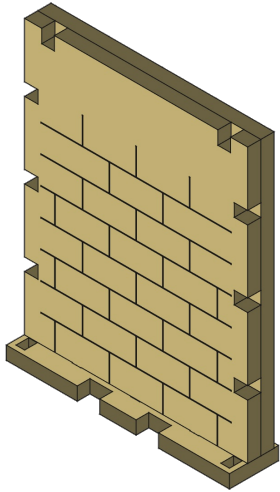
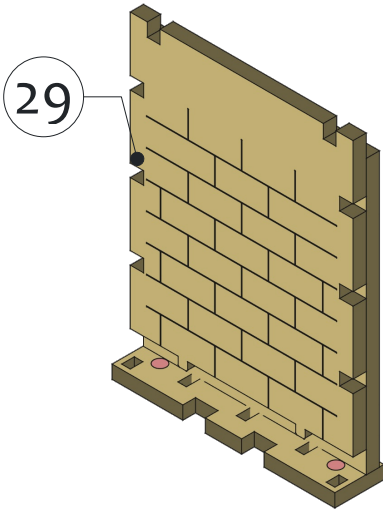
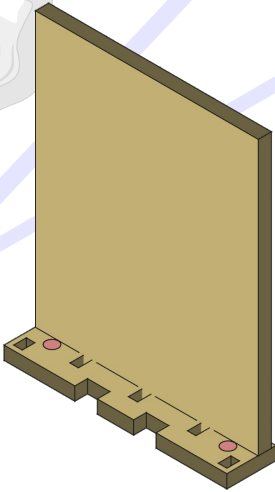
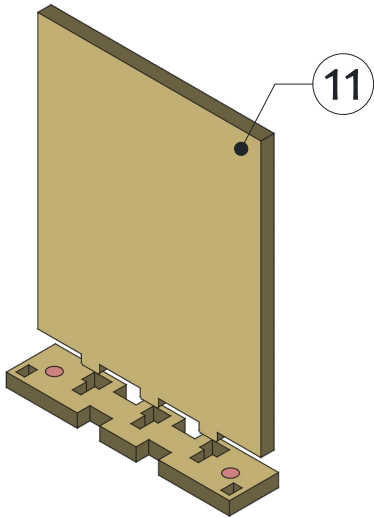
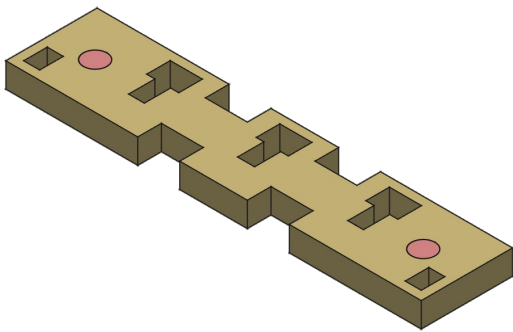
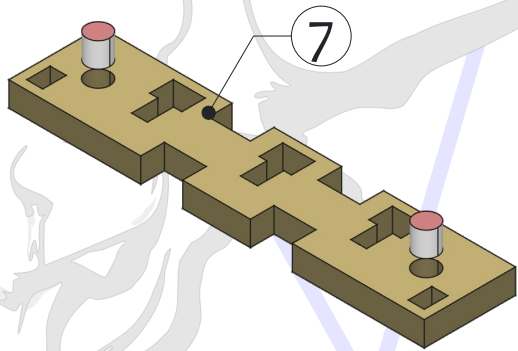

# Gothic Cathedral

## Double Arch Wall, 1x Tall - Ruined 4

Part 2

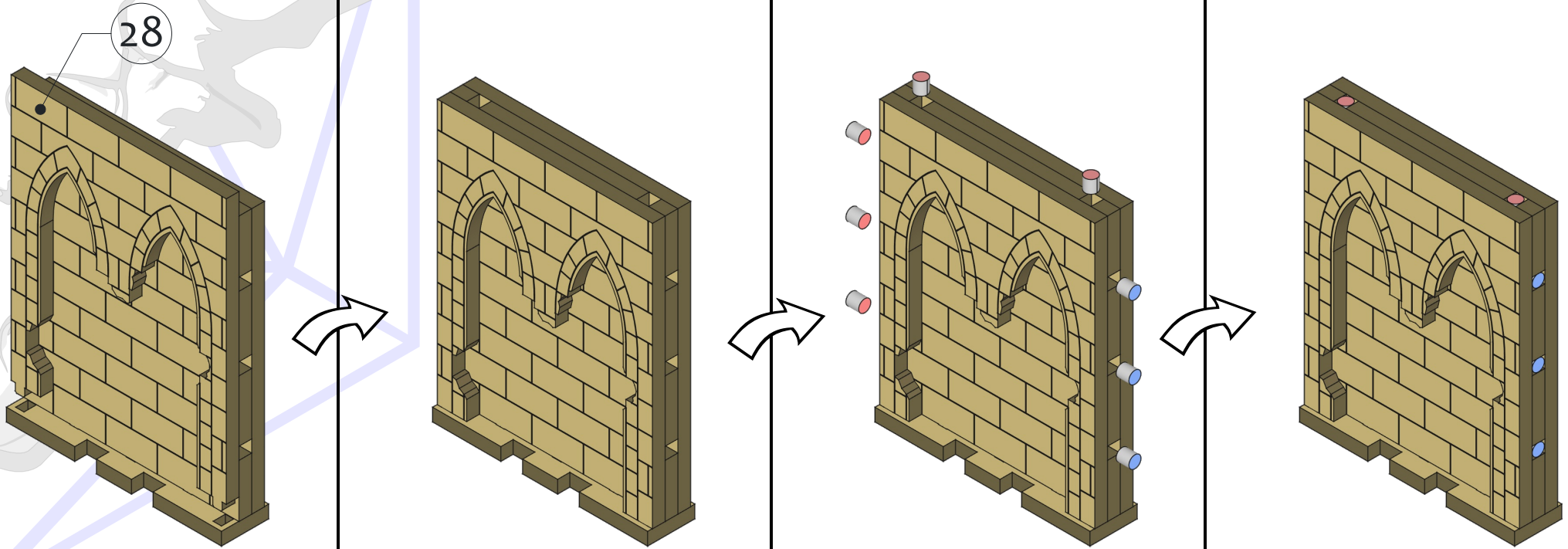



# Gothic Cathedral

Double Window Wall, 1x Tall - Ruined 10

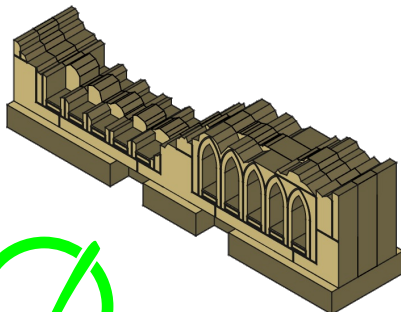
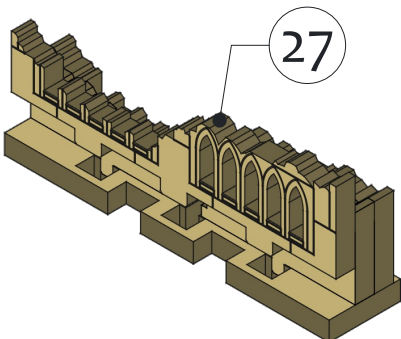
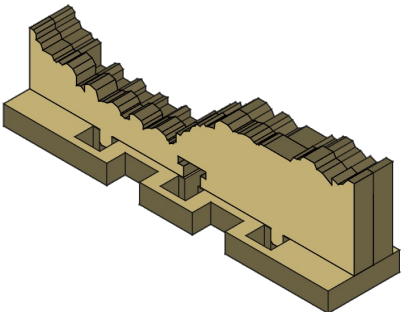
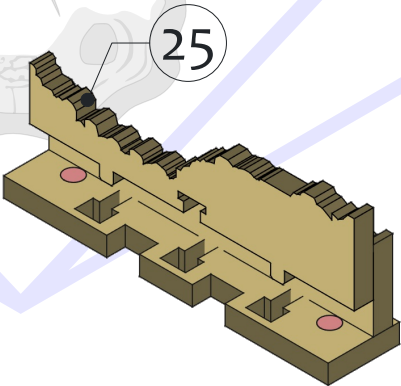
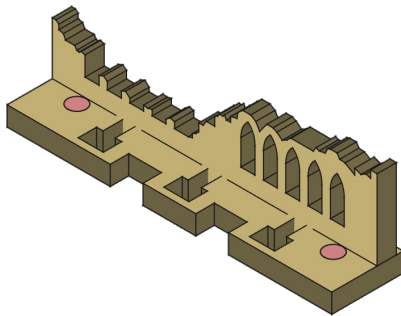
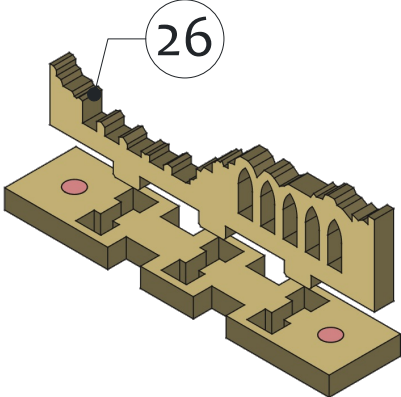
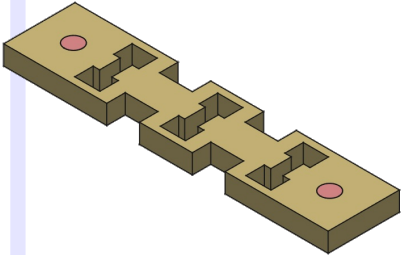
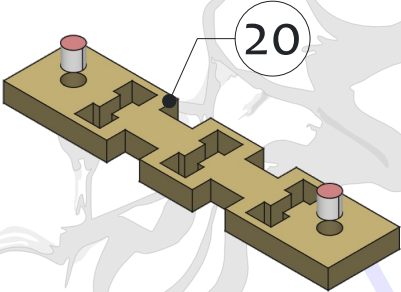

# Gothic Cathedral

## Double Arch Wall, 1x Tall

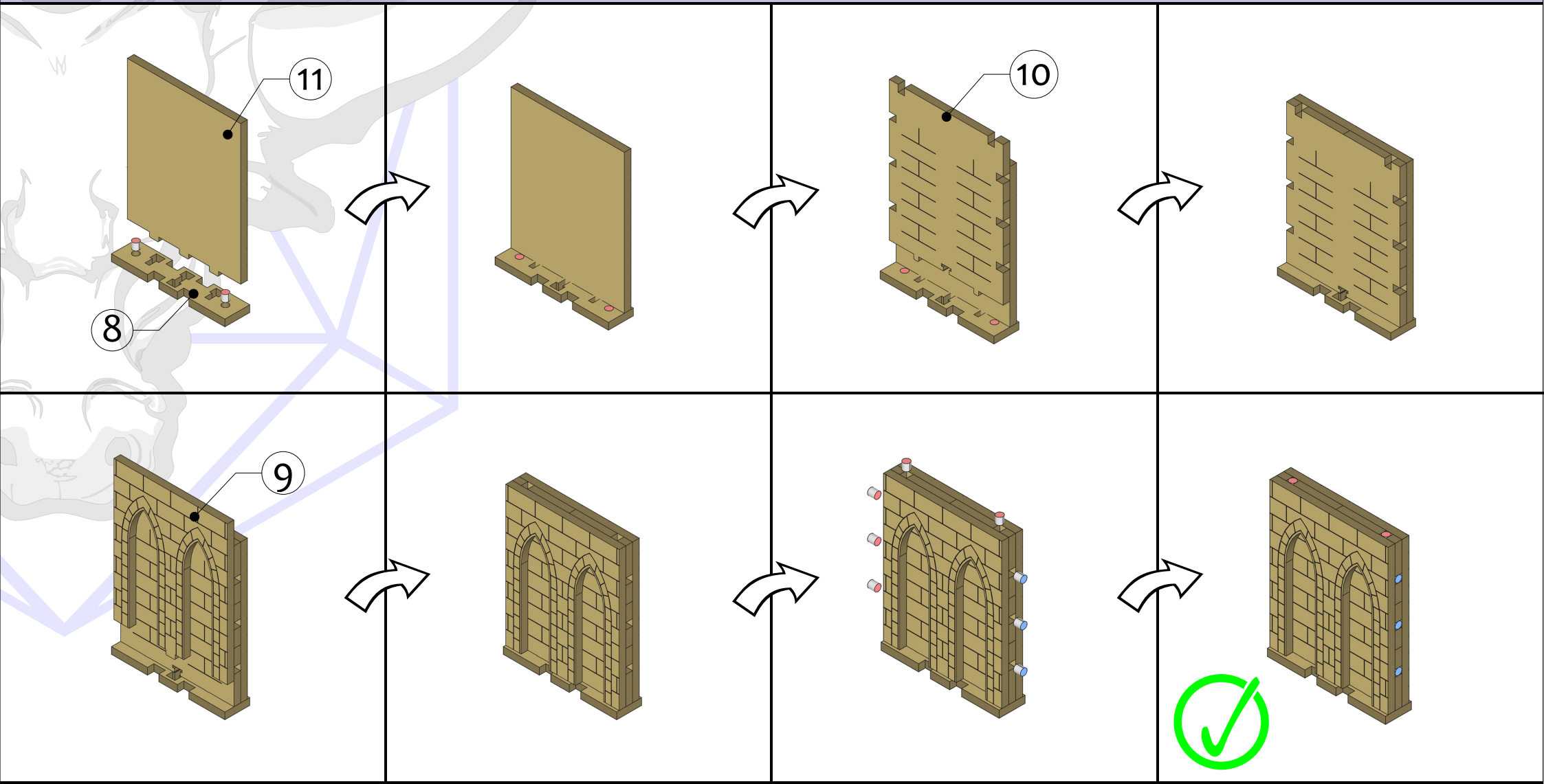

# Gothic Cathedral

## Double Window Wall, 1x Tall - Ruined 12

Part 1

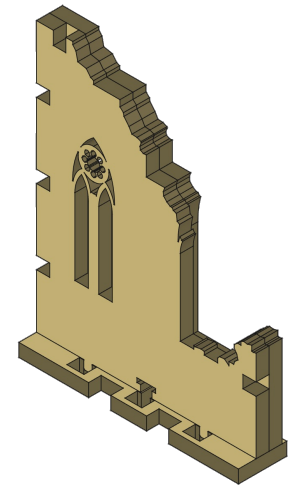
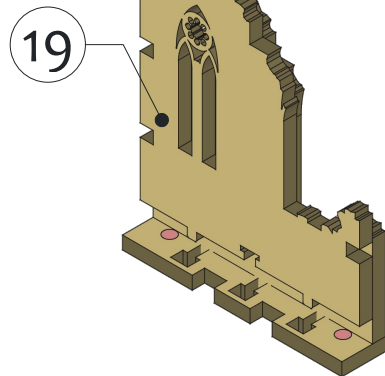
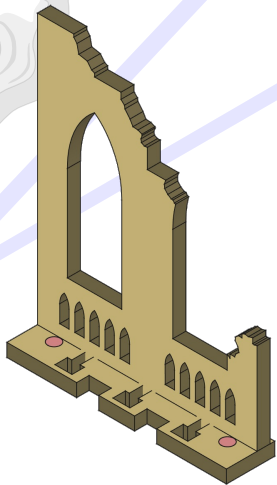
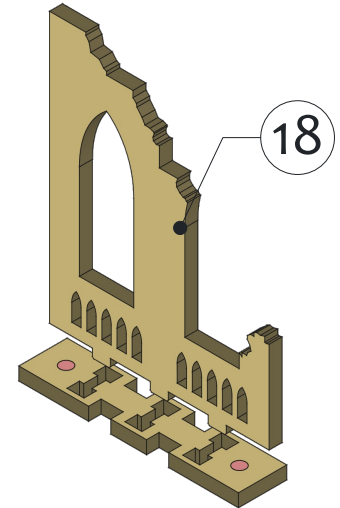
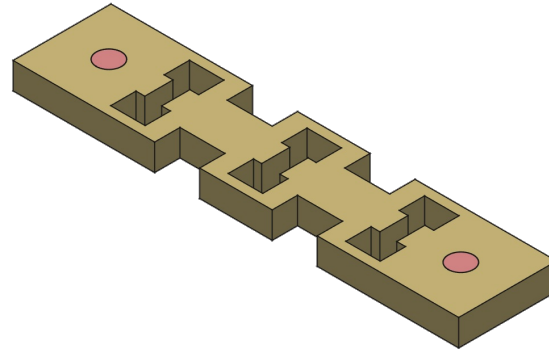
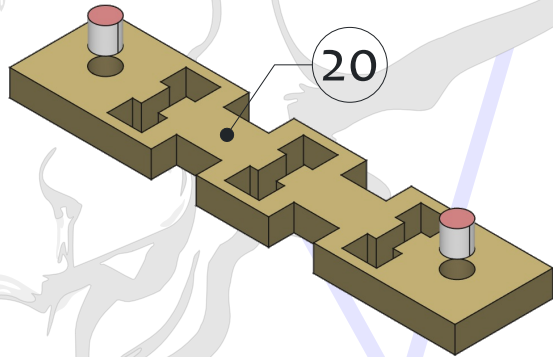

# Gothic Cathedral

## Double Window Wall, 1x Tall - Ruined 12

Part 2





# Gothic Cathedral

## Double Window Wall, 1x Tall - Ruined 13

Part 1

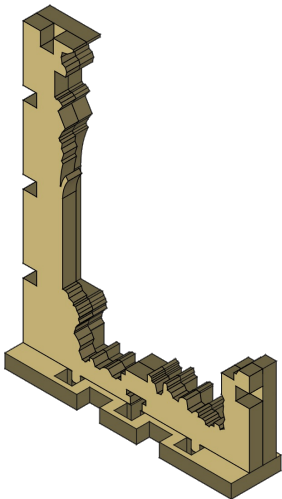
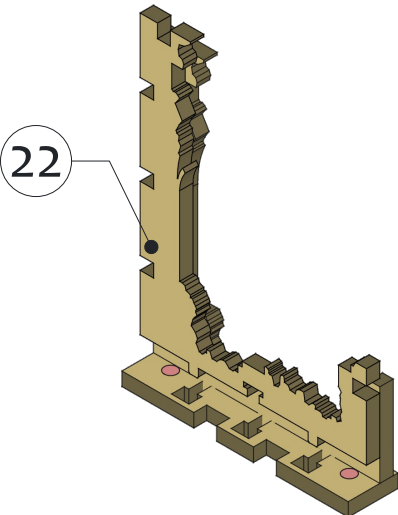
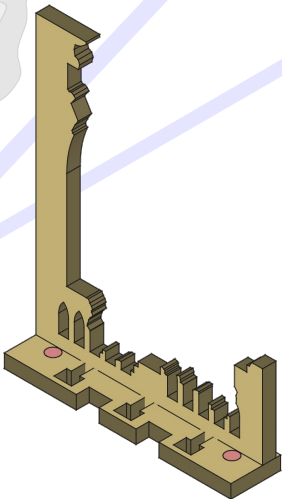
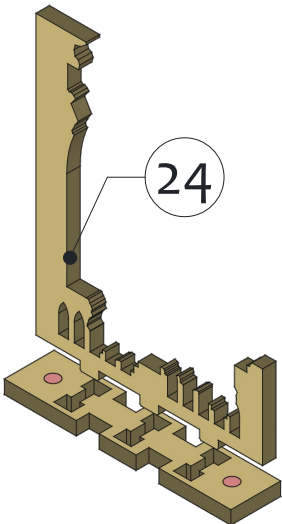
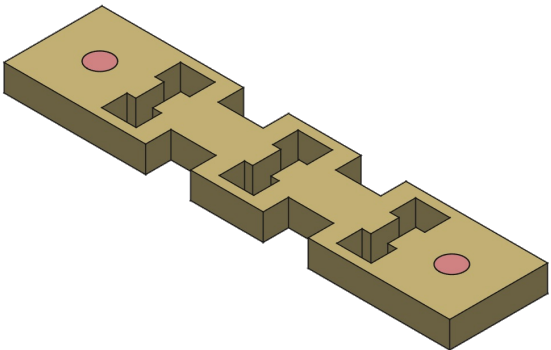
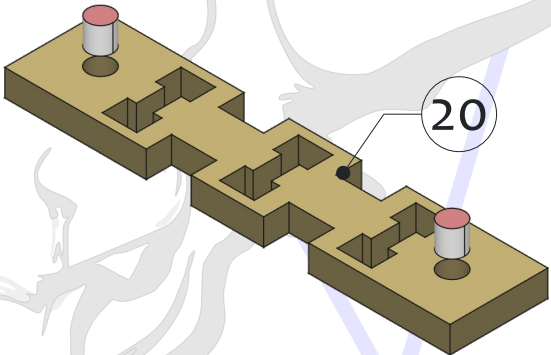

# Gothic Cathedral

## Double Window Wall, 1x Tall - Ruined 13

Part 2

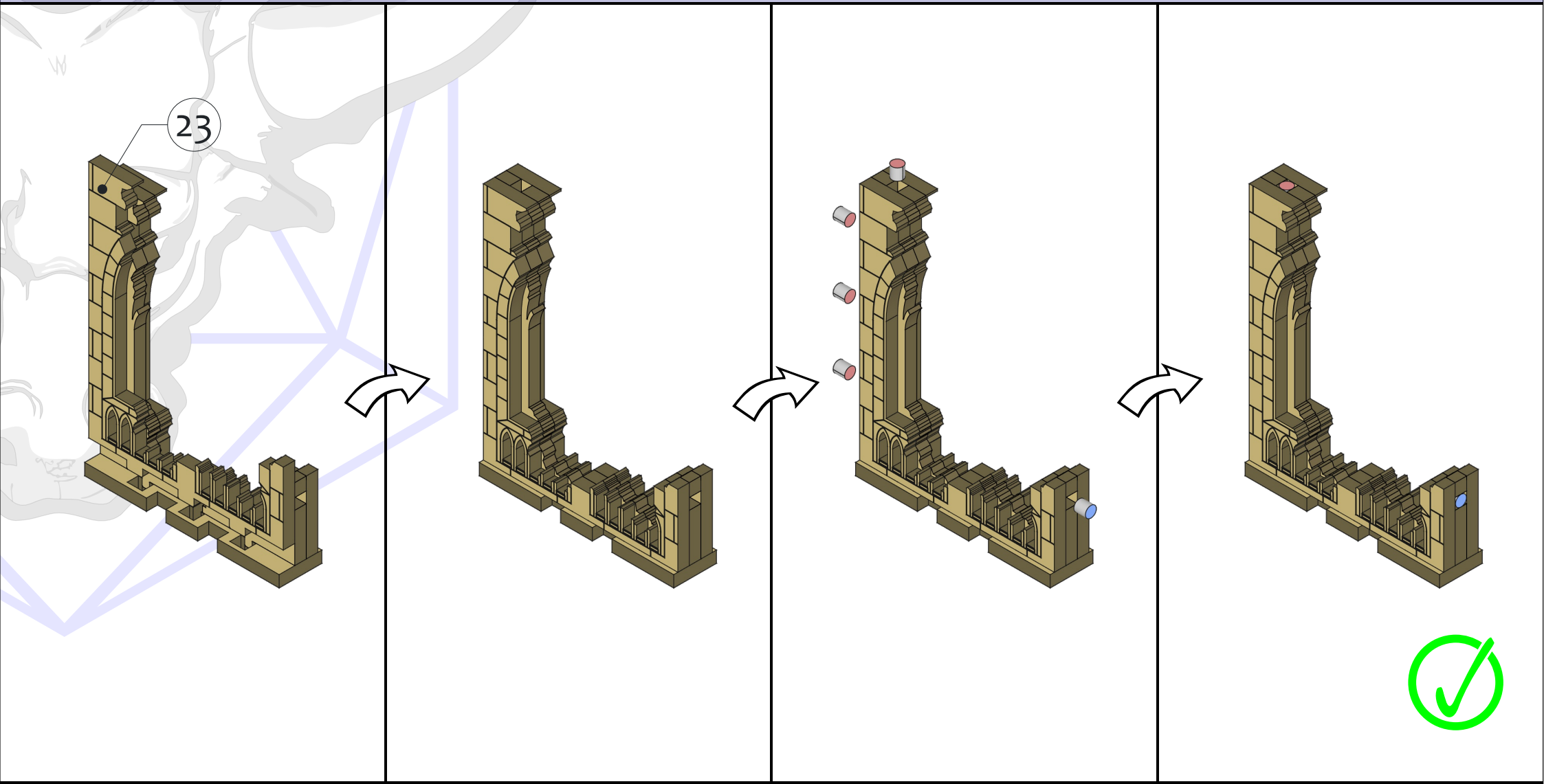

# Gothic Cathedral

## 4-Way Column, Ruined 1

Part 1

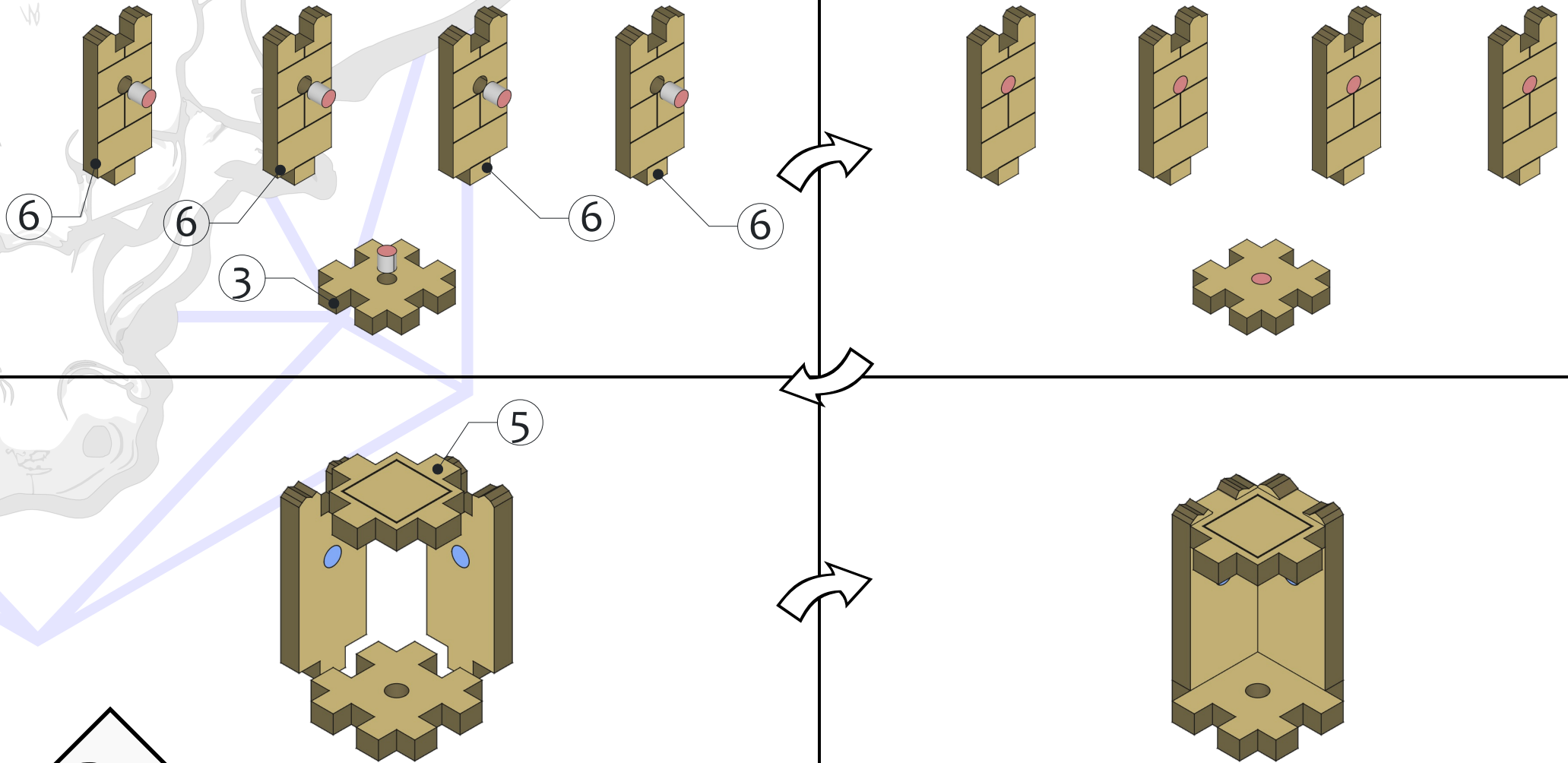

# Gothic Cathedral

## 4-Way Column, Ruined 1

Part 2



2x





# Gothic Cathedral

## Floor Spacers - Ruined 1 and Column Cap

GR-BS0001

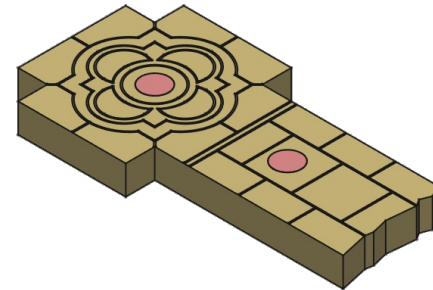
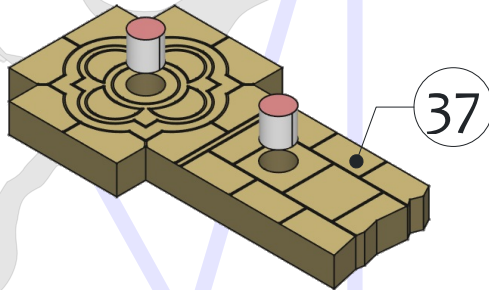

GC-CC0001

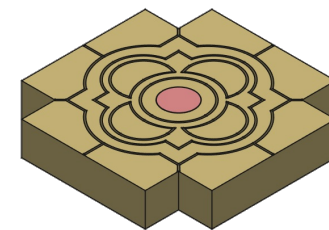
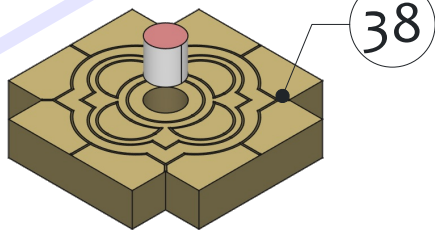

Warning: Contains small parts. May not be suitable for children under 13.  
Copyright 2024-2025 BS Gaming Stuff, LLC

# Gothic Cathedral

## Column Endcap - Decorative Support - Ruined 1

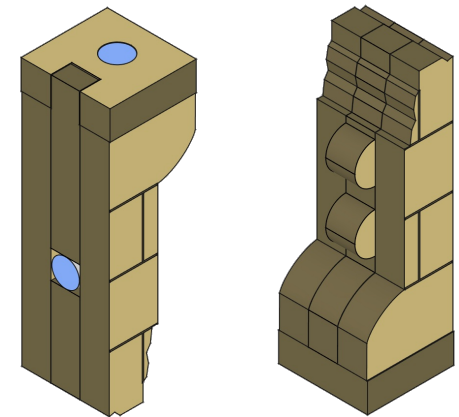
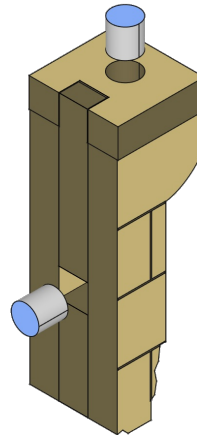
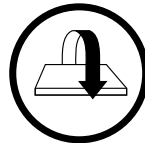
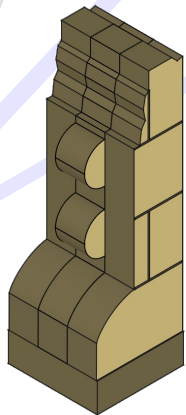
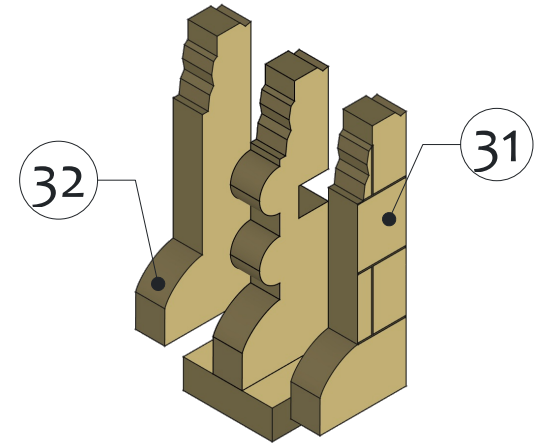
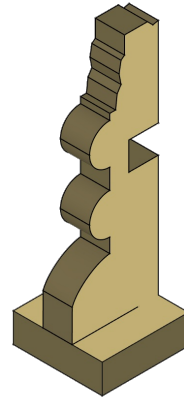
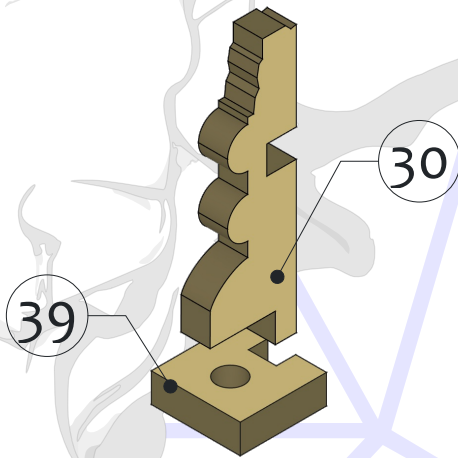

# Gothic Cathedral

## Column Endcap - Decorative Support

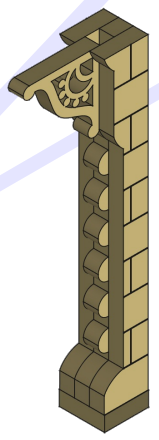
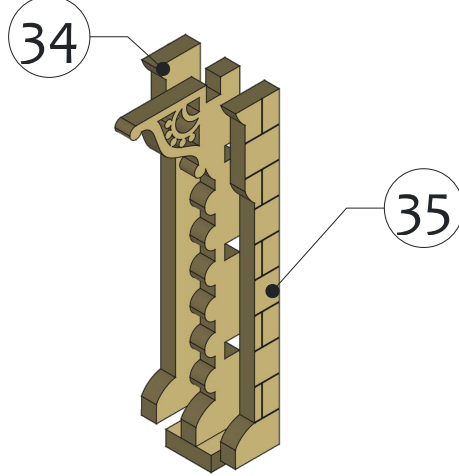
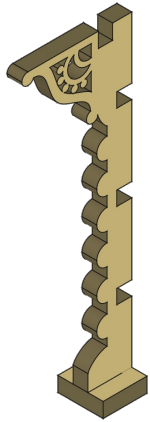
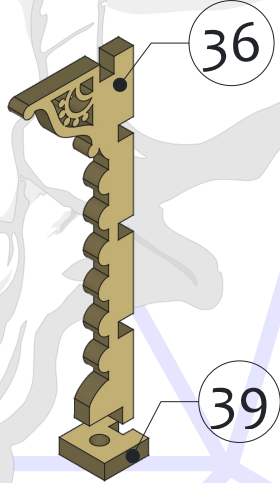

180°

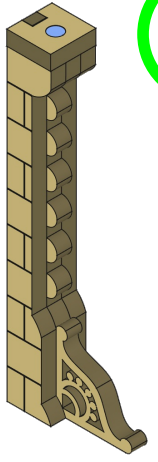
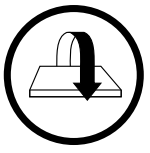
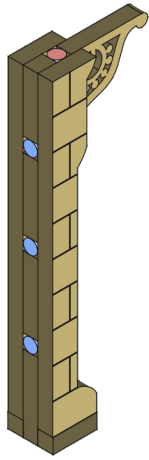
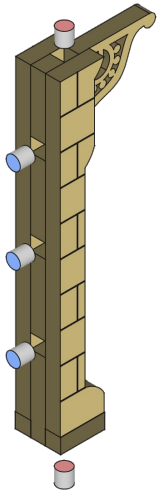

2x



# Gothic Cathedral

Stone Tile Floor, 1x2 - Ruined 2

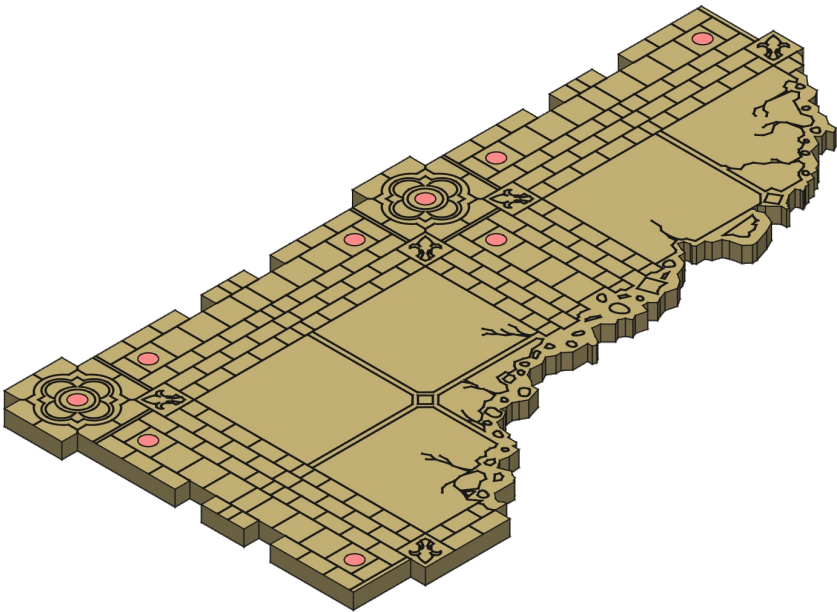
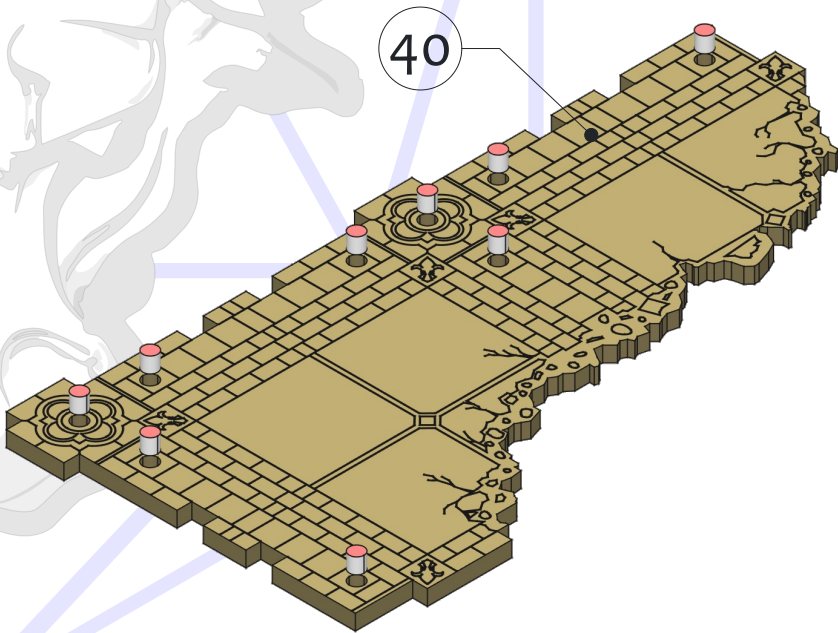



# Gothic Cathedral

Wood Plank Floor, 1x2 - Ruined 2

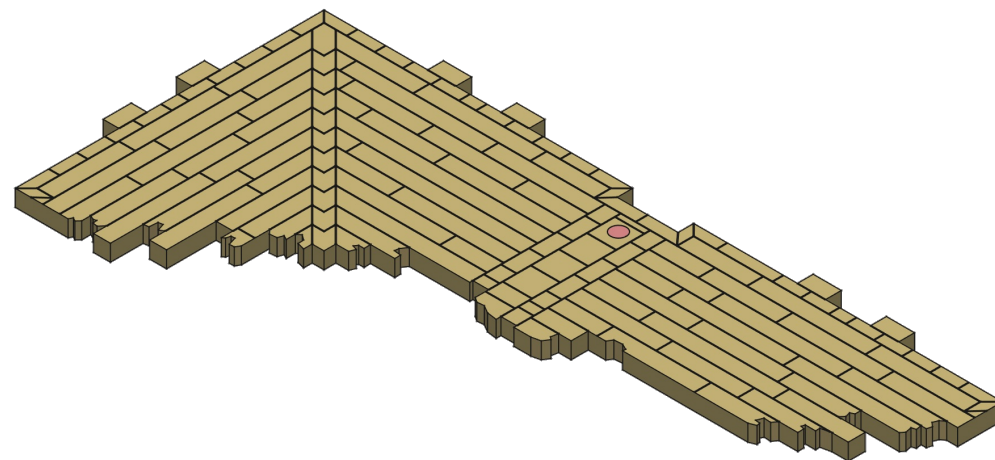
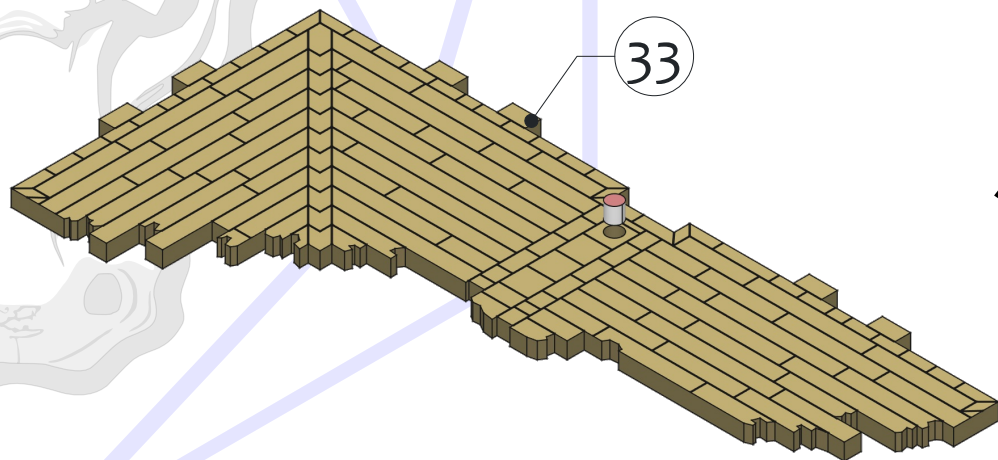

# Gothic Cathedral

## Alternate Builds

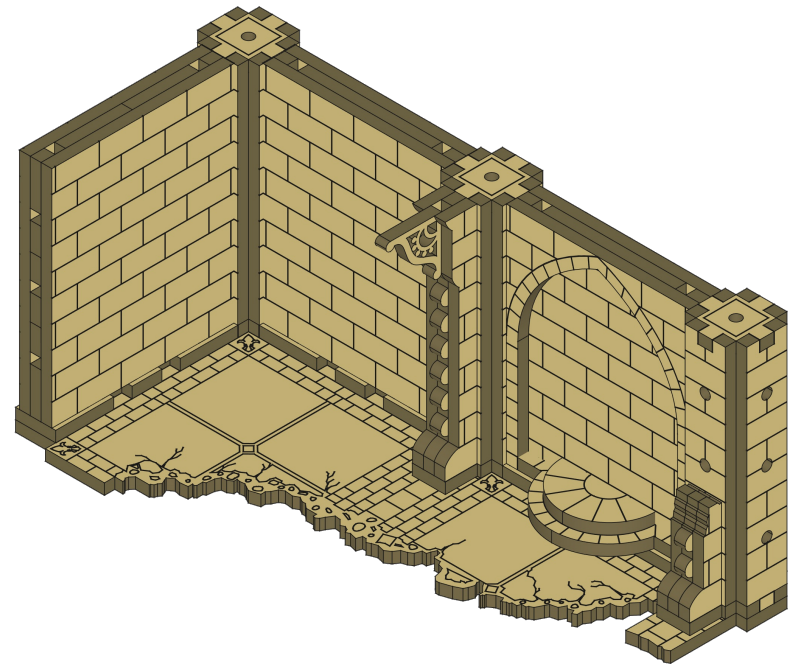

# Gothic Cathedral – Ruined Corner 4 (GR-K005)

## Part List

Module	Part	Qty.	Piece #	Pages
4-way Column, 1x Tall (GC-MC004) x4	GC-CW1101	16	1	2
	GC-CB0201	4	2	2
	GC-CB0101	4	3	2
	GC-CS0001	12	4	3
Alcove Wall, 1x Tall (GC-MW013)	GC-WB1107	1	7	4
	GR-WW1105	1	13	4
	GR-WW1112	1	14	4
	GR-WW1111	1	12	5
	GC-WA0004	1	15	5
	GC-WA0005	1	16	5
Double Arch Wall, 1x Tall – Ruined 4 (GR-MW019)	GC-WB1107	1	7	6
	GC-WW1105	1	11	6
	GR-WW1142	1	29	6
	GR-WW1141	1	28	7
Double Window Wall, 1x Tall – Ruined 10 (GR-MW015)	GC-WB1101	1	20	8
	GR-WW1132	1	25	8
	GR-WW1133	1	26	8
	GR-WW1131	1	27	8
Double Arch Wall, 1x Tall (GC-MW004)	GC-WB1102	1	8	9
	GC-WW1103	1	9	9
	GC-WW1104	1	10	9
	GC-WW1105	1	11	9
Double Window Wall, 1x Tall – Ruined 12 (GR-MW018)	GR-WW1143	1	18	10
	GR-WW1144	1	19	10
	GC-WB1101	1	20	10
	GR-WW1145	1	21	11
Double Window Wall, 1x Tall – Ruined 13 (GR-MW020)	GC-WB1101	1	20	12
	GR-WW1133	1	22	12
	GR-WW1131	1	24	12
	GR-WW1132	1	23	13

4-way Column, - Ruined 1 (GR-MC005) x1	GC-CB0101	1	3	14
	GR-CB0201	1	5	14
	GR-CW0101	4	6	14
	GC-CS0001	1	4	15
Floor Spacer – Ruined 1 (GR-BS0001)	GR-BS0001	1	37	16
Column Cap (GC-CC0001)	GC-CC0001	1	38	16
Column Endcap – Decorative Support – Ruined 1 (GR-MC006)	GR-CE008	1	30	17
	GR-CE009	1	31	17
	GR-CE007	1	32	17
	GC-CE0004	1	39	17
Column Endcap – Decorative Support (GC-MC006)	GC-CE0001	1	34	18
	GC-CE0003	1	35	18
	GC-CE0002	1	36	18
	GC-CE0004	1	39	18
Stone Tile Floor, 1x2 – Ruined 2 (GR-FS0007)	GR-FS0007	1	40	19
Wood Plank Floor, 1x2 - Ruined 2 (GR-FW0006)	GR-FW0006	1	33	20
BS TOOL	BSTOOL	2	*	N/A

