

Industrial Complex

Hex Platform

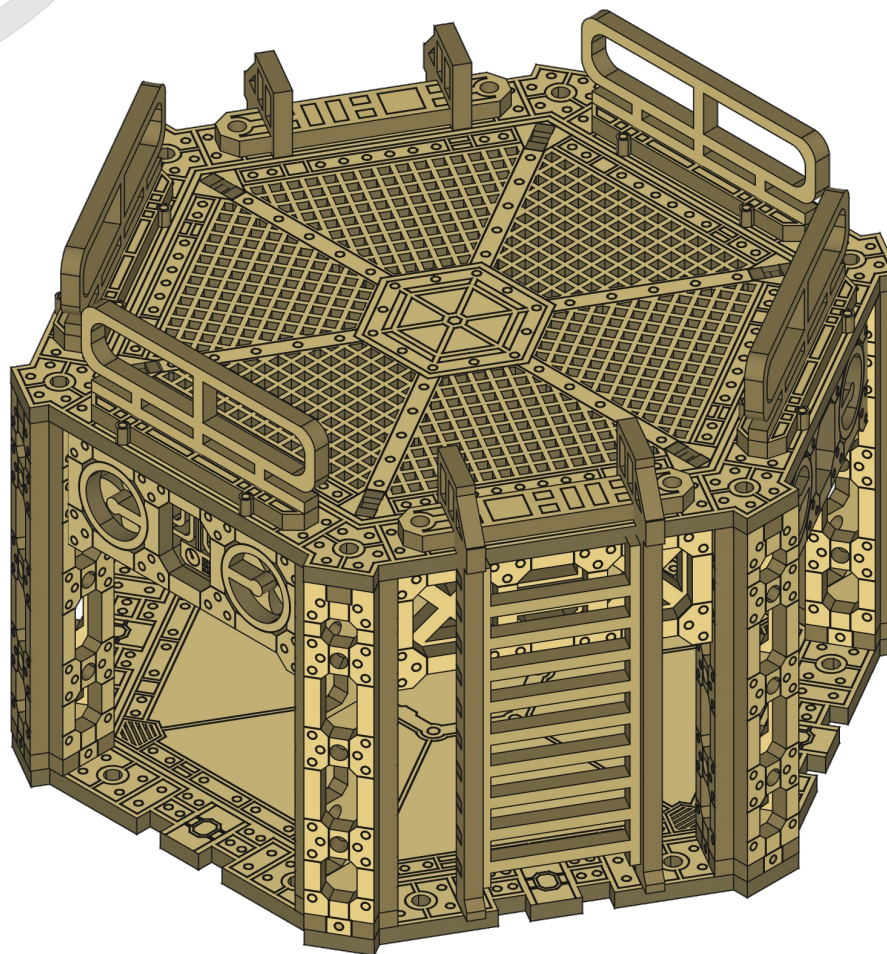

91 Pieces

Requires 138 3mm x 3mm neodymium magnets



Magnets

Tips and Tricks for Your Success.

WHAT IS POLARITY?

Magnets have a north (+) and a south (-) pole. Opposite poles attract each other and like poles repel. You can't easily tell which side is north or south. In these instructions, red is north and blue is south.

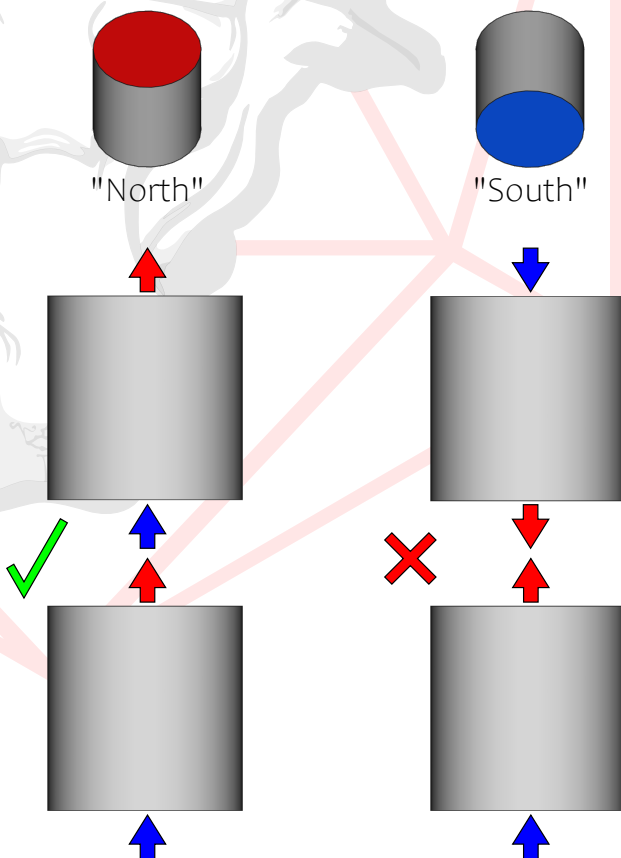

BE CONSISTENT

Because you won't really know which side is north or south, just pick a direction and stick with it. Make one piece and use that to be your guide for the rest.

Apply magnets in a stack.
This ensures they are facing the same direction.

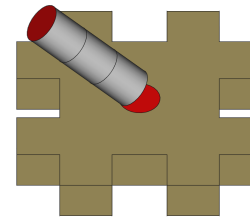

Insert the magnets when the pieces are loose.
Make sure they are flush to the exterior side of the piece.

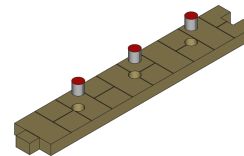
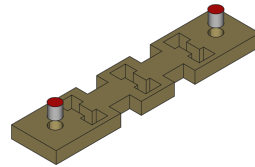

Apply CA glue (super glue) to the back of the magnets.
This will prevent them from falling out or being pulled out.

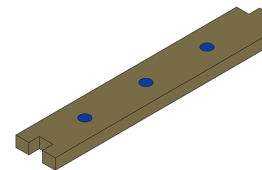

ALIGNMENT

After assembly is finished, the polarities should look like this.
Walls connect horizontally to columns.
Everything stacks vertically.

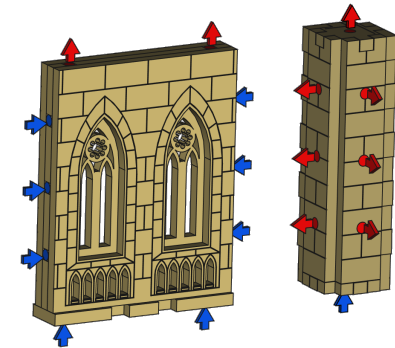

For your convenience, we provide a helper tool in every kit.
This "BSTOOL" has labels to help with aligning your magnets.
Use the tool as if it was a column or wall.
It can also be used to poke pieces out of their sheet or apply glue.

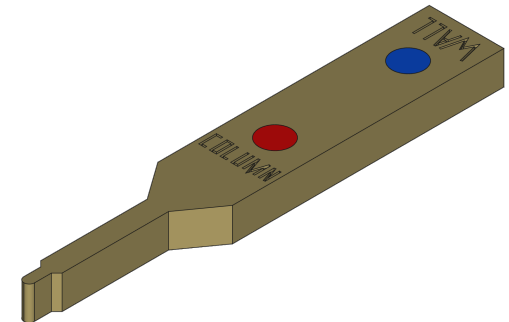

Industrial Complex

Girder Column - Triangle, 1x Tall

Part 1

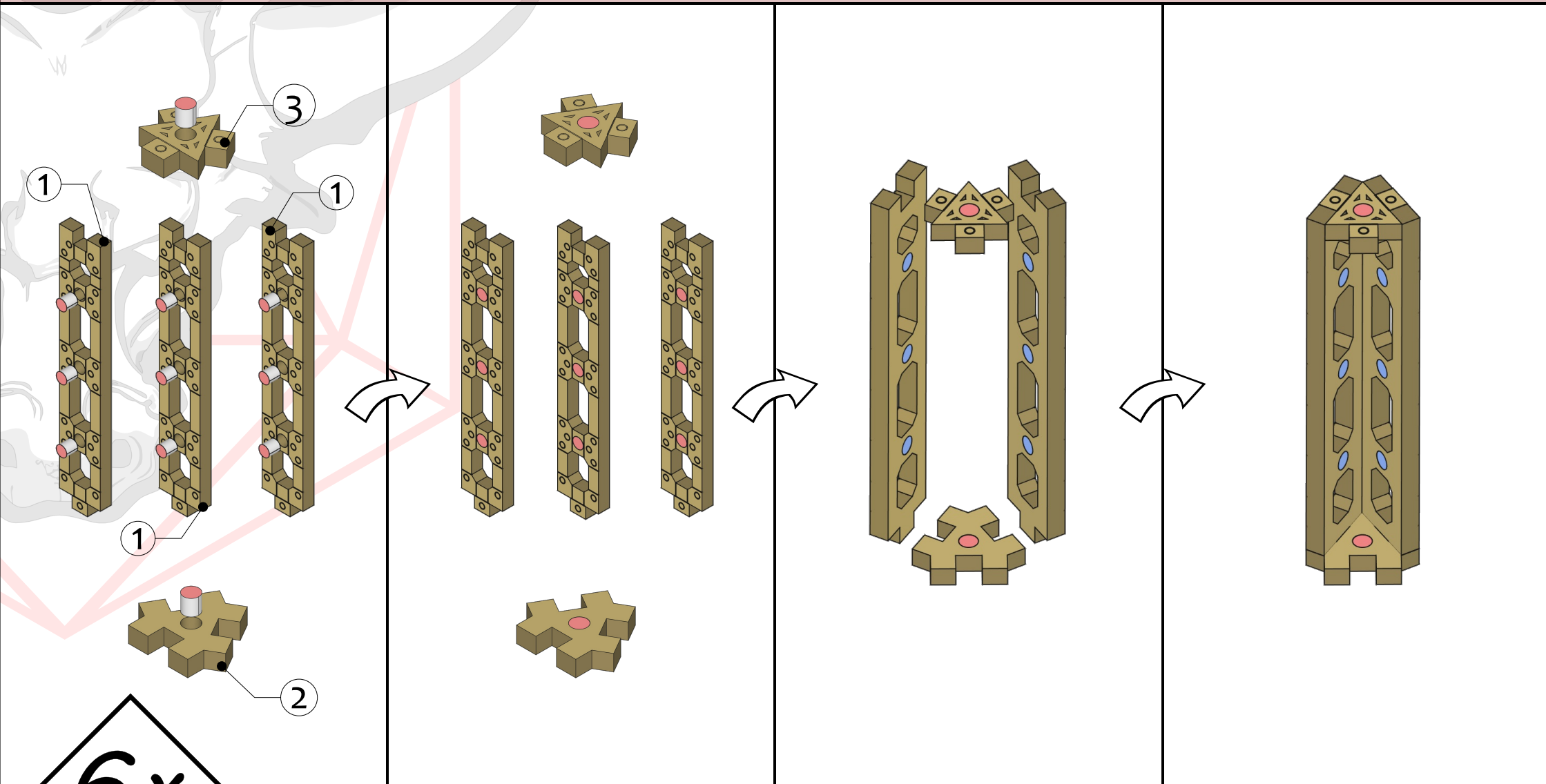

Industrial Complex

Girder Column - Triangle, 1x Tall

Part 2

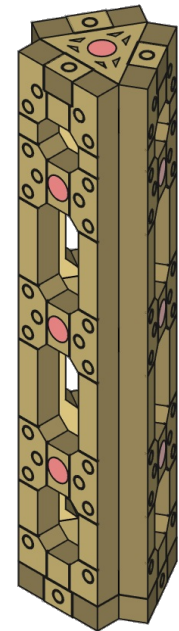
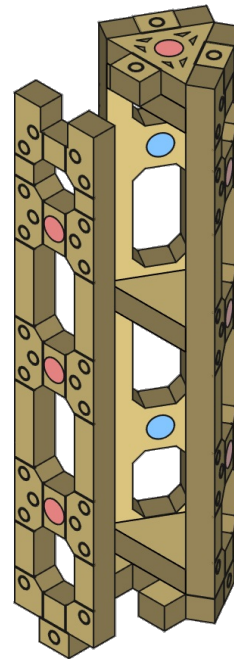
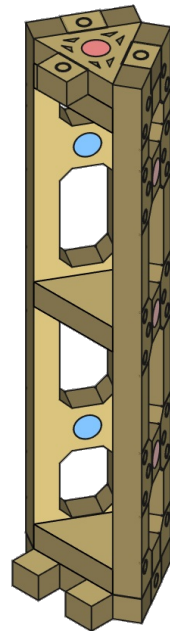
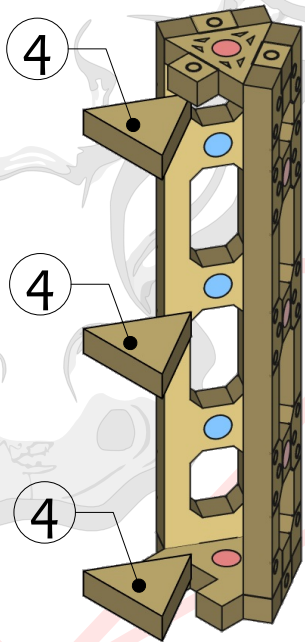

6x



Industrial Complex

Upper Support Wall 1

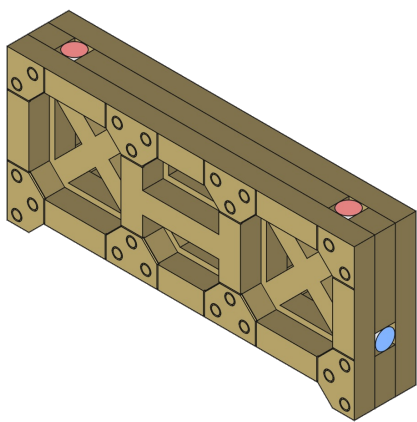
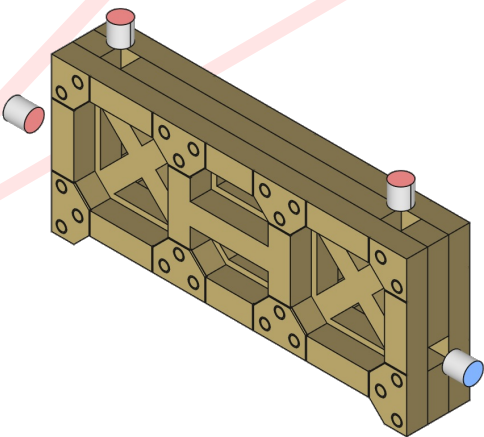
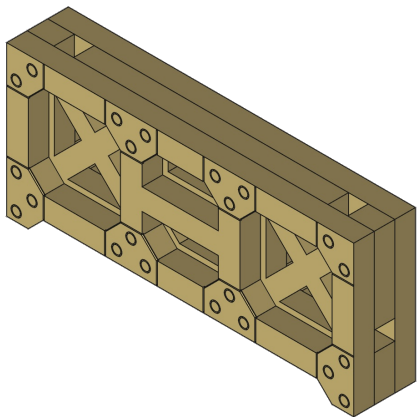
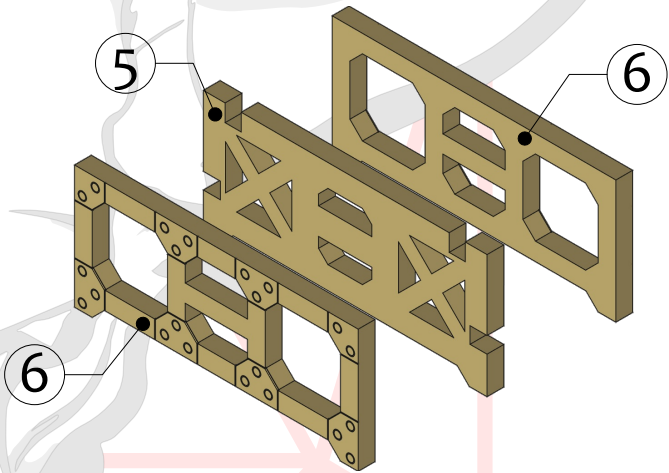

3x



Industrial Complex

Upper Support Wall 2

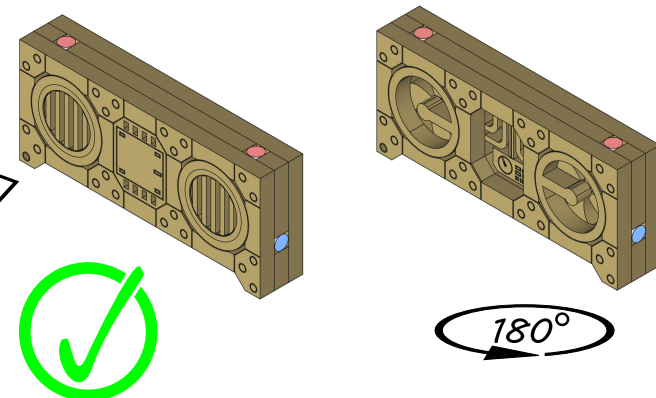
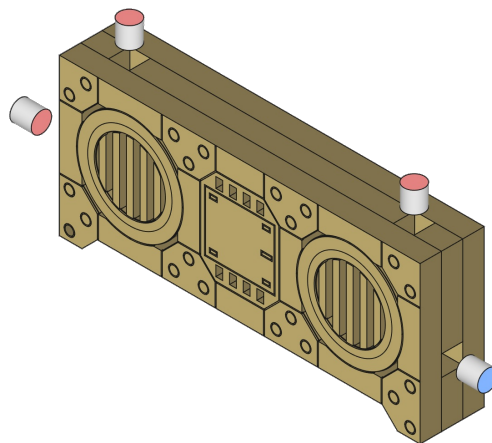
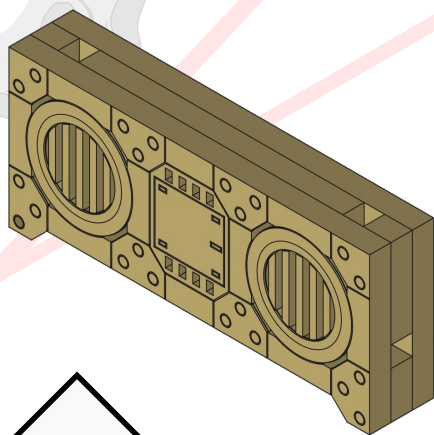
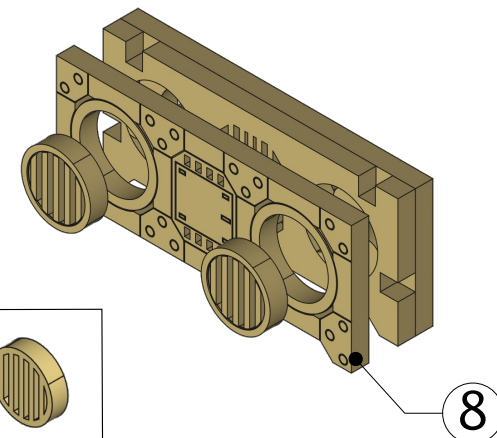
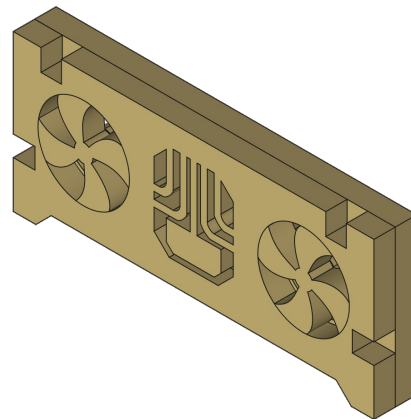
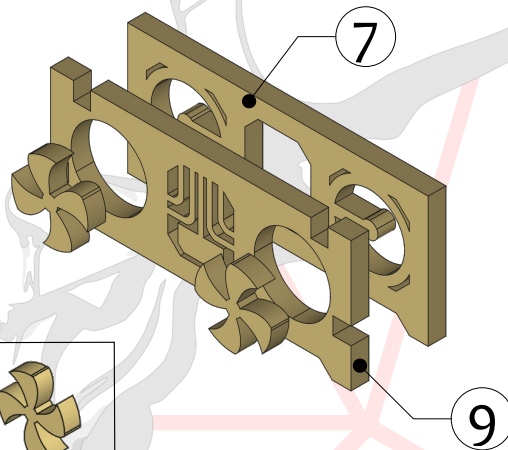

3x



180°

Industrial Complex

Hex Platform

Part 1

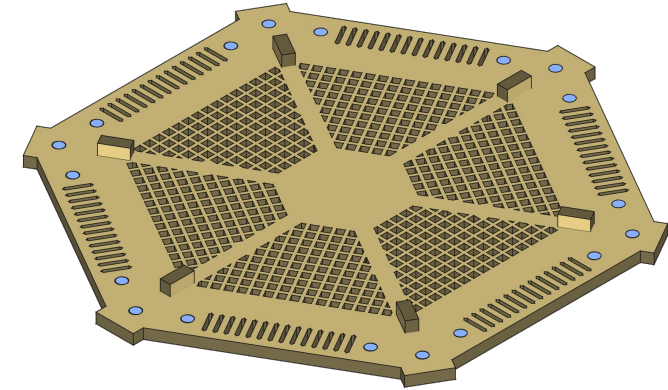
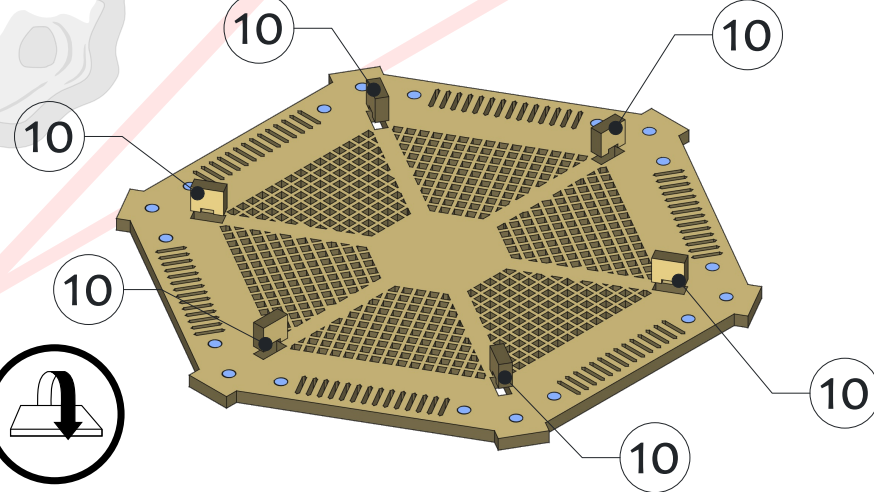
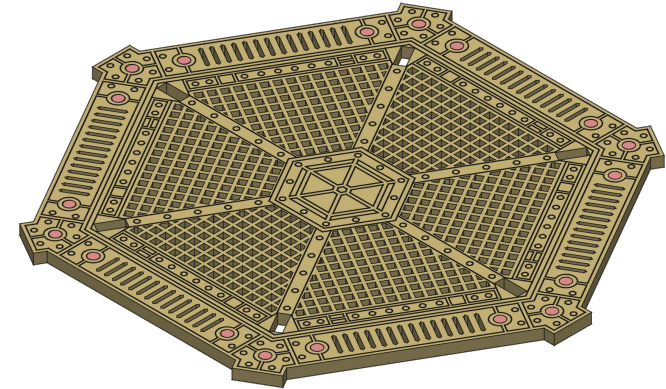
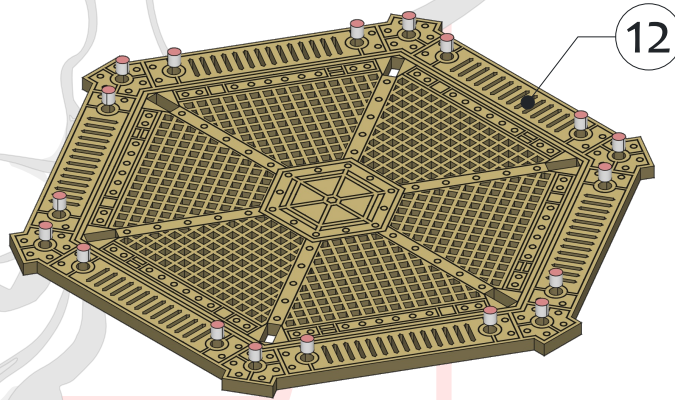

Industrial Complex

Part 2

Hex Platform

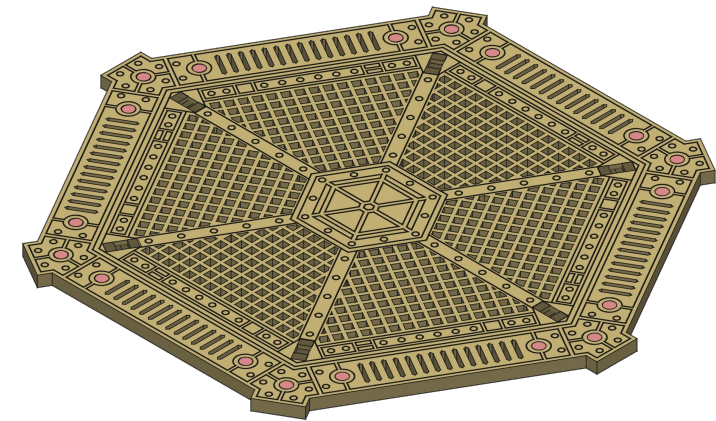
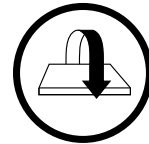
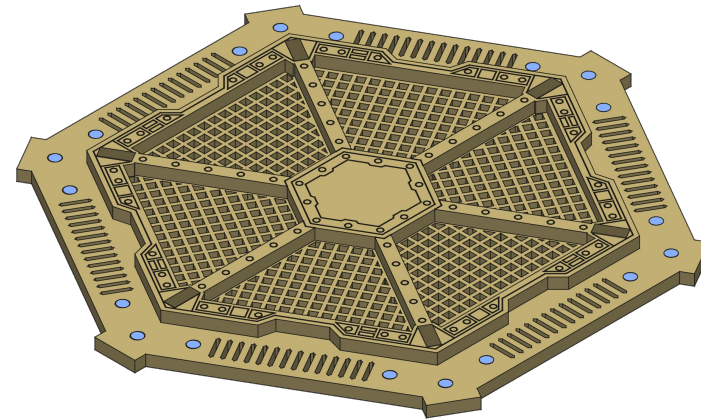
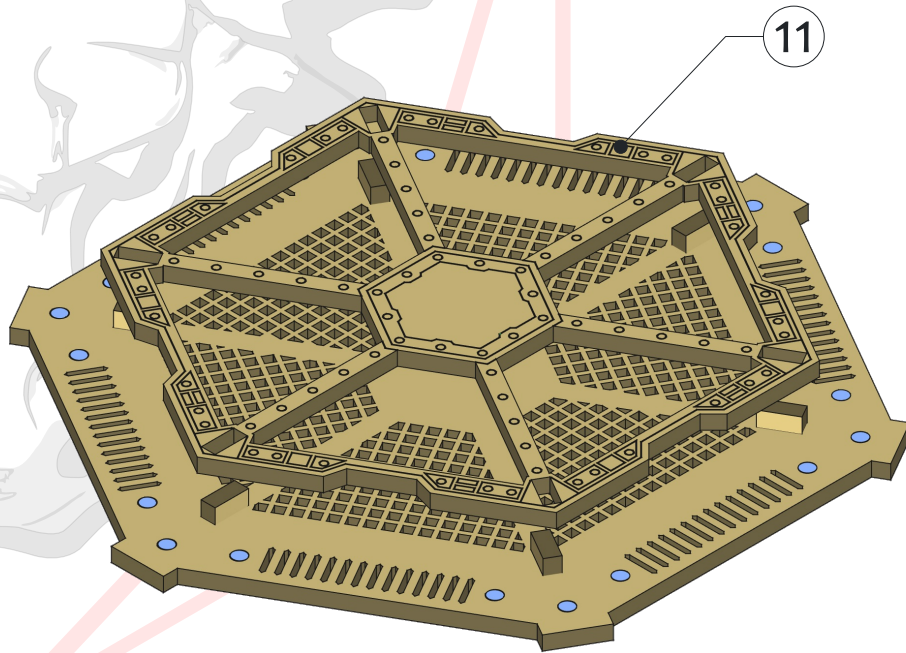

Industrial Complex

Ladder, 1x Tall

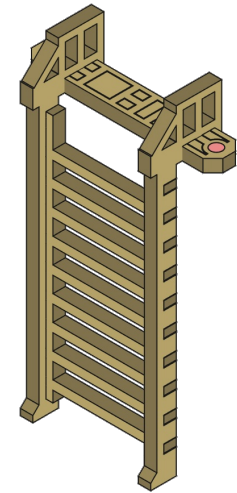
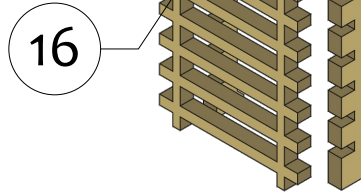
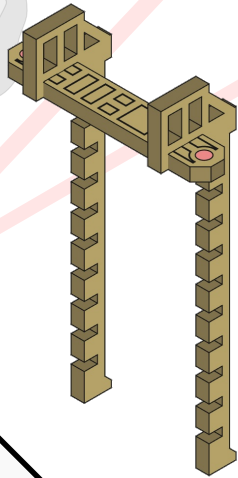
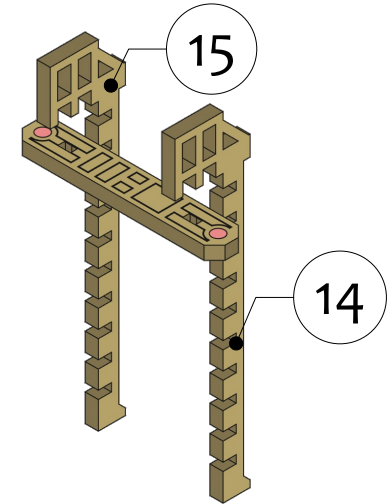
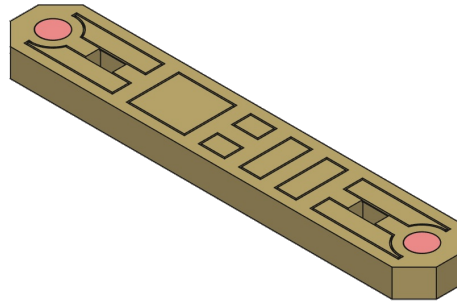
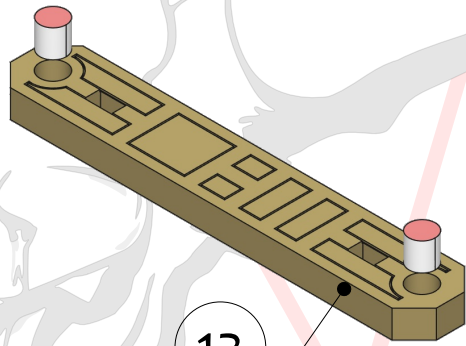

2x



Industrial Complex

Guard Railing

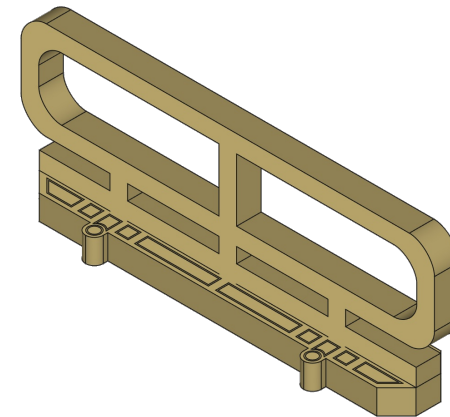
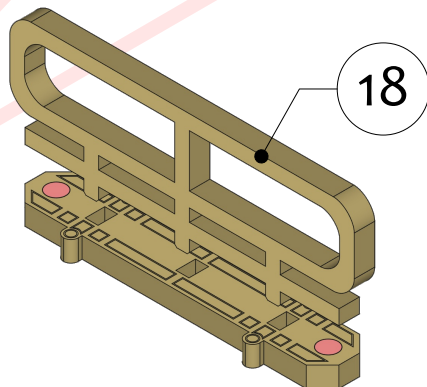
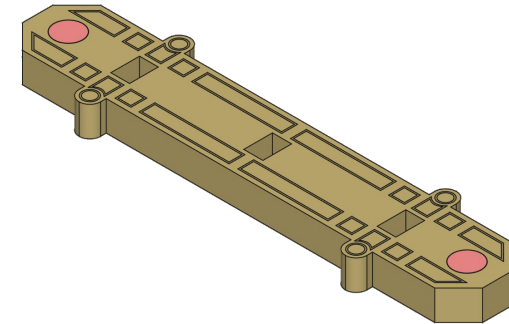
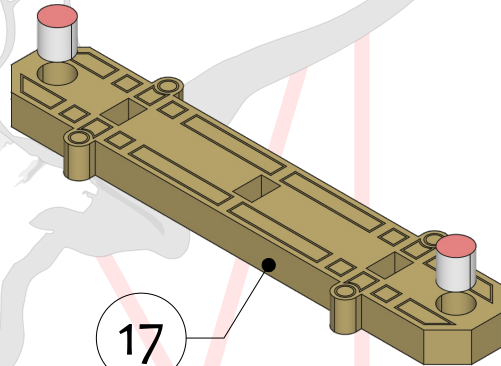

4x



Industrial Complex

Hex Floor

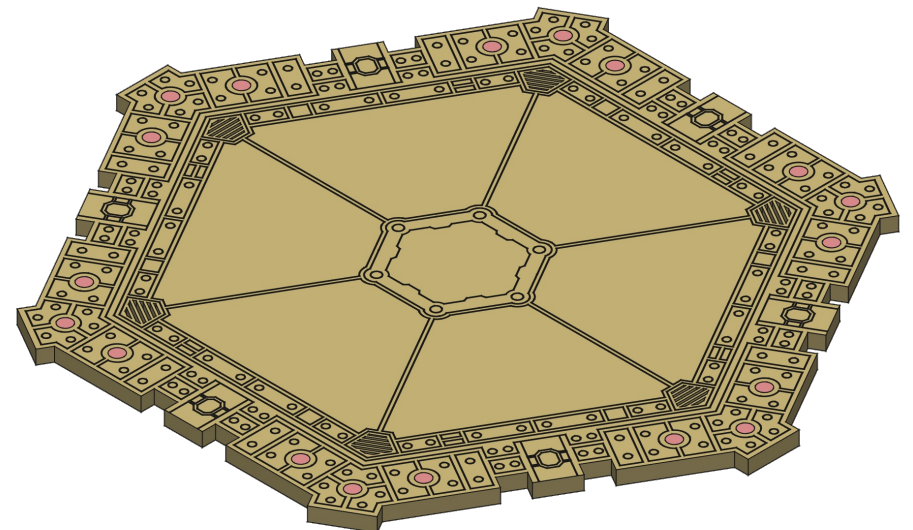
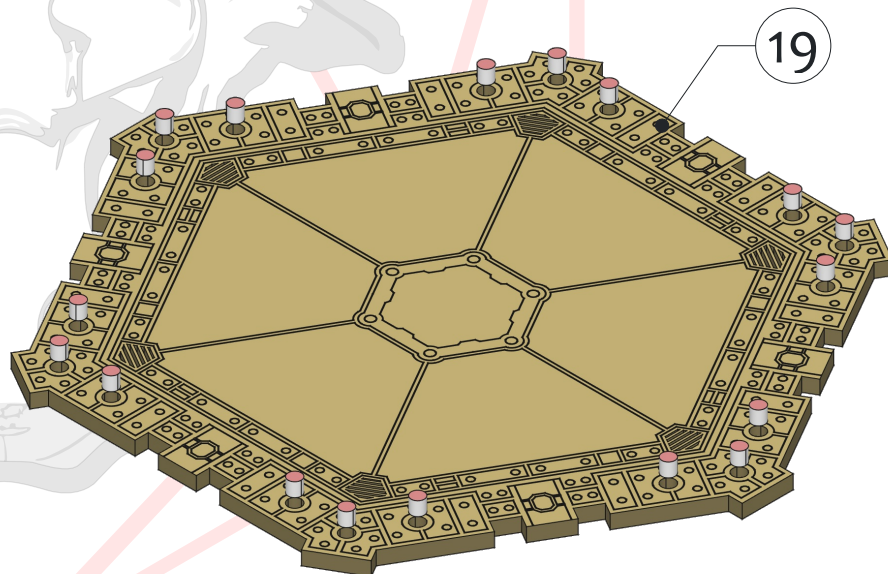

Industrial Complex – Hex Platform (IC-K002)

Part List

Module	Part	Qty.	Piece #	Pages
Girder Column – Triangle, 1x Tall (IC-MC001)	IC-CW0101	18	1	2
	IC-CB0102	6	2	2
	IC-CB0202	6	3	2
	IC-CS0003	18	4	2
Upper Support Wall 1 (IC-MW001)	IC-WW1101	3	5	3
	IC-WW1102	6	6	3
Upper Support Wall 2 (IC-MW002)	IC-WW1103	3	7	4
	IC-WW1104	3	8	4
	IC-WW1105	3	9	4
Hex Platform (IC-MR001)	IC-RK001	6	10	5
	IC-RH002	1	11	5
	IC-RH001	1	12	5
Ladder, 1x Tall (IC-ML001)	IC-RL001	2	13	6
	IC-RL002	2	14	6
	IC-RL003	2	15	6
	IC-RL004	2	16	6
Guard Railing (IC-MA001)	IC-RR001	4	17	7
	IC-RR002	4	18	7
Hex Floor (IC-FH003)	IC-FH003	1	19	8
BS TOOL	BSTOOL	1	*	N/A

