

# Industrial Complex

## Square Platform

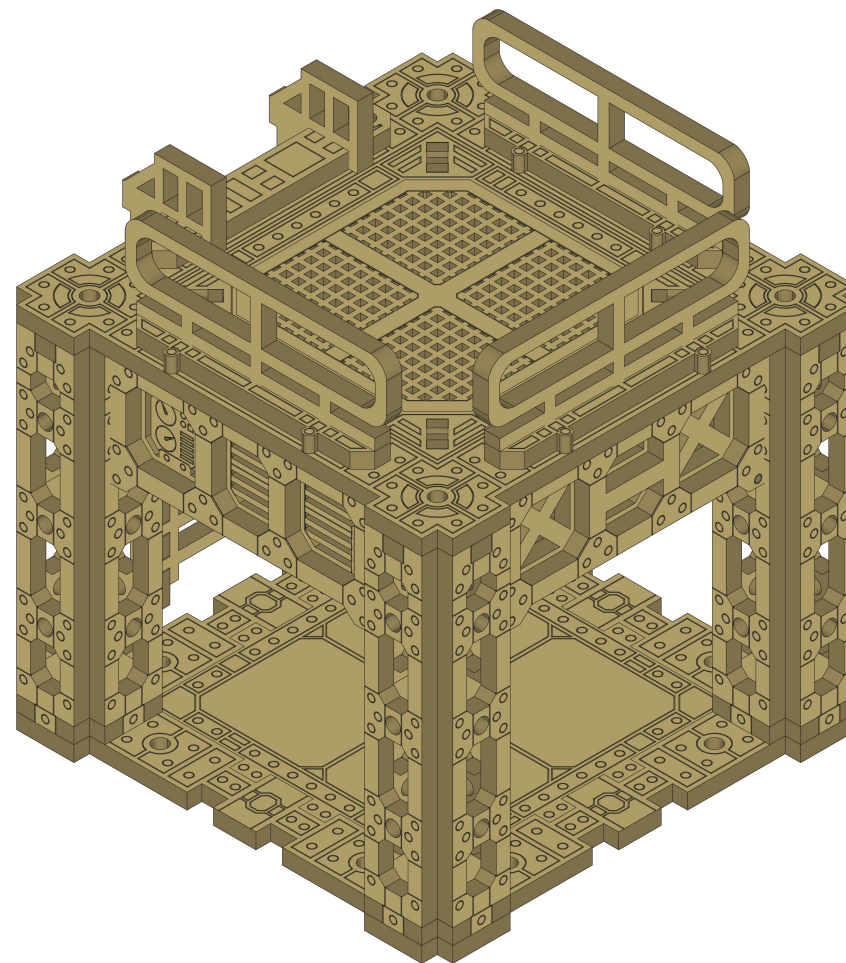
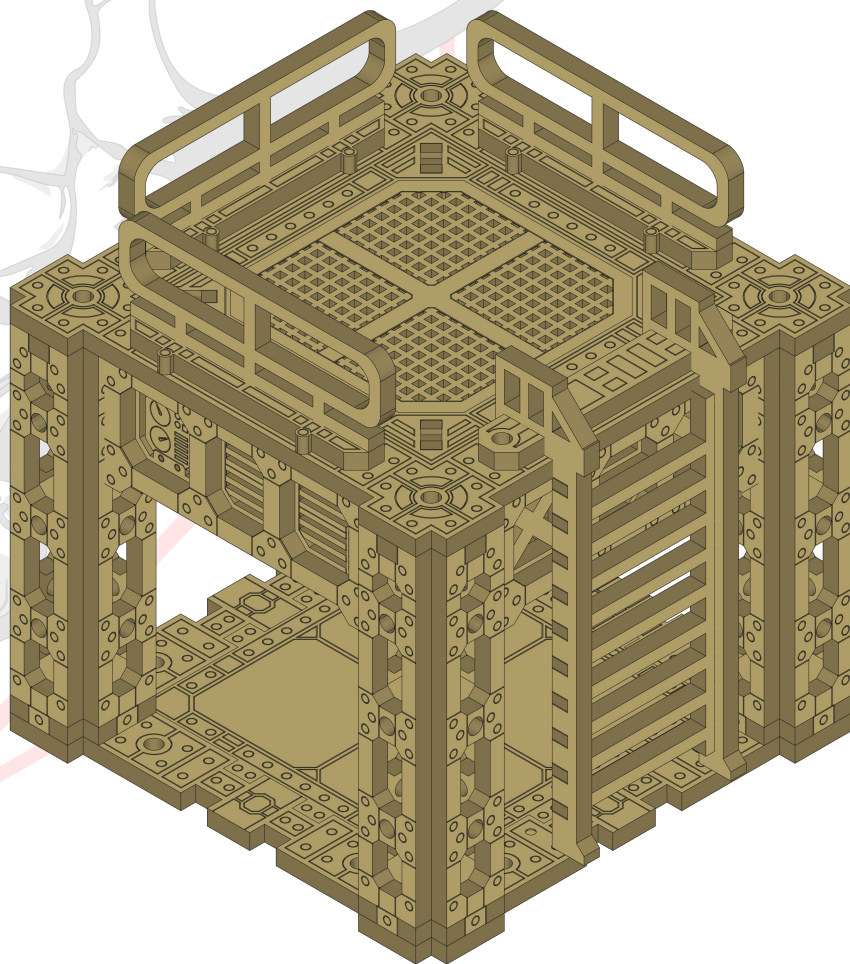

66 Pieces

Requires 104 3mm x 3mm neodymium magnets.



# Magnets

## Tips and Tricks for Your Success.

### WHAT IS POLARITY?

Magnets have a north (+) and a south (-) pole. Opposite poles attract each other and like poles repel. You can't easily tell which side is north or south. In these instructions, red is north and blue is south.

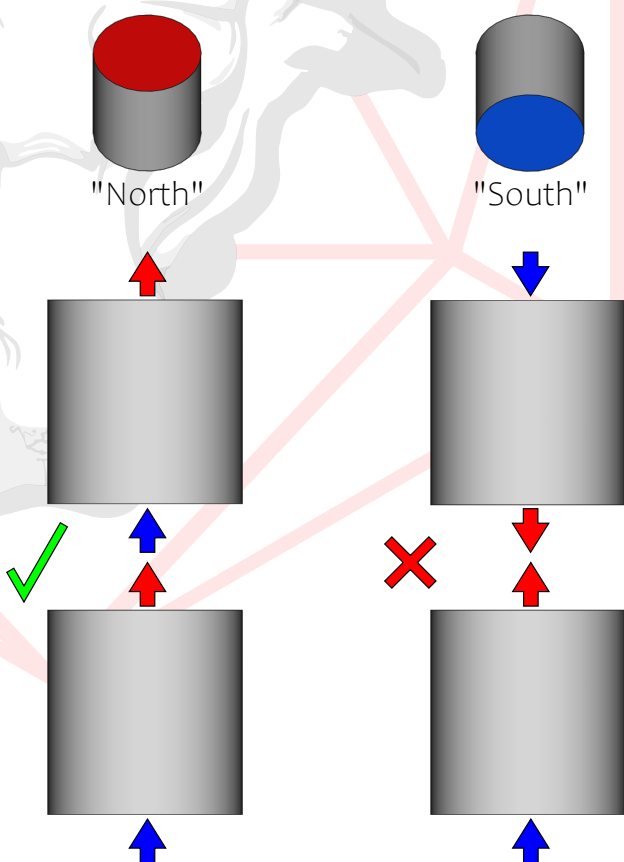

### BE CONSISTENT

Because you won't really know which side is north or south, just pick a direction and stick with it. Make one piece and use that to be your guide for the rest.

Apply magnets in a stack.  
This ensures they are facing the same direction.

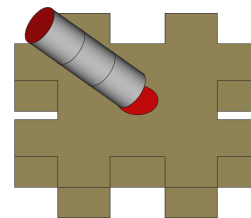

Insert the magnets when the pieces are loose.  
Make sure they are flush to the exterior side of the piece.

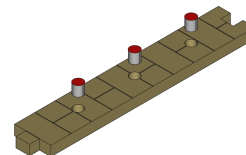
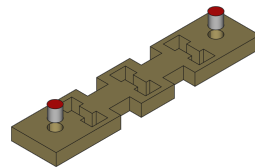

Apply CA glue (super glue) to the back of the magnets.  
This will prevent them from falling out or being pulled out.

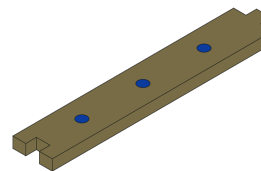

### ALIGNMENT

After assembly is finished, the polarities should look like this.  
Walls connect horizontally to columns.  
Everything stacks vertically.

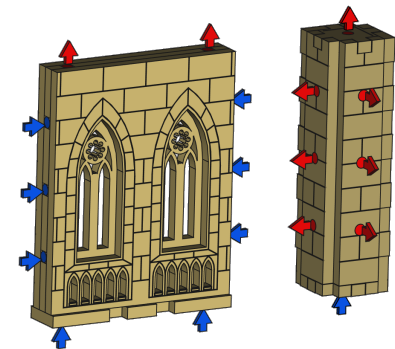

For your convenience, we provide a helper tool in every kit.  
This "BSTOOL" has labels to help with aligning your magnets.  
Use the tool as if it was a column or wall.  
It can also be used to poke pieces out of their sheet or apply glue.

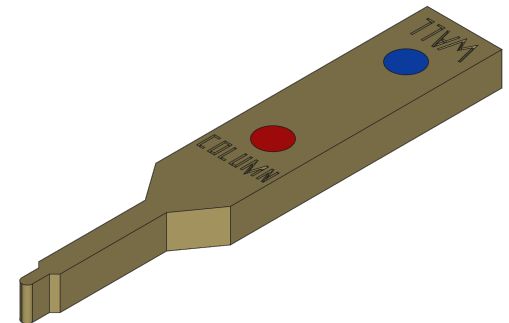

# Industrial Complex

## Girder Column - Square, 1x tall

Part 1

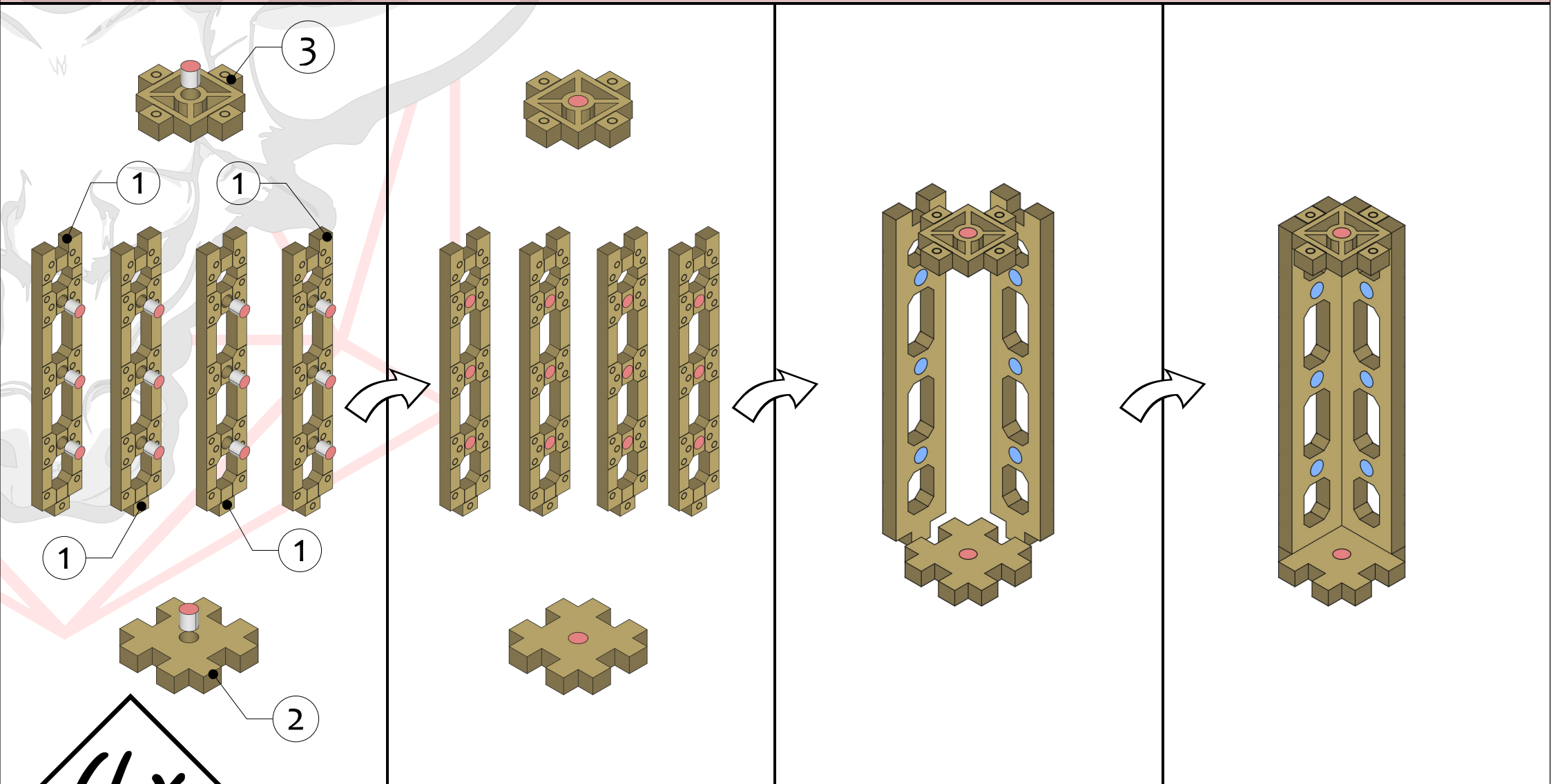

# Industrial Complex

Girder Column - Square, 1x tall

Part 2

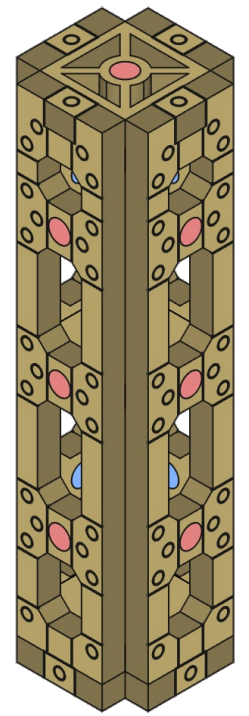
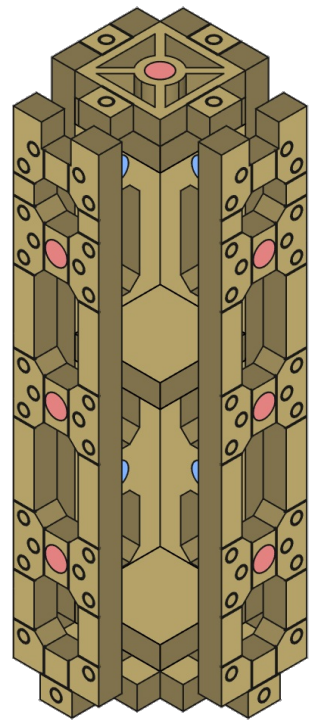
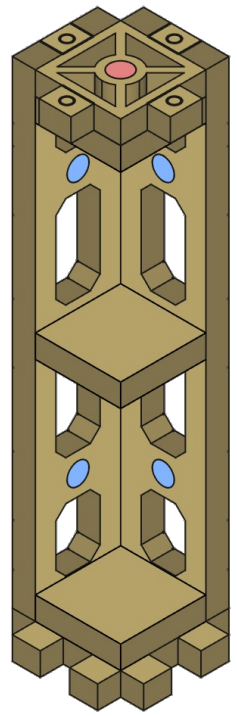
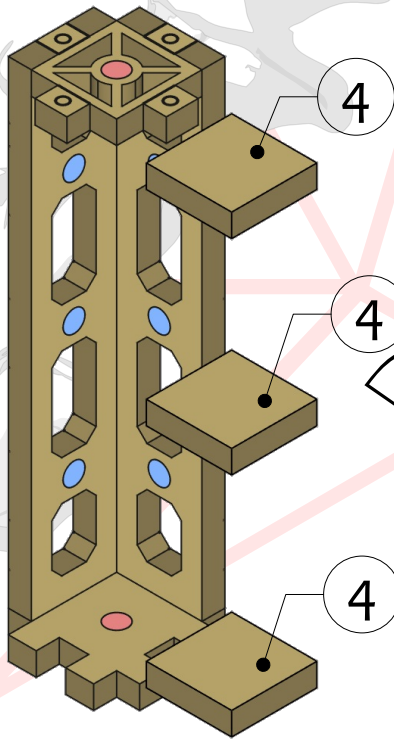

4x





# Industrial Complex

## Square Platform

Part 1

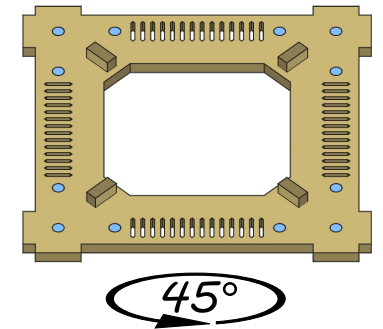
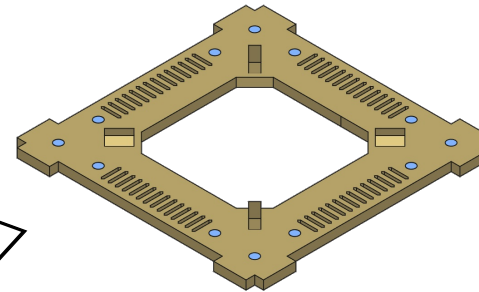
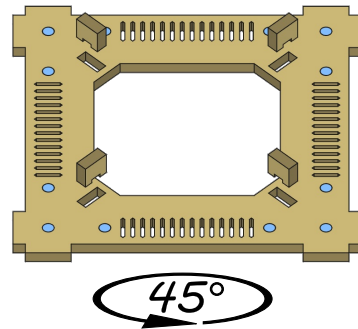
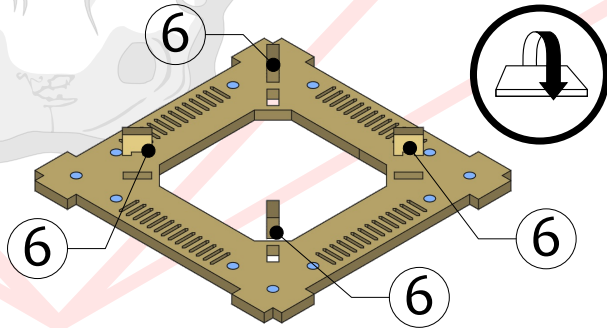
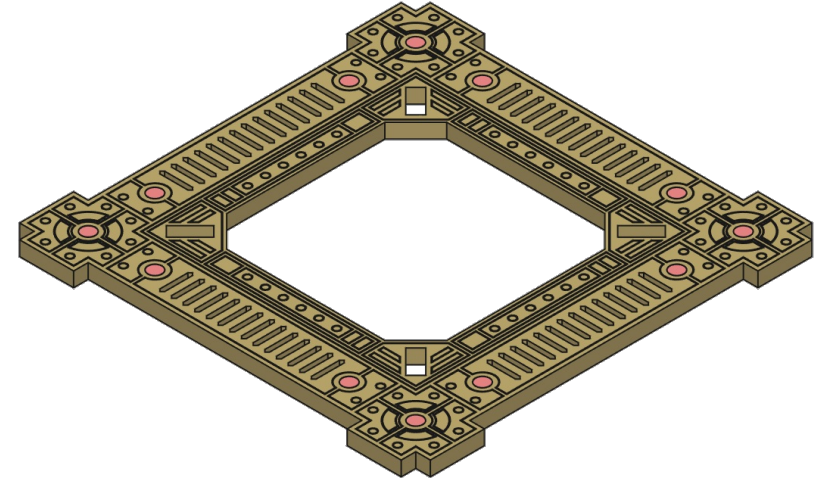
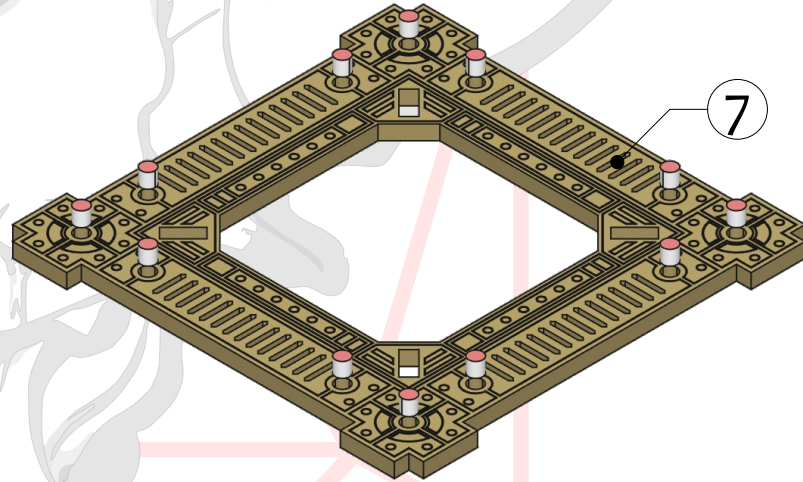

# Industrial Complex

## Part 2

## Square Platform

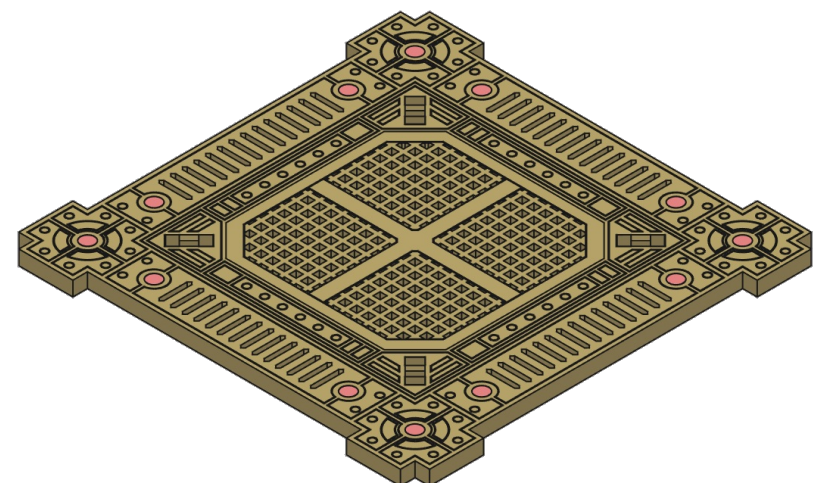
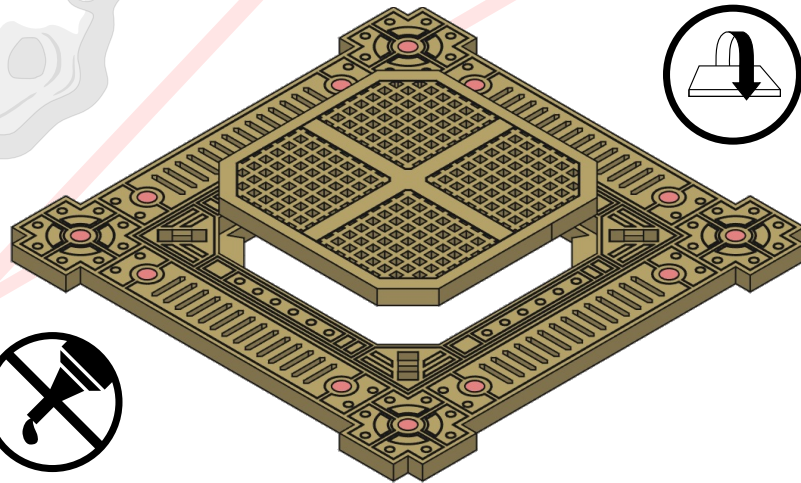
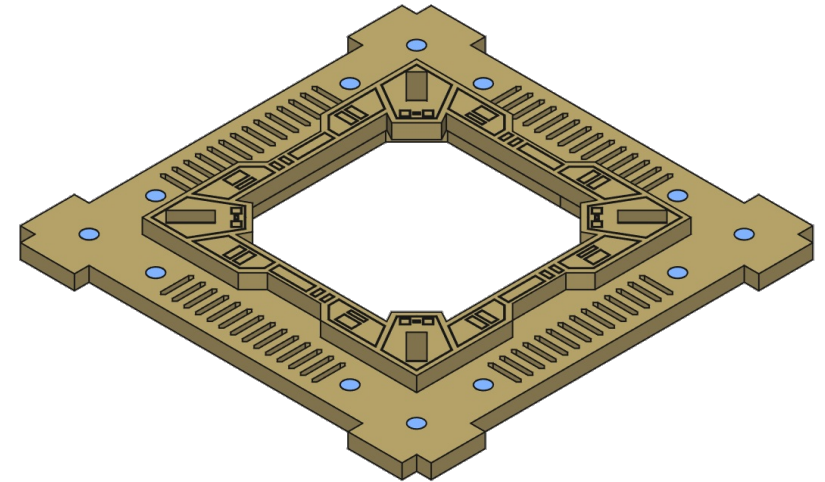
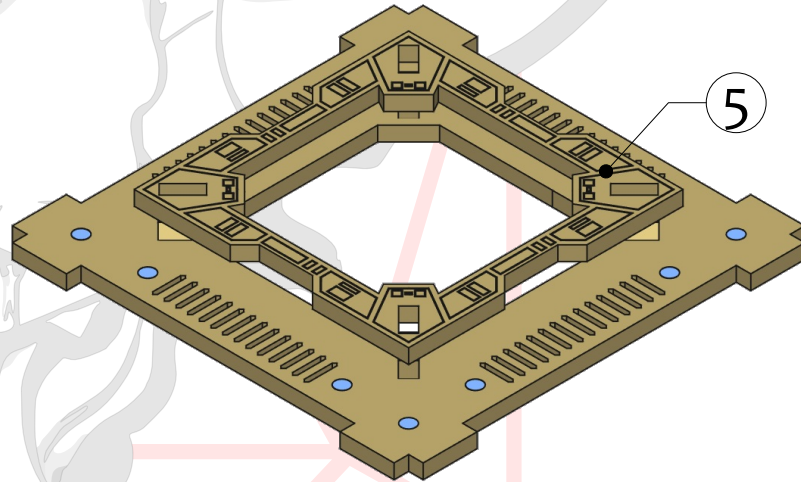

\*The platform inset is meant to be removable.



# Industrial Complex

## Guard Railing

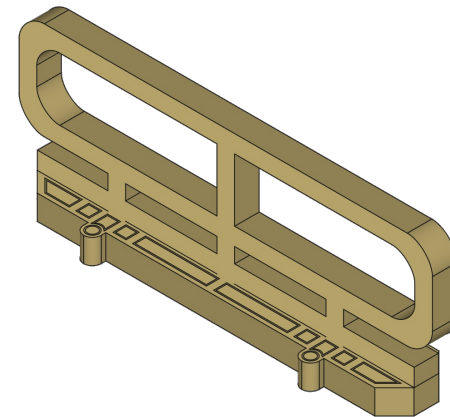
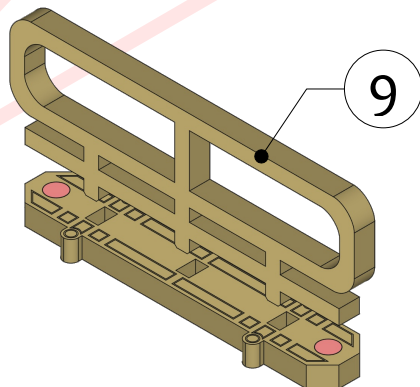
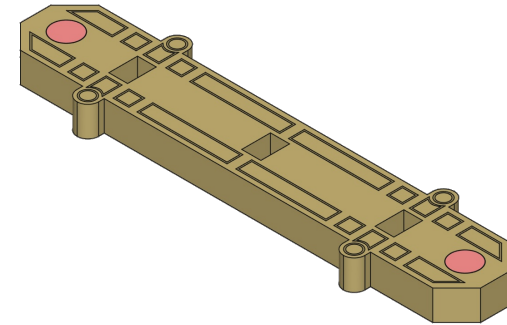
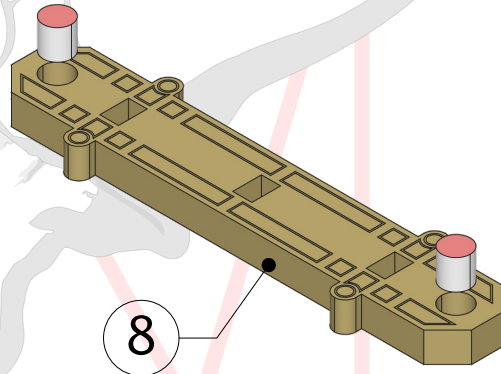

3x





# Industrial Complex

## Square Floor

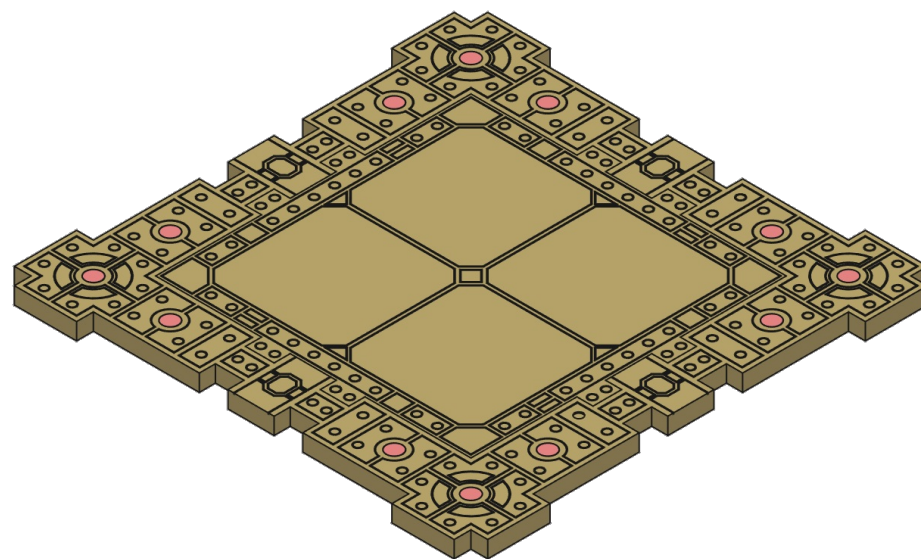
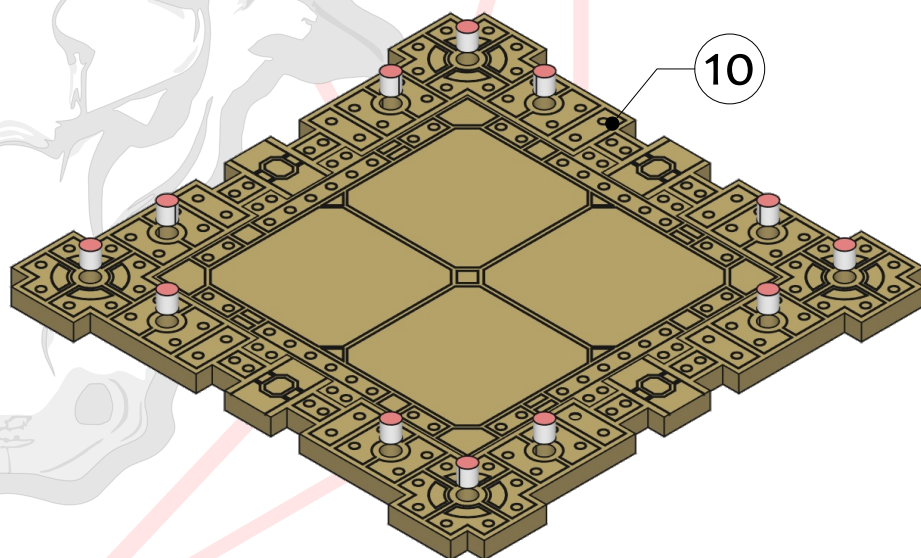

\*The floor inset is meant to be removable.





# Industrial Complex

## Ladder, 1x Tall

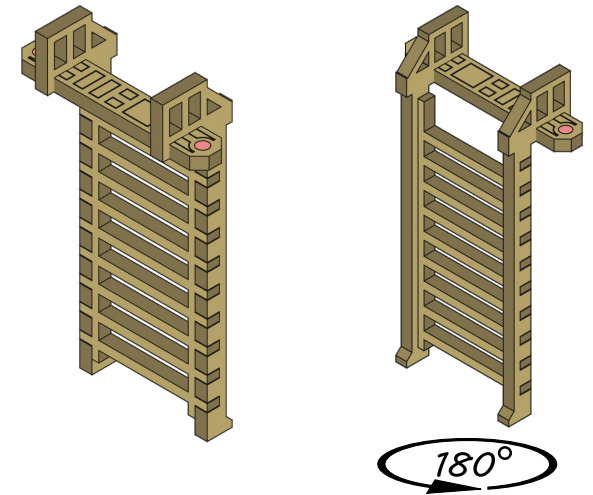
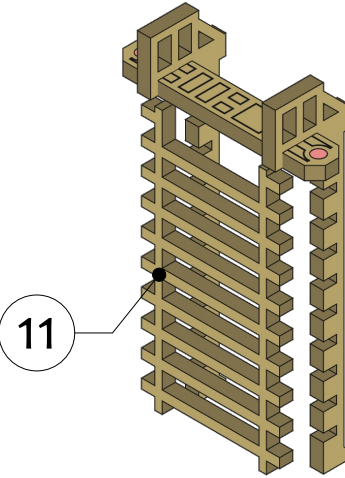
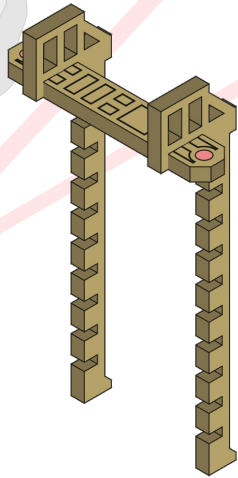
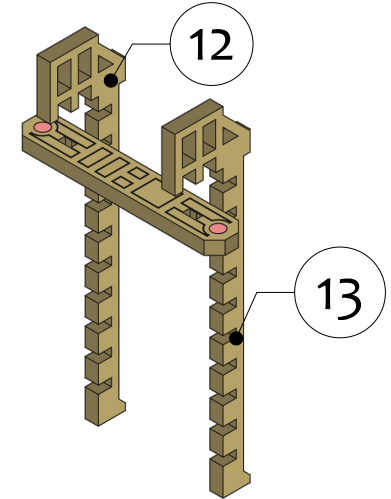
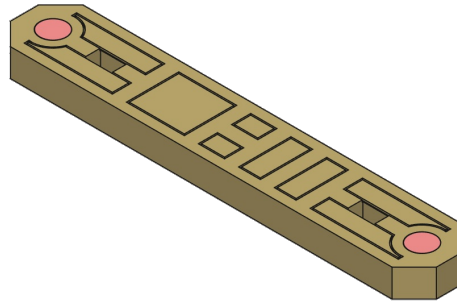
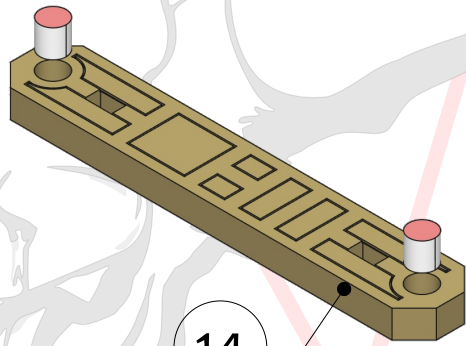

# Industrial Complex

## Upper Support Wall 1

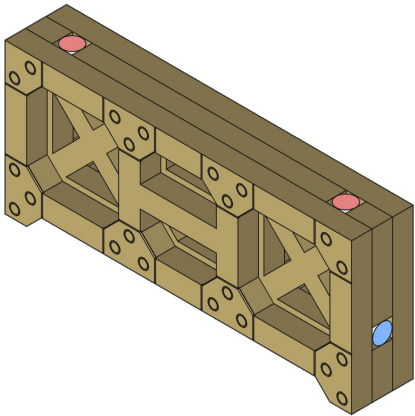
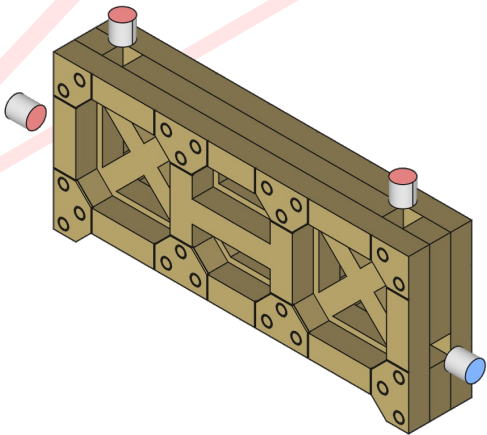
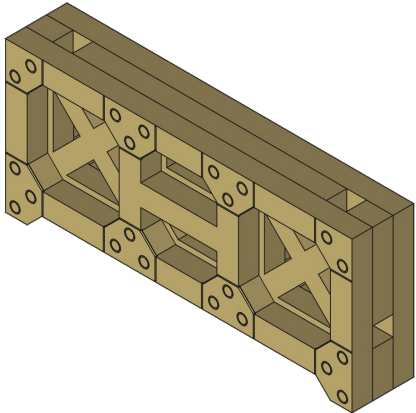
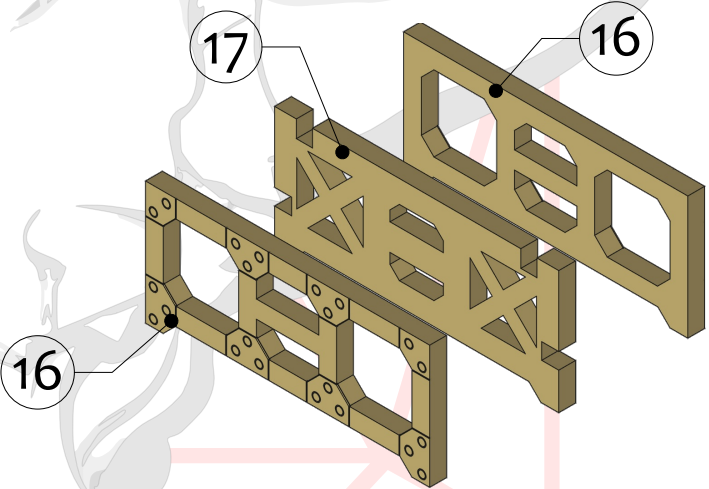

2x



# Industrial Complex

## Upper Support Wall 3

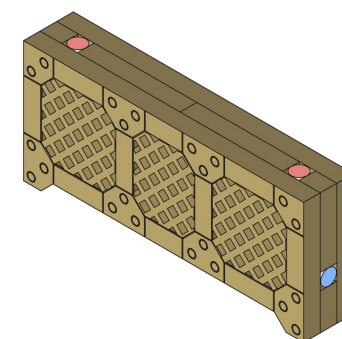
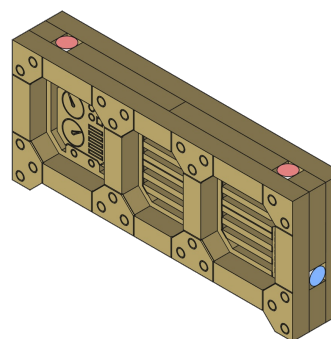
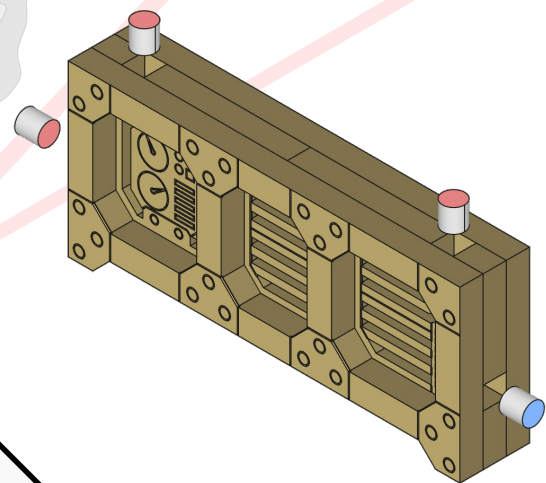
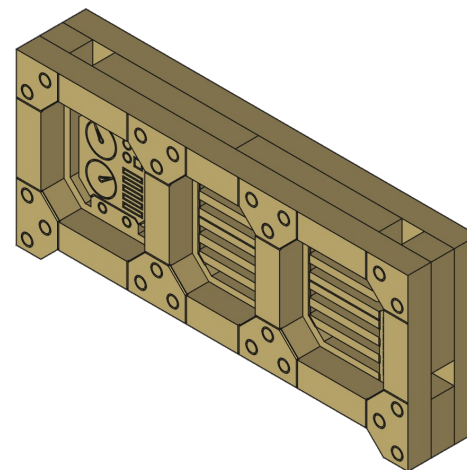
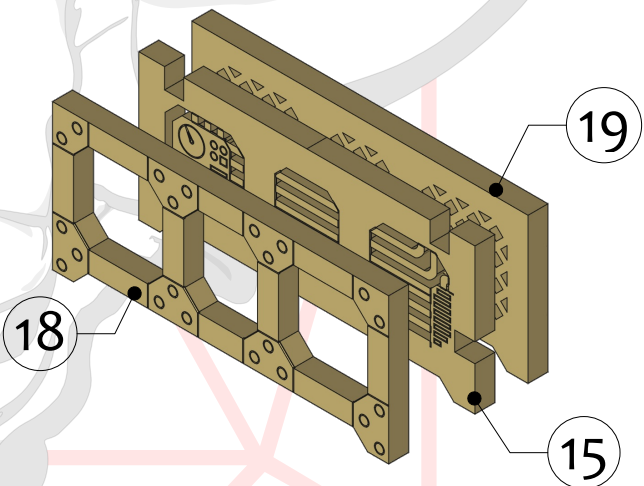

2x



# Industrial Complex – Square Platform (IC-K001)

## Part List

Module	Part	Qty.	Piece #	Pages
Girder Column – Square, 1x Tall (IC-MC002)	IC-CW0101	16	1	2
	IC-CB0102	4	2	2
	IC-CB0202	4	3	2
	IC-CS0003	12	4	3
Square Platform (IC-MR002)	IC-RK001	4	6	4
	IC-RS001	1	7	4
	IC-RS002	1	5	5
Guard Railing (IC-MA001)	IC-RR001	3	8	6
	IC-RR002	3	9	6
Square Floor (IC-FS003)	IC-FS003	1	10	7
Ladder, 1x Tall (IC-ML001)	IC-RL002	1	12	8
	IC-RL003	1	13	8
	IC-RL001	1	14	8
	IC-RL004	1	11	8
Upper Support Wall 1 (IC-MW001)	IC-WW1102	4	16	9
	IC-WW1101	2	17	9
Upper Support Wall 3 (IC-MW003)	IC-WW1108	2	18	10
	IC-WW1107	2	19	10
	IC-WW1106	2	15	10
BS TOOL	BSTOOL	1	*	N/A

