

Gothic Cathedral

Dice Jail

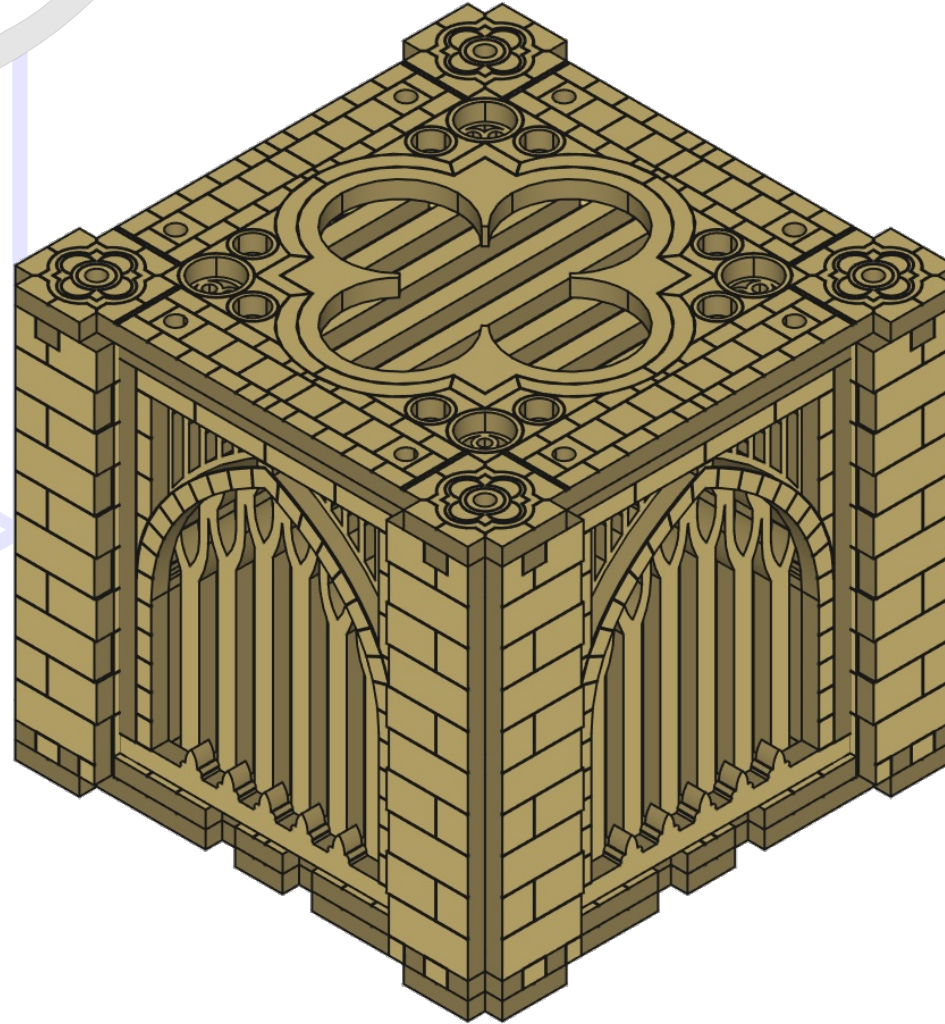

67 Pieces

Requires 96 3mm x 3mm neodymium magnets.



Magnets

Tips and Tricks for Your Success.

WHAT IS POLARITY?

Magnets have a north (+) and a south (-) pole. Opposite poles attract each other and like poles repel. You can't easily tell which side is north or south. In these instructions, red is north and blue is south.

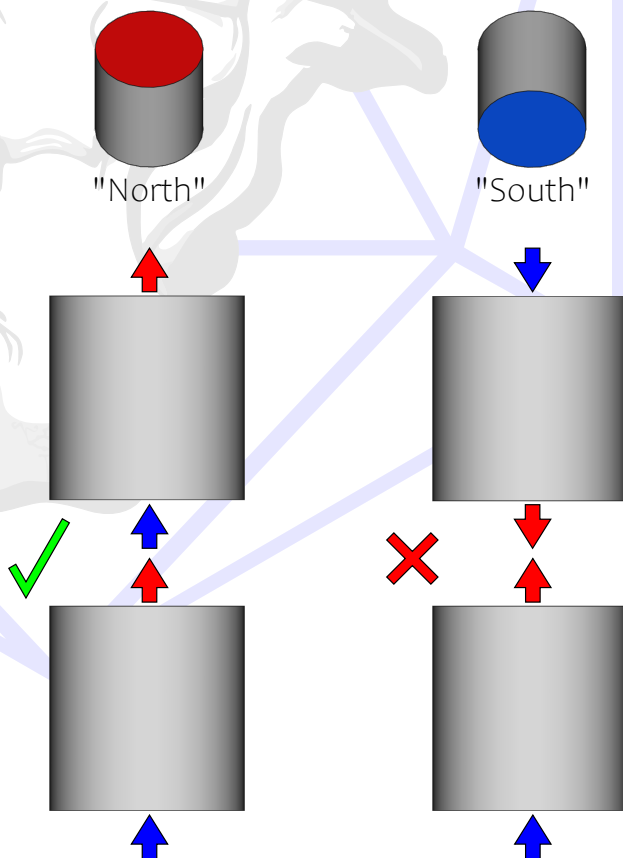

BE CONSISTENT

Because you won't really know which side is north or south, just pick a direction and stick with it. Make one piece and use that to be your guide for the rest.

Apply magnets in a stack.
This ensures they are facing the same direction.

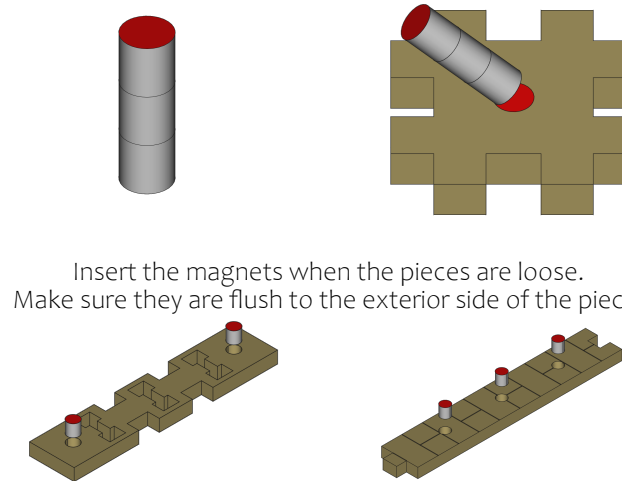

Insert the magnets when the pieces are loose.
Make sure they are flush to the exterior side of the piece.

Apply CA glue (super glue) to the back of the magnets.
This will prevent them from falling out or being pulled out.

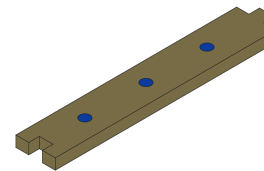

ALIGNMENT

After assembly is finished, the polarities should look like this.
Walls connect horizontally to columns.
Everything stacks vertically.

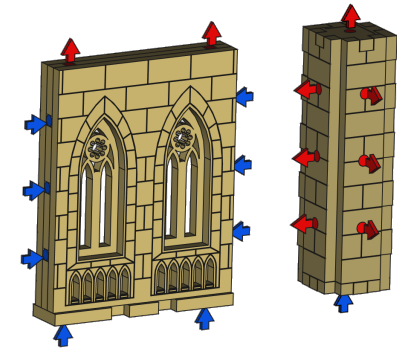

For your convenience, we provide a helper tool in every kit.
This "BSTOOL" has labels to help with aligning your magnets.
Use the tool as if it was a column or wall.
It can also be used to poke pieces out of their sheet or apply glue.

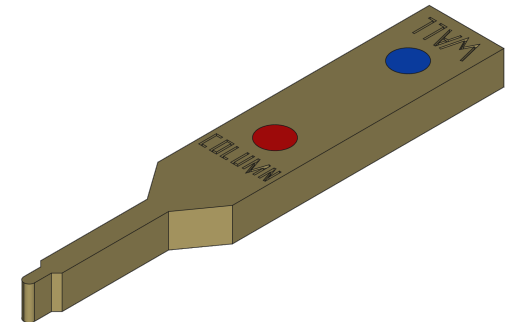

Gothic Cathedral

Flat Faced Corner Column, 1x Tall

Part 1

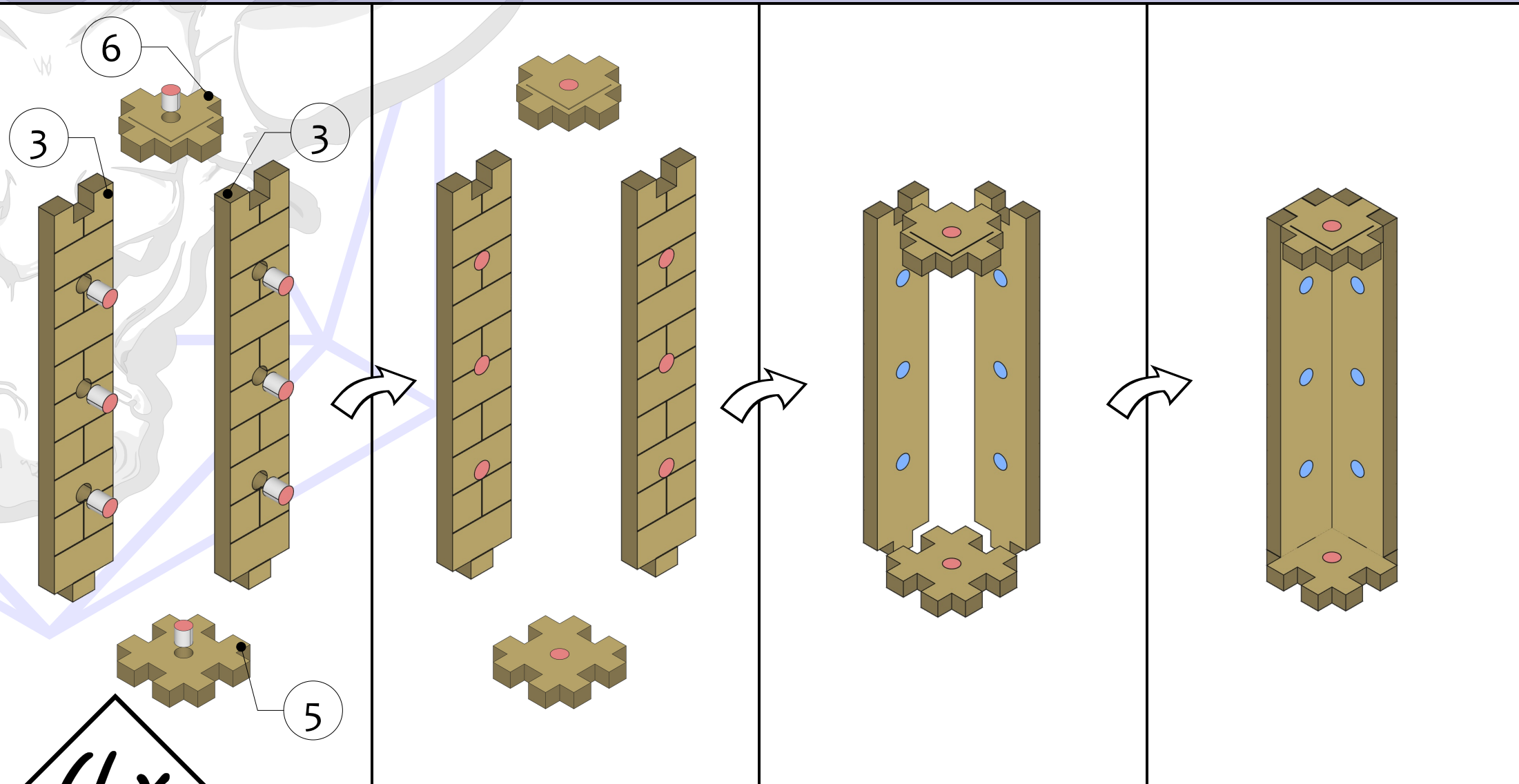

Gothic Cathedral

Flat Faced Corner Column, 1x Tall

Part 2

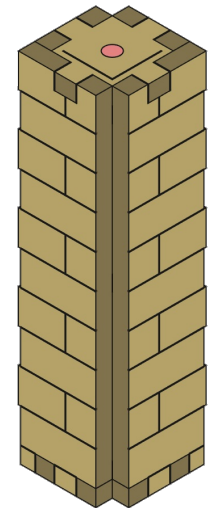
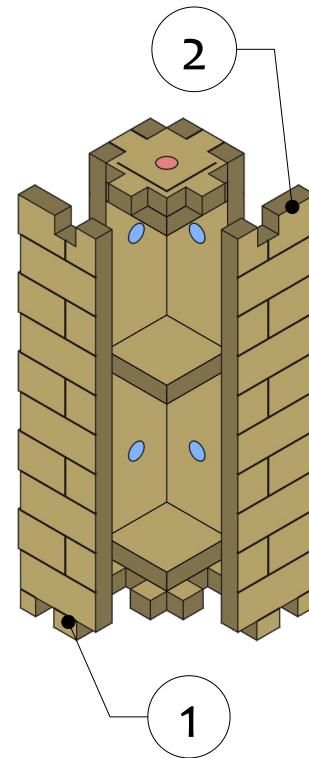
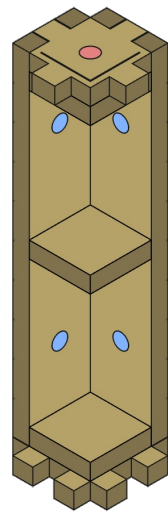
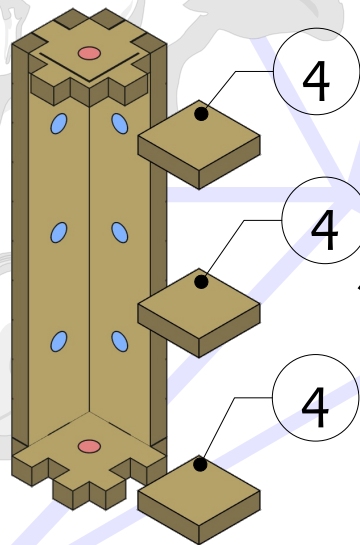

4x



Gothic Cathedral

Ornate Barred Window, 1x Tall

Part 1

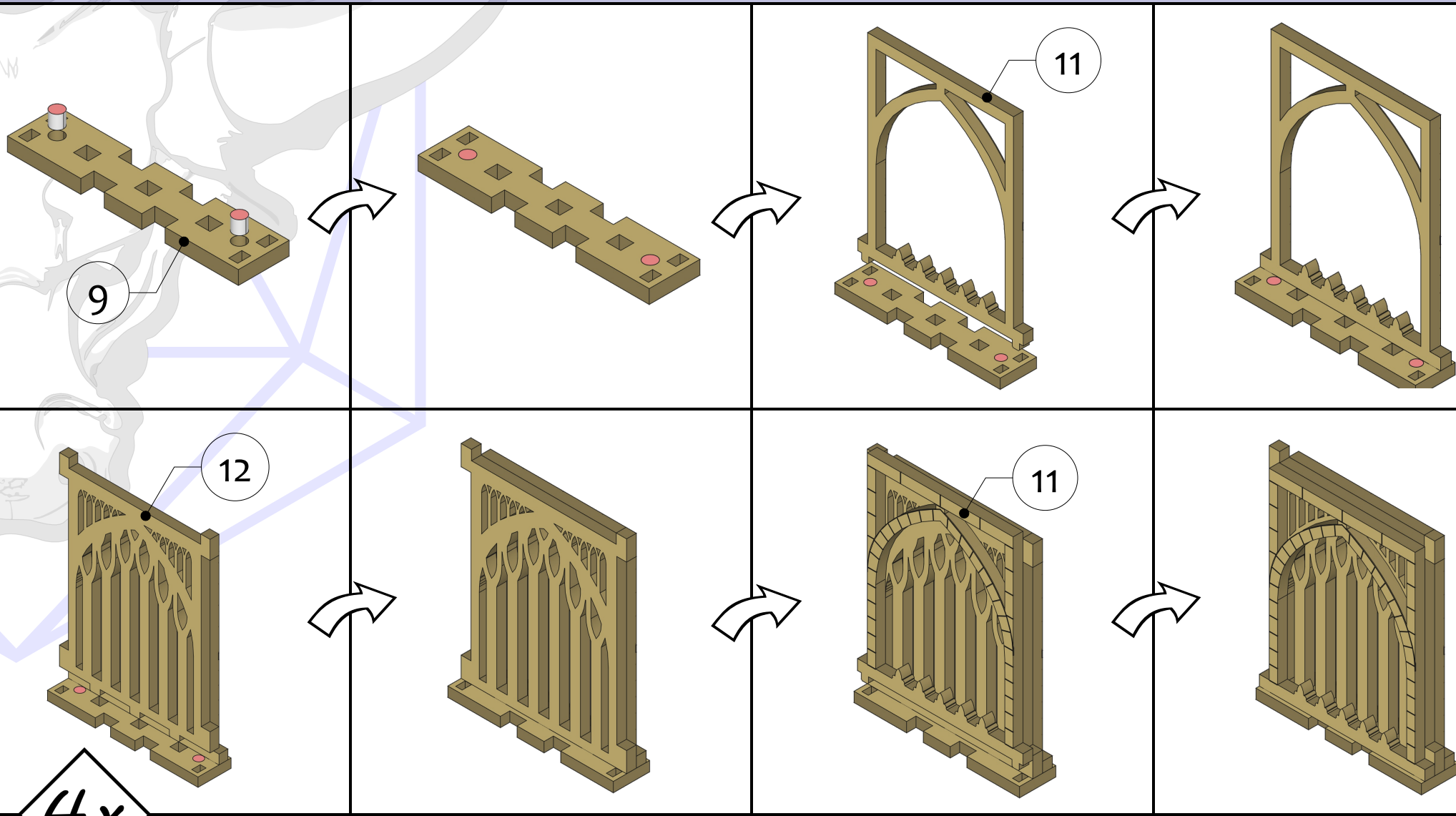

4x



Gothic Cathedral

Ornate Barred Window, 1x Tall

Part 2

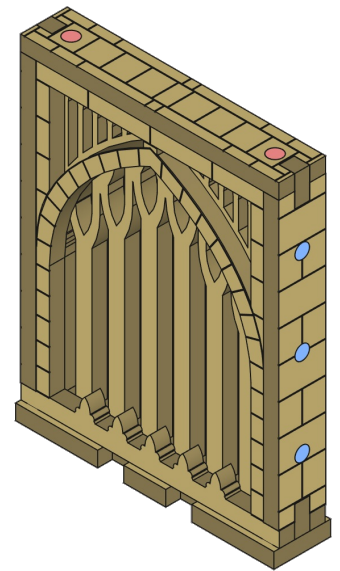
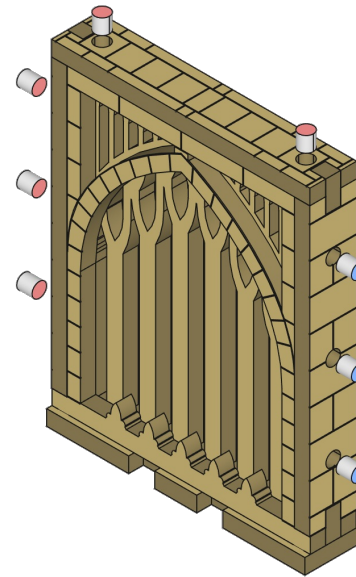
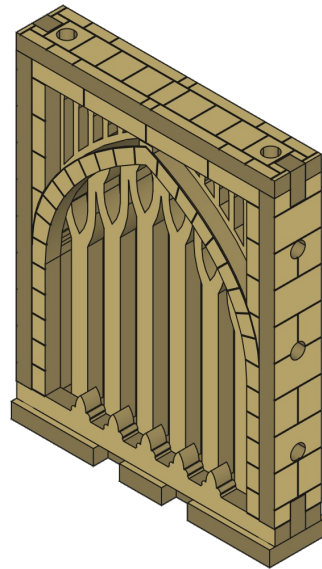
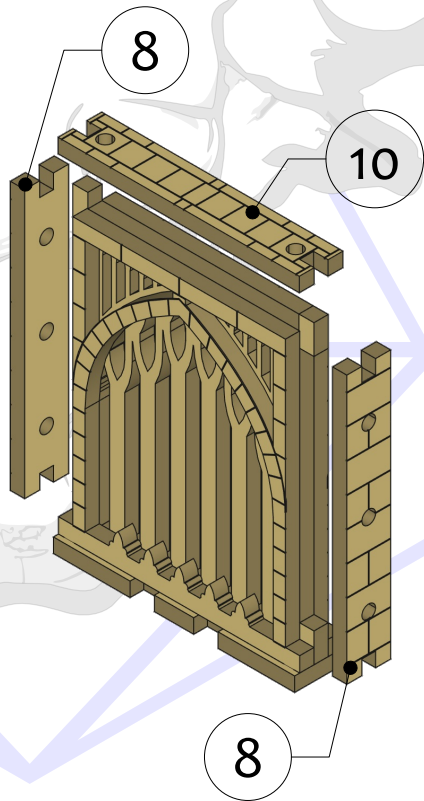

4x



Gothic Cathedral

Ornate Barred Roof

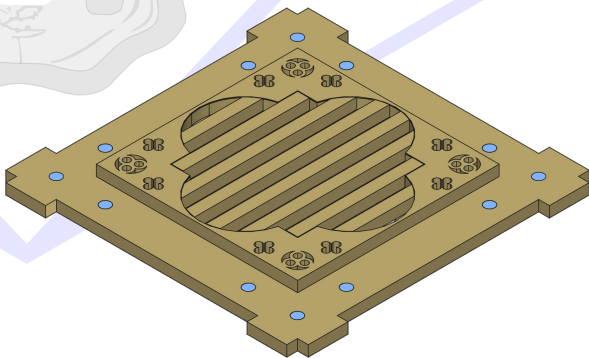
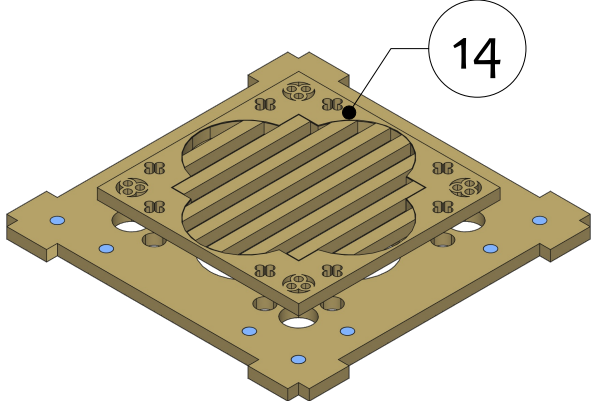
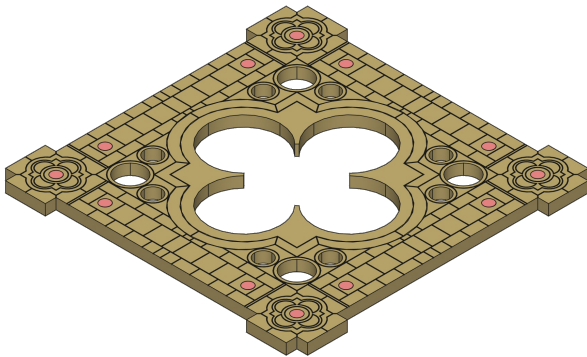
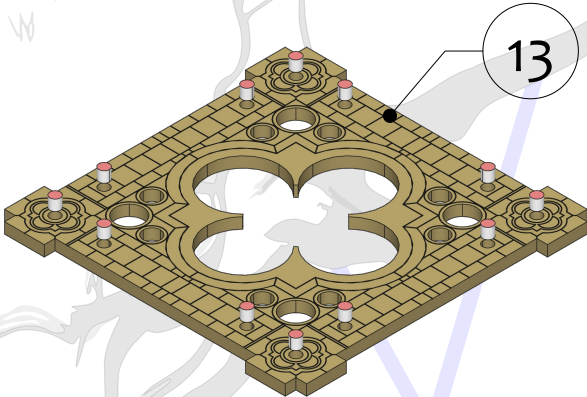

Use these features as guides to help align the pieces.

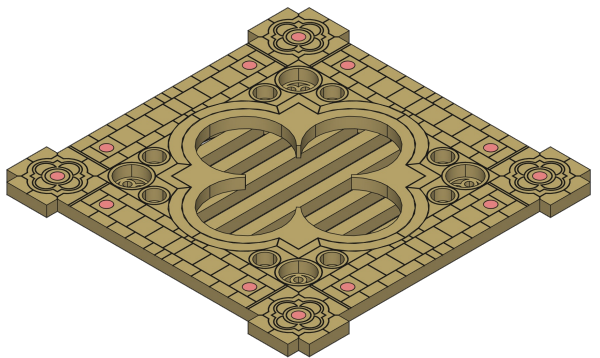
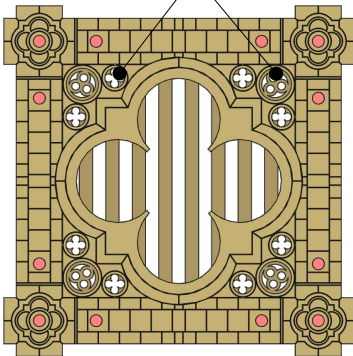

Gothic Cathedral

Square Floor

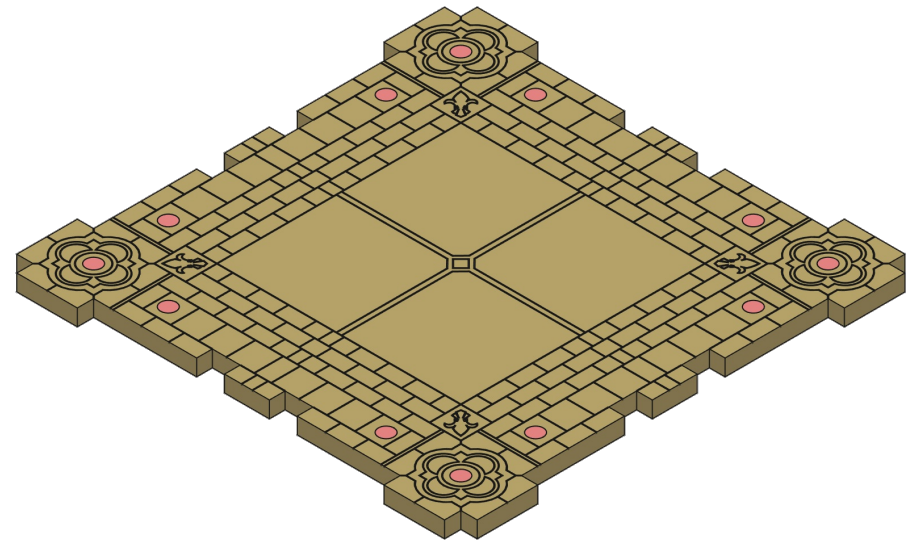
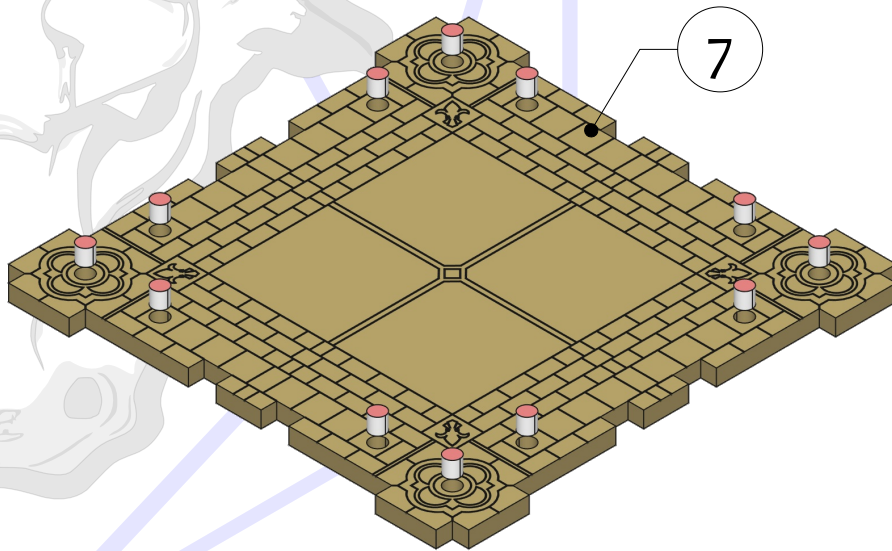

Gothic Cathedral – Dice Jail (GC-K003)

Part List

Module	Part	Qty.	Piece #	Pages
Flat Faced Corner Column, 1x Tall (GC-MC004) x4	GC-CW1102	4	1	2
	GC-CW1103	4	2	2
	GC-CW1101	8	3	2
	GC-CS0001	12	4	2
	GC-CB0101	4	5	2
	GC-CB0201	4	6	2
Ornate Barred Window, 1x Tall (GC-MW009) x4	GC-WB1104	4	9	3
	GC-WW1110	8	11	3
	GC-WW1109	4	12	3
	GC-WS0001	8	8	4
	GC-WT0001	4	10	4
Ornate Barred Roof (GC- MR005)	GC-RS0001	1	13	5
	GC-RS0002	1	14	5
Stone Tiled Floor – Square – Solid (GC-FS0001)	GC-FS0001	1	7	N/A
BSTOOL	BSTOOL	2	*	N/A

