

Gothic Cathedral

Ruined Dice Tower

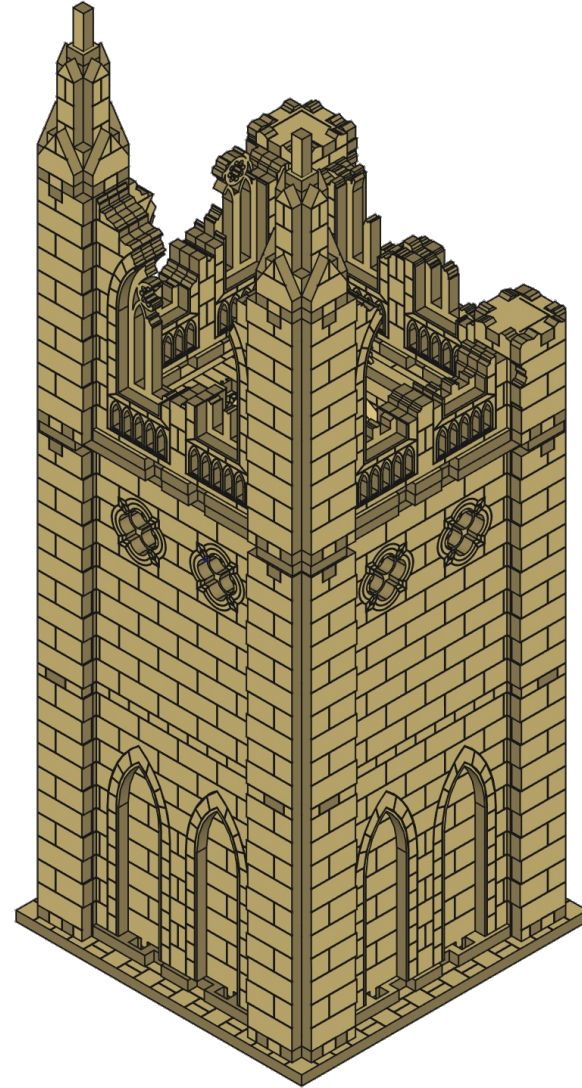
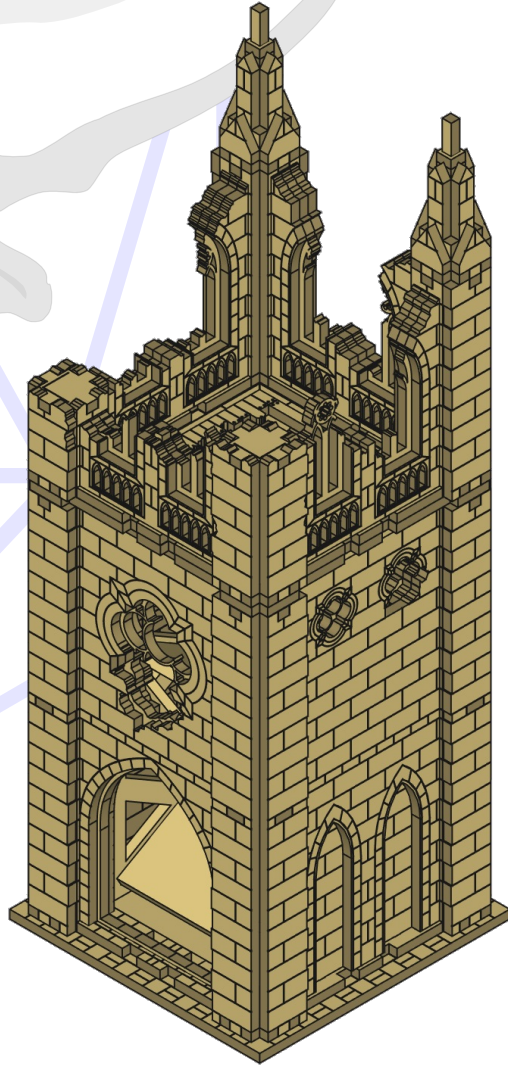

144 Pieces

Requires 208 3mm x 3mm neodymium magnets



Magnets

Tips and Tricks for Your Success.

WHAT IS POLARITY?

Magnets have a north (+) and a south (-) pole. Opposite poles attract each other and like poles repel. You can't easily tell which side is north or south. In these instructions, red is north and blue is south.

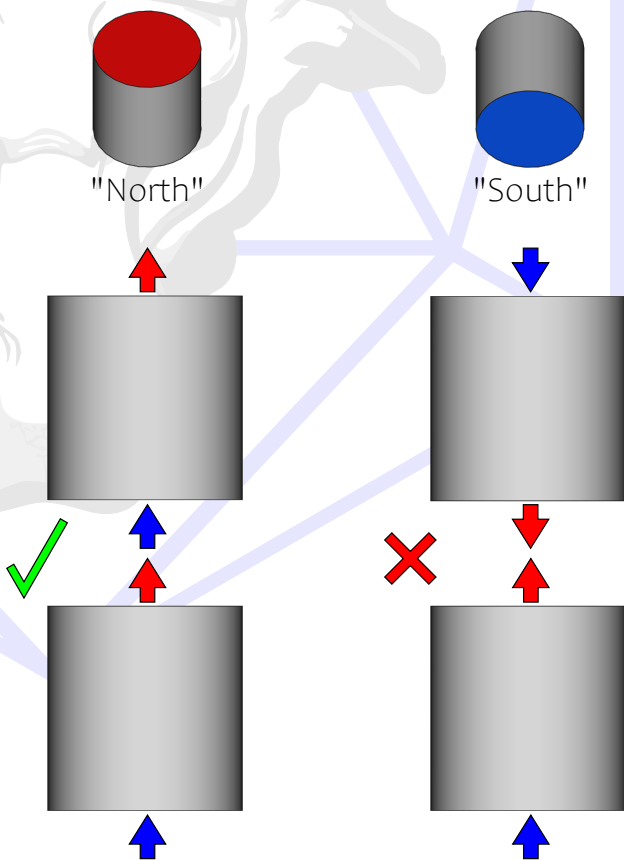

BE CONSISTENT

Because you won't really know which side is north or south, just pick a direction and stick with it. Make one piece and use that to be your guide for the rest.

Apply magnets in a stack.
This ensures they are facing the same direction.

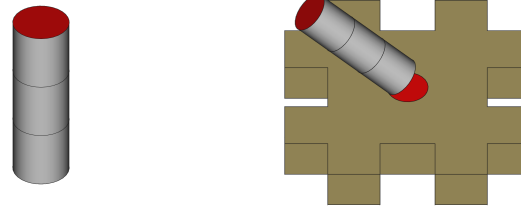

Insert the magnets when the pieces are loose.
Make sure they are flush to the exterior side of the piece.

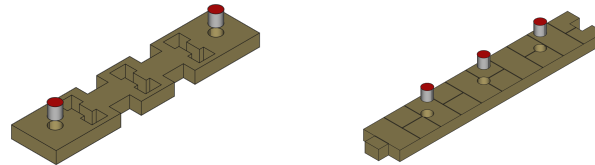

Apply CA glue (super glue) to the back of the magnets.
This will prevent them from falling out or being pulled out.

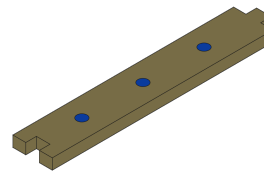

ALIGNMENT

After assembly is finished, the polarities should look like this.
Walls connect horizontally to columns.
Everything stacks vertically.

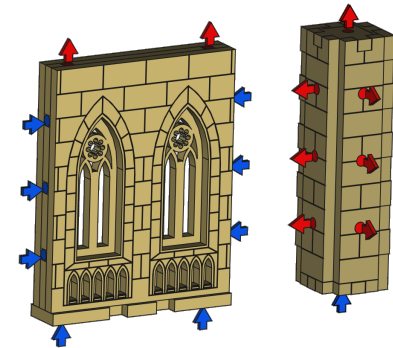

For your convenience, we provide a helper tool in every kit.
This "BSTOOL" has labels to help with aligning your magnets.
Use the tool as if it was a column or wall.
It can also be used to poke pieces out of their sheet or apply glue.

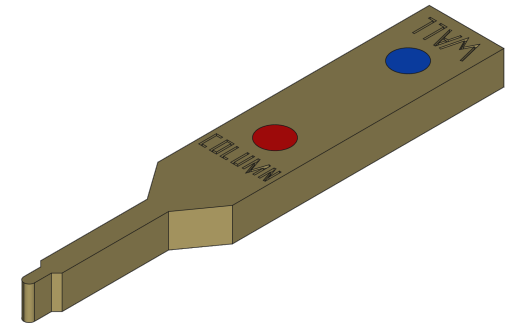

Gothic Cathedral

Flat Faced Corner Column, 2x Tall

Part 1

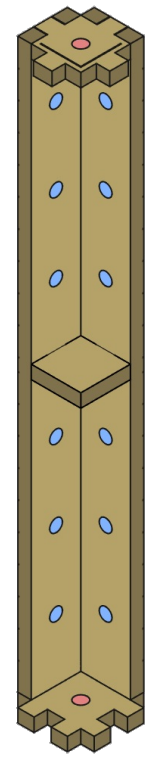
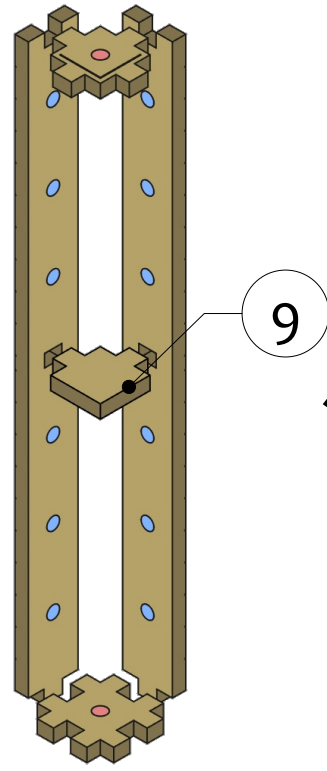
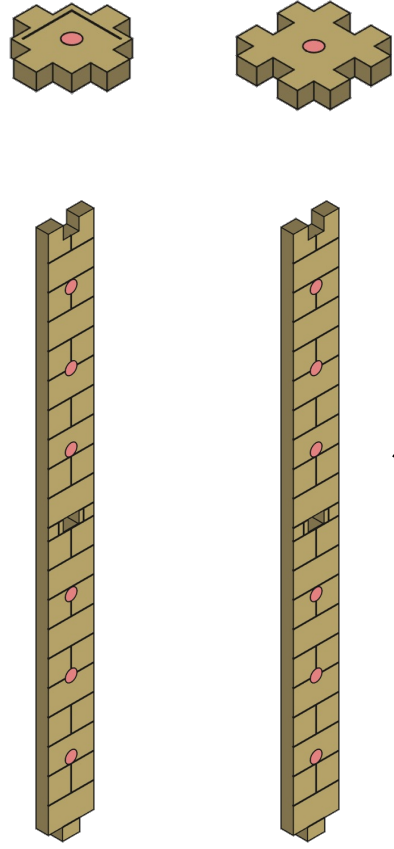
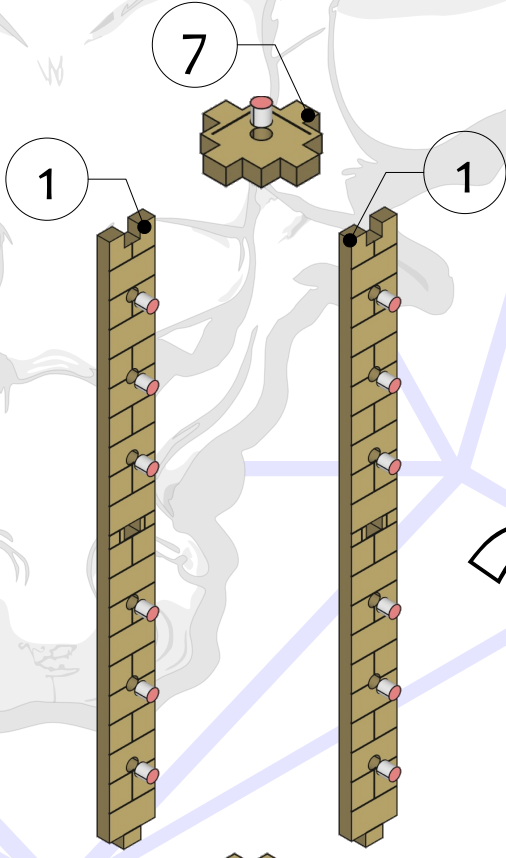

4x



Gothic Cathedral

Flat Faced Corner Column, 2x Tall

Part 2

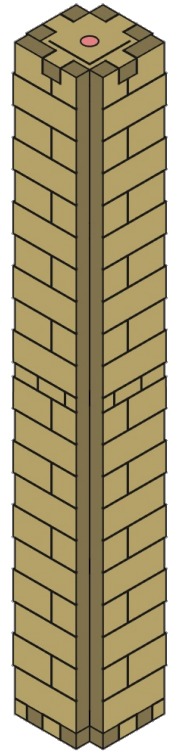
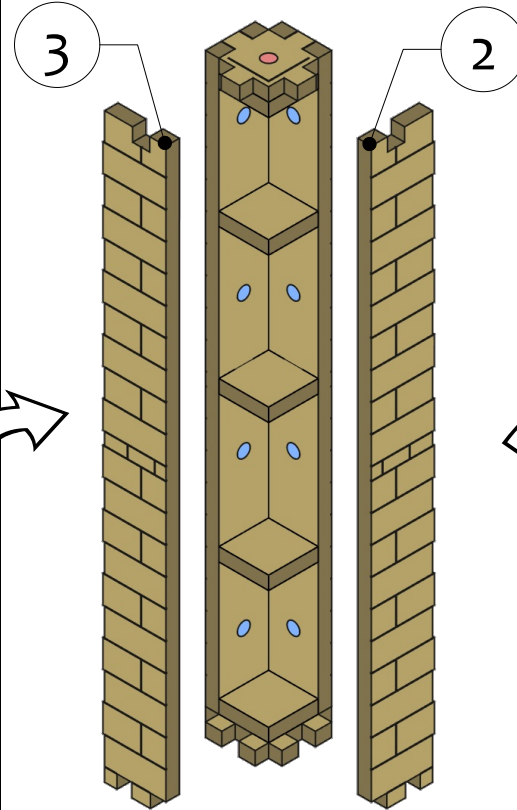
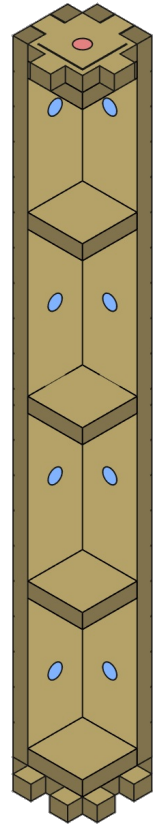
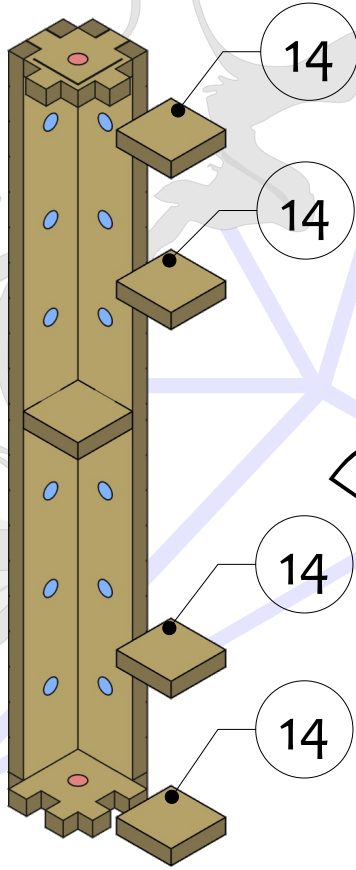

4x



Gothic Cathedral

Flat Faced Corner Column, 1x Tall

Part 1

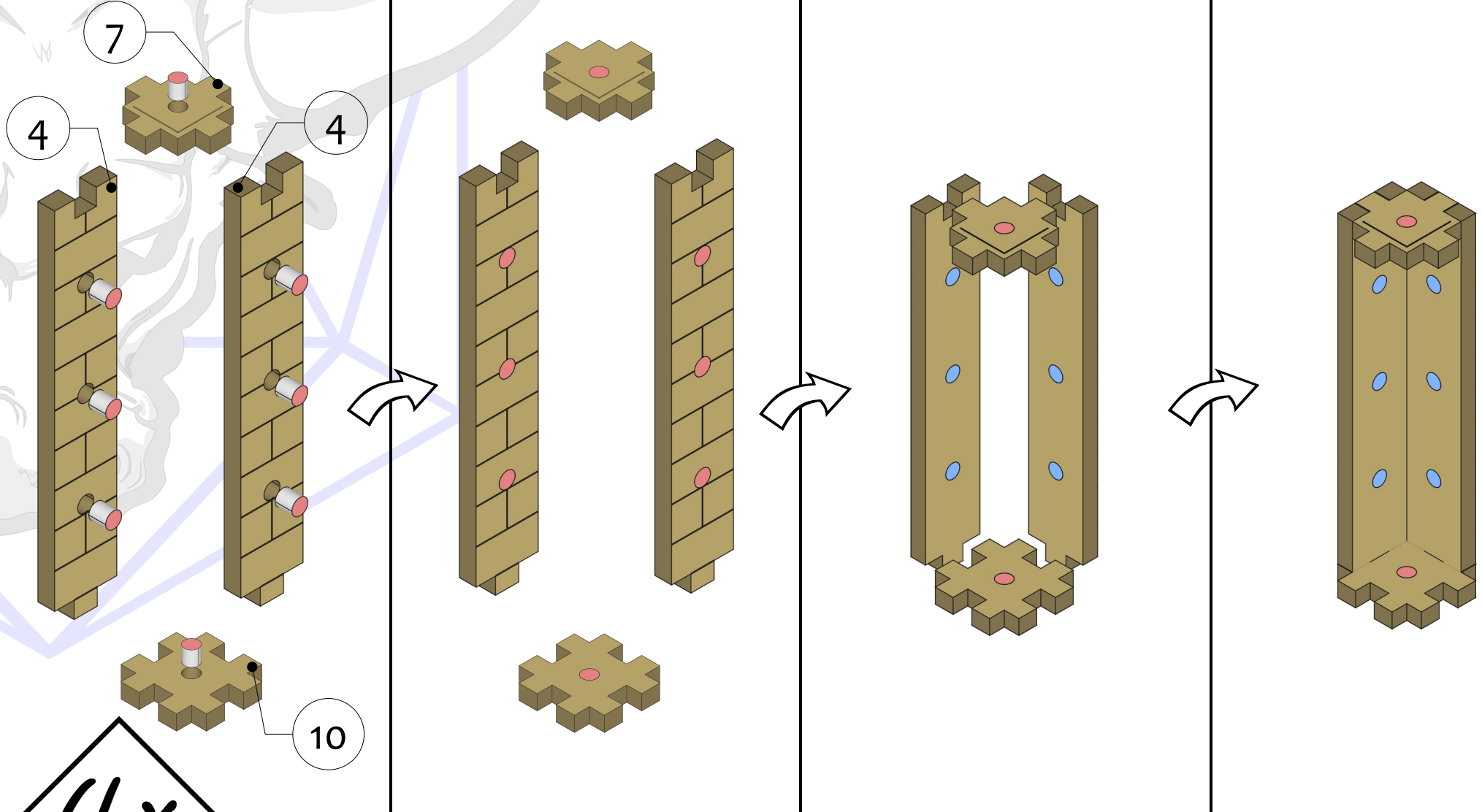

Gothic Cathedral

Flat Faced Corner Column, 1x Tall

Part 2

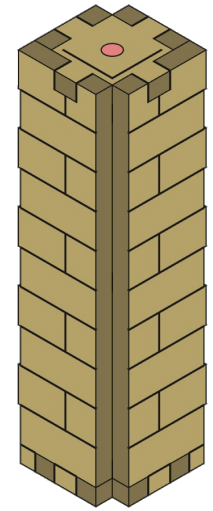
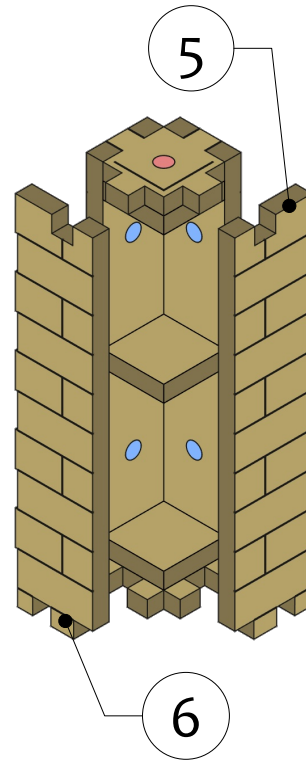
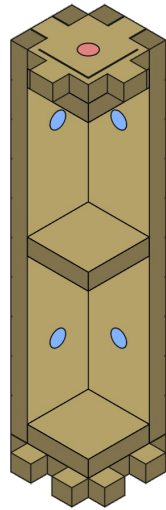
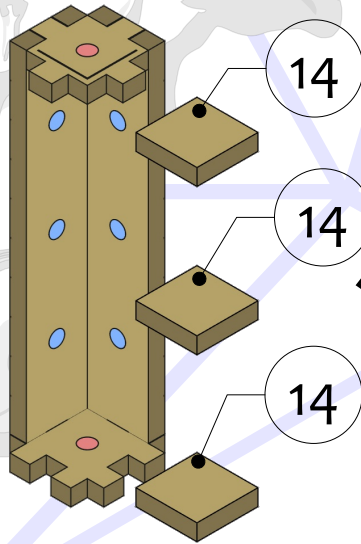

2x



Gothic Cathedral

Double Arch Wall, 2x Tall

Part 1

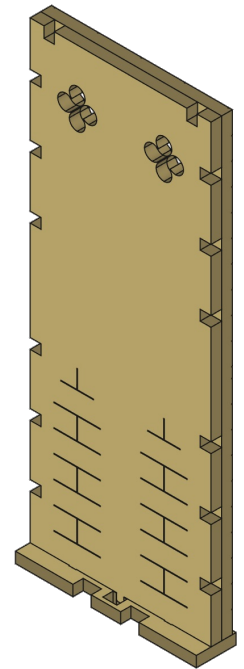
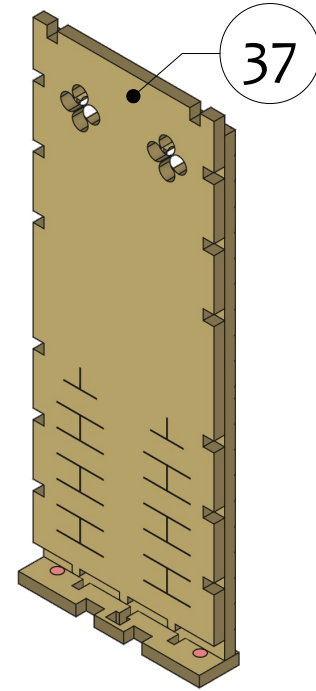
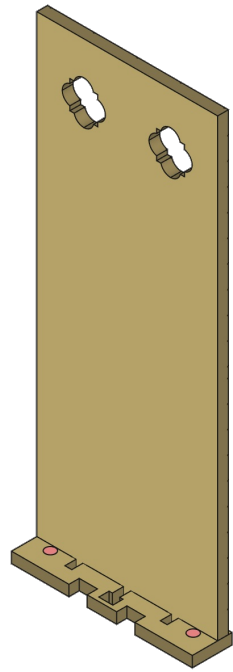
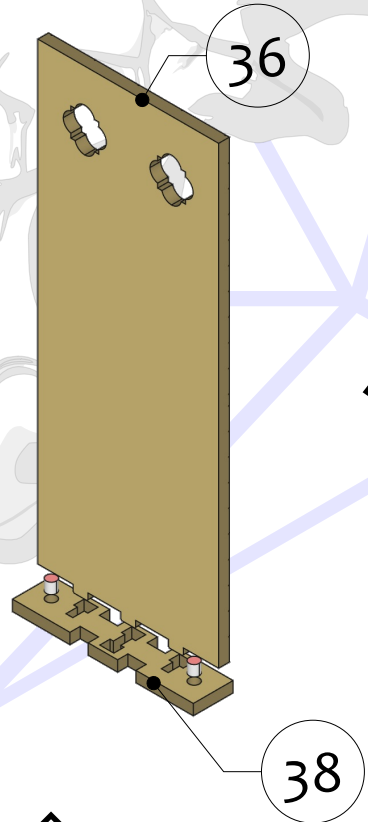

2x



Gothic Cathedral

Double Arch Wall, 2x Tall

Part 2

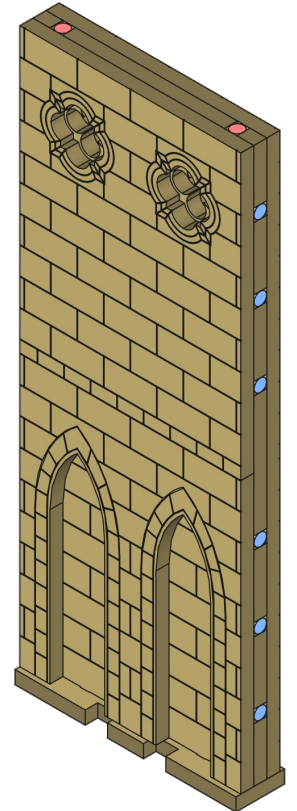
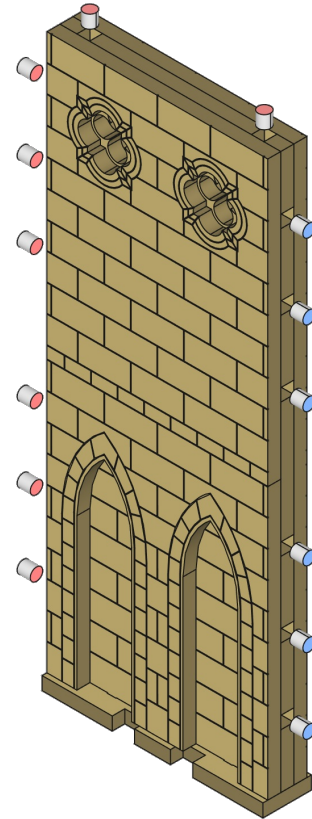
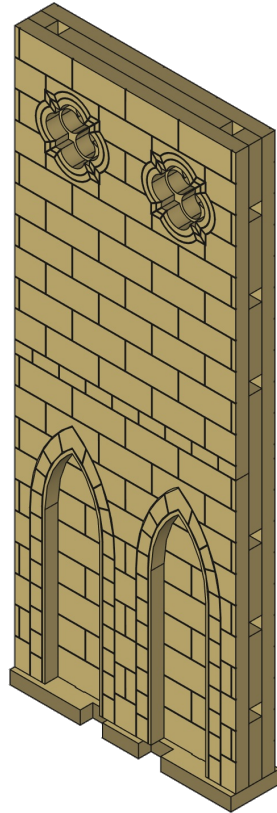
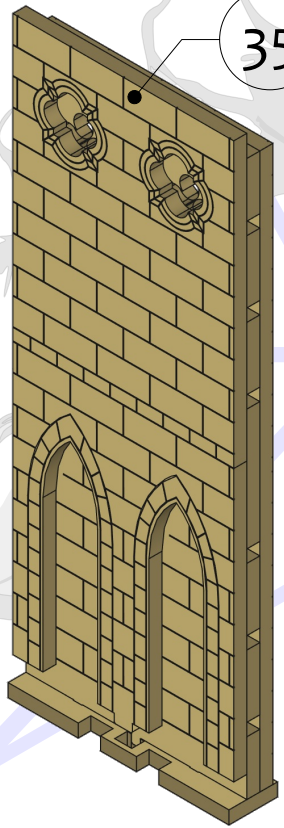

2x



Gothic Cathedral

Double Arch Wall, 2x Tall - Ruined 1

Part 1

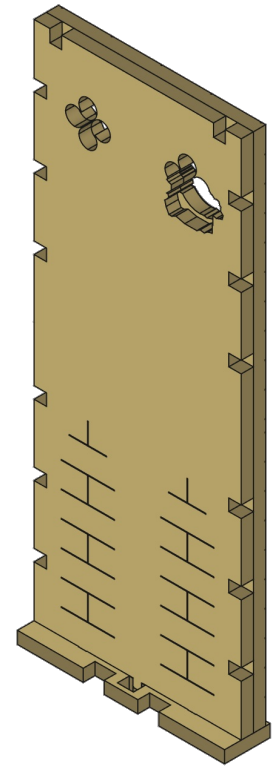
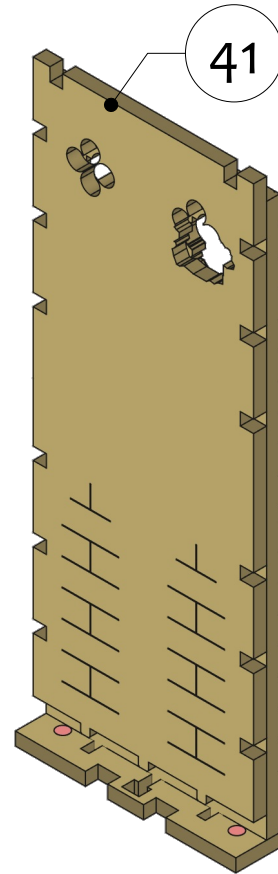
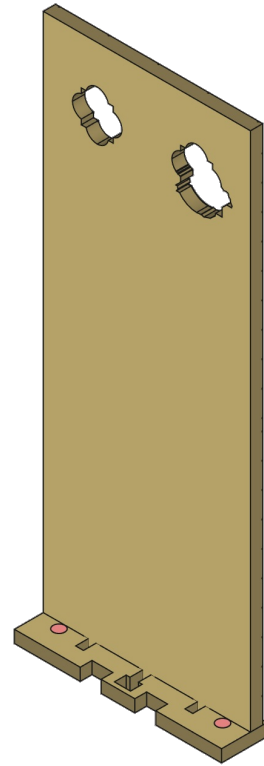
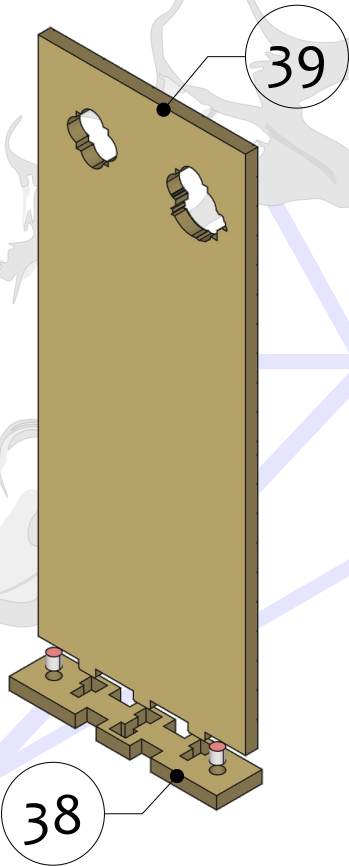

Gothic Cathedral

Double Arch Wall, 2x Tall - Ruined 1

Part 2

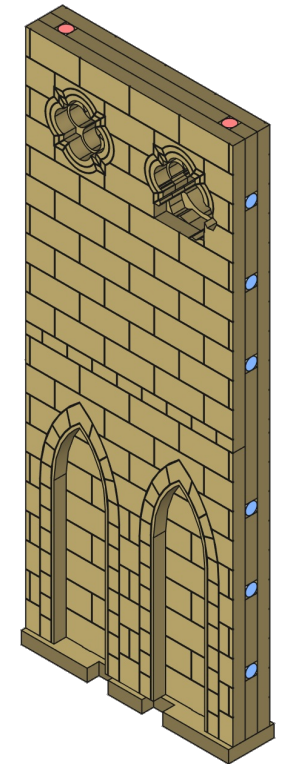
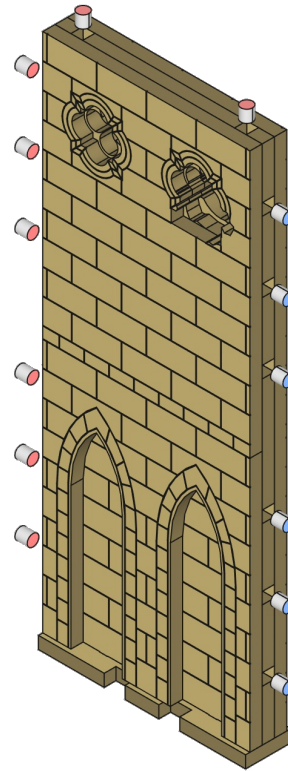
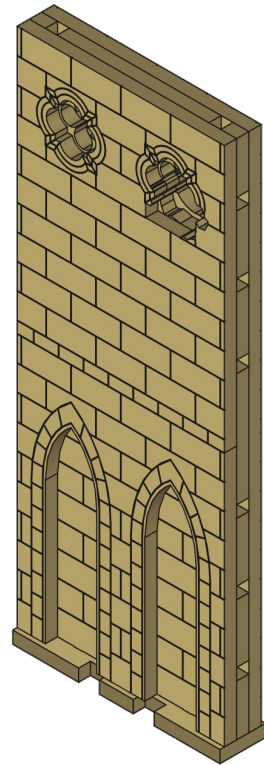
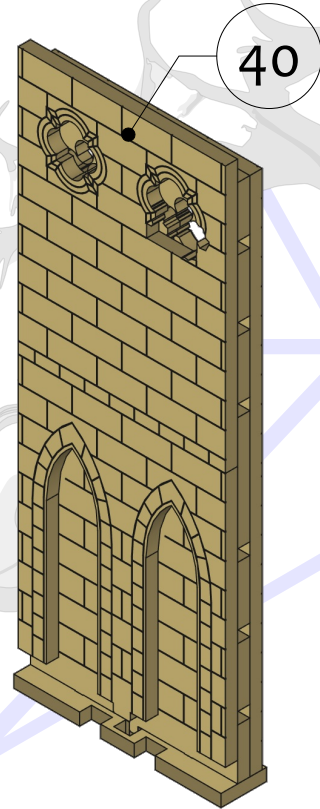

Gothic Cathedral

Tower Archway, 2x Tall - Ruined 1

Part 1

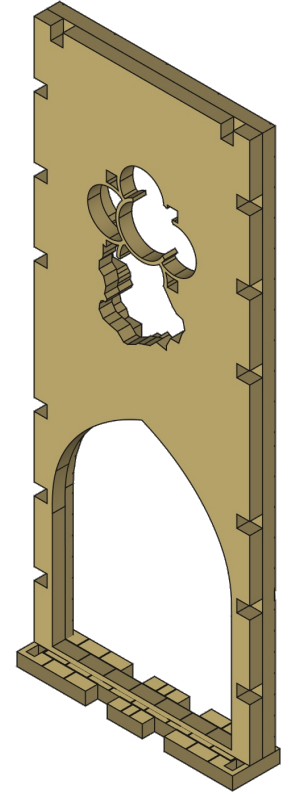
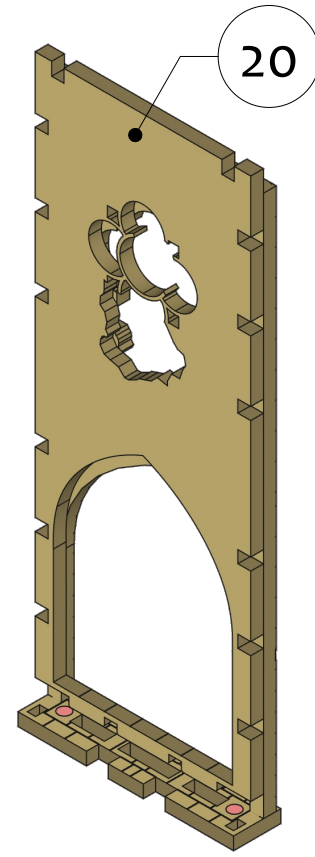
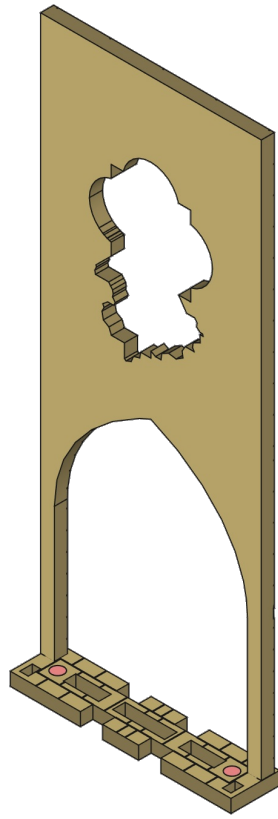
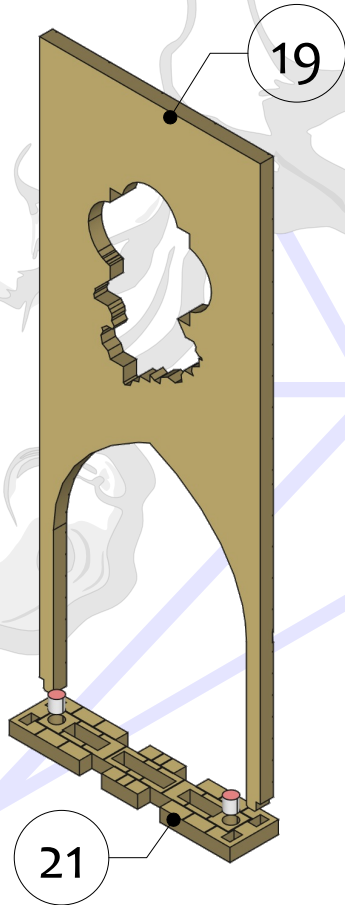

Gothic Cathedral

Tower Archway, 2x Tall - Ruined 1

Part 2

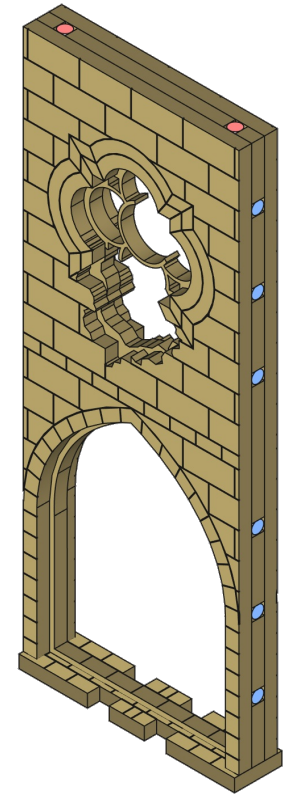
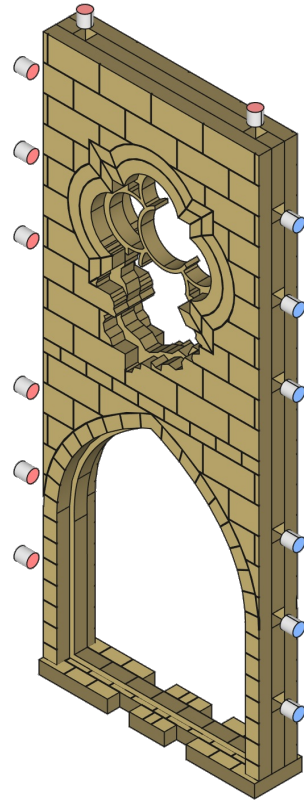
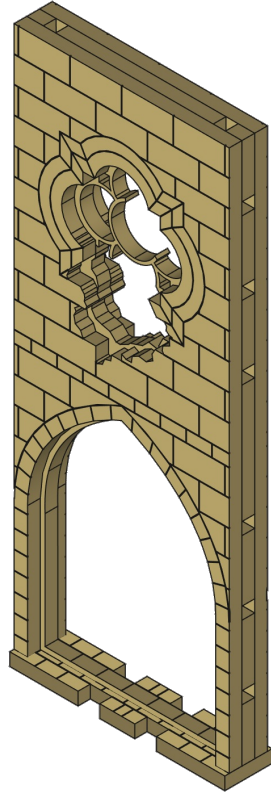
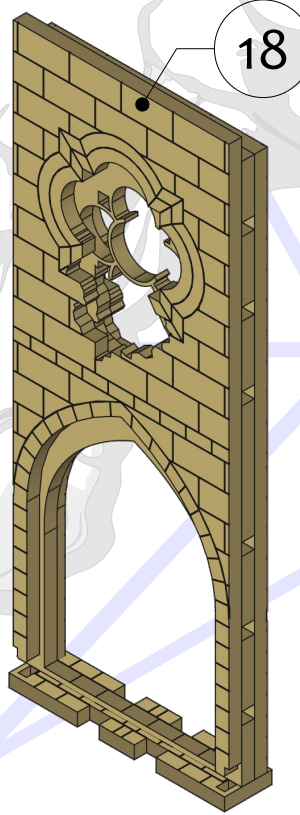

Gothic Cathedral

Double Window Wall, 1x Tall - Ruined 1

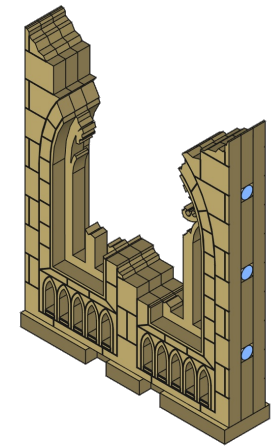
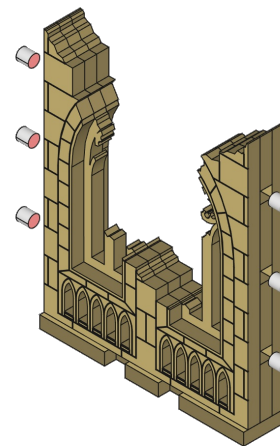
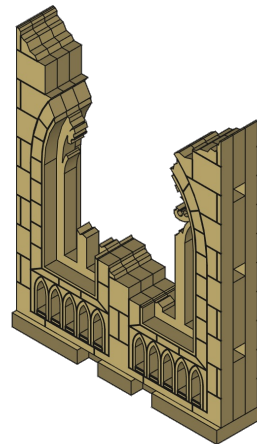
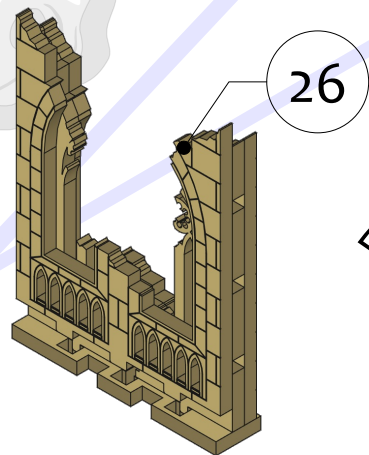
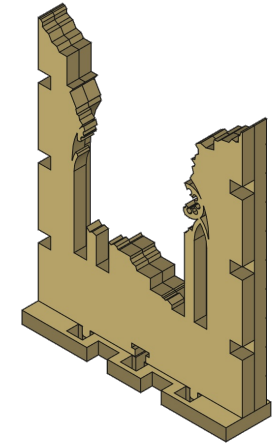
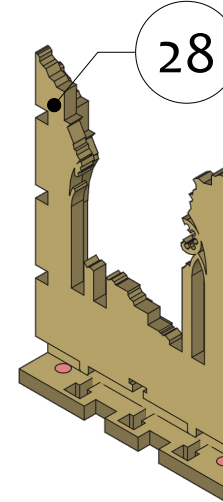
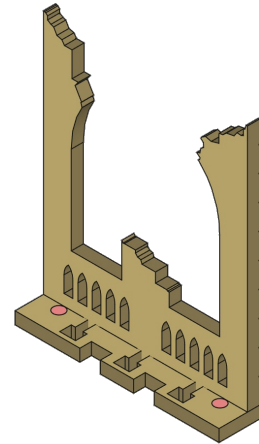
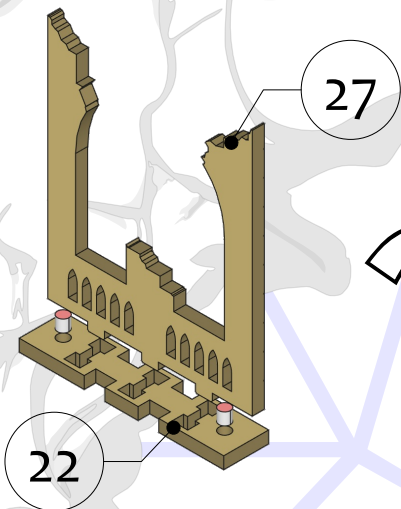

Gothic Cathedral

Double Window Wall, 1x Tall - Ruined 2

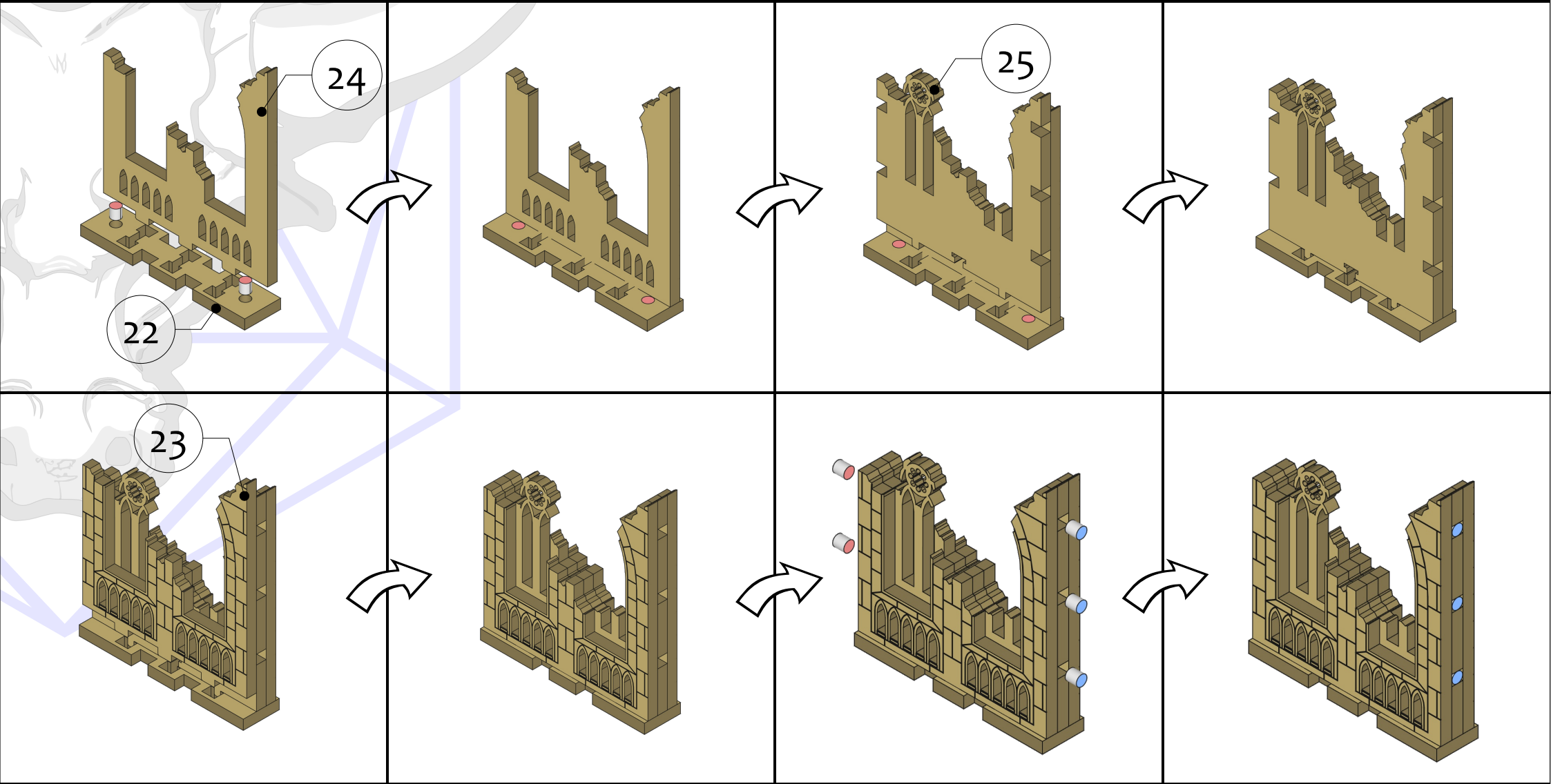

Gothic Cathedral

Double Window Wall, 1x Tall - Ruined 3

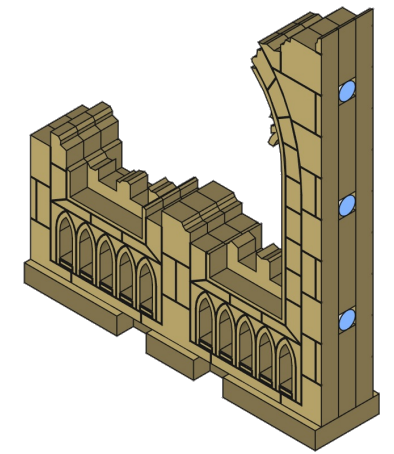
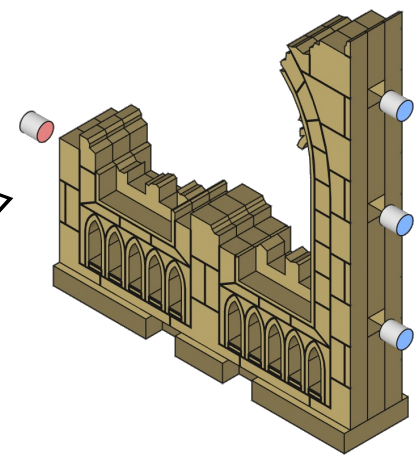
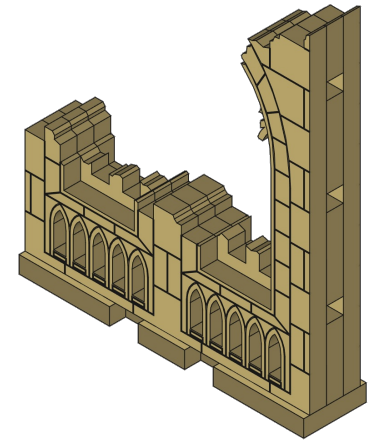
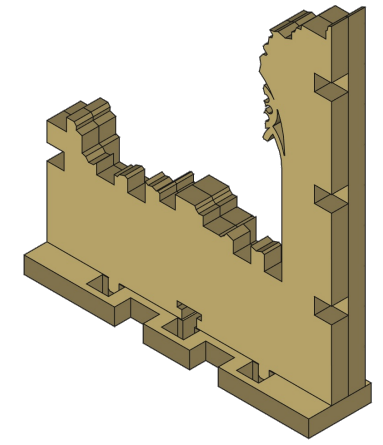
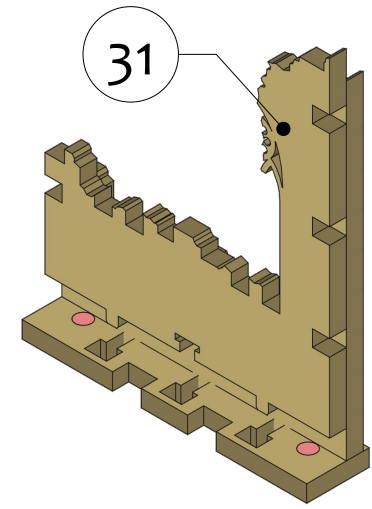
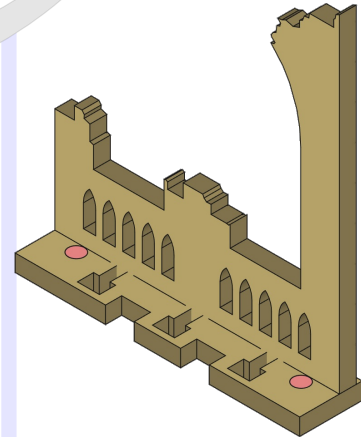
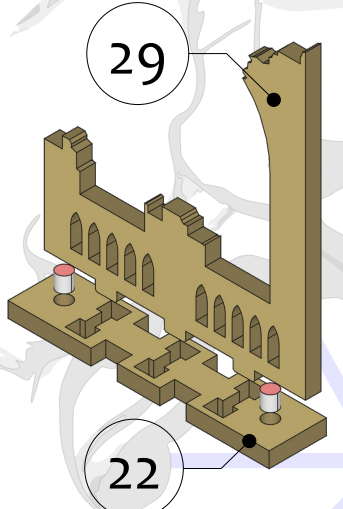

Gothic Cathedral

Double Window Wall, 1x Tall - Ruined 4

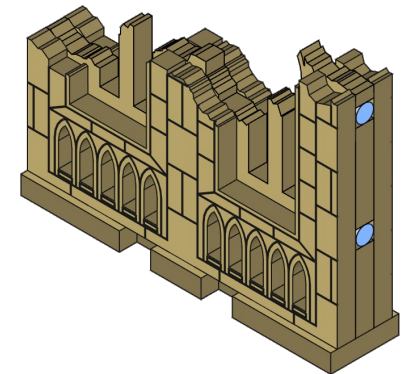
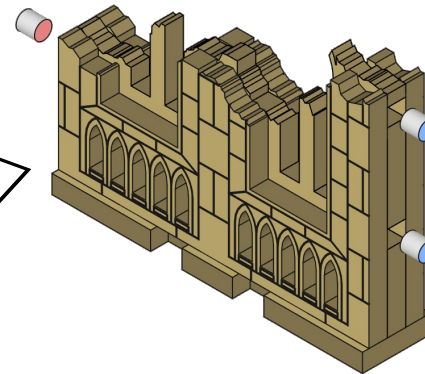
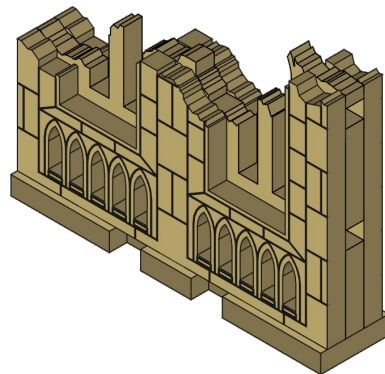
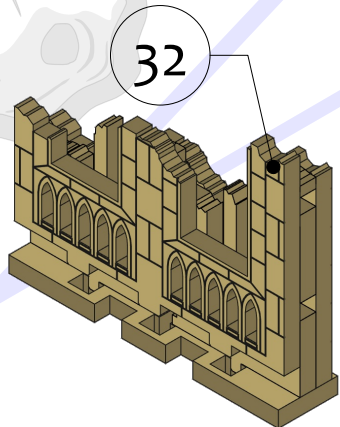
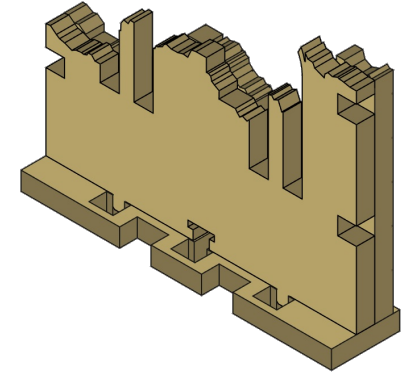
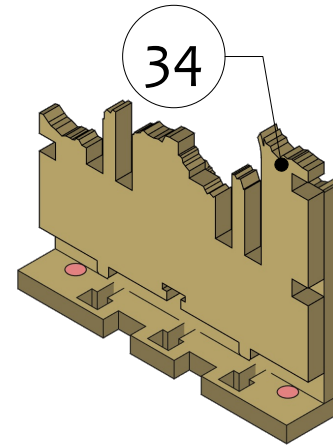
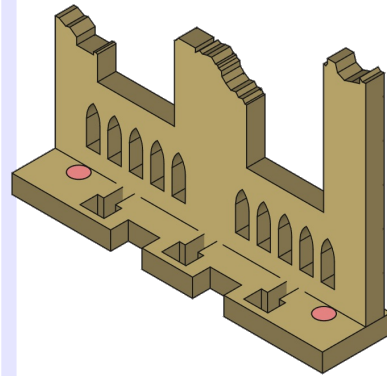
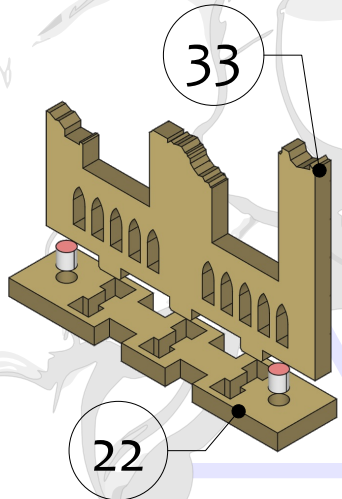

Gothic Cathedral

Flat Faced Corner Column - Ruined 1

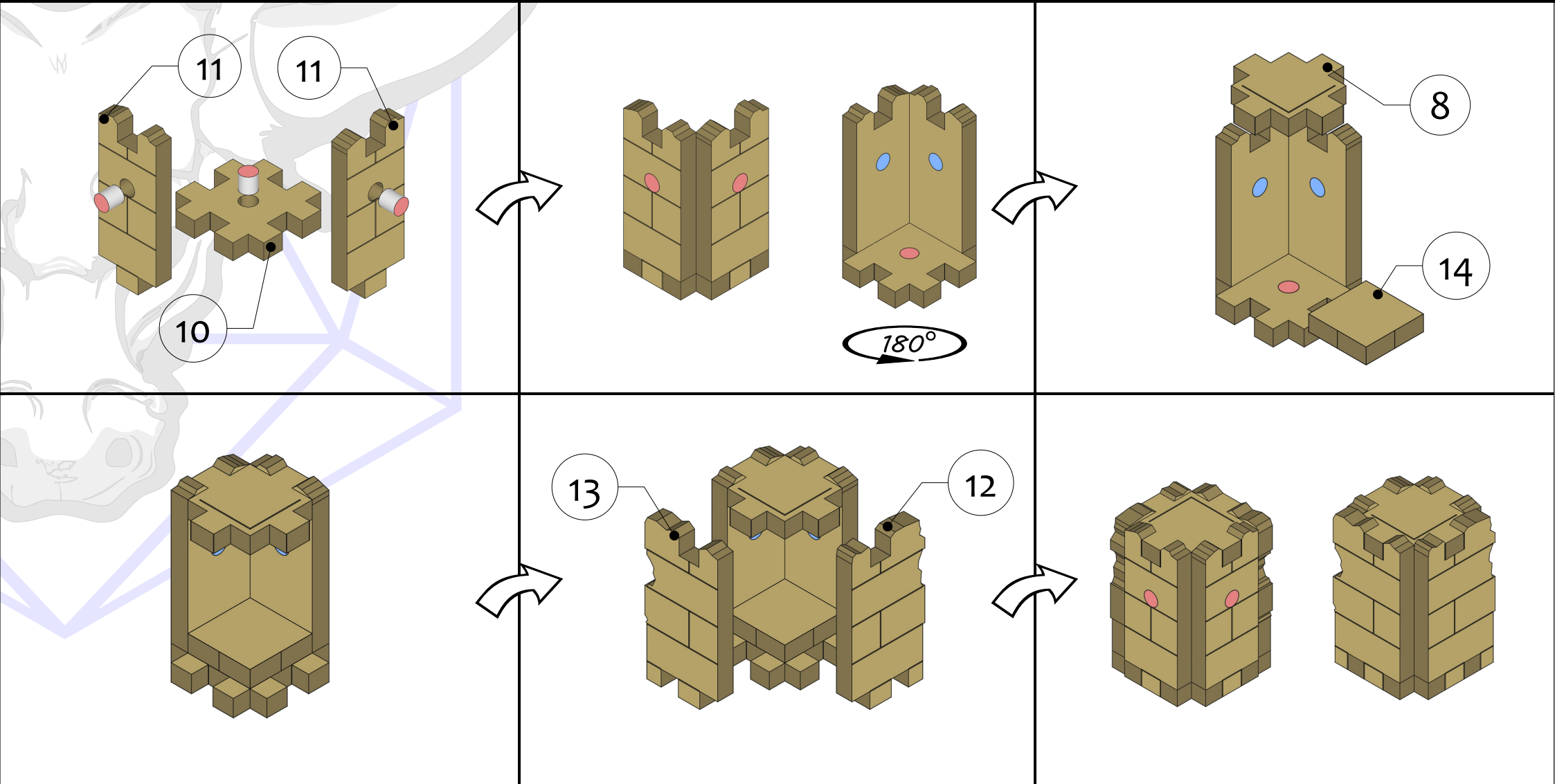

Gothic Cathedral

Flat Faced Corner Column - Ruined 2

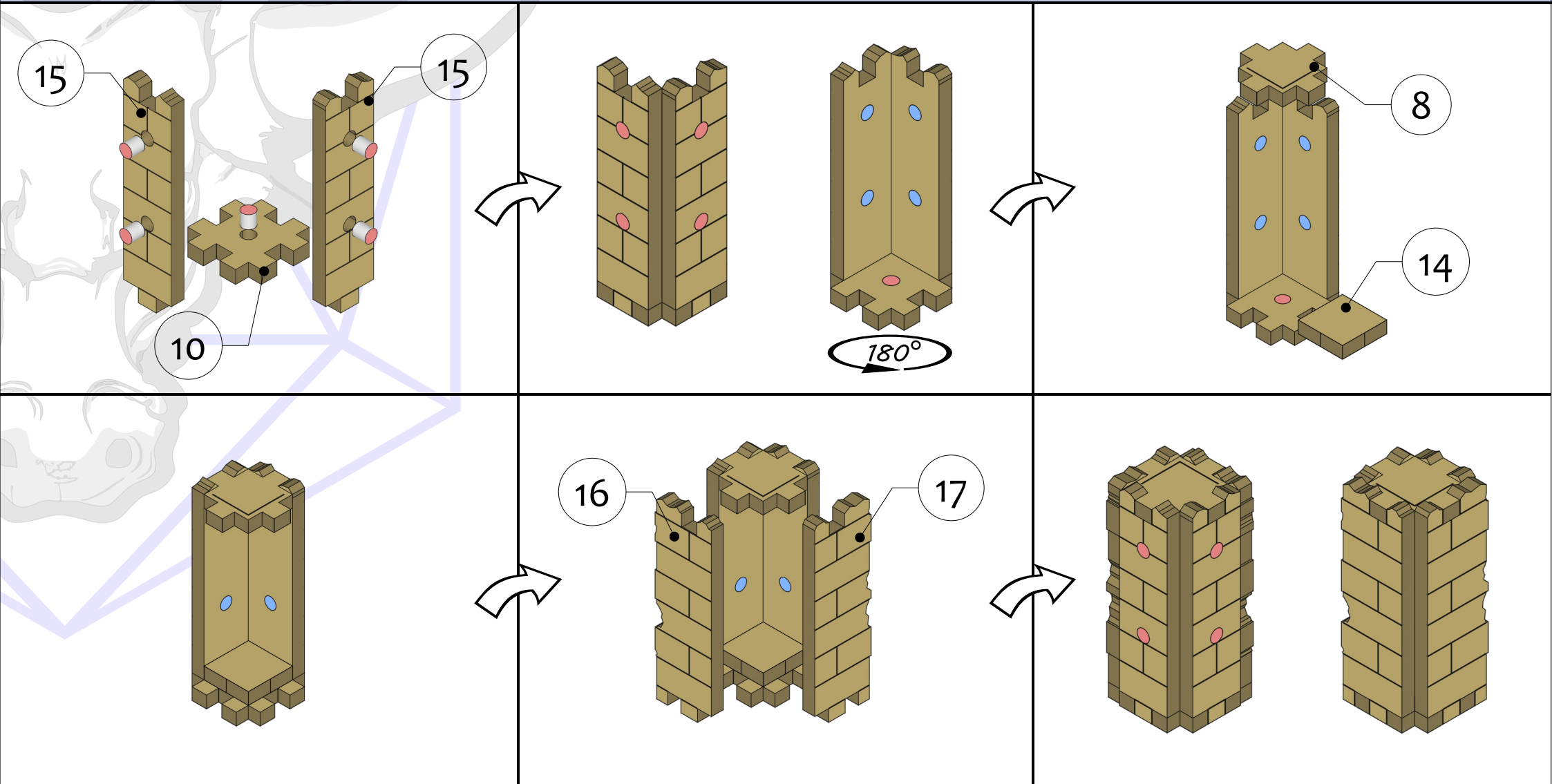

Gothic Cathedral

Column Pinnacle

Part 1

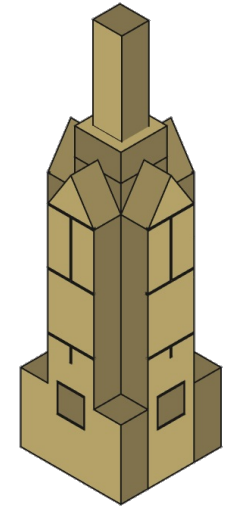
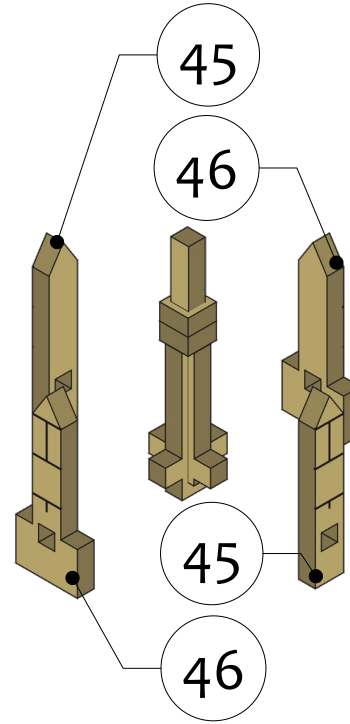
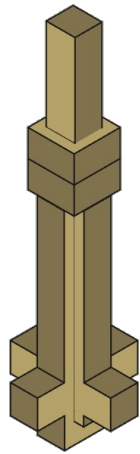
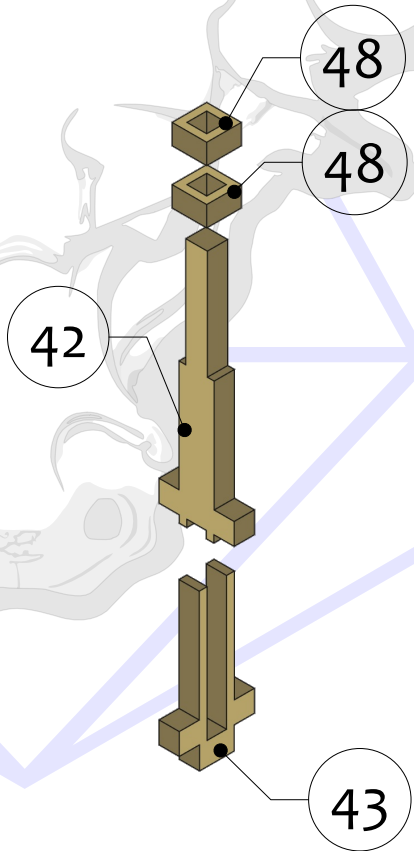

2x



Gothic Cathedral

Column Pinnacle

Part 2

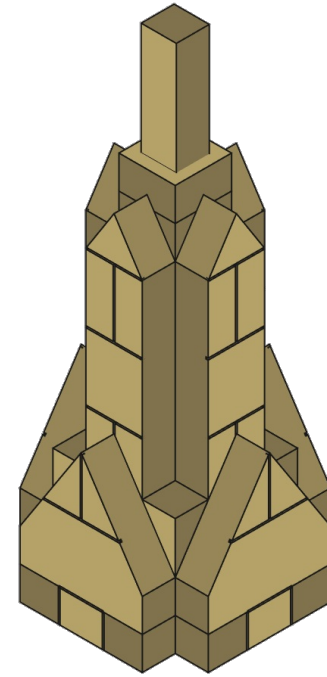
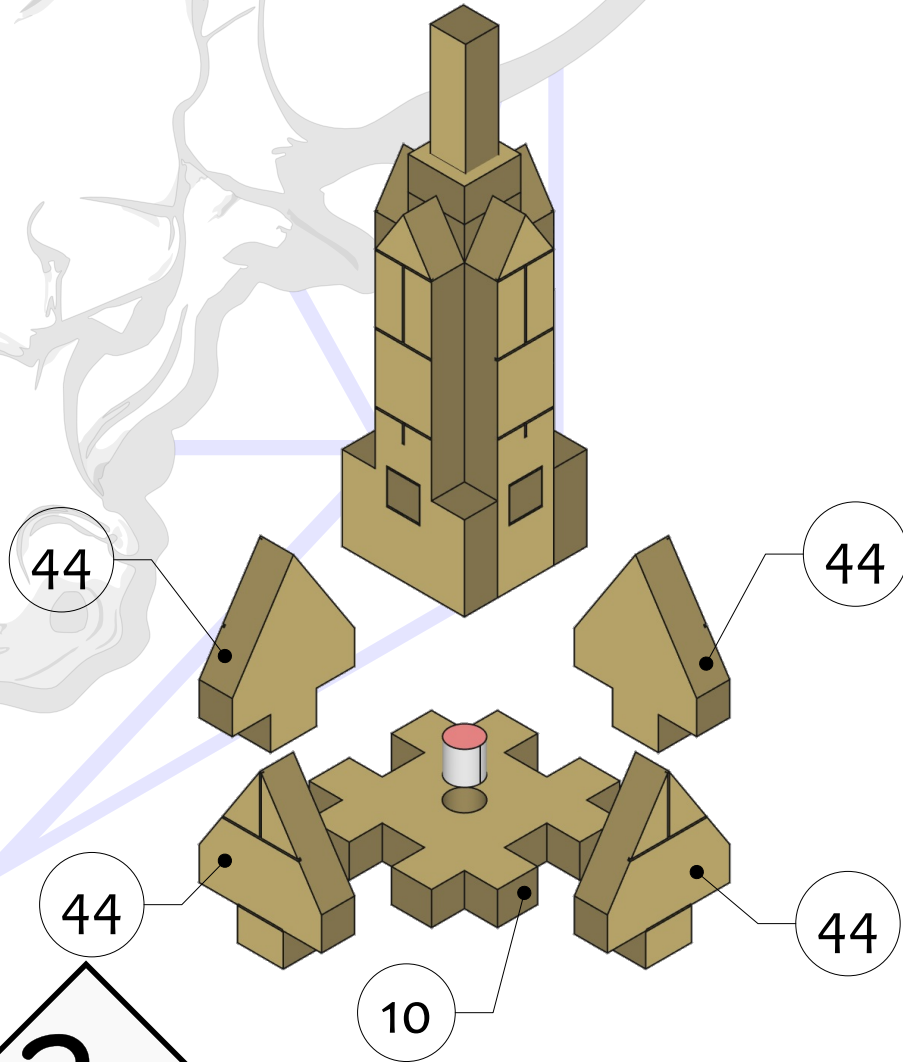

2x



Gothic Cathedral

Square Tower Baseplate

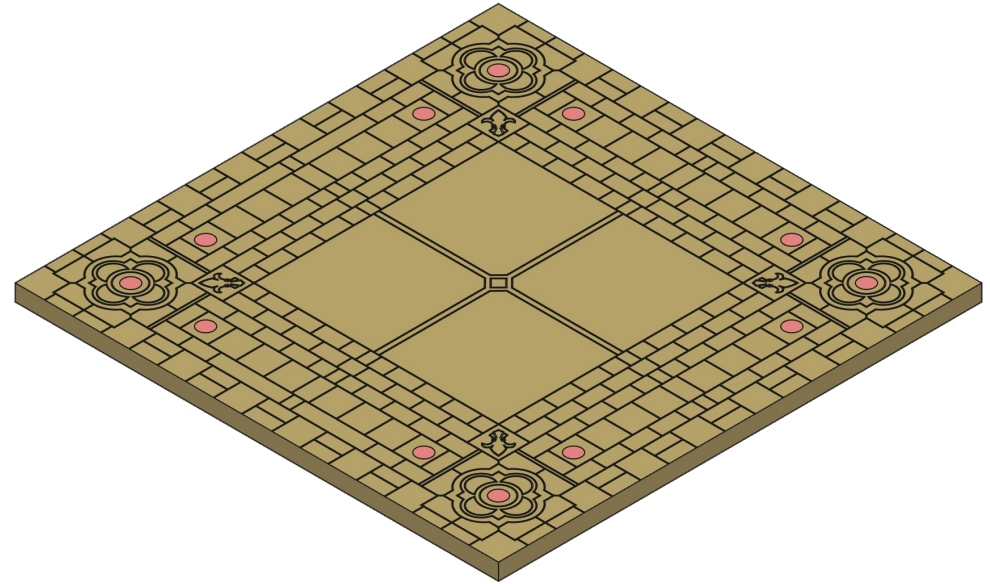
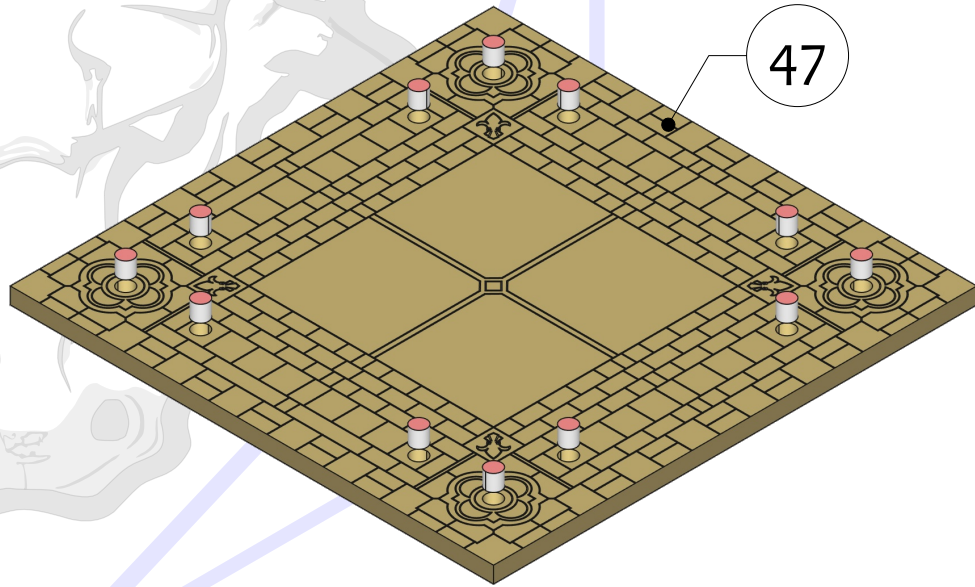

Gothic Cathedral

Stone and Wooden Floor - Ruined 1

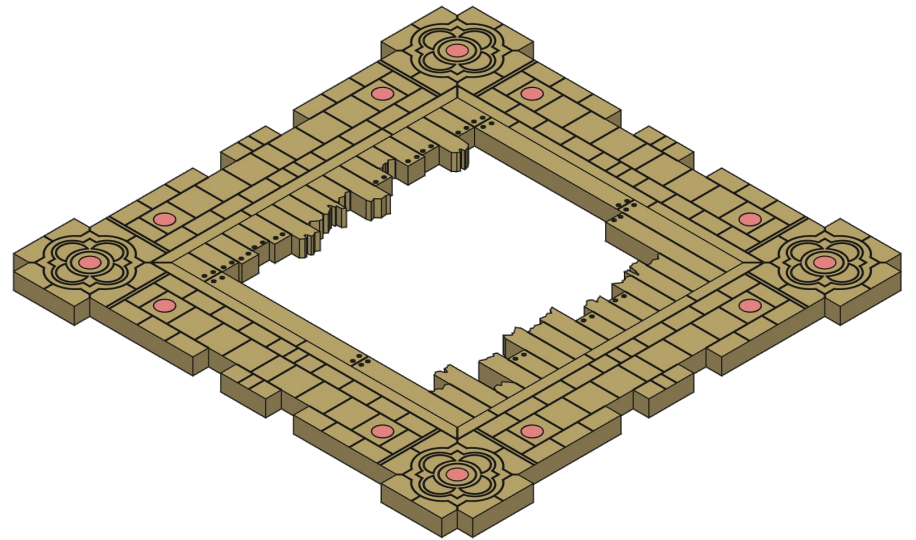
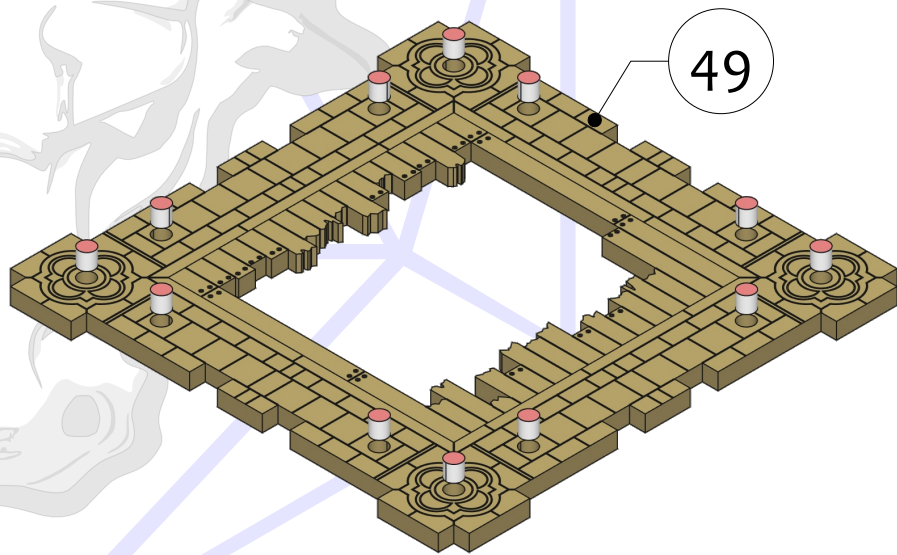

Dice Tower

Baffle Insert

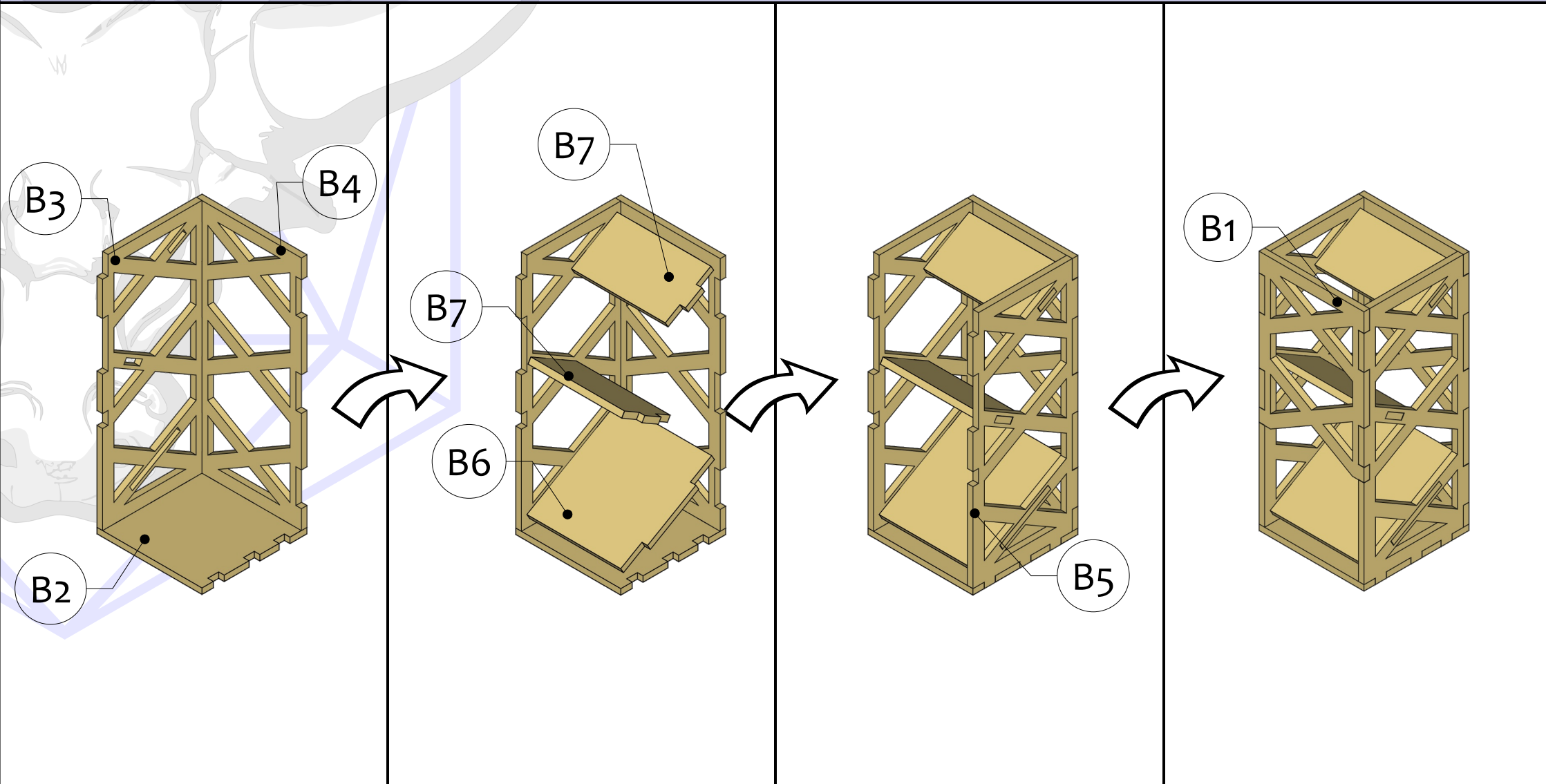

Gothic Cathedral – Ruined Dice Tower (GR-K001)

Part List

Module	Part	Qty.	Piece #	Pages
Flat Faced Corner Column, 2x Tall (GC-MC002) x4	GC-CW1201	8	1	2
	GC-CB0201	4	7	2
	GC-CB0101	4	10	2
	GC-CS0002	4	9	2
	GC-CW1202	4	3	3
	GC-CW1203	4	2	3
	GC-CS0001	16	14	3
Flat Faced Corner Column, 1x Tall (GC-MC003) x2	GC-CW1101	4	4	4
	GC-CB0101	2	10	4
	GC-CB0201	2	7	4
	GC-CW1102	2	5	5
	GC-CW1103	2	6	5
	GC-CS0001	8	14	5
Double Arch Wall, 2x Tall (GC-MW002) x2	GC-WW1202	3	37	6
	GC-WW1203	3	36	6
	GC-WB1102	3	38	6
	GC-WW1201	3	35	7
Double Arch Wall, 2x Tall – Ruined 1 (GR-MW006)	GR-WW1202	3	41	8
	GR-WW1203	3	39	8
	GC-WB1102	3	38	8
	GR-WW1201	3	40	9
Tower Archway, 2x Tall – Ruined (GR-MW007)	GR-WW1207	1	20	10
	GR-WW1206	1	19	10
	GC-WB1103	1	21	10
	GR-WW1204	1	18	11
Double Window Wall, 1x Tall – Ruined 1 (GR-MW001)	GR-WW1101	1	26	12
	GR-WW1102	1	28	12
	GR-WW1103	1	27	12
	GC-WB1101	1	22	12

Module	Part	Qty.	Piece #	Pages
Double Window Wall, 1x Tall – Ruined 2 (GR-MW002)	GR-WW1104	1	23	13
	GR-WW1105	1	25	13
	GR-WW1106	1	24	13
	GC-WB1101	1	22	13
Double Window Wall, 1x Tall – Ruined 3 (GR-MW003)	GR-WW1107	1	30	14
	GR-WW1108	1	31	14
	GR-WW1109	1	29	14
Double Window Wall, 1x Tall – Ruined 4 (GR-MW004)	GC-WB1101	1	22	14
	GR-WW1110	1	32	15
	GR-WW1111	1	34	15
	GR-WW1112	1	33	15
	GC-WB1101	1	22	15
Flat Faced Corner Column, Ruined 1 (GR-MC001)	GR-CW0101	2	11	16
	GR-CW0102	1	13	16
	GR-CW0103	1	12	16
	GR-CB0201	1	8	16
	GC-CB0101	1	10	16
	GC-CS0001	1	14	16
Flat Faced Corner Column, Ruined 2 (GR-MC002)	GR-CW0201	2	15	17
	GR-CW0202	1	16	17
	GR-CW0203	1	17	17
	GR-CB0201	1	8	17
	GC-CB0101	1	10	17
	GC-CS0001	1	14	17
Column Pinnacle (GC-MP001) x2	GC-RP0002	2	42	18
	GC-RP0004	2	43	18
	GC-RP0003	4	48	18
	GC-RP0001	4	46	18
	GC-RP0005	4	45	18
	GC-CB0101	2	10	19
	GC-RP0006	8	44	19
Tower Base	GC-BS0001	1	47	19

Gothic Cathedral – Ruined Dice Tower (GR-K001)

Part List

Module	Part	Qty.	Piece #	Pages
Stone and Wooden Floor – Ruined 1 (GR-FS0003)	GR-FS0003	1	49	21
Baffle Insert	BAFFLEFRONT	1	B1	22
	BAFFLEBASE	1	B2	22
	BAFFLERIGHT	1	B5	22
	BAFFLEBACK	1	B4	22
	BAFFLELEFT	1	B3	22
	BAFFLELARGE	1	B6	22
	BAFFLESMALL	2	B7	22
BS TOOL	BSTOOL	6	*	N/A