



CIELO VERDE PHASE 3B

1686



Livable Area:

1686 sq. ft.

Footprint:

4 Bedroom

1 3/4 Bath

2 Car Garage

Standards:

10' Ceilings

Granite counter tops throughout

Double vanity in Master bath

Snail shower in Master bath

Extended patio under truss

Options:

Garden door off Master bedroom

Fireplace

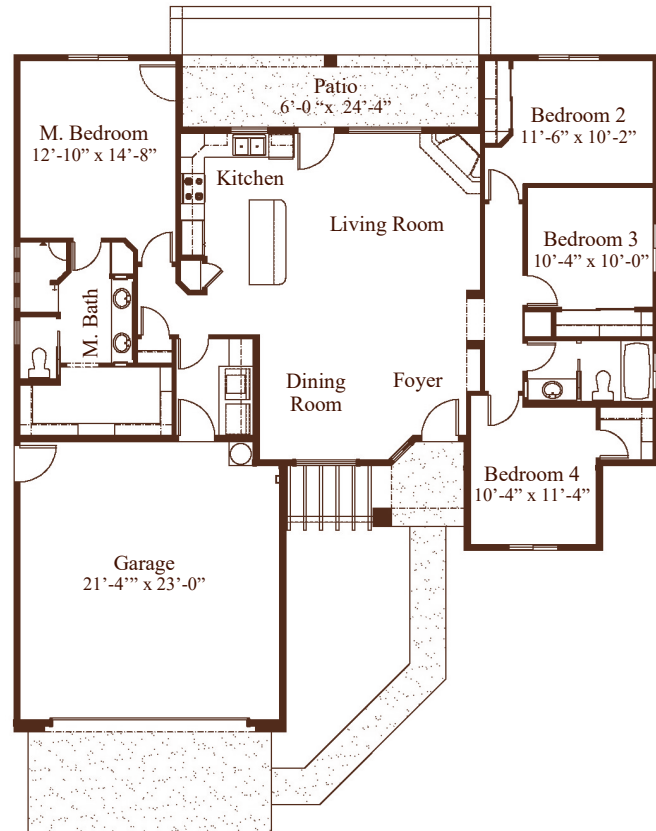

All dimensions and floor areas are approximate. Prices and specifications are subject to change without notice, solely at builder's discretion. Elevation drawings are artistic interpretations of the appearance of the design, which may differ from the actual results when built. Each home to be constructed is subject to terms of approval of a building permit by the City/County of Yuma. Options and additions depicted are not available on all plans or lots.



Main: 1334 S 5 Ave. | Sales: 3310 S. Ave 8E, Suite #1 Yuma, AZ 85365 | Tel: 928-329-9000 |
www. JacobsonHomesYuma.com

