

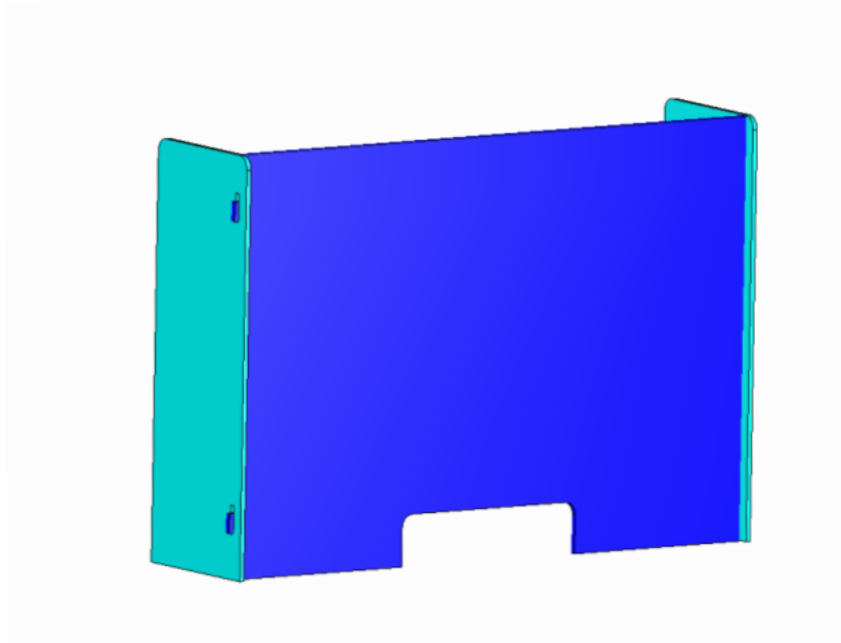

D2 Acrylic Glass Barriers

The D2 acrylic sneeze guards are designed for easy installation, they are of a 3 piece design constructed of 3/8" thick clear cast acrylic in which the front panel locks onto a 12" side panels on either side. This makes the barrier very stable without having to anchor it down, for extra security it can be held down with 3M VHB (very high bond) double sided tape. We can also do custom sizes for special applications, give us a call to schedule an appointment to see what your requirements are and we can provide you with a free estimate.



size	Dimensions W x H	Unit price
S	32" x 32" * with 12" returns	\$150.00
M	46.5" x 32" * with 12" returns	\$250.00
L	72" x 32" * with 12" return	\$325.00

**Specifications are subject to change.*

D2Machining Solutions
2241W SW 31 Street, Fort Lauderdale, FL 33312
Phone: (954) 763-8042 • Email: Manufacturing@d2machiningsolutions.com