



www.seafarerinternational.com

User Installation and Assembly Instruction

SIL-5001 5-1/4" DUAL CONE / SIL-6002 6-1/2" 2-WAY ANTI-UV MARINE SPEAKER

Installation Steps:

1. Using template provided, trace hole patterns on surface
2. Cut hole in surface, following traced pattern
3. Leave sufficient amount of wire at speaker location to complete connection

Drill pilot holes for mounting screws

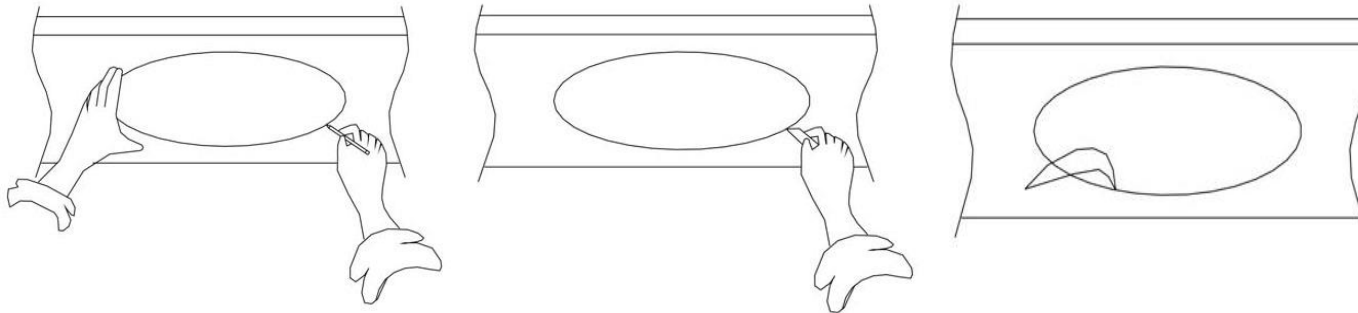

4. Attach wires to speaker terminals , position speaker frame up into cutout.

5. Install and carefully tighten the four mounting screws. The shoulders in the grill holes will secure the speaker in

0.250 terminal is positive (+), 0.187 terminal is negative (-), note markings on terminal board

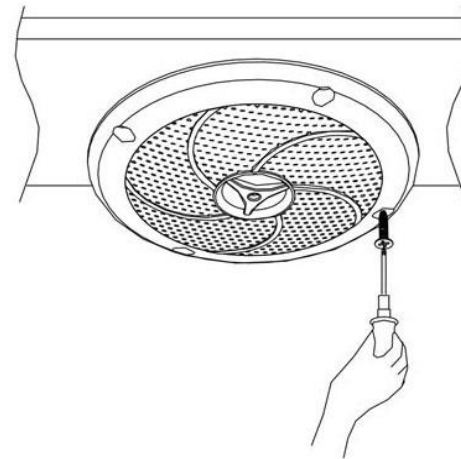
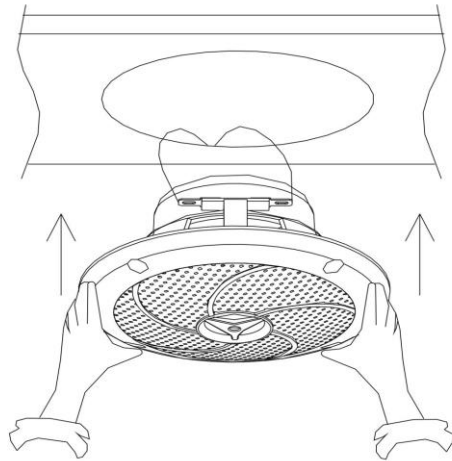

Specifications

Model	SIL-5001	SIL-6002
Magnet	80z	80z
Cone	Black P.P.Inj Cone Rubber Edge	Black P.P.Inj Cone Rubber Edge
Voice Coil	25mm K.S.V.Voice Coil	25mm K.S.V.Voice Coil
Nom power	40W	50W
Peak Power	80W	100W
Impedance	4 Ohms	4 Ohms

For more information contact:
 Seafarer International, LLC . 24481 Dardania Ave, Mission Viejo CA 92691 . Tel: 949 637-7785
www.seafarerinternational.com