



My Philosophy

The practice is founded on the principles of Integrity, Creativity, and Excellence.

Integrity: I deal with Clients, colleagues, stakeholders, and decision-makers with openness and transparency. Ask me what you need to, and you will get a clear and straightforward answer.

Creativity: Coming from creative backgrounds in the arts and in architecture, I inherently tackle all problems with a creative flair.

Excellence: I pride myself on the quality of my work. No project leaves my desk until I know it can fly on its own.

"From the very start Tasyam was incredibly meticulous and thorough in preparing our land use application. No stone was left unturned and his support and professional dealings were unparalleled."

Tim Osrin
Nursery School Project, Kenilworth

"Amazing dedicated town planner. Super efficient and committed to his scope on our project. Tasyam is on the ball and goes the extra mile because he genuinely wants to. He is professional and well experienced. I would highly recommend his services."

Natalia Morse
Single Residential Project, Constantia

"Mr. Tasyam Govender in his Capacity as Consultant has been exemplary in my interactions with him. Not only is he Very Professional, Helpful, and pleasant to deal with, but his initiative in pre-empting potential potholes, is commendable."

Owen Simons
Higher-Density Residential Project, Retreat

"We can highly recommend Tasyam's services. He has been exceptional with handling our planning application."

Angelo Boraine
Performance and Event Space, Paarden Eiland

"Tasyam is a pleasure to work with, always professional and very conscientious!"

Denis Maas
Residential and Warehouse Projects, Cape Town

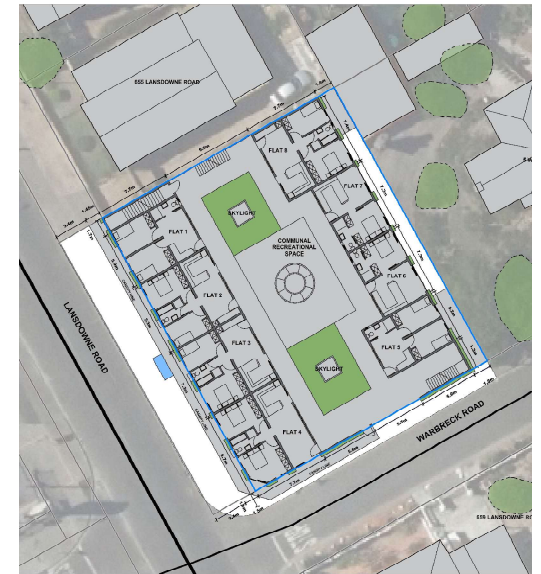

Unique Value Proposition

I have a **100%** success rate with municipal Town Planning submissions. I always deliver a successfully completed project with development rights in place. Each, and every time.

My Mission

My aim in my work is to create beautiful, liveable, mixed-use, higher-density neighbourhoods; which support spatial transformation and urban sustainability imperatives.

Broad-Based Black Economic Empowerment

Tasyam Govender Town Planner is a Level One B-BBEE Contributor.

Selected Projects

Runciman Drive, Simon's Town, Cape Town

Applications for Rezoning and Permanent Departure to enable development of a residential complex.

Simon's Town, Cape Town

Applications for Removal of Restrictive Conditions and Permanent Departure to enable additional residential construction.

Milner Road, Claremont, Cape Town

Applications for Rezoning and Permanent Departure to facilitate the use of the property for medical consulting rooms.

Aukland Street, Paarden Eiland, Cape Town

Applications for Consent and Removal of Restrictive Conditions to enable the use of a part of the property as an Event Venue.

Bishopscourt, Cape Town

Applications for Amendment of Restrictive Conditions and Permanent Departure to enable additional residential construction.

Cockburn Street, Glencairn, Cape Town

Applications for Rezoning, Removal of Restrictive Conditions, and Permanent Departure to enable development of a residential complex.

Newlands, Cape Town

Applications for Removal of Restrictive Conditions and Permanent Departure to enable additional residential construction.

Bakoven, Cape Town

Applications for Amendment of Restrictive Conditions and Permanent Departure to enable construction of a second dwelling.

Belvedere Tygerberg, Cape Town

Applications for Removal of Restrictive Conditions and Permanent Departure to enable construction of second and third dwellings.

Glencairn, Cape Town

Applications for Relaxation of Restrictive Conditions and Permanent Departure to enable additional residential construction.

Alk Van Zyl Avenue, Panorama, Cape Town

Applications for Consent and Permanent Departure to facilitate the use of a part of the property for community (educational) purposes.

Castor Road, Lansdowne Industrial, Cape Town

Applications for Relaxation of Restrictive Conditions and Permanent Departure to enable development of an additional 3,000m² of lettable storage space.

Victoria Road, Plumstead, Cape Town

Applications for Rezoning and Permanent Departure to facilitate the use of the property for business (office) purposes.

Rosedon Road, Lansdowne, Cape Town

Applications for Rezoning and Permanent Departure to enable development of 18 flats.

Marine Drive Service Road, Paarden Eiland, Cape Town

Applications for Consent and Removal of a Restrictive Condition to enable the use of a part of the property as an Event Venue and Performance Space.

Claremont, Cape Town

Applications for Subdivision and Permanent Departure to locate existing dwellings on separate land units.

Bathurst Road, Kenilworth, Cape Town

Applications for Consent and Permanent Departure to facilitate the use of the property for community (educational) purposes.

Constantia, Cape Town

Applications for Relaxation of Restrictive Conditions and Permanent Departure to enable construction of a second dwelling.

Belvedere Road, Claremont, Cape Town

Applications for Rezoning and Permanent Departure to facilitate the use of the property for business (office) purposes.

Lansdowne Road, Lansdowne, Cape Town

Applications for Rezoning and Permanent Departure to enable development of a mixed-use nature (4 shops and 16 flats).

Lakeside, Cape Town

Applications for Relaxation of Restrictive Conditions to enable construction of a second dwelling.

Penhill, Cape Town

Applications for Removal of Restrictive Conditions to enable construction of a second dwelling.

District Six Phase 4, District Six, Cape Town

Applications for Subdivision, Rezoning, Consent and Permanent Departure to enable development of 175 residential restitution units.

Kenwyn, Lansdowne, Cape Town

Applications for Rezoning and Permanent Departure to enable additional residential construction.

Sedgefield, Knysna Local Municipality

Town Planning analysis and recommendations report.

Meadowridge, Constantia, Cape Town

Application for Permanent Departure to enable additional residential construction.

Retreat Road, Retreat, Cape Town

Applications for Rezoning and Removal of Restrictive Conditions to enable development of a mixed-use nature (6 shops and 28 flats).

Boschendal Estate, Stellenbosch

Applications for De-Proclamation / Closure of Minor Road 5230 and Minor Road 5231.