

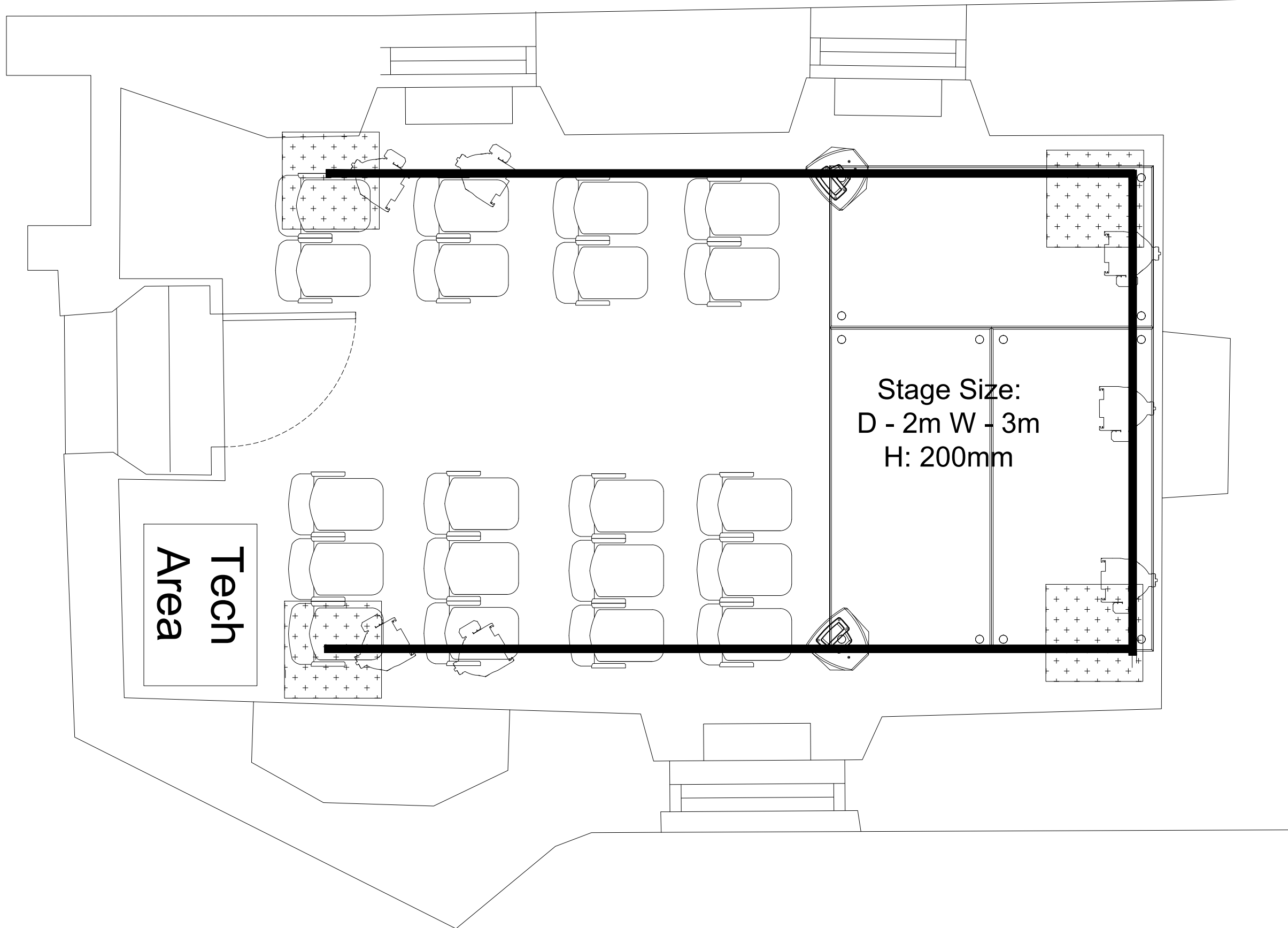

Drawn By Cal Graham
Director of Production
Greenside Venues Ltd.
t: 07585 112144
e: callum@greensidevenue.co.uk



This represents visual concepts & construction suggestions only. It does not replace the knowledge and advice of a licensed structural engineer. The designer is unqualified to determine the structural appropriateness of this design and will not assume responsibility for improper engineering or use

Venue:
Riddles Court

Address: Riddles court
322 Lawnmarket,
Edinburgh
EH1 2PG

Title: Clover Studio
Performer Pack Drawing

Date: 18/08/2023 Scale: 1:25@A3

Designed By: Cal Graham

Drawing No: 1 of 1 Rev: 3.1

Copyright: Greenside Venues Ltd. © 2023