



GREENSIDE

PERFORMER PACK
2025

“Where the original spirit of the fringe lives on”

The Scotsman

Welcome to Greenside!

Greenside returns on the back of our most successful season to date. In 2024 we showcased 196 shows which translated into over 2,000 individual performances across the Fringe. We had record breaking ticket sales – comparatively up over 24% on Fringe 2023 matched with an astonishing 943 individual visits from Press and Media! That's an average of almost five media tickets issued per show!

Every Fringe is special but for us 2025 celebrates a special landmark – Greenside turns 20! From our humble start of just one performance space and four shows per day Greenside has grown into a Fringe staple – proudly supporting the same principles as we did 20 years ago.

2024 marked the launch of Greenside @ George Street and what an inaugural year – record breaking sales, sell out shows, record numbers of media to see our shows, award nominees and winners as Greenside set to establish our new venue as a thriving Fringe hub and we did just that. We return to George Street in 2025 with a brand new space! Jade Studio takes us to SEVEN spaces under one room – firmly cementing Greenside @ George Street as one of the largest Venue Hubs in Edinburgh

As you'd also expect we return to our Royal Mile home – Greenside @ Riddle's Court – set seconds from Edinburgh's most famous landmark – The Castle! With four spaces, our beautiful Yurt and Courtyard seating Riddles Court is quintessentially Edinburgh

For Fringe 2025 we're incredibly excited to present to you eleven spaces across our two centrally located venue hubs – now all we need is you lovely lot to come and join the fun!

They say a picture speaks a thousand words; well a video speaks a million... Check our website for video tours of both our venues and every one of our spaces.

We promise to make things clear and simple. This means we have a straight hire deal; we don't operate a Box Office split.

We also promise that you're in safe hands; in 2024 our wonderful programme bursting with every conceivable genre was the **FOURTH** biggest programme at the biggest Arts Festival in the World- considering there are well over 300 Venues we're pretty happy with that achievement! We think we're just the right size to care and know all our shows individually but big enough to stand out.

We know that you care about fair working practices, the environment and accessibility. Which is why you can be safe in the knowledge that you're part of a venue that pays every single member of its team (irrespective of age) at least the living wage. You'll also be part of a venue that strives to be as accessible as possible having recently been awarded our level one access Award from the Fringe. To round things off we also fully subscribe and have signed up to the Fringe Society's Code of Conduct for Venues.

Finally and importantly we promise to be friendly, approachable and fair. We do this because we want to create great venues and places that people want to be at. We do this because we love the Festival and we want you to love it too.

Greenside Venues - Open, Clear and Friendly.

Contents

At a Glance	4-5
Greenside @ George Street	6-21
Greenside @ Riddles Court	22-31
We're Here For You	32-33
How Does it Work?	34-35
How Much Does it Cost?	36-37
What Else?	38-39
What They Don't Tell You	40-41
What Next	41-42



At a Glance

Lets get the important bits out of the way first: you’re looking for that perfect space and that perfect space has to be the right size and capacity. We have summarised the key information on all of our spaces below.

Once you have found the space that looks right, delve deeper into the pack and find specific information and plans about your space.

Greenside @ George Street							
	Forest Theatre	Mint Studio	Ivy Studio	Olive Studio	Lime Studio	Jade Studio	Fern Studio
Capacity	100	34	33	45	65	65	29
Width	6m	2.5m	5m	7m	5.5m	5	4.5
Depth	5m	2.5m	3m	3m	6m	3	2
Style	End On	Corner	End On	End On	End On	Thrust	End On

Greenside @ Riddles Court				
	Thistle Theatre	Willow Studio	Clover Studio	Pickle Studio
Capacity	70	60	20	22
Width	5m	4m	3m	2m
Depth	5m	3m	2m	2m
Style	End On	Thrust	End On	End On

You will find plans for all our spaces in this back but for the most up to date and detailed plans, please check our website.

Alternatively, please let us know if you have any specific requirements as some of our spaces may be more suitable than others.

PS... YES! All our spaces are named after something Green, cute right?!

“Is there a lovelier venue anywhere at the Fringe? I can’t think of one”

The Wee Review

GREENSIDE @ GEORGE STREET

Set in the heart of Edinburgh, George Street is one of Edinburgh's most recognisable names - home to established Fringe venues and moments from the historic landmarks; the Mound, Princes St and a short stroll to the Royal Mile - Greenside @ George Street is set inside the epic landmark The Royal Society of Edinburgh and now Greenside adds to this infamous Edinburgh location.

With seven spaces Greenside @ George Street launches as one of the largest Multi Venue Hubs in Edinburgh! We're confident that one of our seven spaces will be just right for you add to that a beautiful indoor bar, lobby seating and that infamous Greenside charm we couldn't be more excited for our second season in our new multi venue hub

Greenside @ George Street

FOREST THEATRE

Tech Specs

Lighting

ETC Ion (or Equivalent)

X2 Moving Head Spots

Warm Front Wash

LED Back, Side and Top Light

Sound

Allen & Heath SQ6 (or equivalent)

2x Full Range Speakers (L&R)

1 x Sub (Centre)

3.5mm Jack for playback

Located in a year round Lecture Theatre, then given the Greenside make over... Forest Theatre is a beautiful raked 100 seat Theatre. Perfect for those that are looking for a big stage and audience capacity to match. No compromises are made here in our largest space at Greenside @ George Street.



Capacity: 100 | Stage Width: 6m | Stage Depth: 5m

8

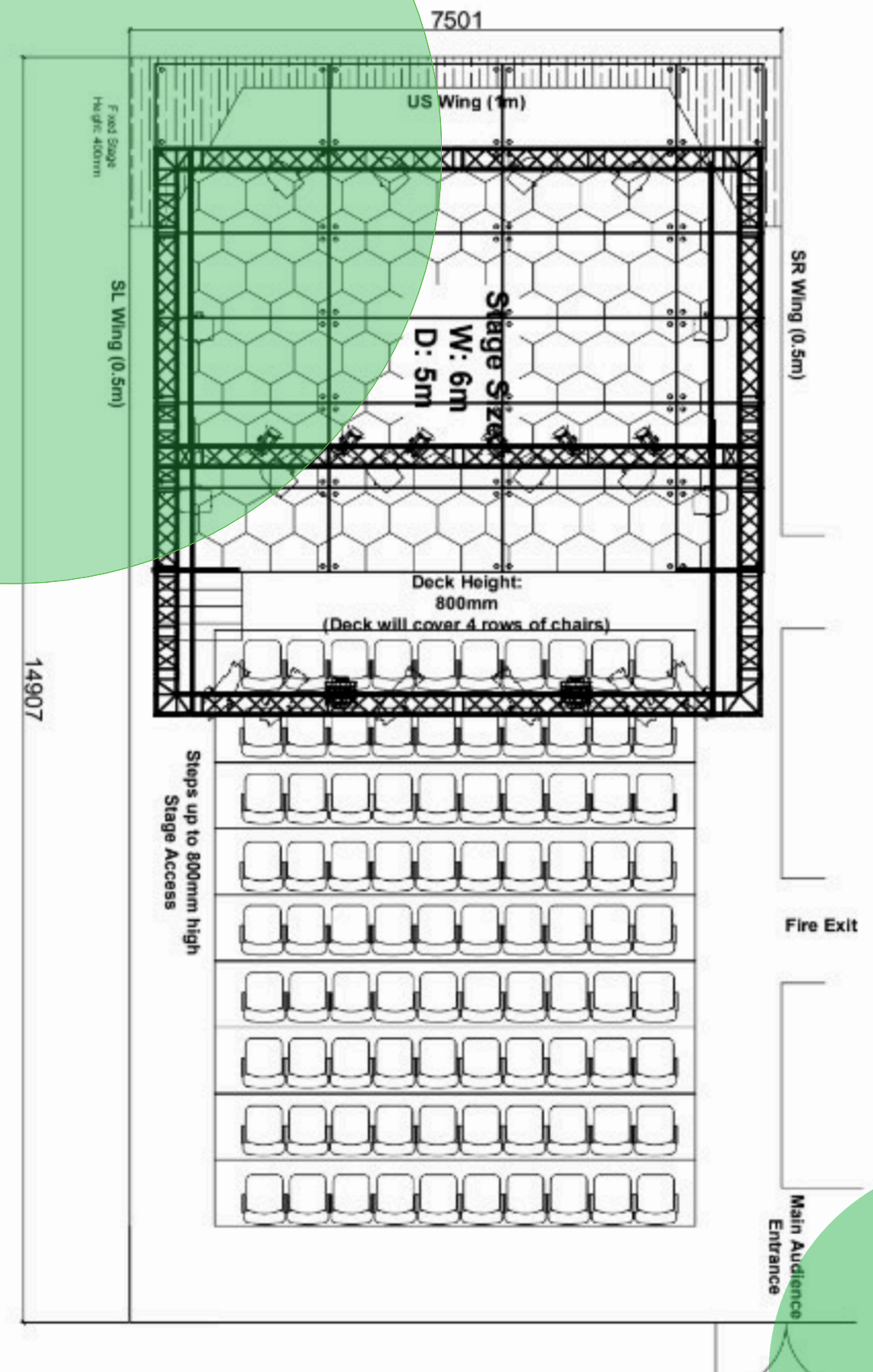

9

Greenside @ George Street

FERN STUDIO

Tech Specs

Lighting

Zero 88 Jester 12/24(or Equivalent)

Warm Front Wash

LED Back and Side Light

2x Refocusable Profiles

Sound

6 Channel Analogue Mixer

2x Full Range Speakers (L&R)

3.5mm Jack for playback

The baby of our George Street family! Fern Studio is perfect for Greensiders who are not looking for a huge capacity and want an intimate stage to go with it.

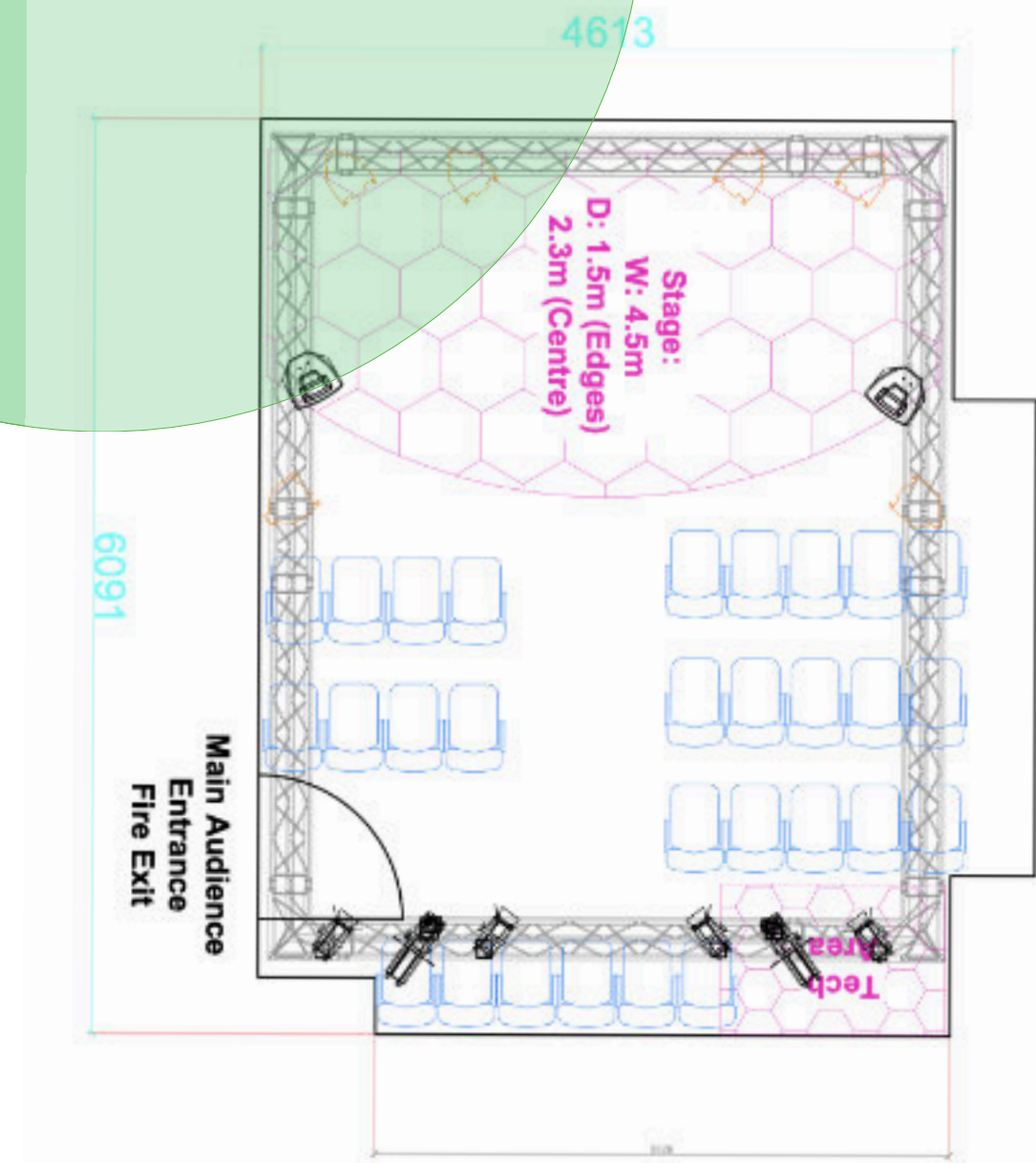

Capacity: 29 | Stage Width: 4.5m | Stage Depth: 2.3m

Greenside @ George Street

IVY STUDIO

Tech Specs

Lighting

Zero 88 Jester 12/24(or Equivalent)

Warm Front Wash

LED Back and Side Light

1x Refocusable Profiles

Sound

6 Channel Analogue Mixer

2x Full Range Speakers (L&R)

3.5mm Jack for playback

A beautifully crafted 33 seat black box studio. For Greensiders who want something a tad bigger than Fern but still a really manageable capacity.

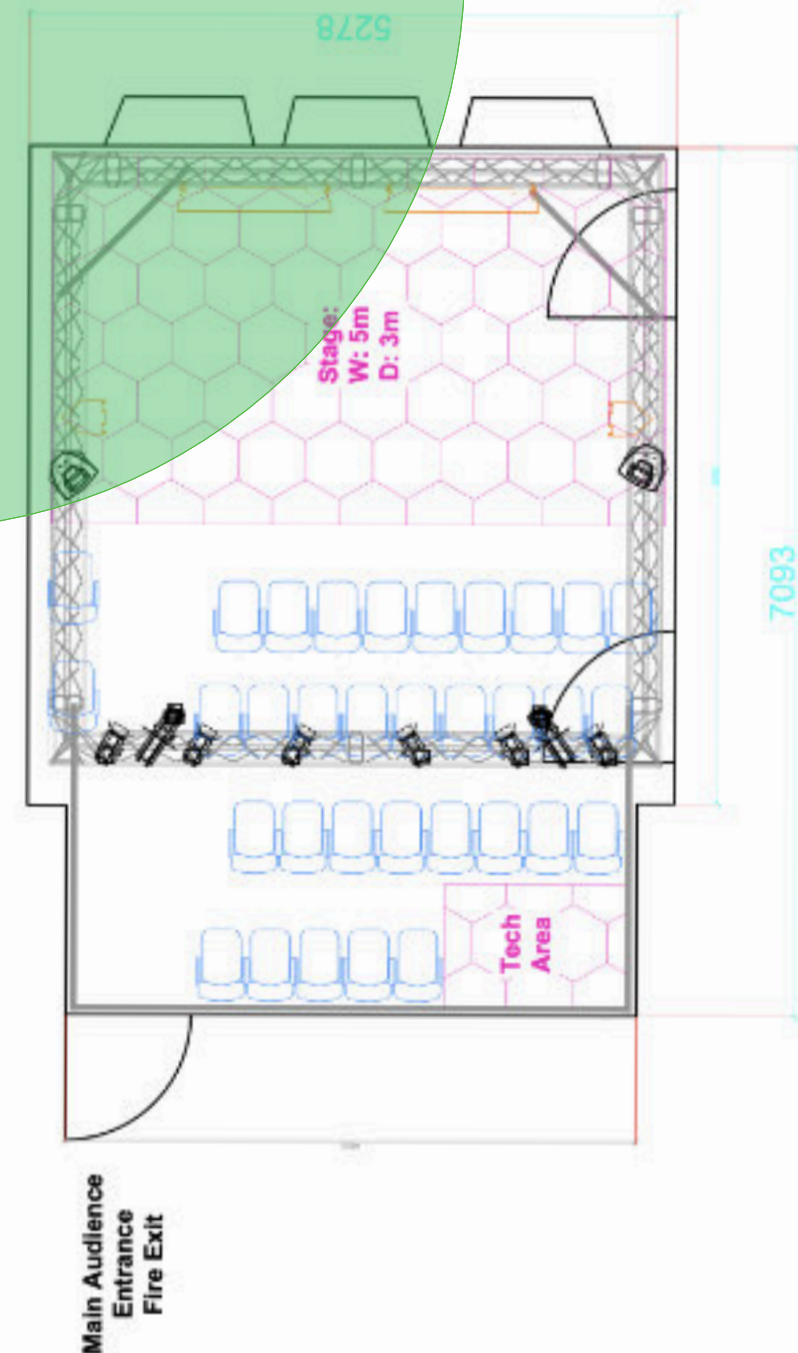

Capacity: 33 | Stage Width: 5m | Stage Depth: 3m

Greenside @ George Street

LIME STUDIO

Tech Specs

Lighting

Zero 88 Jester ML24(or Equivalent)

Warm Front Wash

LED Back, Side and Top Light

3x Refocusable Profiles

Sound

16 Channel Analogue Mixer

2x Full Range Speakers (L&R)

1x Sub

3.5mm Jack for playback

Our second largest space at George Street - 65 seats AND a big old stage to match - If Forest Theatre feels a tad big then Lime Studio is the one for you. Plus.. Look at the size of the backstage... Bigger casts, larger sets? Lime is for you!



Capacity: 65 | Stage Width: 5.5m | Stage Depth: 6m

14

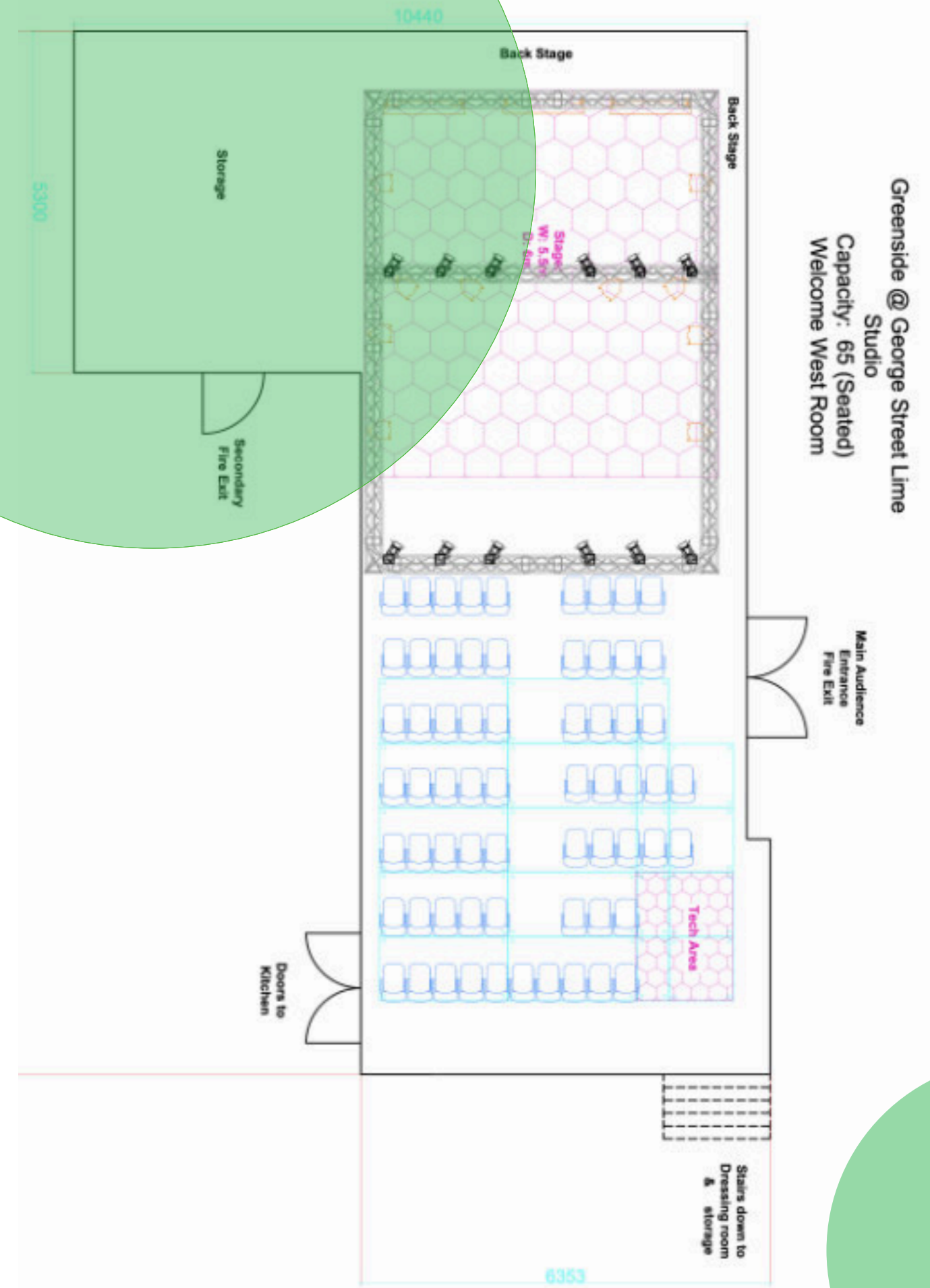

15

Greenside @ George Street

MINT STUDIO

Tech Specs

Lighting

Zero 88 Jester 12/24(or Equivalent)

Warm Front Wash

LED Back and Side Light

2x Refocusable Profiles

Sound

6 Channel Analogue Mixer

2x Full Range Speakers (L&R)

3.5mm Jack for playback

End on stage not for you? Look no further! Mint could just be the thing you've been looking for. With an intimate capacity of 34 and an audience on two sides Mint is a great alternative to the 'end on' norm!

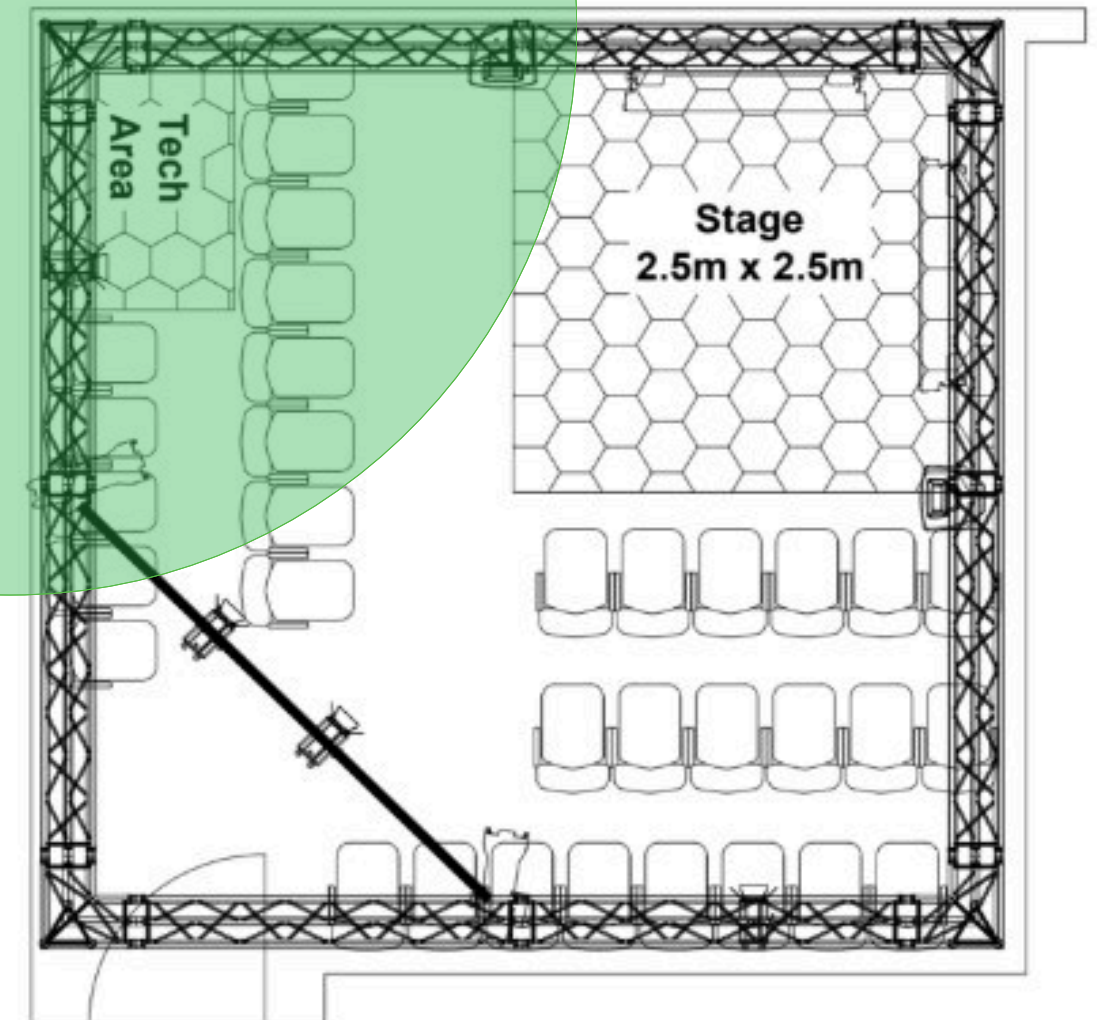

Main Audience
Entrance
Fire Exit



Capacity: 34 | Stage Width: 2.5m | Stage Depth: 2.5m

Greenside @ George Street

OLIVE STUDIO

Tech Specs

Lighting

Zero 88 Jester 12/24(or Equivalent)

Warm Front Wash

LED Back, Side and TopLight

2x Refocus-able Profiles

Olive Studio is perfect for those Greensiders who require a wider stage. Matched with a 45 seat capacity Olive is the perfect stepping stone from our smaller studios but not as big as Forest or Lime.

Sound

8 Channel Analogue Mixer

2x Full Range Speakers (L&R)

3.5mm Jack for playback

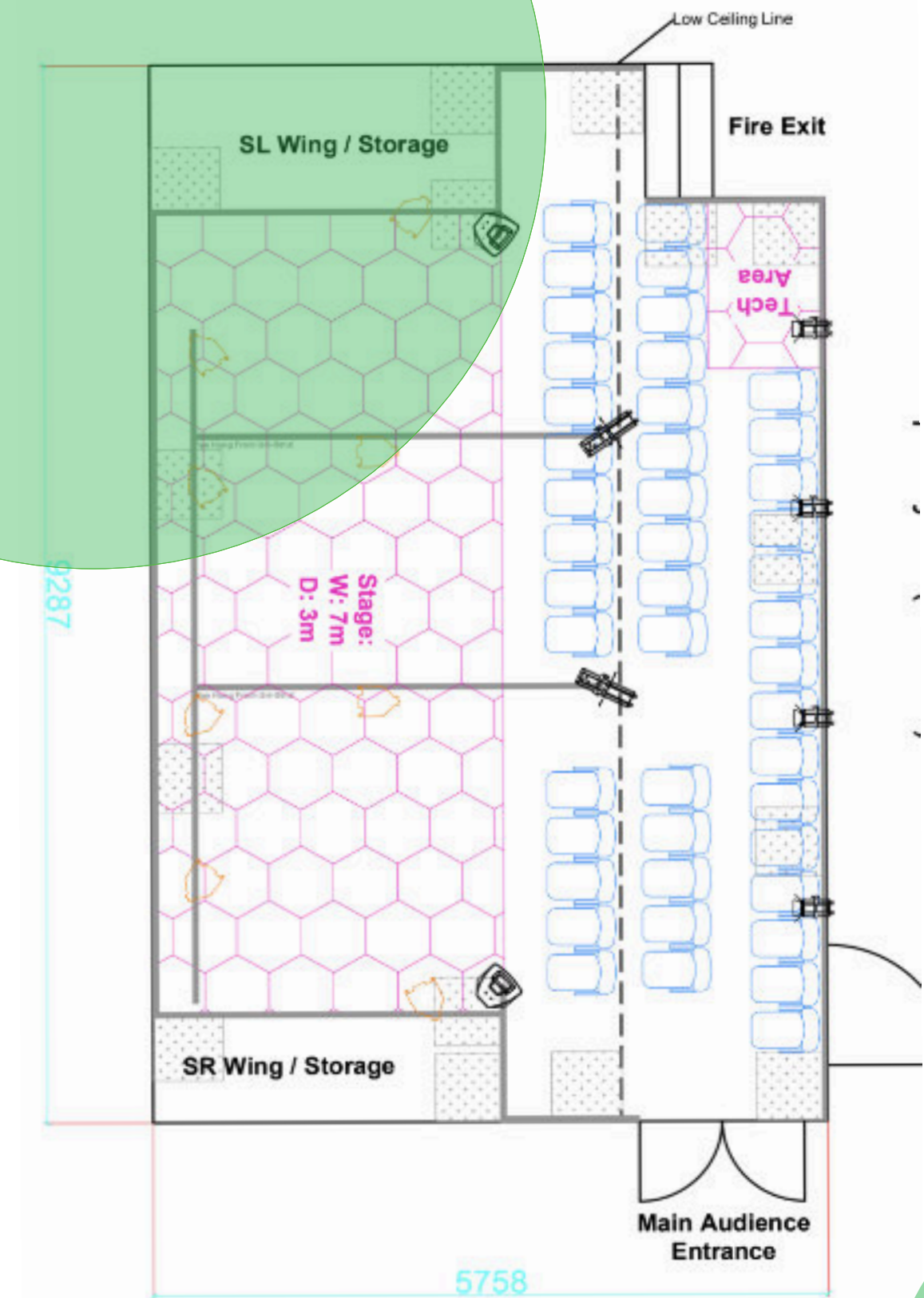

Capacity: 45 | Stage Width: 7m | Stage Depth: 3m

Greenside @ George Street

Jade STUDIO

Tech Specs

Lighting

Zero 88 FLX (or Equivalent)

Warm Front Wash

LED Back Light

2x Refocusable Profiles

Sound

8 Channel Analogue Mixer

2x Full Range Speakers (L&R)

3.5mm Jack for playback

Meet the new kid on the block! Well.... We say new... Jade Studio was the name of our FIRST ever Studio back in our original venue twenty years ago! Given this is our 20th year we thought we should bring back Jade!

Modeled on our hugely popular Willow Studio at Riddle's Court we have our first fully thurst space at George Street - Our biggest Thurst space lands Fringe 2025

• **NEW FOR 2025**

Capacity: 65 | Stage Width: 5.5m | Stage Depth: 6m

20

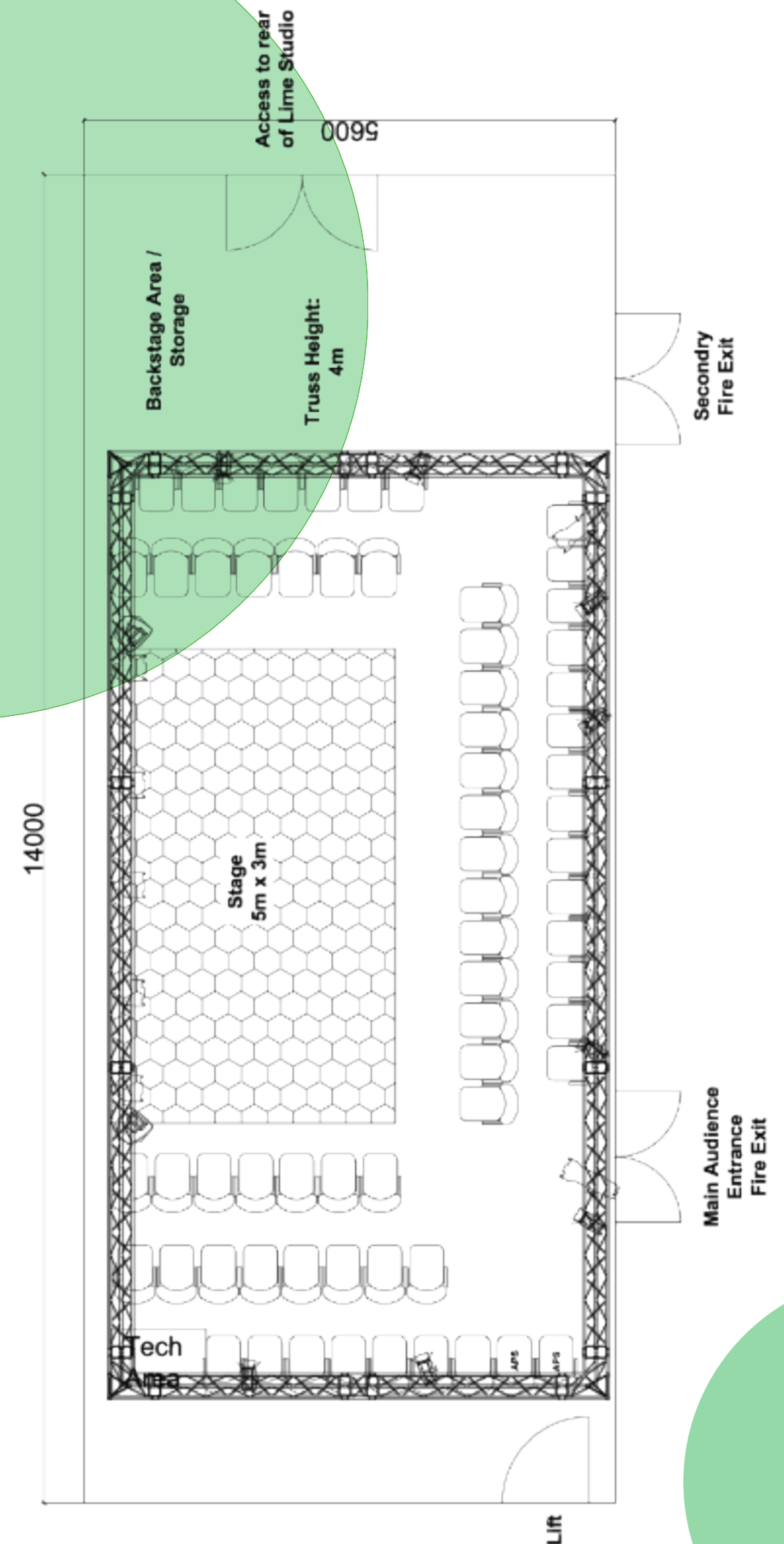

GREENSIDE @ RIDDLE'S COURT

Back for 2025 Greenside @ Riddle's Court is returning bigger and better! Now with FOUR spaces RIGHT in the heart of Edinburghs most famous Street.

If you want to feel fully absorbed by the Fringe, have Edinburghs most famous landmark, the Castle seconds from your venue then look no further,

Riddle's Court is an incredible listed building with over 400 years of History - if only the walls could talk!

In 1751 a state Banquet was held and attended by non other than King James VI. It'll come as no surprise that the building also has a rich Fringe History.

Over the years some familiar faces such as Dame Maggie Smith and Sir Stephen Fry have graced the stages in this venue.

With Four spaces, a bar and beautiful courtyard seating all on the Royal Mile; Greenside @ Riddles Court is a Fringe venue that has it all.



Greenside @ Riddles Court

THISTLE THEATRE

Tech Specs

Lighting

TC Ion (or Equivalent)

Warm Front Wash

LED Back Light

LED Side Light

3x Refocus-able Profile

Sound

Allen & Heath SQ5 (or equivalent)

2x Full Range Speakers (L&R)

2x Subs (L&R)

3.5mm Jack for playback

The largest space at Riddle's Court - the beautiful 70 seat black box studio. Perfect for Greensiders looking for a larger stage and audience capacity.



Capacity: 70 | Stage Width: 5m | Stage Depth: 5m

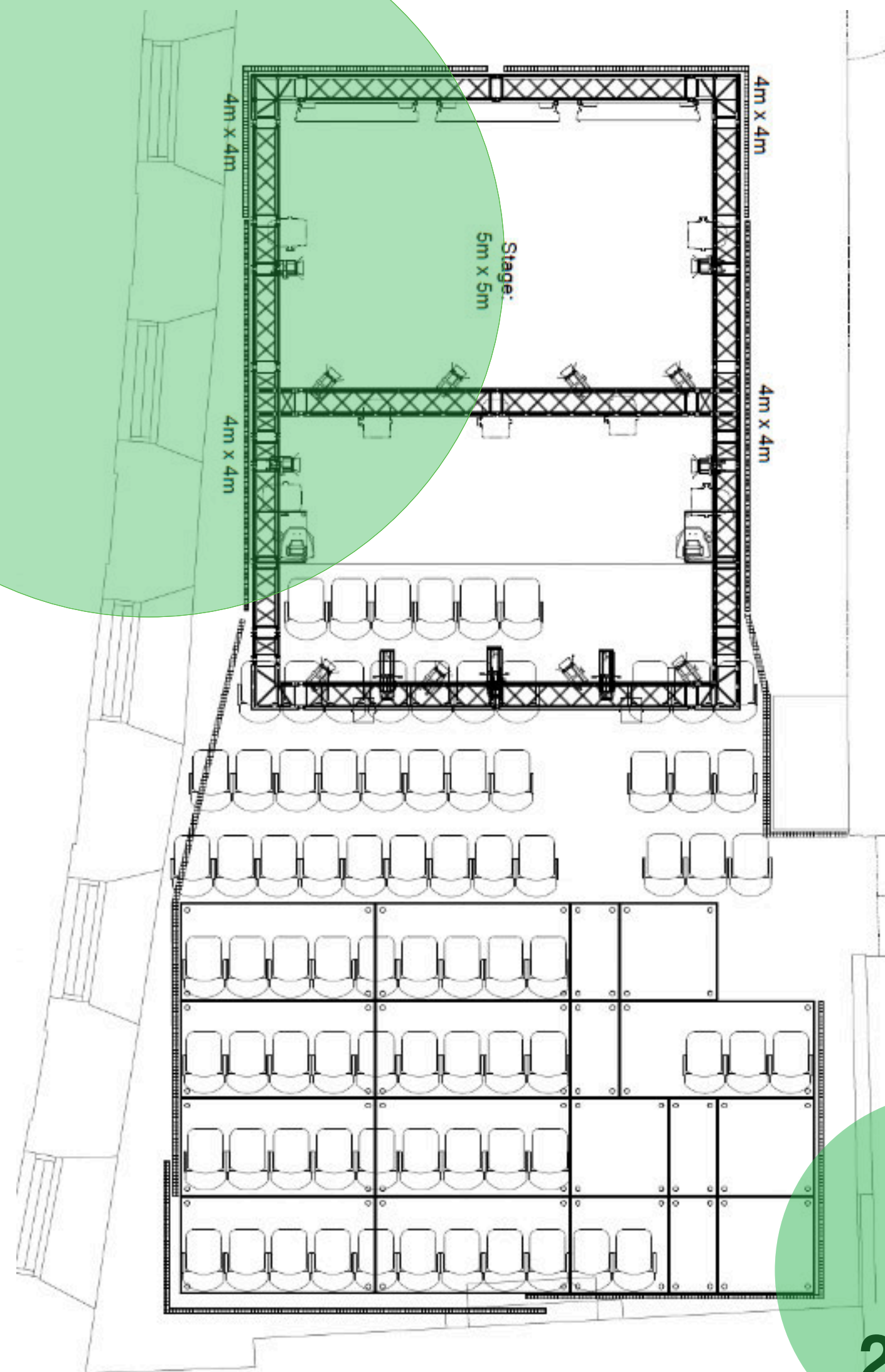

Greenside @ Riddles Court

WILLOW STUDIO

Tech Specs

Lighting

Zero 88 FLX (or Equivalent)

Warm Front Wash

LED Back Light

Warm Side Light

3x Refocus-able Profiles

Sound

8 Channel Analogue Sound Desk

2x Full Range Speakers (L&R)

3.5mm Jack for playback

End on not for you? Look no further - Willow Studio and its thrust stage matched with 60 capacity makes this a perfect choice for Greensiders looking for something different



Capacity: 60 | Stage Width: 4m | Stage Depth: 3m

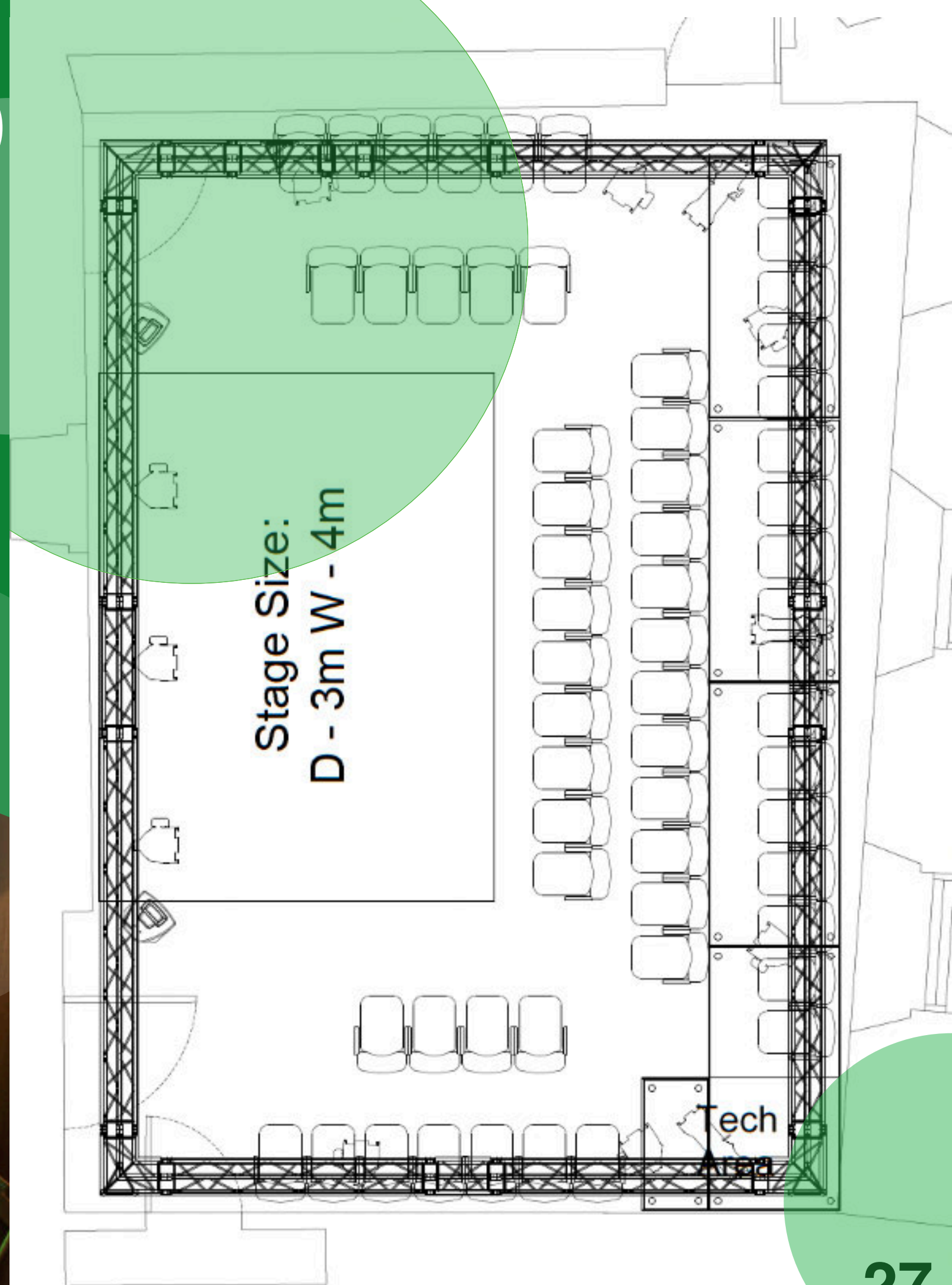

Greenside @ Riddles Court

CLOVER STUDIO

Tech Specs

Lighting

Strand 100 (or Equivalent)

Warm Front Wash

LED Back Light

Sound

4 Channel Analogue Mixer

2x Full Range Speakers (L&R)

3.5mm Jack for playback

We know that big stages and equally big capacities are not for everyone. Small cast? Don't need a huge amount of stage and no backstage work for you? Then Clover Studio could be the space for you.



Capacity: 20 | Stage Width: 3m | Stage Depth: 2m

Greenside @ Riddles Court

PICKLE STUDIO

Tech Specs

Lighting

Strand 100 (or Equivalent)

Warm Front Wash

LED Back Light

Sound

4 Channel Analogue Mixer

2x Full Range Speakers (L&R)

3.5mm Jack for playback

Modelled on the success of Clover Studio we have the new kid on the block for 2024 - Pickle Studio caters for our Greensiders who know that the best things come in small packages! A cute stage and audience capacity to match!



Capacity: 22 | Stage Width: 2m | Stage Depth: 2m

30

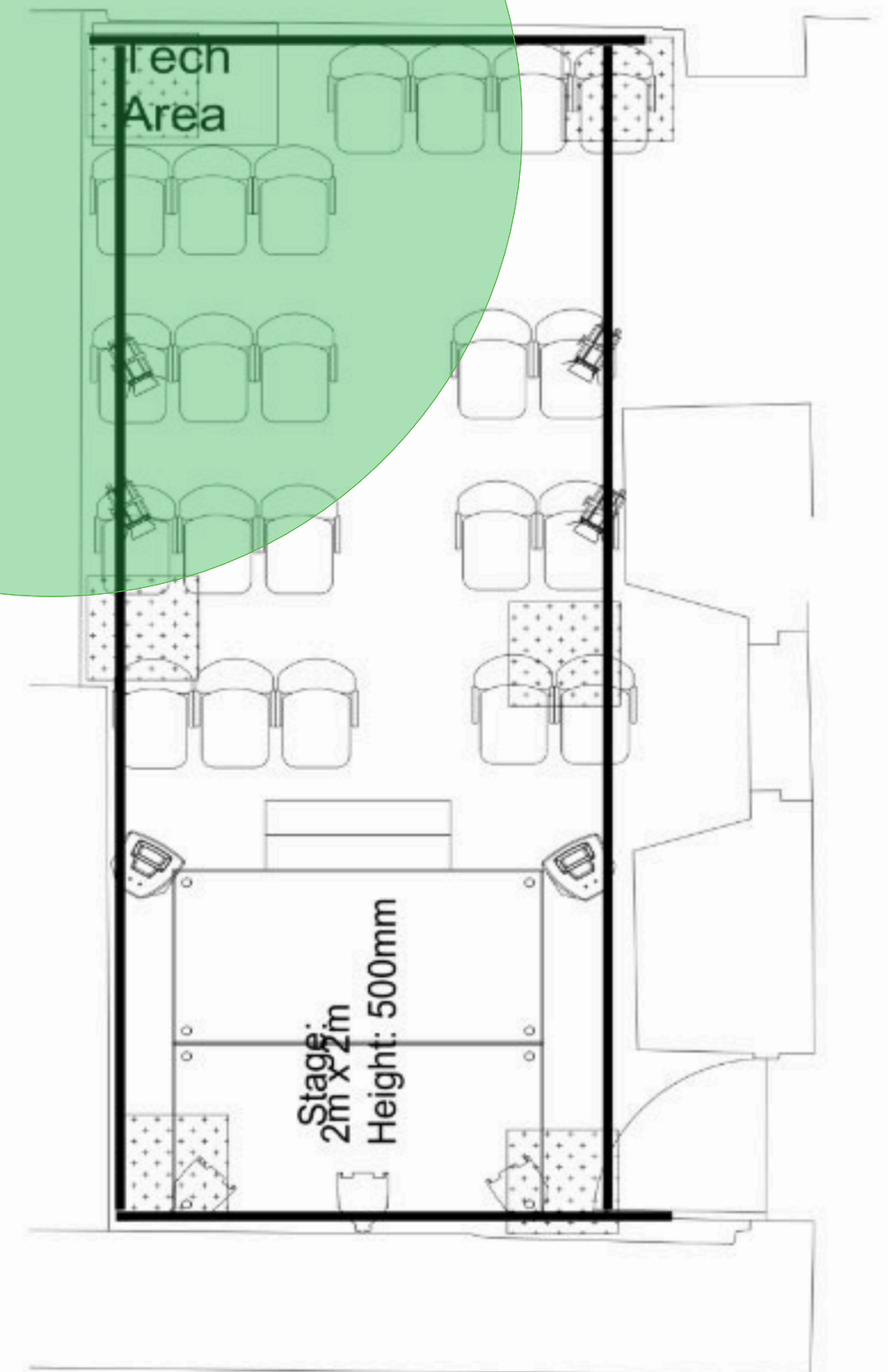

We're here for you

We believe that we uphold the founding principles of the Festival Fringe. The Fringe should truly be a platform where anybody who wishes to perform should be able to perform. Now we know that's quite a claim to make but it's one that we passionately stand by. Everyone is welcome at Greenside.

Providing a space however is just the start of our service.

We aim to provide you the most inclusive, friendly and approachable service at the Fringe. We want to create a community of likeminded people with shared goals and values. How? Well we've been there before, your Management Team all started the Fringe as performers and we know how hard it is. It's scary, daunting and seems like the work load is never ending, but it's worth every second! We want to be your ultimate Fringe support. We want to be able to help you out with aspects of the Fringe that you wouldn't think of asking us for. Like where should you stay, how to get to Edinburgh, where to park, where the best pint in town is, that secret restaurant that only locals know about.

Anything else that you can think of, we really do go by the saying that is 'there is no such thing as a stupid question.'

We're here for you every step of the way!



How does it work?

Slots / Time of Day / which week to perform

You've probably asked yourself one of the following questions:

'What time of day should we perform?'

'What week should we perform in?'

'How many weeks should we perform for?'

The truth is there is no definitive answer; each show / company is different. We'd love to have the opportunity to have a good natter over the phone with you and help you make those decisions.

To help in advance though, heres some important info about the way Greenside operates:

- Our slots are 1hr and 10 Minutes, this is to include your get in, performance and get out.
- The 'standard' Fringe show is around 50 minutes with 10 minutes either side.

Need longer? Speak to us and let us discuss your options.

Our key 2025 Dates are*:

Wednesday 30.07.25

Wednesday 30.07.25 - Thursday 31.07.25

Friday 01.08.25 - Sunday 03.08.25

Monday 04.08.25- Saturday 09.08.25

Sunday 10.08.25

Monday 11.08.25 - Saturday 16.08.25

Sunday 17.08.25

Monday 18.08.25 - Saturday 23.08.25

Press Launch

Technical Rehearsals (W1)

Previews

Week One

Technical Rehearsals (W2)

Week Two

Technical Rehearsals (W3)

Week Three

How much does it cost?

We offer an all inclusive one off straight hire fee.

So... we've made it really (really) simple: You pay us one cost, if you perform earlier in the day it is cheaper than later. You then pay this before you arrive in two instalments one with your signed contract and one in May.

Simple right?

This flat hire includes the FULL use of your venue and:

- FULL Support staff

(Box Office, Venue Manager, Front of House etc.)

- Venue Box Office that is linked with the Fringe - HUGE plus to increase sales and cross selling with the Fringe. As standard there is a handling fee for tickets sold via Greenside's Box Office - 4% + VAT

- Fully assisted Technical Rehearsal with a Greenside technician showing you how everything works.

- Fully Licensed and council approved spaces.

- Complimentary Entry in our Venue Programme

- PRS Background Music license

- Opportunity to perform at the VIP Venue Press Launch (availability permitting)

- Free admittance* to ALL Greenside shows with your snazzy Greenside Lanyard! (There is a small cost for the lanyard paid for when in Edinburgh.)

- Discount at ALL Greenside Cafés and Bars with your Greenside Lanyard.



What Else?

Finding and sourcing your venue is only part of your Fringe administration there are other costs and considerations that you need to think of as early as possible so you can budget/plan accordingly.

Fringe Registration

Firstly you have to pay to 'Register' with the Fringe this is so you are included in the Fringe Programme. The Fringe can sell tickets on your behalf and all other benefits associated with being a registered Fringe show. Please check edFringe.com for the specific deadlines.

Insurance

To perform at Greenside we do require you to have Public Liability insurance. Don't worry though it's not as scary as it sounds, we recommend a specialist insurer who deals specifically with Fringe performers;

http://www.wrightsure.co.uk/Fringe_festival.php.

Members of equity may already have adequate individual cover please check.

Accommodation/Travel

This is a whole separate document to be had! Speak to us.... we know some great deals and places to look! Long story short... there really is a lot to do, the above list is by no means exhaustive, it's just to start you thinking about what else is in store! As we said earlier though becoming a member of the Greenside Family means we are always on hand to help!

What they don't tell you...

So the Fringe is great, it's the biggest and best Arts Festival in the World but beware behind the glitz and glam is a whole lot of hard work. It is a tough hard slog and at times when it's raining hard and you've just had your thousandth flyer pushed in your face, and your best friend has just sent you a picture of themselves soaking up the sun on an exotic beach, you can question your sanity for being in Edinburgh. Anyone that has been to the Fringe before will have experienced something along these lines. Sometimes it isn't easy, far from it.

We are proud of our service and our venues but lets be sure we are all singing from the same green hymn sheet. You are paying a flat hire venue. Put simply put you are hiring a performance space. We promise to provide you a functional performance venue with lights and sound equipment. Staff who will sell tickets through the box office that we provide, and we will let your audience in and out of the performance space. Nobody can guarantee you an audience in Edinburgh and we wont pretend to either; it's an incredibly fierce market place with over 3,000 shows all vying for attention.

We are here to support and guide you as much or as little as you need with the experience we have gained from running venues at the Fringe for almost 20 years. However we do not have a massive marketing department that can work tirelessly on your behalf getting your individual show reviewed and bums on seats. We do have press support and that means that we will ensure that any reviews you receive are printed and displayed at your venue, we will also deal with your venue press enquires and ensure the tickets are allocated. You also have the opportunity to meet some members of the press at your venue launch and we even distribute our own venue programme which you are of course include in. We're not by any means washing our hands of responsibility but its important to clarify that the responsibility of individually promoting your show is down to the expert of your show... ...which is you! That said, in 2024 we had an astonishing 943 visits from the Press and Media... with 196 shows that means on average our shows had five media visits each.. That is just an average tough some would have had more and some less.

We think that you are the best person for the job, you have the tools and knowledge to passionately promote your show.

It might seem like a silly thing to bring up BUT... all venues in Edinburgh will get hot.. Our venues are thriving. We have performances taking place in each space every hour, all day every day. The theatre lights are on in spaces that have been covered head to toe in black material with all windows covered and all doors shut. Throw into the mix a full house and cast on stage it's only natural that things will get hot! We work hard to minimise the impact with fans but its something we want to be clear about right from the start.

So.... if you're coming to the Fringe for financial success, 5* reviews, dreams of sell out audiences, critical acclaim, a west end transfer afterwards and generally an experience that will positively change your life forever, then the Fringe may not provide that for you. We are not saying that never happens because it does, however if you're coming to experience the largest arts festival in the world, and not just experience the best bits, but also the tough bits along the way.. If you get any one of the amazing things we've just mentioned and you'd consider that a bonus then you're in the right place.

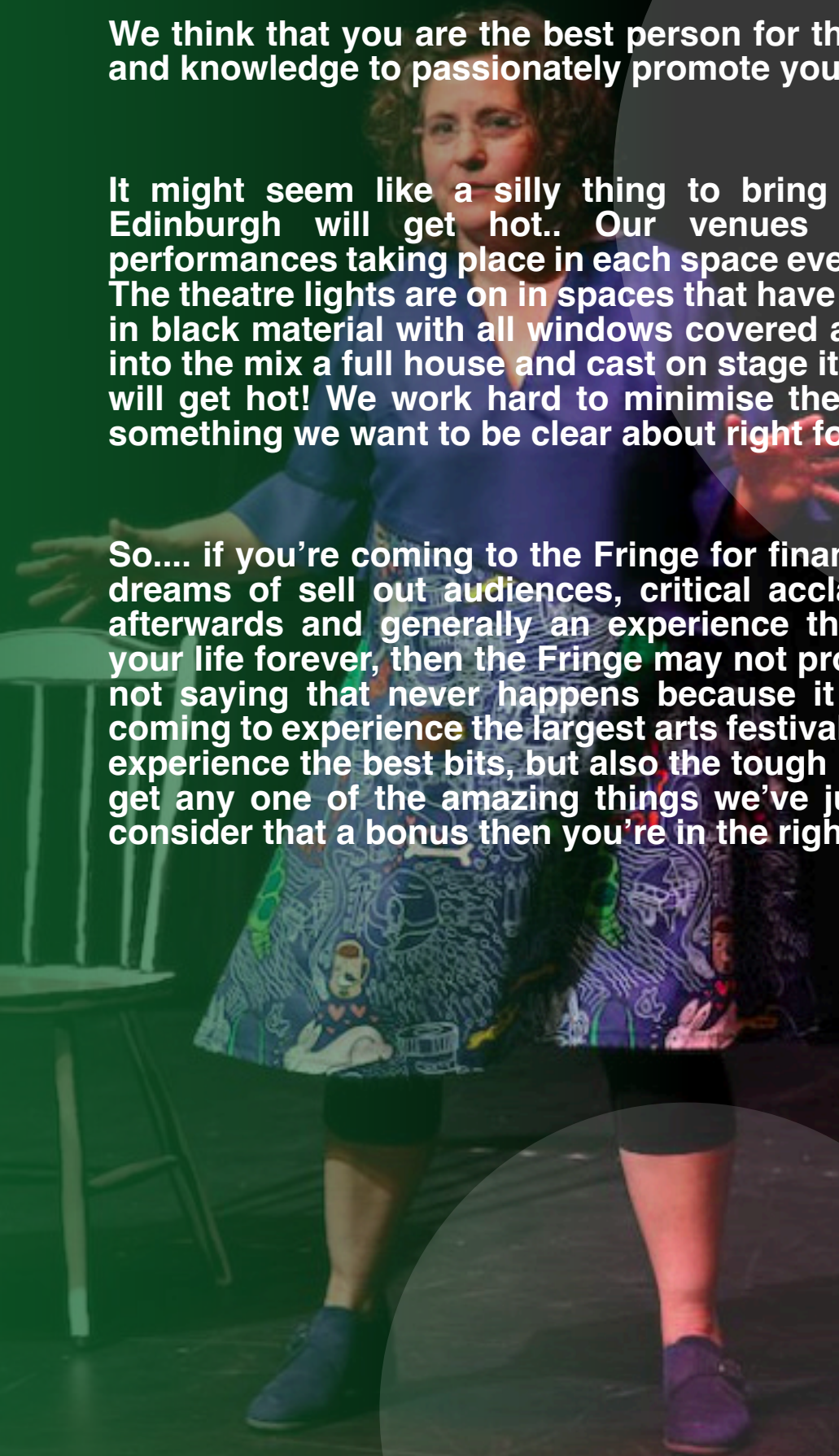

What Next?

We really hope you like what you see and have read. Choosing your venue is such an important decision and we really hope you decide that one of our spaces is right for you.

This pack has been designed as an introduction to Greenside.

All you need to do now is get in touch, no complicated online application forms just a simple email:

enquire@greensidevenue.co.uk

You can contact either Darren or Tara directly:

Darren Neale - Venue Director

darren@greensidevenue.co.uk

07562 978607

Tara Stapleton - Venue Director

tara@greensidevenue.co.uk

07845 279094

We love social media and use it as a key way to communicate and promote our venue and in turn, your show.

Follow us on Facebook:

[Greenside Venue](#)

Follow us on Twitter:

[@GreensideVenue](#)

Follow us on Instagram:

[@GreensideVenues](#)

We look forward to hearing from you!

Tara, Darren and all of Team Green

x



GREENSIDE

“An amazingly Eclectic lineup”

BBC