

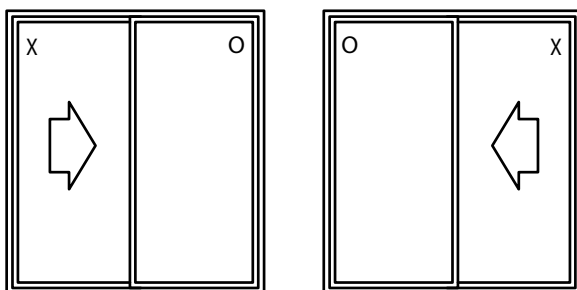

Series 400 and 500
XO & OX Vinyl Sliding Patio Door
FIELD REVERSE GUIDE



Two Panel Doors



Scan QR code for
detailed installation
instructions.



Series 400 and 500 XO & OX Vinyl Sliding Patio Door FIELD REVERSE GUIDE

UNPACK YOUR NEW VINYL SLIDING PATIO DOOR
BY WINCORE® AND CONFIRM THAT YOU
HAVE RECEIVED THE CORRECT COLOR, SIZE AND STYLE.
PLEASE CHECK FOR ANY DAMAGE THAT MAY HAVE
OCCURRED DURING SHIPMENT.

Contents	Page
Part Details	1
Step 1 & 2	2 - 3
Step 3 & 4	4 - 5
Step 5 & 6	6 - 7
Step 7 & 8	8 - 9
Step 9 & 10	10 - 11
Step 11 & 12	12 - 13
Step 13 & 14	14 - 15
Step 15 & 16	16 - 17
Step 17 & 18	18 - 19
Notes	20 - 21

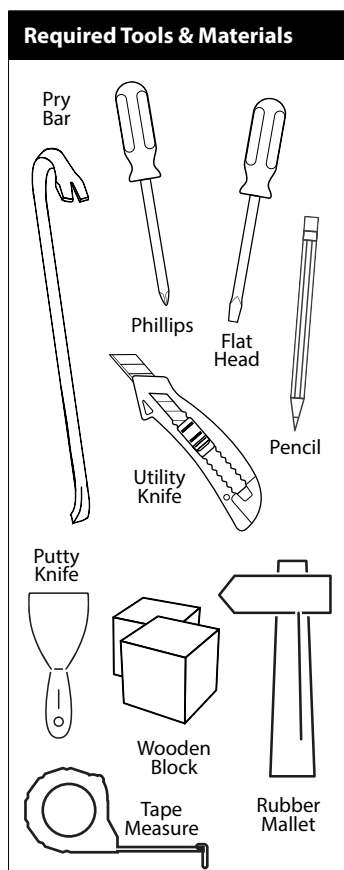

Series 400 and 500

XO & OX Vinyl Sliding Patio Door

PART DETAILS

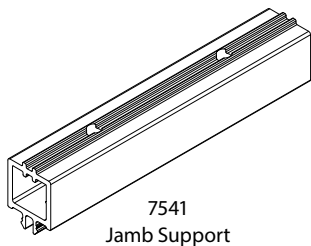

7541
Jamb Support

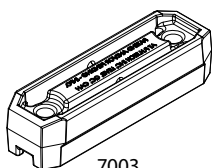

7003
Anchor Black

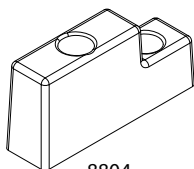

8804
Sash Stopper

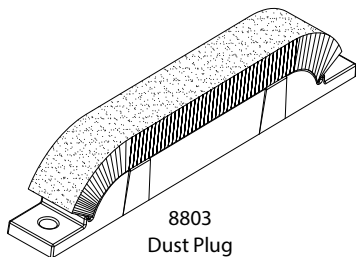

8803
Dust Plug



9667
Screw Hole Cover



5771
Inactive Sash Trim

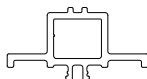

8001
Bottom Fixed Panel Support



8022
Top Fixed Panel Support

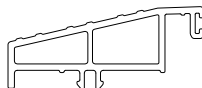

8011
Sill Cover

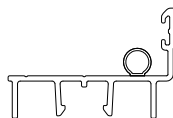

8004
Jamb Cover

1

Step 1 **Reversibility Instructions**

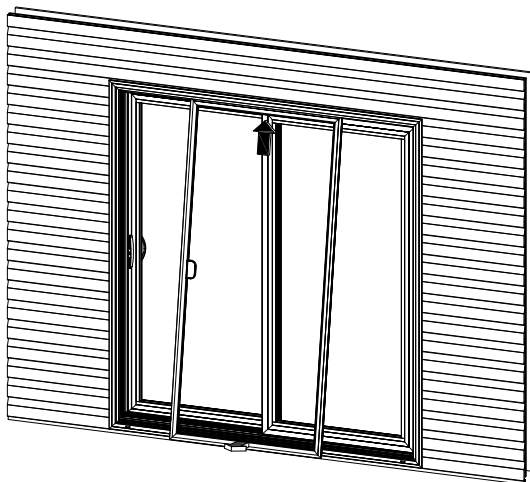

- A** From the exterior, adjust the rollers at the top and bottom of the screen with a Phillips screwdriver by turning the adjustment screw counter-clockwise.
- B** Lift the screen toward the head of the door, tilt at the bottom and pull the screen out toward the exterior.

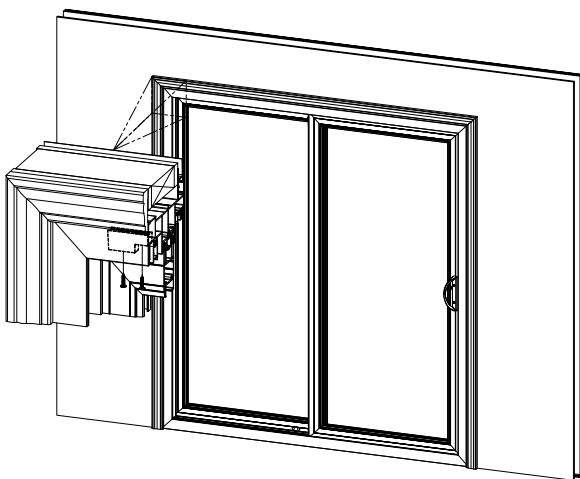

- C** From the interior of the door and with the active panel in the closed position, remove the sash stopper (8804), located in the head of the door on the inactive side of the door next to the jamb, by reversing the two screws in the sash stopper with a Phillips screwdriver.

Step 2 Reversibility Instructions

2

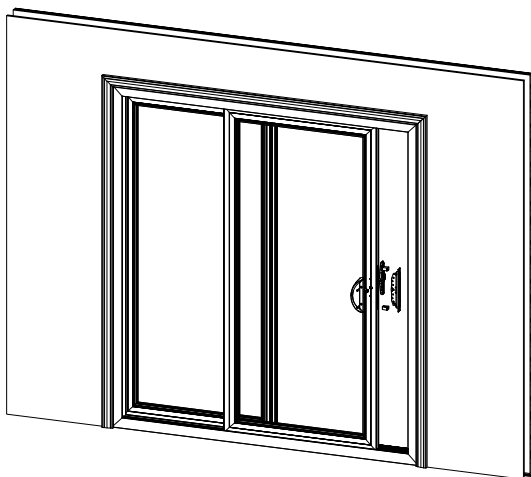

- A** From the interior of the door and with the active sash vented, remove the screws from the handle and mortise assembly. Remove the interior handle, thumb turn, exterior handle, cylinder, mortise and mortise shims from the active sash and set aside for future use.

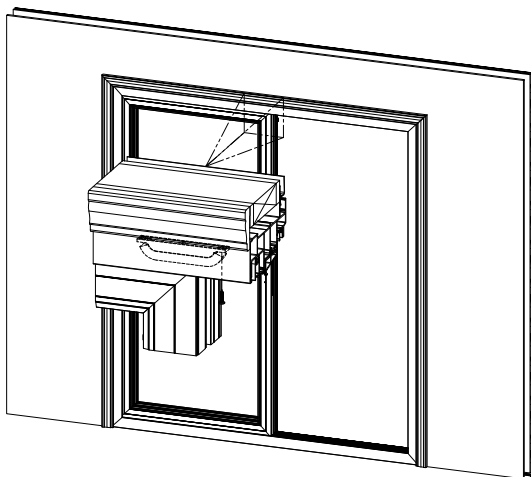

- B** Once the handle assembly has been removed, slide the active panel directly in front of the inactive sash and locate the black dust pad (8803) above the active panel on the interior of the door. Remove the visible screw with a Phillips screwdriver.

3

Step 3 Reversibility Instructions

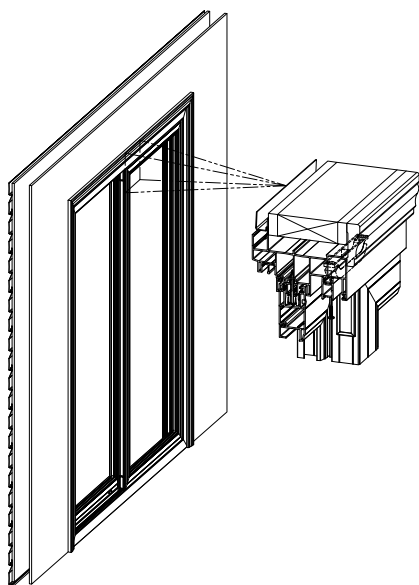

- A** Slide the active sash to the closed position and remove the remaining screw from the dust plug (8803) located above the active sash.

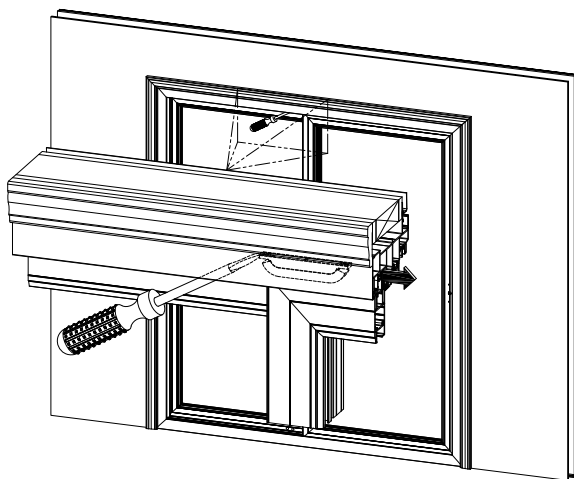

- B** With the active sash still in the closed position, use a flat head screwdriver to push the dust plug (8803) toward the active sash as far as possible.

Step 4 Reversibility Instructions

4

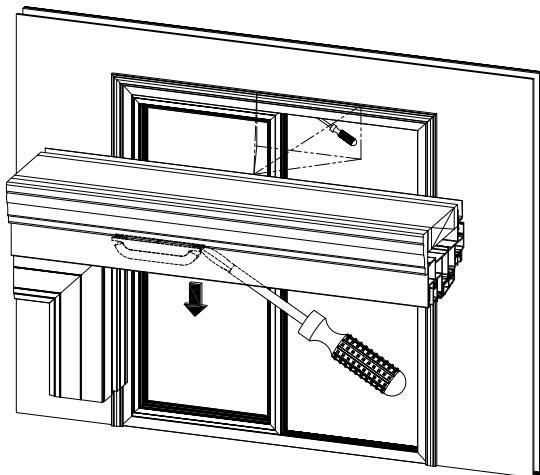

- A** Using a flat head screwdriver, find the edge of the dust plug (8803) and work the dust plug out of the mainframe.

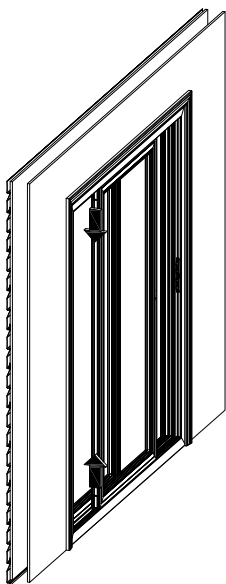

- B** Slide the caps found at each end of the interlock of the active panel.
- C** Move the active panel to the center of the unit and adjust the height of the active panel by turning the roller screws found at the sill end of the active sash. Turn the screws in a counter-clockwise direction to lower the sash.

5

Step 5 Reversibility Instructions

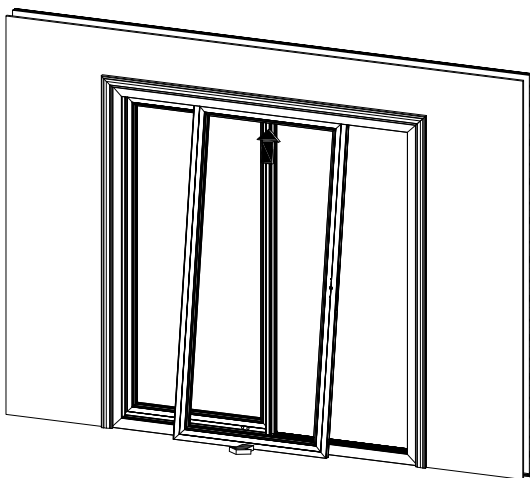

- A** From the inside of the door, lift the operating panel, tilt the bottom of the panel and pull the panel out.

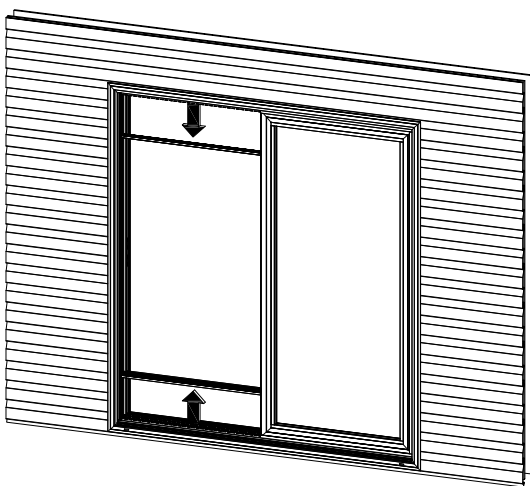

- B** From the exterior of the door at the threshold, locate the sill cover (8011) next to the inactive panel. After finding the exposed edge of the sill cover, insert the tip of a pry bar into that seam and, with a wood block as leverage, push down on the bar to work the plate off, beginning at the center of the plate and working towards the ends of the part. Repeat this process at the head of the unit.

**NOTE - Because of the aggressive nature of this part, it is possible to crack or damage the sill cover during the removal process. If the sill cover is damaged, please contact inside sales for replacement components.*

Step 6 Reversibility Instructions

6

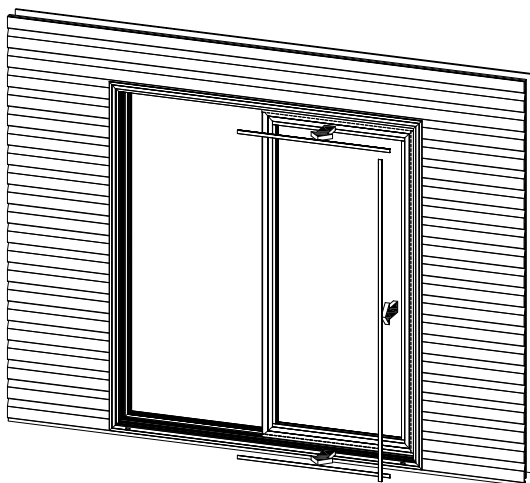

- A** On the exterior side of the unit, remove the trim (5771) from the inactive panel located at the head, sill and jamb. The trim can be removed by inserting a thin putty knife in the seam between the trim and mainframe and prying away from the glass of the unit. Begin this process nearest the cut end of the trim and work toward the center.

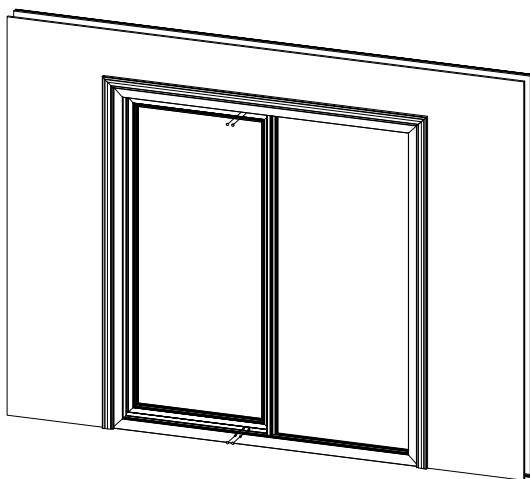

- B** After moving to the interior of the door, locate the screw hole covers (9667) in the face of the inactive panel nearest the interlock of the door (2 located at head and 2 located at the sill of the door).
- C** Remove each screw cover with the edge of a utility knife. After the covers have been removed, remove each screw using a Phillips screwdriver.

7

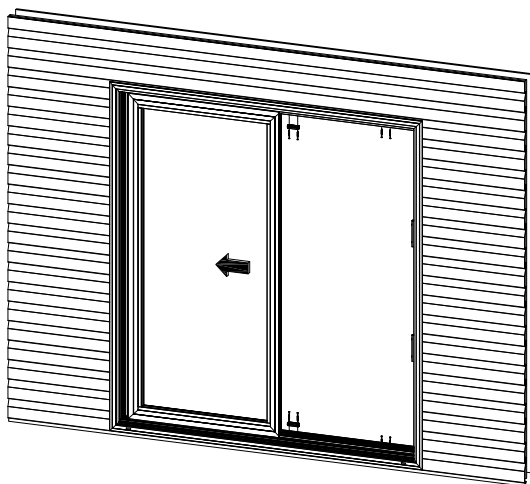
Step 7 Reversibility Instructions

- A** Slide the inactive panel to the open side of the door.
- B** With a Phillips screwdriver, remove the two screws in each anchor block (7003) and inactive sash supports located in both the head and sill of the unit.

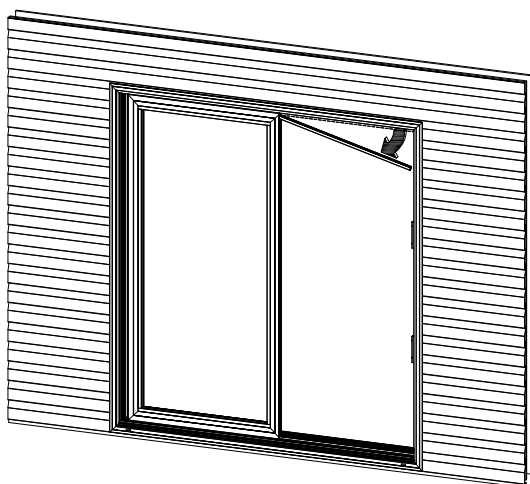

- C** Find the seam between the inactive sash support (8022), located in the head of the door, and frame. Insert the tip of a pry bar into the seam. Using a wood block as leverage, pry up on the bar to remove the support. Begin this process on the end nearest the jamb of the door.

Step 8 Reversibility Instructions

8

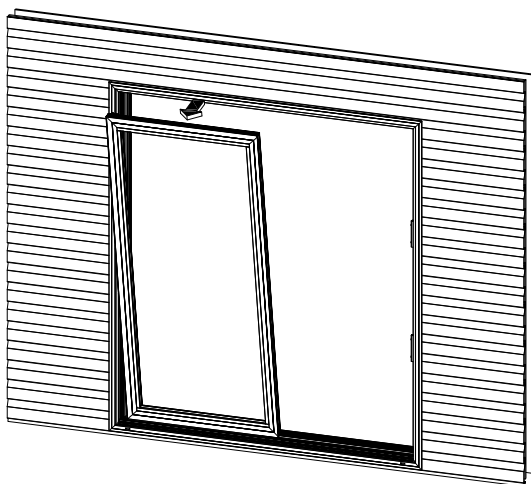

- A** From the exterior of the unit, tilt the top of the inactive sash toward the outside, lift and remove from the door unit.

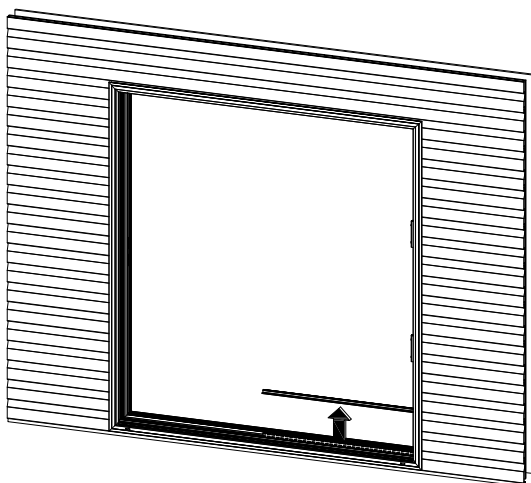

- B** Again, using a pry bar and a wooden block for leverage, remove the inactive sash support (8001) from the threshold of the unit.

9

Step 9 Reversibility Instructions

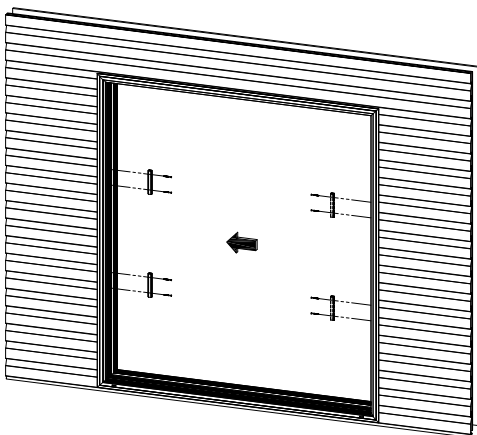

- A** Measure and make note of the locations of the two jamb supports (7541).
- B** With a Phillips screwdriver, remove the two screws located in each jamb support and remove the jamb support from the jamb.
- C** With the locations noted in step 9A, use a tape measure and pencil to mark the locations of the jamb support in the opposite jamb.
- D** Using a rubber mallet, insert each jamb support in the marked locations and anchor the support to the jambs with the screws removed in step 9B.

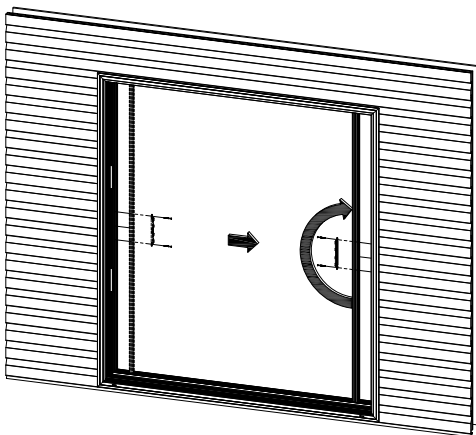

- E** Measure and make note of the keeper location in the jamb.
- F** Using a Phillips screwdriver, remove the two screws anchoring the keeper to the jamb and then remove the keeper.
- G** Insert a thin putty knife between the jamb cover (8004) and jamb and pry the cover out of the jamb.
- H** Turn the jamb cover 180° and place the cover in the opposite jamb with a rubber mallet.
- I** With the location noted in step 9E, locate the keeper and anchor the keeper to the jamb using the screws removed in step 9F.

Step 10 Reversibility Instructions

10

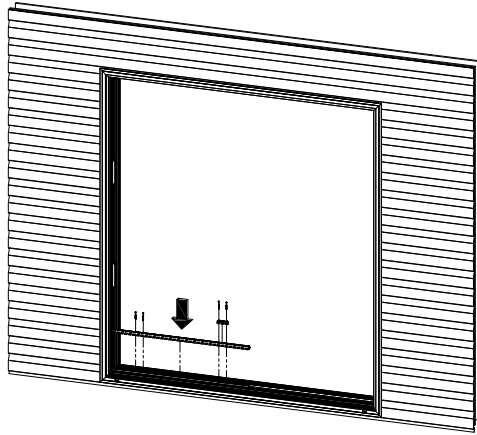

- A** Install the fixed panel support (8001) in the threshold of the door in the opposite side as was previously installed. Use a rubber mallet to snap the support into the threshold making sure that one end is pushed tightly against the jamb.
- B** Using two screws removed in step 7B, anchor the fixed panel support in the two screw holes nearest the jamb first.
- C** Place one of the anchor blocks (7003) removed in step 7B, aligning the holes of the anchor block with the holes in the support and then anchoring the anchor block to the fixed panel support with the two screws removed, also, in step 7B.

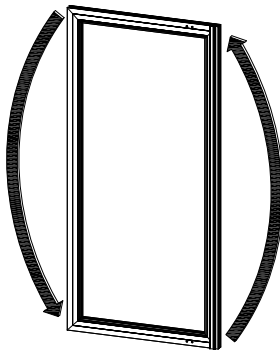

- D** Take the inactive panel and turn 180° making what once was the bottom of the panel the top.

11

Step 11 Reversibility Instructions

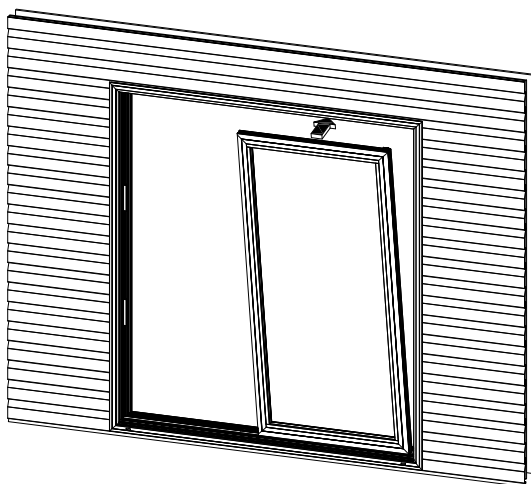

- A** From the exterior of the door, take the inactive panel that was just turned 180 degrees and lift into the side of the frame not containing the fixed panel support, bottom of the panel first and then pushing the top of the panel into the opening.

NOTE - prior to continuing to the next step, an additional person may be necessary in order to hold inactive panel into place while completing the inactive panel installation.

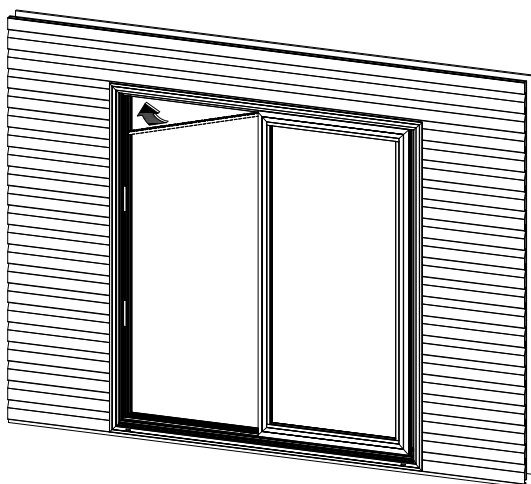

- B** Locate the top fixed panel support (8022) removed in step 7C and install, using into the head of the door frame beginning at the open end of the inactive sash panel and working toward the jamb. Use a rubber mallet to install the top fixed panel support. Be sure the top fixed panel support is pushed tightly against the jamb.

Step 12 Reversibility Instructions

12

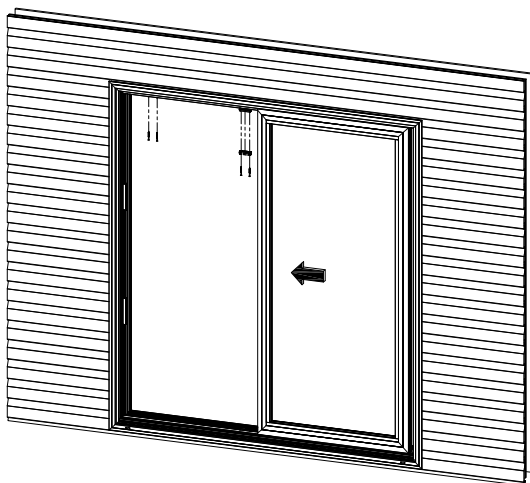

- A** Using two screws removed in step 7B, anchor the top fixed panel support (8022) in the two screw holes nearest the jamb first.
- B** Place the remaining anchor block (7003) removed in step 7B, aligning the holes of the anchor block with the holes in the support and then anchoring the anchor block to the top fixed panel support with the two screws also removed in step 7B.
- C** Slide the inactive sash panel into its new fixed position.

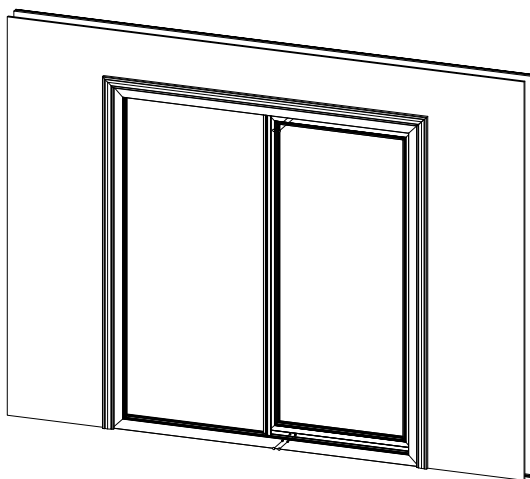

- D** Making sure that the fixed panel is pushed tightly against the jamb, anchor the fixed panel with the screws removed in step 6C in the holes found in the face of the inactive panel near the interlock.
- E** Place the four screw hole covers (9667) removed in step 6B in each of the four exposed holes found in the fixed panel.

13

Step 13 Reversibility Instructions

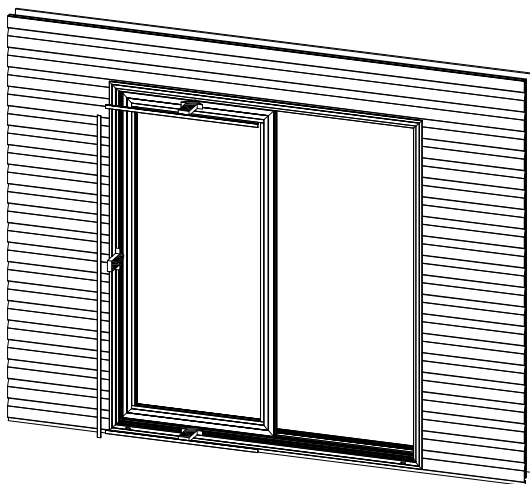

- A** On the exterior of the door, install the fixed panel trim (5771) using a rubber mallet.

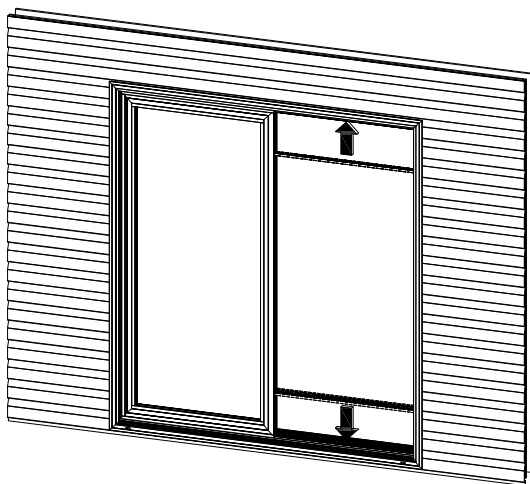

- B** With a rubber mallet, install the two sill covers (8011), one in the threshold and one in the head of the door. Be sure that the flat end of the sill cover is touching the fixed panel and the notched end is on the jamb side of the unit.

Step 14 Reversibility Instructions

14

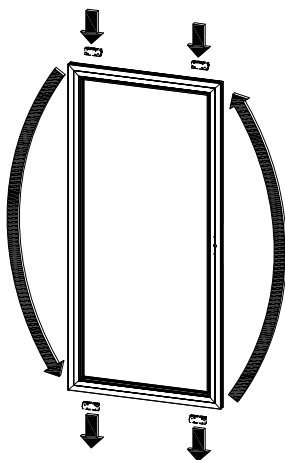

- A** Remove the rollers from the bottom of the operable panel by removing the two visible screws with a Phillips screwdriver.
- B** Install the rollers in the top of the panel making sure that the height adjustment screws are pointed toward the exposed ends of the sash.
- C** Turn the sash 180° making what was once the top of the door the new bottom.

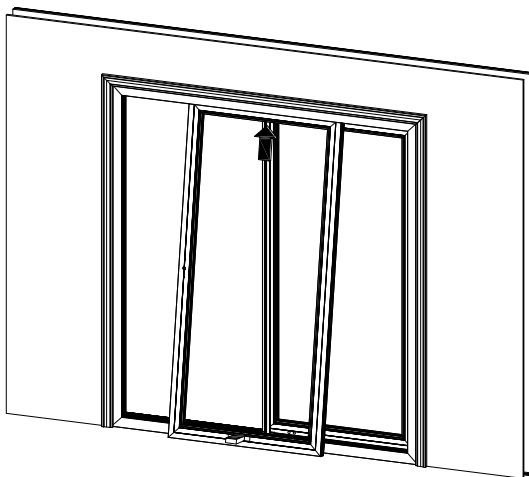

- D** From the interior, lift the top of the panel into the head of the door and swing the bottom of the panel into the opening. Adjust the rollers found at the bottom of the panel for best operation.

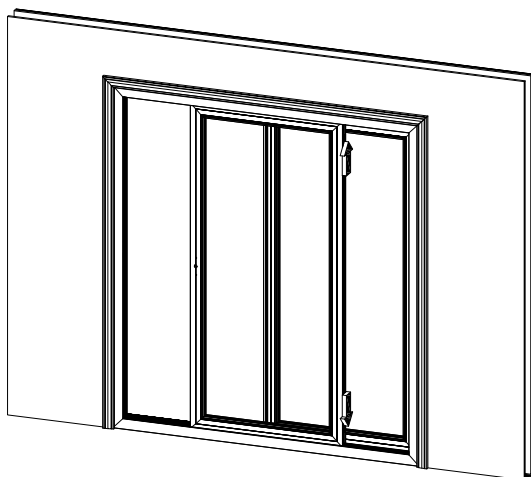

- A** Slide the caps found at each end of the interlock of the active panel to cover the exposed slots in the sash.

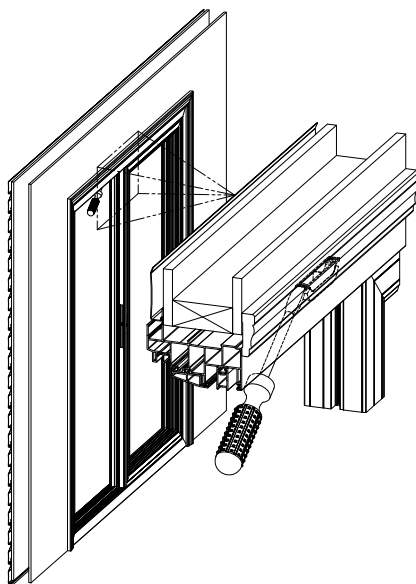

- B** With the active sash in the fully opened position, insert the dust plug (8803) into the cavity shown and align the holes of the dust plug with the holes made by the screws anchoring the dust plug into the head of the unit.

Step 16 Reversibility Instructions

16

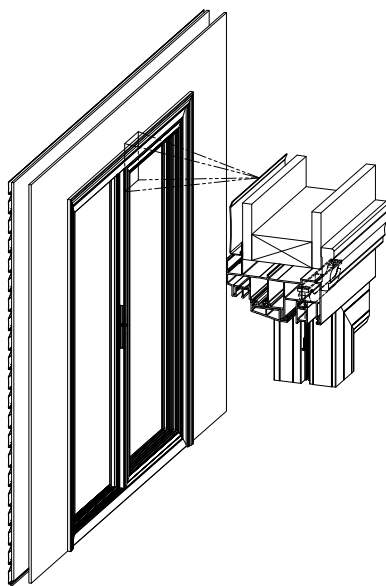

- A** With the sash remaining in the fully opened position, use the screw removed in step 2B to anchor one side of the dust plug (8803) into the head of the unit.

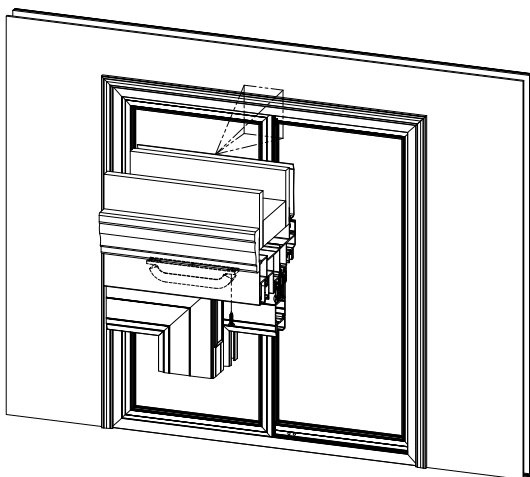

- B** Move the active sash to the closed positions and insert the screw removed in step 3A into the remaining open hole of the dust plug (8803).

17

Step 17 Reversibility Instructions

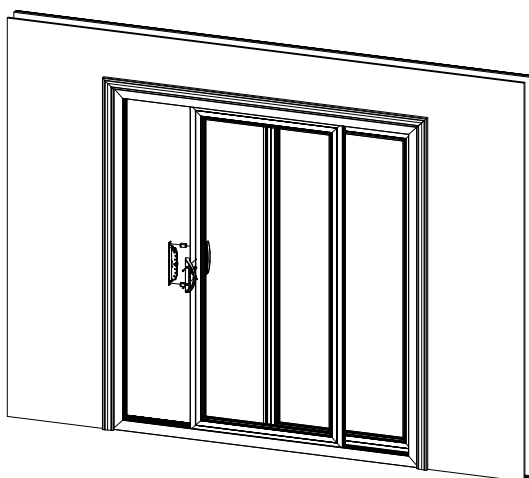

- A** Vent the active panel to easily access the side of the sash. Install the handle and mortise assembly referencing the handle installation instructions packaged with the door.

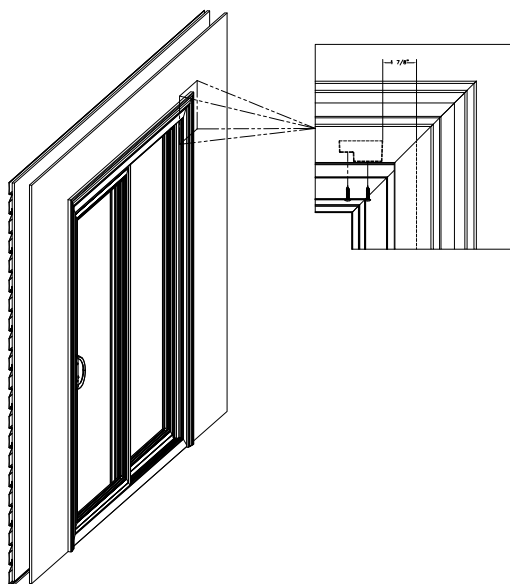

- B** Install the sash stopper (8804) in the head of the unit and closest to the jamb opposite the locking hardware of the door. Use the diagram above for locating the sash stopper in the unit.

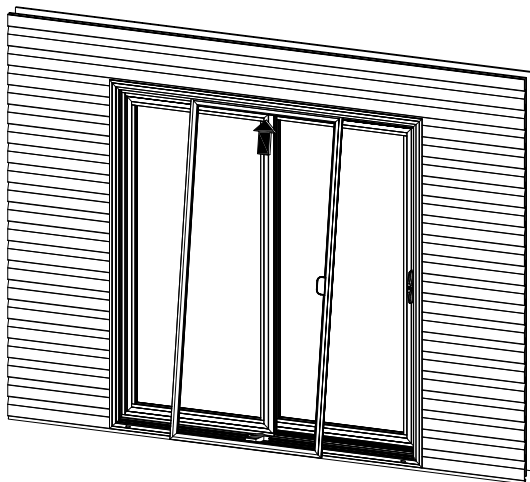

- A** From the exterior of the door, configure the screen in a manner that the locking mechanism of the screen sits directly in front of the locking mechanism of the active door sash and the spline of the screen is facing the exterior of the home. Lift the screen into the head of the unit and swing the bottom of the screen over the roller track of the door. Adjust the rollers at the top and bottom of the screen as needed for smooth, unobstructed operation.

[illegible]

