

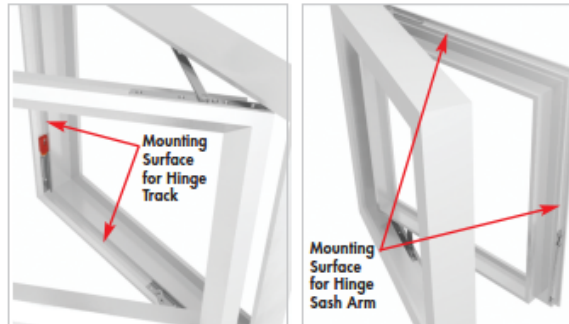

WORK INSTRUCTIONS

Casement Window:

- First Locate your mounting surfaces



- Remove the installation template provided
- Place the template against the edge of the hinge pocket on the vertical sash member and flush to the bottom edge of the sash.

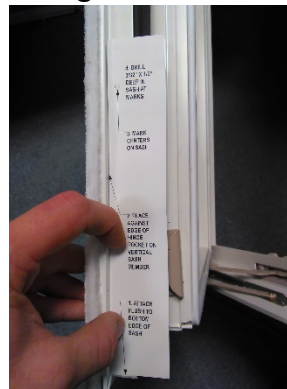

- Mark holes and pre drill 3/32"X1/2" deep in sash mark
- Attach bracket arm
 - Be sure the arm moves freely and hangs toward the inside of the window at approximately a 20 degree angle from the vertical sash.

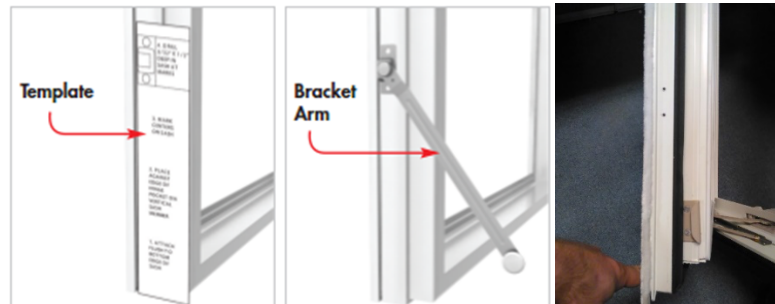

- Place track on the bottom corner and tight against the vertical edges as shown. Mark track hole locations.
- Pre-drill screw holes for track assembly using the 3/32" drill bit to a depth of 1/2"
- Attach the track to the orientation shown

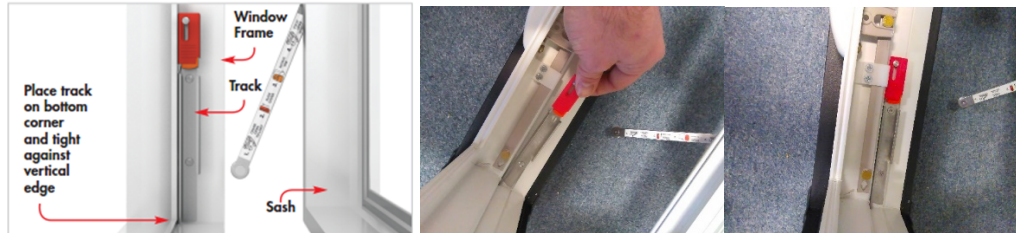

- The completed installation should look like the figure below
 - Be sure to red cover slides up and the orange tab rotates freely when cover is up
 - When the window is closed, be sure the WOCD engages and operates according to the operation instruction provided.
- Attach the warning label, in the bottom corner opposite the hinge stile
 - ASTM F2090-10 requires every window with a WOCD to be labeled accordingly (depending on left or right hinged casement)

