

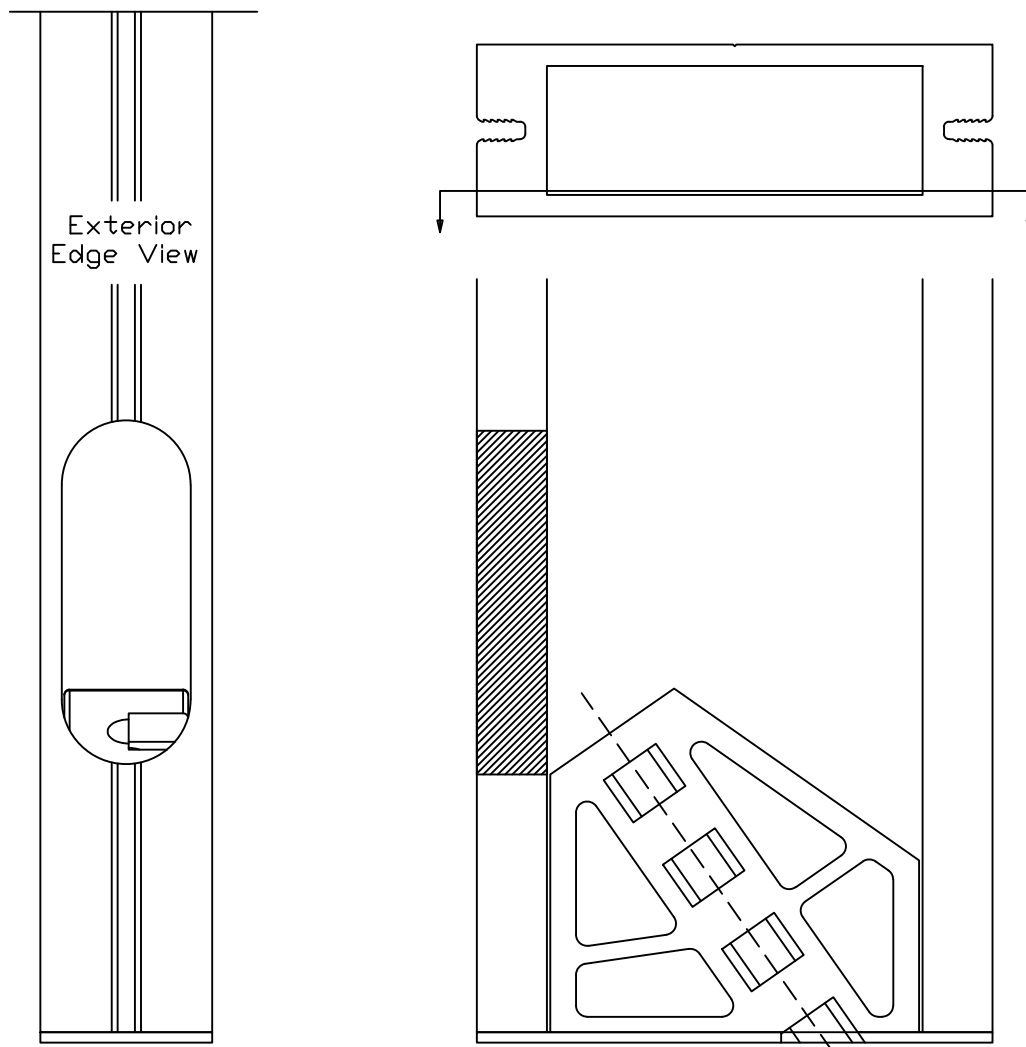

*Field Installation Guide for the
1" Structural Mull System. (non Impact)*



1" Structural Mull System. (Non Impact)

Table of Contents

<i>Table of Contents</i>	<i>2</i>
<i>Component Identification</i>	<i>3</i>
<i>Inspecting the Opening</i>	<i>4</i>
<i>Preparing the Opening</i>	<i>5</i>
<i>Setting the Unit / Anchorage</i>	<i>6</i>
<i>Final Trim and Sealant</i>	<i>7</i>
<i>A look inside</i>	<i>8</i>
<i>Multiple Mulls and Sealant</i>	<i>9</i>

Important

Any fabrication procedures that are different from those mentioned in this document may alter performances and/or the quality of finished product.

1" Structural Mull System. (Non Impact)

Component Identification

Read instructions carefully before starting the installation. Make sure the new Muller Window is sized to fit into the Rough opening (allow 1/4" to 1/2" gap all around)

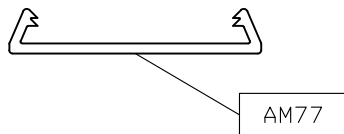
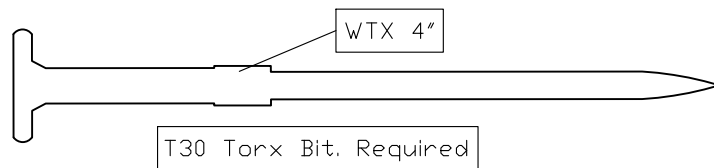
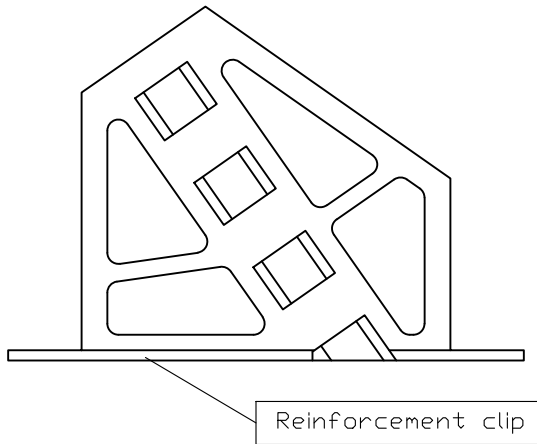

1" Structural Mull System. (Non Impact)

Inspecting the Opening

Read instructions carefully before starting the installation. Make sure the new Muller Window is sized to fit into the Rough opening (allow 1/4" to 1/2" gap all around)

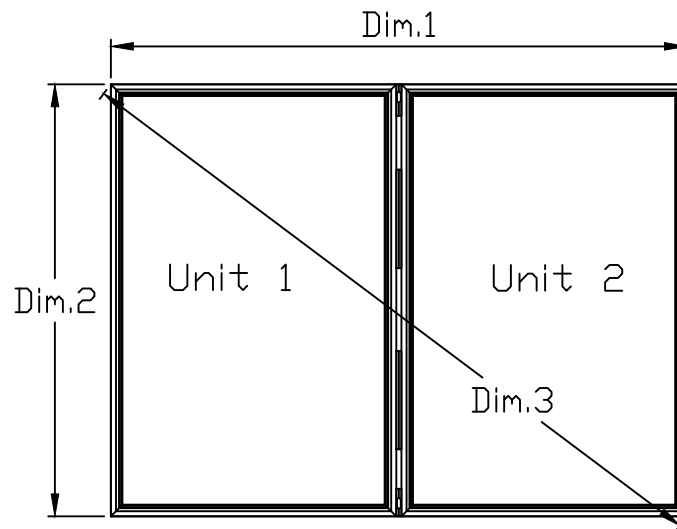
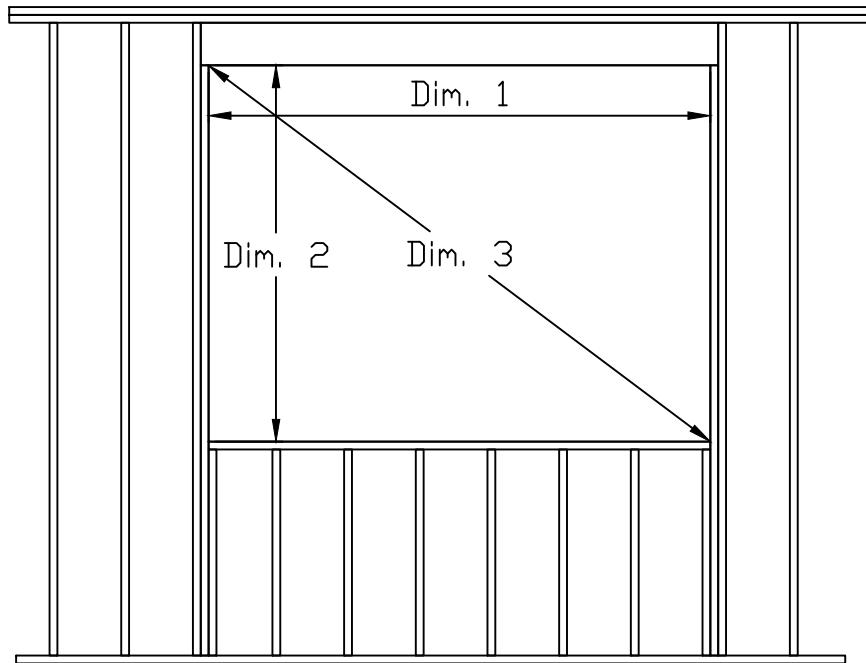

1" Structural Mull System. (Non Impact)

Preparing the Opening

Openings Should be prepped for Waterproofing in accordance to local codes and, best building Practices.

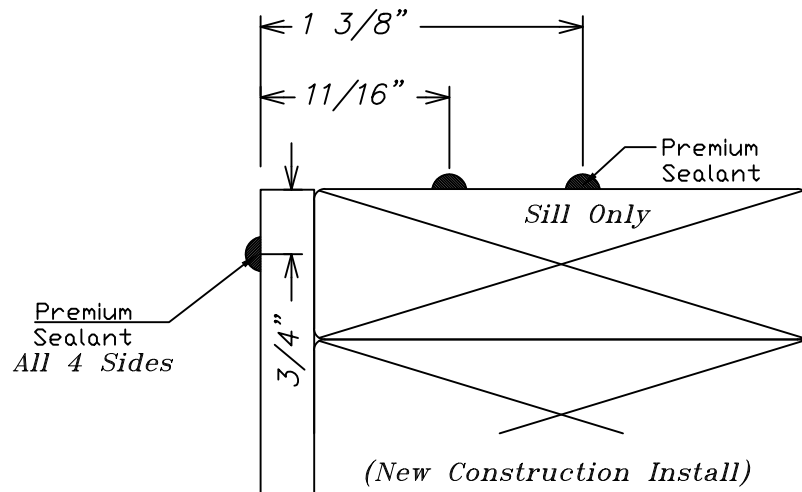
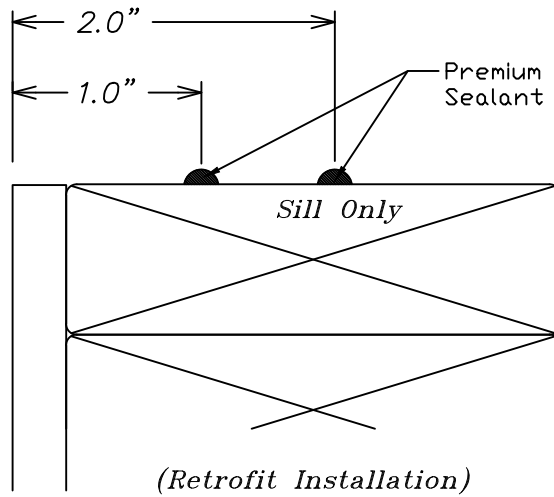

1" Structural Mull System. (Non Impact)

Setting the Unit / Anchorage.

For Retrofit installation : Factory muller Unit should be set into the opening. Unit should be pressed into the Silicone. Square the unit into the opening by placing shims around till you achieve an even reveal. From the outside Anchor the 2 WTX 4" Screws through the openings in the aluminum. Once this is complete you can continue to anchor the unit in from the inside. (Please refer to the Wincore Web Site for installation placement)(See QR Code)

T30 Torx Bit. Required
for 4" WTX Screws.

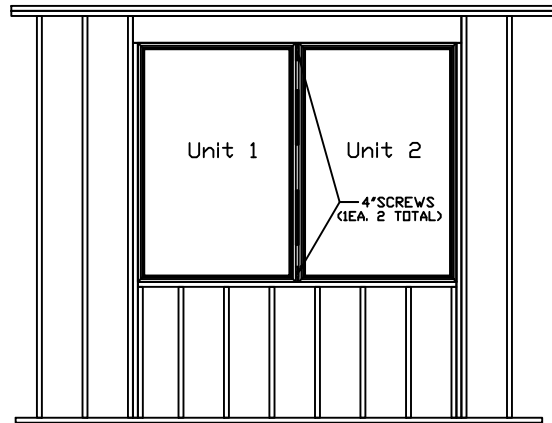

For New Construction installation : Factory muller Unit should be set into the opening. Unit should be pressed into the Silicone. Square the unit into the opening by placing shims around till you achieve an even reveal. From the outside Anchor the 2 WTX 4" Screws through the openings in the aluminum. Once this is complete you can continue to anchor the unit Through the nail-fin. (Please refer to the Wincore Web Site for installation placement)(See QR Code)

T30 Torx Bit. Required
for 4" WTX Screws.

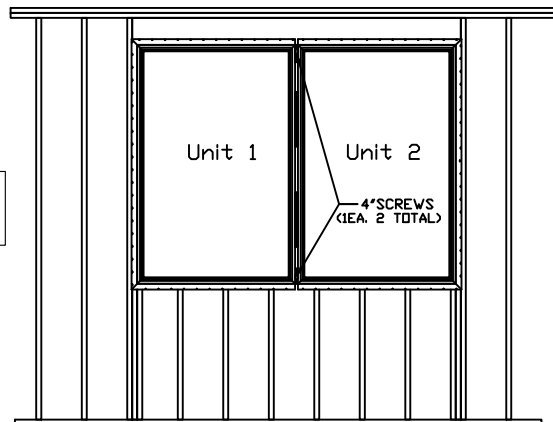

QR

1" Structural Mull System. (Non Impact)

A look inside

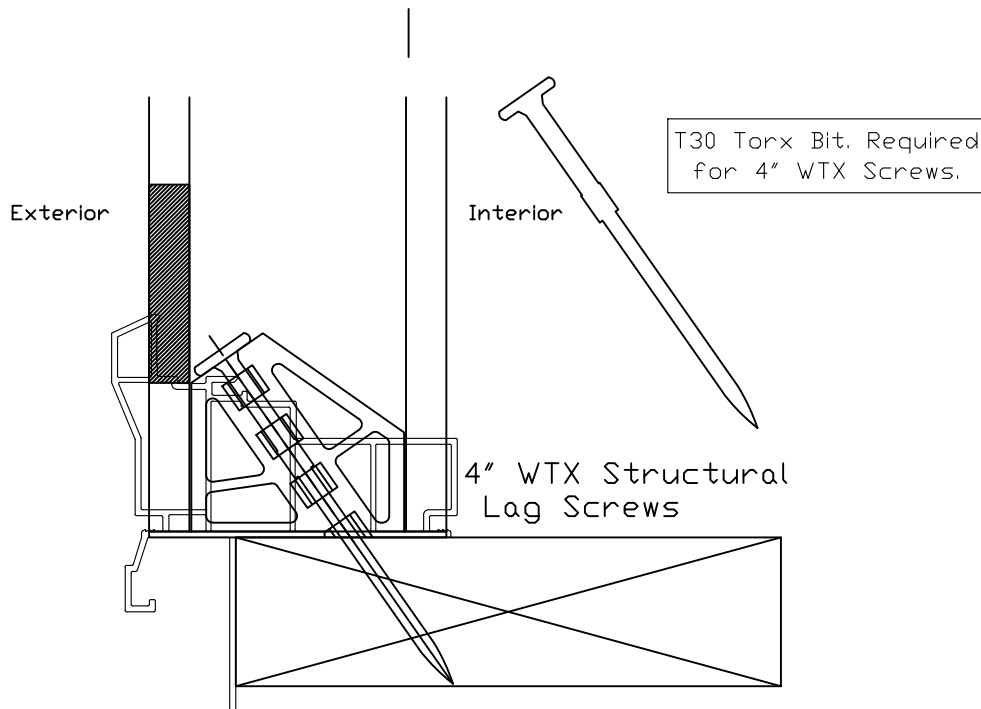
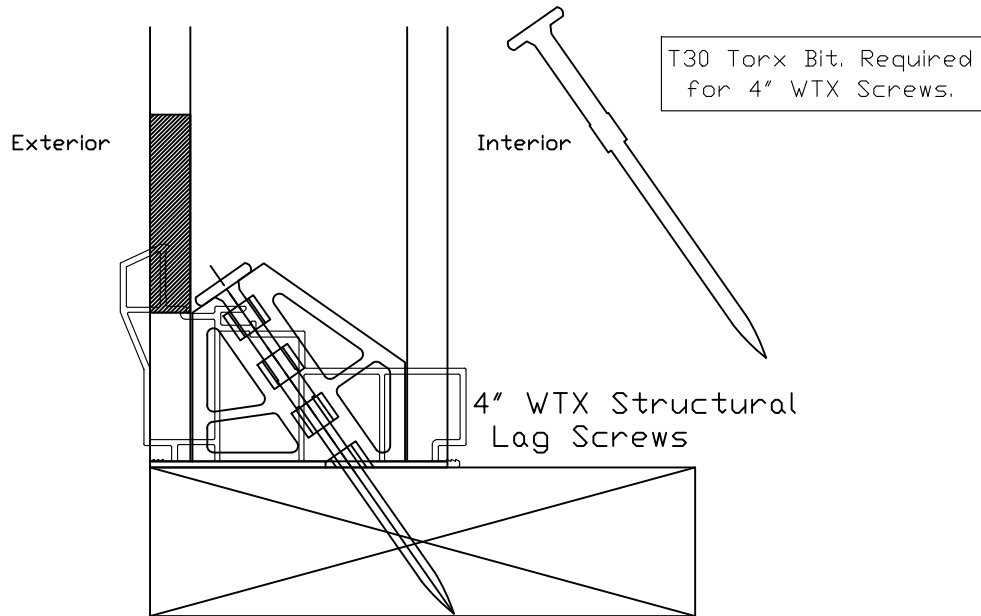

1" Structural Mull System. (Non Impact)

Multiple Mulls and Sealant

In the condition shown below with 2 Structural mulls crossing each other. One of the AM77 should be notched out to jump over the opposite aluminum support. Also when butting the short AM77 to the cross, extra silicone needs applied to ensure an appropriate seal.

