

ROAD CLOSURE – TRAFFIC CONTROL COORDINATION REQUIREMENTS

- 1. Project proponent (DPW engineer, BBC, COE, UPs, TXDOT, City, etc) must
- conduct all the preliminary coordination with DES, DPTMS, BBC, impacted
- facilities and (City/TXDOT when applicable).
-
- 2. The proponent will generate power point slides providing the pertinent
- details for the closure. See attached sample.
-
- - Name of impacted road(s)
- - Name and phone number of POC (For DPW projects managed by DPW, list the
- DPW POC)
- - Beginning and end dates and times
- - Brief description of the work taking place
- - Map showing impacted road sections, but the area shown must be large
- enough for someone not familiar with the project to recognize where the
- project is taking place.
- - Detail map showing the impacted road(s) and the traffic control plan (i.e.
- detours, one-ways, etc)
- -traffic control plan to comply with TX MUTCD
-
- 3. Email the power point slides to the DPW Director and Deputy at least two
- weeks before the scheduled closure and concurrently provide them to DES,
- BBC, PAO and TBOC. The DPW Director or Deputy will email the info to the
- installation leadership for their awareness and approval.
-
- 4. If the installation leadership desires changes, the proponent will make
- the necessary changes and will provide the revised power point slides to
- DES, BBC, PAO and TBOC.



Directorate of Public Works



Road Closure West of Pershing Gate

Start Date: 5 Jan 13/0800

End Date: 15 Apr 13/1300

Point of Contact: Mr. John Doe, 568-0000

The heading should change to the appropriate entity if not executed by DPW



Directorate of Public Works



PROJECT DETAILS

- **Failing road is being replaced with new asphalt pavement and pavement markings**
- **New sidewalk and vehicle guardrail will be installed on south side of Pershing Rd to address safety deficiencies**
- **New Right turn lane will be constructed on Pershing to Radford St**
- **Phase 1 will last approximately 60 days**
- **Phase 2 will last approximately 45 days**
- **Project has been phased to allow the gate to remain open during the two phases for inbound traffic only**



Directorate of Public Works



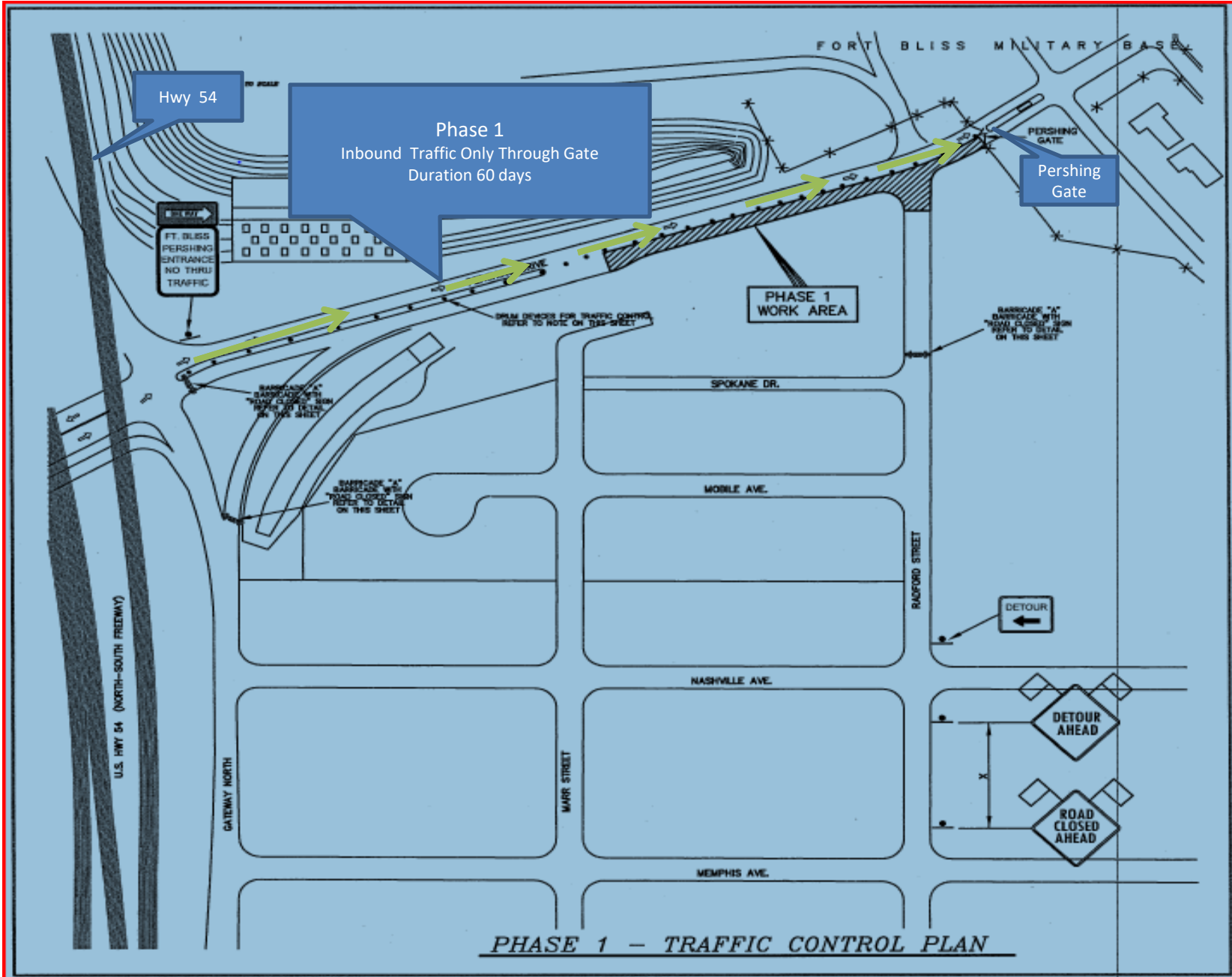

Hwy 54

Phase 1
Inbound Traffic Only Through Gate
Duration 60 days

Pershing Gate

PHASE 1
WORK AREA

BARRICADE #1
BARRICADE WITH
ROAD CLOSED SIGN
REFER TO DETAIL
ON THIS SHEET

BARRICADE #1
BARRICADE WITH
ROAD CLOSED SIGN
REFER TO DETAIL
ON THIS SHEET

BARRICADE #2
BARRICADE WITH
ROAD CLOSED SIGN
REFER TO DETAIL
ON THIS SHEET

DETOUR

DETOUR
AHEAD

ROAD
CLOSED
AHEAD

PHASE 1 - TRAFFIC CONTROL PLAN

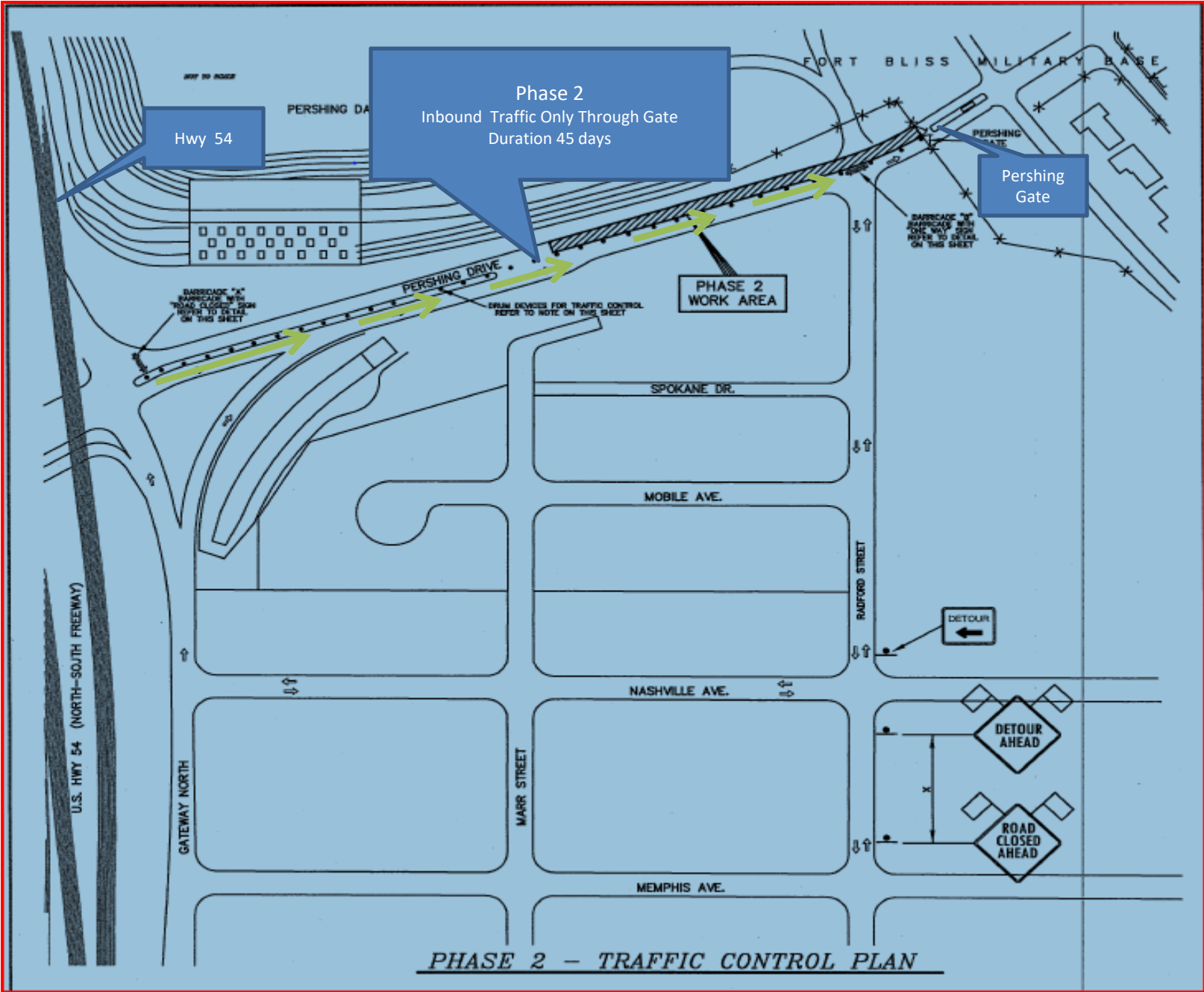

Hwy 54

Phase 2
Inbound Traffic Only Through Gate
Duration 45 days

Pershing Gate

PHASE 2
WORK AREA

DETOUR

DETOUR
AHEAD

ROAD
CLOSED
AHEAD

PHASE 2 - TRAFFIC CONTROL PLAN