

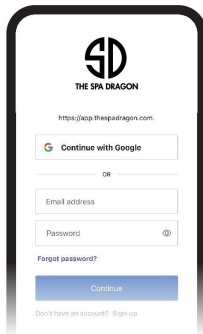

THE SPA DRAGON

Quick Start

1



On your smartphone, go to: app.thepadragon.com and register.

2

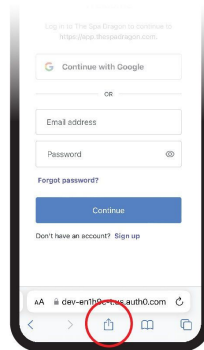

From the browser, select "share" button.

3

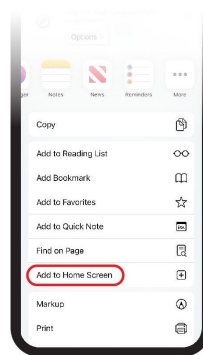

Select "Add to Home Screen" (from safari on iPhone) - Now you can access TheSpaDragon from the App Store

4



You will receive a code once you create your account, write the code down.

5

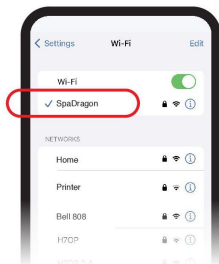

Go to your phone's WiFi settings and locate "TheSpaDragon." Connect to this network. Password: **MySpaDragon (case sensitive)**

6

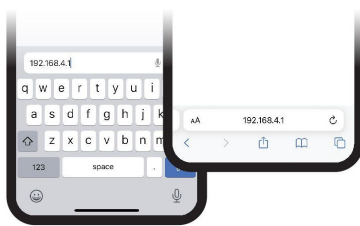

Type 192.168.4.1 into the address bar of your phone's browser and a window similar to the next picture will appear.

Note: Some phones may not connect with mobile data on, turn off if needed.

7

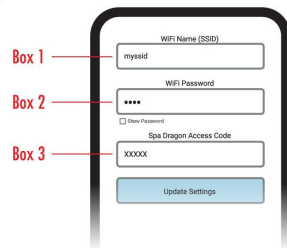

Box 1 — Select your home wifi (Box 1). Enter home wifi password (box 2). Enter Access code from step 2 (Box 3). Select update settings and device should count down 5-1 and connect, wifi unit will flash Green/Purple if successful. If not successful (red/purple) repeat step 6, 7.

8



Return to app.thepadragon.com and setup options. Recommended alert warning settings (May have to adjust depending on insulation type):
• With 24 hour circulation pump: 90°F • With 2 speed circulation pump: 60°F

SETUP INDICATORS

Purple	WiFi Setup Mode
Alternating Purple/Red	WiFi password failed or wrong ssid or router is unavailable
Alternating Purple/Yellow	WiFi setup timed out waiting for input
Alternating Purple/Green	WiFi setup completed successfully
Green Sweep	Does once on power up

IN USE INDICATORS

Light Blue	One or more Temperature sensors has failed
Solid Green	Normal operation, all is good
Solid Red	Normal operation, forced heat (maintenance mode)
Flashing Red	Normal operation, temp below the set point
Dark Blue	Firmware update in progress, do not disconnect the power!
Blinking Yellow	Major software fault. Unit cannot monitor the Spa